

INDEX TO DRAWINGS	
SHEET NO.	DESCRIPTION
1	TITLE SHEET
2	STANDARD PLANS SUMMARY
3	GENERAL NOTES & LEGEND
4 - 5	WATER POLLUTION AND EROSION CONTROL NOTES
6	TYPICAL SECTIONS
7	ROADWAY PLAN
8 - 9	KAINAHOLA STREAM BRIDGE PLANS
10	PAVEMENT MARKING LEGEND, DETAILS & NOTES
11	PAVEMENT MARKING AND TRAFFIC SIGNING PLAN
12	LOW SPEED UNDIVIDED HIGHWAY WORK ZONE SIGNING PLAN, NOTES & DETAILS

STATE OF HAWAII

DEPARTMENT OF TRANSPORTATION

HIGHWAYS DIVISION

HONOLULU, HAWAII

"AS-BUILT" PLANS FOR

TEMPORARY KAPAA BYPASS ROAD

REPAIRS AT KAINAHOLA STREAM BRIDGE

PROJECT NO. 5600-01-10M

DISTRICT OF KAWAIIHAU

ISLAND OF KAUAI

FED. ROAD DIST. NO.	STATE	PROJ. NO.	FISCAL YEAR	SHEET NO.	TOTAL SHEETS
HAWAII	HAW.	5600-01-10M	2010	1	12

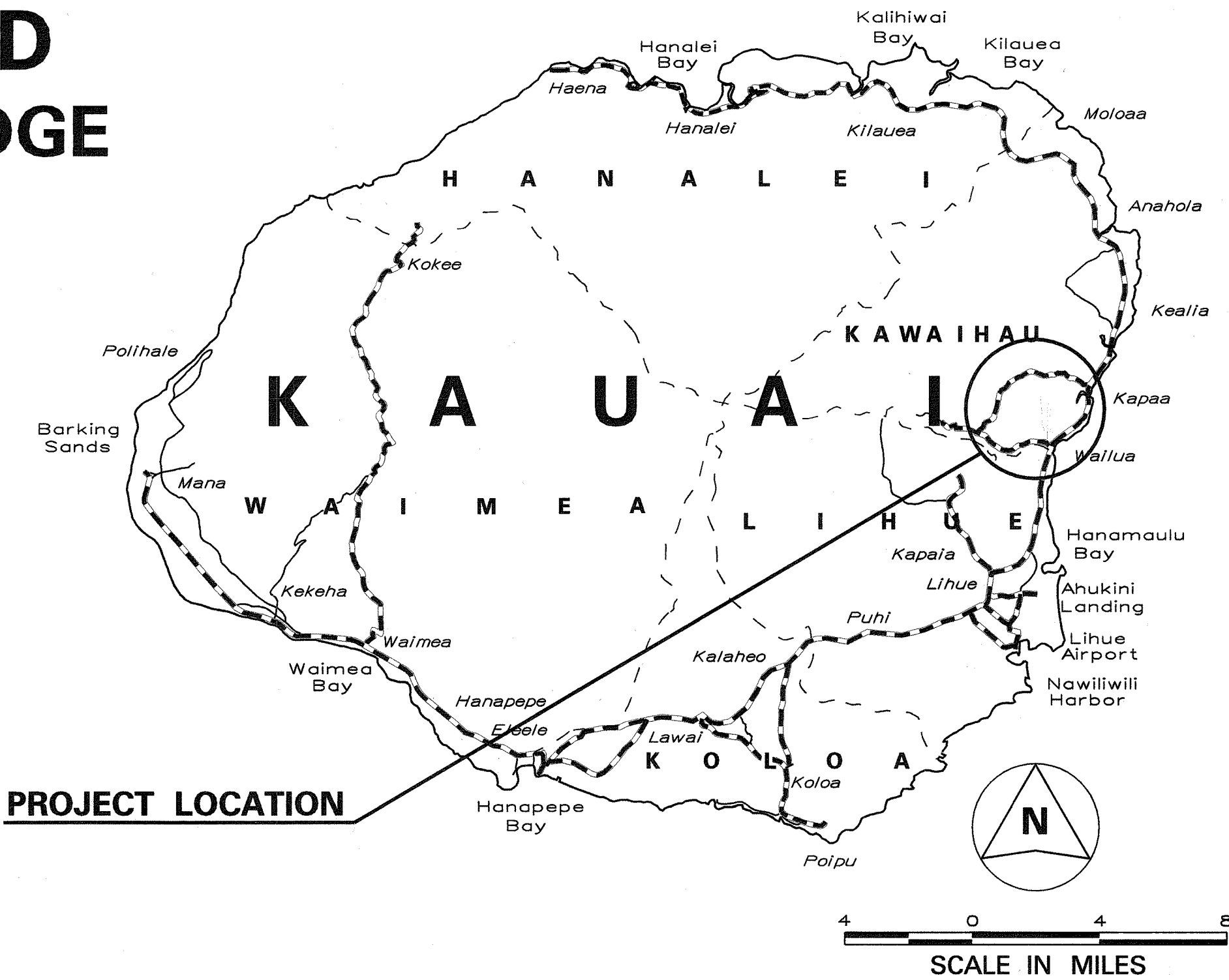
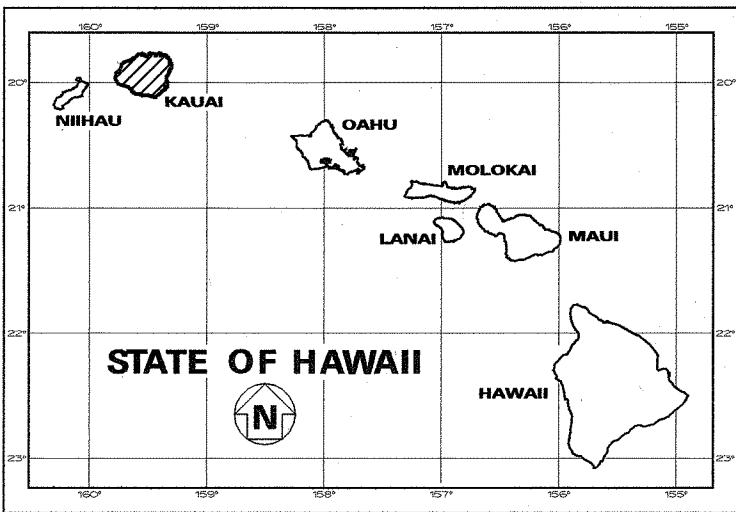

----- FEDERAL AID PROJECTS PREVIOUSLY CONSTRUCTED OR UNDER CONSTRUCTION

MILE POST 1.59 TO MILE POST 1.63

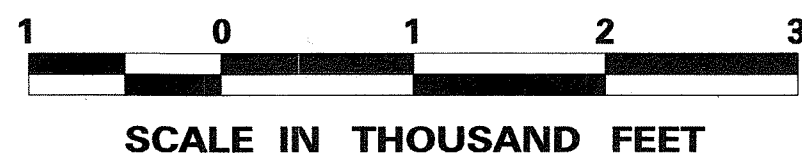
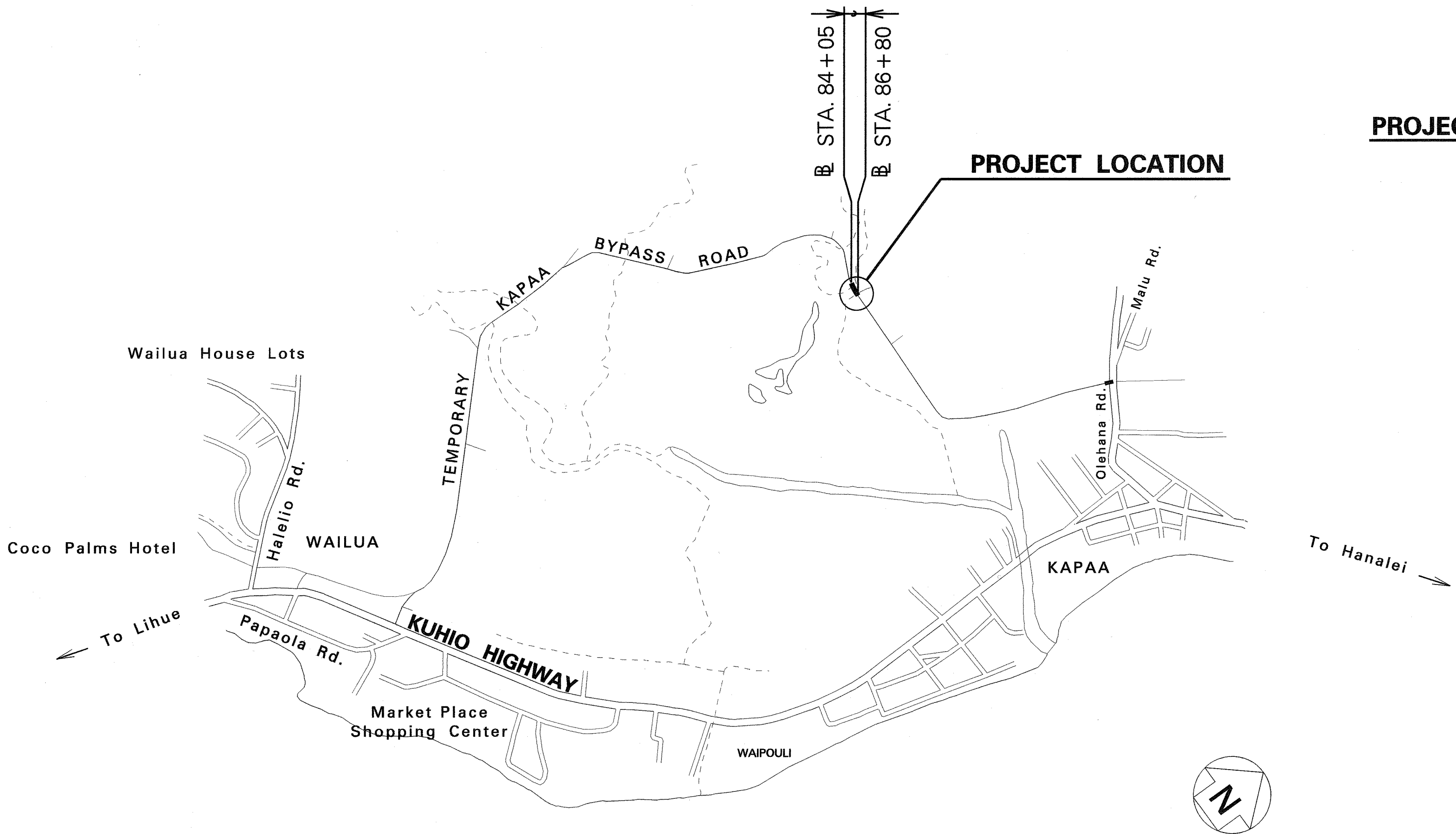

LAYOUT PLAN

GROSS LENGTH OF PROJECT.....0.04 MILE

NET LENGTH OF PROJECT.....0.04 MILE

CHANGES MADE DURING CONSTRUCTION HAVE BEEN INCORPORATED ON THESE PLANS EXCEPT CHANGES IN THE ORIGINAL THEORETICAL QUANTITIES. FOR ACTUAL QUANTITIES, REFER TO PROJECT LETTER AND/OR COMPUTER BOOK.

*J.R. [Signature]* 3-12-12

DEPARTMENT OF TRANSPORTATION

STATE OF HAWAII

APPROVED:

*[Signature]* 5/28/10

DIR. OF TRANSPORTATION

DATE

HWY-K

DESIGNED BY

HWY-KE

MANAGED BY

241-3000

PHONE

MAY 2010

DATE