

FED. ROAD DIST. NO.	STATE	FED. AID PROJ. NO.	FISCAL YEAR	SHEET NO.	TOTAL SHEETS
HAWAII	HAW.	580A-01-02	2005	12	25

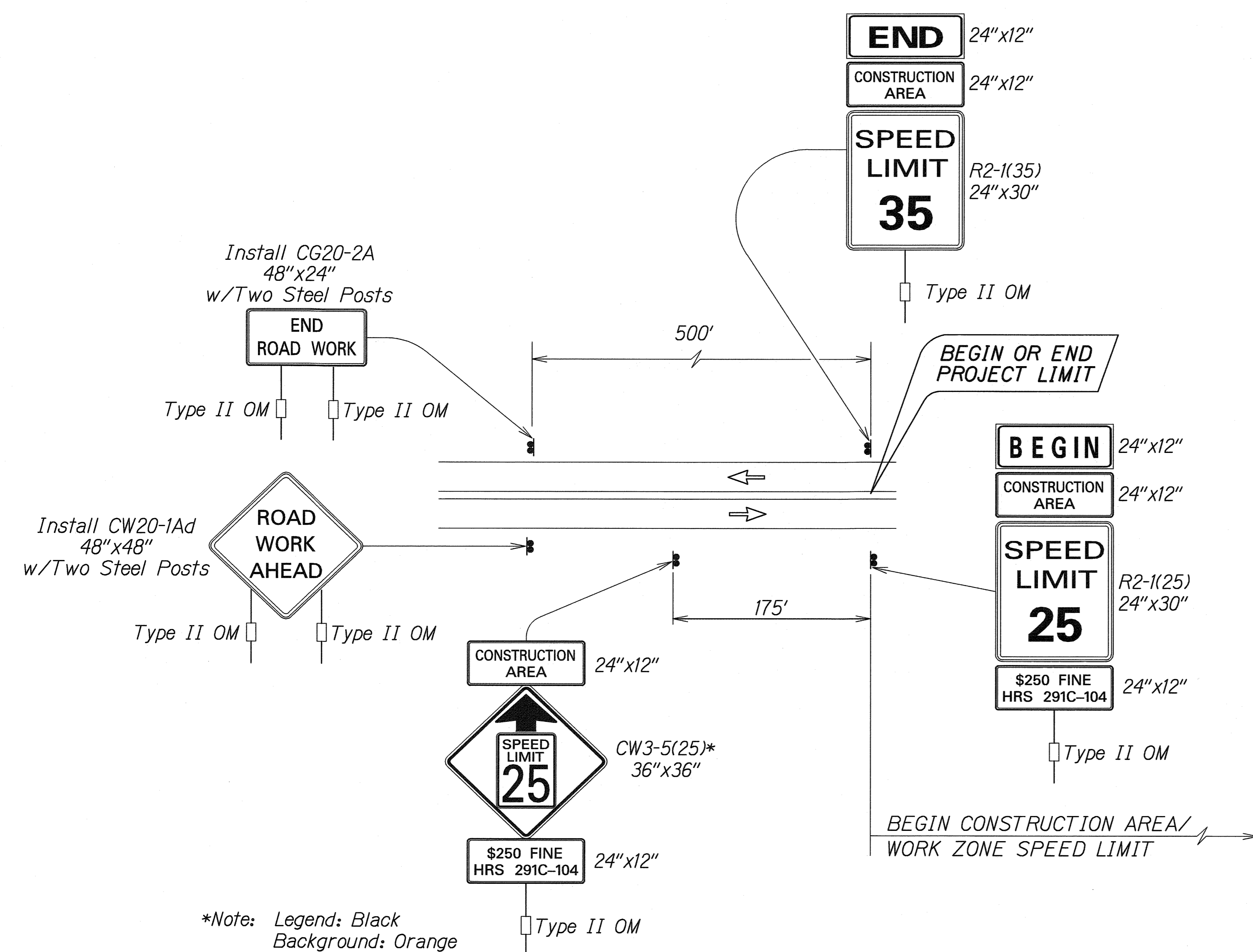

*Note: Legend: Black Background: Orange

TYPICAL DETAIL FOR CONSTRUCTION SIGNS ON TWO LANE OR MULTILANE UNDIVIDED LOW SPEED HIGHWAY
NOT TO SCALE

- Work Zone Notes:**
1. This Work Zone Sign Plan is intended for use on long-term stationary work zones/construction phases (3 days or more). All work zones or construction phases less than 3 days duration will use Traffic Control Plans shown in Section 645 of the Special Provisions.
 2. All existing regulatory speed limit signs with posts within the work zone/project limits shall be removed and replaced with work zone speed limit sign assemblies (R2-1(25) and CW3-5(25) with "CONSTRUCTION AREA" and "\$250 FINE HRS 291C-104" Supplemental Signs).
 3. Construction sign assemblies shall be installed on both the approaching and trailing ends of each work zone as shown on this plan.
 4. Each construction warning sign shall have a minimum of two (2) Type II OM. Each work zone speed limit assembly shall have a minimum of one (1) Type II OM. Installation of each Type II OM shall be considered incidental to ~~Item No. 621.7100, Construction Sign with Posts.~~ contract Item No. 645.1000 - Traffic Control.
 5. Upon the completion of all physical work or as directed by the Engineer, all construction signs and work zone speed limit assemblies shall be removed. All speed limit signs and posts that were existing at the start of the project within the work zone/project limits shall be restored back to their original locations and configurations.
 6. Placement of construction signs shall not obstruct the path of pedestrians and bicyclists.
 7. ~~The removal and restoration of existing regulatory speed limit signs with new posts along with the installation, maintenance and removal of work zone speed limit sign assemblies shall be considered incidental to Item No. 621.7100, Construction Sign with Posts.~~
 ~~and warning signs with new posts shall be paid for under contract Item No. 621B.0300 and 621B.0400, respectively. The installation, maintenance, and removal of work zone sign assemblies shall be paid for under contract Item No. 645.1000 - Traffic Control.~~

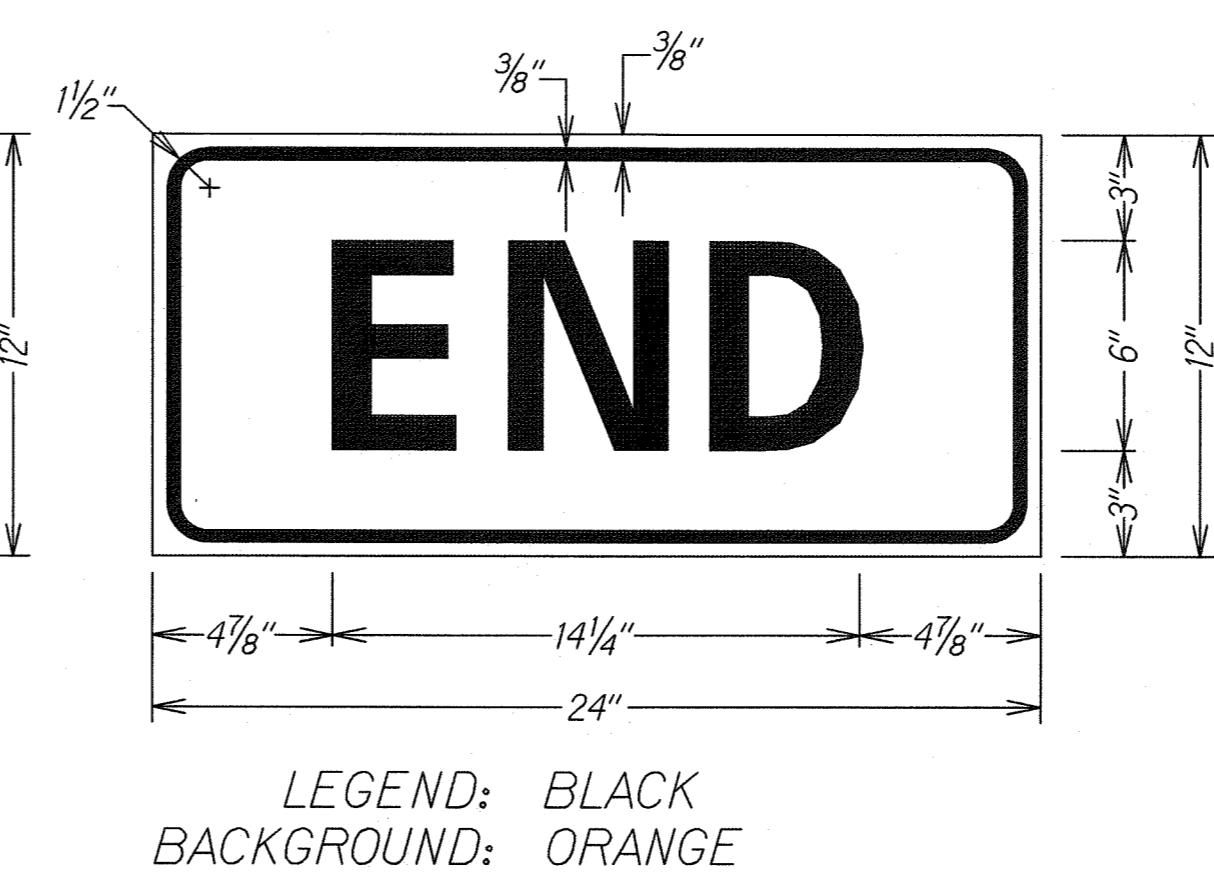
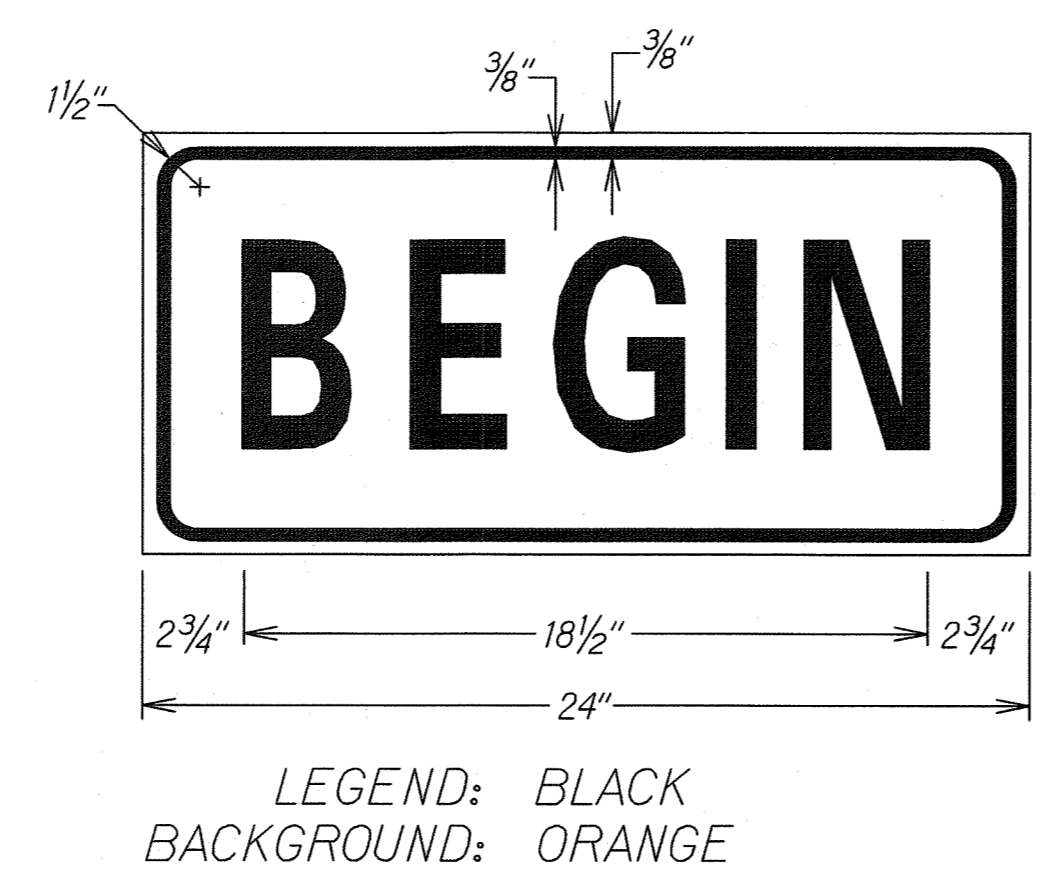
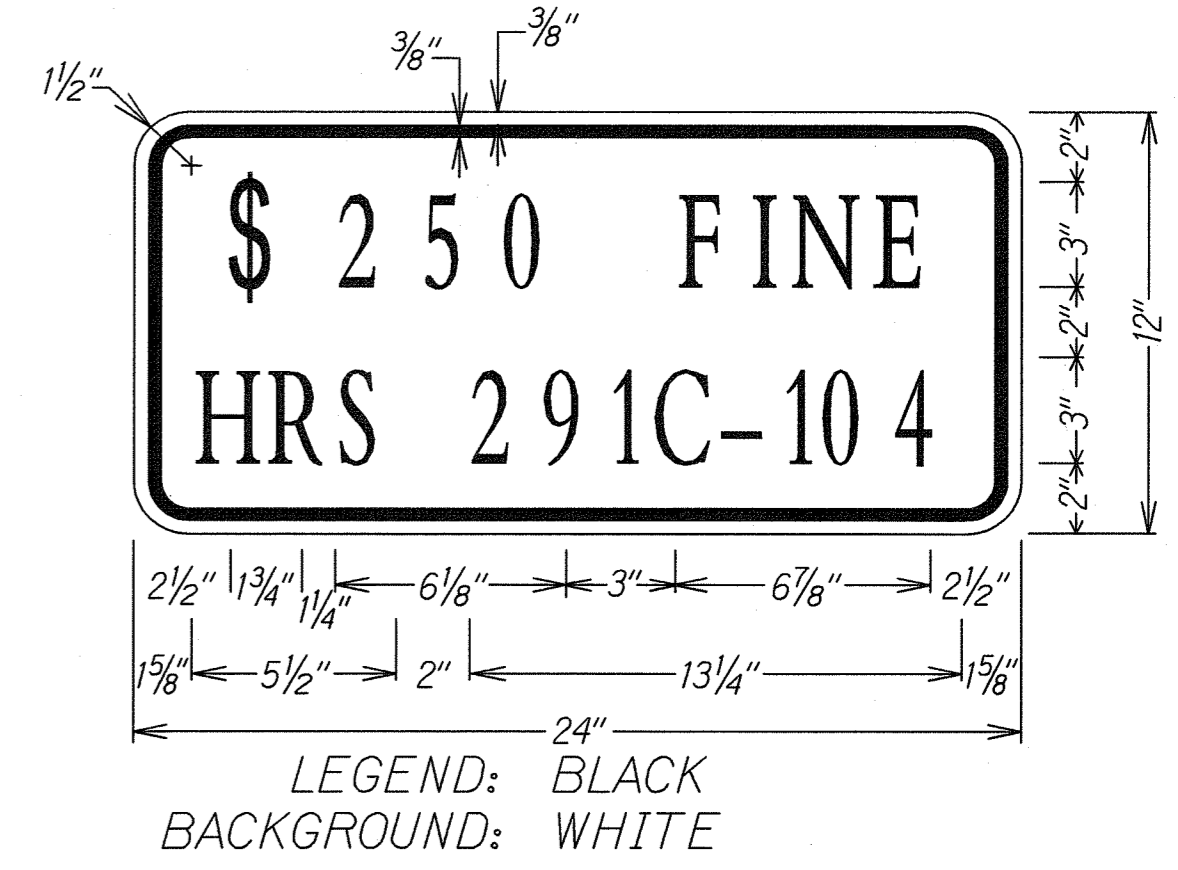
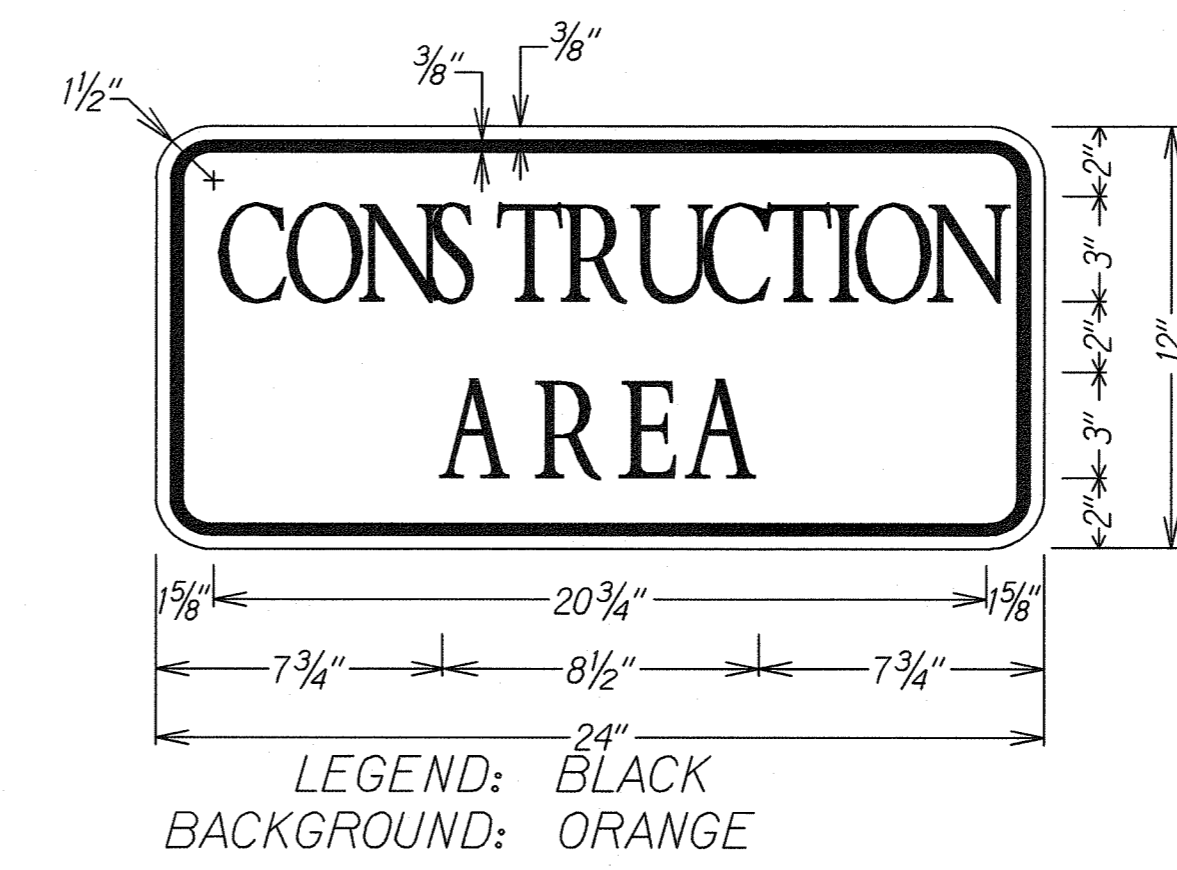

LEGEND FOR AS-BUILT POSTINGS

	Squiggly line for as-built deletion
	Double line for as-built deletion
Roadway	Text for as-built posting

EXPIRATION DATE OF THE LICENSE (4/30/10)

ALAN M. KATO
LICENSED PROFESSIONAL ENGINEER
No. 7552-C
HAWAII

THIS WORK WAS PREPARED BY ME OR UNDER MY SUPERVISION

STATE OF HAWAII
DEPARTMENT OF TRANSPORTATION
HIGHWAYS DIVISION

LOW SPEED UNDIVIDED HIGHWAY

WORK ZONE SIGNING PLAN, NOTES & DETAILS

KUAMOO ROAD RETAINING WALL IN THE VICINITY OF M.P. 11 PROJECT NO. 580A-01-02

SCALE: NOT TO SCALE DATE: SEPT 2005

SHEET No. / OF / SHEETS

"AS-BUILT"

DATE	_____
SURVEY PLOTTED BY	_____
DRAWN BY	_____
TRACED BY	_____
NOTED BY	_____
CHECKED BY	_____
ORIGINAL PLAN	_____
NOTE BOOK	_____
No.	_____

FILED DATE: 09/01/04 JOB NO.: 0741000