

FED. ROAD DIST. NO.	STATE	PROJ. NO.	FISCAL YEAR	SHEET NO.	TOTAL SHEETS
HAWAII	HAW.	580A-01-99M	2000	11	27

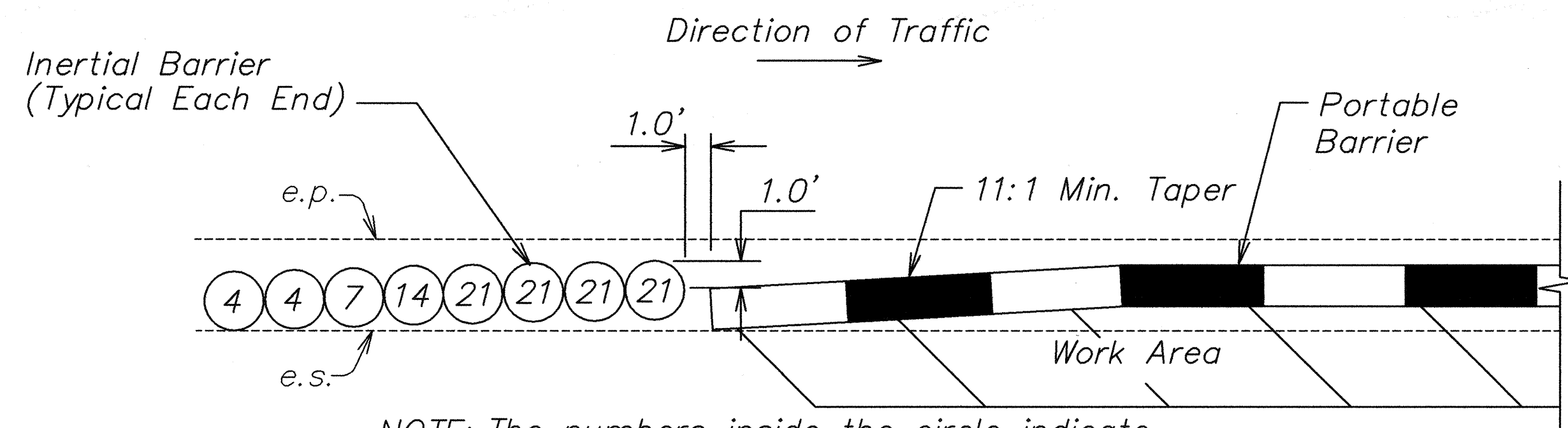

NOTE: The numbers inside the circle indicate weight of sand in 100 lb unit. Installation shall conform to Manufacturer's recommendations.

TYPICAL DETAIL 8-MODULE INERTIAL BARRIER Not To Scale

NOTES:

1. Installation of portable physical barriers shall conform to Manufacturer's recommendations.
2. Physical barriers shall be required whenever guardrails have been removed and will not be reinstalled at the end of the work day. See General Note No. 20 on Plan Sht. No. 3.
3. Physical barriers shall be either portable concrete barriers or portable water-filled barriers. Installation of portable water-filled barriers shall conform to Manufacturer's recommendations as dictated by design speed and field conditions.
4. Providing, transporting, placing, maintaining, relocating and removing physical barriers shall be considered incidental to the various items of work. See Section 645, TRAFFIC CONTROL DEVICES of the Special Provisions.
5. Ends of portable barriers shall be protected with Inertial Barriers as shown hereon. Furnishing, installing and maintaining inertial barriers shall be considered incidental to the various contract items.
6. Furnishing, installing and maintaining reflector markers (RM-3) over the portable barriers shall be considered incidental to the various contract items.

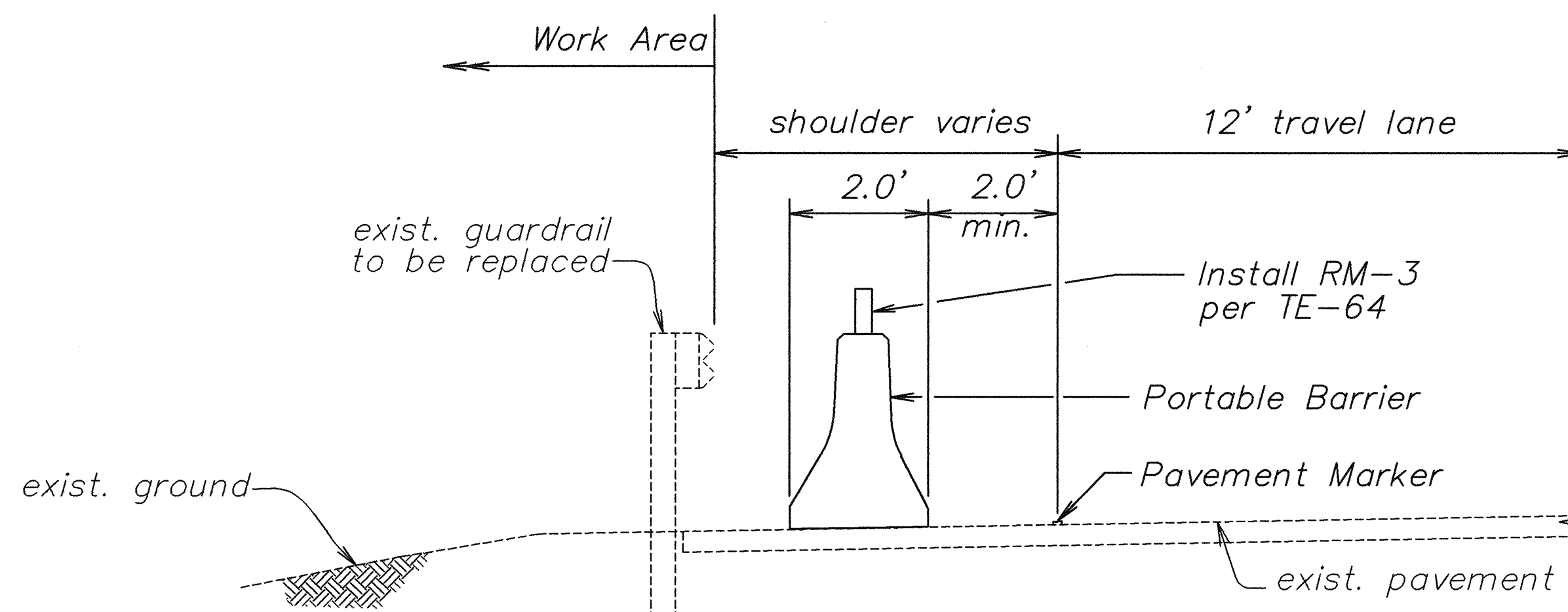

TYPICAL DETAIL PORTABLE BARRIER Not To Scale

ORIGINAL PLAN	SURVEY PLOTTED BY	DATE
NOTE BOOK	DRAWN BY	
NO. 1	DESIGNED BY	
	CHECKED BY	
	CHECKED BY	

STATE OF HAWAII
DEPARTMENT OF TRANSPORTATION
HIGHWAYS DIVISION

PORTABLE PHYSICAL BARRIER

KUAMOO ROAD RESURFACING
Vicinity of U.H. Agricultural Station to
End of Kuamoo Road
Project No. 580A-01-99M

Scale: No Scale

Date: April, 2000

SHEET No. 1 OF 1 SHEETS