

FED. ROAD DIST. NO.	STATE	PROJ. NO.	FISCAL YEAR	SHEET NO.	TOTAL SHEETS
HAWAII	HAW.	580A-01-99M	2000	20	27

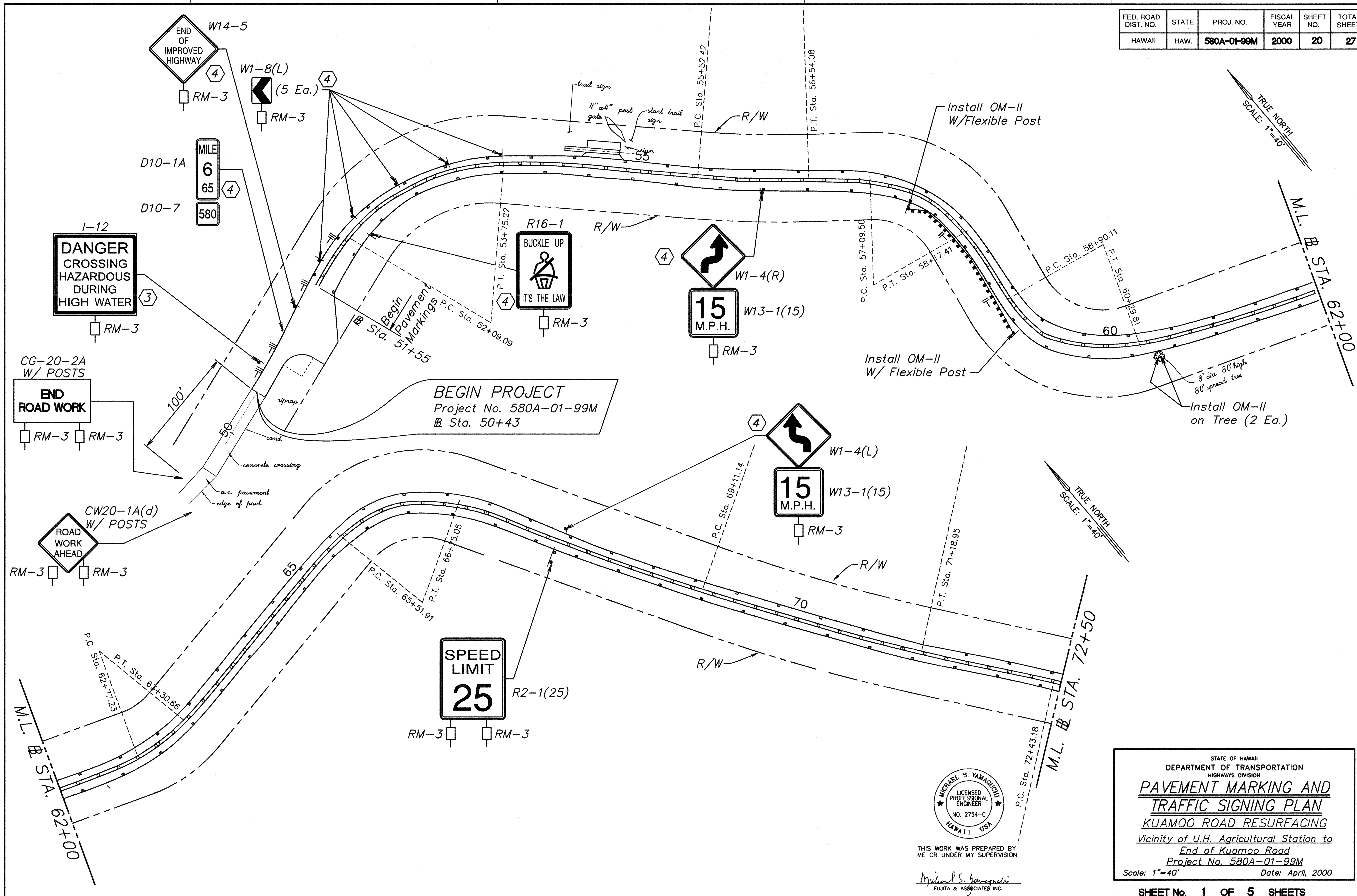

ORIGINAL PLAN	DATE
SURVEY PLOTTED BY	
DRAWN BY	
DESIGNED BY	
QUANTITIES BY	
CHECKED BY	

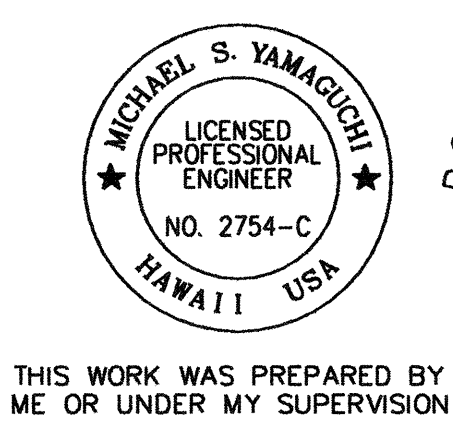

THIS WORK WAS PREPARED BY ME OR UNDER MY SUPERVISION

Michael S. Yamaguchi
FUJITA & ASSOCIATES, INC.

STATE OF HAWAII
DEPARTMENT OF TRANSPORTATION
HIGHWAYS DIVISION

PAVEMENT MARKING AND TRAFFIC SIGNING PLAN
KUAMOO ROAD RESURFACING

Vicinity of U.H. Agricultural Station to End of Kuamoo Road
Project No. 580A-01-99M
Scale: 1"=40' Date: April, 2000

akwakt01.dwg Tue, May 16, 2000 - 10:33:57

FED. ROAD DIST. NO.	STATE	PROJ. NO.	FISCAL YEAR	SHEET NO.	TOTAL SHEETS
HAWAII	HAW.	580A-01-99M	2000	21	27

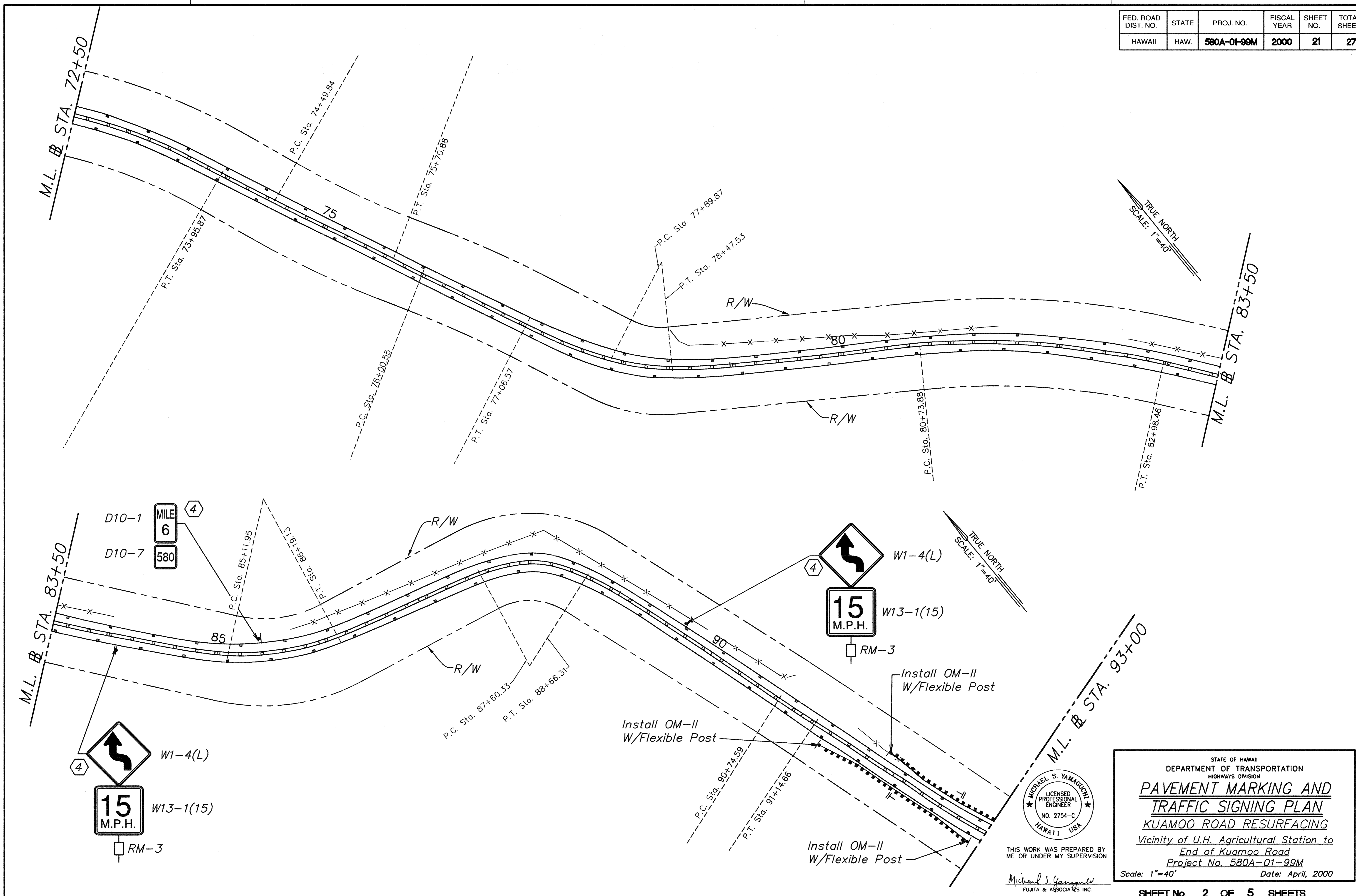

TRUE NORTH
SCALE: 1"=40'

TRUE NORTH
SCALE: 1"=40'

ORIGINAL PLAN
DATE
SURVEY PLOTTED BY
DRAWN BY
NOTE BOOK
DESIGNED BY
CHECKED BY
QUANTIFIED BY
NO.

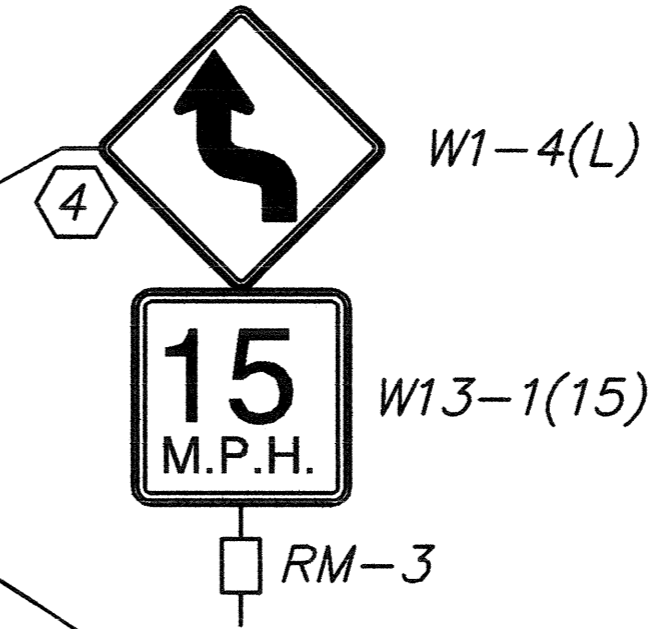
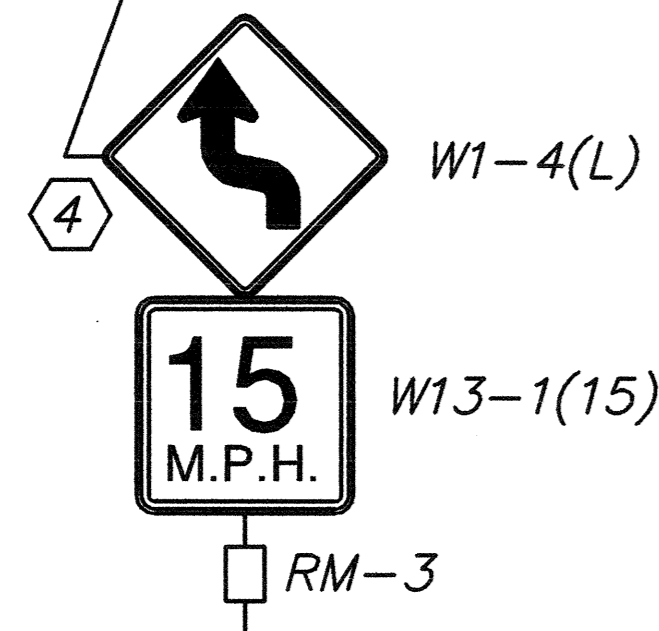

MICHAEL S. YAMAGUCHI
LICENSED PROFESSIONAL ENGINEER
NO. 2754-C
HAWAII USA

THIS WORK WAS PREPARED BY ME OR UNDER MY SUPERVISION

Michael S. Yamaguchi
FUJITA & ASSOCIATES INC.

STATE OF HAWAII
DEPARTMENT OF TRANSPORTATION
HIGHWAYS DIVISION
PAVEMENT MARKING AND TRAFFIC SIGNING PLAN
KUAMOO ROAD RESURFACING
Vicinity of U.H. Agricultural Station to End of Kuamoo Road
Project No. 580A-01-99M
Scale: 1"=40' Date: April, 2000

SHEET No. 2 OF 5 SHEETS

FED. ROAD DIST. NO.	STATE	PROJ. NO.	FISCAL YEAR	SHEET NO.	TOTAL SHEETS
HAWAII	HAW.	580A-01-99M	2000	22	27

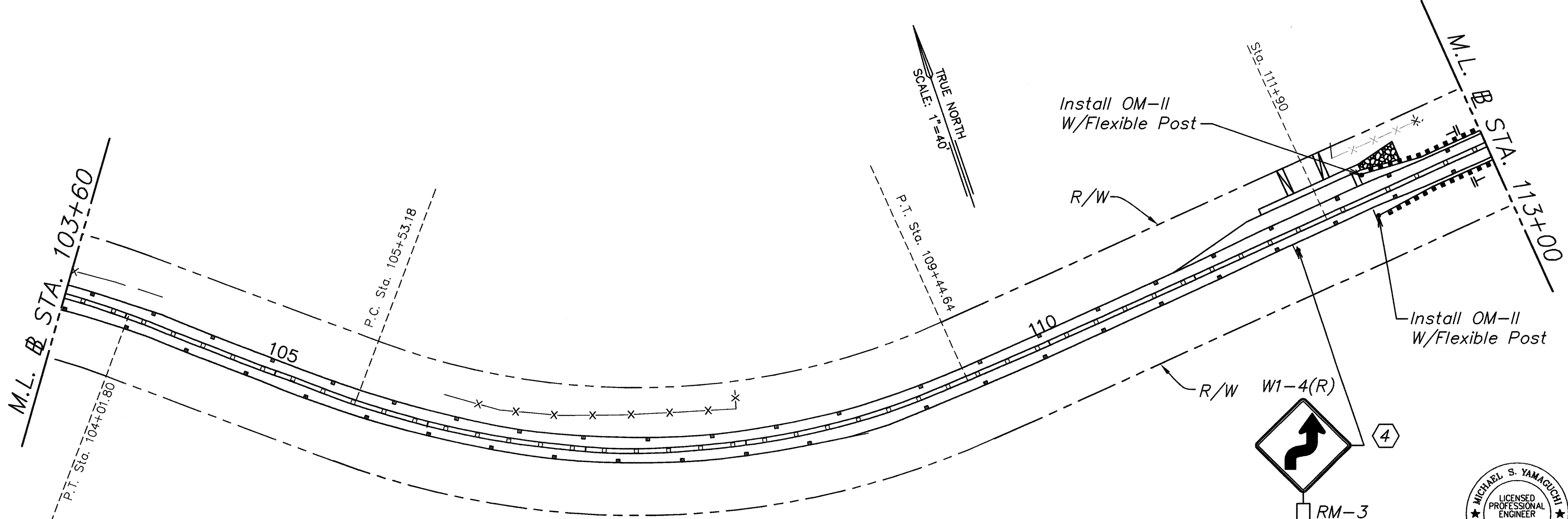
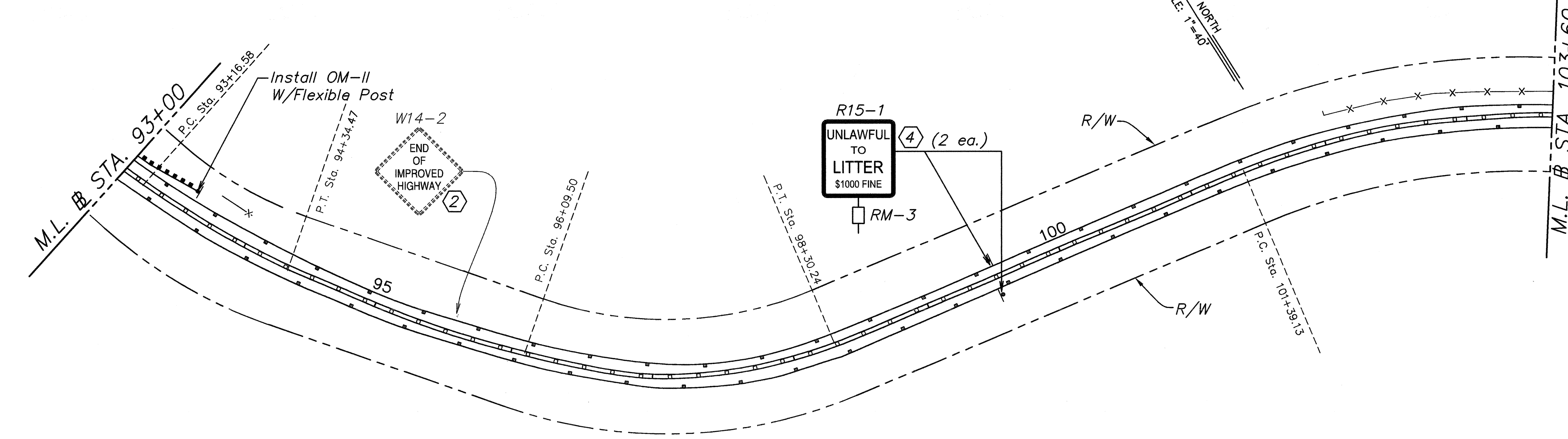

SURVEY PLOTTED BY	DATE
DRAWN BY	
NOTE BOOK	
DESIGNED BY FUJITA & ASSOCIATES, INC.	APR 1, 2000
CHECKED BY	
NO.	

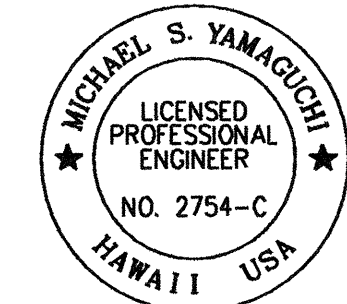

THIS WORK WAS PREPARED BY ME OR UNDER MY SUPERVISION

Michael S. Yamaguchi
FUJITA & ASSOCIATES, INC.

STATE OF HAWAII
DEPARTMENT OF TRANSPORTATION
HIGHWAYS DIVISION

**PAVEMENT MARKING AND
TRAFFIC SIGNING PLAN**

KUAMOO ROAD RESURFACING

Vicinity of U.H. Agricultural Station to
End of Kuamoo Road

Project No. 580A-01-99M

Scale: 1"=40' Date: April, 2000

SHEET No. 3 OF 5 SHEETS

chuckb03.dwg Tue, May 16, 2000 - 10:37:34

FED. ROAD DIST. NO.	STATE	PROJ. NO.	FISCAL YEAR	SHEET NO.	TOTAL SHEETS
HAWAII	HAW.	580A-01-99M	2000	23	27

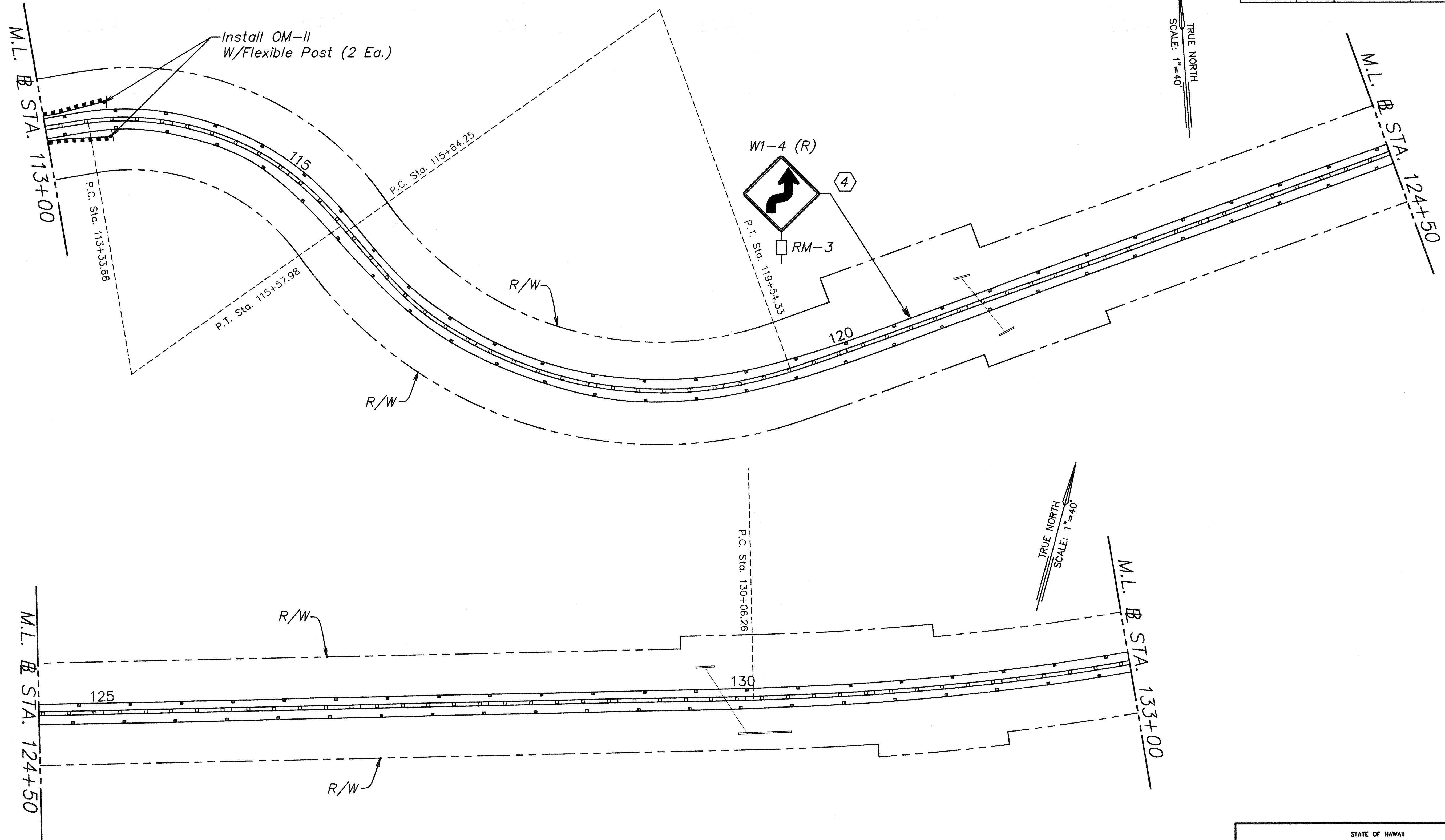

ORIGINAL PLAN
 SURVEY PLOTTED BY
 DATE
 TRACED BY
 DRAWN BY
 CHECKED BY
 MICHAEL S. YAMAGUCHI
 NO.

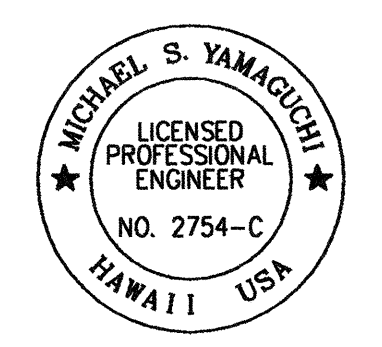

THIS WORK WAS PREPARED BY ME OR UNDER MY SUPERVISION

Michael S. Yamaguchi
FUJITA & ASSOCIATES INC.

STATE OF HAWAII
 DEPARTMENT OF TRANSPORTATION
 HIGHWAYS DIVISION
**PAVEMENT MARKING AND
 TRAFFIC SIGNING PLAN**
 KUAMOO ROAD RESURFACING
 Vicinity of U.H. Agricultural Station to
 End of Kuamoo Road
 Project No. 580A-01-99M
 Scale: 1"=40' Date: April, 2000

SHEET No. 4 OF 5 SHEETS

ckuaktp04.dwg Tue May 16, 2000 - 10:38:14

FED. ROAD DIST. NO.	STATE	PROJ. NO.	FISCAL YEAR	SHEET NO.	TOTAL SHEETS
HAWAII	HAW.	580A-01-99M	2000	24	27

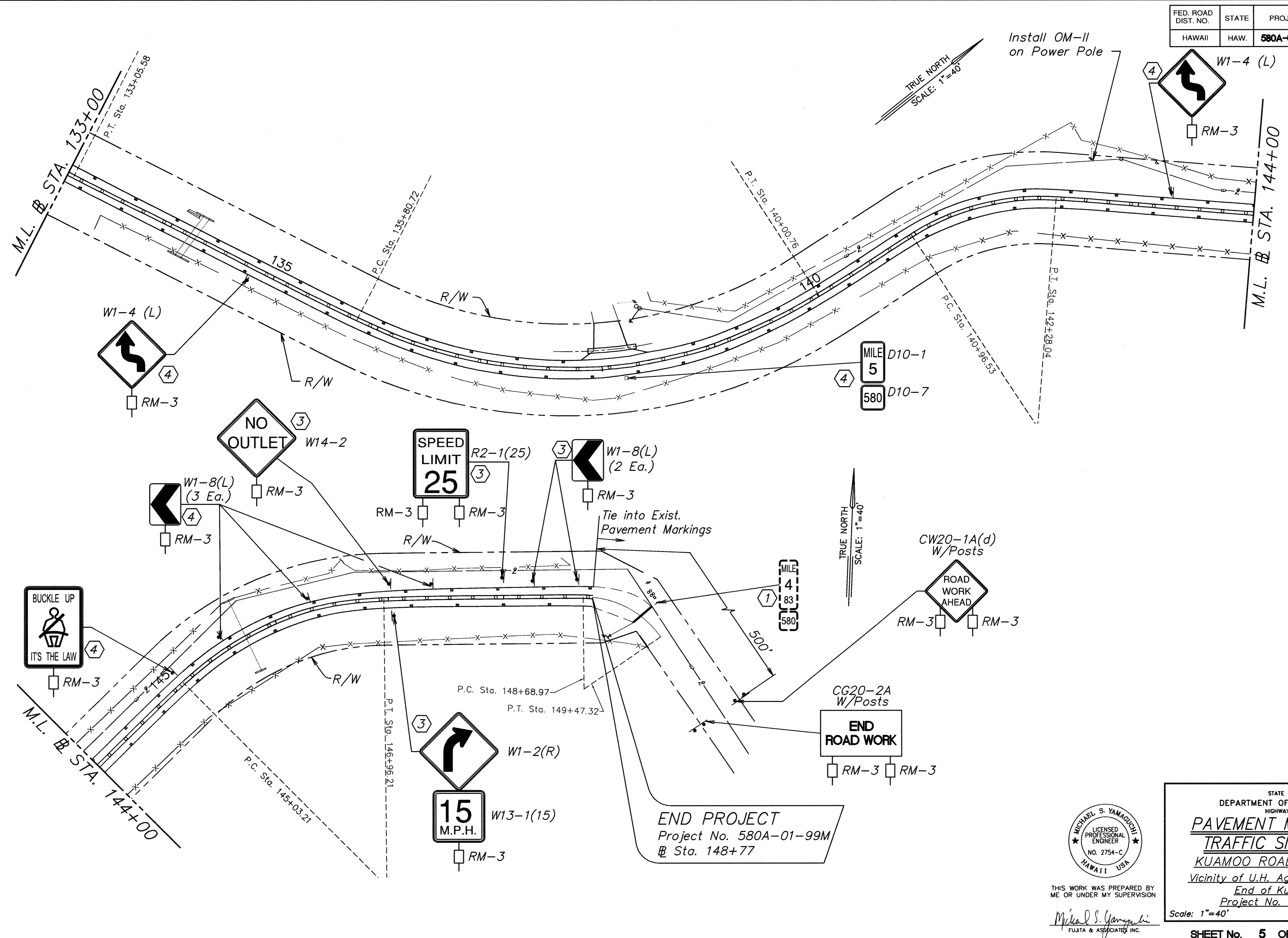

DATE	BY
DATE	BY
DATE	BY
DATE	BY
DATE	BY

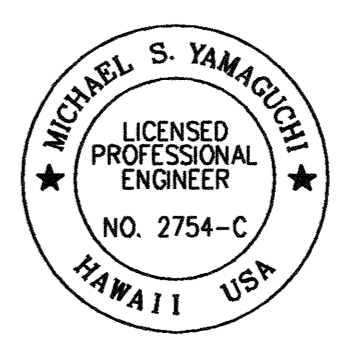

THIS WORK WAS PREPARED BY ME OR UNDER MY SUPERVISION

Michael S. Yamaguchi
FUJITA & ASSOCIATES, INC.

STATE OF HAWAII
DEPARTMENT OF TRANSPORTATION
HIGHWAYS DIVISION

PAVEMENT MARKING AND TRAFFIC SIGNING PLAN

KUAMOO ROAD RESURFACING

Vicinity of U.H. Agricultural Station to End of Kuamoo Road

Project No. 580A-01-99M

Scale: 1"=40' Date: April, 2000

08:59:32 Thu May 18, 2000 - 08:59:32