

**STATE OF HAWAII
DEPARTMENT OF TRANSPORTATION
HIGHWAYS DIVISION**

ADDENDUM NO. 1

FOR

**KUHIO HIGHWAY (ROUTE 560)
EMERGENCY SLOPE STABILIZATION
IN LUMAHAI IN THE VICINITY OF M.P. 5.1 TO 5.3
FEDERAL AID PROJECT NO. ER-16(002)**

**DISTRICT OF HANAIEI
ISLAND OF KAUAI
FY 2014**

Amend the Bid Documents as follows:

A. SPECIAL PROVISIONS

1. Replace Table of Contents dated 5/2/14 with attached Table of Contents dated r7/31/14.
2. Replace Section 103 – Award and Execution of Contract dated 3/25/08 with attached Section 103 – Award and Execution of Contract dated r5/5/14.
3. Replace Section 107 – Legal Relations and Responsibility to Public dated 7/1/08 with attached Section 107 – Legal Relations and Responsibility to Public dated r5/5/14.
4. Replace Federal Wage Rates dated 05/02/2014 with attached Federal Wage Rates dated 07/25/14.

B. PLANS

1. Remove sheets 5 and 6 and replace with attached sheets ADD.5 and ADD.6.
2. The attached Plan Sheet No. ADD.6 S-1 shall be incorporated and made part of the Plans.

C. PRE-BID MEETING

1. The attached pre-bid meeting conference summary shall be incorporated and made a part of the contract documents.

D. REQUEST FOR INFORMATION/REQUEST FOR CLARIFICATION

1. On page P-4 of the proposal, there is blank space in the last paragraph where the DBE contract Goal is to be completed by the bidder. Please clarify if this percentage is the combined value of UDBE and DBE participation or just the UDBE participation.

The amount that bidders should list is both UDBE and DBE combined. The amount of UDBE participation shall meet or exceed the project goal listed on page P-1 of the proposal.

2. On page P-9 of the proposal, Bid Item 619.1000 Tree Koaia and Bid Item 619.2000 Shrub Naupaka are listed. Please provide locations where these trees and shrubs are to be planted.

See sheet C1.1. The Naupaka bush shall be planted along the entire length of the metal guardrail. The Koaia Trees shall be planted within the limits of grading shown on sheet C2.3.

3. On page P-9 of the proposal, Bid Item 613.1000 Centerline and Reference Survey Monument is listed. Please provide locations of centerline monuments.

The new monuments are to be located in the mauka roadway shoulder (see note 2 on sheet C2.1). The exact location will be determined by the Engineer.

4. On page 657-11a of Specifications Section 657 – Soil Nail Retaining Wall, paragraph (J) references report by Ernest K. Hirata & Associates, Inc. entitled “Soils Investigation, Kuhio Highway Improvements at Lumahai and Wainiha, Lumahai, Kauai”, dated August 30, 1999. Please provide this report to bidders.

The soil nail retaining wall design was based on three borings drilled by Ernest Hirata & Associates, Inc. Approximate boring locations and boring logs are attached.

5. Is it possible to edit Section 657.02 (Soil Nail Contractor’s Experience Requirements) in order to accommodate newer ventures-provided that the drilling subcontractor’s RME/license-holder, field superintendent, and drill operator are each experienced soil nail installers?

Section 657.02 shall remain as is.

6. Does the guardrail require painting? I was under the impression that all guardrail requires painting on the North Shore.

See sheet C0.2, note 27 and sheet S4.2 of plans for painting requirements.

7. Please provide location for Field Office Trailer as listed for Proposal Item 696.2000 – “Field Office Trailer or Field Office”. There are several utility hook ups required by Specification Section 696 – “Field Office and Project Site Laboratory”, and given the remoteness from available utilities at the project site, the location of the Field Office will have a significant impact on the cost of hooking up to required utilities.

The contractor shall be responsible for determining the location for the Field Office Trailer. The total disturbed areas for the project is 0.18 acres. If the total of the disturbed area and the Contractor staging and storage area and Field Office Trailer is one acre or greater, the Contractor shall obtain the NPDES Construction Activities Permit using HDOT's latest SWPPP template.

8. Specification Section 657 – “Soil Nail Retaining Wall”, paragraph 657.02 lists qualifications that the soil nail Contractor shall conform to. Please clarify if the General Contractor, that does not have these qualifications, be able to bid on this project if the General Contractor lists a soil nailing Subcontractor that meets those qualifications.

The general contractor will be qualified to bid the project if he/she lists a soil nail subcontractor, who meets the minimum experience requirements and is approved by the State.

Please acknowledge receipt of this Addendum No. 1 by recording the date of its receipt in the space provided on page P-4 of the Proposal.



FORD N. FUCHIGAMI
Interim Director of Transportation

TABLE OF CONTENTS

Notice To Bidders

Instructions for Contractor's Licensing

Notice of Requirement for Affirmative Action to Ensure
Equal Employment Opportunity (Executive Order 11246)

Disadvantaged Business Enterprise (DBE) Requirements

Required Federal-Aid Contract Provisions

Special Provisions Title Page

Special Provisions:

DIVISION 100 - GENERAL PROVISIONS		
Section	Description	Pages
102	Bidding Requirements and Conditions	102-1a – 102-8a
103	Award And Execution of Contract	103-1a – 103-5a
104	Scope of Work	104-1a – 104-2a
105	Control of Work	105-1a – 105-3a
106	Material Restrictions and Requirements	106-1a
107	Legal Relations and Responsibility To Public	107-1a – 107-3a
108	Prosecution And Progress	108-1a – 108-2a
109	Measurement and Payment	109-1a

DIVISION 200 – EARTHWORK		
Section	Description	Pages
202	Removal of Structures and Obstructions	202-1a
203	Excavation And Embankment	203-1a
205	Excavation and Backfill for Bridge and Retaining Structures	205-1a - 205-2a
209	Temporary Water Pollution, Dust, and Erosion Control	209-1a – 209-34a
304	Aggregate Base Course	304-1a

DIVISION 400 - PAVEMENTS		
Section	Description	Pages
401	Hot Mix Asphalt Pavement	401-1a – 401-4a
415	Cold Planing of Existing Pavement	415-1a

DIVISION 500 – STRUCTURES		
Section	Description	Pages
503	Concrete Structures	503-1a – 503-7a
507	Textured and Stained Concrete Railing	507-1a – 507-2a
508	Cement Rubble Masonry	508-1a

DIVISION 600 - INCIDENTAL CONSTRUCTION		
Section	Description	Pages
601	Structural Concrete	601-1a – 601-2a
602	Reinforcing Steel	602-1a – 602-2a
603	Culverts and Storm Drains	603-1a
606	Guardrail	606-1a
612	Grouted Rubble Paving	612-1a
613	Centerline and Reference Survey Monuments	613-1a
617	Planting Soil	617-1a
619	Planting	619-1a – 619-2a
628	Shotcrete	628-1a – 628-10a
629	Pavement Markings	629-1a – 629-2a
630	Traffic Control Guide Signs	630-1a
632	Markers	632-1a
641	Hydro-Mulch Seeding	641-1a – 641-2a
645	Work Zone Traffic Control	645-1a
657	Soil Nail Retaining Wall	657-1a – 657-22a
660	Formliners	660-1a – 660-2a
663	Erosion Control Matting	663-1a – 663-3a
670	Glass Fiber Reinforced Polymer Rebar	670-1a – 670-2a
694	Project Sign	694-1a – 694-3a
695	Moveable Steel Barrier	695-1a – 695-2a
696	Field Office and Project Site Laboratory	696-1a
699	Mobilization	699-1a

DIVISION 700 – MATERIALS		
Section	Description	Pages
702	Bituminous Materials	702-1a
709	Reinforcing Steel, Wire Rope, and Prestressing Steel	709-1a
712	Miscellaneous	712.04-1a
717	Cullet And Cullet-Made Materials	717-1a – 717-2a
750	Traffic Control Sign and Marker Materials	750-1a – 750-2a
755	Pavement Marking Materials	755-1a

Requirement of Chapter 104, HRS
Wages and Hours of Employees on Public Works Law

Federal Wage Rates

Proposal Title Page

Proposal	P-1 – P-7
Proposal Schedule	P-8 - P-12
Supplement to Proposal Schedule	P-13 - P-16

Confirmation by DBE

Surety Bid Bond

Sample Forms

Contract

Performance Bond (Surety)

Performance Bond

Labor and Material Payment Bond (Surety)

Labor and Material Payment Bond

Disclosure of Lobbying Activities
Standard Form - LLL and LLL-A

Statement of Compliance
Form WH-348

DBE Participation Report & Prompt Payment Certification

Chapter 104, HRS Compliance Certificate

END OF TABLE OF CONTENTS

1 Make this section a part of the Standard Specifications:

2
3 **"SECTION 103 - AWARD AND EXECUTION OF CONTRACT**

4
5 **103.01 Consideration of Proposals.** The Department will compare the
6 proposals in terms of the summation of the products of the approximate
7 quantities and the unit bid prices after the Contracts Officer opens and reads the
8 proposals. The Department will make the results immediately available to the
9 public. If a discrepancy occurs between the unit bid price and the bid price,
10 the unit bid price shall govern.
11

12 The "Buy America" provisions in the Surface Transportation Assistance
13 Act of 1982 is applicable to Federal-aid projects. Bidders may submit a bid
14 based upon the furnishing and use of domestic steel or foreign steel. The
15 Department will award the contract to the bidder who submits the lowest total bid
16 based on furnishing domestic steel unless such total bid exceeds the lowest total
17 bid based on furnishing foreign steel by more than 25 percent. The bases for
18 the determination of foreign or domestic character of the steel are on place of
19 manufacture. Manufacturing processes for domestic steel shall occur in the
20 United States.
21

22 The Department directs the bidder to the instructions in the Proposal
23 regarding alternate bidding procedures for foreign steel.
24

25 The Department will decide the total bid for bid comparison purposes as
26 provided in the proposal. The Department will consider the bid based on
27 furnishing domestic steel the lower of the bids if a tie occurs between a bid based
28 upon furnishing foreign steel for the steel items and a bid based upon furnishing
29 domestic steel for the steel items and including the 25 percent price differential
30 allowed to bids based on furnishing domestic steel.
31

32 The Department reserves the right to reject proposals, waive
33 technicalities or advertise for new proposals, if the rejection, waiver, or new
34 advertisement favors the Department.
35

36 **103.02 Award of Contract.** The award of contract, if it be awarded, will
37 be made within 60 calendar days after the opening of bids, to the lowest
38 responsible bidder whose proposal complies with all the requirements. The
39 successful bidder will be notified by letter mailed to the address shown in its
40 proposal, that its proposal has been accepted, and that it has been awarded the
41 contract.
42

43 (1) **Requirement for Award.** To be eligible for award, the
44 apparent low bidder will be contacted to submit copies of the

documents listed below to demonstrate compliance with HRS Section 103D-310(c). The documents should be submitted to the Department as soon as possible. If a valid certificate/clearance is not submitted on a timely basis for award of a contract, a bidder otherwise responsive and responsible may not receive the award. See also Subsection 108.03 – Preconstruction Data Submittal.

(A) Tax Clearance. Pursuant to HRS Sections 103D-310(c), 103-53 and 103D-328, the successful bidder shall be required to submit a certified copy of its tax clearance issued by the Hawaii State Department of Taxation (DOTAX) and the Internal Revenue Service (IRS) to demonstrate its compliance with HRS Chapter 237. A tax clearance is valid for six (6) months from the most recent approval stamp date on the tax clearance and must be valid on the bid's first legal advertisement date or any date thereafter up to the bid opening date.

FORM A6, TAX CLEARANCE CERTIFICATE, is available at the following website:

<http://www.hawaii.gov/tax/>

To receive DOTAX Forms by fax or mail, phone (808) 587-7572 or 1-800-222-7572.

The application for the Tax Clearance Certificate is the responsibility of the bidder and must be submitted directly to the DOTAX or IRS. The approved certificate may then be submitted to the Department.

(B) DLIR Certificate of Compliance. Pursuant to HRS Section 103D-310(c), the successful bidder shall be required to submit a copy (faxed copies are acceptable) of its approved certificate of compliance issued by the Hawaii State Department of Labor and Industrial Relations (DLIR) to demonstrate its compliance with unemployment insurance (HRS Chapter 383), workers' compensation (HRS Chapter 386), temporary disability insurance (HRS Chapter 392), and prepaid health care (HRS Chapter 393). The certificate is valid for six (6) months from the most recent approval stamp date on the certificate and must be valid on the bid's first legal advertisement date or any date thereafter up to the bid opening date. For certificates which receive a "pending" approval stamp, a DLIR approval stamp is required prior to the issuance of the Notice to Proceed.

FORM LIR#27, APPLICATION FOR CERTIFICATE OF COMPLIANCE WITH SECTION 3-122-112, HAR, is available at the following website:

www.hawaii.gov/labor

94 More information is available by calling the DLIR Unemployment
95 Insurance Division at (808) 586-8926.
96

97 Inquiries regarding the status of a LIR#27 Form may be made by
98 calling the DLIR Disability Compensation Division at (808) 586-9200.
99

100 The application for the Certificate of Compliance is the
101 responsibility of the bidder and must be submitted directly to the DLIR.
102 The approved certificate may then be submitted to the Department.
103

104 **(C) DCCA Certificate of Good Standing.** Pursuant to HRS Section
105 103D-310(c), the successful bidder shall be required to submit a copy
106 (faxed copies are acceptable) of its approved Certificate of Good Standing
107 issued by the Hawaii State Department of Commerce and Consumer
108 Affairs (DCCA), Business Registration Division (BREG) to demonstrate
109 that it is either:
110

111 **(1)** Incorporated or organized under the laws of the State; or
112

113 **(2)** Registered to do business in the State as a separate branch
114 or division that is capable of fully performing under the contract.
115

116 The Certificate of Good Standing is valid for six (6) months from the
117 approval date on the certificate and must be valid on the bid's first legal
118 advertisement date or any date thereafter up to the bid opening date. A
119 Hawaii business that is a sole proprietorship, however, is not required to
120 register with the BREG, and therefore not required to submit a Certificate
121 of Good Standing. Bidders are advised that there are costs associated
122 with registering and obtaining a Certificate of Good Standing from the
123 DCCA.
124

125 To purchase a CERTIFICATE OF GOOD STANDING, go to On-
126 Line Services at the following website:
127

128 www.hawaii.gov/dcca/
129

130 The application for the Certificate of Good Standing is the
131 responsibility of the bidder and must be submitted directly to the DCCA.
132 The approved certificate may then be submitted to the Department.
133

134 **(D) Hawaii Compliance Express (HCE).** In lieu of the certificates
135 referenced above, the bidder may make available proof of compliance
136 through the Hawaii Compliance Express or any other designated
137 certification process. Bidders may apply and register at the "Hawaii
138 Compliance Express" website:
139

103.03 Cancellation of Award. The Department reserves the right to cancel the award of contracts before the execution of said contract by the parties. There will be no liability to the awardee and to other bidders.

103.04 Return of Proposal Guaranty. The Department will return the proposal guaranties, except those of the three lowest bidders, after the Department checks the proposals. The Department will return the proposal guaranties of the remaining two lowest bidders not awarded the contract within five working days following the execution of the contract. The Department will return the successful bidder's proposal guaranty after the successful bidder furnishes a bond and executes the contract.

103.05 Requirement of Contract Bond. At the time of execution of the contract, the successful bidder shall file a good and sufficient performance bond and a payment bond on the forms furnished by the Department conditioned for the full and faithful performance of the contract in accordance with the terms and intent thereof and for the prompt payment to all others for all labor and material furnished by them to the bidder and used in the prosecution of the work provided for in the contract. The bonds shall be of an amount equal to 100 percent of the amount of the contract price and include 5 percent of the contract amount estimated to be required for extra work. The bidder shall limit the acceptable performance and payment bonds to the following:

- (a) Legal tender;
- (b) Surety bond underwritten by a company licensed to issue bonds in the State of Hawaii; or
- (c) A certificate of deposit; share certificate; cashier's check; treasurer's check, teller's check drawn by or a certified check accepted by and payable on demand to the State by a bank savings institution or credit union insured by the Federal Deposit Insurance Corporation (FDIC) or the National Credit Union Administration (NCUA).

1. The bidder may use these instruments only to a maximum of \$100,000.

2. If the required security or bond amount totals over \$100,000 more than one instrument not exceeding \$100,000 each and issued by different financial institutions shall be acceptable.

184
185 Such bonds shall also by the terms inure to the benefit of any and all
186 persons entitled to file claims for labor done or material furnished in the work so
187 as to give them a right of action as contemplated by HRS Section 103D-324.
188

189 **103.06 Execution of the Contract.** The contract bond and HRS Chapter
190 104 - Compliance Certificate, similar to a copy of the same annexed hereto,
191 shall be executed by the successful bidder and returned within ten days after the
192 award of the contract or within such further time as the Director may allow after
193 the bidder has received the contract for execution.
194

195 The contract shall not bind the Department unless said parties execute the
196 contract and the Director of Finance endorses the bidder's certificate in
197 accordance with HRS Section 103-39.
198

199 **103.07 Failure to Execute Contract.** Failure to execute the contract and
200 file acceptable bonds shall be cause for the cancellation of the award in
201 accordance with Subsection 103.06 - Execution of the Contract. Also, the
202 Contractor forfeits the proposal guaranty which becomes the property of the
203 Department. This is not a penalty, but liquidated damages sustained by the
204 State. The Department may then make award to the next lowest responsible
205 bidder or the Department may readvertise and construct the work under
206 contract."
207
208
209
210
211

212 **END OF SECTION 103**
213

1 **SECTION 107 - LEGAL RELATIONS AND RESPONSIBILITY TO PUBLIC**

2
3 Make the following amendments to said Section:

4
5 **(I) Amend Section 107.01 Insurance Requirements** from lines 5 to 81 to
6 read as follows:

7
8 **“(A) Obligation of Contractor.** Contractor shall not commence any
9 work until it obtains, at its own expense, all required insurance described
10 herein. Such insurance shall be provided by an insurance company
11 authorized by the laws of the State to issue such insurance in the State of
12 Hawaii. Coverage by a “Non-Admitted” carrier is permissible provided the
13 carrier has a Best’s Rating of “A-VII” or better. The Contractor shall
14 maintain and ensure all insurance policies are current for the full period of
15 the contract until final acceptance of the work by the State.
16

17 The Certificate of Insurance shall contain: a clause that it is agreed
18 that any insurance maintained by the State of Hawaii will apply in excess
19 of, and not contribute with, insurance provided by this policy; and shall be
20 accompanied by endorsement form CG2010 or equivalent naming the
21 State as an additional insured to the policy which status shall be
22 maintained for the full period of the contract until final acceptance of the
23 work by State.
24

25 The Contractor shall obtain all required insurance as part of the
26 contract price. Where there is a requirement for the State of Hawaii and
27 its officers and employees to be named as additional insureds under any
28 Contractor’s insurance policy, before the State of Hawaii issues the Notice
29 to Proceed, the Contractor shall obtain and submit to the Engineer a
30 Certificate of Insurance and a written policy endorsement that confirms the
31 State of Hawaii and its officers and employees are additional insureds for
32 the specific State project number and project title under such insurance
33 policies. The written policy endorsement must be issued by the insurance
34 company insuring the Contractor for the specified policy type or by an
35 agent of such insurance company who is vested with the authority to issue
36 a written policy endorsement. The insurer’s agent shall also submit
37 written confirmation of such authority to bind the insurer. Any delays in
38 the issuance of the Notice to Proceed attributed to the failure to obtain the
39 proof of the State of Hawaii and its officers and employees’ additional
40 insured status shall be charged to the Contractor.
41

42 A mere Certificate of Insurance issued by a broker who represents
43 the Contractor (but not the Contractor’s insurer), or by any other party who
44 is not authorized to contractually name the State as an additional insured
45 under the Contractor’s insurance policy, is not sufficient to meet the
46 Contractor’s insurance obligations.

47
48 Certificates shall contain a provision that coverages being certified
49 will not be cancelled or materially changed without giving the Engineer at
50 least thirty (30) days prior written notice. Contractor will immediately
51 provide written notice to the Director should any of the insurance policies
52 evidenced on its Certificate of Insurance form be cancelled, reduced in
53 scope or coverage, or not renewed upon expiration. Should any policy be
54 canceled before final acceptance of the work by the State, and the
55 Contractor fails to immediately procure replacement insurance as
56 specified, the State, in addition to all other remedies it may have for such
57 breach, reserves the right to procure such insurance and deduct the cost
58 thereof from any money due or to become due to the Contractor.
59

60 Nothing contained in these insurance requirements is to be
61 construed as limiting the extent of Contractor's responsibility for payment
62 of damages resulting from its operations under this contract, including the
63 Contractor's obligation to pay liquidated damages, nor shall it affect the
64 Contractor's separate and independent duty to defend, indemnify and hold
65 the State harmless pursuant to other provisions of this contract. In no
66 instance will the State's exercise of an option to occupy and use
67 completed portions of the work relieve the Contractor of its obligation to
68 maintain the required insurance until the date of final acceptance of the
69 work.
70

71 All insurance described herein shall be primary and cover the
72 insured for all work to be performed under the contract, all work performed
73 incidental thereto or directly or indirectly connected therewith, including
74 but not limited to traffic detour work, barricades, warnings, diversions, lane
75 closures, and other work performed outside the work area and all change
76 order work.
77

78 The Contractor shall, from time to time, furnish the Engineer, when
79 requested, satisfactory proof of coverage of each type of insurance
80 required covering the work. Failure to comply with the Engineer's request
81 may result in suspension of the work, and shall be sufficient grounds to
82 withhold future payments due the Contractor and to terminate the contract
83 for Contractor's default.
84

85 **(B) Types of Insurance.** Contractor shall purchase and maintain
86 insurance described below which shall provide coverage against claims
87 arising out of the Contractor's operations under the contract, whether such
88 operations be by the Contractor itself or by any subcontractor or by
89 anyone directly or indirectly employed by any of them or by anyone for
90 whose acts any of them may be liable.
91

(1) **Workers' Compensation.** The Contractor shall obtain worker's compensation insurance for all persons whom they employ in carrying out the work under this contract. This insurance shall be in strict conformity with the requirements of the most current and applicable State of Hawaii Worker's Compensation Insurance laws in effect on the date of the execution of this contract and as modified during the duration of the contract.

(2) **Auto Liability.** The Contractor shall obtain Auto Liability Insurance covering all owned, non-owned and hired autos with a Combined single Limit of not less than \$1,000,000 per occurrence for bodily injury and property damage with the State of Hawaii named as additional insured. Refer to SPECIAL CONDITIONS for any additional requirements.

(3) **General Liability.** The Contractor shall obtain General Liability insurance with a limit of not less than \$2,000,000 per occurrence and in the Aggregates for each of the following:

- (a) Products - Completed/Operations Aggregate,
- (b) Personal & Advertising Injury, and
- (c) Bodily Injury & Property Damage

The General Liability insurance shall include the State as an Additional Insured. The required limit of insurance may be provided by a single policy or with a combination of primary and excess policies. Refer to SPECIAL CONDITIONS for any additional requirements."

END OF SECTION 107

HI1.dvb
General Decision Number: HI140001 07/25/2014 HI1

Superseded General Decision Number: HI20130001

State: Hawaii

Construction Types: Building, Heavy (Heavy and Dredging),
Highway and Residential

Counties: Hawaii Statewide.

BUILDING CONSTRUCTION PROJECTS; RESIDENTIAL CONSTRUCTION
PROJECTS (consisting of single family homes and apartments up
to and including 4 stories); HEAVY AND HIGHWAY CONSTRUCTION
PROJECTS AND DREDGING

Modification Number	Publication Date
0	01/03/2014
1	02/07/2014
2	03/14/2014
3	04/18/2014
4	05/02/2014
5	06/13/2014
6	06/27/2014
7	07/11/2014
8	07/18/2014
9	07/25/2014

ASBE0132-001 08/29/2010

	Rates	Fringes
Asbestos workers/Insulator Includes application of all insulating materials, protective coverings, coatings and finishes to all types of mechanical systems. Also the application of firestopping material for wall openings and penetrations in walls, floors, ceilings and curtain walls.....	\$ 36.65	22.24

BOIL0627-005 01/01/2013

	Rates	Fringes
BOILERMAKER.....	\$ 35.20	27.35

BRHI0001-001 09/03/2012

	Rates	Fringes
BRICKLAYER Bricklayers and Stonemasons.	\$ 35.35	22.92
Pointers, Caulkers and weatherproofers.....	\$ 35.60	22.92

BRHI0001-002 09/02/2013

	Rates	Fringes
Tile, Marble & Terrazzo Worker		
Terrazzo Base Grinders.....	\$ 35.29	23.22
Terrazzo Floor Grinders		
and Tenders.....	\$ 32.24	23.22
Tile, Marble and Terrazzo		
Workers.....	\$ 37.10	23.22

CARP0745-001 09/02/2013

	Rates	Fringes
Carpenters:		
Carpenters; Hardwood Floor		
Layers; Patent Scaffold		
Erectors (14 ft. and		
over); Piledrivers;		
Pneumatic Nailers; Wood		
Shinglers and Transit		
and/or Layout Man.....	\$ 40.75	20.42
Millwrights and Machine		
Erectors.....	\$ 41.00	20.42
Power Saw Operators (2		
h.p. and over).....	\$ 40.90	20.42

CARP0745-002 09/02/2013

	Rates	Fringes
Drywall and Acoustical		
Workers and Lathers.....	\$ 41.00	20.42

ELEC1186-001 02/23/2014

	Rates	Fringes
Electricians:		
Cable Splicers.....	\$ 46.09	27.25
Electricians.....	\$ 41.90	25.98
Telecommunication worker....	\$ 23.20	17%+6.35

ELEC1186-002 02/23/2014

	Rates	Fringes
Line Construction:		
Cable Splicers.....	\$ 46.09	27.25
Groundmen/Truck Drivers.....	\$ 31.43	22.77
Heavy Equipment Operators...	\$ 37.71	24.69
Linemen.....	\$ 41.90	25.98
Telecommunication worker....	\$ 23.20	17%+\$6.35

ELEV0126-001 01/01/2014

	Rates	Fringes
ELEVATOR MECHANIC.....	\$ 52.10	26.785

a. VACATION: Employer contributes 8% of basic hourly rate for 5 years service and 6% of basic hourly rate for 6 months to

HI1.dvb

5 years service as vacation pay credit.

b. PAID HOLIDAYS: New Year's Day, Memorial Day, Independence Day, Labor Day, Veterans' Day, Thanksgiving Day, the Friday after Thanksgiving Day and Christmas Day.

 ENGI0003-002 09/02/2013

	Rates	Fringes
Diver (Aqua Lung) (Scuba))		
Diver (Aqua Lung) (Scuba)		
(over a depth of 30 feet)...\$ 60.50		26.98
Diver (Aqua Lung) (Scuba)		
(up to a depth of 30 feet)..\$ 51.13		26.98
Stand-by Diver (Aqua Lung)		
(Scuba).....\$ 41.75		26.98
Diver (Other than Aqua Lung)		
Diver (Other than Aqua		
Lung).....\$ 60.50		26.98
Diver Tender (Other than		
Aqua Lung).....\$ 38.72		26.98
Stand-by Diver (Other than		
Aqua Lung).....\$ 41.75		26.98
Helicopter work		
Airborne Hoist Operator		
for Helicopter.....\$ 40.30		26.98
Co-Pilot of Helicopter.....\$ 40.44		26.98
Pilot of Helicopter.....\$ 40.61		26.98
Power equipment operator -		
tunnel work		
GROUP 1.....\$ 36.74		26.98
GROUP 2.....\$ 36.85		26.98
GROUP 3.....\$ 37.02		26.98
GROUP 4.....\$ 37.29		26.98
GROUP 5.....\$ 37.60		26.98
GROUP 6.....\$ 38.25		26.98
GROUP 7.....\$ 38.57		26.98
GROUP 8.....\$ 38.68		26.98
GROUP 9.....\$ 38.79		26.98
GROUP 9A.....\$ 39.02		26.98
GROUP 10.....\$ 39.08		26.98
GROUP 10A.....\$ 39.23		26.98
GROUP 11.....\$ 39.38		26.98
GROUP 12.....\$ 39.74		26.98
GROUP 12A.....\$ 40.10		26.98
Power equipment operators:		
GROUP 1.....\$ 36.44		26.98
GROUP 2.....\$ 36.55		26.98
GROUP 3.....\$ 36.72		26.98
GROUP 4.....\$ 36.99		26.98
GROUP 5.....\$ 37.30		26.98
GROUP 6.....\$ 37.95		26.98
GROUP 7.....\$ 38.27		26.98
GROUP 8.....\$ 38.38		26.98
GROUP 9.....\$ 38.49		26.98
GROUP 9A.....\$ 38.72		26.98
GROUP 10.....\$ 38.78		26.98
GROUP 10A.....\$ 38.93		26.98
GROUP 11.....\$ 39.08		26.98
GROUP 12.....\$ 39.44		26.98
GROUP 12A.....\$ 39.80		26.98

	HI1.dvb	
GROUP 13.....	\$ 36.72	26.98
GROUP 13A.....	\$ 36.99	26.98
GROUP 13B.....	\$ 37.30	26.98
GROUP 13C.....	\$ 37.95	26.98
GROUP 13D.....	\$ 38.27	26.98
GROUP 13E.....	\$ 38.38	26.98

POWER EQUIPMENT OPERATORS CLASSIFICATIONS

GROUP 1: Fork Lift (up to and including 10 tons); Partsman (heavy duty repair shop parts room when needed).

GROUP 2: Conveyor Operator (Handling building material); Hydraulic Monitor; Mixer Box Operator (Concrete Plant).

GROUP 3: Brakeman; Deckhand; Fireman; Oiler; Oiler/Gradechecker; Signalman; Switchman; Highline Cableway Signalman; Bargeman; Bunkerman; Concrete Curing Machine (self-propelled, automatically applied unit on streets, highways, airports and canals); Leveeman; Roller (5 tons and under); Tugger Hoist.

GROUP 4: Boom Truck or dual purpose "A" Frame Truck (5 tons or less); Concrete Placing Boom (Building Construction); Dinky Operator; Elevator Operator; Hoist and/or winch (one drum); Straddle Truck (Ross Carrier, Hyster and similar).

GROUP 5: Asphalt Plant Fireman; Compressors, Pumps, Generators and Welding Machines ("Bank" of 9 or more, individually or collectively); Concrete Pumps or Pumpcrete Guns; Lubrication and Service Engineer (Grease Rack); Screedman.

GROUP 6: Boom Truck or Dual Purpose "A"Frame Truck (over 5 tons); Combination Loader/Backhoe (up to and including 3/4 cu. yd.); Concrete Batch Plants (wet or dry); Concrete Cutter, Groover and/or Grinder (self-propelled unit on streets, highways, airports, and canals); Conveyor or Concrete Pump (Truck or Equipment Mounted); Drilling Machinery (not to apply to waterliners, wagon drills or jack hammers); Fork Lift (over 10 tons); Loader (up to and including 3 and 1/2 cu. yds); Lull High Lift (under 40 feet); Lubrication and Service Engineer (Mobile); Maginnis Internal Full Slab Vibrator (on airports, highways, canals and warehouses); Man or Material Hoist; Mechanical Concrete Finisher (Large Clary, Johnson Bidwell, Bridge Deck and similar); Mobile Truck Crane Driver; Portable Shotblast Concrete Cleaning Machine; Portable Boring Machine (under streets, highways, etc.); Portable Crusher; Power Jumbo Operator (setting slip forms, etc., in tunnels); Rollers (over 5 tons); Self-propelled Compactor (single engine); Self-propelled Pavement Breaker; Skidsteer Loader with attachments; Slip Form Pumps (Power driven by hydraulic, electric, air, gas, etc., lifting device for concrete forms); Small Rubber Tired Tractors; Trencher (up to and including 6 feet); Underbridge Personnel Aerial Platform (50 feet of platform or less).

GROUP 7: Crusher Plant Engineer, Dozer (D-4, Case 450, John Deere 450, and similar); Dual Drum Mixer, Extend Lift; Hoist and/or winch (2 drums); Loader (over 3 and 1/2 cu. yds. up to and including 6 yards.); Mechanical Finisher or Spreader Machine (asphalt), (Barber Greene and similar)

HI1.dvb

(Screedman required); Mine or Shaft Hoist; Mobile Concrete Mixer (over 5 tons); Pipe Bending Machine (pipelines only); Pipe Cleaning Machine (tractor propelled and supported); Pipe Wrapping Machine (tractor propelled and supported); Roller Operator (Asphalt); Self-Propelled Elevating Grade Plane; Slusher Operator; Tractor (with boom) (D-6, or similar); Trencher (over 6 feet and less than 200 h.p.); water Tanker (pulled by Euclids, T-Pulls, DW-10, 20 or 21, or similar); Winchman (Stern winch on Dredge).

GROUP 8: Asphalt Plant Operator; Barge Mate (Seagoing); Cast-in-Place Pipe Laying Machine; Concrete Batch Plant (multiple units); Conveyor Operator (tunnel); Deckmate; Dozer (D-6 and similar); Finishing Machine Operator (airports and highways); Gradesetter; Kolman Loader (and similar); Mucking Machine (Crawler-type); Mucking Machine (Conveyor-type); No-Joint Pipe Laying Machine; Portable Crushing and Screening Plant; Power Blade Operator (under 12); Saurman Type Dragline (up to and including 5 yds.); Stationary Pipe Wrapping, Cleaning and Bending Machine; Surface Heater and Planer Operator, Tractor (D-6 and similar); Tri-Batch Paver; Tunnel Badger; Tunnel Mole and/or Boring Machine Operator Underbridge Personnel Aerial Platform (over 50 feet of platform).

GROUP 9: Combination Mixer and Compressor (gunite); Do-Mor Loader and Adams Elegrader; Dozer (D-7 or equal); wheel and/or Ladder Trencher (over 6 feet and 200 to 749 h.p.).

GROUP 9A: Dozer (D-8 and similar); Gradesetter (when required by the Contractor to work from drawings, plans or specifications without the direct supervision of a foreman or superintendent); Push Cat; Scrapers (up to and including 20 cu. yds); Self-propelled Compactor with Dozer; Self-Propelled, Rubber-Tired Earthmoving Equipment (up to and including 20 cu. yds) (621 Band and similar); Sheep's Foot; Tractor (D-8 and similar); Tractors with boom (larger than D-6, and similar).

GROUP 10: Chicago Boom; Cold Planers; Heavy Duty Repairman or welder; Hoist and/or winch (3 drums); Hydraulic Skooper (Koehring and similar); Loader (over 6 cu. yds. up to and including 12 cu. yds.); Saurman type Dragline (over 5 cu. yds.); Self-propelled, rubber-tired Earthmoving Equipment (over 20 cu. yds. up to and including 31 cu. yds.) (637D and similar); Soil Stabilizer (P & H or equal); Sub-Grader (Gurries or other automatic type); Tractors (D-9 or equivalent, all attachments); Tractor (Tandem Scraper); Watch Engineer.

GROUP 10A: Boat Operator; Cable-operated Crawler Crane (up to and including 25 tons); Cable-operated Power Shovel, Clamshell, Dragline and Backhoe (up to and including 1 cu. yd.); Dozer D9-L; Dozer (D-10, HD41 and similar) (all attachments); Gradall (up to and including 1 cu. yd.); Hydraulic Backhoe (over 3/4 cu. yds. up to and including 2 cu. yds.); Mobile Truck Crane Operator (up to and including 25 tons) (Mobile Truck Crane Driver Required); Self-propelled Boom Type Lifting Device (Center Mount) (up to and including 25 tons) (Grove, Drott, P&H, Pettibone and similar); Trencher (over 6 feet and 750 h.p. or more); Watch Engineer (steam or electric).

HI1.dvb

GROUP 11: Automatic Slip Form Paver (concrete or asphalt); Band Wagon (in conjunction with Wheel Excavator); Cable-operated Crawler Cranes (over 25 tons but less than 50 tons); Cable-operated Power Shovel, Clamshell, Dragline and Backhoe (over 1 cu. yd. up to 7 cu. yds.); Gradall (over 1 cu. yds. up to 7 cu. yds.); DW-10, 20, etc. (Tandem); Earthmoving Machines (multiple propulsion power units and 2 or more Scrapers) (up to and including 35 cu. yds., "struck" m.r.c.); Highline Cableway; Hydraulic Backhoe (over 2 cu. yds. up to and including 4 cu. yds.); Leverman; Lift Slab Machine; Loader (over 12 cu. yds); Master Boat Operator; Mobile Truck Crane Operator (over 25 tons but less than 50 tons); (Mobile Truck Crane Driver required); Pre-stress Wire Wrapping Machine; Self-propelled Boom-type Lifting Device (Center Mount) (over 25 tons m.r.c.); Self-propelled Compactor (with multiple-propulsion power units); Single Engine Rubber Tired Earthmoving Machine (with Tandem Scraper); Tandem Cats; Trencher (pulling attached shield).

GROUP 12: Clamshell or Dipper Operator; Derricks; Drill Rigs; Multi-Propulsion Earthmoving Machines (2 or more Scrapers) (over 35 cu. yds "struck"m.r.c.); Operators (Derricks, Piledrivers and Cranes); Power Shovels and Draglines (7 cu. yds. m.r.c. and over); Self-propelled rubber-tired Earthmoving equipment (over 31 cu. yds.) (657B and similar); Wheel Excavator (up to and including 750 cu. yds. per hour); Wheel Excavator (over 750 cu. yds. per hour).

GROUP 12A: Dozer (D-11 or similar or larger); Hydraulic Excavators (over 4 cu. yds.); Lifting cranes (50 tons and over); Pioneering Dozer/Backhoe (initial clearing and excavation for the purpose of providing access for other equipment where the terrain worked involves 1-to-1 slopes that are 50 feet in height or depth, the scope of this work does not include normal clearing and grubbing on usual hilly terrain nor the excavation work once the access is provided); Power Blade Operator (Cat 12 or equivalent or over); Straddle Lifts (over 50 tons); Tower Crane, Mobile; Traveling Truss Cranes; Universal, Liebherr, Linden, and similar types of Tower Cranes (in the erection, dismantling, and moving of equipment there shall be an additional Operating Engineer or Heavy Duty Repairman); Yo-Yo Cat or Dozer.

GROUP 13: Truck Driver (Utility, Flatbed, etc.)

GROUP 13A: Dump Truck, 8 cu.yds. and under (water level); Water Truck (up to and including 2,000 gallons).

GROUP 13B: Water Truck (over 2,000 gallons); Tandem Dump Truck, over 8 cu. yds. (water level).

GROUP 13C: Truck Driver (Semi-trailer. Rock Cans, Semi-Dump or Roll-Offs).

GROUP 13D: Truck Driver (Slip-In or Pup).

GROUP 13E: End Dumps, Unlicensed (Euclid, Mack, Caterpillar or similar); Tractor Trailer (Hauling Equipment); Tandem Trucks hooked up to Trailer (Hauling Equipment)

BOOMS AND/OR LEADS (HOURLY PREMIUMS):

The operator of a crane (under 50 tons) with a boom of 80 feet or more (including jib), or of a crane (under 50 tons) with leads of 100 feet or more, shall receive a per hour premium for each hour worked on said crane (under 50 tons) in accordance with the following schedule:

Booms of 80 feet up to but not including 130 feet or Leads of 100 feet up to but not including 130 feet	0.50
Booms and/or Leads of 130 feet up to but not including 180 feet	0.75
Booms and/or Leads of 180 feet up to and including 250 feet	1.15
Booms and/or Leads over 250 feet	1.50

The operator of a crane (50 tons and over) with a boom of 180 feet or more (including jib) shall receive a per hour premium for each hour worked on said crane (50 tons and over) in accordance with the following schedule:

Booms of 180 feet up to and including 250 feet	1.25
Booms over 250 feet	1.75

ENGI0003-004 09/02/2013

	Rates	Fringes
Dredging: (Boat Operators)		
Boat Deckhand.....	\$ 36.72	26.98
Boat Operator.....	\$ 38.93	26.98
Master Boat Operator.....	\$ 39.08	26.98
Dredging: (Clamshell or Dipper Dredging)		
GROUP 1.....	\$ 39.44	26.98
GROUP 2.....	\$ 38.78	26.98
GROUP 3.....	\$ 38.38	26.98
GROUP 4.....	\$ 36.72	26.98
Dredging: (Derricks)		
GROUP 1.....	\$ 39.44	26.98
GROUP 2.....	\$ 38.78	26.98
GROUP 3.....	\$ 38.38	26.98
GROUP 4.....	\$ 36.72	26.98
Dredging: (Hydraulic Suction Dredges)		
GROUP 1.....	\$ 39.08	26.98
GROUP 2.....	\$ 38.93	26.98
GROUP 3.....	\$ 38.78	26.98
GROUP 4.....	\$ 38.72	26.98
GROUP 5.....	\$ 37.88	26.76
Group 5.....	\$ 38.38	26.98
GROUP 6.....	\$ 37.77	26.76
Group 6.....	\$ 38.27	26.98
GROUP 7.....	\$ 36.22	26.76
Group 7.....	\$ 36.72	26.98

CLAMSHELL OR DIPPER DREDGING CLASSIFICATIONS

GROUP 1: Clamshell or Dipper Operator.

HI1.dvb

GROUP 2: Mechanic or Welder; Watch Engineer.
 GROUP 3: Barge Mate; Deckmate.
 GROUP 4: Bargeman; Deckhand; Fireman; Oiler.

HYDRAULIC SUCTION DREDGING CLASSIFICATIONS

GROUP 1: Leverman.
 GROUP 2: Watch Engineer (steam or electric).
 GROUP 3: Mechanic or Welder.
 GROUP 4: Dozer Operator.
 GROUP 5: Deckmate.
 GROUP 6: Winchman (Stern winch on Dredge)
 GROUP 7: Deckhand (can operate anchor scow under direction of Deckmate); Fireman; Leveeman; Oiler.

DERRICK CLASSIFICATIONS

GROUP 1: Operators (Derricks, Piledrivers and Cranes).
 GROUP 2: Saurman Type Dragline (over 5 cubic yards).
 GROUP 3: Deckmate; Saurman Type Dragline (up to and including 5 yards).
 GROUP 4: Deckhand, Fireman, Oiler.

 ENGI0003-044 09/02/2013

	Rates	Fringes
Power Equipment Operators (PAVING)		
(10) Cold Planer.....	\$ 38.25	26.98
(10) Loader (2 1/2 cu. yds. and under).....	\$ 37.42	26.98
(10) Soil Stabilizer.....	\$ 38.25	26.98
(11) Loader (over 2 1/2 cu. yds. to and including 5 cu. yds.).....	\$ 37.74	26.98
(3) Roller Operator (five tons and under).....	\$ 36.19	26.98
(5) Screed Person.....	\$ 37.42	26.98
(6) Combination Loader/Backhoe (up to 3/4 cu.yd.).....	\$ 35.48	26.98
(6) Concrete Saws and/or Grinder (self-propelled unit on streets, highways, airports and canals).....	\$ 37.42	26.98
(6) Roller Operator (over five tons).....	\$ 37.62	26.98
(7) Combination Loader/Backhoe (over 3/4 cu.yd.).....	\$ 36.46	26.98
(8) Asphalt Plant Operator..	\$ 37.89	26.98
Asphalt Concrete Material Transfer.....	\$ 37.42	26.98
Asphalt Raker.....	\$ 36.46	26.98
Asphalt Spreader Operator..	\$ 37.94	26.98
Grader.....	\$ 38.25	26.98
Laborer, Hand Roller.....	\$ 35.96	26.98

 IRON0625-001 09/01/2013

Ironworkers:.....\$ 34.75 28.41
 a. Employees will be paid \$.50 per hour more while working in tunnels and coffer dams; \$1.00 per hour more when required to work under or are covered with water (submerged) and when they are required to work on the summit of Mauna Kea, Mauna Loa or Haleakala.

 LABO0368-001 09/02/2013

	Rates	Fringes
Laborers:		
Driller.....	\$ 33.30	15.96
Final Clean Up.....	\$ 23.70	11.77
Guniting Operator & High		
Scaler.....	\$ 32.80	15.96
Laborer I.....	\$ 32.30	15.96
Laborer II.....	\$ 29.70	15.96
Powderman.....	\$ 33.30	15.96
Window Washer (bosun chair).....	\$ 31.80	15.96

LABORERS CLASSIFICATIONS

Laborer I: Asbestos Removal Worker (EPA certified workers); Asphalt Laborer, Ironer, Raker, Luteman, and Handroller, and all types of Asphalt Spreader Boxes; Asphalt Shoveler; Assembly and Installation of Multiplates, Liner Plates, Rings, Mesh, Mats; Batching Plant (portable and temporary); Boring Machine Operator (under streets and sidewalks); Buggymobile; Burning, Welding, Signalling, Choke Setting, and Rigging in connection with Laborers' work (except demolition); Chainsaw, Faller, Logloader, and Bucker; Compactors (Jackson Jumping Jack and similar); Concrete Bucket Dumpman; Concrete Chipping; Concrete Chuteman/Hoseman (pouring concrete) (the handling of the chute from ready-mix trucks for such jobs as walls, slabs, decks, floors, foundations, footings, curbs, gutters, and sidewalks); Concrete Core Cutter (Walls, Floors, and Ceiling); Concrete Grinding or Sanding; Concrete: Hooking on, signaling, dumping of concrete for tremie work over water on caissons, pilings, abutments, etc.; Concrete: Mixing, handling, conveying, pouring, vibrating, otherwise placing of concrete or aggregates or by any other process; Concrete: Operation of motorized wheelbarrows or buggies or machines of similar character, whether run by gas, diesel, or electric power; Concrete Placement Machine Operator: operation of Somero Hammerhead, Copperheads, or similar machines; Concrete Pump Machine (laying, coupling, uncoupling of all connections and cleaning of equipment); Concrete and/or Asphalt Saw (walking or Handtype) (cutting walls or flatwork) (scoring old or new concrete and/or asphalt) (cutting for expansion joints) (streets and ways for laying of pipe, cable or conduit for all purposes); Concrete Shovelers/Laborers (wet or Dry); Concrete Screeding for Rough Strike-Off: Rodding or striking-off, by hand or mechanical means prior to finishing; Concrete Vibrator Operator; Coring Holes: walls, footings, piers or other obstructions for passage of pipes or conduits for any purpose and the pouring of concrete to secure the hole; Curbing (Concrete and Asphalt); Curing of Concrete (impervious membrane and form oiler) mortar and other materials by any mode or method; Cut Granite Curb Setter

(setting, leveling and grouting of all precast concrete or stone curbs); Cutting and Burning Torch (demolition); Dri Pak-It Machine; Falling, bucking, yarding, loading or burning of all trees or timber on construction site; Forklift (9 ft. and under); Grating and Grill work for drains or other purposes; Green Cutter of concrete or aggregate in any form, by hand, mechanical means, grindstone or air and/or water; Grout: Spreading for any purpose; Guinea Chaser (Grade Checker) for general utility trenches, sitework, and excavation; Headerboard Man (Asphalt or Concrete); Heat Welder of Plastic (Laborers' AGC certified workers) (when work involves waterproofing for waterponds, artificial lakes and reservoir, or heat welding for sewer pipes); Heavy Highway Laborer (Rigging, signaling, handling, and installation of pre-cast catch basins, manholes, curbs and gutters); High Pressure Nozzleman - Hydraulic Monitor (over 100# pressure); Installation of lightweight backfill; Jackhammer Operator; Jacking of slip forms: All semi and unskilled work connected therewith; Laying of all multi-cell conduit or multi-purpose pipe; Lead base paint abatement laborers (EPA certified workers); Magnesite and Mastic Workers (Wet or Dry)(including mixer operator); Mason Tender, Mortar Man; Mortar Mixer (Block, Brick, Masonry, and Plastering); Nozzleman (Sandblasting and/or Water Blasting): handling, placing and operation of nozzle; Operation, Manual or Hydraulic jacking of shields and the use of such other mechanical equipment as may be necessary; Pavement Breakers; Paving, curbing and surfacing of streets, ways, courts, under and overpasses, bridges, approaches, slope walls, and all other labor connected therewith; Pilecutters; Pipe Assessment in place, bolting and lining up of sectional metal or other pipe including corrugated pipe; Pipelayer performing all services in the laying and installation of pipe from the point of receiving pipe in the ditch until completion of operation, including any and all forms of tubular material, whether pipe, metallic or non-metallic, conduit, and any other stationary-type of tubular device used for conveying of any substance or element, whether water, sewage, solid, gas, air, or other product whatsoever and without regard to the nature of material from which tubular material is fabricated; No-joint pipe and stripping of same, Pipewrapper, Caulker, Bander, Kettlemen, and men applying asphalt, Laykold, treating Creosote and similar-type materials (6-inch) pipe and over); Piping: resurfacing and paving of all ditches in preparation for laying of all pipes; Pipe laying of lateral sewer pipe from main or side sewer to buildings or structure (except Contactor may direct work be done under proper supervision); Pipe laying, leveling and marking of the joint used for main or side sewers and storm sewers; Laying of all clay, terra cotta, ironstone, vitrified concrete or other pipe for drainage; Placing and setting of water mains, gas mains and all pipe including removal of skids; Plaster Mortar Mixer/Pump; Pneumatic Impact wrench; Portable Sawmill Operation: Choker setters, off bearers, and lumber handlers connected with clearing; Posthole Digger (Hand Held, Gas, Air and Electric); Power Broom Sweepers (Small); Preparation and Compaction of roadbeds for railroad track laying, highway construction, and the preparation of trenches, footings, etc., for cross-country transmission by pipelines, electrical transmission or underground lines or cables (by mechanical means); Raising

HI1.dvb

of structure by manual or hydraulic jacks or other methods and resetting of structure in new locations, including all concrete work; Ramming or compaction; Riprap, Stonepaver, and Rock Slinger (includes placement of stacked concrete, wet or dry and loading, unloading, signaling, slinging and setting of other similar materials); Rotary Scarifier (including multiple head concrete chipping Scarifier); Salamander Heater, Drying of plaster, concrete mortar or other aggregate; Scaffold Erector Leadman; Scaffolds: (Swing and hanging) including maintenance thereof; Scaler; Septic Tank/Cesspool and Drain Fields Digger and Installer; Shredder/Chipper (tree branches, brush, etc.); Stripping and Setting Forms; Stripping of Forms: Other than panel forms which are to be re-used in their original form, and stripping of forms on all flat arch work; Tampers (Barko, Wacker, and similar type); Tank Scaler and Cleaners; Tarman; Tree Climbers and Trimmers; Trencher (includes hand-held, Davis T-66 and similar type); Trucks (flatbed up to and including 2 1/2 tons when used in connection with on-site Laborers' work; Trucks (Refuse and Garbage Disposal) (from job site to dump); Vibra-Screed (Bull Float in connection with Laborers' work); Well Points, Installation of or any other dewatering system.

Laborer II: Air Blasting; Appliance Handling (job site) (after delivery and unloading in storage area); Asphalt Plant Laborer; Backfilling, Grading and all other labor connected therewith; Boring Machine; Bridge Laborer; Burning of all debris (crates, boxes, packaging waste materials); Chainman, Rodmen, and Grade Markers; Cleaning and Clearing of all debris; Cleaning, clearing, grading and/or removal for streets, highways, roadways, aprons, runways, sidewalks, parking areas, airports, approaches, and other similar installations; Cleaning or reconditioning of streets, ways, sewers and waterlines, all maintenance work and work of an unskilled and semi-skilled nature; Cleanup of Grounds and Buildings (other than "Light Clean-Up") (Janitorial Laborer); Clean-up of right-of-way; Clearing and slashing of brush or trees by hand or mechanical cutting; Concrete Bucket Tender (Groundman) hooking and unhooking of bucket; Concrete Forms; moving, cleaning, oiling and carrying to the next point of erection of all forms; Concrete Products Plant Laborers; Conveyor Tender (conveying of building materials); Cribbers, Shorer, Lagging, Sheeting, and Trench Jacking and Bracing, Hand-Guided Lagging Hammer Whaling Bracing; Crushed Stone Yards and Gravel and Sand Pit Laborers and all other similar plants; Demolition, wrecking and Salvage Laborers: Wrecking and dismantling of buildings and all structures, with use of cutting or wrecking tools, burning or cutting, breaking away, cleaning and removal of all masonry, wood or metal fixtures for salvage or scrap, All hooking, unhooking, signaling of materials for salvage or scrap removed by crane or derrick; Digging under streets, roadways, aprons or other paved surfaces; Chuck Tender, Outside Nipper; Dry-packing of concrete (plugging and filling of she-bolt holes); Excavation, Preparation of street ways and bridges; Fence and/or Guardrail Erector: Dismantling and/or re-installation of all fence; Finegrader; Firewatcher; Flagman (Coning, preparing, establishing and removing portable roadway barricade devices); Signal Men on all construction work defined herein, including Traffic Control Signal Men at

construction site; Garbage and Debris Handlers and Cleaners; Gas, Pneumatic, and Electric Tools, not listed Group 1 (except Rototiller); General Clean-up: sweeping, cleaning, washdown, wiping of construction facility, and equipment (other than "Light Clean-up" [Janitorial] Laborer); General Excavation and Grading (all labor connected therewith); Digging of trenches, ditches and manholes and the leveling, grading and other preparation prior to laying pipe or conduit for any purpose; Excavations and foundations for buildings, piers, foundations and holes, and all other construction; General Laborer; Ground and Soil Treatment Work (Pest Control); Junk Yard Laborers (same as Salvage Yard); Landscape Nursery Laborers; Laser Beam "Target Man" in connection with Laborers' work; Layout Person for Plastic (when work involves waterproofing for waterpools, artificial lakes and reservoirs); Limbers, Brush Loaders, and Pilers; Loading, Unloading, carrying, distributing and handling of all rods and material for use in reinforcing concrete construction (except when a derrick or outrigger operated by other than hand power is used); Loading, unloading, sorting, stockpiling, handling and distribution of water mains, gas mains and all pipes; Loading and unloading of all materials, fixtures, furnishings and appliances from point of delivery to stockpile to point of installation; hooking and signalling from truck, conveyance or stockpile; Material Yard Laborers; Pipelayer Tender; Pipewrapper, Caulker, Bander, Kettlemen, and men applying asphalt, Laykold, Creosote, and similar-type materials (pipe under 6 inches); Plasterer Laborer (including Hod Carrier); Preparation, construction and maintenance of roadbeds and sub-grade for all paving, including excavation, dumping, and spreading of sub-grade material; Prestressed or precast concrete slabs, walls, or sections: all loading, unloading, stockpiling, hooking on of such slabs, walls or sections; Quarry Laborers; Railroad, Streetcar, and Rail Transit Maintenance and Repair; Removal of surplus material; Roustabout; Rubbish Trucks in connection with Building Construction Projects (excluding clearing, grubbing, and excavating); Salvage Yard: All work connected with cutting, cleaning, storing, stockpiling or handling of materials, all cleanup, removal of debris, burning, back-filling and landscaping of the site; Sandblasting (Pot Tender): Hoses and pots or markers; Scaffolds: Erection, planking and removal of all scaffolds used for support for lathers, plasters, brick layers, masons, and other construction trades crafts; Scaffolds: (Specially designed by carpenters) laborers shall tend said carpenter on erection and dismantling thereof, preparation for foundation or mudsills, maintenance; Scraping of floors; Screeds: Handling of all screeds to be reused; handling, dismantling and conveyance of screeds; Setting, leveling and securing or bracing of metal or other road forms and expansion joints; Sheeting Piling/trench shoring (handling and placing of skip sheet or wood plank trench shoring); Ship Scalers; Sign Erector (subdivision traffic, regulatory, and street-name signs); Sloper; Slurry Seal Crews (Mixer Operator, Applicator, Squeegee Man, Shuttle Man, Top Man); Snapping of wall ties and removal of tie rods; Soil Test operations of semi and unskilled labor such as filling sand bags; Striper (Asphalt, Concrete or other Paved Surfaces); Tagging and signaling of all building materials into high-rise units; Tool Room Attendant (Job Site); Traffic

HI1.dvb

Delineating Device Applicator; Underpinning, lagging, bracing, propping and shoring, loading, signaling, right-of-way clearance along the route of movement, The clearance of new site, excavation of foundation when moving a house or structure from old site to new site; Utilities employees; Water Man; Waterscape/Hardscape Laborers; Wire Mesh Pulling (all concrete pouring operations); wrecking, stripping, dismantling and handling concrete forms an false work.

LAB00368-002 09/02/2013

	Rates	Fringes
Landscape & Irrigation Laborers		
GROUP 1.....	\$ 22.65	9.51
GROUP 2.....	\$ 23.15	9.51
GROUP 3.....	\$ 19.15	9.51

LABORERS CLASSIFICATIONS

GROUP 1: Installation of non-potable permanent or temporary irrigation water systems performed for the purposes of Landscaping and Irrigation architectural horticultural work; the installation of drinking fountains and permanent or temporary irrigation systems using potable water for Landscaping and Irrigation architectural horticultural purposes only. This work includes (a) the installation of all heads, risers, valves, valve boxes, vacuum breakers (pressure and non-pressure), low voltage electrical lines and, provided such work involves electrical wiring that will carry 24 volts or less, the installation of sensors, master control panels, display boards, junction boxes, conductors, including all other components for controllers, (b) and metallic (copper, brass, galvanized, or similar) pipe, as well as PVC or other plastic pipe including all work incidental thereto, i.e., unloading, handling and distribution of all pipes fittings, tools, materials and equipment, (c) all soldering work in connection with the above whether done by torch, soldering iron, or other means; (d) tie-in to main lines, thrust blocks (both precast and poured in place), pipe hangers and supports incidental to installation of the entire irrigation system, (e) making of pressure tests, start-up testing, flushing, purging, water balancing, placing into operation all irrigation equipment, fixtures and appurtenances installed under this agreement, and (f) the fabrication, replacement, repair and servicing of landscaping and irrigation systems. Operation of hand-held gas, air, electric, or self-powered tools and equipment used in the performance of Landscape and Irrigation work in connection with architectural horticulture; Choke-setting, signaling, and rigging for equipment operators on job-site in the performance of such Landscaping and Irrigation work; Concrete work (wet or dry) performed in connection with such Landscaping and Irrigation work. This work shall also include the setting of rock, stone, or riprap in connection with such Landscape, Waterscape, Rockscape, and Irrigation work; Grubbing, pick and shovel excavation, and hand rolling or tamping in connection with the performance of such Landscaping and Irrigation work; Sprigging, handseeding,

HI1.dvb

and planting of trees, shrubs, ground covers, and other plantings and the performance of all types of gardening and horticultural work relating to said planting; Operation of flat bed trucks (up to and including 2 1/2 tons)..:

GROUP 2. Layout of irrigation and other non-potable irrigation water systems and the layout of drinking fountains and other potable irrigation water systems in connection with such Landscaping and Irrigation work. This includes the layout of all heads, risers, valves, valve boxes, vacuum breakers, low voltage electrical lines, hydraulic and electrical controllers, and metallic (coppers, brass, galvanized, or similar) pipe, as well as PVC or other plastic pipe. This work also includes the reading and interpretation of plans and specifications in connection with the layout of Landscaping, Rockscape, Waterscape, and Irrigation work; Operation of Hydro-Mulching machines (sprayman and driver), Drillers, Trenchers (riding type, Davis T-66, and similar) and fork lifts used in connection with the performance of such Landscaping and Irrigation work; Tree climbers and chain saw tree trimmers, Sporadic operation (when used in connection with Landscaping, Rockscape, Waterscape, and Irrigation work) of Skid-Steer Loaders (Bobcat and similar), Cranes (Bantam, Grove, and similar), Hoptos, Backhoes, Loaders, Rollers, and Dozers (Case, John Deere, and similar), Water Trucks, Trucks requiring a State of Hawaii Public Utilities Commission Type 5 and/or type 7 license, sit-down type and "gang" mowers, and other self-propelled, sit-down operated machines not listed under Landscape & Irrigation Maintenance Laborer; Chemical spraying using self-propelled power spraying equipment (200 gallon capacity or more).

GROUP 3: Maintenance of trees, shrubs, ground covers, lawns and other planted areas, including the replanting of trees, shrubs, ground covers, and other plantings that did not "take" or which are damaged; provided, however, that re-planting that requires the use of equipment, machinery, or power tools shall be paid for at the rate of pay specified under Landscape and Irrigation Laborer, Group 1; Raking, mowing, trimming, and runing, including the use of "weed eaters", hedge trimmers, vacuums, blowers, and other hand-held gas, air, electric, or self-powered tools, and the operation of lawn mowers (Note: The operation of sit-down type and "gang" mowers shall be paid for at the rate of pay specified under Landscape & Irrigation Laborer, Group 2); Guywiring, staking, propping, and supporting trees; Fertilizing, Chemical spraying using spray equipment with less than 200 gallon capacity, Maintaining irrigation and sprinkler systems, including the staking, clamping, and adjustment of risers, and the adjustment and/or replacement of sprinkler heads, (Note: the cleaning and gluing of pipe and fittings shall be paid for at the rate of pay specified under Landscape & Irrigation Laborer(Group 1); watering by hand or sprinkler system and the performance of other types of gardening, yardman, and horticultural-related work.

LAB00368-003 09/02/2013

Rates

Fringes

HI1.dvb

Underground Laborer

GROUP 1.....	\$ 32.90	15.96
GROUP 2.....	\$ 34.40	15.96
GROUP 3.....	\$ 34.90	15.96
GROUP 4.....	\$ 35.90	15.96
GROUP 5.....	\$ 36.25	15.96
GROUP 6.....	\$ 36.50	15.96
GROUP 7.....	\$ 36.95	15.96

GROUP 1: Watchmen; Change House Attendant.

GROUP 2: Swamper; Brakeman; Bull Gang-Muckers, Trackmen; Dumpmen (any method); Concrete Crew (includes rodding and spreading); Grout Crew; Reboundmen

GROUP 3: Chucktenders and Cabletenders; Powderman (Prime House); Vibratorman, Pavement Breakers

GROUP 4: Miners - Tunnel (including top and bottom man on shaft and raise work); Timberman, Retimberman (wood or steel or substitute materials thereof); Blasters, Drillers, Powderman (in heading); Microtunnel Laborer; Headman; Cherry Picker (where car is lifted); Nipper; Grout Gunmen; Grout Pumpman & Potman; Gunite, Shotcrete Gunmen & Potmen; Concrete Finisher (in tunnel); Concrete Screed Man; Bit Grinder; Steel Form Raisers & Setters; High Pressure Nozzleman; Nozzleman (on slick line); Sandblaster-Potman (combination work assignment interchangeable); Tugger

GROUP 5: Shaft work & Raise (below actual or excavated ground level); Diamond Driller; Gunite or Shotcrete Nozzleman; Rodman; Groundman

GROUP 6: Shifter

GROUP 7: Shifter (Shaft work & Raiser)

PAIN1791-001 07/01/2014

	Rates	Fringes
Painters:		
Brush.....	\$ 34.35	26.20
Sandblaster; Spray.....	\$ 34.35	26.20

PAIN1889-001 07/01/2013

	Rates	Fringes
Glaziers.....	\$ 33.65	26.08

PAIN1926-001 02/24/2013

	Rates	Fringes
Soft Floor Layers.....	\$ 29.14	22.91

PAIN1944-001 01/01/2014

	Rates	Fringes
Taper.....	\$ 40.00	20.45

PLAS0630-001 09/03/2012

	Rates	Fringes
PLASTERER.....	\$ 36.14	22.92

PLAS0630-002 09/03/2012

	Rates	Fringes
Cement Masons:		
Cement Masons.....	\$ 35.30	22.72
Trowel Machine Operators....	\$ 35.45	22.72

* PLUM0675-001 07/06/2014

	Rates	Fringes
Plumber, Pipefitter, Steamfitter & Sprinkler Fitter...	\$ 38.85	24.11

ROOF0221-001 09/01/2013

	Rates	Fringes
Roofers (Including Built Up, Composition and Single Ply).....	\$ 37.10	16.88

SHEE0293-001 09/01/2013

	Rates	Fringes
Sheet metal worker.....	\$ 37.25	22.73

SUHI1997-002 09/15/1997

	Rates	Fringes
Drapery Installer.....	\$ 13.60	1.20
FENCE ERECTOR (Chain Link Fence).....	\$ 9.33	1.65

WELDERS - Receive rate prescribed for craft performing
operation to which welding is incidental.
=====

Unlisted classifications needed for work not included within
the scope of the classifications listed may be added after
award only as provided in the labor standards contract clauses
(29CFR 5.5 (a) (1) (ii)).

The body of each wage determination lists the classification
and wage rates that have been found to be prevailing for the
cited type(s) of construction in the area covered by the wage

determination. The classifications are listed in alphabetical order of "identifiers" that indicate whether the particular rate is union or non-union.

Union Identifiers

An identifier enclosed in dotted lines beginning with characters other than "SU" denotes that the union classification and rate have found to be prevailing for that classification. Example: PLUM0198-005 07/01/2011. The first four letters, PLUM, indicate the international union and the four-digit number, 0198, that follows indicates the local union number or district council number where applicable, i.e., Plumbers Local 0198. The next number, 005 in the example, is an internal number used in processing the wage determination. The date, 07/01/2011, following these characters is the effective date of the most current negotiated rate/collective bargaining agreement which would be July 1, 2011 in the above example.

Union prevailing wage rates will be updated to reflect any changes in the collective bargaining agreements governing the rates.

0000/9999: weighted union wage rates will be published annually each January.

Non-Union Identifiers

Classifications listed under an "SU" identifier were derived from survey data by computing average rates and are not union rates; however, the data used in computing these rates may include both union and non-union data. Example: SULA2004-007 5/13/2010. SU indicates the rates are not union majority rates, LA indicates the State of Louisiana; 2004 is the year of the survey; and 007 is an internal number used in producing the wage determination. A 1993 or later date, 5/13/2010, indicates the classifications and rates under that identifier were issued as a General Wage Determination on that date.

Survey wage rates will remain in effect and will not change until a new survey is conducted.

WAGE DETERMINATION APPEALS PROCESS

1.) Has there been an initial decision in the matter? This can be:

- * an existing published wage determination
- * a survey underlying a wage determination
- * a wage and Hour Division letter setting forth a position on a wage determination matter
- * a conformance (additional classification and rate) ruling

On survey related matters, initial contact, including requests for summaries of surveys, should be with the Wage and Hour Regional Office for the area in which the survey was conducted

HI1.dvb

because those Regional Offices have responsibility for the Davis-Bacon survey program. If the response from this initial contact is not satisfactory, then the process described in 2.) and 3.) should be followed.

With regard to any other matter not yet ripe for the formal process described here, initial contact should be with the Branch of Construction Wage Determinations. Write to:

Branch of Construction Wage Determinations
Wage and Hour Division
U.S. Department of Labor
200 Constitution Avenue, N.W.
Washington, DC 20210

2.) If the answer to the question in 1.) is yes, then an interested party (those affected by the action) can request review and reconsideration from the Wage and Hour Administrator (See 29 CFR Part 1.8 and 29 CFR Part 7). Write to:

Wage and Hour Administrator
U.S. Department of Labor
200 Constitution Avenue, N.W.
Washington, DC 20210

The request should be accompanied by a full statement of the interested party's position and by any information (wage payment data, project description, area practice material, etc.) that the requestor considers relevant to the issue.

3.) If the decision of the Administrator is not favorable, an interested party may appeal directly to the Administrative Review Board (formerly the Wage Appeals Board). Write to:

Administrative Review Board
U.S. Department of Labor
200 Constitution Avenue, N.W.
Washington, DC 20210

4.) All decisions by the Administrative Review Board are final.

=====

END OF GENERAL DECISION

MINUTES OF PRE-BID CONFERENCE

PROJECT: Kuhio Highway (Route 560)
Emergency Slope Stabilization
In Lumahai In the Vicinity of M.P. 5.1 to 5.3

**FEDERAL-AID
PROJECT NO.:** ER-16(002)

LOCATION: 1720 Haleukana Street
Lihue, Kauai, Hawaii

DATE & TIME: July 28, 2014 at 9:00 a.m.

IN ATTENDANCE: See attached Attendance List

The meeting started at 9:00 a.m.

The pre-bid meeting was opened with a brief description of the project by the Hawaii Department of Transportation (HDOT) staff.

The following items were discussed.

1. Bid Opening Date is August 14, 2014. Bids will be received at either the Contracts Office, Department of Transportation, 869 Punchbowl Street, Honolulu or Office of the District Engineer – Kauai, 1720 Haleukana Street, Lihue.
2. HDOT has not determined a Notice to Proceed date as of yet, but it will be issued in accordance with Federal Guidelines.

The following questions were asked at the pre-bid conference.

1. Can the staging area from the previous Lumahai Projects be used?

The contractor shall verify owner of property and negotiate any permits required to use land as staging area. The total disturbed areas for the project is 0.18 acres. If the total of the disturbed area and the Contractor staging and storage area and Field Office Trailer is one acre or greater, the Contractor shall obtain the NPDES Construction Activities Permit using HDOT's latest SWPPP template.

2. Is night work allowed?

Nighttime construction will be allowed between January and August. Also no clearing, grubbing, or trimming of woody plants greater than 15 ft shall be

allowed during the Hawaiian Hoary Bat pup-rearing season (June 1 to September 15).

3. Can road be contra-flowed continuously?

No. Two lanes of travel must be maintained during non-working hours.

4. What items require demolition?

Demolition work includes concrete spillway, CRM wall, GRP, portions of segmental retaining wall, portions of vertical soil nails

5. Does demolition of existing structures need to be done in any particular sequence?

No.

6. Is the existing concrete segmental retaining wall reinforced?

The existing concrete segment retaining wall is a Keystone wall, reinforced by geogrid.

7. Are the soil nails required to drill through existing steel plates?

There are existing soil nails installed in the steel plate area that are to remain and no additional soil nails are required within the steel plate areas.

8. Are there utilities in the area?

There are two utility poles that need to be considered. As far as we can determine, it is phone and cable and not electrical.

9. What permits will be required?

There are no specific environmental permits or clearances that we are aware of that are required beyond those already obtained for the project. The Contractor shall be responsible to obtain a Permit to Perform Work Upon State Highways from HDOT Highways, Kauai District Office prior to the start of construction. Certificate of Liability Insurance, and copy of the project's performance bond shall be required to be submitted at time of permit issuance.

10. What is required for UDBE at bid opening?

See specifications for Disadvantaged Business Enterprise Requirements.

11. What is required for overweight vehicle on weight-posted bridge?

Contractor shall apply for an oversize/overweight/vehicle load permit for each affected vehicle

12. Are there details for the 2 reference monuments to be installed in the mauka shoulder?

See Hawaii Department of Transportation Standard Plans for details. Location of monuments shall be determined by the HDOT.

The meeting concluded at 9:45 a.m.

End of Pre-Bid Conference Summary

The minutes of the meeting will be distributed in Addendum No. 1. Contractors will be notified when the Addendum will be available for pick-up.

PRE-BID CONFERENCE ATTENDANCE LIST

FEDERAL-AID PROJECT : EB-16(002), KUHIO HIGHWAY (ROUTE 560) EMERGENCY SLOPE STABILIZATION IN LUMAHAI, IN THE VICINITY OF M.P. 5.1 TO M.P. 5.3

DATE: JUNE 28, 2014

TIME: 9:00 AM

LOCATION: 1720 HALEUKANA STREET, LIHUE, KAUAI, HAWAII 96766

CALLED BY: FRED REYES

PLEASE PRINT

PARTICIPANT	COMPANY / ORGANIZATION	ADDRESS (Including City and Zip Code)	EMAIL (Print legibly)	PHONE/FAX NUMBERS
1 BERNIE VARGAS	HDOF - KAUAI	1720 HALEUKANA ST. LIHUE, KAUAI 96766	BERNIE.P.VARGAS@HAWAII.GOV	(808) 241-8018 (808) 241-3011
PIERRE ROUSSEAU	IBC		PIERRE.ROUSSEAU@HOTMAIL.COM	808-590-9644
3 Rod Uemura	Kiewit	1001 Kamehaha St. Ste 205	rod.ueamura@kiewit.com	(808) 671-1254 (808) 671-1255
4 Russ Miyahara	KSF, Inc.	814 Piikoi St Ste 300, Honolulu	russm@ksf,inc.us	(808) 593-0933 (808) 593-9331
5 John Chen	Geolabs	2006 Kalih St., Honolulu	johnc@geolabs.net	(808) 841-5064 (808) 847-1749
6 Stephen Peters	KSF, Inc	814 Piikoi St. Ste 300, Honolulu	stephenp@ksf,inc.us	(808) 695-6227
7 Xochi Rose	Kauai Drilling & Shoring	4247 Kapua Rd, Lihue	xochi@kauaiDrillingandShoring.com	808-212-6662 4758
8 Jason Rose	Kauai Drilling & Shoring	4247 Kapua RD, Lihue	Jason@KauaiDrillingandShoring.com	361 632 4424
9 Spencer Ingraham	Aues Limited Const	921 Prospect St. B Honolulu 96822	spencer@olakine rockfall.com	949-244-3705
10 Fred Reyes	HDOF - Kauai	1720 Haleukana St. Lihue	fred.reyes@hawaii.gov	241-3011
11 Cliff Tillotson	Prometheul	1024 Queen St. Honolulu	cliff+gov@aol.com	808 869-0428
12 David Smith	HDOF	"		

FED. ROAD DIST. NO.	STATE	FEDERAL AID PROJ. NO.	FISCAL YEAR	SHEET NO.	TOTAL SHEETS
HAWAII	HAW.	ER-16(002)	2013		

BEGIN PROJECT
Project No. ER-16(002)
STA. 55+00
N 922.90
E 68.40

END PROJECT
Project No. ER-16(002)
STA. 60+47.49
N 1049.41
E 592.68

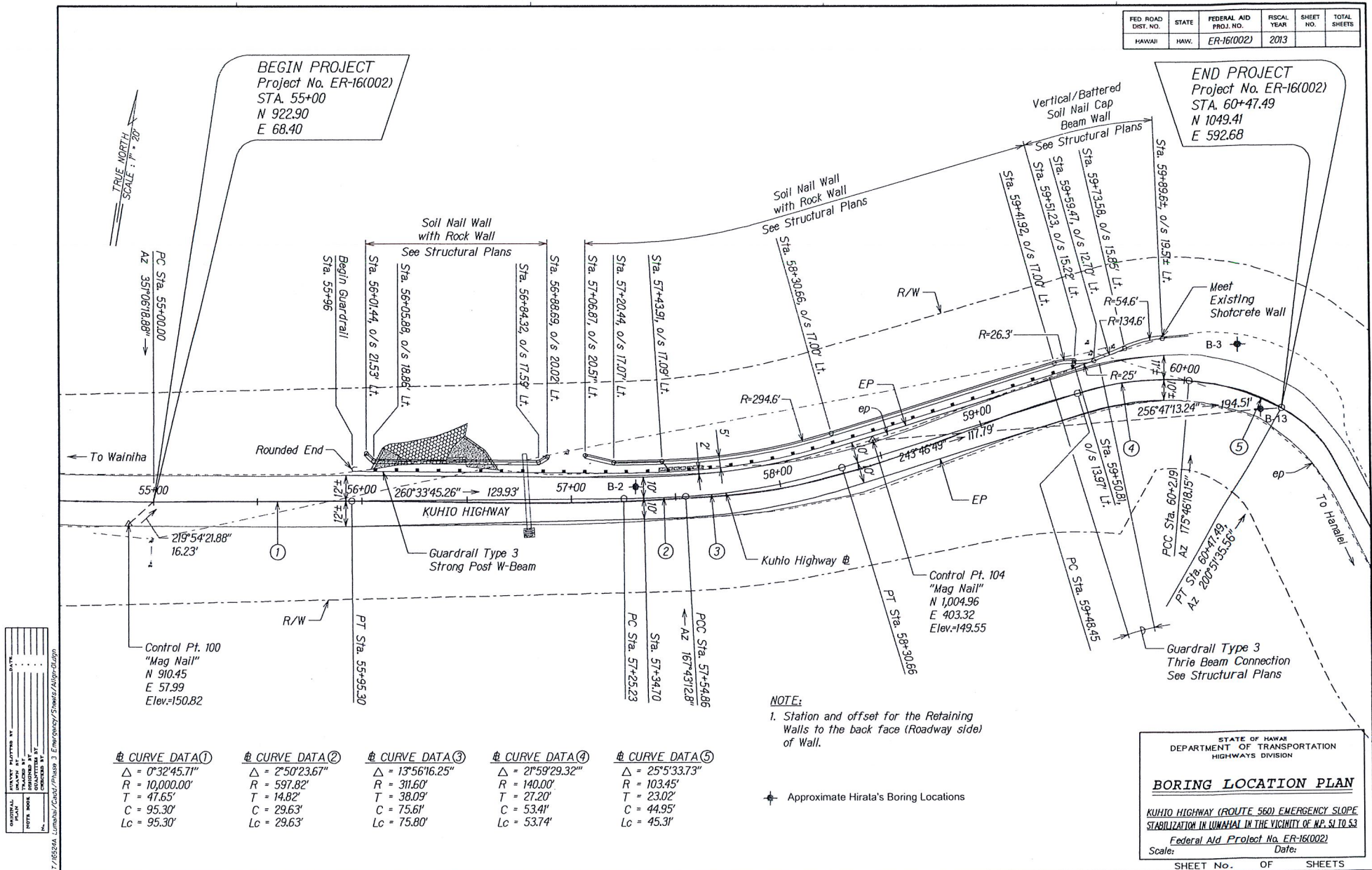

HIRATA & ASSOCIATES, INC.

BORING LOG

W.O. 04-3977

BORING NO. B2 DRIVING WT. 140 lb. START DATE 9/9/04
 SURFACE ELEV. 148.5± DROP 30 in. END DATE 9/10/04

DEPTH	GRAPH	SAMPLE	BLOWS PER FOOT	DRY DENSITY (PCF)	MOIST. CONT. (%)	DESCRIPTION
0						
5						
10						
15						
20						
25						
30						

Clayey SILT (MH) - Mottled gray and reddish brown, moist, medium stiff to stiff. (Completely Weathered Rock/Saprolite)
 Covered by 4 inches of asphaltic concrete over 2 inches of base material.
 Grinding from 0.5 to 1.5 feet.

HIGHLY TO COMPLETELY WEATHERED ROCK (WH-WC) - Mottled grayish brown, moist, stiff. (Sandy Silt with weathered rock fragments.)

Highly weathered at 23 feet.

HIGHLY WEATHERED ROCK (WH) - Mottled brown, dense to medium hard.

Plate A4.3

HIRATA & ASSOCIATES, INC.

BORING LOG

W.O. 04-3977

BORING NO. B2 (continued) DRIVING WT. 140 lb. START DATE 9/9/04
 SURFACE ELEV. 148.5± DROP 30 in. END DATE 9/10/04

DEPTH	GRAPH	SAMPLE	BLOWS PER FOOT	DRY DENSITY (PCF)	MOIST. CONT. (%)	DESCRIPTION
30						
35			76/6"	113	13	BASALT (WM) - Mottled gray, medium hard to hard, moderately weathered.
			10/No Penetration			
40						End boring at 38 feet.
45						
50						
55						
60						

ERNEST K. HIRATA & ASSOCIATES, INC.

Geotechnical Engineering

BORING FROM PREVIOUS STUDY

BORING LOG

W.O. 98-3060

BORING NO. B3 DRIVING WT. 140 lb. DATE OF DRILLING 10/6/98
 SURFACE ELEV. 150± DROP 30 in. WATER LEVEL None

DEPTH	GRAPH	SAMPLE	BLOWS PER FOOT	DRY DENSITY (PCF)	MOIST. CONT. (%)	DESCRIPTION
0						WEATHERED ROCK (WC) - Mottled dark brown, moist, medium stiff, completely weathered. (Clayey silt with weathered rock fragments) Covered by 8 inches of asphaltic concrete.
			10	58	30	
5			17	64	35	
10			20	56	55	Mottled reddish brown color at 9 feet.
15			36	62	51	Stiff from 14 feet.
20			39	71	52	
25			52	72	48	Highly to completely weathered from 24 feet.
30			48	70	57	

Plate A5.5

ERNEST K. HIRATA & ASSOCIATES, INC.

Geotechnical Engineering

BORING FROM PREVIOUS STUDY

BORING LOG

W.O. 98-3060

BORING NO. B3 (continued) DRIVING WT. 140 lb. DATE OF DRILLING 10/6/98
 SURFACE ELEV. 150± DROP 30 in. WATER LEVEL None

DEPTH	GRAPH	SAMPLE	BLOWS PER FOOT	DRY DENSITY (PCF)	MOIST. CONT. (%)	DESCRIPTION
30						
35			54	80	23	
40			46	65	56	
45			42	59	59	
50			44	63	59	
						End boring at 50.5 feet.
55						
60						

ERNEST K. HIRATA & ASSOCIATES, INC.

Geotechnical Engineering

BORING FROM PREVIOUS STUDY

BORING LOG

W.O. 98-3060

BORING NO. B13 DRIVING WT. 140 lb. DATE OF DRILLING 10/9/98
SURFACE ELEV. 149± DROP 30 in. WATER LEVEL None

DEPTH	GRAPH	SAMPLE	BLOWS PER FOOT	DRY DENSITY (PCF)	MOIST. CONT. (%)	DESCRIPTION
0						WEATHERED ROCK (WC) - Mottled reddish brown, moist, medium stiff, completely weathered. (Clayey silt with weathered rock fragments)
			18	59	65	
			25	61	61	
5			17	64	54	
10			9	63	63	Highly weathered at 14 feet.
15			50	72	50	End boring at 15.5 feet.
20						
25						
30						