

FED. ROAD DIST. NO.	STATE	PROJ. NO.	FISCAL YEAR	SHEET NO.	TOTAL SHEETS
HAWAII	HAW.	560A-03-96	2009	10	27

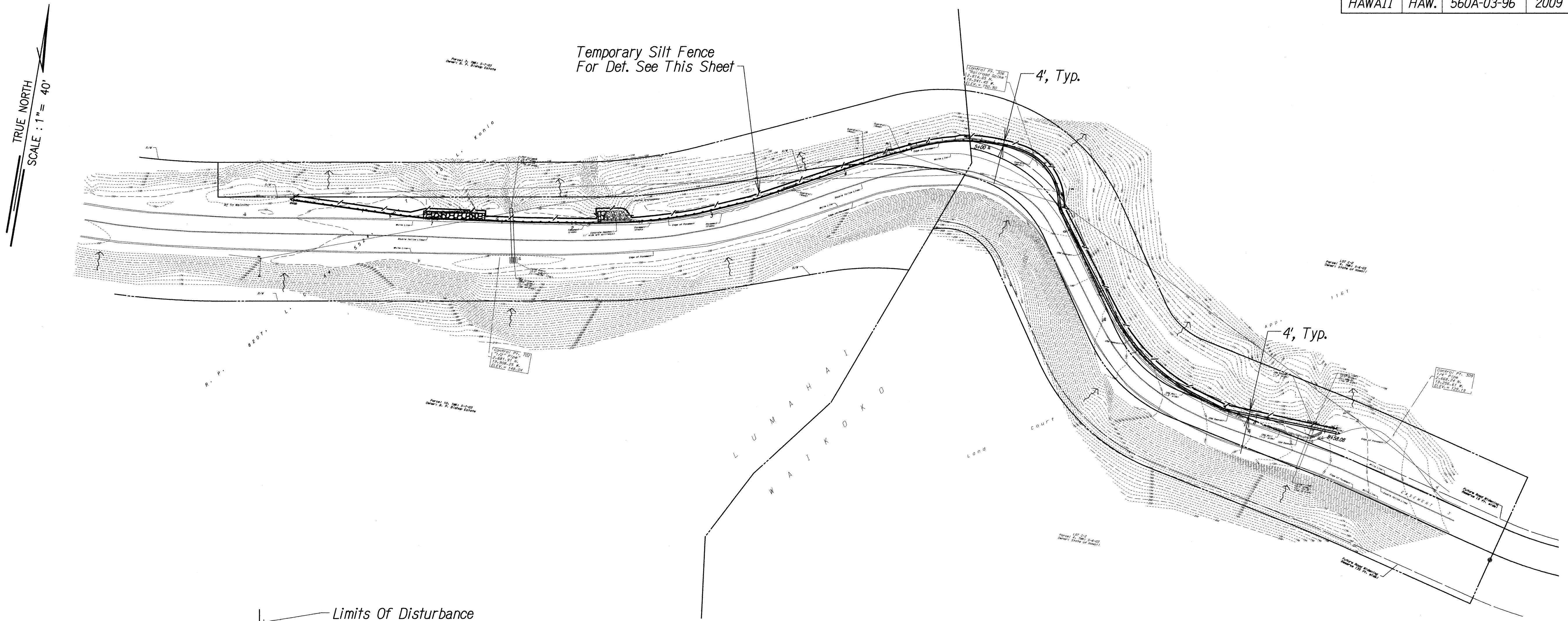

# **BEST MANAGEMENT PRACTICES PLAN** Scale: 1" = 40'

Note: Contents shown on this Plan Sheet are general in nature and may be subject to modifications acceptable to the State. Contractor shall follow all requirements set forth in Section 209 of the "Hawaii Standard Specifications for Road and Bridge Construction, 2005" and its amendments.

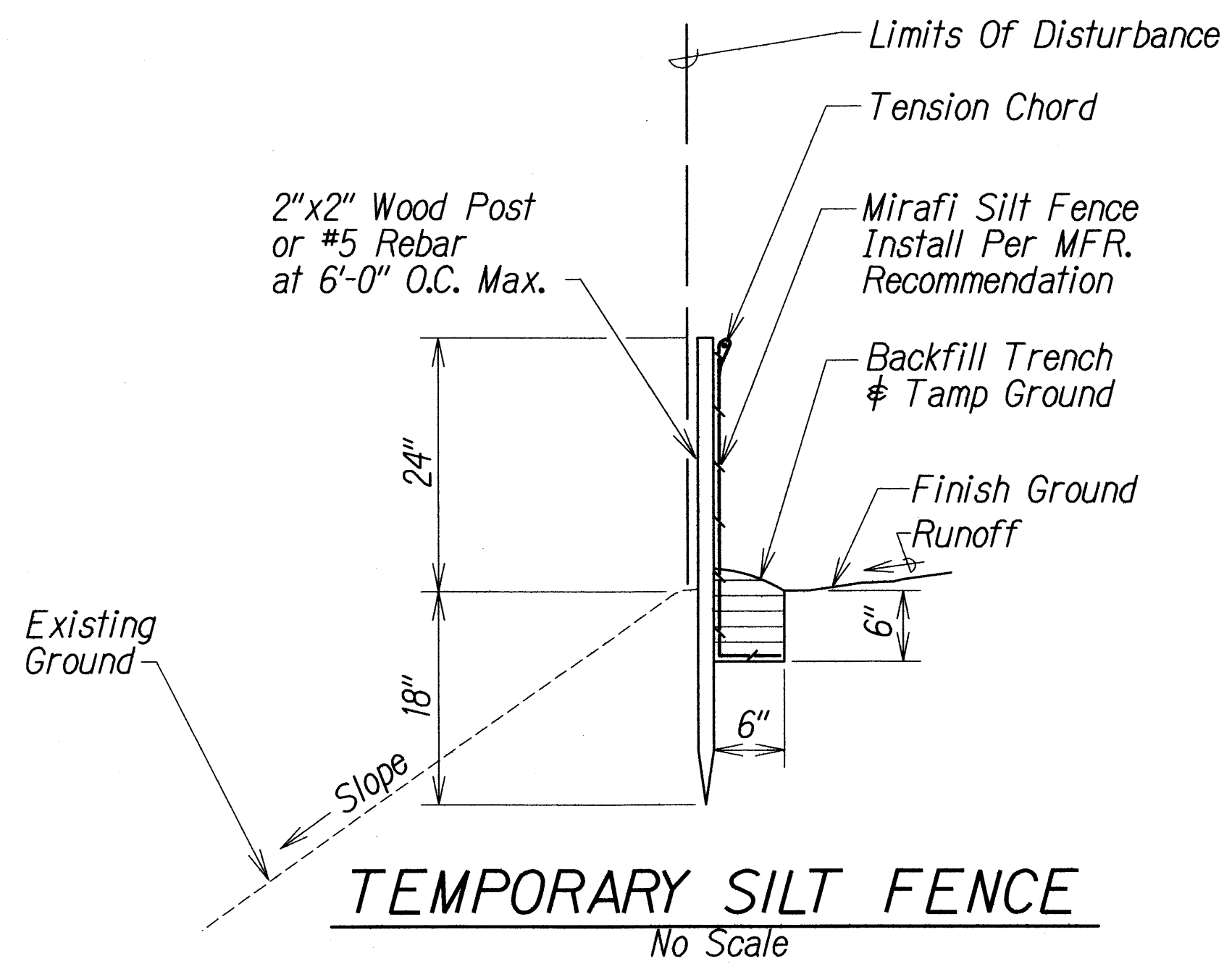

- LEGEND :**
- Right-of-Way
  - 190- Existing Contour
  - /-/- Temporary Silt Fence
  - ~ Surface Flow Direction

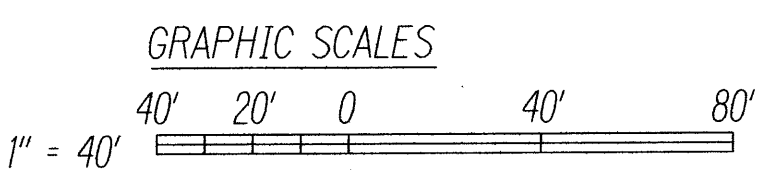

CRAIG S. ARAKAKI  
LICENSED PROFESSIONAL ENGINEER  
No. 5510-C  
HAWAII, U.S.A.  
LICENSE EXP. DATE 04-30-10  
THIS WORK WAS PREPARED BY ME OR UNDER MY SUPERVISION AND CONSTRUCTION OF THIS PROJECT WILL BE UNDER MY OBSERVATION AS DEFINED IN H.A.R. TITLE 16, CHAPTER 115, RULES OF THE BOARD OF PROFESSIONAL ENGINEERS, ARCHITECTS AND SURVEYORS, STATE OF HAWAII.  
*Craig S. Arakaki*

STATE OF HAWAII  
DEPARTMENT OF TRANSPORTATION  
HIGHWAYS DIVISION

**BEST MANAGEMENT PRACTICES**  
**PLAN & DETAILS**  
**KUHIO HIGHWAY**  
**Retaining Walls At Lumahai And Wainiha**  
**Project No. 560A-03-96**  
Scale: As Shown      Date: August 2009  
SHEET No. 1 OF 1 SHEETS

ORIGINAL PLAN	SURVEY PLOTTED BY	DATE
NOTE BOOK	DRAWN BY	
QUANTITIES BY	TRACED BY	
CHECKED BY	DESIGNED BY	
	NOTED BY	