

FED. ROAD DIST. NO.	STATE	PROJ. NO.	FISCAL YEAR	SHEET NO.	TOTAL SHEETS
HAWAII	HAW.	550AB-01-06	2009	7	34

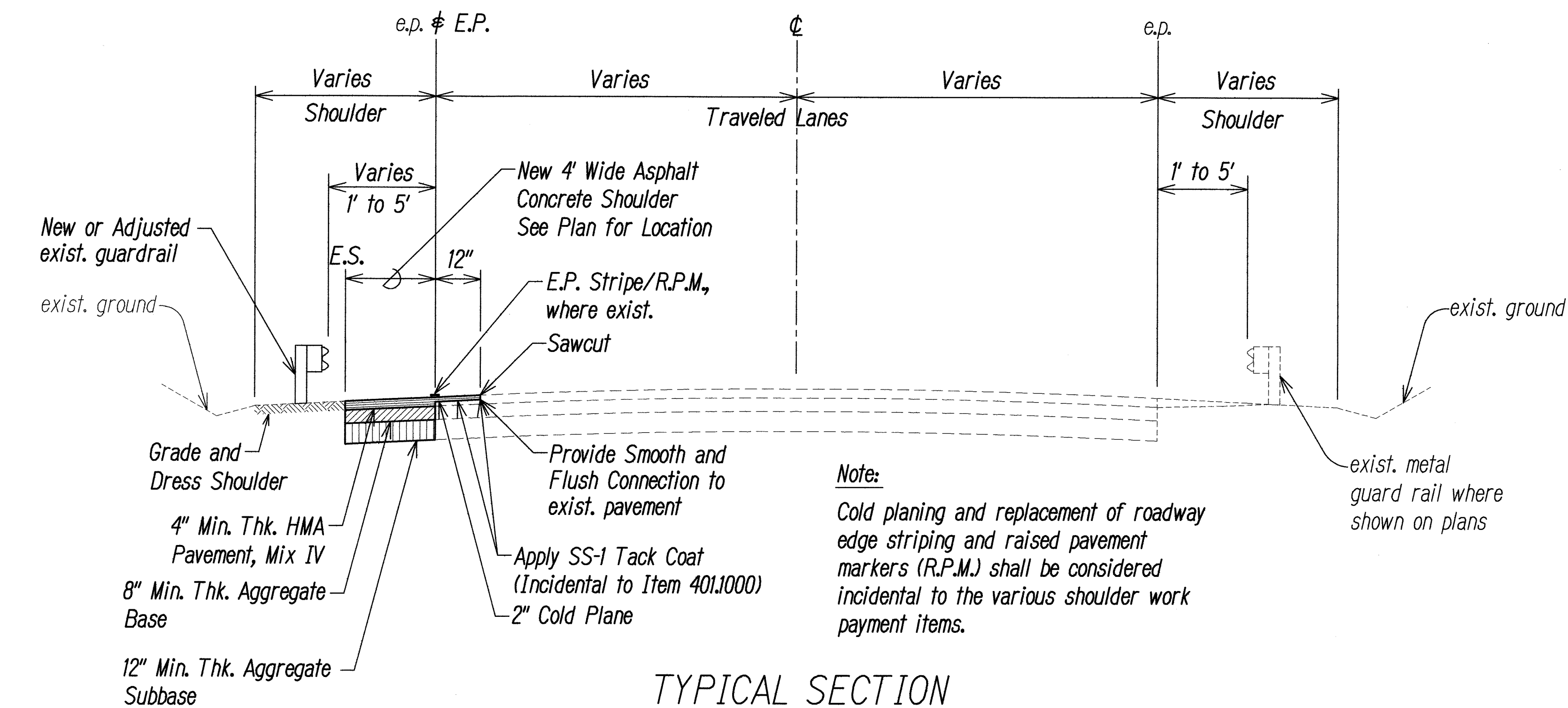

TYPICAL SECTION
Not to Scale

Notes:

1. Typical layout will vary based on speed and manufacturer of system used. Installation shall conform to Manufacturer's recommendations.
2. Physical barriers shall be required whenever guardrails have been removed and will not be reinstalled at the end of the work day. See General Note No. 31 on Plan Sht. No. 4.
3. Physical barriers shall be portable concrete barriers.
4. Providing, transporting, placing, maintaining, relocating and removing portable concrete barriers shall be considered incidental to the various items of work. See Section 645, WORK ZONE TRAFFIC CONTROL of the Contract Documents.

5. Ends of portable concrete barriers shall be protected with Inertial Barriers as shown hereon. The lead (first) inertial barrier shall have a retroreflective object marker attached to it. Furnishing and installing inertial barriers including retroreflective object markers, shall be considered incidental to the various contract items.
6. Furnishing and installing reflector markers (RM-3) over the portable barriers shall be considered incidental to the various contract items.

TABLE A SHY LINE OFFSETS*	
DESIGN SPEED (mph)	SHY LINE OFFSETS
30	3.5'
≤ 25	2.0'

TABLE B MAXIMUM TAPERS FOR CONCRETE BARRIER*		
DESIGN SPEED (mph)	TAPER	
	INSIDE SHY LINE	BEYOND SHY LINE
35	15:1	9:1
≤ 30	13:1	8:1

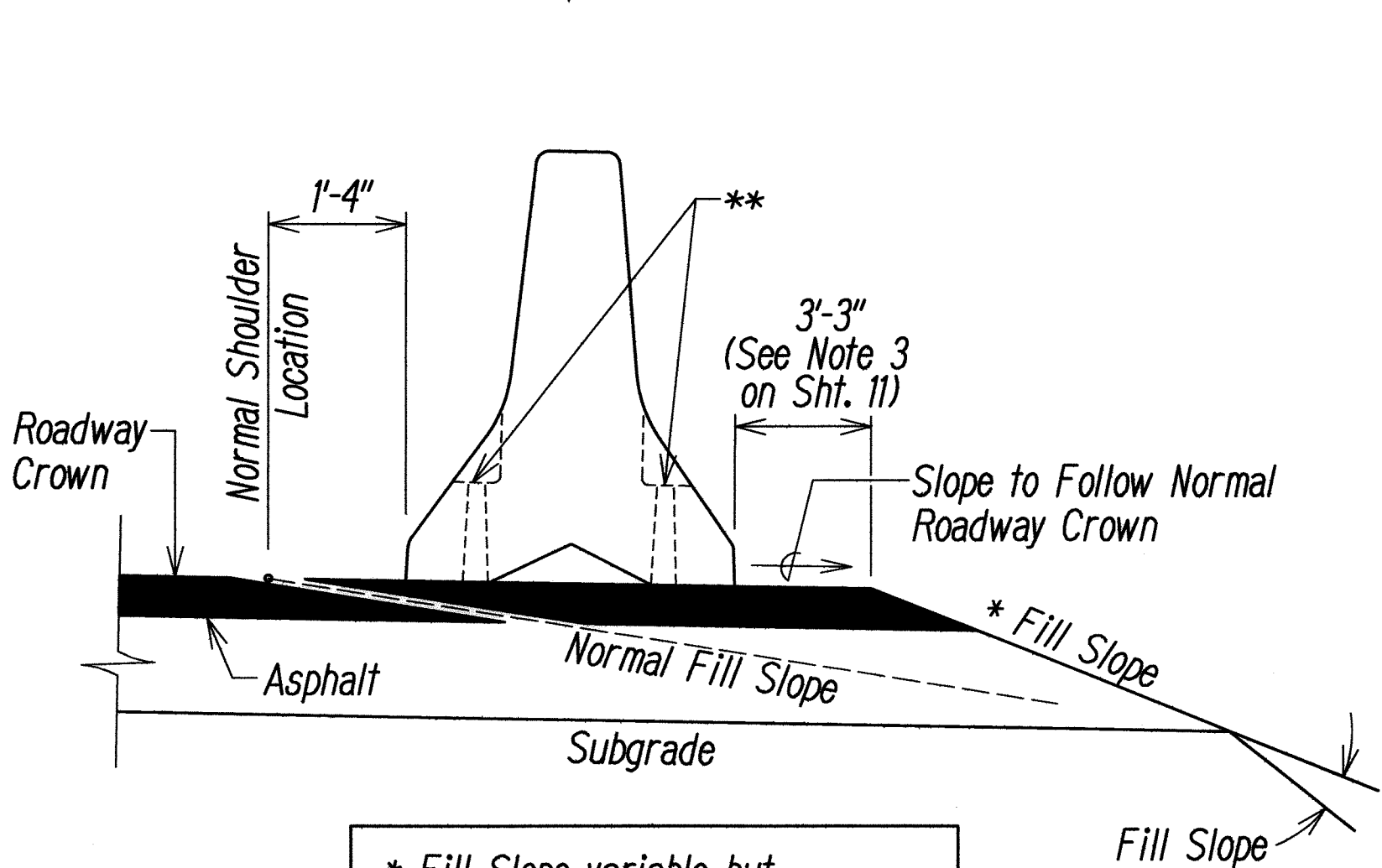
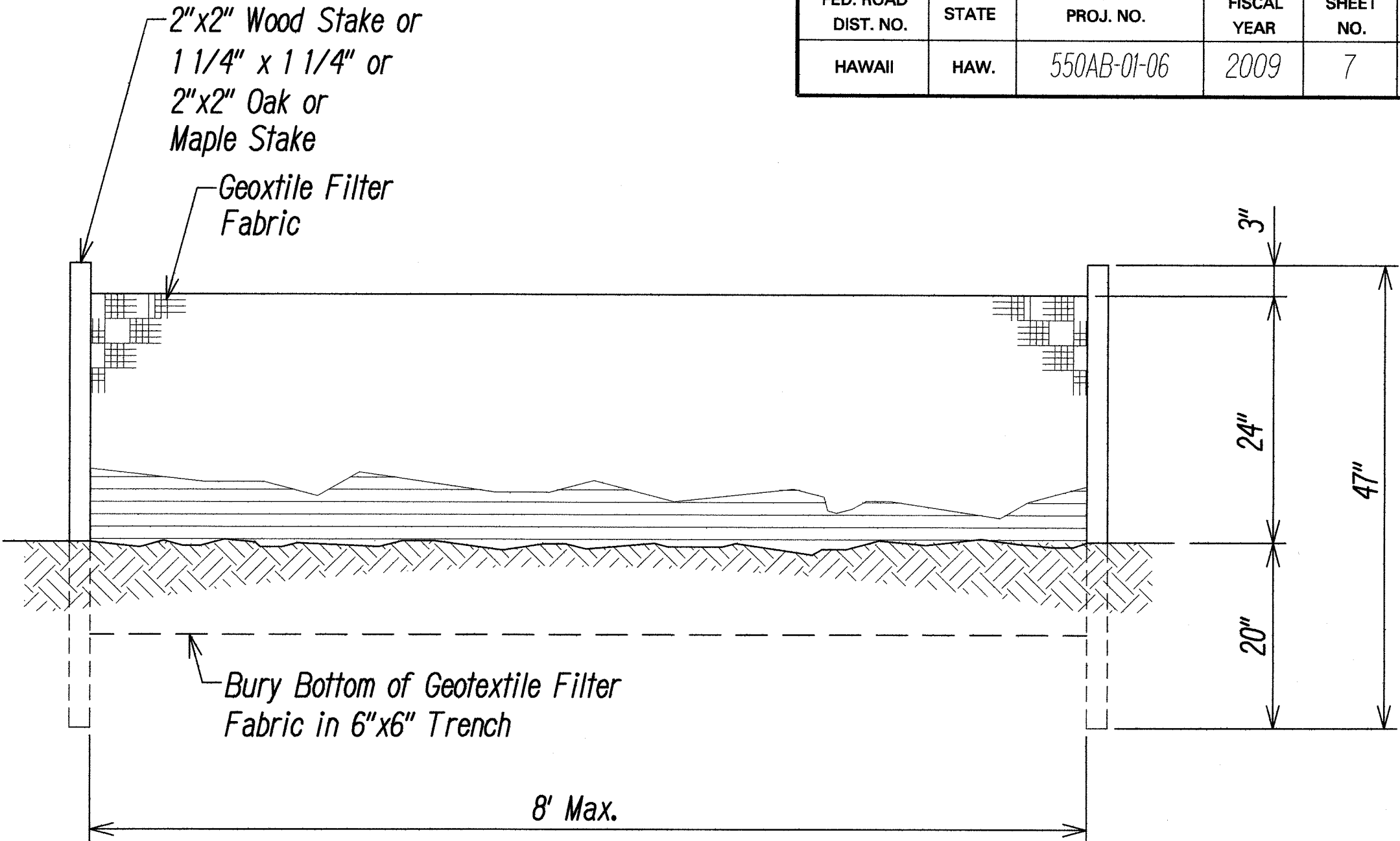

STANDARD INSTALLATION
(See Note No. 1)

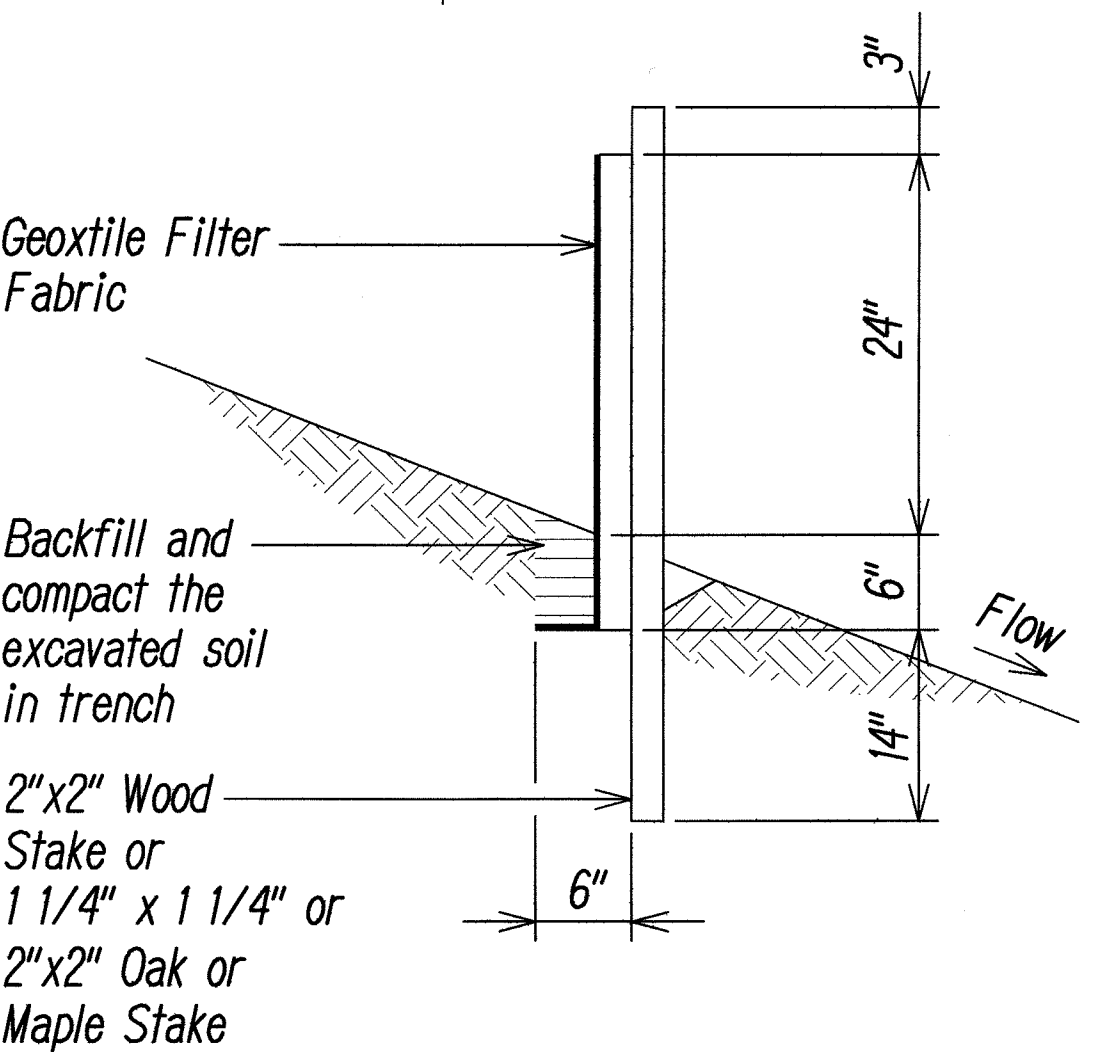

SILT FENCE DETAIL
Not to Scale

Note:

All BMP's shall conform to the Construction BMP Field Manual of State of Hawaii Department of Transportation Highways Division.

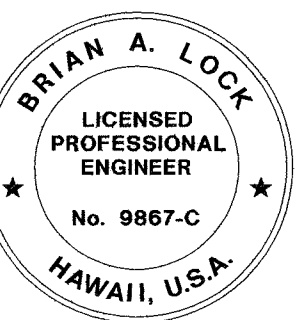

THIS WORK WAS PREPARED BY ME OR UNDER MY SUPERVISION.
APRIL 30, 2010
WILSON OKAMOTO CORPORATION LIC. EXP. DATE

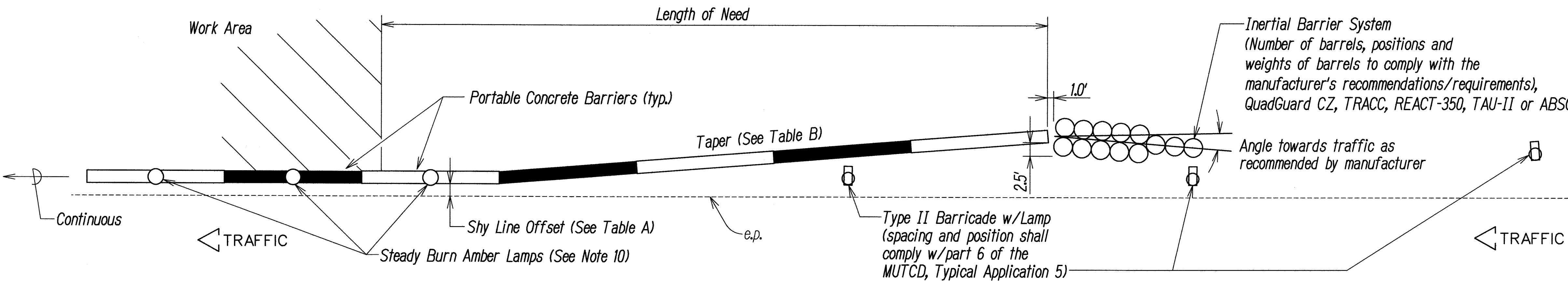

TYPICAL DETAIL - PORTABLE CONCRETE BARRIER END TREATMENT
Not to Scale

STATE OF HAWAII
DEPARTMENT OF TRANSPORTATION
HIGHWAYS DIVISION
**TYPICAL ROADWAY SECTIONS
AND DETAILS**
WAIMEA CANYON DRIVE/KOKEE ROAD
IMPROVEMENTS PHASE 1
MILE POST 0.80 TO MILE POST 4.60
Proj. No. 550AB-01-06
Scale: Not to Scale Date: October 2008
SHEET No. 1 OF 1 SHEETS

DATE	_____
SURVEY PLANNED BY	_____
DRAWN BY	_____
NOTED BY	_____
CHECKED BY	_____
ORIGINAL PLAN	_____
NOTE BOOK	_____
SHEET NO.	_____

FED. ROAD DIST. NO.	STATE	FED. AID PROJ. NO.	FISCAL YEAR	SHEET NO.	TOTAL SHEETS
HAWAII	HAW.	550AB-01-06	2011	C.O. 7 S-1	34

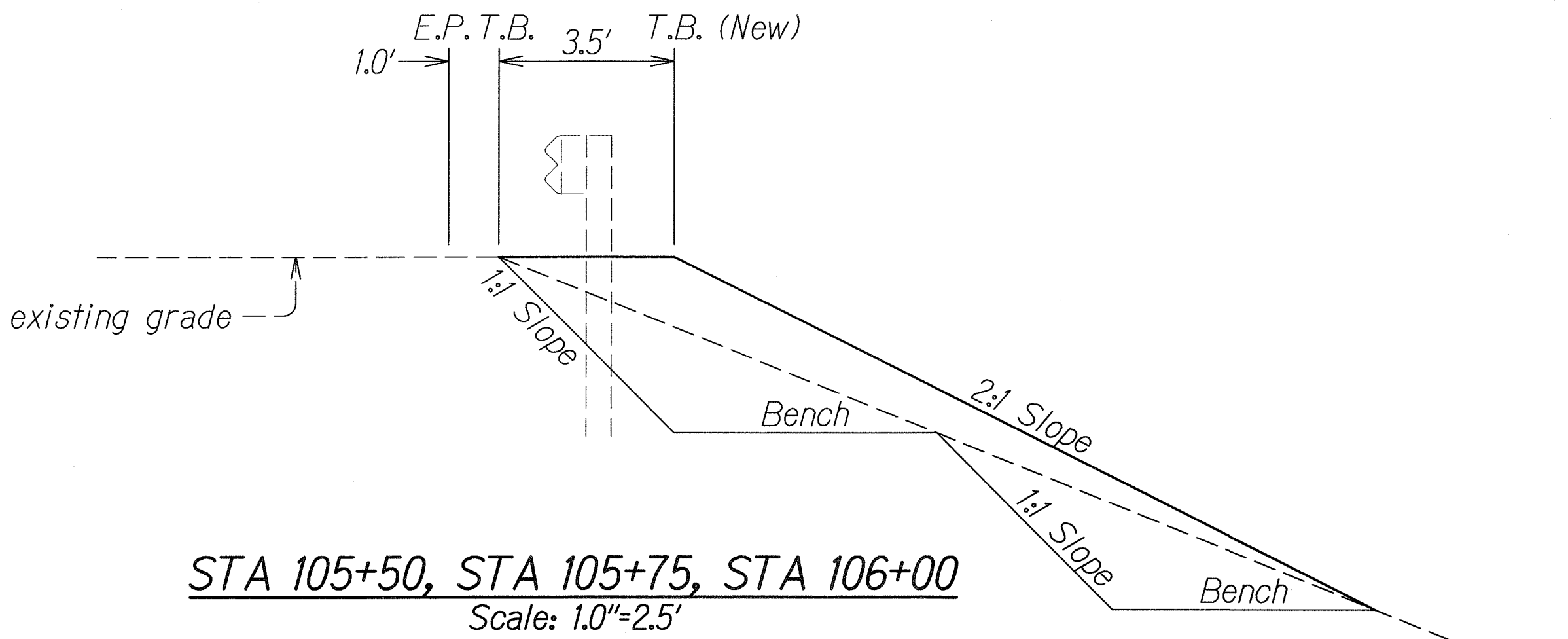
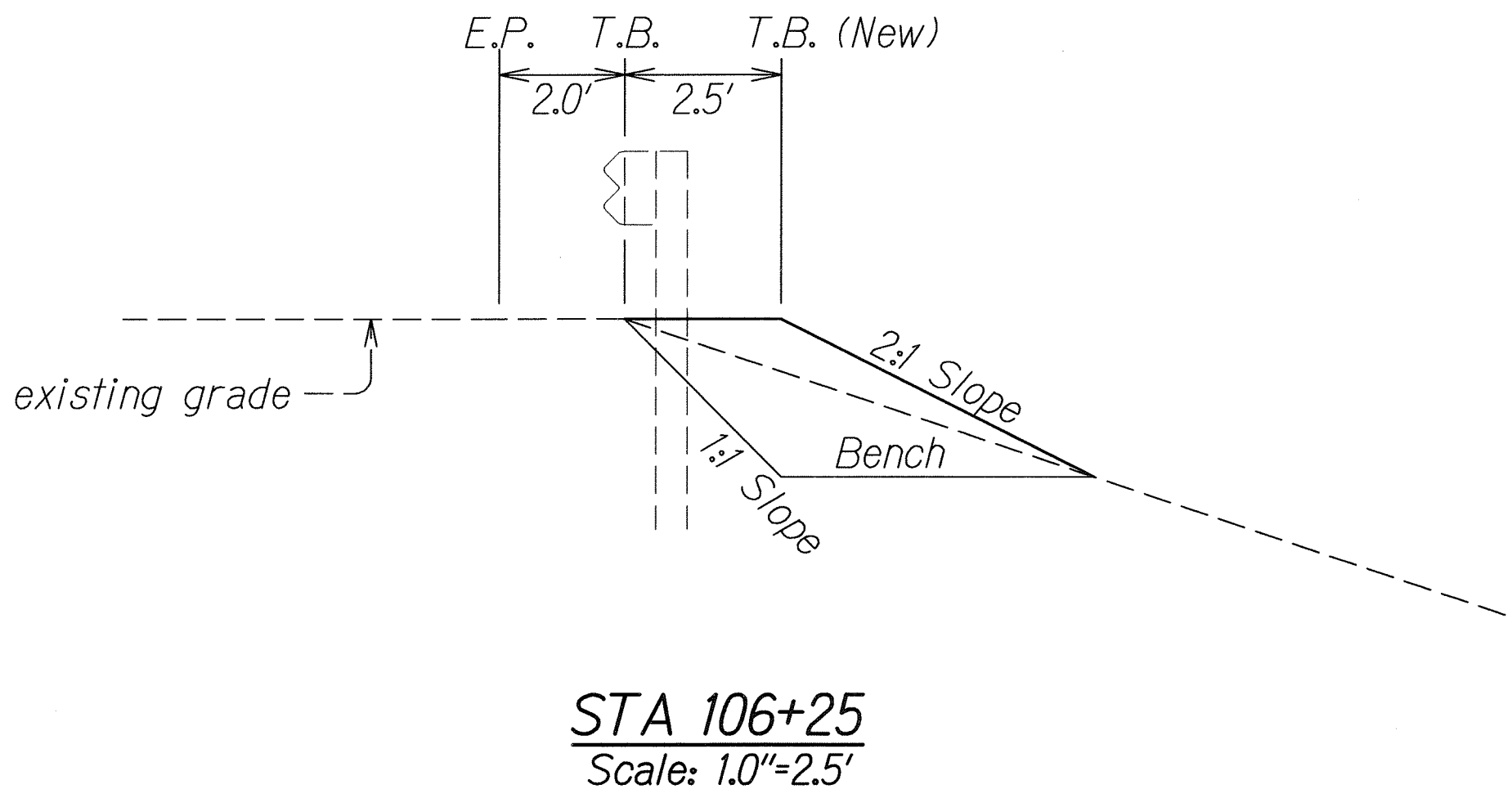
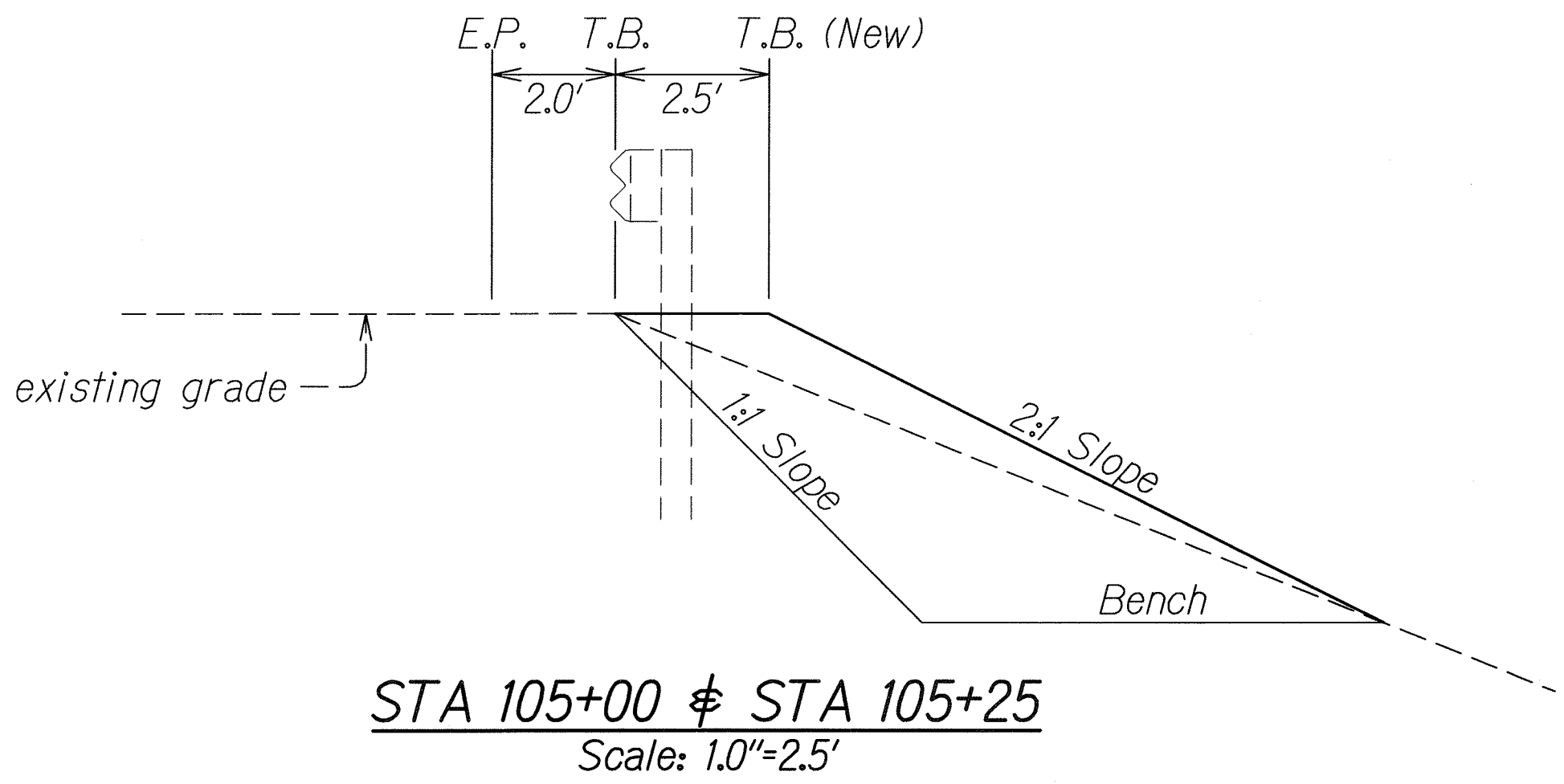

SURVEY PLOTTED BY	DATE
DRAWN BY	X
TRACED BY	X
NOTED BY	X
QUANTITIES BY	X
CHECKED BY	X

ORIGINAL PLAN	DATE
NOTE BOOK	X
NO. X	X

STATE OF HAWAII
DEPARTMENT OF TRANSPORTATION
HIGHWAYS DIVISION

TYPICAL ROADWAY SECTIONS
WAIMEA CANYON DRIVE/KOKEE ROAD
IMPROVEMENTS PHASE 1
MILE POST 0.80 TO MILE POST 4.60
Proj. No. 550AB-01-06
Scale: 1.0" = 2.5' Date: August, 2011
SHEET No. 1 OF 1 SHEETS

"AS-BUILT"

C.O. 7 S-1