

INDEX TO DRAWINGS	
SHEET NO.	DESCRIPTION
1	TITLE SHEET
2	STANDARD PLANS SUMMARY
3	GENERAL NOTES AND LEGENDS
4 - 5	WATER POLLUTION AND EROSION CONTROL NOTES
6 - 10	ROADWAY PLANS
11	MISCELLANEOUS SECTIONS AND DETAILS
12	GUARDRAIL DETAILS & NOTES
13	STRONG POST W-BEAM GUARDRAIL
14	GUARDRAIL DETAILS
15	FLEAT-350
16	QUANTITY SUMMARIES
17	GENERAL NOTES AND SYMBOLS AND ABBREVIATIONS
18	LAYOUT PLAN AND ELEVATION
19	BRIDGE RAIL AND ENDPOST UPGRADE DETAILS
20	BRIDGE RAIL UPGRADE DETAILS
21	EXISTING ENDPOST UPGRADE DETAILS
22	NEW ENDPOST DETAILS
23	METAL GUARDRAIL TYPE 3 THRIE BEAM AND APPURTENANCES DETAILS

STATE OF HAWAII

DEPARTMENT OF TRANSPORTATION

HIGHWAYS DIVISION

HONOLULU, HAWAII

"AS-BUILT"

PLANS FOR

HALEWILI ROAD

GUARDRAIL AND SHOULDER IMPROVEMENTS

FEDERAL AID PROJECT NO. STP-0540(2)

DISTRICT OF KOLOA

ISLAND OF KAUAI

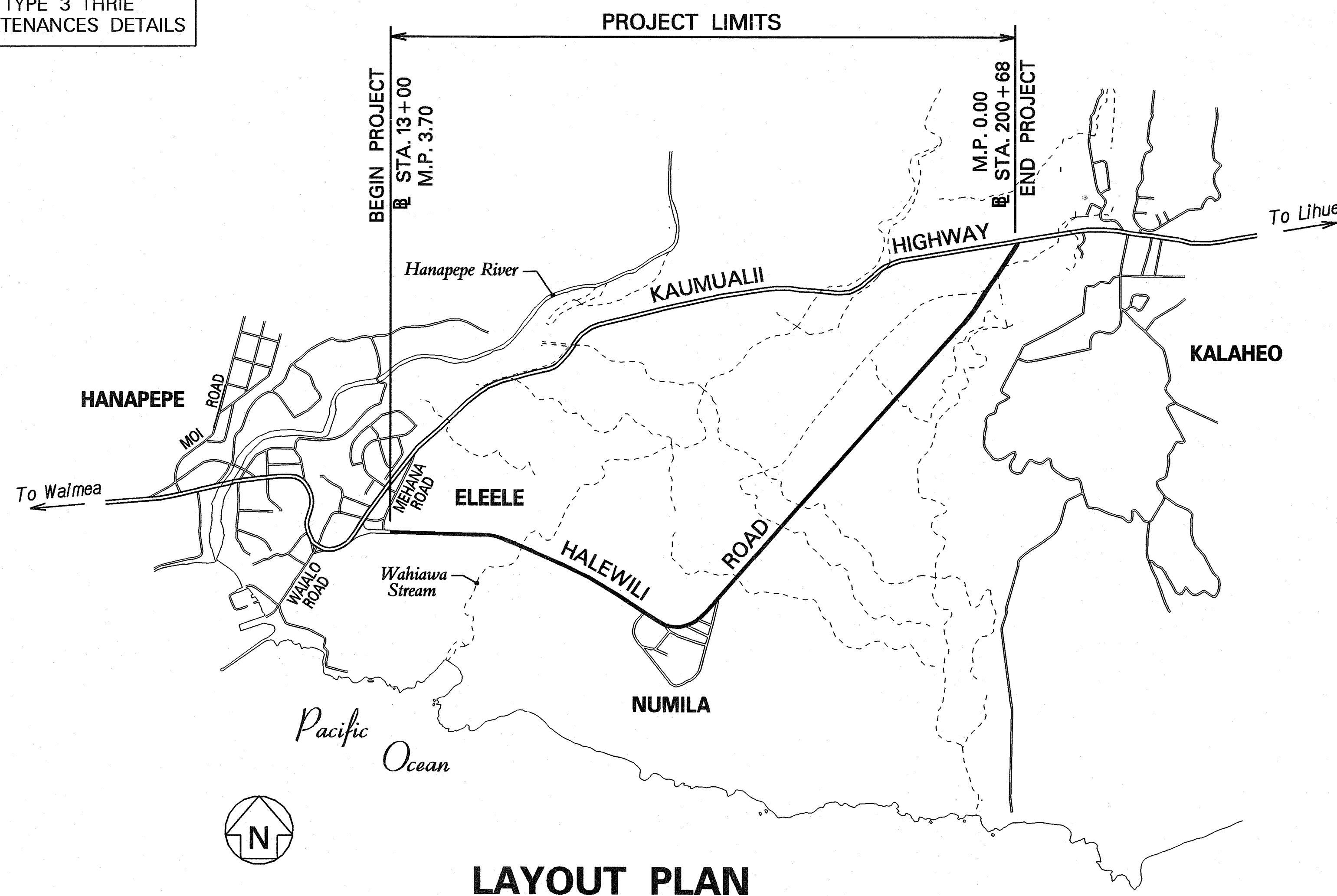

LAYOUT PLAN

FED. ROAD DIST. NO.	STATE	FEDERAL AID PROJ. NO.	FISCAL YEAR	SHEET NO.	TOTAL SHEETS
HAWAII	HAW.	STP-0540(2)	2004	1	23

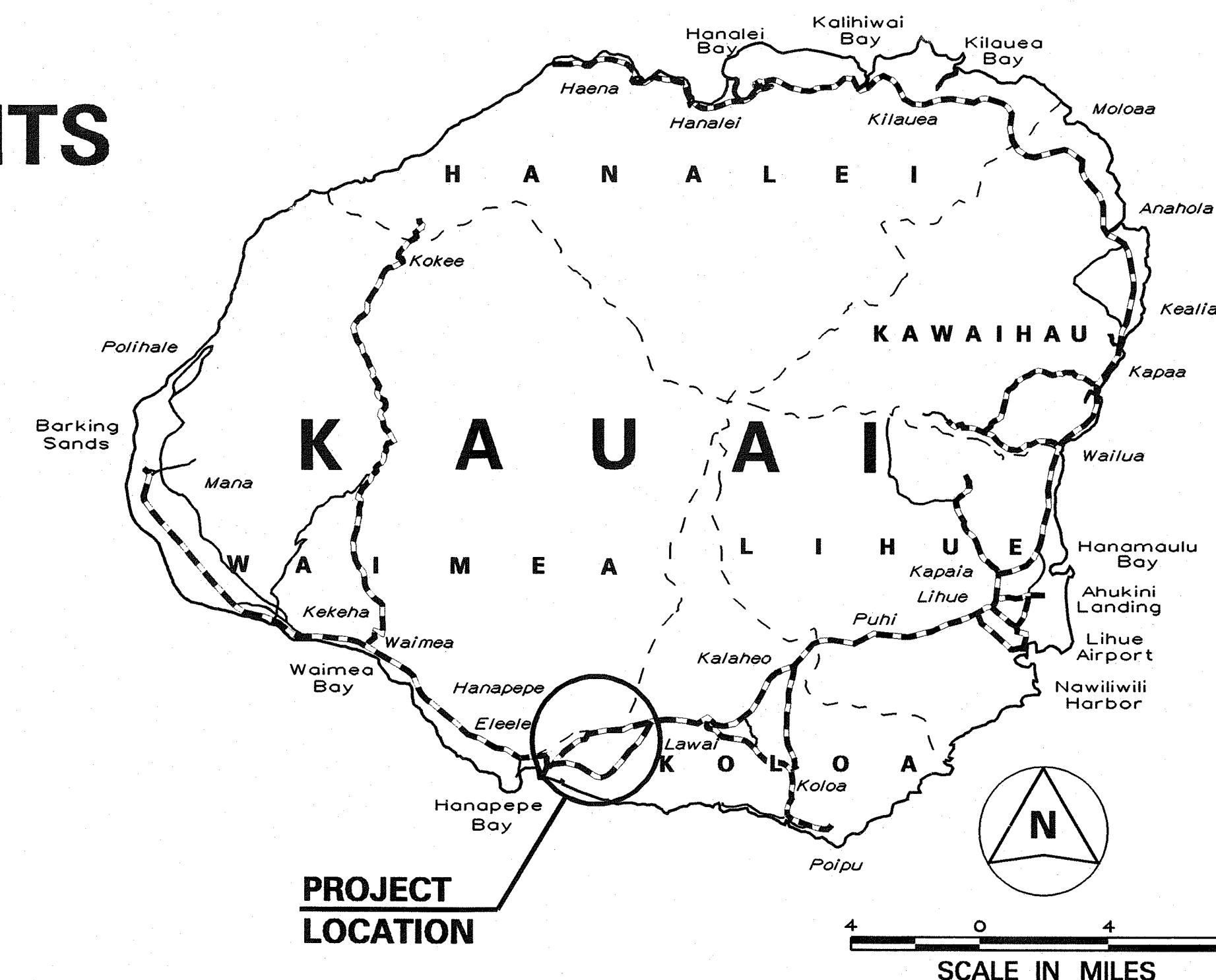
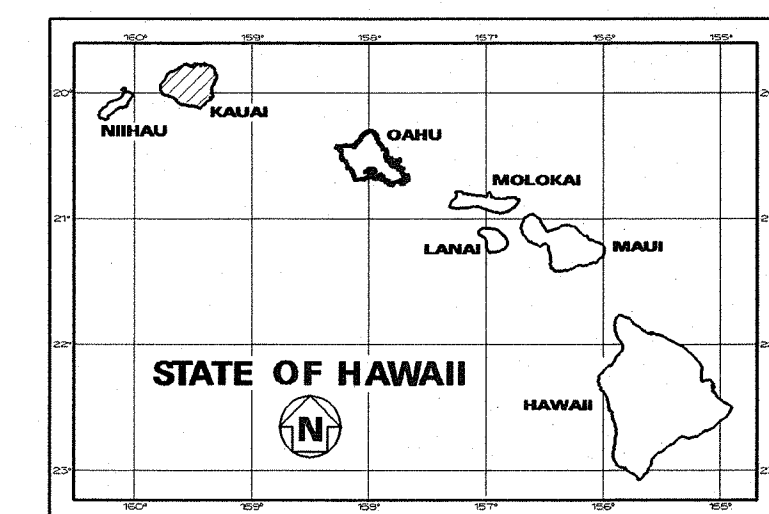

PROJECT LOCATION

----- FEDERAL AID PROJECTS PREVIOUSLY CONSTRUCTED OR UNDER CONSTRUCTION

MILE POST 0.00 TO MILE POST 3.70

DESIGN DESIGNATION

CURRENT ADT (2003).....2600
DESIGN ADT (2024).....3500
DHV.....350
Design K.....10.0
Design D.....60/40
Design T.....4.5
T24.....6.5
V.....25-50

NO SIGNIFICANT CHANGES WERE MADE DURING CONSTRUCTION ON THESE PLANS EXCEPT CHANGES IN THE ORIGINAL THEORETICAL QUANTITIES FOR ACTUAL QUANTITIES ADDED TO PROJECT LEDGER AND/OR CORRECTIONS.

RESIDENT ENGINEER DATE

DEPARTMENT OF TRANSPORTATION STATE OF HAWAII	
APPROVED:	
<i>[Signature]</i>	7-8-03
for DIR. OF TRANSPORTATION	DATE

DESIGNED BY
MANAGED BY
HWY-K
274-3118
June, 2003
DATE
PHONE