

INDEX TO DRAWINGS	
SHEET NO.	DESCRIPTION
1	TITLE SHEET
2	TYPICAL SECTION & GENERAL NOTES
3-4	PLAN & PROFILE
5	SUPERELEVATION DIAGRAMS
6-15	ROADWAY STANDARD & MISC. DETAILS
16-33	REPLACEMENT OF EXISTING WAHIWA TIMBER BRIDGE
34-36	INFORMATION & GUIDANCE TO DEMOLITION OF STRUCTURE
37-45	BRIDGE STANDARD DETAILS
46	CROSS SECTIONS

548-7597 April, 1973
 Phone-Loc Date
 D. Bevier By
 PS8E

Designed By

STATE OF HAWAII
 DEPARTMENT OF TRANSPORTATION
 HIGHWAYS DIVISION
 "AS-BUILT"
 PLANS FOR
 HALEWILI ROAD
 REPLACEMENT OF WAHIWA BRIDGE
 PROJ. NO. RS-0540(1)
 DISTRICT OF KOLOA
 ISLAND OF KAUAI

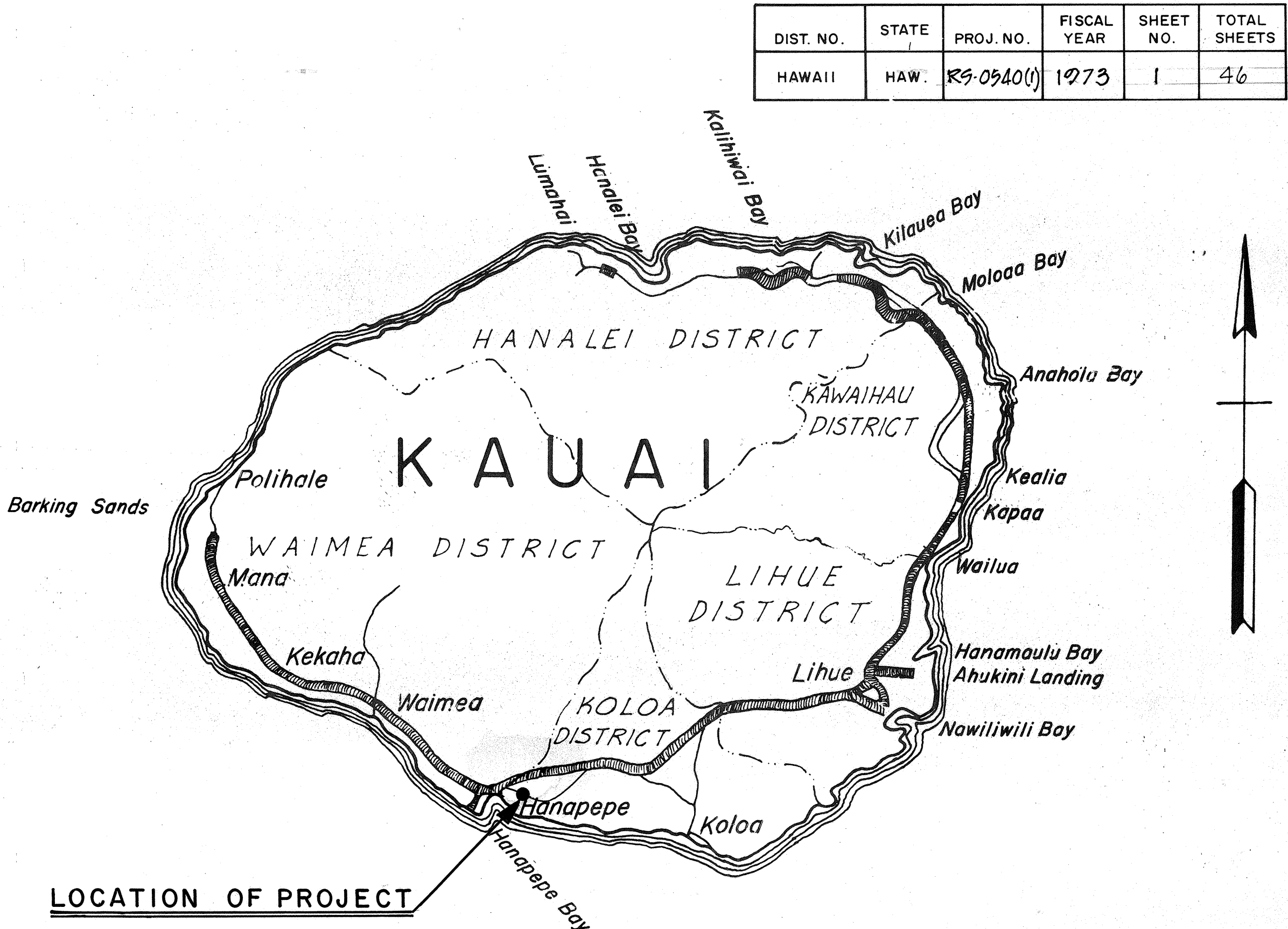

FEDERAL AID PROJECTS PREVIOUSLY CONSTRUCTED OR UNDER CONSTRUCTION

CHANGES MADE DURING CONSTRUCTION HAVE BEEN INCORPORATED ON THESE PLANS EXCEPT CHANGES IN THE ORIGINAL THEORETICAL QUANTITIES. FOR ACTUAL QUANTITIES, REFER TO PROJECT LEDGER AND/OR COMPUTATION BOOK.

Donald Nagamine
 for RESIDENT ENGINEER 6-6-84
 DATE

DESIGN CLASSIFICATION

ADT (1972)	1,250
DESIGN ADT (1993)	2,120
DHV	250
D	50/50
T	8.0
T ₂₄	9.0
V	60

LAYOUT PLAN

GROSS LENGTH OF PROJECT	0.161
LESS BRIDGES OVER 20.00' SPAN	0.077
NET LENGTH OF ROADWAY	0.084

DEPARTMENT OF TRANSPORTATION
 STATE OF HAWAII
 APPROVED:
 Munny Lee 4/30/73
 for DIR. OF TRANSPORTATION DATE

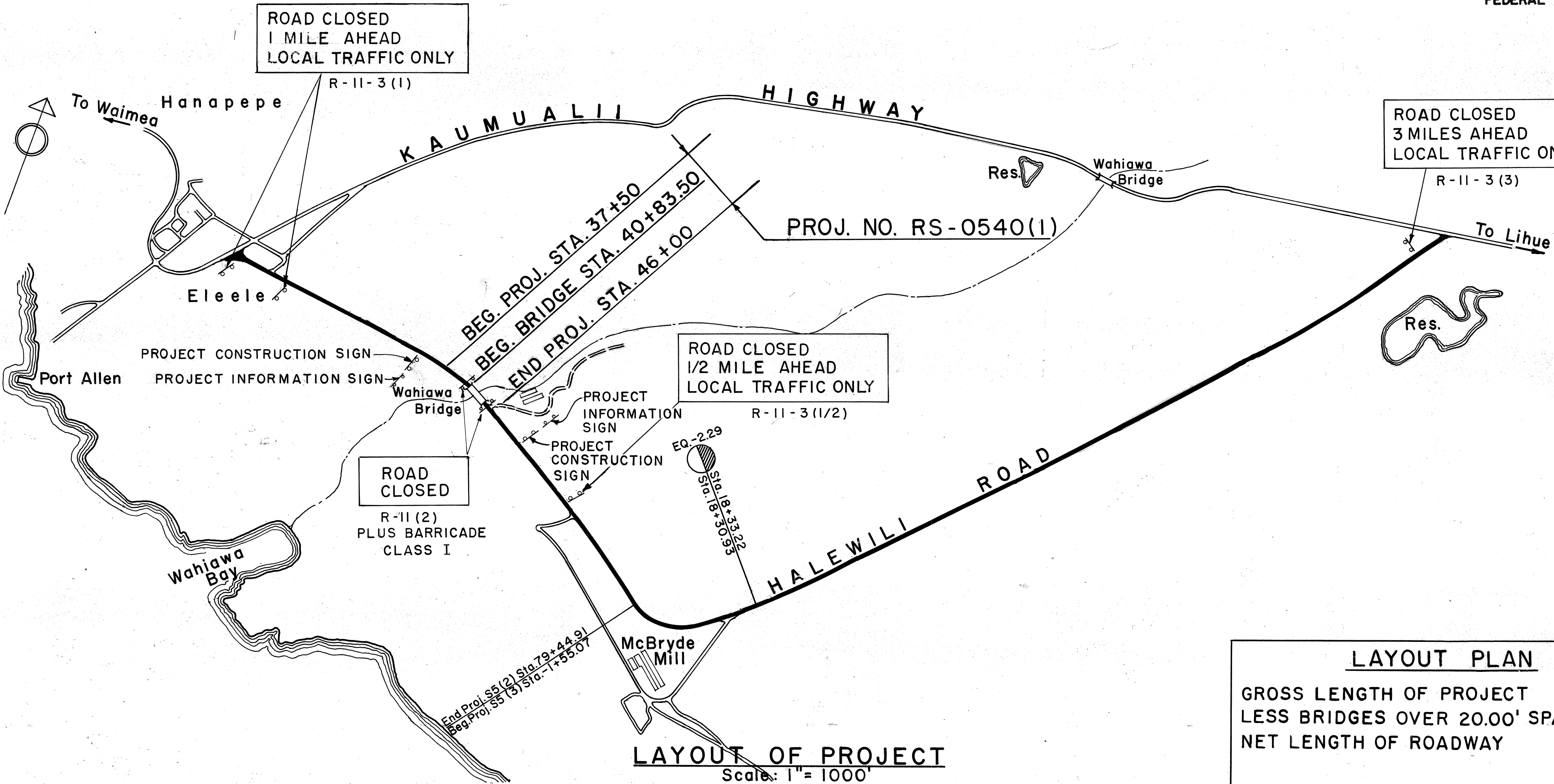

SURVEY PLOTTED BY	DATE
ORIGINAL PLAN	
TRACED BY	
NOTE BOOK	
CHECKED BY	

0-10-8