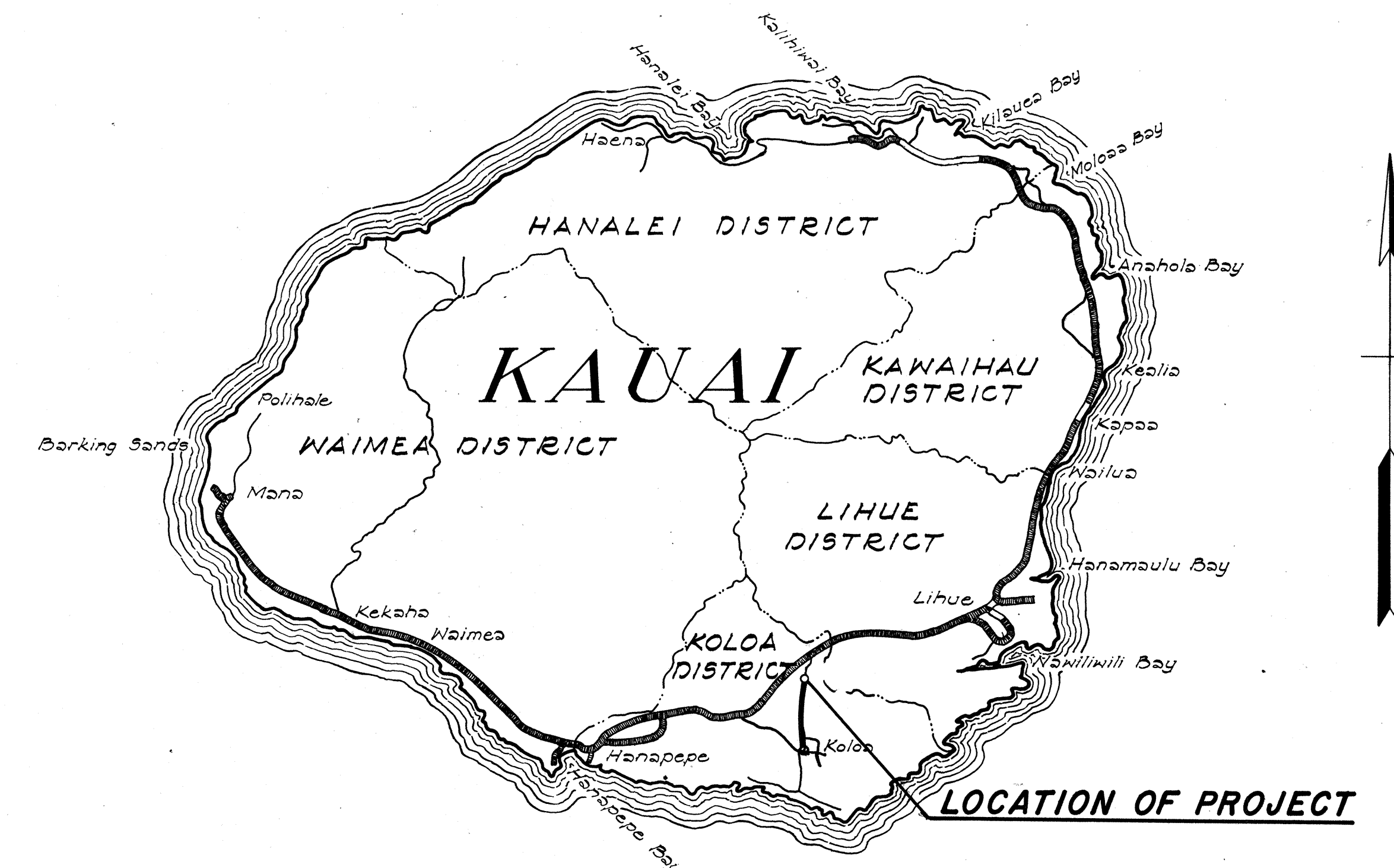
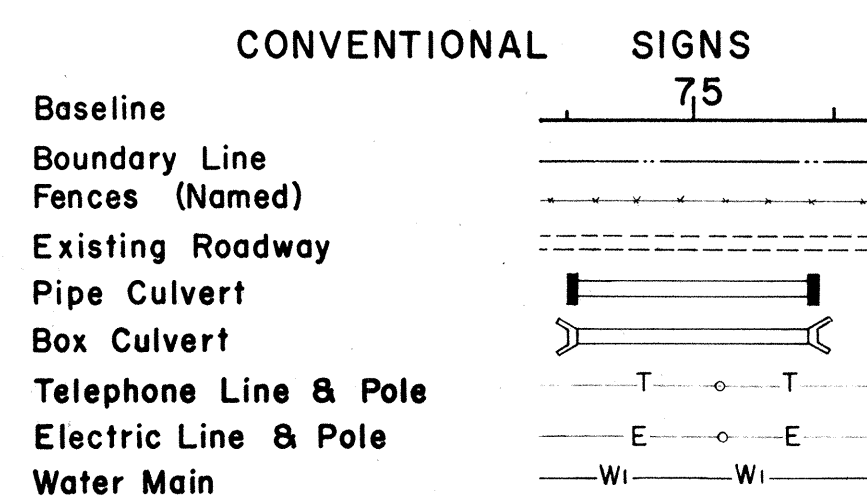

SHEET NO.	DESCRIPTION
I	TITLE SHEET
2-3	BRIDGE WIDENING
4-5	STANDARD DETAILS

"AS BUILT" PLANS FOR

DISTRICT OF KOLOA
ISLAND OF KAUAI

FEDERAL AID PROJECTS PREVIOUSLY CONSTRUCTED OR UNDER CONSTRUCTION 11

ALL CHANGES MADE DURING CONSTRUCTION HAVE BEEN NOTED
IN RED ON THESE TRACINGS AND CHECKED BY:

Shigeto Yamaguchi
PROJECT ENGINEER
June 6 1967
DATE

Lower all elevations in
this plan by 0.52'

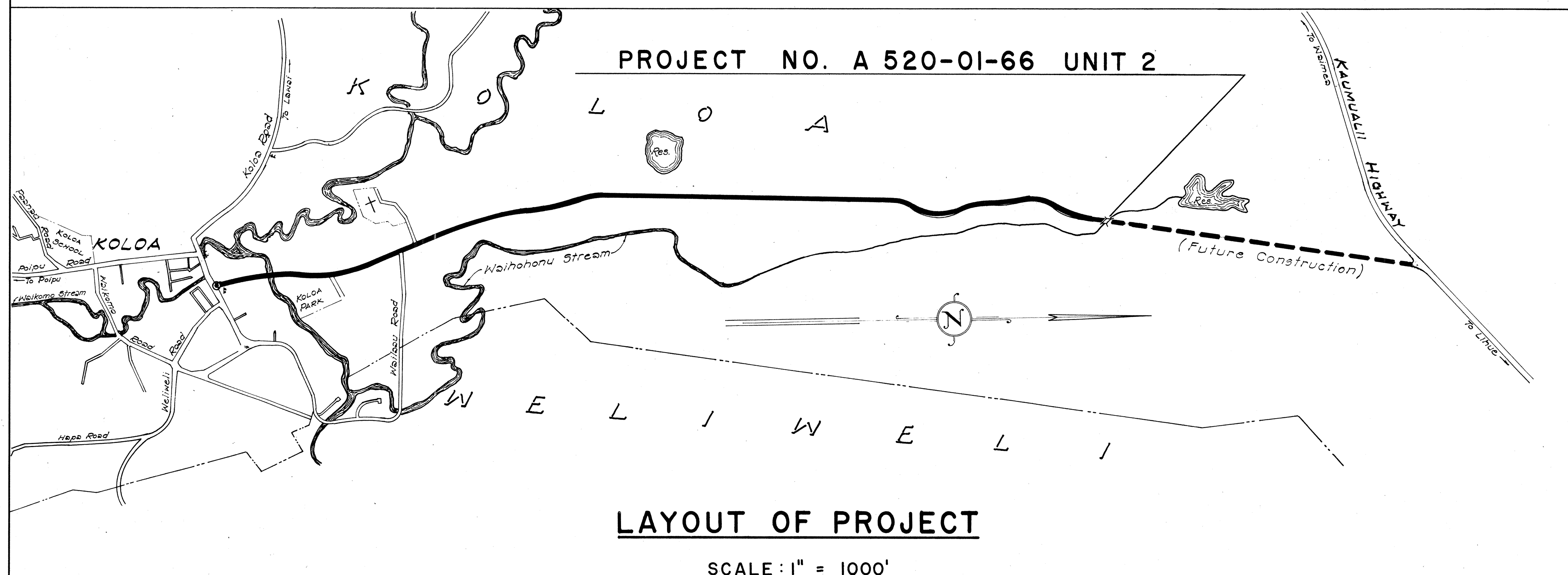

APPROVED: _____ DATE 3/4/66

John W. Lee

FOR DIRECTOR OF TRANSPORTATION