

FED. ROAD DIST. NO.	STATE	FED. AID PROJ. NO.	FISCAL YEAR	SHEET NO.	TOTAL SHEETS
HAWAII	HAW.	NH-058-1(3)	2001	12	39

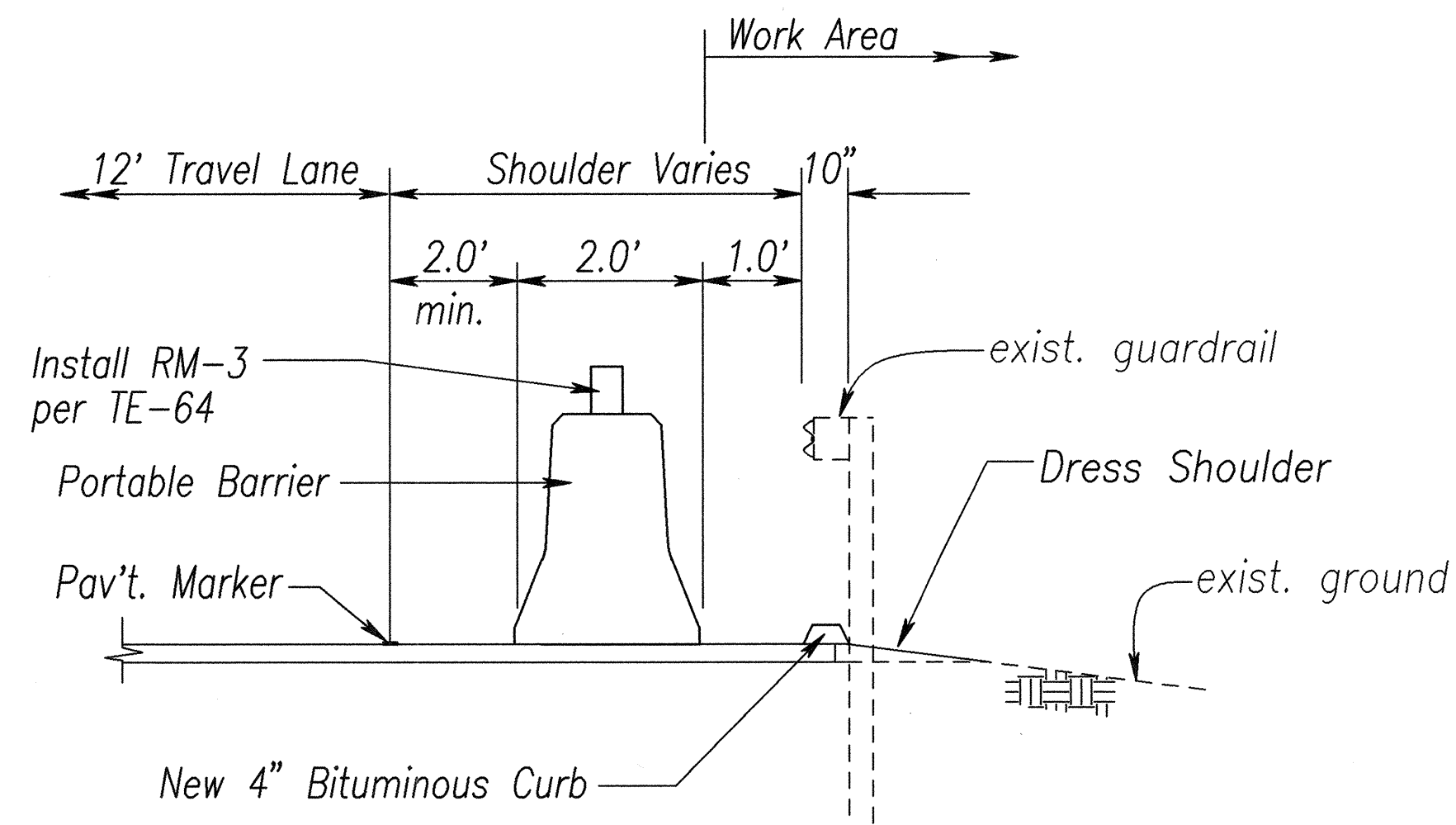

TYPICAL DETAIL PHYSICAL BARRIER
Not to Scale

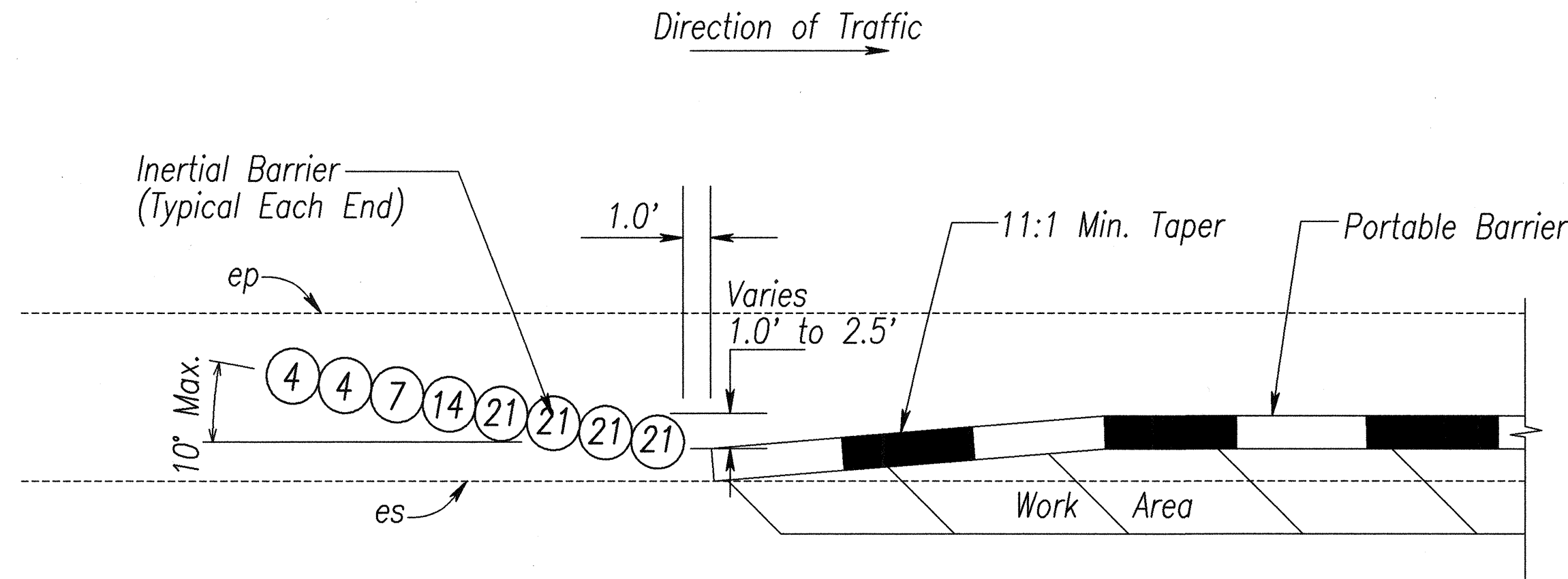

NOTE:
The numbers inside the circle indicate weight of sand in 100-lb unit.
Installation shall conform to Manufacturer's recommendations as dictated by design speed and field condition.

TYPICAL DETAIL
8-MODULE INERTIAL BARRIER
Not to Scale

- NOTES:
1. Typical layout will vary based on speed and manufacturer of system used. Installation shall conform to Manufacturer's recommendations.
 2. Physical barriers shall be required whenever guardrails have been removed and will not be reinstalled by the end of the work day. See General Note No. 20 on Plan Sht. No. 3.
 3. Physical barriers shall be either portable concrete barriers or portable water filled barriers. Installation of portable water-filled barriers shall conform to Manufacturer's recommendations as dictated by design speed and field conditions.
 4. Providing, transporting, placing, maintaining, relocating and removing physical barriers shall be considered incidental to the various items of work. See Section 645- Traffic Control Devices of the Special Provisions.
 5. Ends of portable barriers shall be protected with Inertial Barriers as shown above. Furnishing and installing inertial barriers shall be considered incidental to the various contract items.
 6. Furnishing and installing reflector marker (RM-3) over the portable barriers shall be considered incidental to the various contract items.

SURVEY PLOTTED BY	DATE
DRAWN BY D. Miron	9-8-00
DESIGNED BY S. Harano	"
QUANTITIES BY	"
CHECKED BY Mm. D. Alcon	"
ORIGINAL PLAN	
NOTE BOOK	
No. and date of copy	

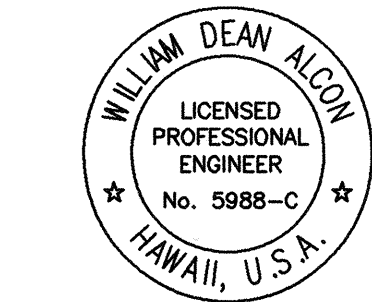

THIS WORK WAS PREPARED BY
ME OR UNDER MY SUPERVISION

STATE OF HAWAII
DEPARTMENT OF TRANSPORTATION
HIGHWAYS DIVISION

PORTABLE PHYSICAL BARRIER
DETAILS
NAWILIWILI ROAD RESURFACING
Kaumualii Highway to Waapa Road
Federal Aid Proj. No. NH-058-1(3)
Scale: As Shown Date: Nov. 2000
SHEET No. 1 OF 1 SHEETS