

FED. ROAD DIST. NO.	STATE	PROJ. NO.	FISCAL YEAR	SHEET NO.	TOTAL SHEETS
HAWAII	HAW.	HWY-K-01-13M	2013	16	18

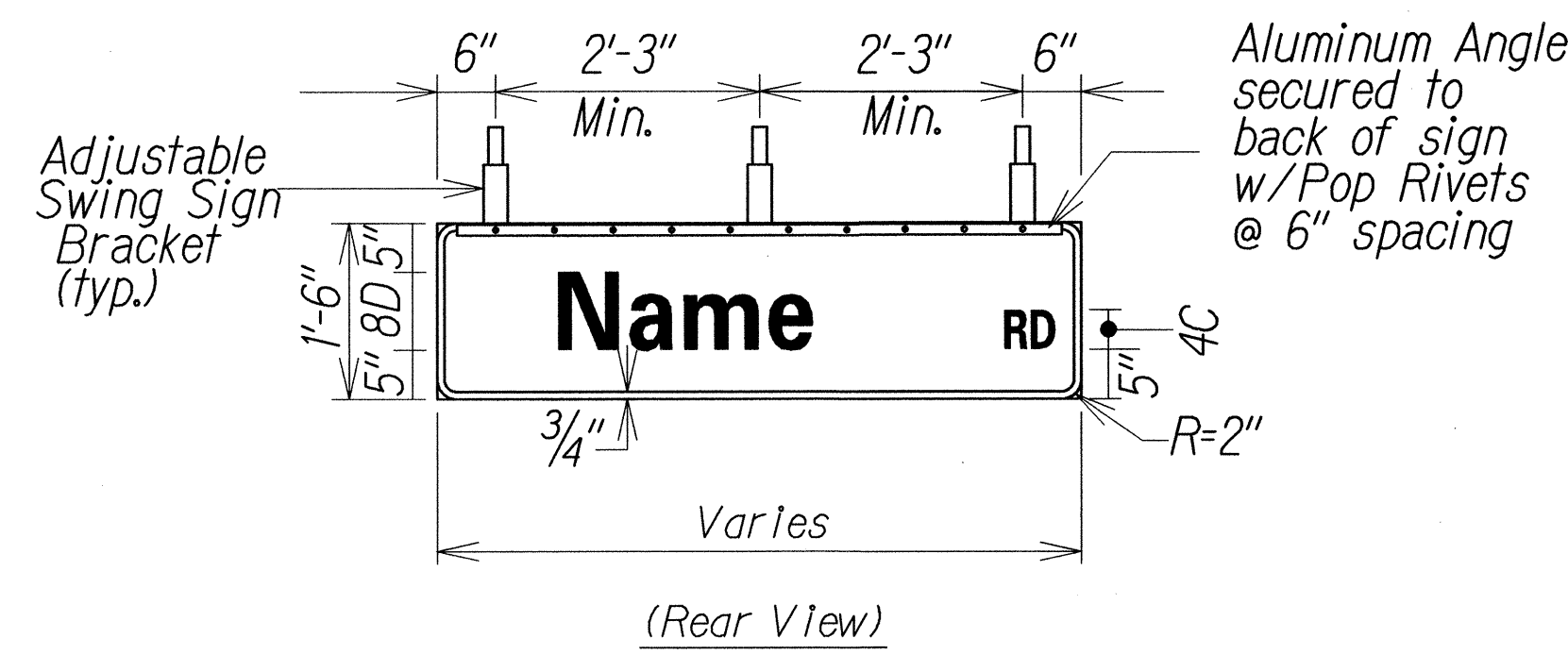

PANEL & SWING BRACKET LAYOUT  
FOR STREET NAME SIGN

- ① Pivotal Upper Bracket
- ② 5/8" x 1/4" Slot for double strapping to electrolier mast arm. (M2G-34S(HD) .030" x 3/4" Heavy Duty Stainless Steel Strap with M2G-34B(HD) Buckle recommended.)
- ③ 1/2" - 13 x 1/2" Stainless Steel Hex Head Bolt with Stainless Steel Hex Lock Nut and 1/16" Stainless Steel Washer (both sides). Allows upper bracket to pivot and align with electrolier mast arm.
- ④ 6" Overall drop with Fixed Length Sign Bracket
- ⑤ Stainless Steel Dampener Spring (Removable)
- ⑥ Stainless Steel Hex Lock Nut with 1/16" Stainless Steel Washer
- ⑦ 1" O.D. Axle Housing
- ⑧ 1/2" - 13 x 4" Stainless Steel Hex Head Bolt with 1/16" Stainless Steel Washer
- ⑨ Oilite Bushing
- ⑩ Sign Mounting Sets, consisting of two each 5/16" - 18 x 1" Stainless Steel Hex Head Bolt with Stainless Steel Hex Lock Nut. Two holes on 1 1/2" centers provide positive lock sign mounting to bracket.
- ⑪ 8 1/4" overall length Upper Adjustable Sign Bracket section
- ⑫ 9" overall length Lower Adjustable Sign Bracket section, including Axle Housing (8" overall length to top of Axle Housing)
- ⑬ 1/2" - 13 x 1 1/2" Stainless Steel Hex Bolt with Stainless Steel Hex Lock Nut and 1/16" Stainless Steel Washers (both sides). Loosen lock nut, adjust bracket teeth to level sign.
- ⑭ 1 1/4" x 1 1/4" x 1/8" Aluminum Angle

Note: Dimensions may vary slightly.

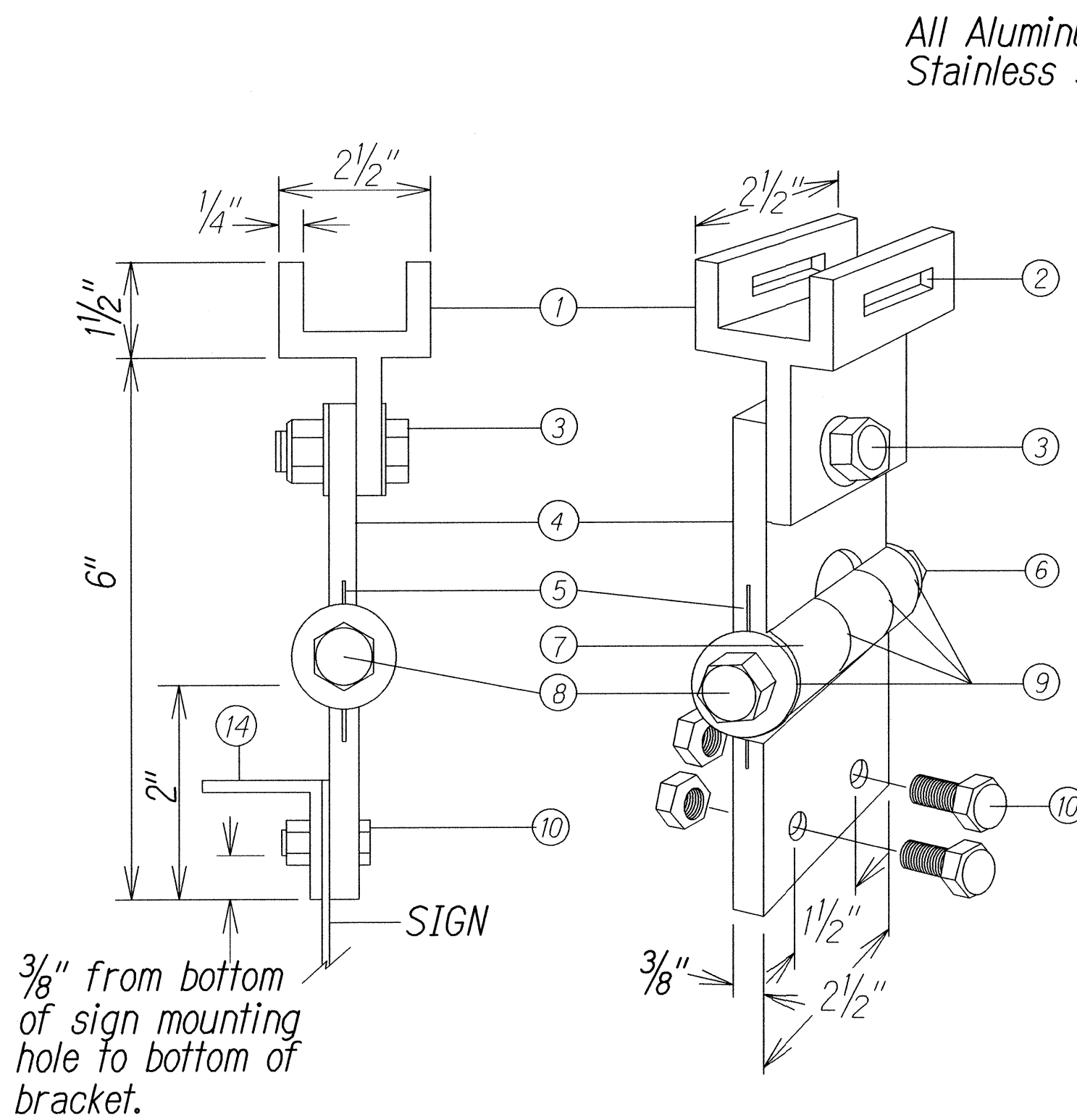

FIXED LENGTH NON-ADJUSTABLE  
SWING SIGN BRACKET

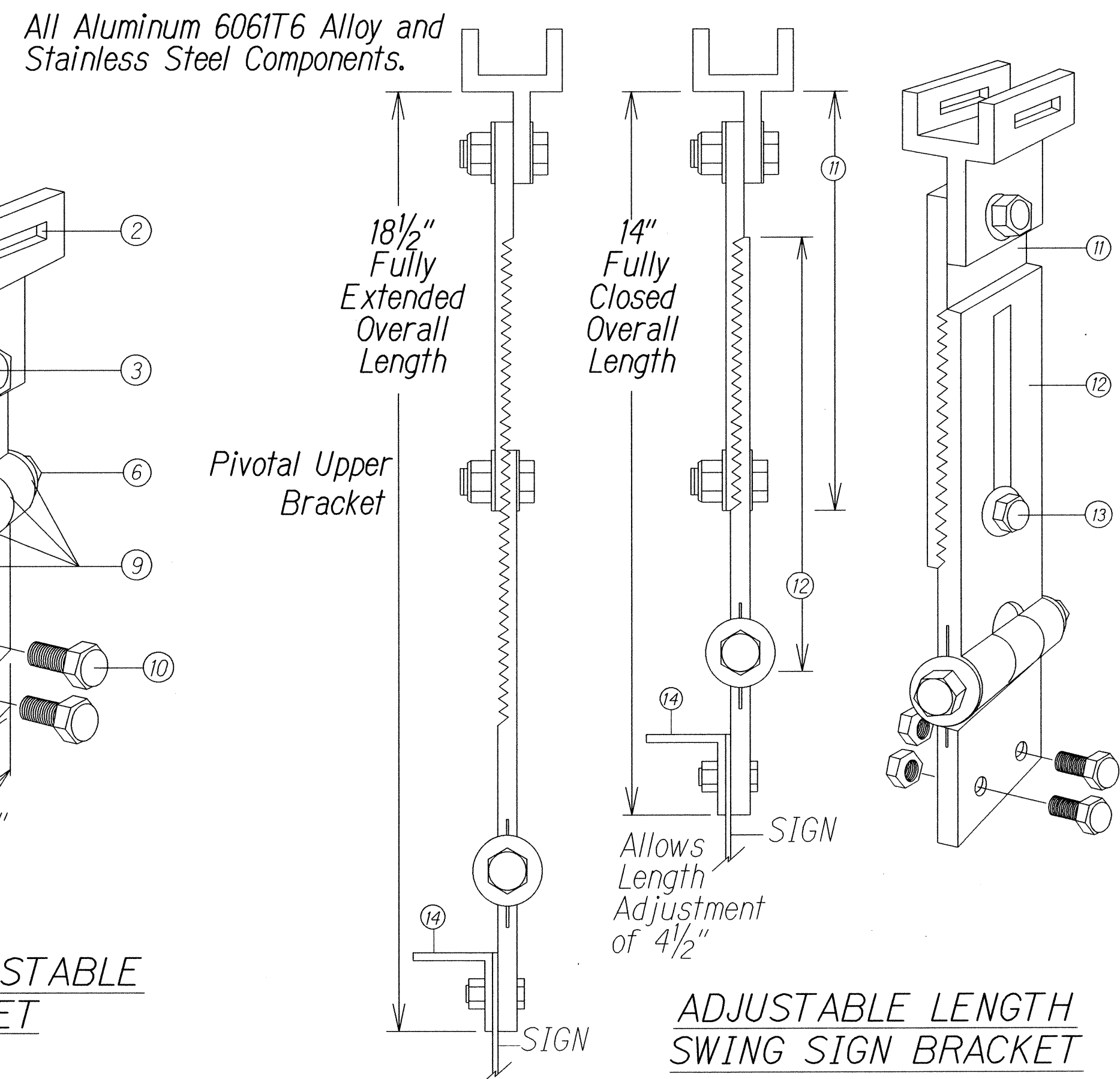

ADJUSTABLE LENGTH  
SWING SIGN BRACKET

SIGN NOTES:

1. Provide the same message on the front and back side of the sign. Payment will not be made separately but shall be considered as one unit.
2. Colors:  
Legend: - White (Reflectorized)  
Background - Green (Reflectorized)
3. All Panels shall be reflectorized with Type B Reflectorized Sheeting in accordance with Section 750.01 of the Standard Specifications.
4. All signs shall conform to Section 630 of the Specifications and the latest editions and amendments of the following FHWA publications:
  - a. "Manual on Uniform Traffic Control Devices for Streets and Highways" (MUTCD)
  - b. "Standard Highway Signs"
  - c. "Standard Alphabets for Highway Signs"
5. Borders and messages shall conform to details as shown on the Plans and as specified in the MUTCD.
6. Sign mounting brackets, fixtures, fasteners, all necessary hardware, equipment, tools, labor, materials and other incidentals required for installation will not be paid for separately but shall be considered incidental to Street Name Sign contract item.

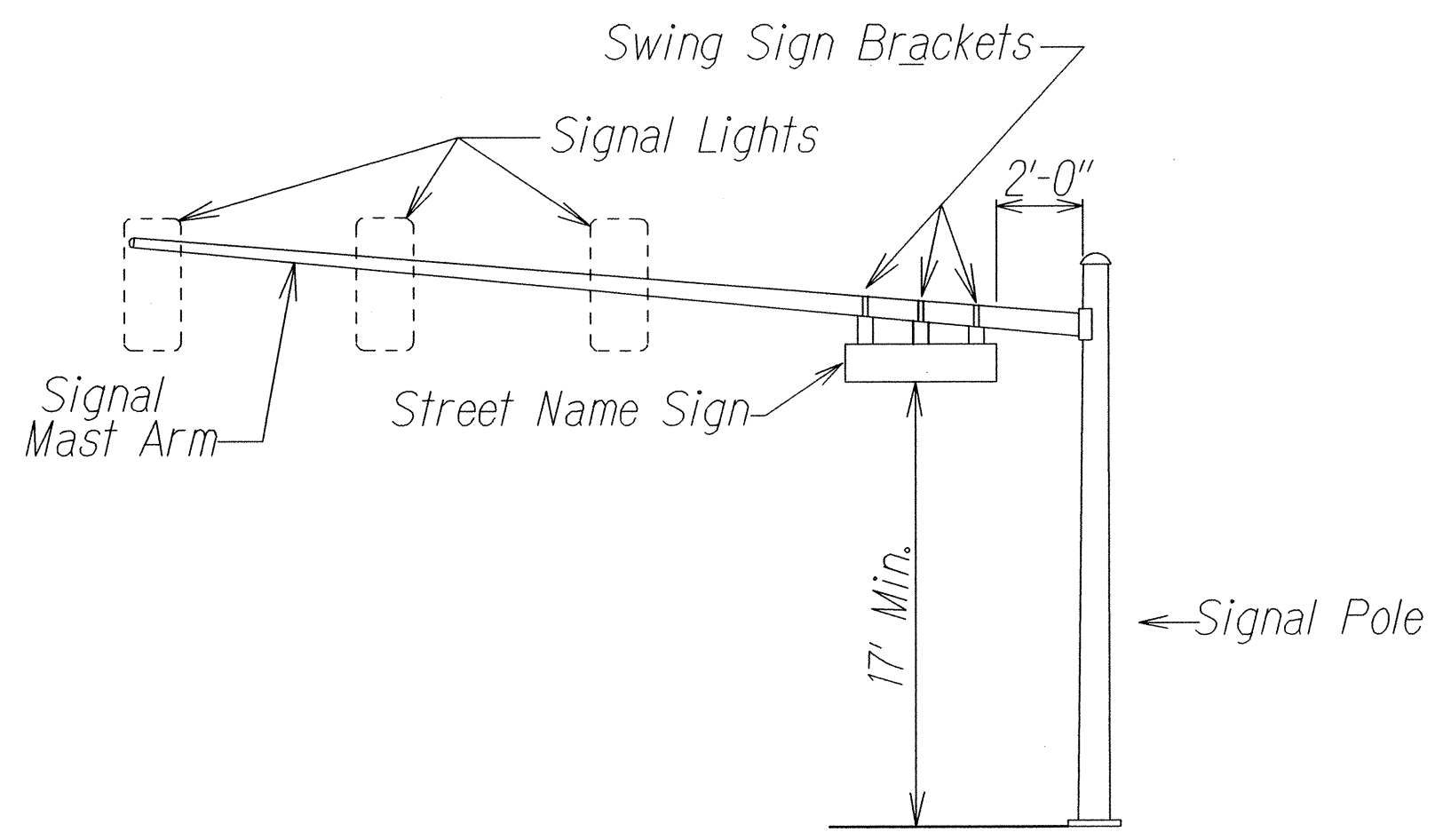

STREET NAME SIGN MOUNTING  
ON MAST ARM

STATE OF HAWAII  
DEPARTMENT OF TRANSPORTATION  
HIGHWAYS DIVISION

**TRAFFIC SIGN DETAILS**  
 KUHIO HIGHWAY  
 TRAFFIC SIGNAL REHABILITATION  
 AT VARIOUS LOCATIONS  
 PROJECT NO. HWY-K-01-13M  
 Scale: Not to Scale      Date: May, 2013  
 SHEET No. 1 OF 2 SHEETS

SURVEY PLOTTED BY	DATE
DRAWN BY	
CHECKED BY	
NOTED BY	
CHECKED BY	

FED. ROAD DIST. NO.	STATE	PROJ. NO.	FISCAL YEAR	SHEET NO.	TOTAL SHEETS
HAWAII	HAW.	HWY-K-01-13M	2013	17	18

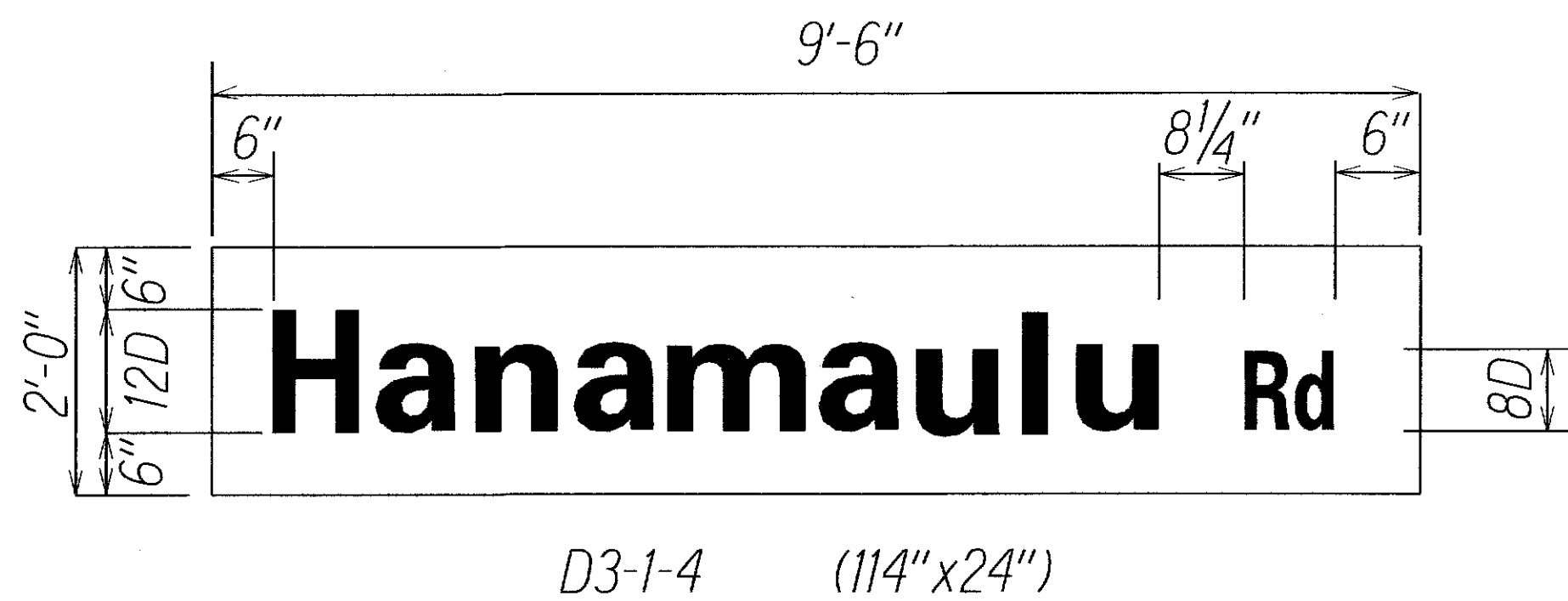
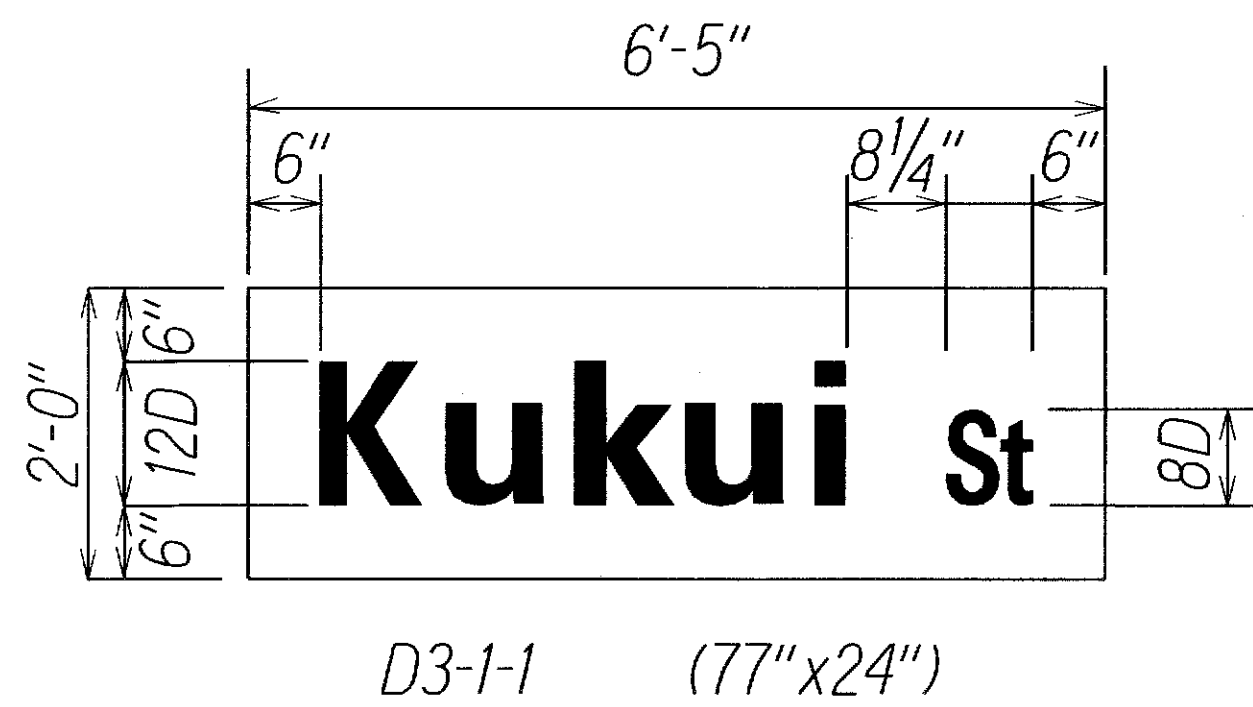

Two Street Name Mounted Northbound/Southbound Mast Arm Extensions

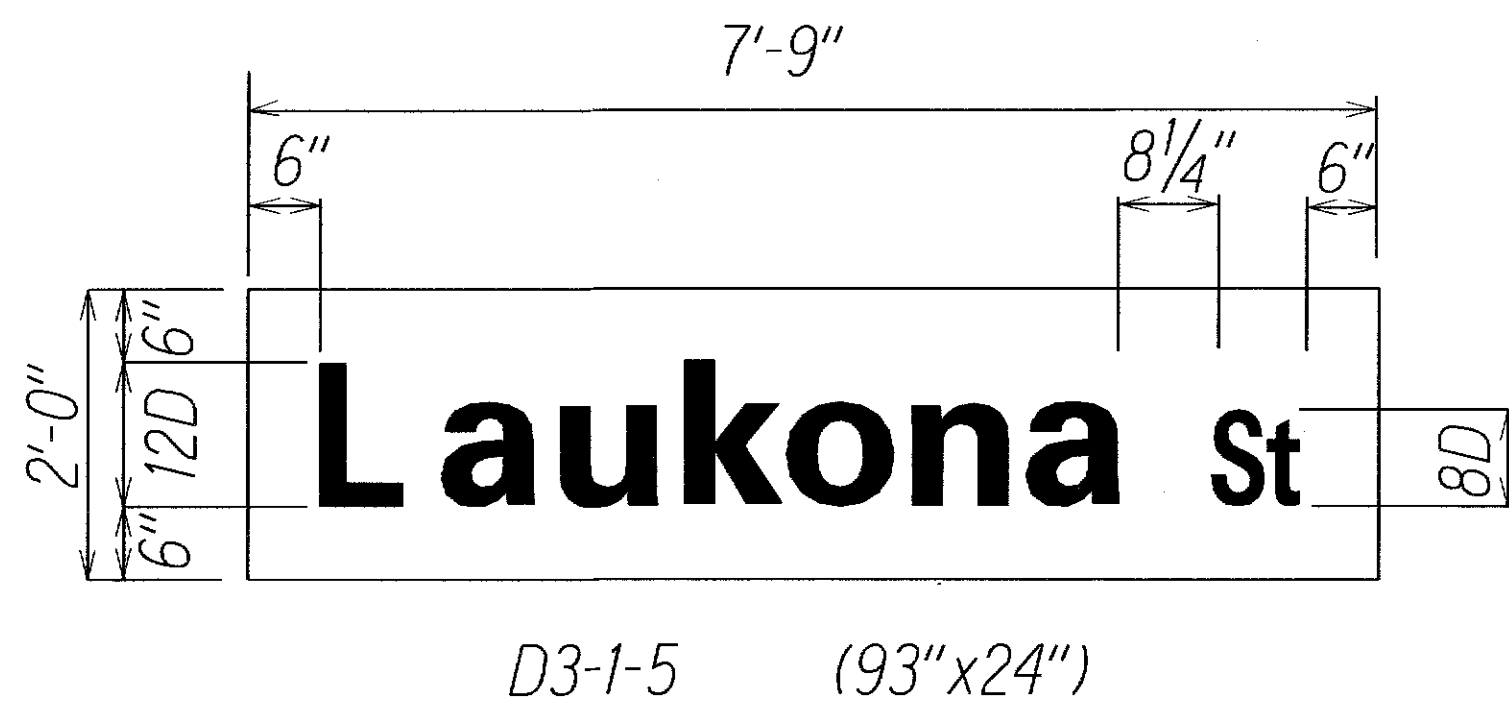
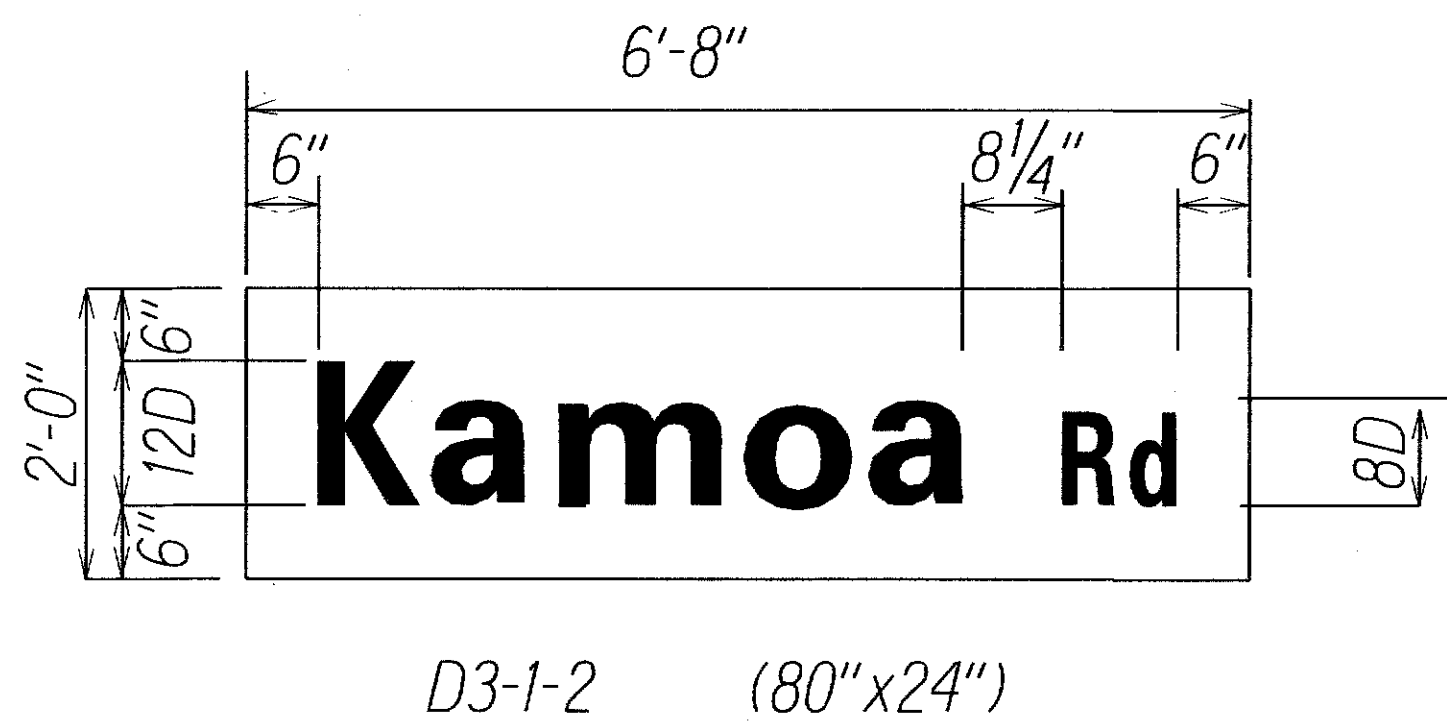

Two Street Name Mounted Northbound/Southbound Mast Arm Extensions

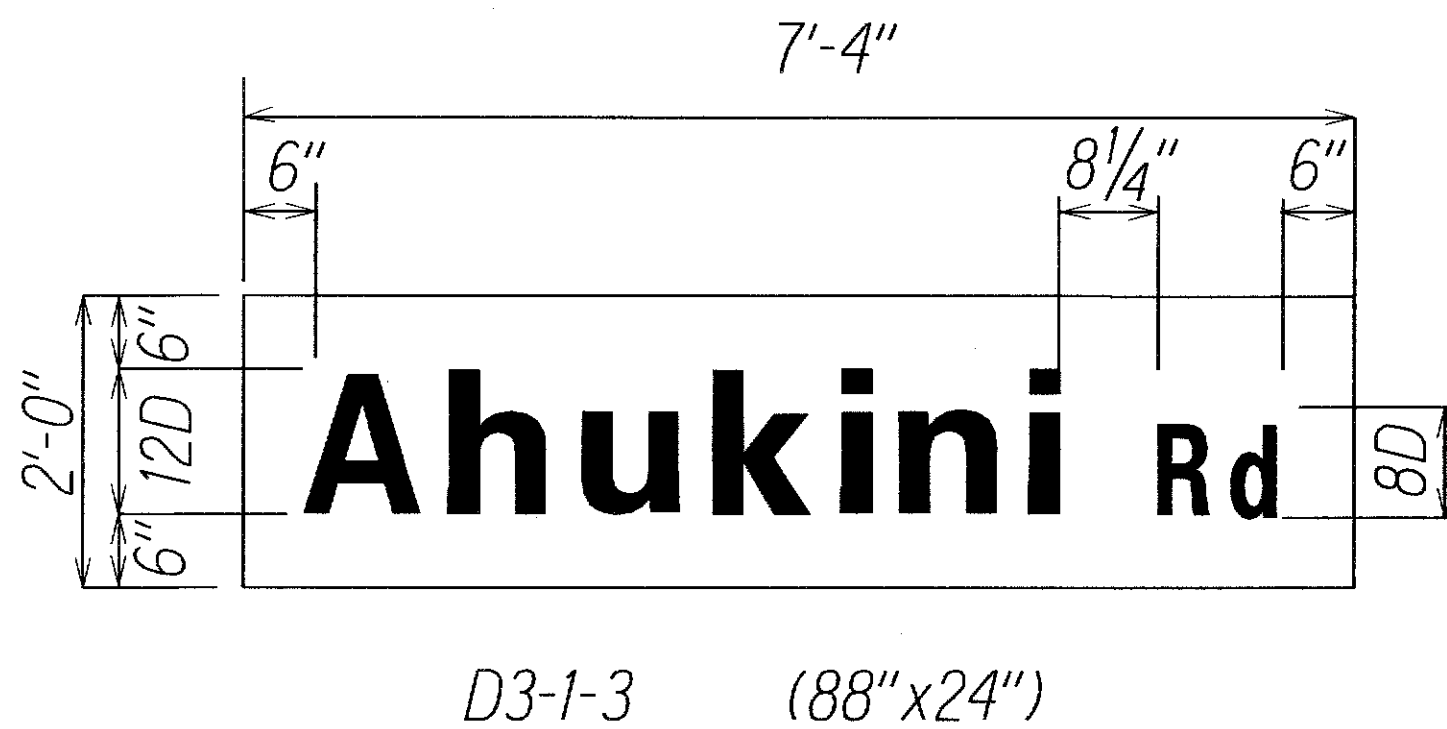

Notes:

- Each Street Name sign shall be installed on the traffic signal mast arm with a minimum of three (3) support brackets.
- The Street Name sign shall be retroreflective to show the same shape and similar color, both day and night, and on two sides (visible to both directions).
- The legend and border shall be white on a green background.

LEGEND FOR AS-BUILT POSTINGS	
	Squiggly line for as-built deletion
	Double line for as-built deletion
Roadway	Text for as-built posting

STATE OF HAWAII DEPARTMENT OF TRANSPORTATION HIGHWAYS DIVISION	
<b>TRAFFIC SIGN DETAILS</b>	
KUHIU HIGHWAY Traffic Signal Rehabilitation at Various Locations Project No. HWY-K-01-13M	
Scale: Not to Scale	Date: May, 2013
SHEET No. 17 OF 18 SHEETS	

ORIGINAL PLAN	SURVEY PLOTTED BY	DATE
NOTE BOOK	DRAWN BY	
1/2	DESIGNED BY	
1/2	CHECKED BY	
1/2	1/2	