

FED. ROAD DIST. NO.	STATE	PROJ. NO.	FISCAL YEAR	SHEET NO.	TOTAL SHEETS
HAWAII	HAW.	56A-03-21	2022	11	11

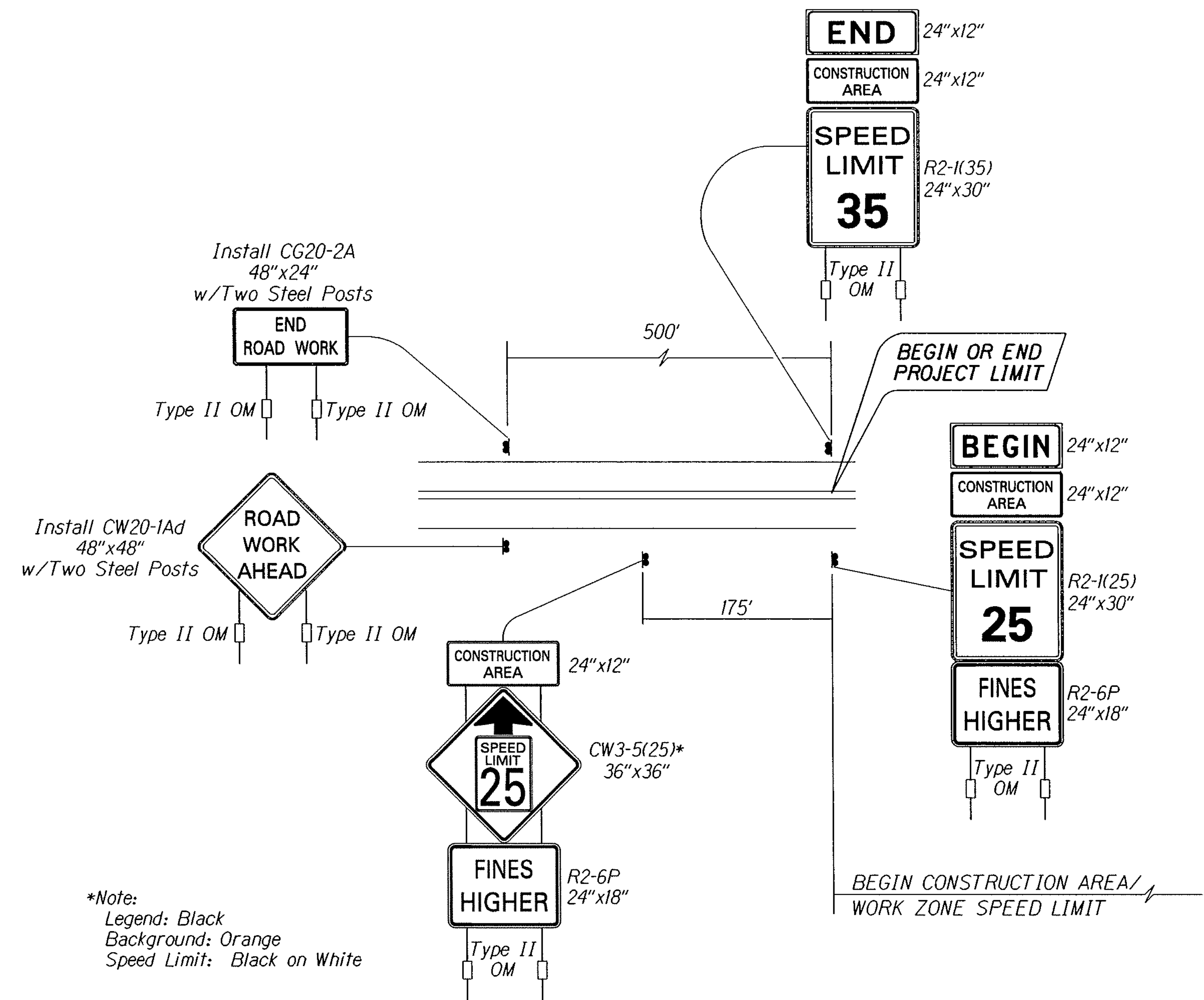

Work Zone Notes:

1. This Work Zone Sign Plan is intended for use on long-term stationary work zones/construction phases (3 days or more). All work zones or construction phases less than 3 days duration will use Traffic Control Plans shown in Section 645 of the Special Provisions.
2. All existing regulatory speed limit signs within the work zone/project limits shall be covered and work zone speed limit sign assemblies (R2-1(XX)-A and CW3-5(XX)-A with "CONSTRUCTION AREA" and R2-6P, "FINES HIGHER" Supplemental Signs) shall be displayed during lane closure hours.
3. Upon the removal of the lane closure, all work zone speed limit signs shall be covered and existing speed limit signs within the work zone/project limits shall be restored.
4. Construction signs shall be installed on both the approaching and trailing ends of each work zone.
5. Each construction sign and work zone speed limit assembly shall have a minimum of two (2) Type II OM. Installation of each Type II OM shall be included in the lump sum cost of the Bidder's Proposal documents.
6. The contractor shall maintain a log of the covering and uncovering of the existing regulatory speed limit signs, as well as the covering and uncovering of the work zone speed limit sign assemblies. The log will be submitted weekly to the engineer and indicate the daily times of when each existing regulatory speed limit sign and work zone speed limit assembly are covered and uncovered. The log will also include the installation and removal dates, times, and locations of the work zone speed limit sign assemblies at the start and end of the project.
7. The daily covering and uncovering of existing regulatory speed limit signs along with the installation, maintenance, removal, daily covering and uncovering of work zone speed limit sign assemblies and weekly log shall be included in the lump cost of the Bidder's Proposal documents. Sign covers shall not allow any portion of the sign being covered to be visible. If the sign has more than one side, cover shall completely cover each side. "Homemade" or "field made" covers shall not be used or accepted.
8. Placement of construction signs shall not obstruct the path of pedestrians and bicyclists.

**TYPICAL DETAIL FOR CONSTRUCTION SIGNS
ON TWO LANE OR MULTILANE UNDIVIDED LOW SPEED HIGHWAY**

SURVEY PLOTTED BY	DATE
DRAWN BY	
DESIGNED BY	
QUANTITIES BY	
CHECKED BY	
ORIGINAL PLAN	
NOTE BOOK	
NO.	

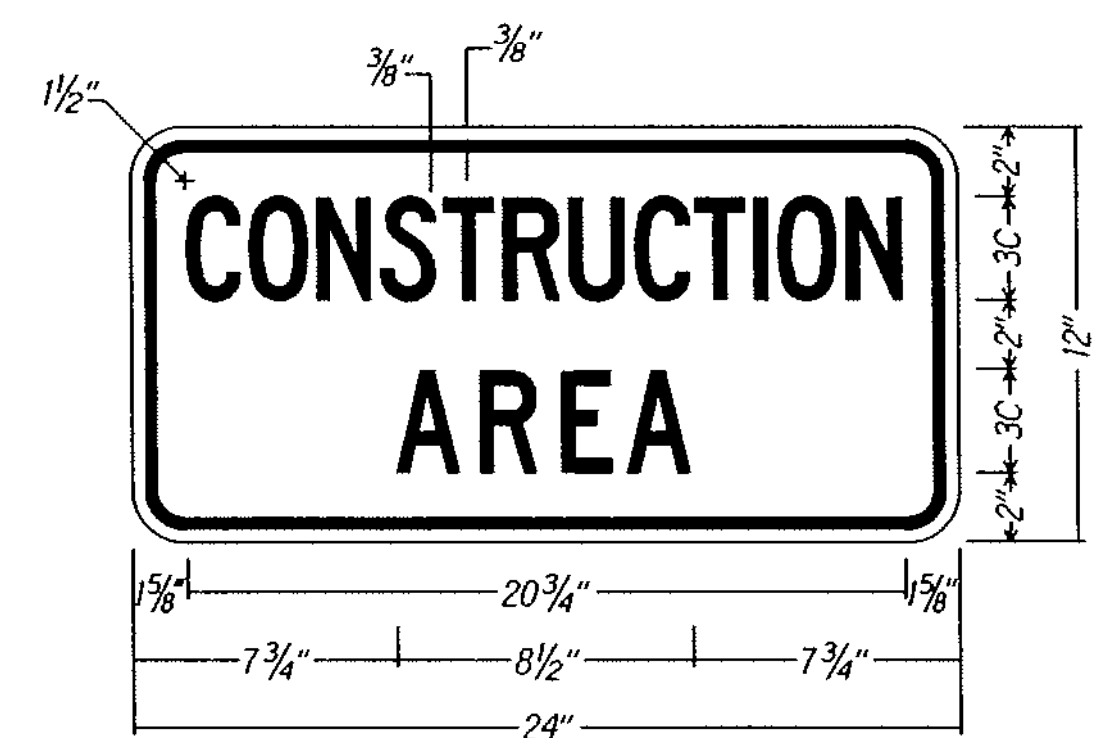

LEGEND: BLACK
BACKGROUND: ORANGE

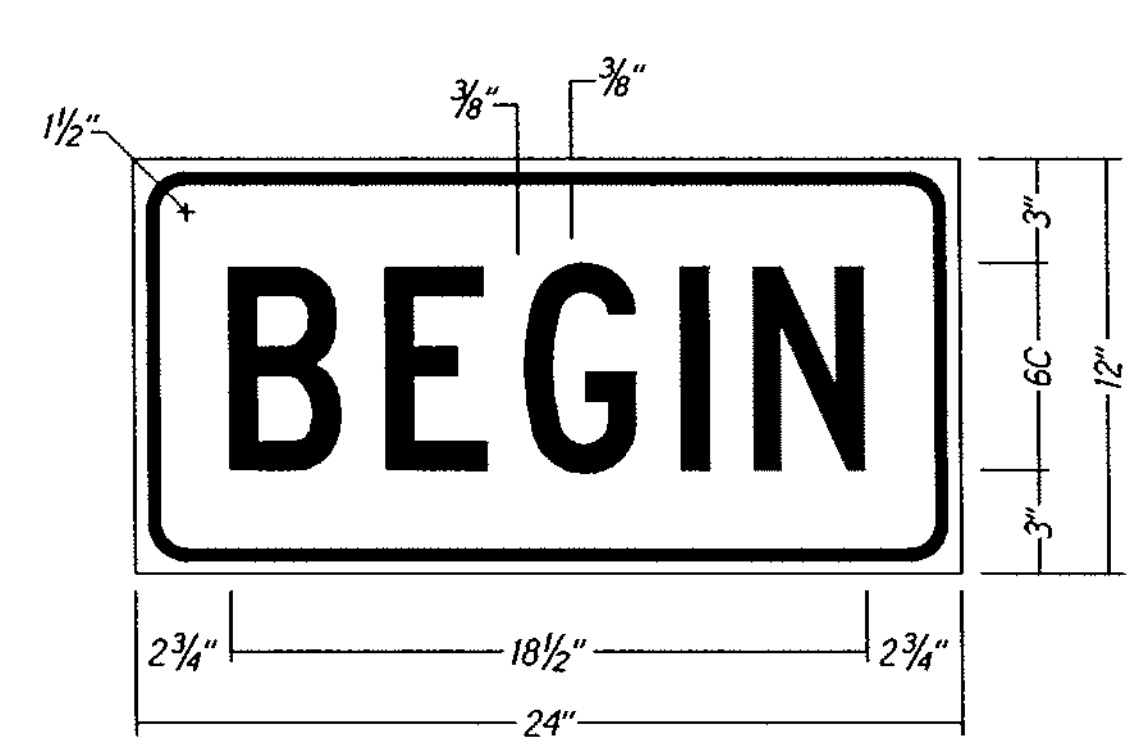

LEGEND: BLACK
BACKGROUND: ORANGE

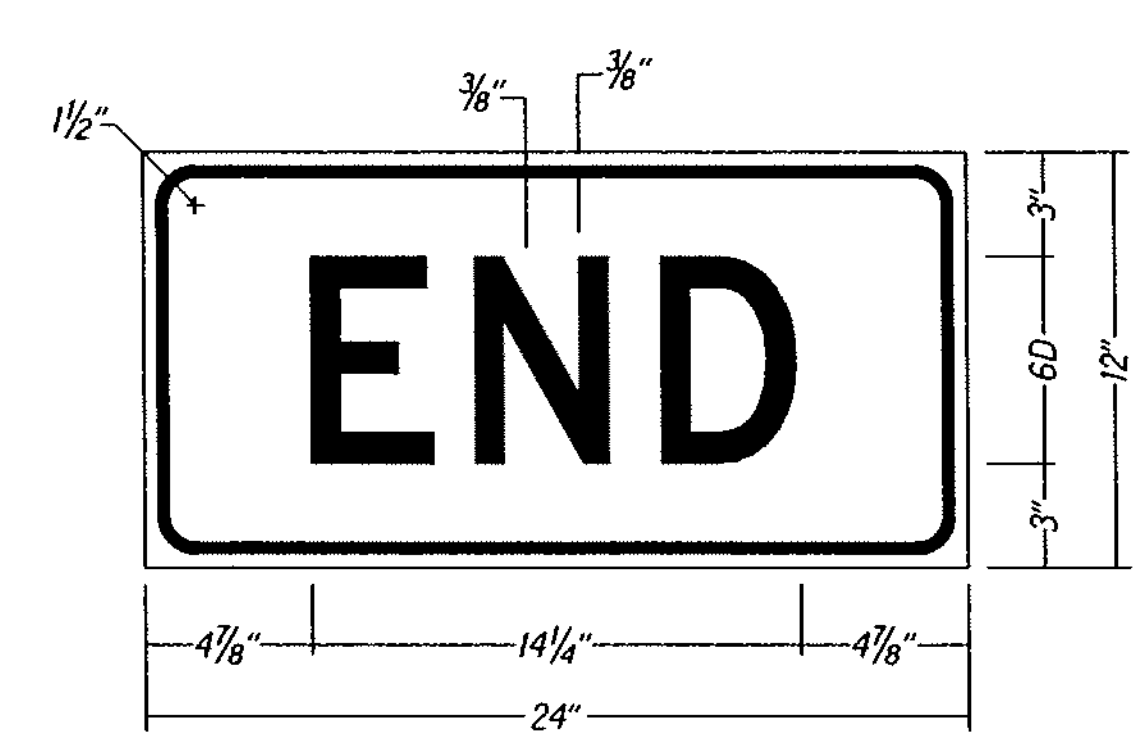

LEGEND: BLACK
BACKGROUND: ORANGE

STATE OF HAWAII
DEPARTMENT OF TRANSPORTATION
HIGHWAYS DIVISION

**LOW SPEED UNDIVIDED HIGHWAY
WORK ZONE SIGNING PLAN, NOTES & DETAILS**

KUHIO HIGHWAY DRAINAGE IMPV'T.
Vicinity of Kapule Highway
Project No. 56A-03-21

Scale: Not to Scale Date: September 2021

SHEET No. 1 OF 1 SHEETS