

FED. ROAD DIST. NO.	STATE	FED. AID PROJ. NO.	FISCAL YEAR	SHEET NO.	TOTAL SHEETS
HAWAII	HAW.	STP-056-1(49)	2006	17	31

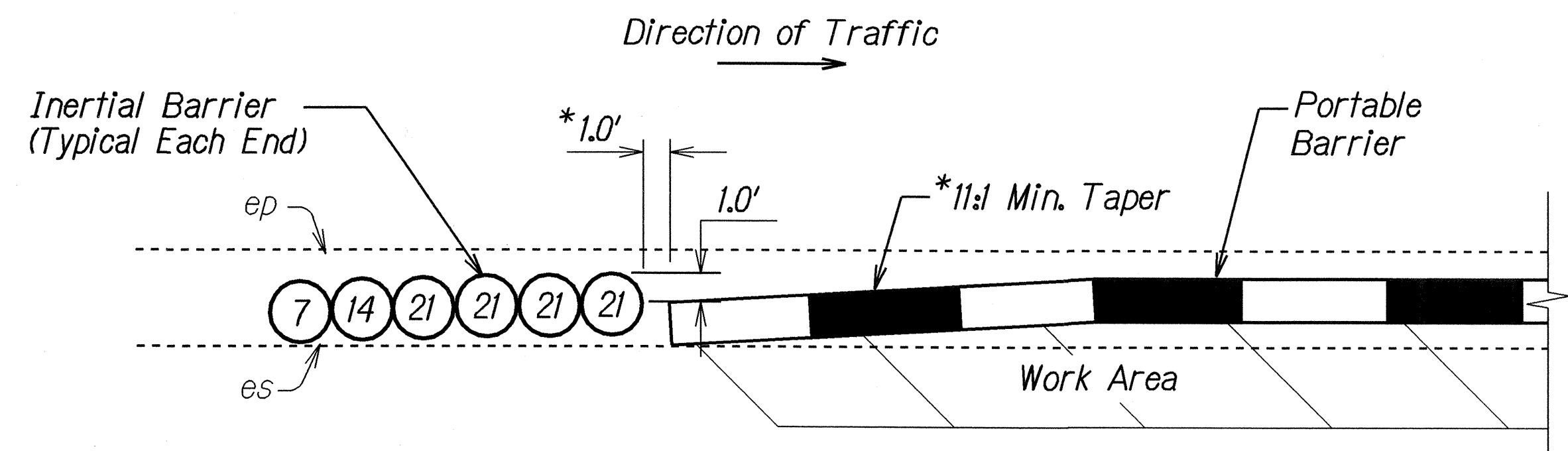

NOTE: The numbers inside the circle indicate weight of sand in 100 lb unit. Installation shall conform to Manufacturer's recommendations.

**TYPICAL DETAIL**  
**6-MODULE INERTIAL BARRIER**  
Not to Scale

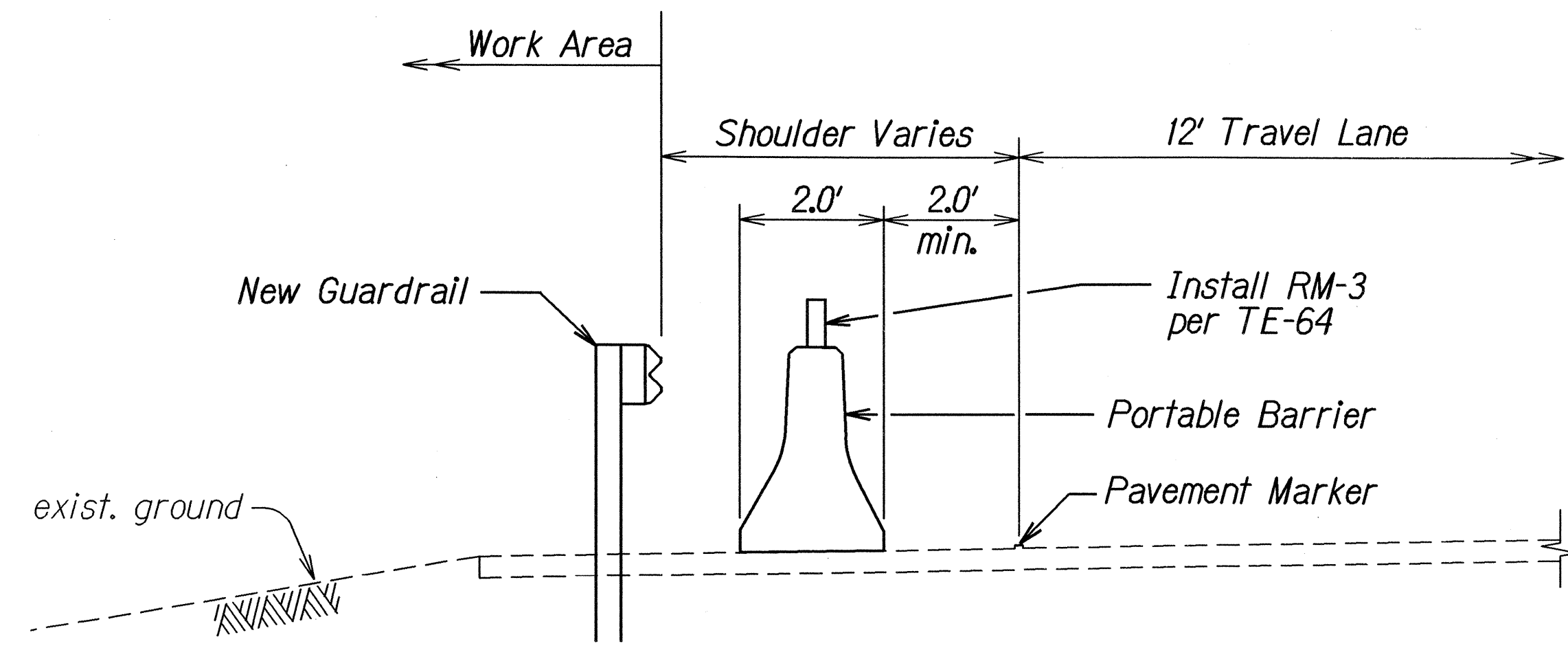

**TYPICAL DETAIL**  
**PORTABLE BARRIER**  
Not to Scale

**NOTES:**

- Typical layout will vary based on speed and manufacturer of system used. Installation shall conform to Manufacturer's recommendations.
- Physical barriers shall be required whenever guardrails have been removed and will not be reinstalled at the end of the work day. See General Note No. 13 on Plan Sht. No. 3.
- Physical barriers shall be either portable concrete barriers or portable water-filled barriers. Installation of portable water-filled barriers shall conform to Manufacturer's recommendations as dictated by design speed and field conditions.
- Providing, transporting, placing, maintaining, relocating and removing physical barriers shall be considered incidental to the various items of work. See Section 645, TRAFFIC CONTROL DEVICES of the Special Provisions.
- Ends of portable barriers shall be protected with Inertial Barriers as shown above. Furnishing and installing inertial barriers shall be considered incidental to the various contract items.
- Furnishing and installing reflector markers (RM-3) over the portable barriers shall be considered incidental to the various contract items.

ORIGINAL PLAN	SURVEY PLOTTED BY	DATE
NOTE BOOK	DRAWN BY	
DESIGNED BY	CHECKED BY	
QUANTITIES BY		
CHECKED BY		

STATE OF HAWAII  
DEPARTMENT OF TRANSPORTATION  
HIGHWAYS DIVISION

**PORTABLE PHYSICAL BARRIER**  
  
**KUHIO HIGHWAY**  
Guardrail and Shoulder Improvements  
at Various Locations  
Fed. Aid Project No. STP-056-1(49)  
Scale: As Shown      Date: Oct. 2005

SHEET No. 1 OF 1 SHEETS