

FED. ROAD DIST. NO.	STATE	PROJ. NO.	FISCAL YEAR	SHEET NO.	TOTAL SHEETS
HAWAII	HAW.	56A-01-04M	2005	20	48

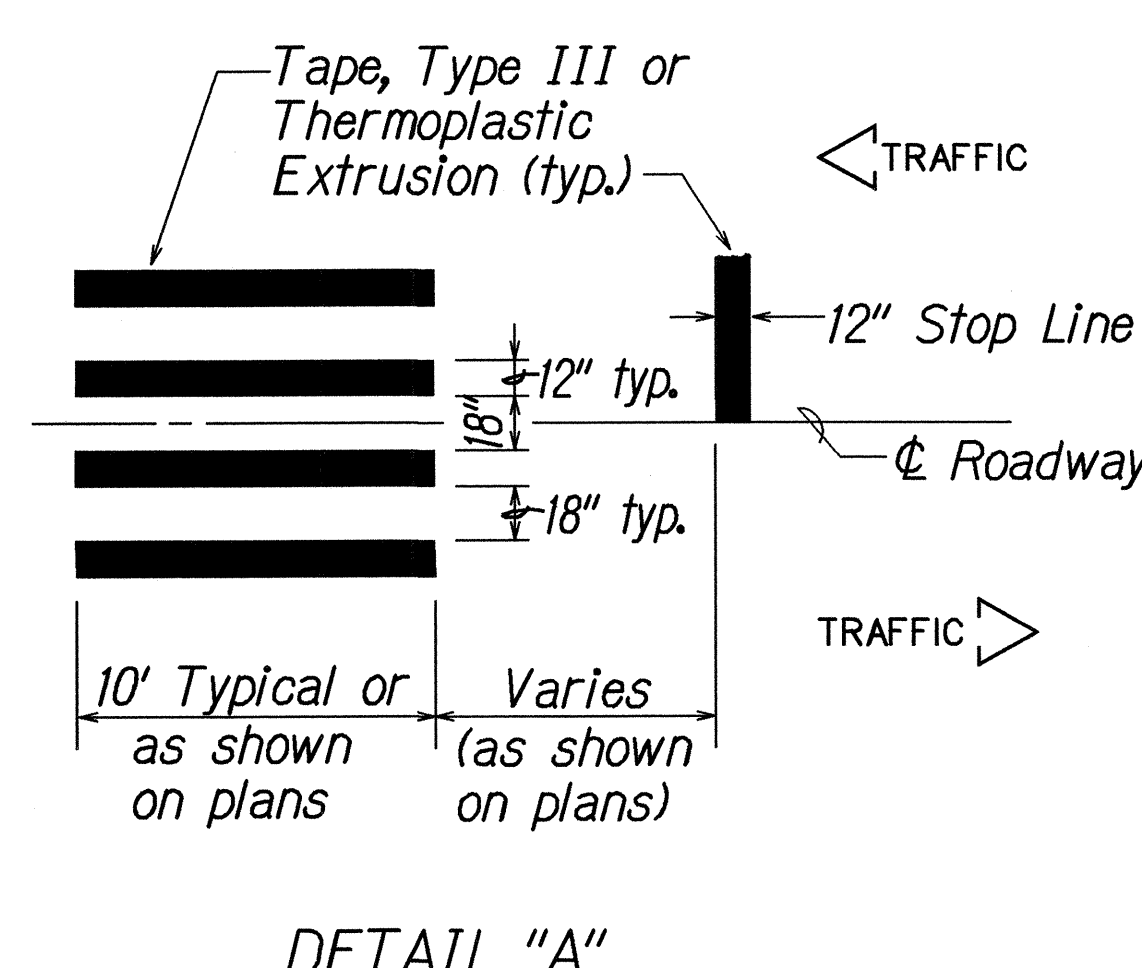

CROSSWALK STRIPING DETAIL

NOTE:
Longitudinal lines shall be parallel to traffic flow.

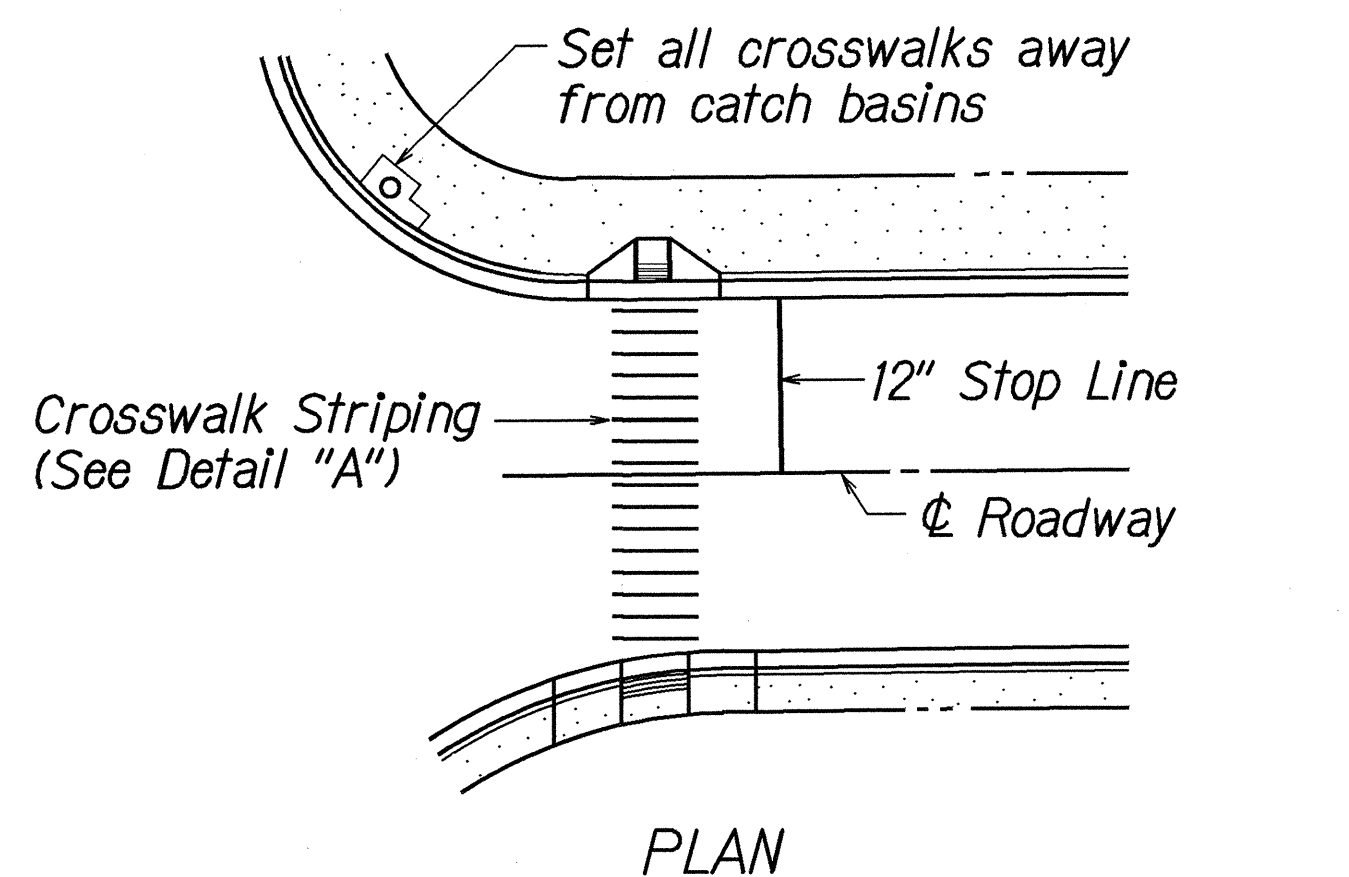
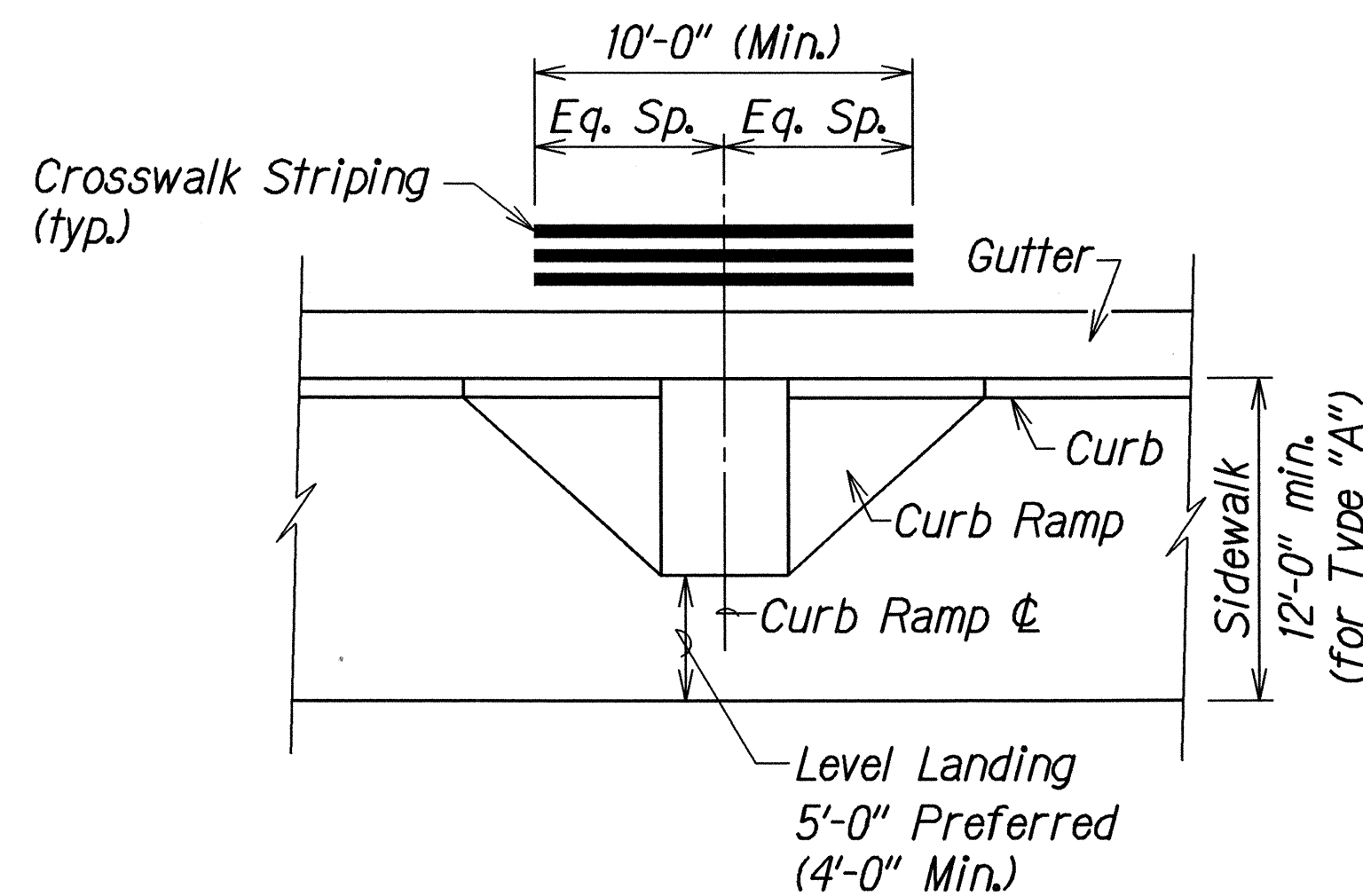

TYPICAL CROSSWALK STRIPING AT CURB RAMP

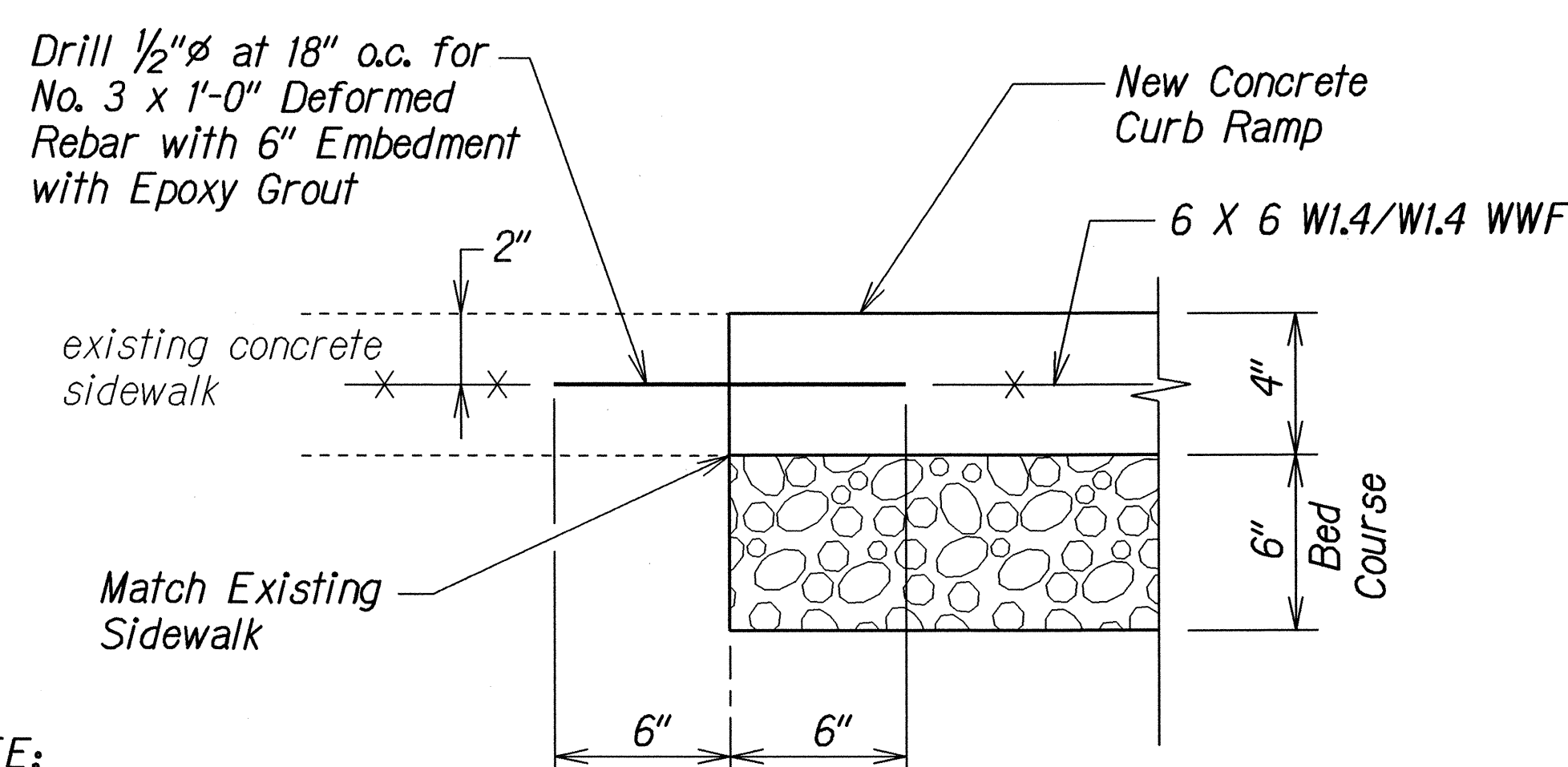

NOTE:
All curb ramps shall be reinforced.

TYPICAL CONSTRUCTION JOINT AT EXISTING SIDEWALK

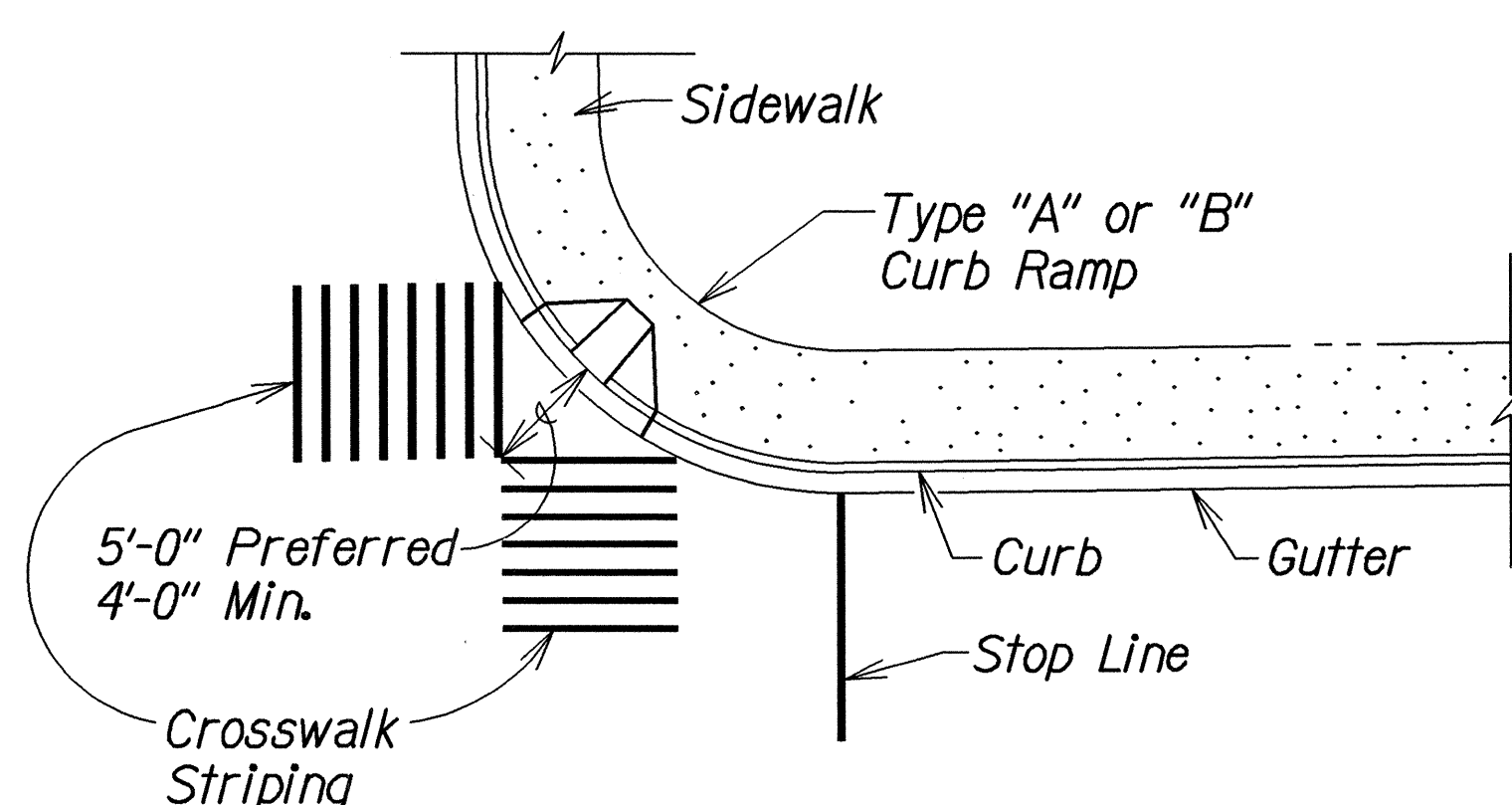

TYPICAL CROSSWALK STRIPING AT DIAGONAL CURB RAMP

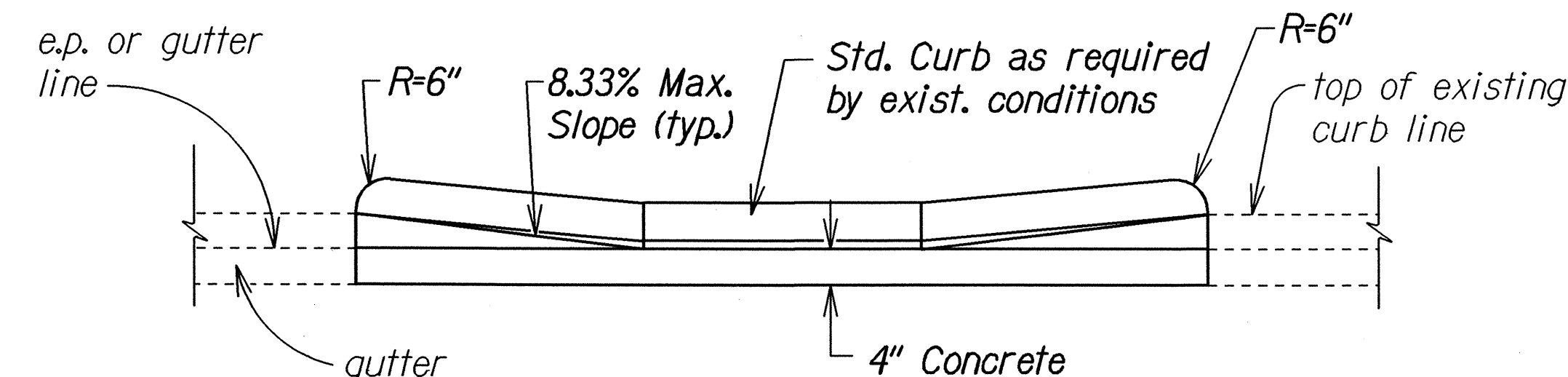
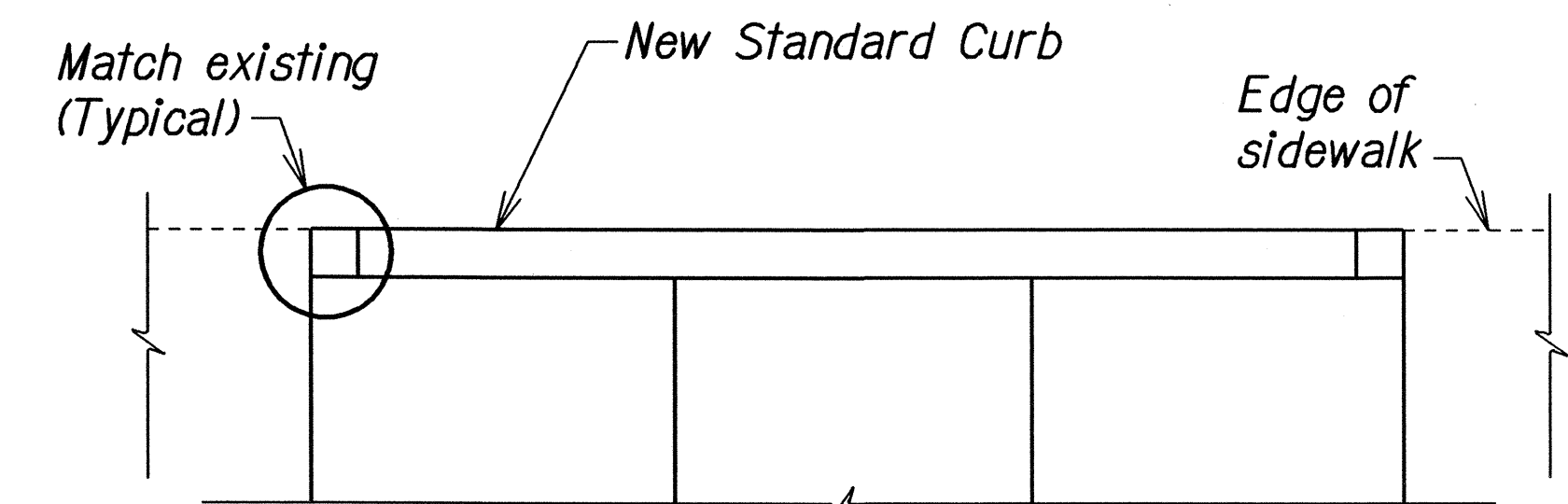

ELEVATION

DETAIL - BACK CURB

NOTE:
This detail can be used in situations where the edge of sidewalk cannot be flush with the face of (back) curb due to right of way restrictions.

ORIGINAL PLAN	DATE	2/27/04
DRAWN BY		
DESIGNED BY		
NOTED BY		
CHECKED BY		

STATE OF HAWAII
DEPARTMENT OF TRANSPORTATION
HIGHWAYS DIVISION

MISCELLANEOUS DETAILS
KUHIO HIGHWAY RESURFACING
Vicinity of Hanamaulu
Project No. 56A-01-04M

Not to Scale
Date: June 2004

SHEET No. 1 OF 1 SHEETS