

Diagram illustrating the cross-section of a sidewalk or pavement structure. The structure is shown as a rectangular slab with a width of 6 feet and a depth of 6 feet. The slab is supported by a 6 x 6 w 1.4/w 1.4 WWF (Wide Flange) beam. The slab is divided into sections by transverse joints, with a width of 1/8 inch for the transverse joints. The slab is labeled "Sidewalk or Pavement". The dimensions are labeled as follows:

- Width: 6'
- Depth: 6'
- Transverse Joints: 1/8" Width Transverse Weakened Plane Joints
- Slab Width: A
- Slab Depth: B
- Joint Width: d = 1"
- Support Beam: 6 x 6 w 1.4/w 1.4 WWF

Diagram illustrating the cross-section of a reinforced concrete beam with a 6x6 W8F steel column. The beam has a total width of 12 inches (6 inches on each side of the column) and a height of 4 inches. It is reinforced with 3/8 inch diameter x 12 inch deformed bars spaced at 18 inches on center. The diagram shows the column, the beam, and the reinforcement bars with dimensions and labels.

Diagram illustrating the cross-section detail of the sidewalk and gutter assembly. The assembly includes a 4" concrete sidewalk with 6x6 w/1.4/w/1.4 WWF, a 4" bedcourse, and a gutter. The gutter is labeled "curb & gutter". The sidewalk is labeled "4" Concrete Sidewalk w/ 6x6 w/1.4/w/1.4 WWF". The bedcourse is labeled "4" Bedcourse". The gutter is labeled "curb & gutter". The gutter is labeled "6'-0\"". The gutter is labeled "Butt Joint". The gutter is labeled "2%". The gutter is labeled "6" Max.". The gutter is labeled "Dress Sidewalk See Note this Sheet". The gutter is labeled "existing ground".

1. *Cast-In-Place P.C.C. gutters shall be longitudinally broom finished.*
2. *The top of all types of concrete curbs, including driveway curbs shall be longitudinally broom finished.*
3. *For A.C. pavement areas, use the same thickness as A.C.+A.C.B. but not less than 10"*

1. Dressing of sidewalk shall consist of clearing, grubbing, grading, reshaping and compacting the area adjacent to the improvement with suitable material as shown on the plans and/or as directed by the Engineer. Asphalt concrete removed from cold planing, reconstruction, or roadway excavation shall not be used for dressing of shoulders or sidewalk. This work shall be considered incidental to the new sidewalk.
2. Ramp sidewalk shall be paid under Item No. 650.0200 - Ramp Sidewalk at Driveway.

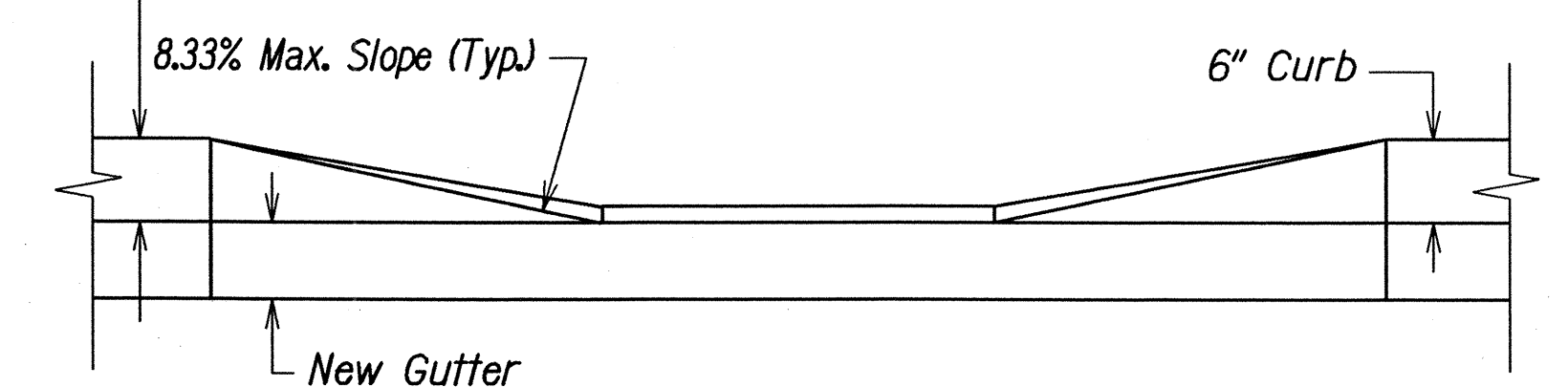
~~Sta. 4+55± TO Sta. 4+95±~~

6/17/03	Revised limits for Sidewalk with Curb and Gutter. Revised Ramp Sidewalk at Driveway Detail.
DATE	REVISION

STATE OF HAWAII  
DEPARTMENT OF TRANSPORTATION  
HIGHWAYS DIVISION

**SIDEWALK, CURB AND GUTTER DETAILS**

**KUHIO HIGHWAY RESURFACING**

**Vicinity of Kealia**

**Project No. 56B-01-01M**

Not to Scale Date: May, 2003

SHEET No. 1 OF 1 SHEETS



FED. ROAD DIST. NO.	STATE	PROJ. NO.	FISCAL YEAR	SHEET NO.	TOTAL SHEETS
HAWAII	HAW.	56B-01-01M	2003	10	34

**NOTES:**

1. Detectable warnings shall be 24 inches in the direction of travel and extend the full width of the curb ramp or flush surface (does not include flares).
2. Truncated domes shall have a diameter of 0.9 inch at the bottom, a diameter of 0.4 inch at the top, a height of 0.2 inch and a center-to-center spacing of 2.35 inches measured along one side of a square arrangement.
3. Domes shall be aligned on a square grid in the predominant direction of travel to permit wheels to roll between the domes.
4. There shall be a minimum of 70 percent contrast in light reflectance between the detectable warning and an adjoining surface, or the detectable warning shall be "safety yellow".
5. The material used to provide visual contrast shall be an integral part of the detectable warning surface.
6. The detectable warning shall be located so that the edge nearest the curb line or other potential hazard is 6 to 8 inches from the curb line or other potential hazard, such as a reflecting pool edge or the edge of a transit platform.
7. The cost to furnish and install the detectable warning shall be considered incidental to Item No. 650.0100 - Curb Ramp, Modified Type "D".

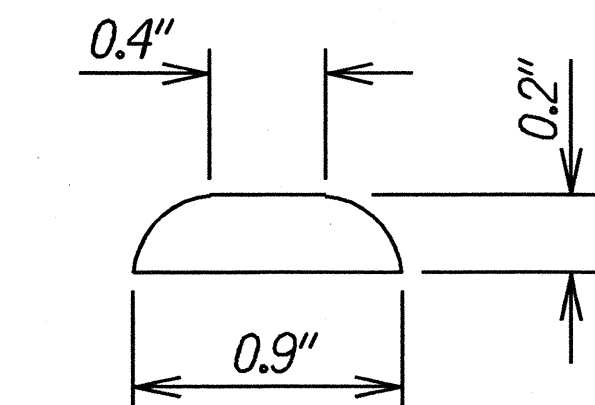
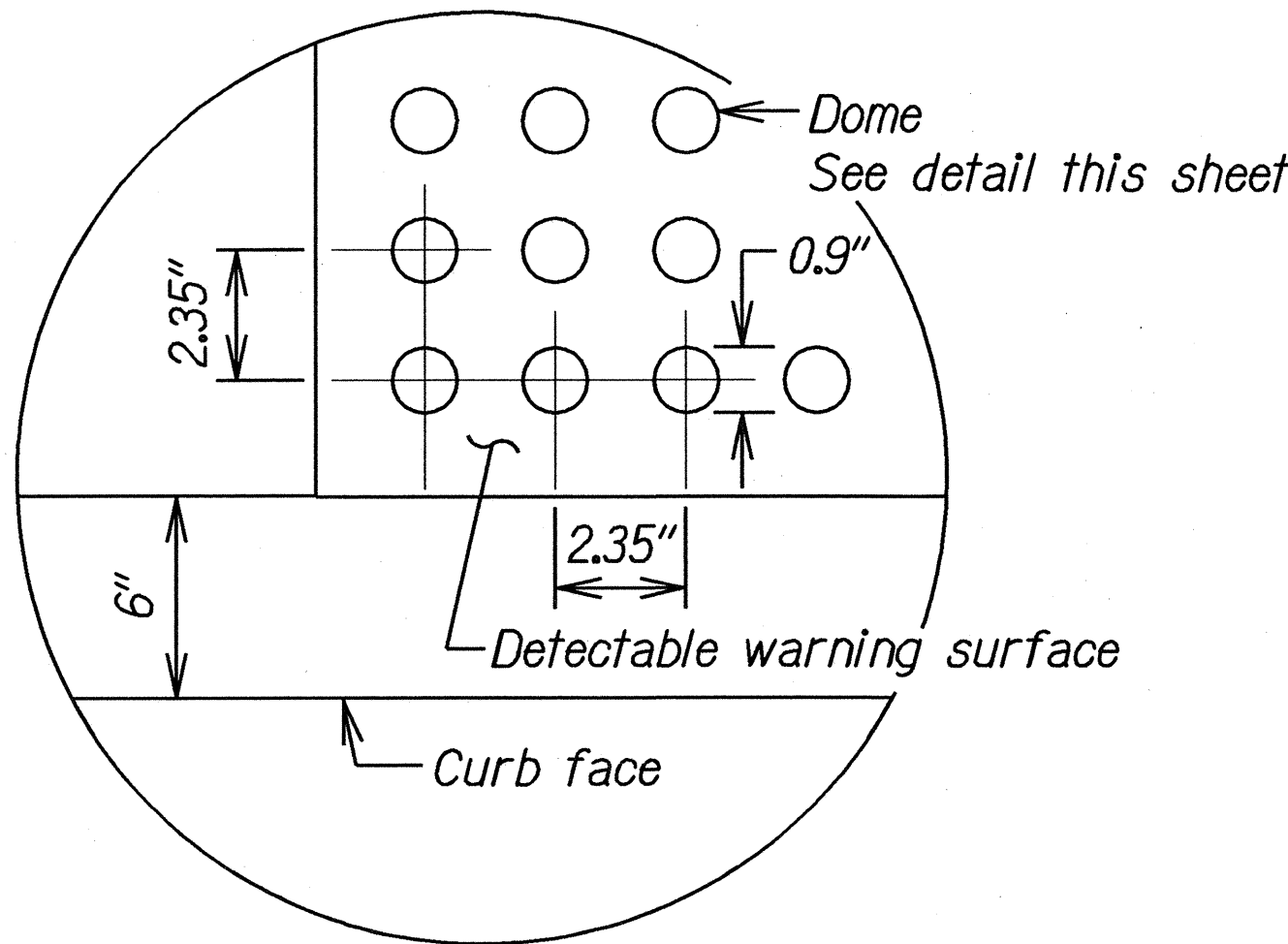

DOMES SECTION

ENLARGEMENT

DETECTABLE WARNING DETAIL

Not to Scale

ORIGINAL PLAN	SURVEY PLOTTED BY	DATE
NOTE BOOK	DRAWN BY	
10/1/03	TRACED BY	
defect	CHECKED BY	

STATE OF HAWAII  
DEPARTMENT OF TRANSPORTATION  
HIGHWAYS DIVISION

***DETECTABLE WARNING DETAILS***

***KUHIO HIGHWAY RESURFACING***

***Vicinity of Kealia***

***Project Nos. 56B-01-01M***

*Not to Scale*

*Date: May, 2003*

SHEET No. 1

OF 1

SHEETS