

FED. ROAD DIST. NO.	STATE	FEDERAL-AID PROJ. NO.	FISCAL YEAR	SHEET NO.	TOTAL SHEETS
HAWAII	HAW.	CMAQ-056-1(47)	2003	6	50

LEGEND

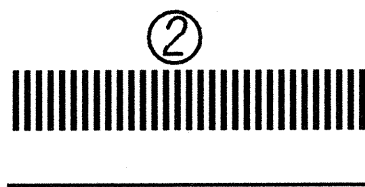

Crosswalk and Stop Line. All Stop Lines shall be 10'-0" from Crosswalk unless otherwise noted. The circled number indicates the number of lanes for payment (Tape, Type III or Thermoplastic Extrusion)

NOTES

- Layout of crosswalks and striping shall be done by the Contractor and approved by the Engineer prior to any installation work.
- Existing crosswalks not incorporated in the final traffic pattern shall be removed as directed by the Engineer. Costs shall be incidental to the various contract items.
- Final locations of all signs shall be approved by the Engineer prior to any installation work.
- All crosswalk striping shall be as noted on the legend or plans.
- All preformed pavement marking tapes over existing pavement shall be applied with an approved primer as recommended by the tape manufacturer and as approved by the Engineer. The primer shall be allowed to dry to the tacky tacky stage prior to application.
- All sign panels shall conform to Section 621 of Special Provisions and the latest editions and amendments of the following FHWA publications:
  - "Manual on Uniform Traffic Control Devices fro Street and Highways"(MUTCD)
  - "Standard Highway Signs"
  - "Standard Allhabets for Highway Signs"
- The Contractor shall erect at the beginning of the project and at the end of the project advance construction warning signs placed as indicated hereon or as directed by the Engineer for the duration of the highway project and shall be maintained by the Contractor. These signs shall be placed in addition to the required traffic control signs called for in Section 645-Traffic Control. The advance construction warning signs shall be new and become the property of the State. The Contractor shall remove, clean, and deliver the signs and posts to the Kauai District Baseyard , in Kapaa, upon completion of the project.
- Warning Signs (W-11-2, W16-7pL and W16-9p) shall have a black legend and border on a fluorescent yellow-green (retroreflective) background.
- Removal and disposal of pavement markings, extension of centerline pavement markings and replacement of damaged pavement markings, whether or not shown on the plans, shall be considered incidental to the various contract items.

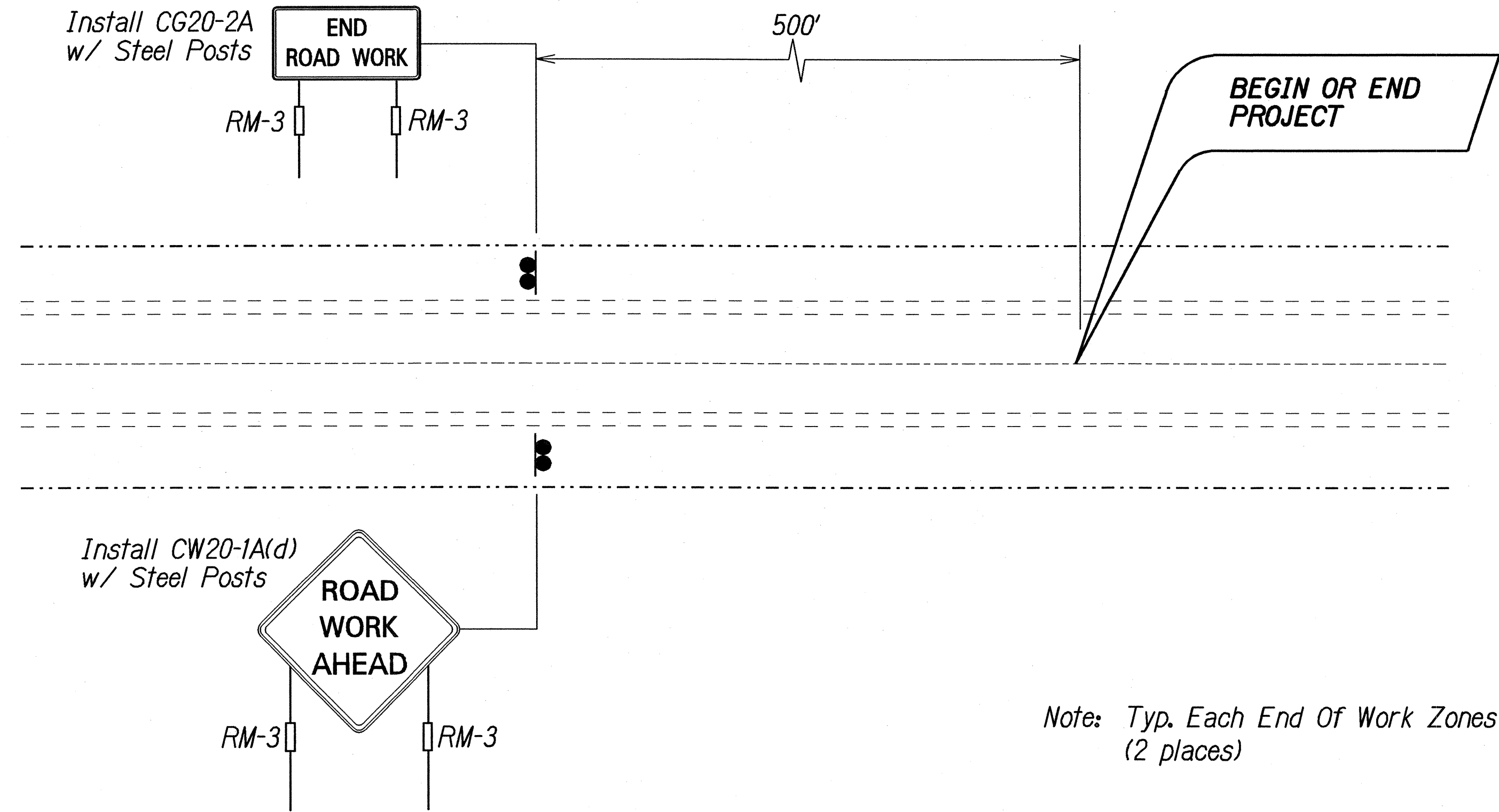

Note: Typ. Each End Of Work Zones (2 places)

ROAD WORK SIGN DETAIL  
STA. 0+00 & 50+00

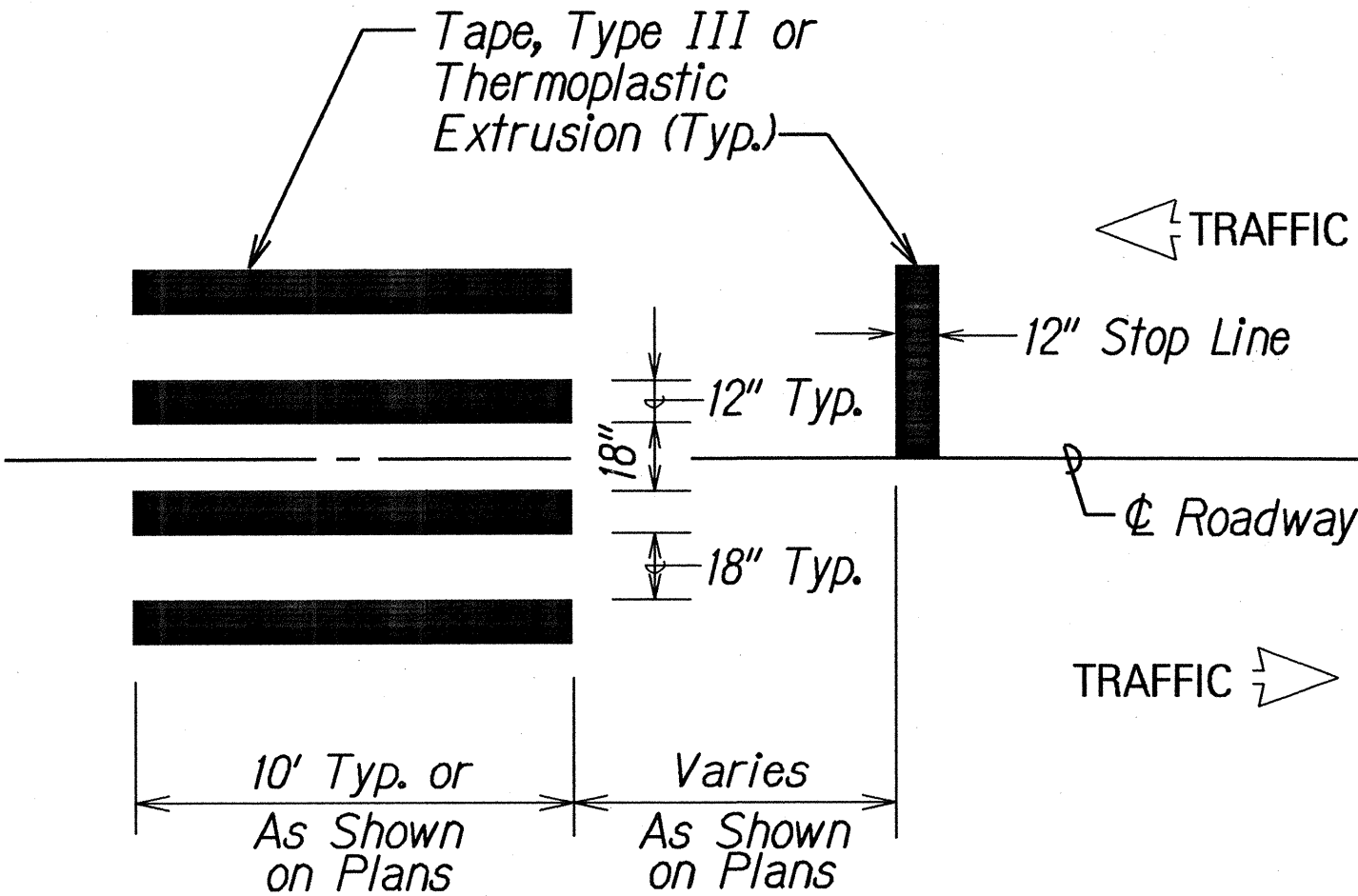

CROSSWALK STRIPING DETAIL  
Not to Scale

Note: Longitudinal lines shall be parallel to traffic flow.

STATE OF HAWAII

DEPARTMENT OF TRANSPORTATION

HIGHWAYS DIVISION

TRAFFIC MARKING LEGEND,

DETAILS AND NOTES

KUHIO HIGHWAY

Pedestrian Facilities and ADA Compliance

at Various Locations

Federal-Aid Project No. CMAQ-056-1(47)

Not to Scale

Date: March 2003