

FED. ROAD DIST. NO.	STATE	PROJ. NO.	FISCAL YEAR	SHEET NO.	TOTAL SHEETS
HAWAII	HAW.	56A-01-00M	2003	16	42

TRUE NORTH  
SCALE: 1" = 20'

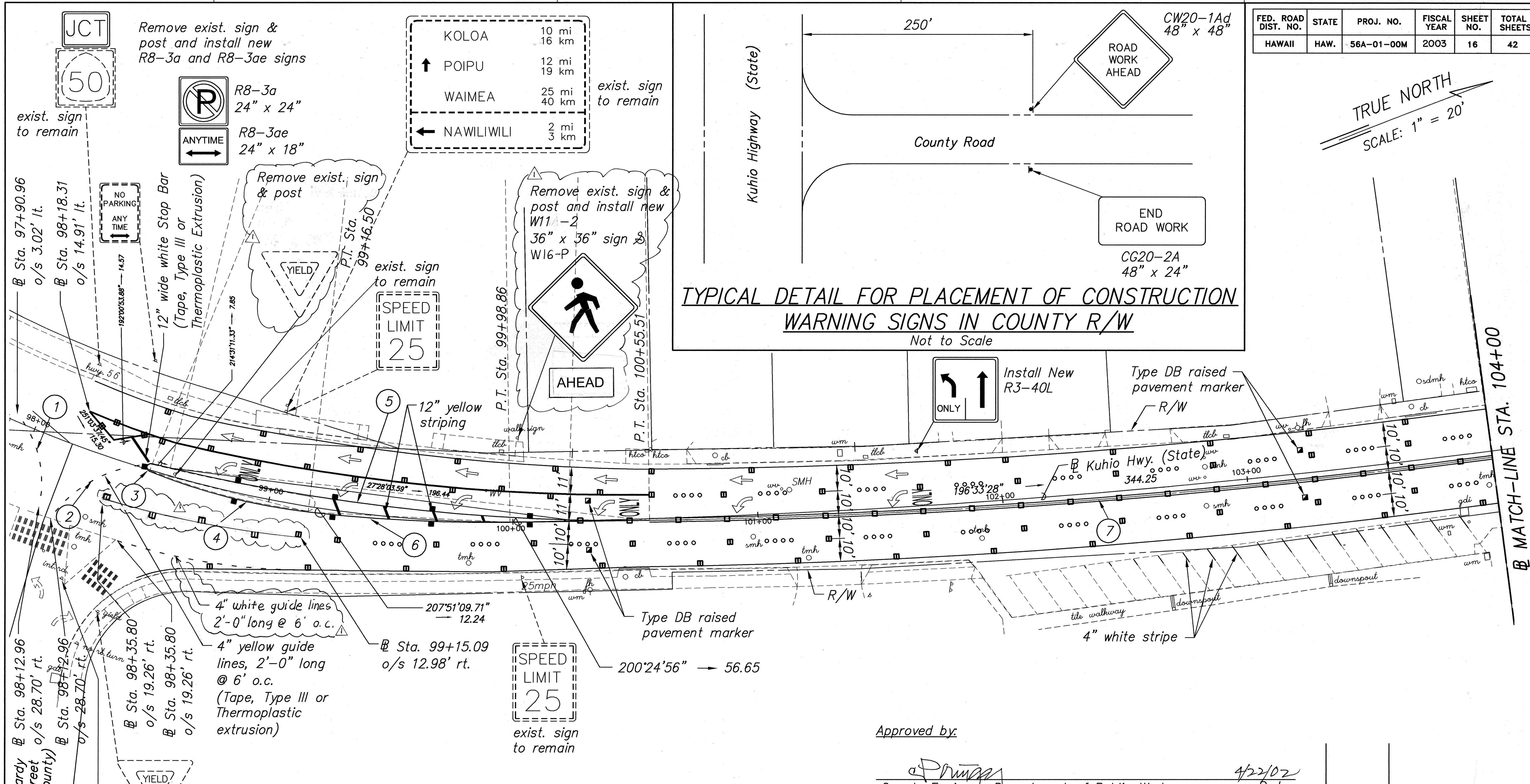

**PAVEMENT MARKING, STRIPING, & SIGNING PLAN**

1" = 20'-0"

CURVE	1	2	3	4	5	6	7
Δ	51°52'00"	45°40'57"	12°18'14"	15°31'14"	14°06'15"	7°26'14"	7°02'56"
Δ/2	25°56'00"	22°50'28.5"	6°09'07"	7°45'37"	7°03'07.5"	3°43'07"	3°31'28"
R	40.28	52.00	1.65	248.00	800.00	635.96	2800.00
T	21.64	21.90	1.53	33.80	98.97	41.33	172.45
C	38.92	40.37	2.25	66.98	196.43	82.49	344.25
Lc	38.22	41.46	2.47	67.18	196.93	82.55	344.47

Approved by:

*[Signature]*  
County Engineer, Department of Public Works  
County Of Kauai  
(For Work Within County R/W)

4/22/02  
Date

DATE	REVISION
12/3/2002	Revised Signs & Striping

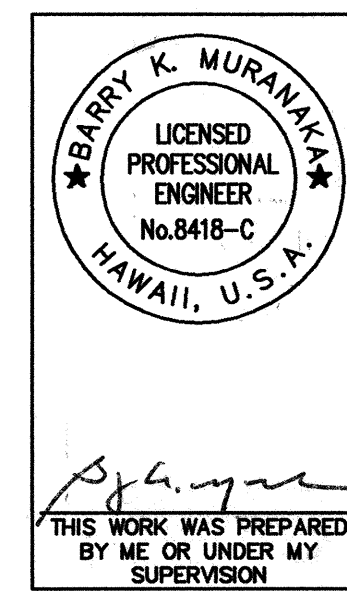

STATE OF HAWAII  
DEPARTMENT OF TRANSPORTATION  
HIGHWAYS DIVISION  
**PAVEMENT MARKING, STRIPING, & SIGNING PLAN**  
KUHIO HIGHWAY RESURFACING  
HARDY ST. TO KUENE RD.  
Project No. 56A-01-00M  
Scale: As shown Date: NOV. 2000  
SHEET No. 3 OF 12 SHEETS

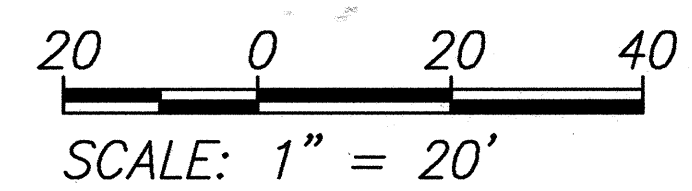

P.M.: BKM  
CURRENT OPR: mkf  
PREV. OPR:  
CURRENT TIME: Mar 25, 2002 - 2:22pm  
LAST SAVED BY: sai  
LAST MODIFIED: Thu, 20 Dec 2001 - 11:04am

PREFIX: G:\Coe9901\Accd\  
FILE: COE99110.dwg  
BEGN: 3/31/2000  
SCALE: 1=1

ORIGINAL SURVEY PLOTTED BY	DATE
DRAWN BY	
DESIGNED BY	
CHECKED BY	
NOTED BY	
NO.	

Remove exist. sign & post and install new R1-1 (30" x 30")

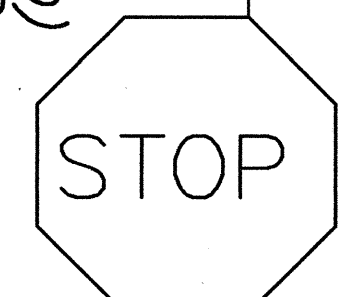

Hardy Street (County)  
Sta. 98+12.96 o/s 28.70' rt.  
Sta. 98+12.96 o/s 28.70' ft.  
Sta. 98+35.80 o/s 19.26' rt.  
Sta. 98+35.80 o/s 19.26' ft.

exist. sign to remain

4" white guide lines 2'-0" long @ 6' o.c.  
4" yellow guide lines 2'-0" long @ 6' o.c. (Tape, Type III or Thermoplastic extrusion)

Sta. 99+15.09 o/s 12.98' rt.

SPEED LIMIT 25  
exist. sign to remain



Remove exist. sign & post and install new W11-2 36" x 36" sign & W16-P

SPEED LIMIT 25  
exist. sign to remain

Remove exist. sign & post

R8-3a 24" x 24"  
R8-3ae 24" x 18"  
ANYTIME

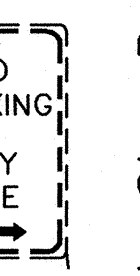

Remove exist. sign & post and install new R8-3a and R8-3ae signs

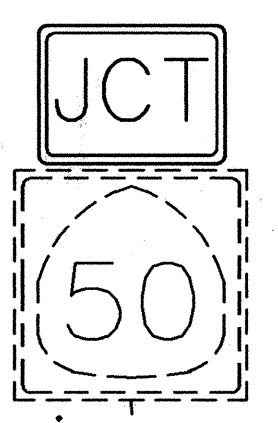

KOLOA 10 mi 16 km  
↑ POIPU 12 mi 19 km  
WAIMEA 25 mi 40 km  
← NAWILIWILI 2 mi 3 km  
exist. sign to remain

TYPICAL DETAIL FOR PLACEMENT OF CONSTRUCTION WARNING SIGNS IN COUNTY R/W  
Not to Scale

END ROAD WORK  
CG20-2A 48" x 24"

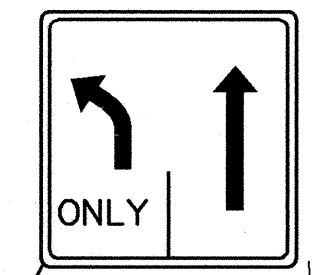

Install New R3-40L

Type DB raised pavement marker R/W

Type DB raised pavement marker

4" white stripe

MATCH-LINE STA. 104+00





FED. ROAD DIST. NO.	STATE	PROJ. NO.	FISCAL YEAR	SHEET NO.	TOTAL SHEETS
HAWAII	HAW.	56A-01-00M	2003	19	42

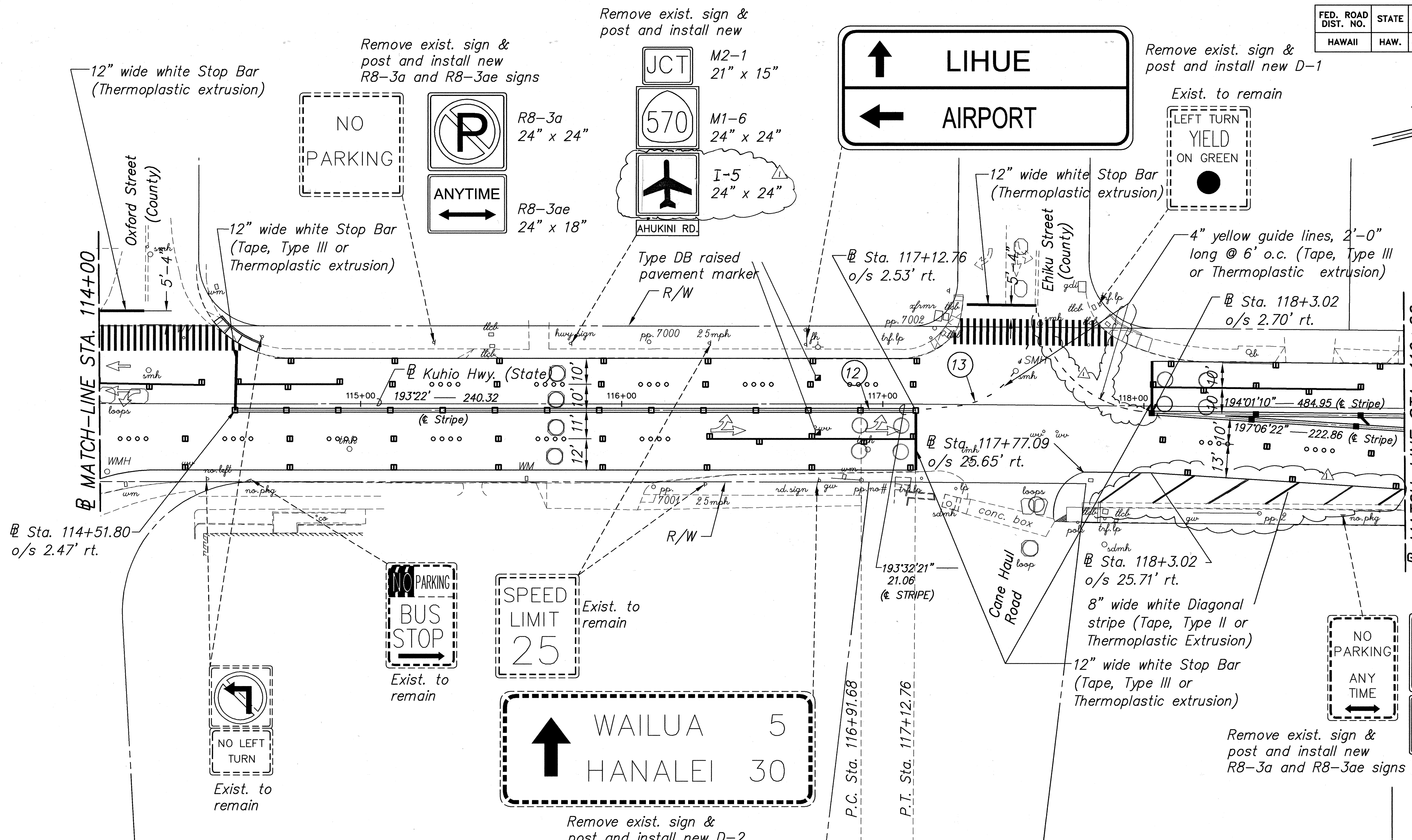

TRUE NORTH  
SCALE: 1" = 20'

P.I.: BKM  
CURRENT OPR: mkf  
PREV. OPR:  
CURRENT TIME: Mar 25, 2002 - 2:38pm  
LAST SAVED BY: sai  
LAST MODIFIED: Thu, 20 Dec 2001 - 1:59pm

PREFIX: G:\Coe9901\Acad\  
FILE: coe99128.dwg  
BEGIN: 3/31/2000  
SCALE: 1=1

ORIGINAL SURVEY PLOTTED BY	DATE
DRAWN BY	
TRACED BY	
DESIGNED BY	
QUANTITIES BY	
CHECKED BY	
NO.	

CURVE	12	13
Δ	0°20'41"	59°01'31"
Δ/2	0°10'20.5"	29°30'46"
R	3500.00	30.00
T	10.53	16.98
C	21.06	29.56
Lc	21.06	30.91

PAVEMENT MARKING, STRIPING, & SIGNING PLAN

1" = 20'-0"

Approved by:  
*[Signature]*  
County Engineer, Department of Public Works  
County Of Kauai  
(For Work Within County R/W)

4/22/02  
Date

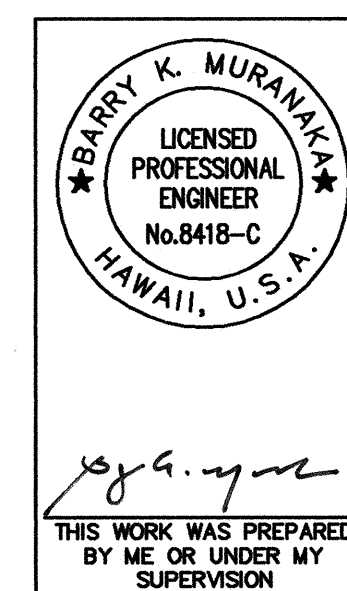
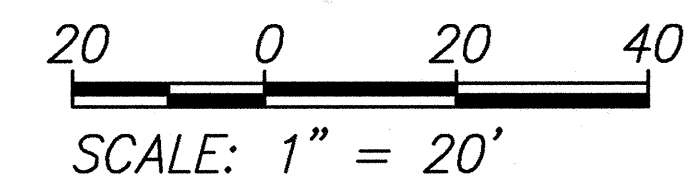

STATE OF HAWAII  
DEPARTMENT OF TRANSPORTATION  
HIGHWAYS DIVISION  
**PAVEMENT MARKING,  
STRIPING, & SIGNING PLAN**  
KUHIO HIGHWAY RESURFACING  
HARDY ST. TO KUENE RD.  
Project No. 56A-01-00M

Scale: As shown Date: NOV. 2000  
SHEET No. 6 OF 12 SHEETS

12/3/2002	Revised Signs & Striping
DATE	REVISION

"AS-BUILT"





