

INDEX TO DRAWINGS	
SHEET NO.	DESCRIPTION
1	TITLE SHEET
2	STANDARD PLANS SUMMARY
3	GENERAL NOTES AND LEGEND
4-5	WATER POLLUTION & EROSION CONTROL NOTES
6	TYPICAL SECTIONS
7	GUARDRAIL DETAILS AND NOTES
8	STRONG POST W-BEAM GUARDRAIL
9	THRIE BEAM & APPURTENANCE DETAILS
10	THRIE BEAM TRANSITION DETAILS
11	PORTABLE PHYSICAL BARRIER
12-13	ROADWAY PLAN
14	PAVEMENT MARKING LEGEND, DETAILS AND NOTES
15-16	PAVEMENT MARKING & TRAFFIC SIGNING PLAN
17	TRAFFIC AND PAVEMENT MARKING SUMMARIES
18-30	STRUCTURAL DRAWINGS

STATE OF HAWAII

DEPARTMENT OF TRANSPORTATION

HIGHWAYS DIVISION

HONOLULU, HAWAII

"AS-BUILT" PLANS FOR

KUHIO HIGHWAY, WAILUA RIVER PLANTATION BRIDGE

REPLACE AND RECONSTRUCT PAVEMENT AND STRUCTURAL SUPPORTS

PROJECT NO. 56A-02-00M

FED. ROAD DIST. NO.	STATE	PROJ. NO.	FISCAL YEAR	SHEET NO.	TOTAL SHEETS
HAWAII	HAW.	56A-02-00M	2002	1	30

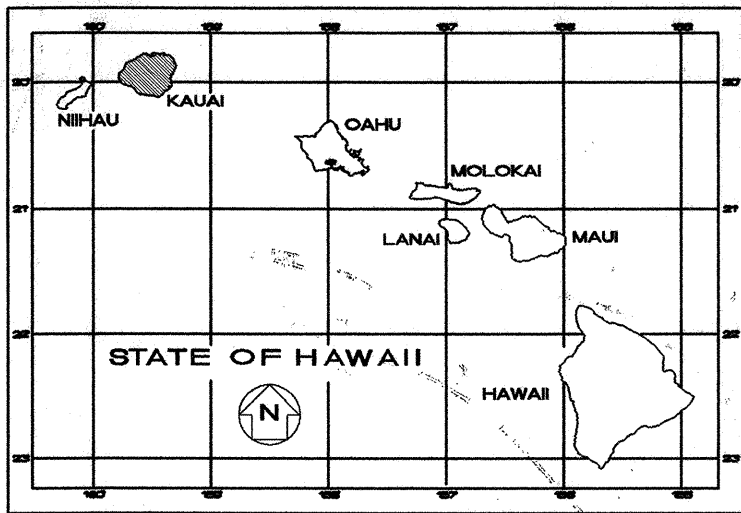

DISTRICTS OF LIHUE AND KAWAIHAU

ISLAND OF KAUAI

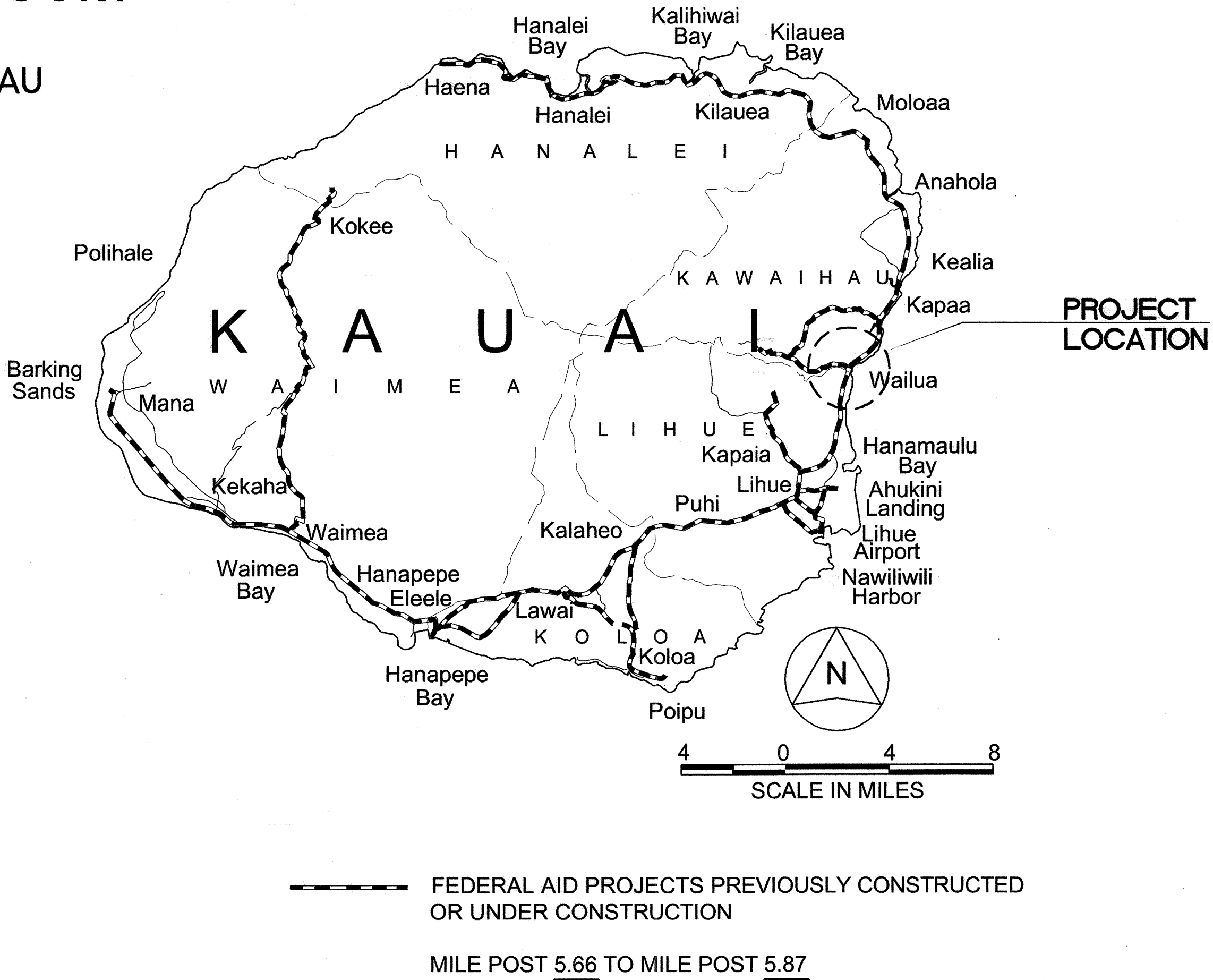
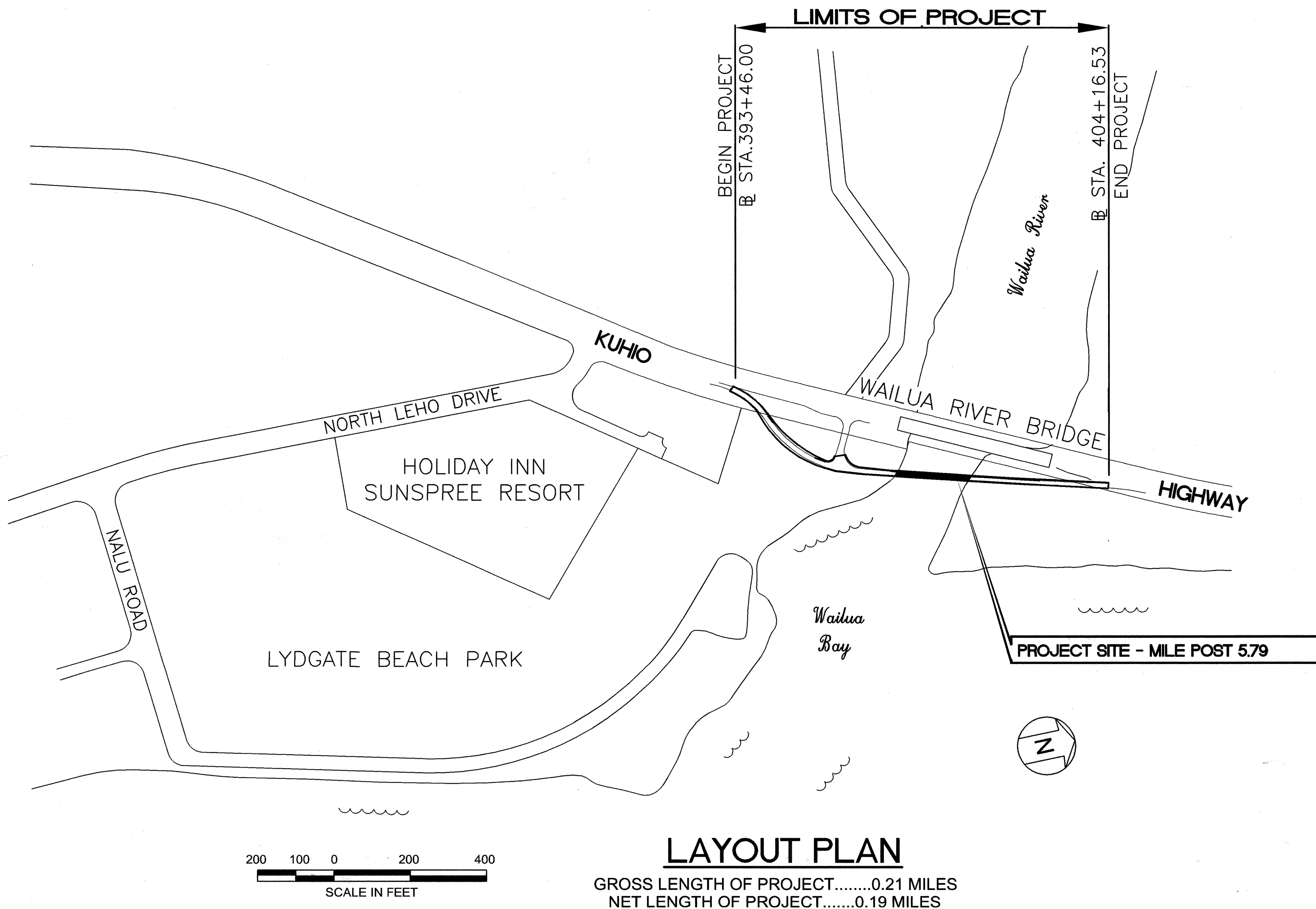

CHANGES MADE DURING CONSTRUCTION HAVE BEEN INCORPORATED ON THESE PLANS EXCEPT CHANGES IN THE ORIGINAL THEORETICAL QUANTITIES. FOR ACTUAL QUANTITIES, REFER TO PROJECT LEDGER AND/OR CONSTRUCTION LOG.

10-24-03

DEPARTMENT OF TRANSPORTATION

STATE OF HAWAII

APPROVED:

6/27/01

DATE

DESIGNED BY

WESLEY R. SEGAWA & ASSOC.

DATE

MAY 2001

PHONE

274-3118

& E:

P. S.