

FED. ROAD DIST. NO.	STATE	PROJ. NO.	FISCAL YEAR	SHEET NO.	TOTAL SHEETS
HAWAII	HAW.	56A-02-00M	2002	11	30

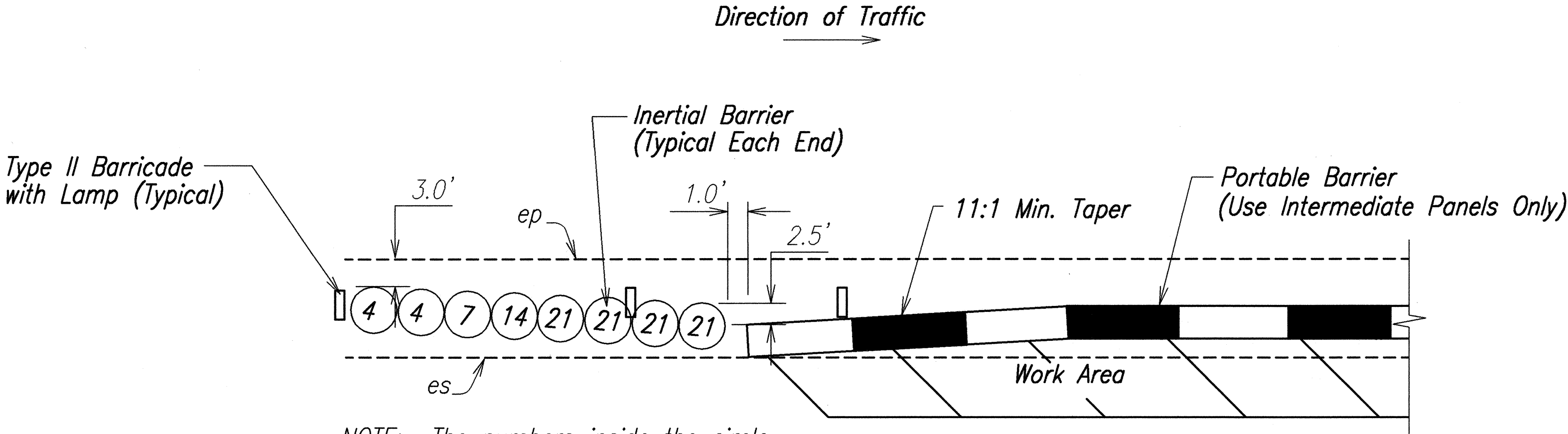

NOTE: The numbers inside the circle indicate weight of sand in 100 lb unit. Installation shall conform to Manufacturer's recommendations.

TYPICAL DETAIL
8-MODULE INERTIAL BARRIER
Not To Scale

NOTES:

- Physical barriers shall be required whenever guardrails have been removed and will not be reinstalled at the end of the work day. See General Note No. 19 on Plan Sht. 3.
- Physical barriers shall be either portable concrete barriers or portable water-filled barriers. Installation and design of portable water-filled barriers shall conform to Manufacturer's recommendations as dictated by design speed and field conditions. Installation of portable concrete barriers shall comply with HDOT and AASHTO standards which includes, but not limited to, a minimum of five (5) portable concrete barriers.
- Providing, transporting, placing, maintaining, relocating and removing physical barriers shall be considered incidental to the various items of work. See Section 645, TRAFFIC CONTROL DEVICES of the Special Provisions.
- Ends of portable barriers shall be protected with inertial barriers as shown hereon. Furnishing, installing and maintaining inertial barriers shall be considered incidental to the various contract items.
- Furnishing, installing and maintaining reflector markers (RM-3) over the portable barriers shall be considered incidental to the various contract items.

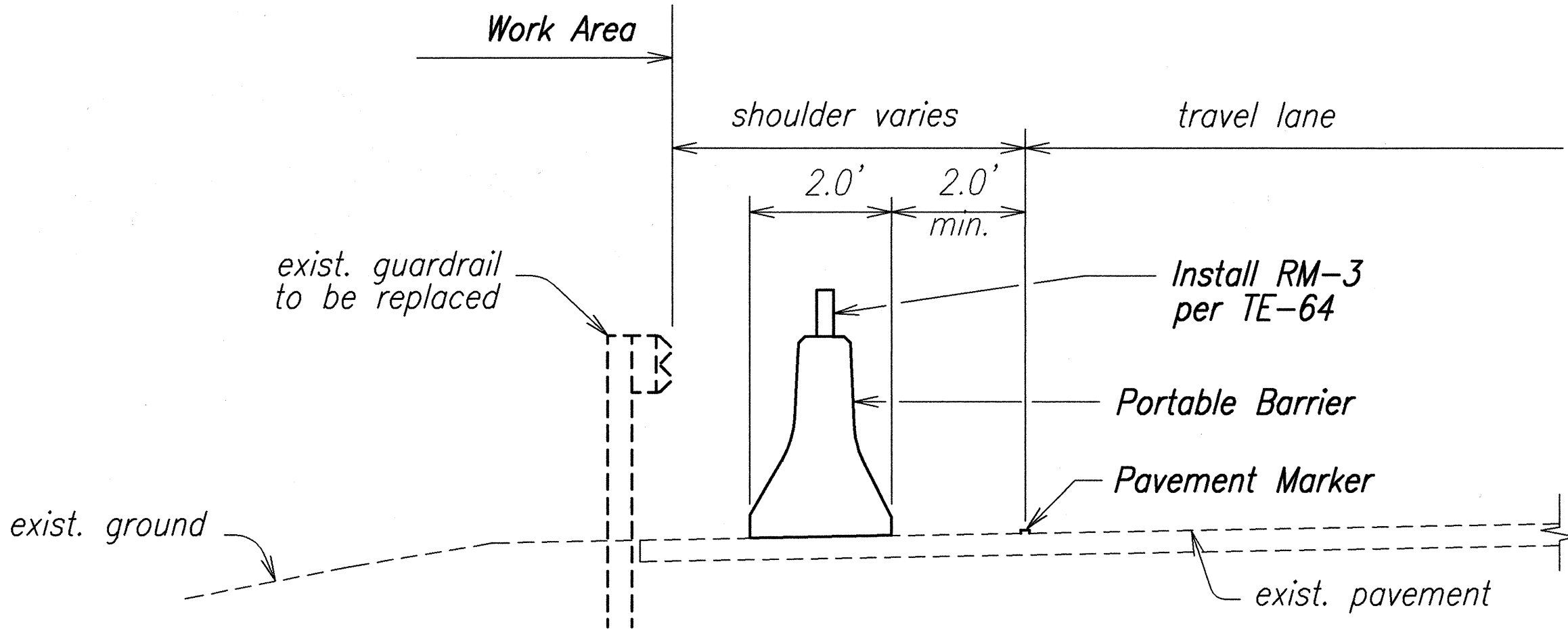

TYPICAL DETAIL
PORTABLE BARRIER
Not To Scale

SURVEY PLOTTED BY	DATE
DRAWN BY	05/14/01
DESIGNED BY	05/14/01
QUANTITIES BY	
CHECKED BY	
ORIGINAL PLAN	
NOTE BOOK	
NO.	

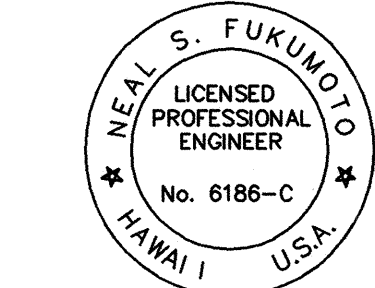

This work was prepared by me or under my supervision.
Wesley R. Segawa
Wesley R. Segawa & Associates, Inc.

STATE OF HAWAII
DEPARTMENT OF TRANSPORTATION
HIGHWAYS DIVISION
PORTABLE PHYSICAL BARRIER
KUHIO HIGHWAY
Wailua River Plantation Bridge
Replace and Reconstruct Pavement
and Structural Supports
Project No. 56A-02-00M
Date: May, 2001

SHEET No. 1 OF 1 SHEETS