

FED. ROAD DIST. NO.	STATE	FED. AID PROJ. NO.	FISCAL YEAR	SHEET NO.	TOTAL SHEETS
HAWAII	HAW.	STP-056-1(43)	2000	13	42

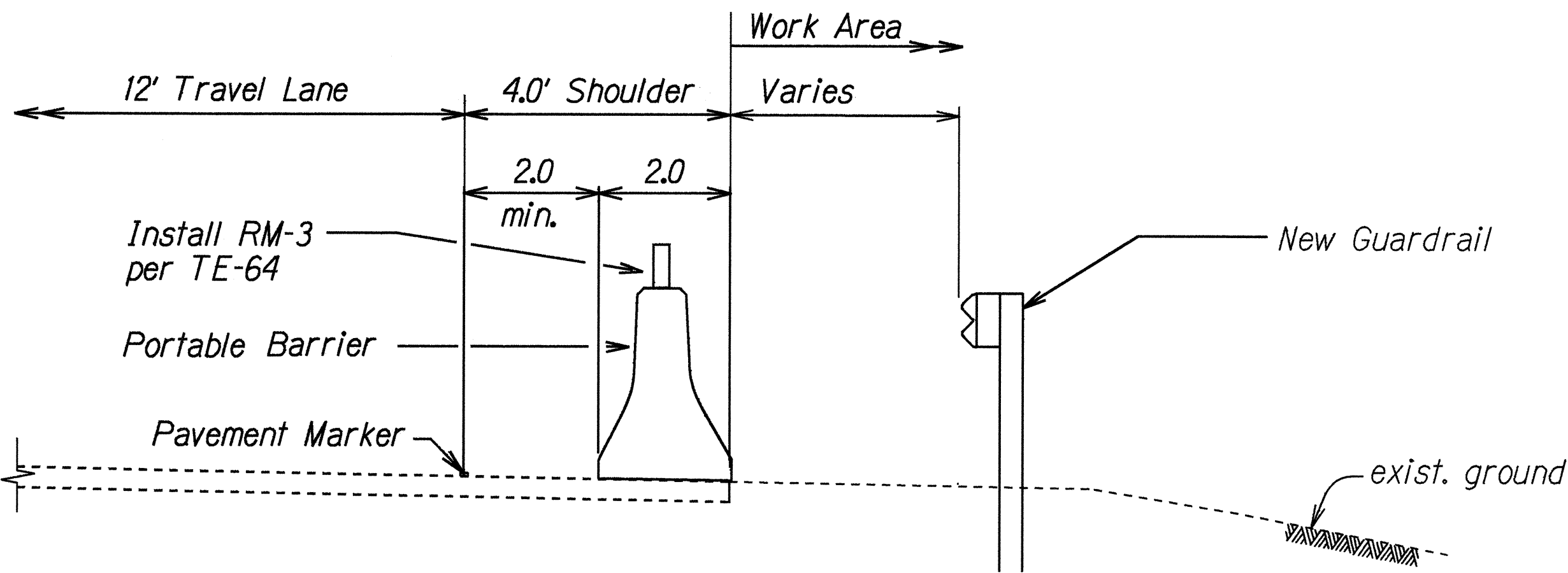

TYPICAL DETAIL
PORTABLE BARRIER
Not To Scale

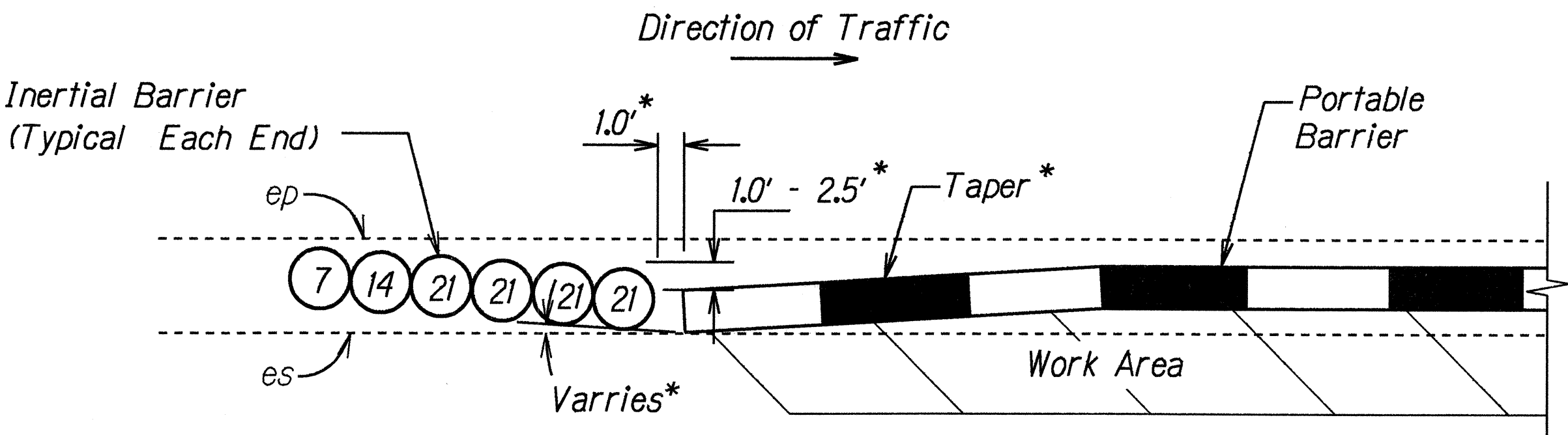

NOTE: The numbers inside the circle indicate weight of sand in 100 lb unit. Installation shall conform to Manufacturer's recommendations.

TYPICAL DETAIL
6-MODULE INERTIAL BARRIER
Not To Scale

NOTES:

- Typical layout will vary based on speed and manufacturer of system used. Installation shall conform to Manufacturer's recommendations
- Physical barriers shall be required whenever guardrails have been removed and will not be reinstalled at the end of the work day. See note 15 of General Notes (Plan Sheet Number 3).
- Physical barriers shall be either portable concrete barriers or portable water filled barriers. Instalation of portable water filled barriers shall conform to Manufacturer's recommendations as dictated by design speed and field conditions.
- Providing, transporting, placing, maintaining, relocating and removal of physical barriers shall be considered incidental to the various items of work. See Section 645, TRAFFIC CONTROL DEVICES of the Special Provisions.
- Ends of portable barriers shall be protected with Inertial Barriers as shown above.

ORIGINAL	SURVEY PLOTTED BY	DATE
ke2/medda	Aug 1998	
ekmsk	DRAWN BY	
ms02.dgn	DESIGNED BY	
	CHECKED BY	

STATE OF HAWAII
DEPARTMENT OF TRANSPORTATION
HIGHWAYS DIVISION

PORTABLE PHYSICAL BARRIER
DETAILS
KUHIO HIGHWAY- Guardrail and Shoulder
Improvements at Various Locations
Fed. Aid Project No. STP-056-1(43)
Scale: As Shown Date: Nov 1998

SHEET No. 1 OF 1 SHEETS