

| INDEX TO DRAWINGS |   |
|-------------------|---|
| SHEET NO.         | DESCRIPTION   |
| 1                 | TITLE SHEET   |
| 2                 | STANDARD PLANS SUMMARY  |
| 3                 | GENERAL NOTES & LEGEND  |
| 4 – 5             | WATER POLLUTION AND EROSION CONTROL NOTES                           |
| 7 – 8             | HISTORIC PRESERVATION, AND ENVIRONMENTAL PROTECTION NOTES           |
| 9                 | TYPICAL SECTION   |
| 10                | CONCRETE MOSS ROCK STAMP PATTERN DETAILS, AND NOTES                 |
| 11 – 13           | MISCELLANEOUS DETAIL  |
| 14                | ROADWAY PLAN  |
| 15                | LOW SPEED UNDIVIDED HIGHWAY WORK ZONE SIGNING PLAN, NOTES & DETAILS |

STATE OF HAWAII

DEPARTMENT OF TRANSPORTATION

HIGHWAYS DIVISION

HONOLULU, HAWAII

PLANS FOR

KUHIO HIGHWAY

CONCRETE BARRIER INSTALLATION

Vicinity of Lanikai Street

PROJECT NO. 56A-01-24M

DISTRICT OF KAWAIIHAU

ISLAND OF KAUAI

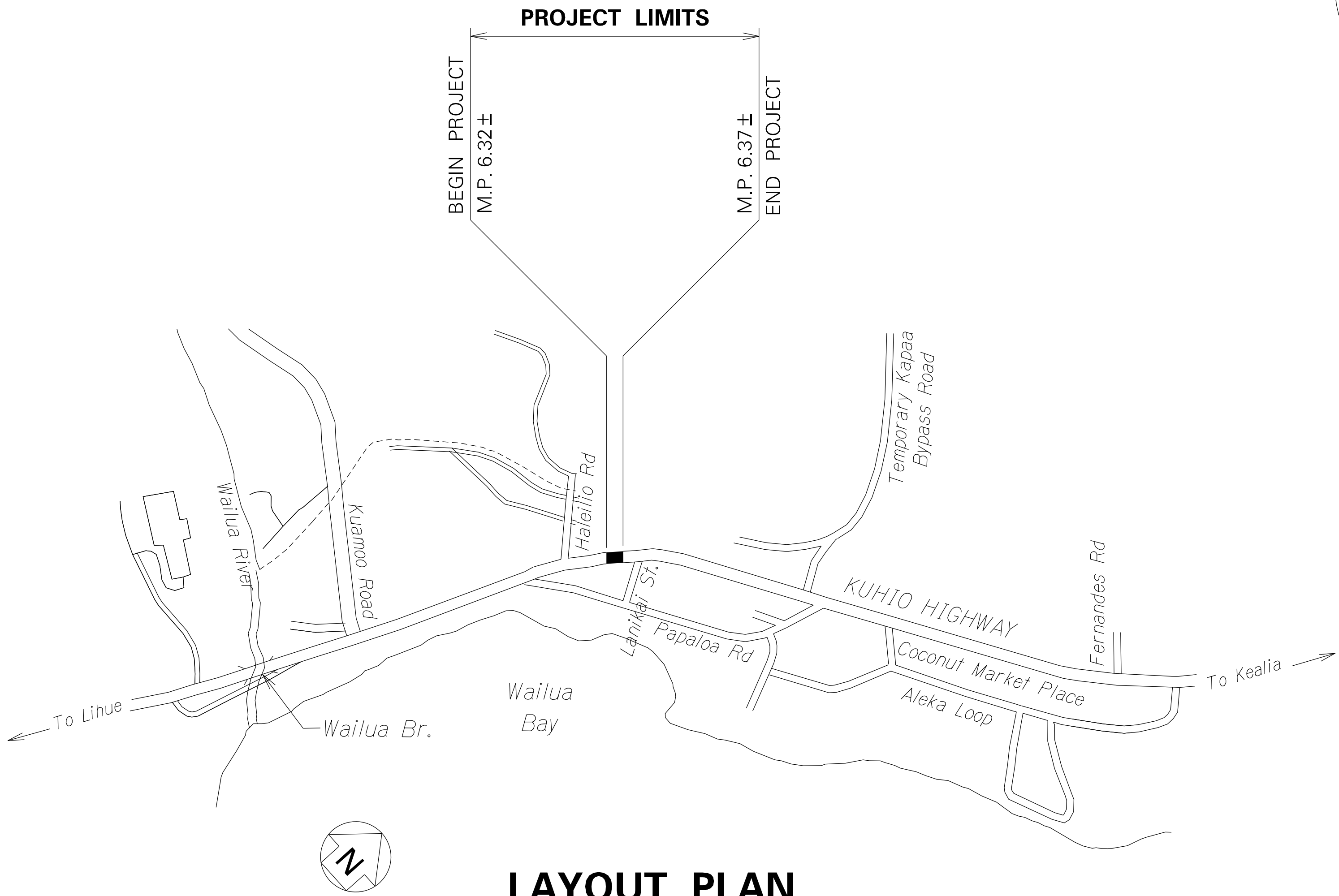

LAYOUT PLAN

GROSS LENGTH OF PROJECT.....0.05 MILE

NET LENGTH OF PROJECT.....0.05 MILE

| FED. ROAD DIST. NO. | STATE | PROJ. NO.  | FISCAL YEAR | SHEET NO. | TOTAL SHEETS |
|---------------------|-------|------------|-------------|-----------|--------------|
| HAWAII              | HAW.  | 56A-01-24M | 2025        | 1         | 15           |

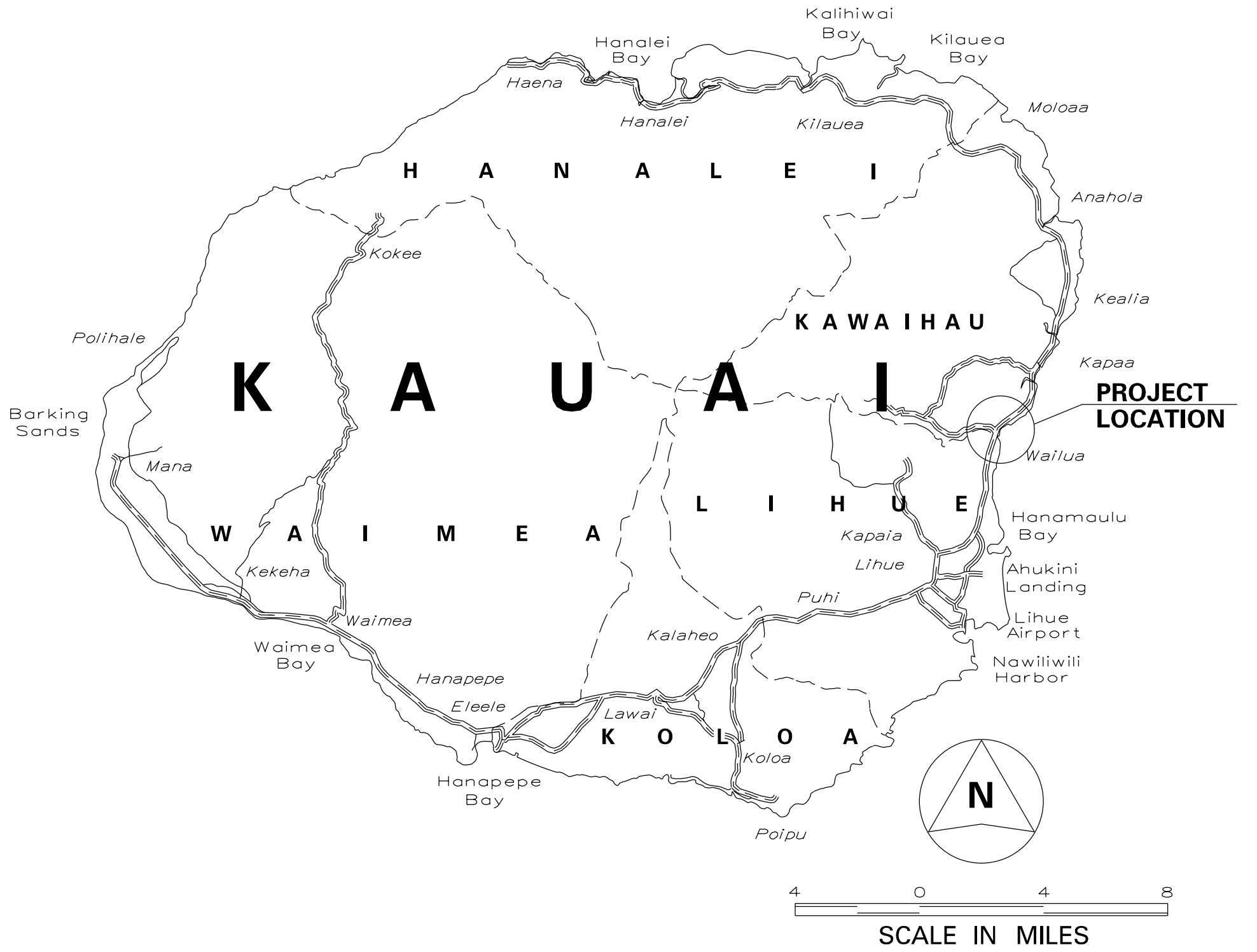
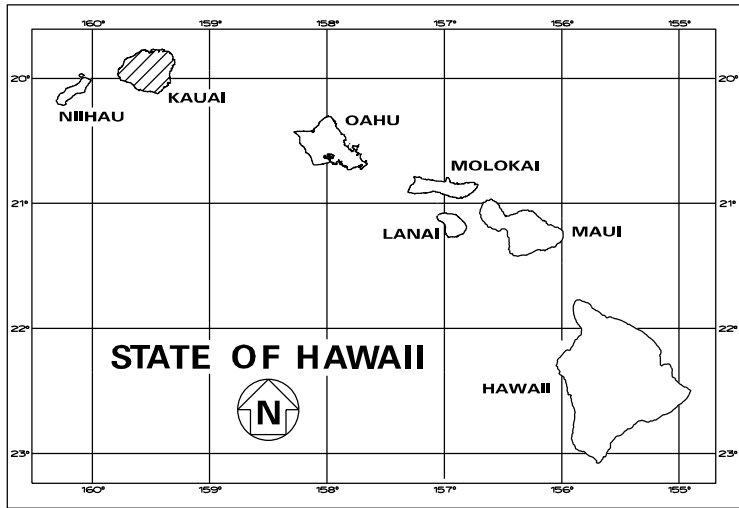

FEDERAL AID PROJECTS PREVIOUSLY CONSTRUCTED OR UNDER CONSTRUCTION

MILE POST 6.32 TO MILE POST 6.37

HWY-K DESIGNED BY

HWY-KE MANAGED BY

241-3000 PHONE

May 2024 DATE

|   |              |
|---|--------------|
| DEPARTMENT OF TRANSPORTATION<br>STATE OF HAWAII |              |
| APPROVED:                                       |              |
| for   | May 17, 2024 |
| DIR. OF TRANSPORTATION                          | DATE         |