

FED. ROAD DIST. NO.	STATE	FED. AID PROJ. NO.	FISCAL YEAR	SHEET NO.	TOTAL SHEETS
HAWAII	HAW.	BR-056-1(35)	1995	2	2

GENERAL NOTES:

1. The project consists of subsurface investigation at Waikaea Bridge, including approximately 880 lineal feet of borings, conducting penetration tests and obtaining samples.
2. At the end of each days work, the Contractor shall remove all equipment and other obstructions to permit free and safe passage of public traffic.
3. The existence and location of underground utilities, manholes, monuments and structures as shown on the plans are from the latest available data but the accuracy is not guaranteed. The encountering of other obstacles during the course of the work is possible. The Contractor shall be held liable for any damages incurred to the existing facilities and/or improvements as a result of his operations.
4. All work for widening Waikaea Bridge will not be included in this contract, but will be included in a future project, Kuhio Highway, Waikaea Bridge Widening.

LEGEND

- ⊙ Boring Site
- R/W
- - - - - exist. edge of pavement
- w - exist. water line
- s - exist. sewer line
- d - - - exist. drainage line
- ⊙_{gv} exist. water gate valve
- ⊙_{av} exist. water air valve
- ⊙_{smh} exist. sewer manhole
- ⊙_{tp} exist. telephone pole
- ⊙_{agp} exist. anchor guy pole
- ⊙_{agw} exist. anchor guy wire
- ⊙_{pp} exist. power pole

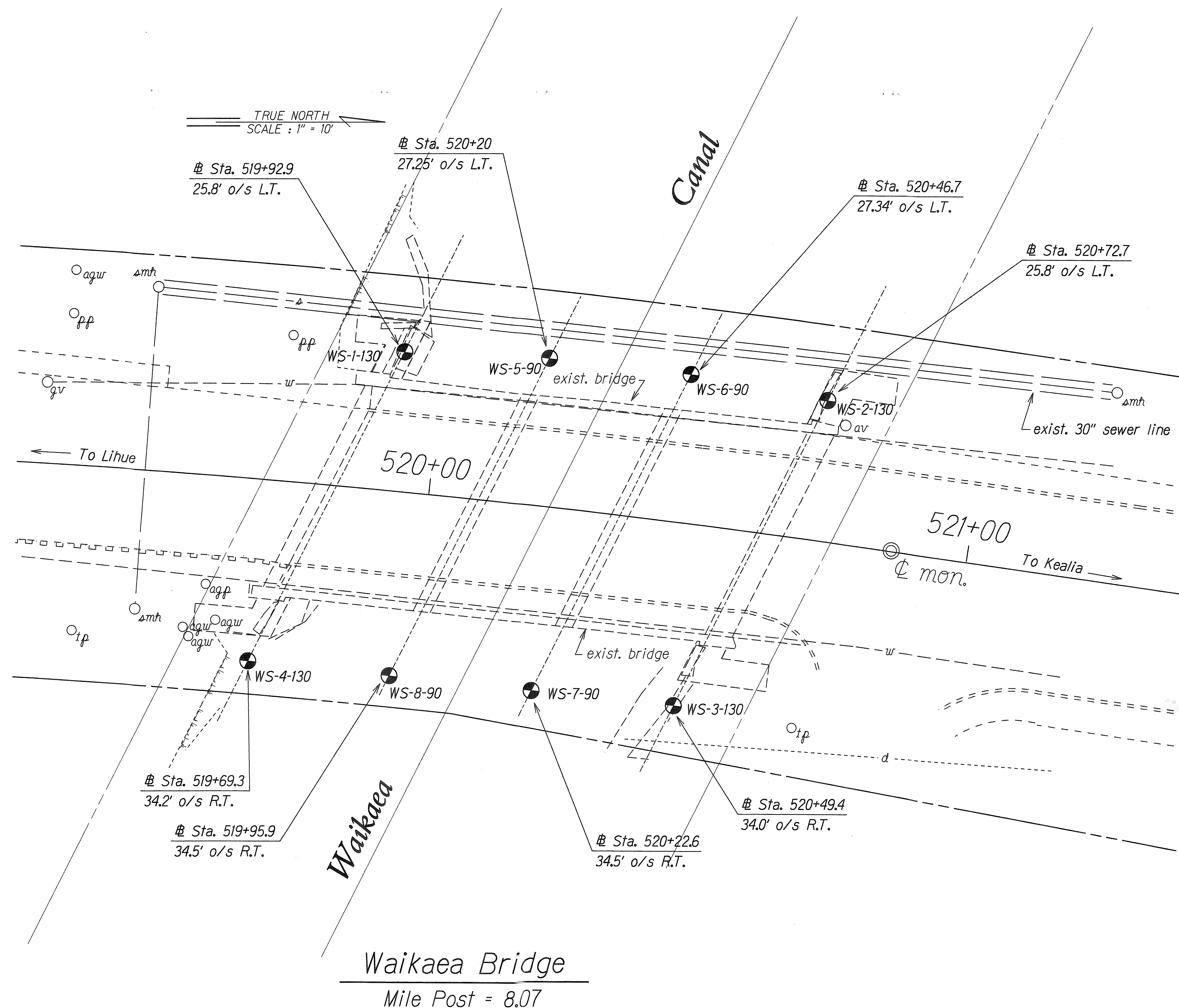

ORIGINAL PLAN	DATE
NOTE BOOK	12-95
DESIGNED BY	S. HILAKA
QUANTITIES BY	
CHECKED BY	

STATE OF HAWAII
DEPARTMENT OF TRANSPORTATION
HIGHWAYS DIVISION
PLAN AND GENERAL NOTES
SUBSURFACE INVESTIGATION FOR
KUHIO HIGHWAY
Waikaea Bridge Widening
Fed. Aid Proj. No. BR-056-1(35)
Scale: 1" = 10' Date: July, 1994
SHEET No. 2 OF 2 SHEETS