

| FED. ROAD DIST. NO. | STATE | FED-AID PROJ. NO. | FISCAL YEAR | SHEET NO. | TOTAL SHEETS |
|---------------------|-------|-------------------|-------------|-----------|--------------|
| HAWAII | HAW. | NH-056-1(062) | 2023 | 21 | 33 |

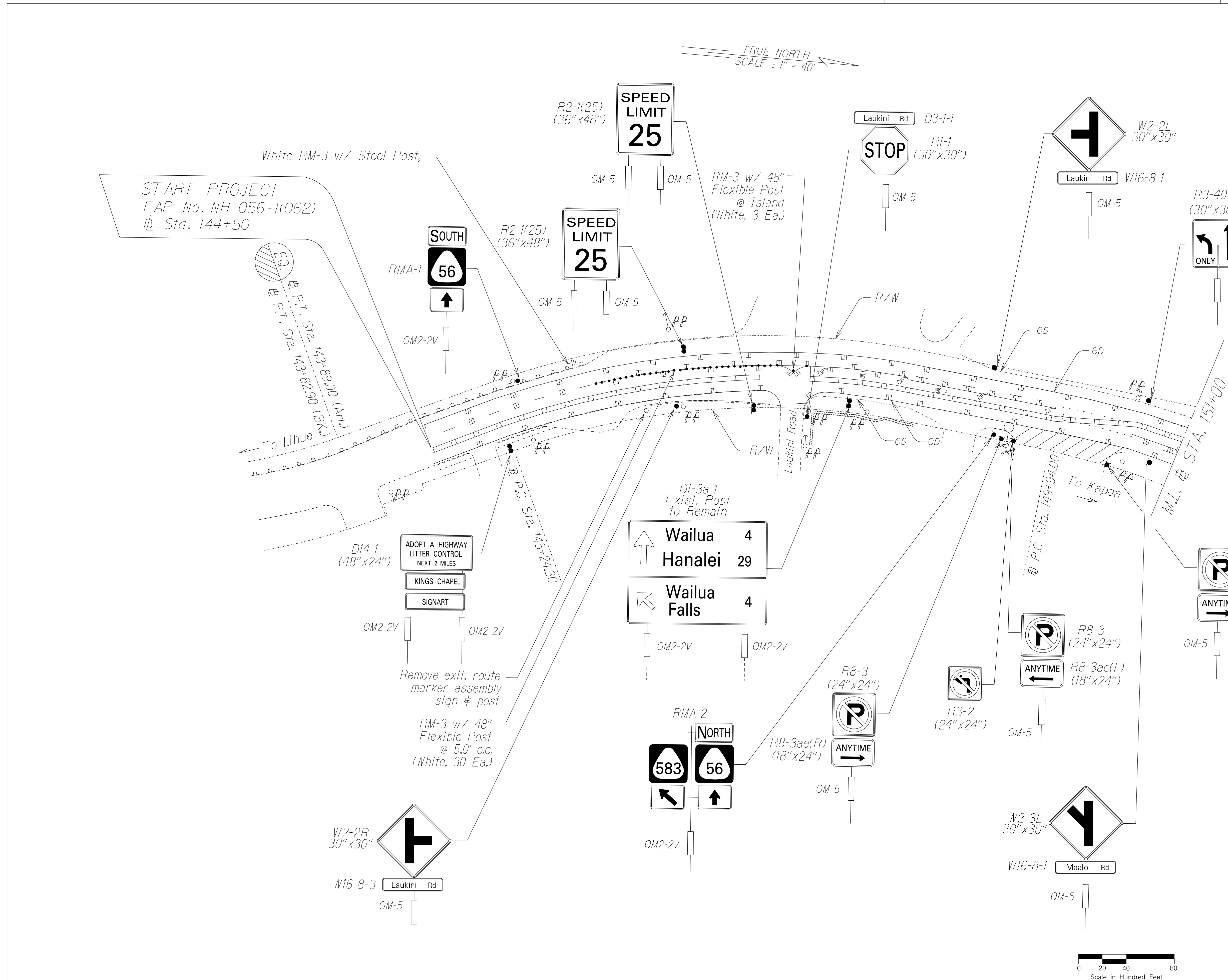

| | |
|-------------------|------|
| SURVEY PLOTTED BY | DATE |
| DRAWN BY | |
| DESIGNED BY | |
| QUANTITIES BY | |
| CHECKED BY | |
| ORIGINAL PLAN | |
| NOTE BOOK | |
| NO. | |

STATE OF HAWAII
DEPARTMENT OF TRANSPORTATION
HIGHWAYS DIVISION
PAVEMENT MARKING
TRAFFIC SIGNING PLAN
KUHIO HIGHWAY RESURFACING
Laukini Road to Kapule Highway
Federal-Aid Project No. NH-056-1(062)
Scale: 1" = 40' Date: Dec. 2022
SHEET No. 21 OF 6 SHEETS

| FED. ROAD DIST. NO. | STATE | FED-AID PROJ. NO. | FISCAL YEAR | SHEET NO. | TOTAL SHEETS |
|---------------------|-------|-------------------|-------------|-----------|--------------|
| HAWAII | HAW. | NH-056-1(062) | 2023 | 22 | 33 |

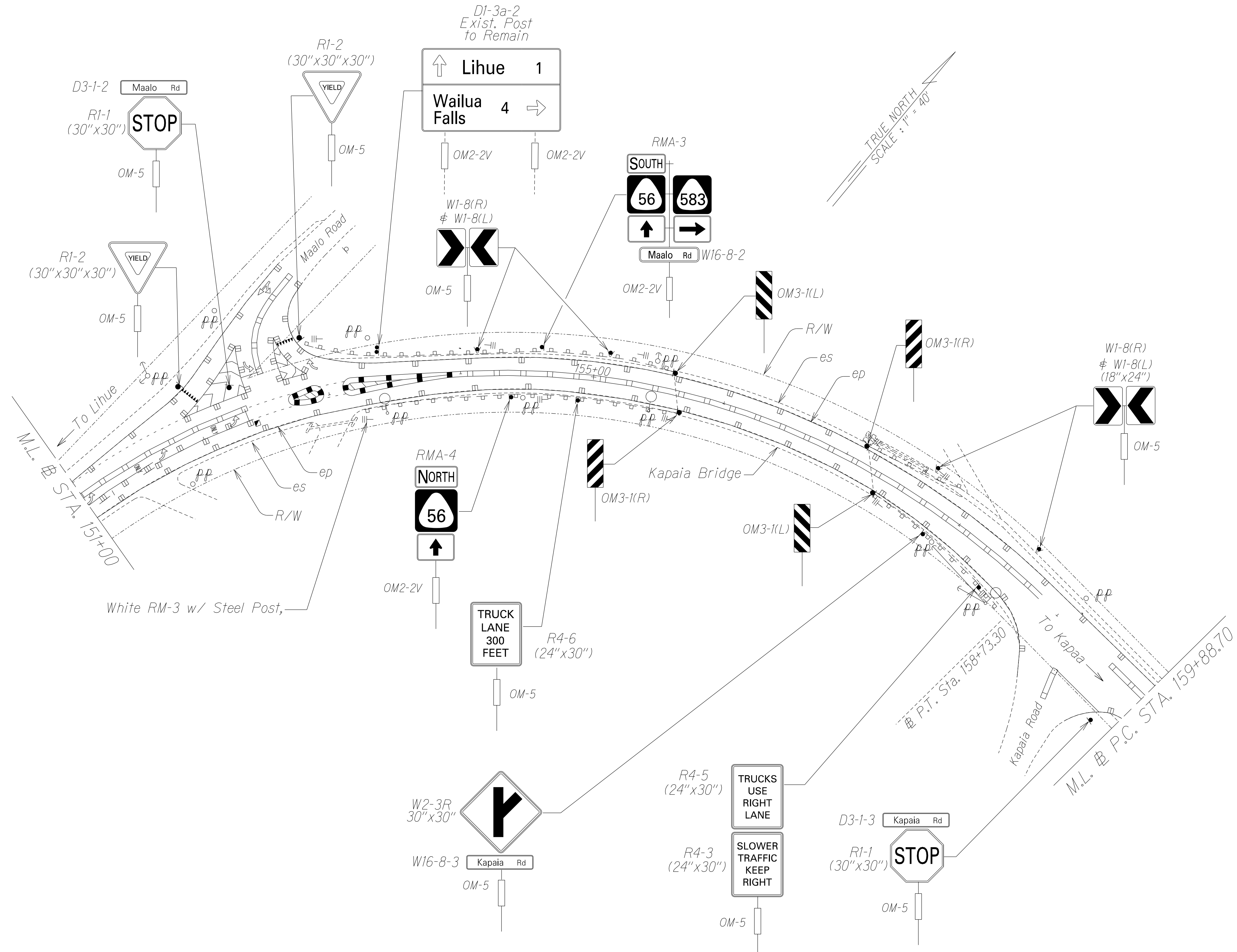

| | |
|-------------------|------|
| SURVEY PLOTTED BY | DATE |
| DRAWN BY | |
| DESIGNED BY | |
| QUANTITIES BY | |
| CHECKED BY | |
| ORIGINAL PLAN | |
| NOTE BOOK | |
| DATE | |
| NO. | |

STATE OF HAWAII
DEPARTMENT OF TRANSPORTATION
HIGHWAYS DIVISION

**PAVEMENT MARKING
& TRAFFIC SIGNING PLAN**

KUHIO HIGHWAY RESURFACING
Lauikini Road to Kapule Highway
Federal-Aid Project No. NH-056-1(062)

Scale: 1" = 40' Date: Dec. 2022

SHEET No. T2 OF 6 SHEETS

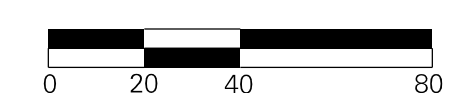

| FED. ROAD DIST. NO. | STATE | FED-AID PROJ. NO. | FISCAL YEAR | SHEET NO. | TOTAL SHEETS |
|---------------------|-------|-------------------|-------------|-----------|--------------|
| HAWAII | HAW. | NH-056-1(062) | 2023 | 23 | 33 |

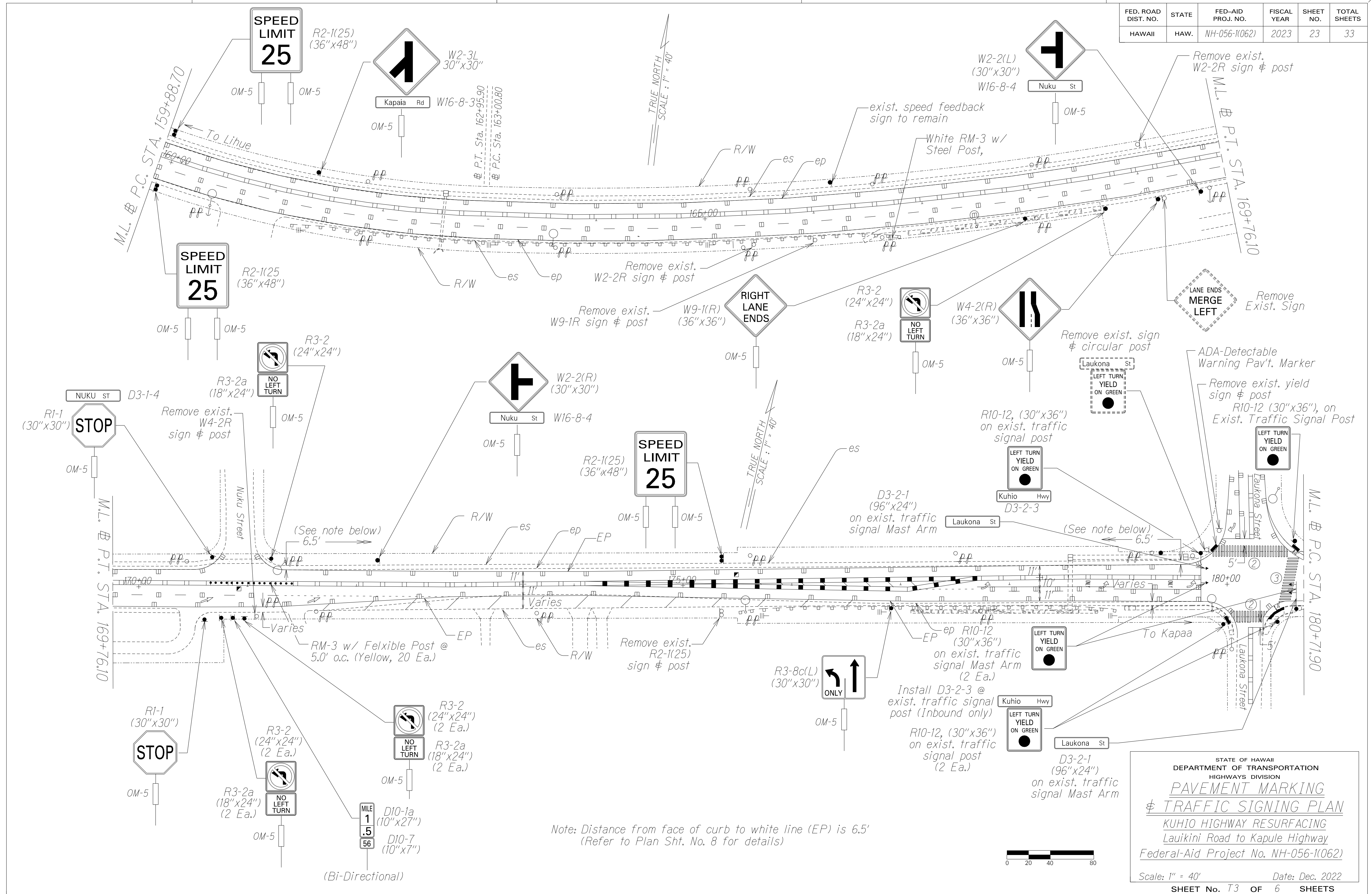

Note: Distance from face of curb to white line (EP) is 6.5' (Refer to Plan Sht. No. 8 for details)

| | |
|-------------------|------|
| SURVEY PLOTTED BY | DATE |
| DRAWN BY | |
| DESIGNED BY | |
| QUANTITIES BY | |
| CHECKED BY | |
| ORIGINAL PLAN | |
| NOTE BOOK | |
| NO. | |

STATE OF HAWAII
DEPARTMENT OF TRANSPORTATION
HIGHWAYS DIVISION
PAVEMENT MARKING
& TRAFFIC SIGNING PLAN
KUHIO HIGHWAY RESURFACING
Lauikini Road to Kapule Highway
Federal-Aid Project No. NH-056-1(062)
Scale: 1" = 40' Date: Dec. 2022
SHEET No. T3 OF 6 SHEETS

| FED. ROAD DIST. NO. | STATE | FED-AID PROJ. NO. | FISCAL YEAR | SHEET NO. | TOTAL SHEETS |
|---------------------|-------|-------------------|-------------|-----------|--------------|
| HAWAII | HAW. | NH-056-1(062) | 2023 | 24 | 33 |

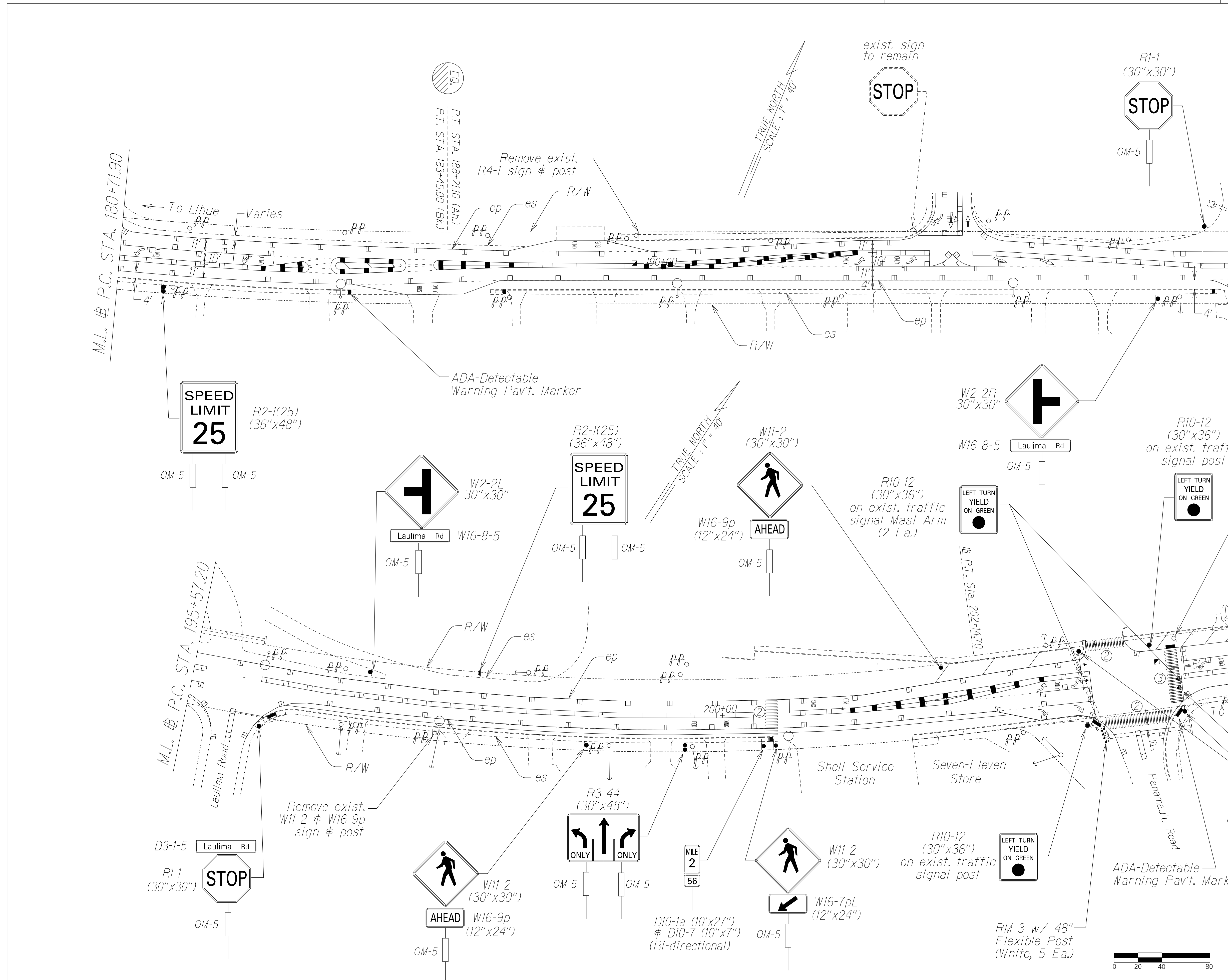

| | |
|-------------------|------|
| SURVEY PLOTTED BY | DATE |
| DRAWN BY | |
| DESIGNED BY | |
| QUANTITIES BY | |
| CHECKED BY | |
| ORIGINAL PLAN | |
| NOTE BOOK | |
| DESIGNED BY | |
| QUANTITIES BY | |
| CHECKED BY | |

STATE OF HAWAII
DEPARTMENT OF TRANSPORTATION
HIGHWAYS DIVISION

**PAVEMENT MARKING
& TRAFFIC SIGNING PLAN**

KUHIU HIGHWAY RESURFACING
Lauikini Road to Kapule Highway
Federal-Aid Project No. NH-056-1(062)

Scale: 1" = 40' Date: Dec. 2022

SHEET No. T4 OF 6 SHEETS

| FED. ROAD DIST. NO. | STATE | FED-AID PROJ. NO. | FISCAL YEAR | SHEET NO. | TOTAL SHEETS |
|---------------------|-------|-------------------|-------------|-----------|--------------|
| HAWAII | HAW. | NH-056-1(062) | 2023 | 25 | 33 |

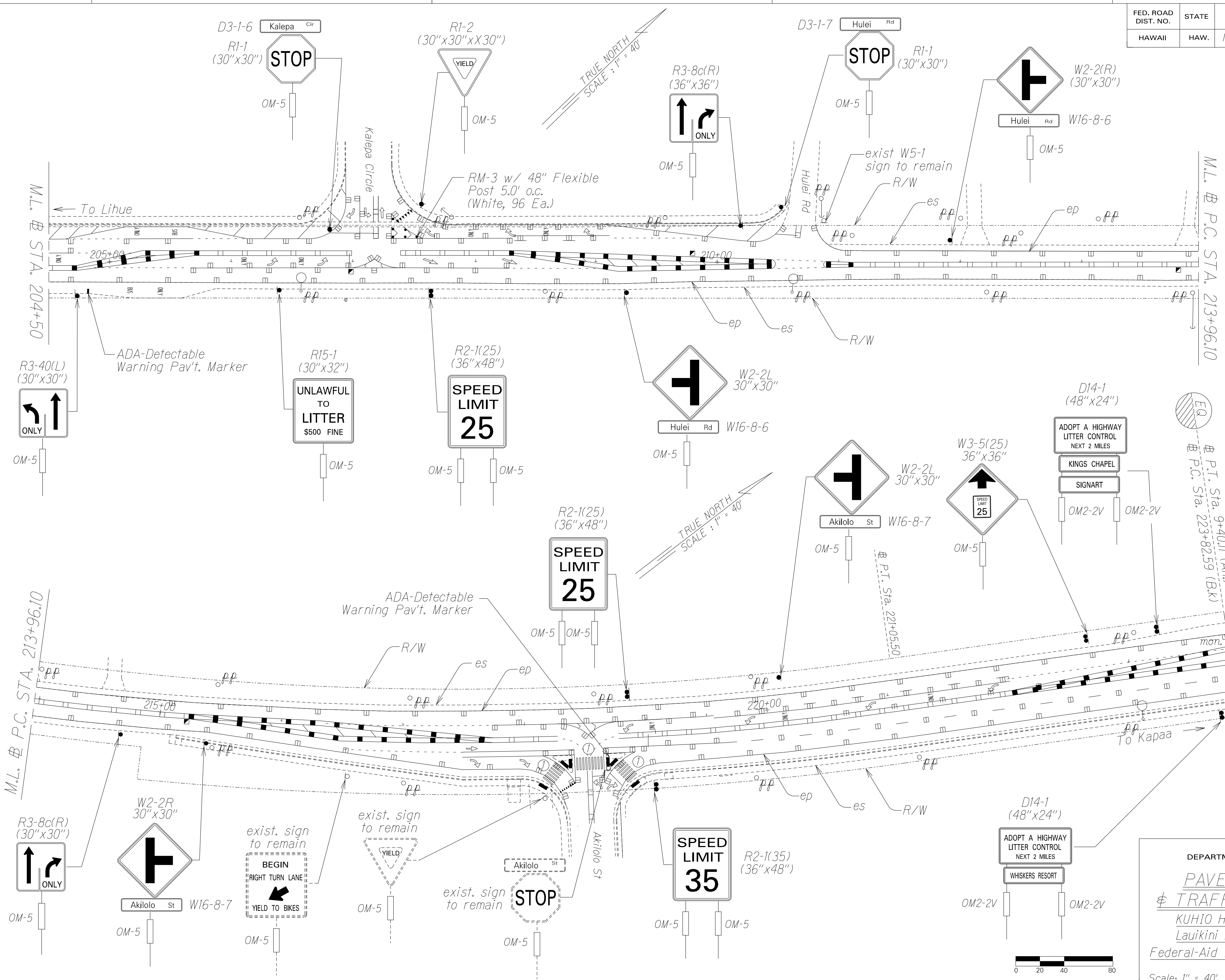

| | |
|-------------------|------|
| SURVEY PLOTTED BY | DATE |
| DRAWN BY | |
| DESIGNED BY | |
| QUANTITIES BY | |
| CHECKED BY | |
| ORIGINAL PLAN | |
| NOTE BOOK | |
| DESIGNED BY | |
| QUANTITIES BY | |
| CHECKED BY | |

STATE OF HAWAII
DEPARTMENT OF TRANSPORTATION
HIGHWAYS DIVISION

PAVEMENT MARKING
TRAFFIC SIGNING PLAN

KUHIU HIGHWAY RESURFACING
Lauikini Road to Kapule Highway
Federal-Aid Project No. NH-056-1(062)

Scale: 1" = 40' Date: Dec. 2022

SHEET No. T5 OF 6 SHEETS

| FED. ROAD DIST. NO. | STATE | FED-AID PROJ. NO. | FISCAL YEAR | SHEET NO. | TOTAL SHEETS |
|---------------------|-------|-------------------|-------------|-----------|--------------|
| HAWAII | HAW. | NH-056-1(062) | 2023 | 26 | 33 |

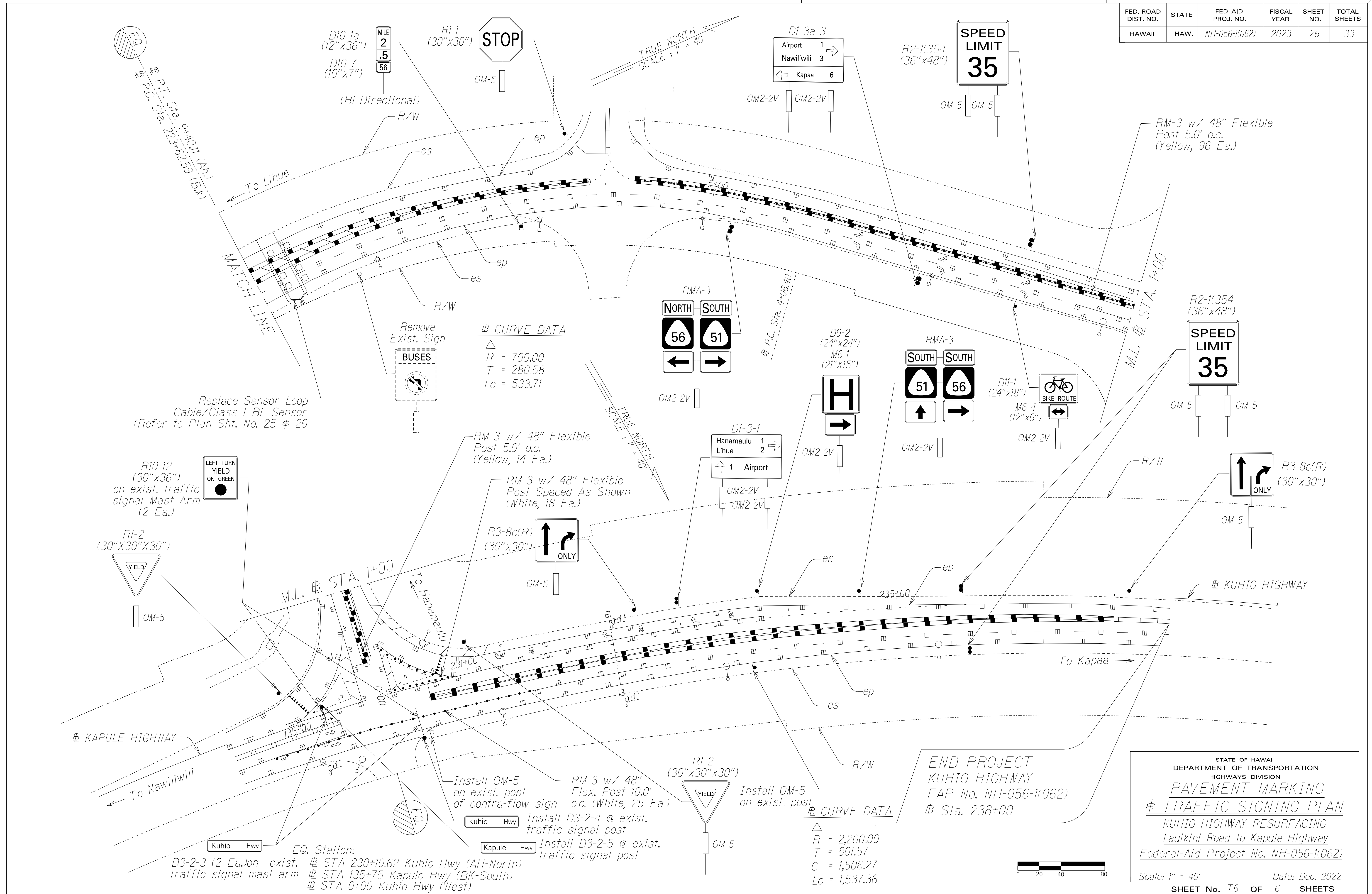

| | |
|-------------------|------|
| SURVEY PLOTTED BY | DATE |
| DRAWN BY | |
| DESIGNED BY | |
| QUANTITIES BY | |
| CHECKED BY | |
| ORIGINAL PLAN | |
| NOTE BOOK | |
| DESIGNED BY | |
| CHECKED BY | |
| No. | |

END PROJECT
 KUHIO HIGHWAY
 FAP No. NH-056-1(062)
 # Sta. 238+00

STATE OF HAWAII
 DEPARTMENT OF TRANSPORTATION
 HIGHWAYS DIVISION
PAVEMENT MARKING
TRAFFIC SIGNING PLAN
 KUHIO HIGHWAY RESURFACING
 Lauikini Road to Kapule Highway
 Federal-Aid Project No. NH-056-1(062)
 Scale: 1" = 40' Date: Dec. 2022
 SHEET No. T6 OF 6 SHEETS