

FED. ROAD DIST. NO.	STATE	FED-AID PROJ. NO.	FISCAL YEAR	SHEET NO.	TOTAL SHEETS
HAWAII	HAW.	STP-056-1(057)	2015	18	24

**BEGIN PROJECT**  
 FAP No. STP -056-1(057)  
 @ Sta. 64+58.25±

TRUE NORTH  
 SCALE: 1" = 40'

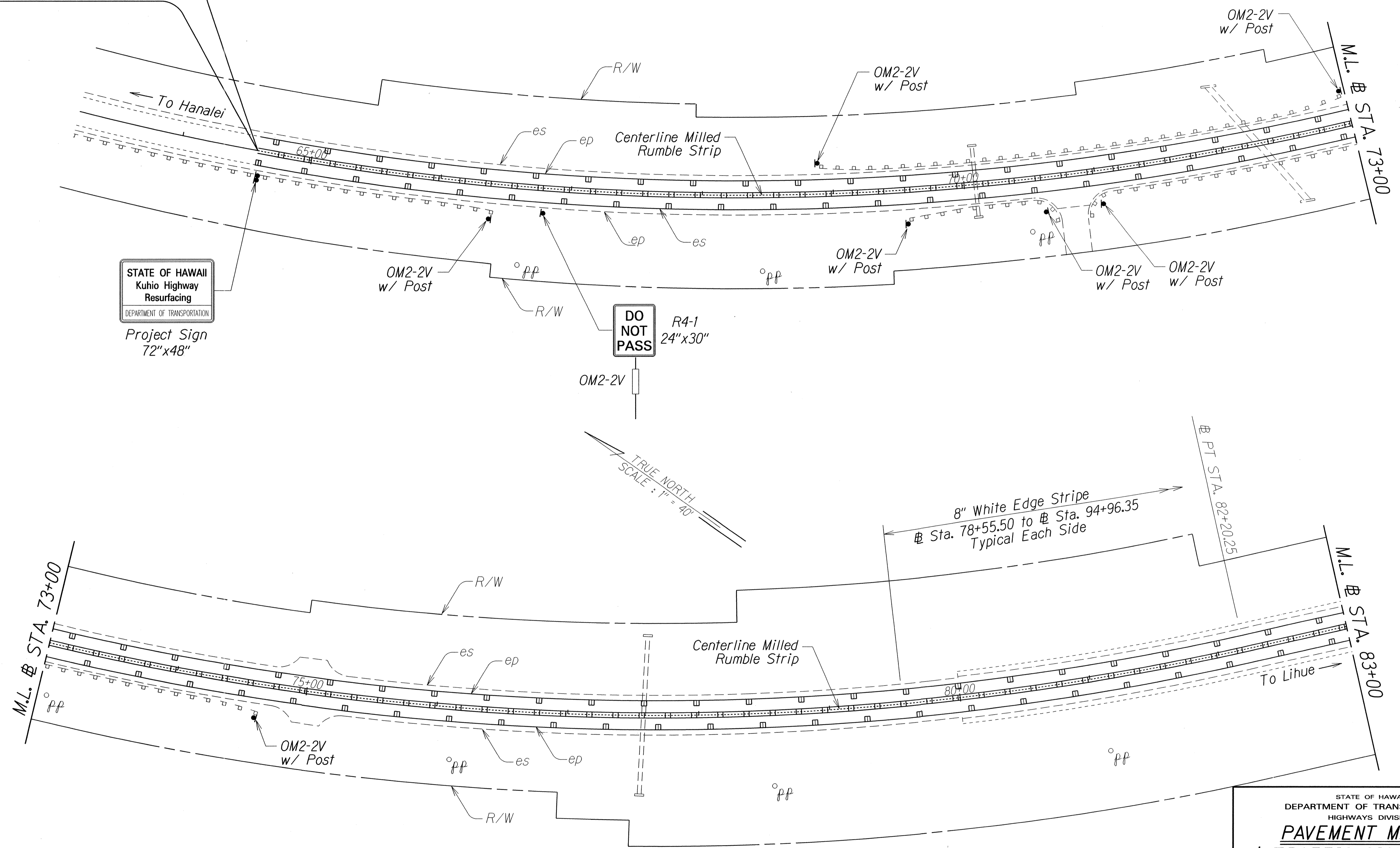

STATE OF HAWAII  
 Kuhio Highway  
 Resurfacing  
 DEPARTMENT OF TRANSPORTATION

Project Sign  
 72"x48"

DO NOT PASS  
 R4-1  
 24"x30"

8" White Edge Stripe  
 @ Sta. 78+55.50 to @ Sta. 94+96.35  
 Typical Each Side

DATE	
SURVEY PLOTTED BY	
DRAWN BY	
DESIGNED BY	
QUANTITIES BY	
CHECKED BY	
ORIGINAL PLAN	
NOTE BOOK	
PHOTOGRAPH	
N.	

STATE OF HAWAII  
 DEPARTMENT OF TRANSPORTATION  
 HIGHWAYS DIVISION  
**PAVEMENT MARKING**  
**TRAFFIC SIGNING PLAN**  
 KUHIO HIGHWAY RESURFACING  
 Vic. of South Koolau Road to Kapuna Road  
 Mile Post 16.88 to Mile Post 18.95  
 Federal-Aid Project No. STP-056-1(057)  
 Scale: 1" = 40' Date: Oct. 2014

FED. ROAD DIST. NO.	STATE	FED-AID PROJ. NO.	FISCAL YEAR	SHEET NO.	TOTAL SHEETS
HAWAII	HAW.	STP-056-1(057)	2015	19	24

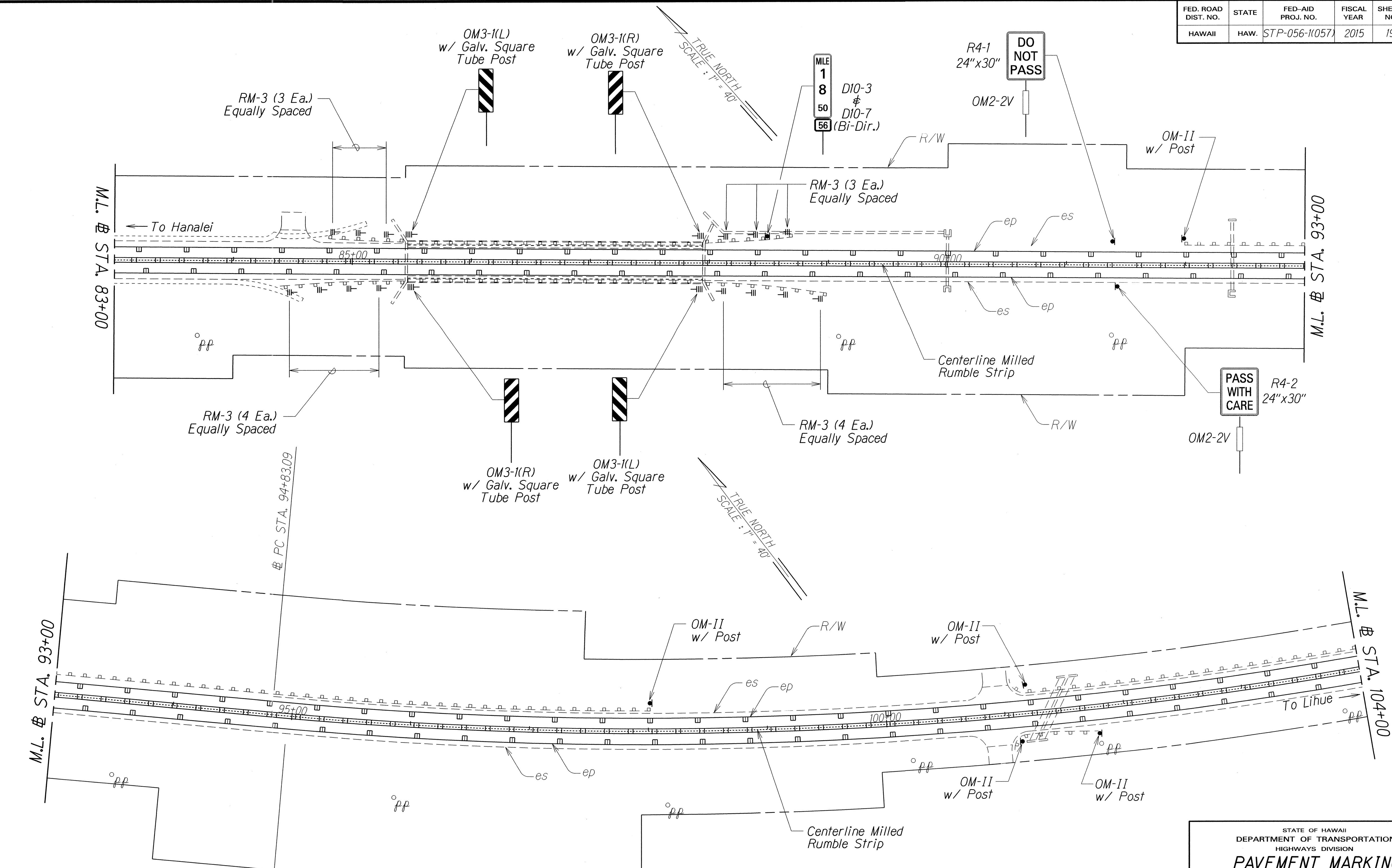

8" White Edge Stripe  
 Sta. 78+55.50 to Sta. 94+96.35  
 Typical Each Side

- Notes:
- Reflector marker (RM-3) shall be mounted on a galvanized flanged channel post. See Std. Plan TE-14 & TE-15.

ORIGINAL PLAN	DATE
DRAWN BY	
DESIGNED BY	
QUANTITIES BY	
CHECKED BY	

STATE OF HAWAII  
 DEPARTMENT OF TRANSPORTATION  
 HIGHWAYS DIVISION

**PAVEMENT MARKING**  
**TRAFFIC SIGNING PLAN**  
 KUHIO HIGHWAY RESURFACING  
 Vic. of South Koolau Road to Kapuna Road  
 Mile Post 16.88 to Mile Post 18.95  
 Federal-Aid Project No. STP-056-1(057)  
 Scale: 1" = 40' Date: Oct. 2014

SHEET No. T4 OF 8 SHEETS

FED. ROAD DIST. NO.	STATE	FED-AID PROJ. NO.	FISCAL YEAR	SHEET NO.	TOTAL SHEETS
HAWAII	HAW.	STP-056-1(057)	2015	20	24

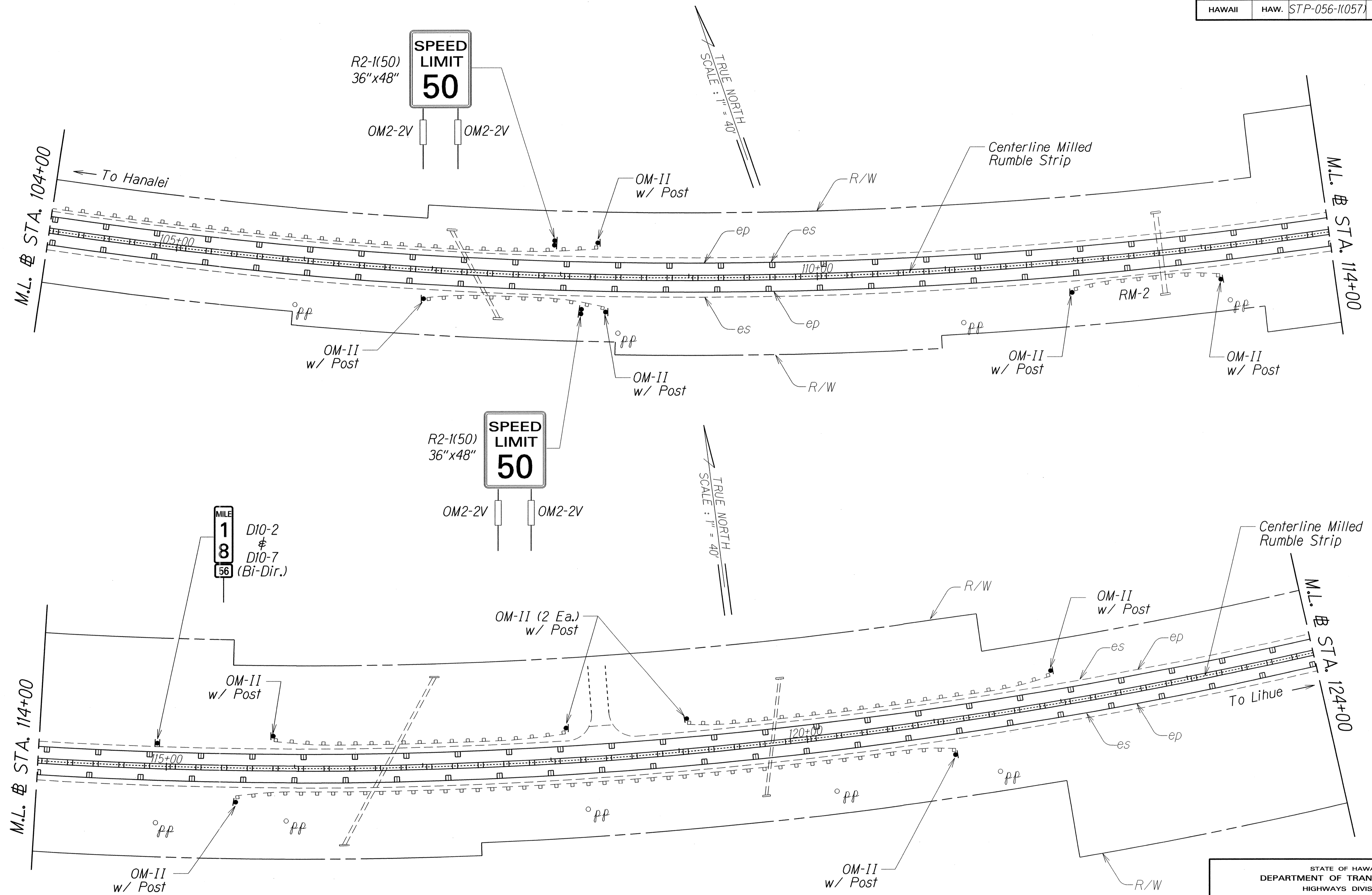

SURVEY PLOTTED BY	DATE
DRAWN BY	
DESIGNED BY	
NOTE BOOK	
QUANTITIES BY	
CHECKED BY	
N.	

STATE OF HAWAII  
DEPARTMENT OF TRANSPORTATION  
HIGHWAYS DIVISION

**PAVEMENT MARKING**  
**& TRAFFIC SIGNING PLAN**

**KUHIO HIGHWAY RESURFACING**  
Vic. of South Koolau Road to Kapuna Road  
Mile Post 16.88 to Mile Post 18.95  
Federal-Aid Project No. STP-056-1(057)  
Scale: 1" = 40' Date: Oct. 2014

FED. ROAD DIST. NO.	STATE	FED-AID PROJ. NO.	FISCAL YEAR	SHEET NO.	TOTAL SHEETS
HAWAII	HAW.	STP-056-1(057)	2015	21	24

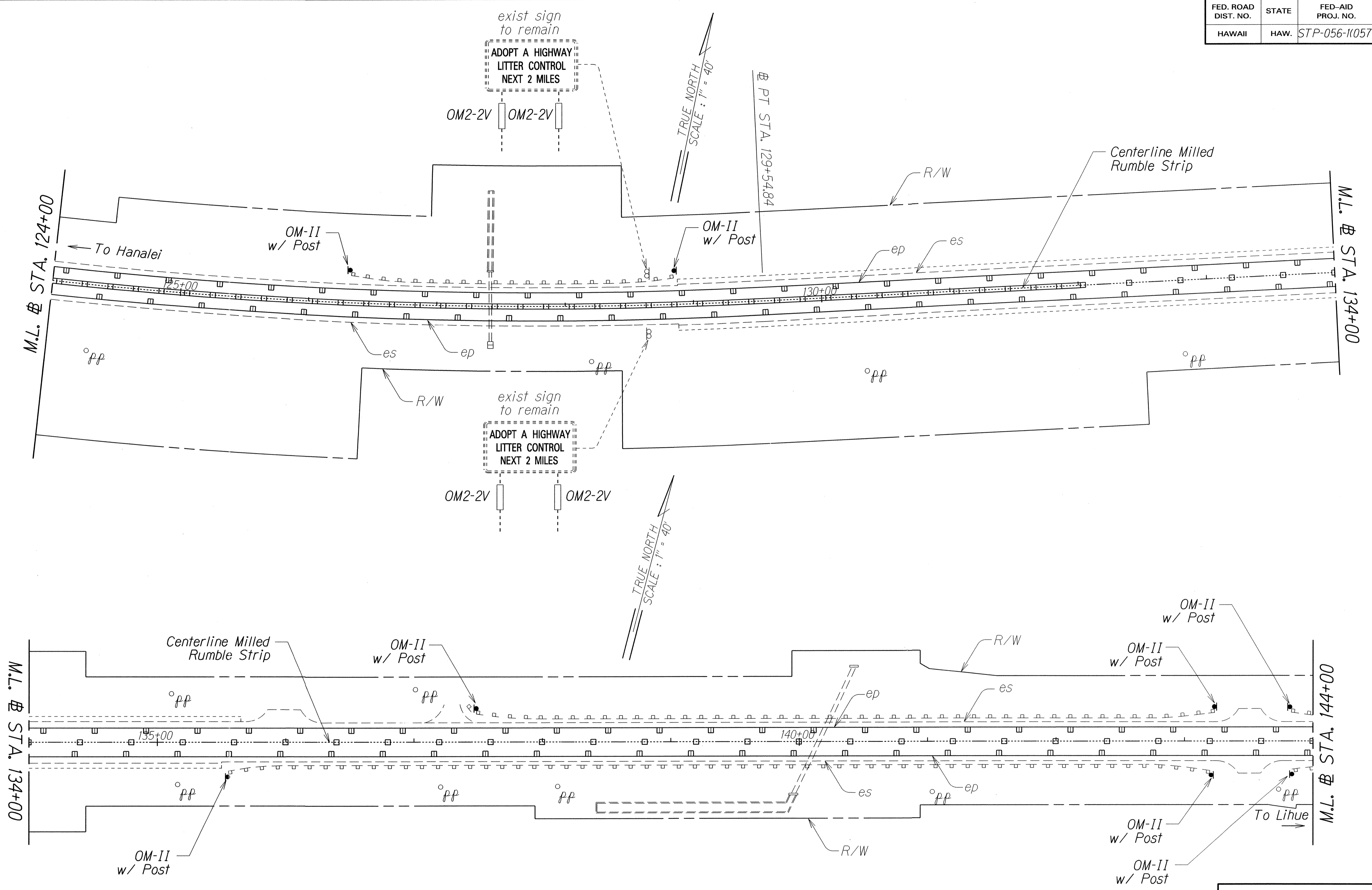

ORIGINAL PLAN	SURVEY PLOTTED BY	DATE
NOTE BOOK	DRAWN BY	
DESIGNED BY	DESIGNED BY	
QUANTITIES BY	QUANTITIES BY	
CHECKED BY	CHECKED BY	

STATE OF HAWAII  
DEPARTMENT OF TRANSPORTATION  
HIGHWAYS DIVISION

**PAVEMENT MARKING**  
**TRAFFIC SIGNING PLAN**

KUHIU HIGHWAY RESURFACING  
Vic. of South Koolau Road to Kapuna Road  
Mile Post 16.88 to Mile Post 18.95  
Federal-Aid Project No. STP-056-1(057)  
Scale: 1" = 40'      Date: Oct. 2014

SHEET No. T6 OF 8 SHEETS

FED. ROAD DIST. NO.	STATE	FED-AID PROJ. NO.	FISCAL YEAR	SHEET NO.	TOTAL SHEETS
HAWAII	HAW.	STP-056-1(057)	2015	22	24

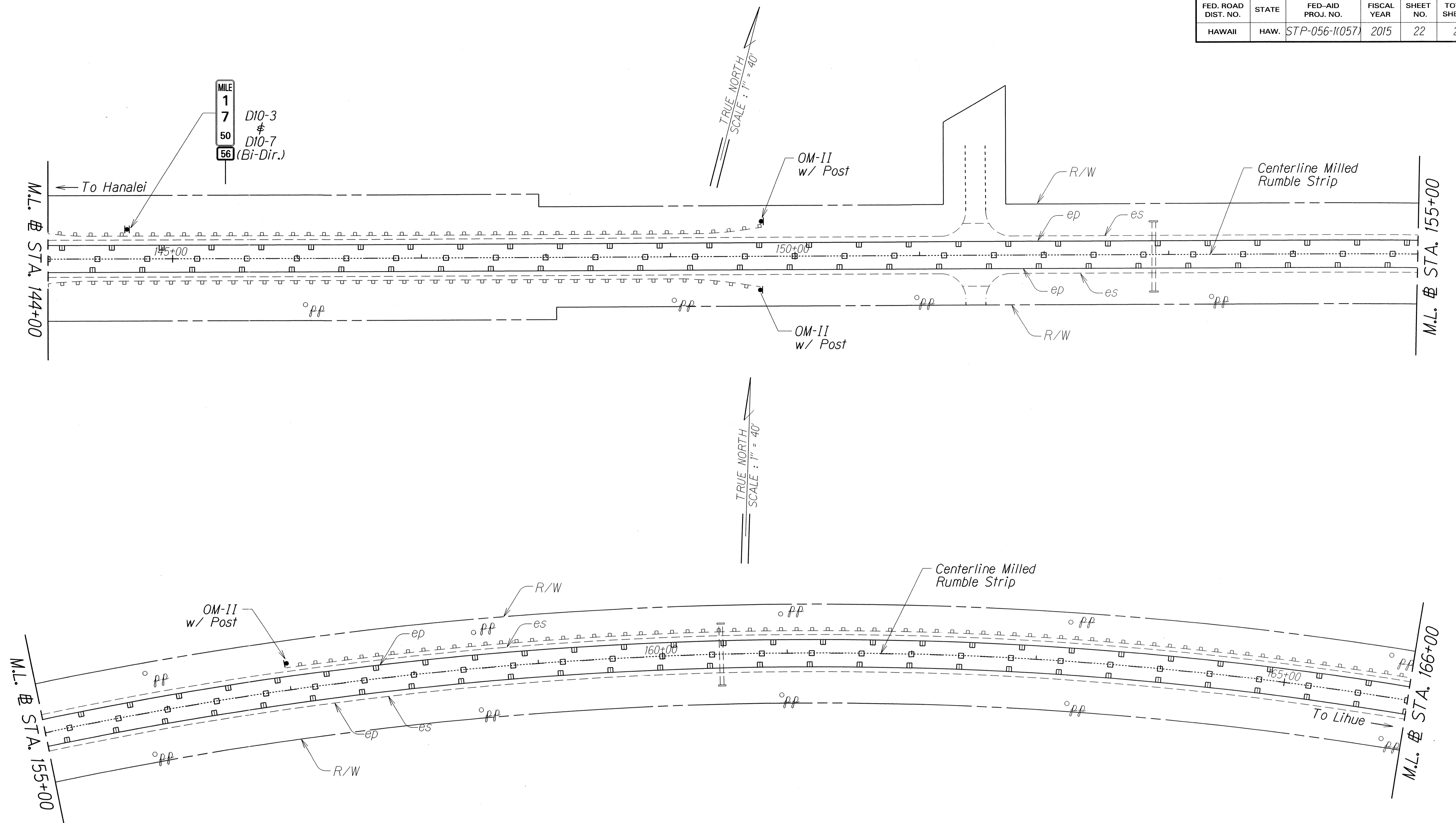

ORIGINAL PLAN	SURVEY PLOTTED BY	DATE
NOTE BOOK	DRAWN BY	
REVISIONS	DESIGNED BY	
QUANTITIES BY	CHECKED BY	
N. No.		

STATE OF HAWAII  
DEPARTMENT OF TRANSPORTATION  
HIGHWAYS DIVISION

**PAVEMENT MARKING**  
**TRAFFIC SIGNING PLAN**  
**KUHIO HIGHWAY RESURFACING**  
Vic. of South Koolau Road to Kapuna Road  
Mile Post 16.88 to Mile Post 18.95  
Federal-Aid Project No. STP-056-1(057)  
Scale: 1" = 40' Date: Oct. 2014

FED. ROAD DIST. NO.	STATE	FED-AID PROJ. NO.	FISCAL YEAR	SHEET NO.	TOTAL SHEETS
HAWAII	HAW.	STP-056-1(057)	2015	23	24

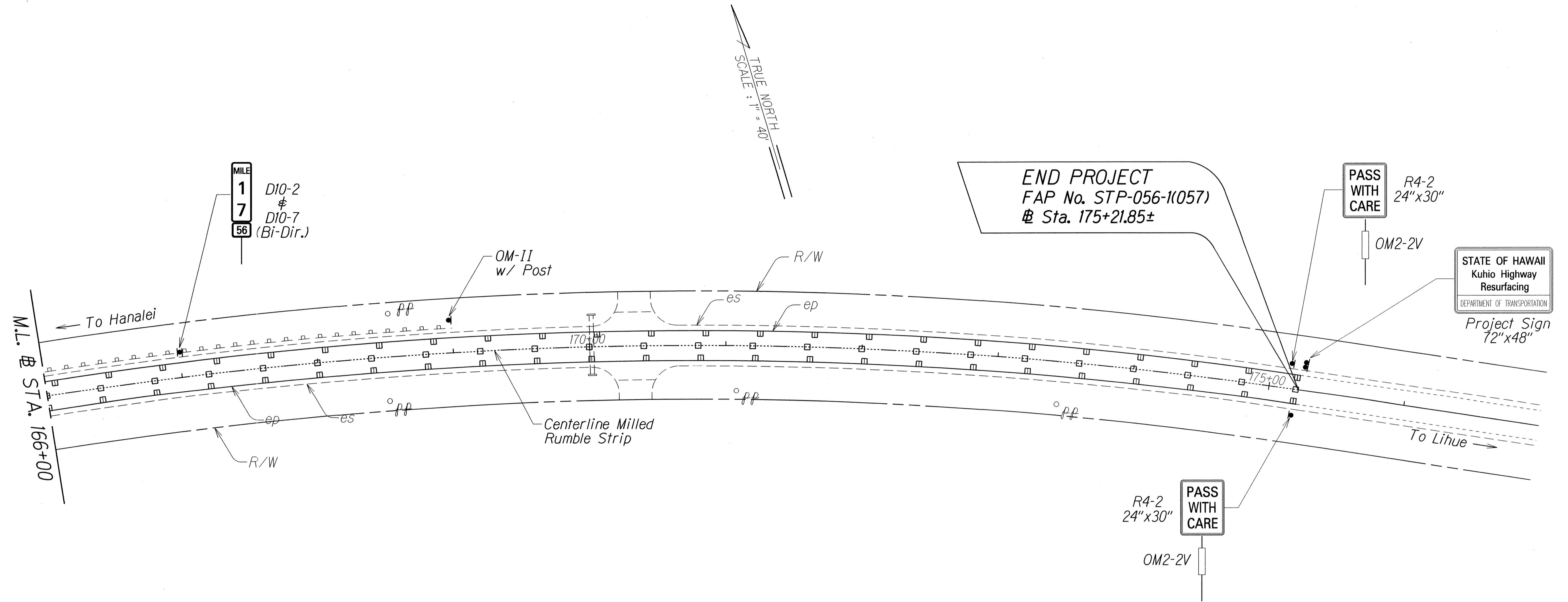

ORIGINAL PLAN	SURVEY PLOTTED BY	DATE
NOTE BOOK	DRAWN BY	
REVISIONS	DESIGNED BY	
QUANTITIES BY	CHECKED BY	
NO. APPROVED		

STATE OF HAWAII  
DEPARTMENT OF TRANSPORTATION  
HIGHWAYS DIVISION

**PAVEMENT MARKING**  
**TRAFFIC SIGNING PLAN**

**KUHIO HIGHWAY RESURFACING**  
Vic. of South Koolau Road to Kapuna Road  
Mile Post 16.88 to Mile Post 18.95  
Federal-Aid Project No. STP-056-1(057)  
Scale: 1" = 40' Date: Oct. 2014

SHEET No. T8 OF 8 SHEETS