

INDEX TO DRAWINGS	
SHEET NO.	DESCRIPTION
1	TITLE SHEET
2	STANDARD PLANS SUMMARY
3	GENERAL NOTES & LEGEND
4 - 5	WATER POLLUTION AND EROSION CONTROL NOTES
6 - 8	TYPICAL SECTIONS
9 - 10	ROADWAY PLAN
11	PAVEMENT MARKING, NOTES, LEGEND, AND SIGN DETAILS
12 - 13	PAVEMENT MARKING AND TRAFFIC SIGNING PLAN
14	LOW SPEED UNDIVIDED HIGHWAY WORK ZONE SIGNING PLAN, NOTES & DETAILS

STATE OF HAWAII

DEPARTMENT OF TRANSPORTATION

HIGHWAYS DIVISION

HONOLULU, HAWAII

PLANS FOR

KUHIO HIGHWAY RESURFACING

KILAUEA TO WAILAPA

PROJECT NO. 56C-02-08M

DISTRICT OF HANAIEI

ISLAND OF KAUAI

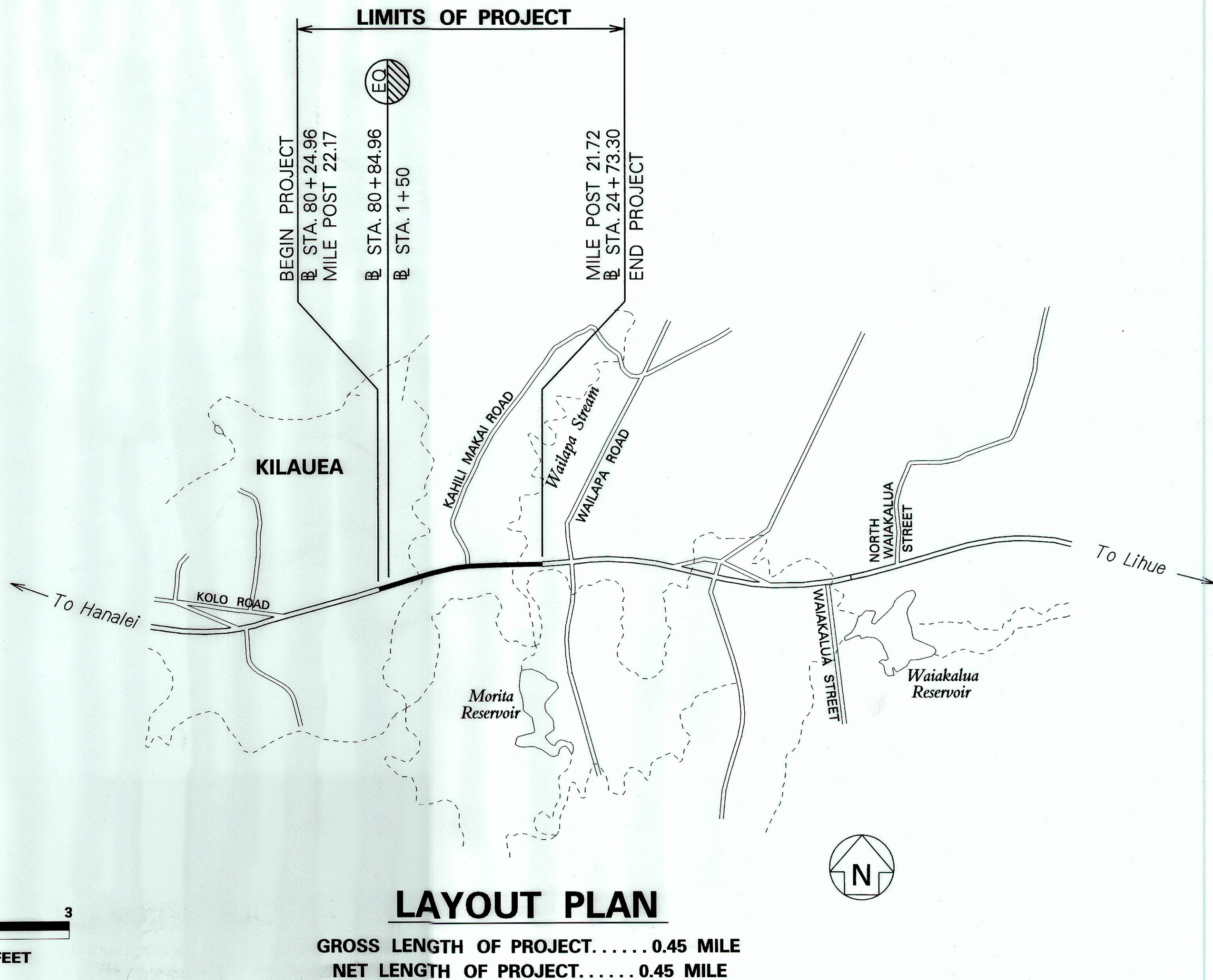

FED. ROAD DIST. NO.	STATE	PROJ. NO.	FISCAL YEAR	SHEET NO.	TOTAL SHEETS
HAWAII	HAW.	56C-02-08M	2009	1	14

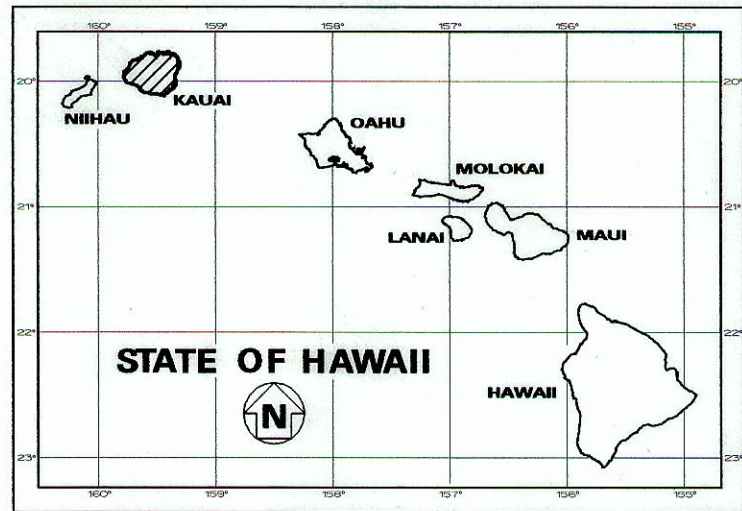

PROJECT LOCATION

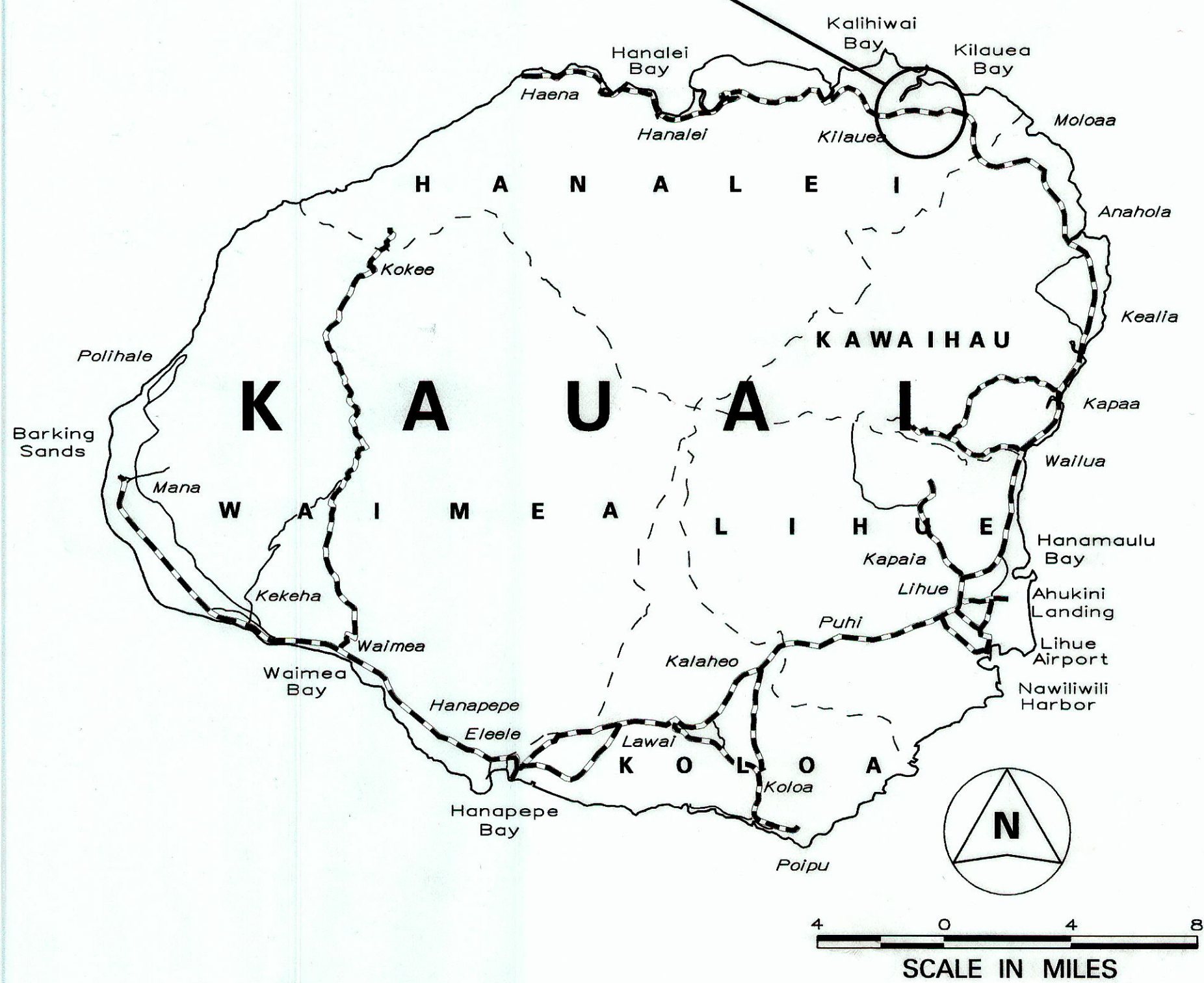

FEDERAL AID PROJECTS PREVIOUSLY CONSTRUCTED OR UNDER CONSTRUCTION

MILE POST 21.72 TO MILE POST 22.17

CHANGES MADE DURING CONSTRUCTION HAVE BEEN INCORPORATED ON THESE PLANS EXCEPT CHANGES IN THE GEOMETRIC PHYSICAL QUANTITIES FOR ACTUAL QUANTITIES, WHICH TO PROJECT LEADER APPROX. QUANTITIES ONLY.

5/1/2014

DEPARTMENT OF TRANSPORTATION

STATE OF HAWAII

APPROVED:

5-9-09

DATE

DESIGNED BY

MANAGED BY

PHONE

DATE