

| FED. ROAD DIST. NO. | STATE | FED. AID PROJ. NO. | FISCAL YEAR | SHEET NO. | TOTAL SHEETS |
|---------------------|-------|--------------------|-------------|-----------|--------------|
| HAWAII | HAW | BR-056-1(51) | 2008 | 268 | 284 |

| LEGEND FOR AS-BUILT POSTINGS |
|---|
| ~~~~~ Squiggly line for as-built deletion |
| ===== Double line for as-built deletion |
| _____ Roadway |
| _____ Text for as-built posting |

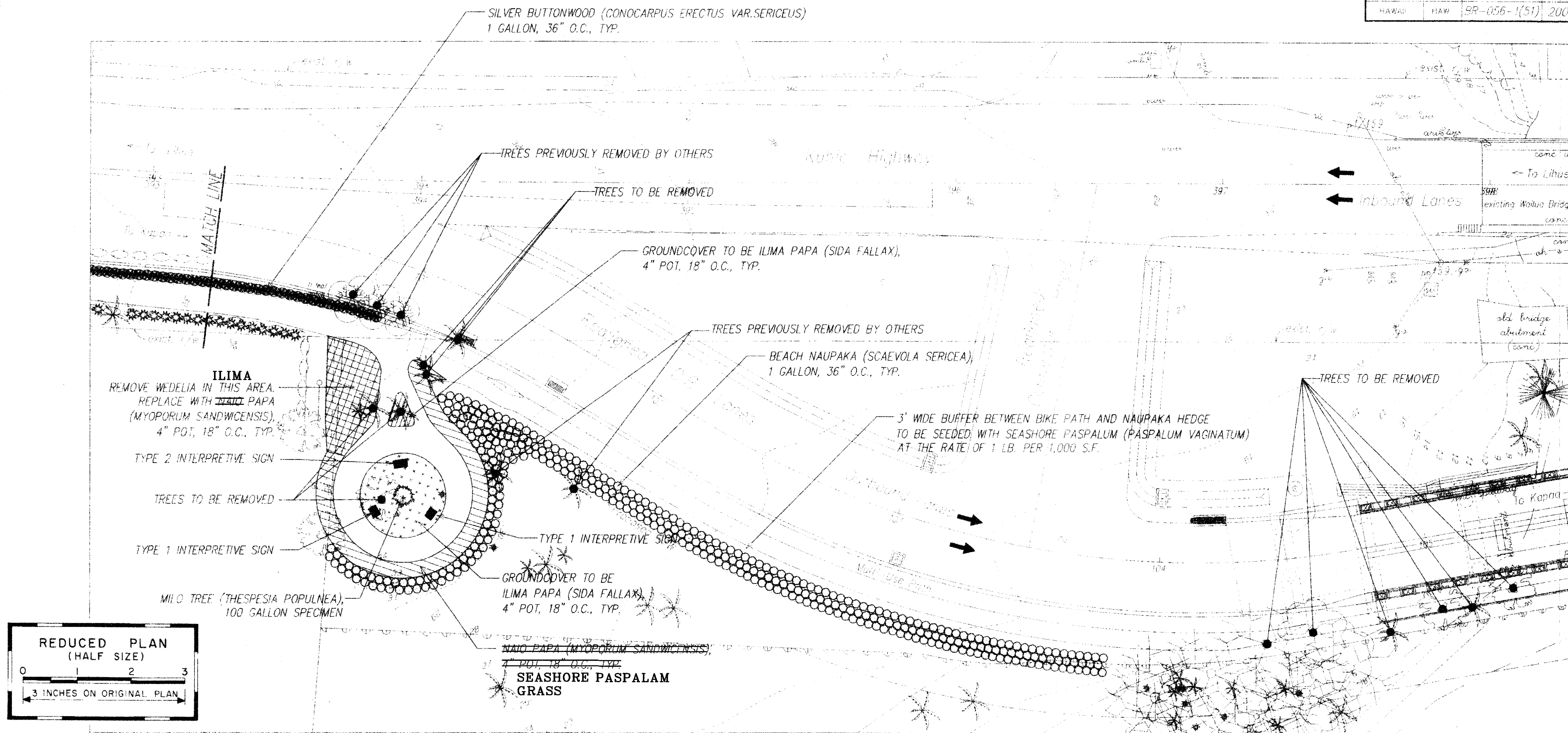

EXISTING BIKE PATH ROUNDABOUT TO WAILUA BRIDGE
SCALE: 1"=20'

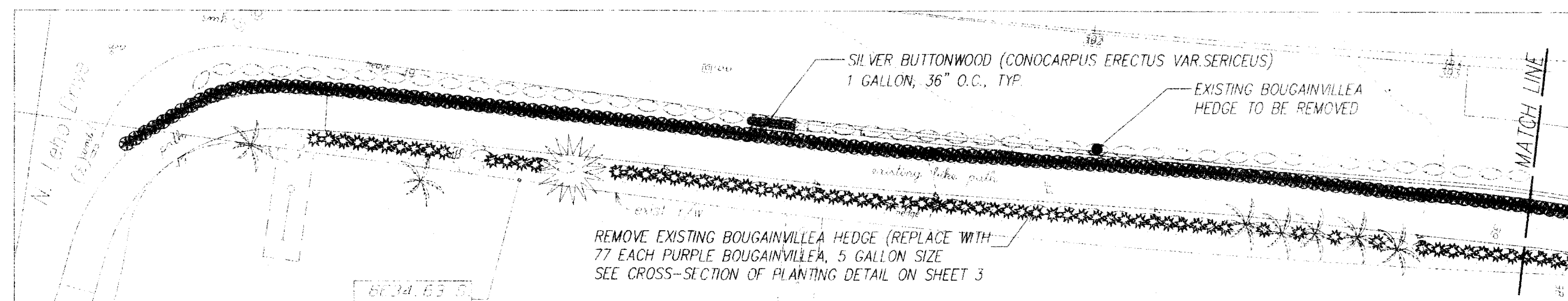

LEHO ROAD TO EXISTING BIKE PATH ROUNDABOUT
SCALE: 1"=20'

GRASSING NOTES:
ALL AREAS DISTURBED BY CONSTRUCTION FROM THIS PROJECT AND
NOT SPECIFICALLY CALLED OUT FOR NEW HARDSCAPES OR PLANTING
SHALL BE SEEDING OR HYDROMULCHED WITH COMMON BERMUDAGRASS
AT THE RATE OF 1 LB. PER 1,000 SQUARE FEET (REFER TO SECTION
641 - HYDRO-MULCH SEEDING FOR ADDITIONAL NOTES AND
SPECIFICATIONS).

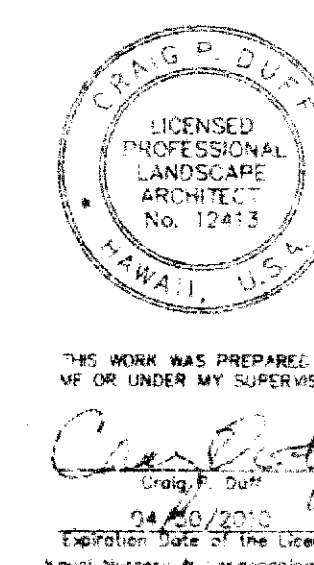

STATE OF HAWAII
DEPARTMENT OF TRANSPORTATION
HIGHWAYS DIVISION

SOUTH LANDSCAPE PLAN

KUHIO HIGHWAY, SHORT TERM IMPROVEMENTS
Wailua Cone Haul Bridge Widening
Fed. Aid Project No. BR-056-1(51)
Scale: As Noted Date: MAY 2008
SHEET NO. 111 OF 3 SHEETS

"AS-BUILT"

| LIB2: KAUAI CITY KAPAA BIKE PATH KUHIOWIDENING KNL-2-LANDSCAPE (2000 FORMAT).DWG 05/12/08 | | | | | |
|--|-------|--------------------|-------------|-----------|--------------|
| FED. ROAD DIST. NO. | STATE | FED. AID PROJ. NO. | FISCAL YEAR | SHEET NO. | TOTAL SHEETS |
| HAWAII | HAW | BR-056-1(51) | 2008 | 269 | 284 |

GRASSING NOTES:
ALL AREAS DISTURBED BY CONSTRUCTION FROM THIS PROJECT AND NOT SPECIFICALLY CALLED OUT FOR NEW HARDSCAPES OR PLANTING SHALL BE SEEDED OR HYDROMULCHED WITH COMMON BERMUDAGRASS AT THE RATE OF 1 LB. PER 1,000 SQUARE FEET (REFER TO SECTION 641 - HYDRO-MULCH SEEDING FOR ADDITIONAL NOTES AND SPECIFICATIONS).

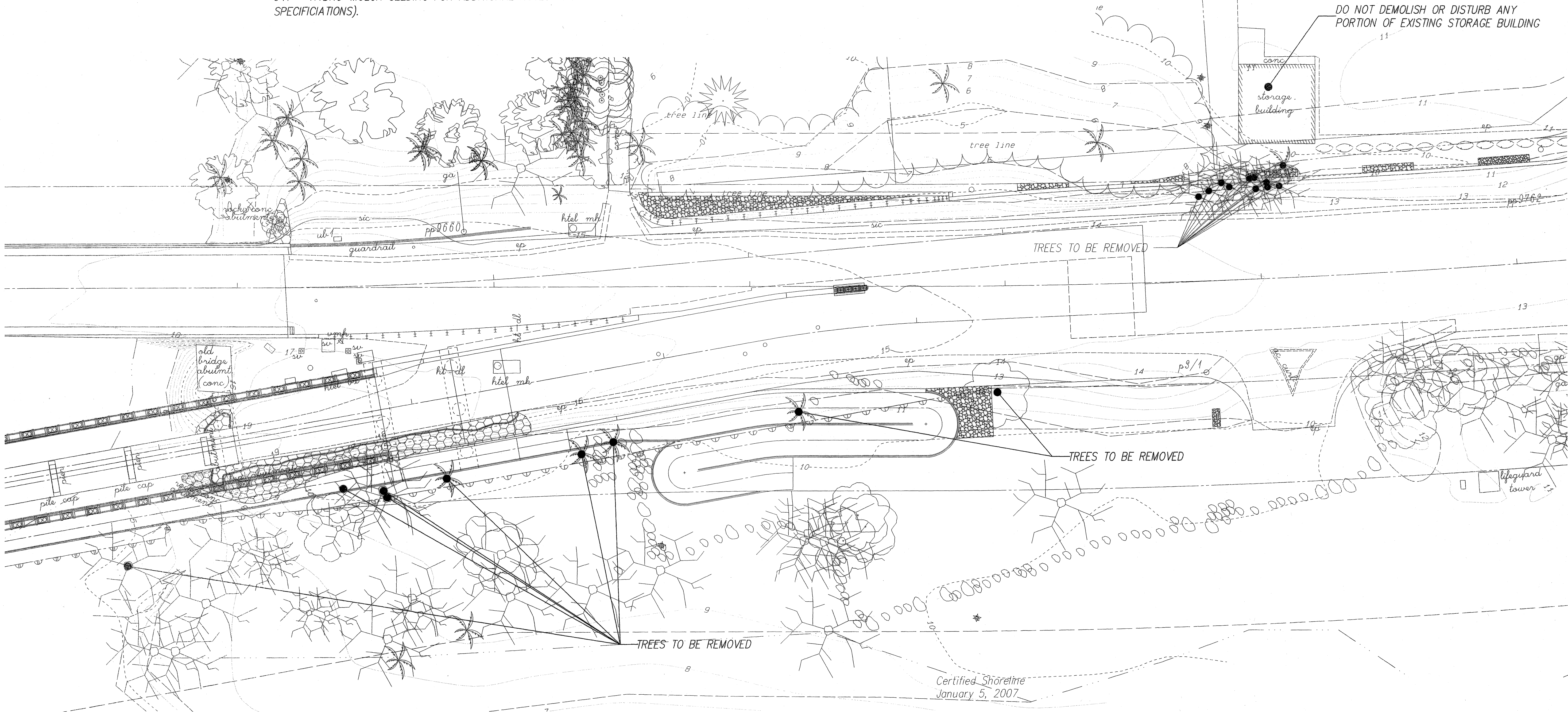

| | | |
|------------------|-------------------|------|
| ORIGINAL PLAN | SURVEY PLOTTED BY | DATE |
| | DRAWN BY | |
| | DESIGNED BY | |
| | QUANTITIES BY | |
| NOTE BOOK | CHECKED BY | |
| | No. | |

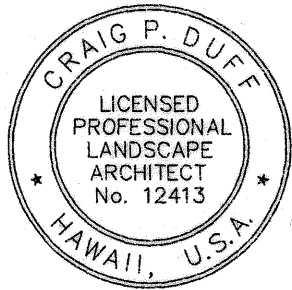

THIS WORK WAS PREPARED BY
ME OR UNDER MY SUPERVISION
Craig P. Duff
Craig P. Duff
04/30/2010
Expiration Date of the License
Kouali Nursery & Landscaping, Inc.

STATE OF HAWAII
DEPARTMENT OF TRANSPORTATION
HIGHWAYS DIVISION

NORTH LANDSCAPE PLAN

KUHIOW HIGHWAY, SHORT TERM IMPROVEMENTS
Wailua Cane Haul Bridge Widening
Fed. Aid Project No. BR-056-1(51)
Scale: As Noted Date: MAY 2008
SHEET No. L1.2 OF 3 SHEETS

Fri, 16 May 2008 - 9:13am
U:\CHD\Bike Path Lydgate-Kapaa\Bike Path Final\05-15-08\YNU-3-Notes-landscape (2000 format).dwg

| | | |
|---------------|-------------------|------|
| ORIGINAL PLAN | SURVEY PLOTTED BY | DATE |
| NOTE BOOK | DESIGNED BY | |
| | QUANTITIES BY | |
| | CHECKED BY | |

PLANT NOTES:

1. LANDSCAPE CONTRACTOR SHALL FIELD VERIFY ALL PLANT QUANTITIES AND DIMENSIONS PRIOR TO INSTALLATION. QUANTITIES SHOWN ON PLANT LIST ARE FOR REFERENCE ONLY. VERIFY ACTUAL QUANTITIES AS SHOWN ON PLAN. IF THERE IS A DISCREPANCY, THE PLANTING PLAN SHALL TAKE PRECEDENCE.
2. LANDSCAPE CONTRACTOR SHALL BE RESPONSIBLE FOR LOCATING AND PROTECTING EXISTING UTILITIES
3. PRIOR TO TREE AND SHRUB HOLE EXCAVATION, ALL PLANTING LOCATIONS SHALL BE STAKED OUT BY CONTRACTOR FOR APPROVAL BY ENGINEER. DO NOT PLANT UNTIL GROUND HAS BEEN PREPARED AND FREE OF STONES GREATER THAN 1/2" DIA., SITE IS NEAT, ORDERLY, AND THE ENGINEER ACCEPTS SITE FOR PLANTING.
4. NOTIFY ENGINEER OF ANY DISCREPANCIES IN PLANT LOCATIONS OR INSUFFICIENT PLANT QUANTITIES DUE TO DIFFERENCE IN PLANTS AND ACTUAL FIELD CONDITIONS.
5. NOTIFY ENGINEER 30 DAYS PRIOR TO PLANTING OPERATIONS FOR APPROVAL OF ALL PLANT MATERIAL AT PLACE OF GROWTH. ALL PLANT MATERIAL NOT APPROVED BY THE ENGINEER WILL BE SUBJECT TO REJECTION.
6. THE ENGINEER WILL INSPECT PLANTS AT THE PLACE OF GROWTH AND AFTER THE DELIVERY TO THE PROJECT. EACH TREE SHALL BE TAGGED BY THE ENGINEER WITH A CONSECUTIVELY NUMBERED PLASTIC TAMPER-RESISTANT AND SELF-LOCKING SEAL. SEALS SHALL REMAIN ON TREES AND ONLY BE REMOVED BY THE ENGINEER AT THE COMPLETION OF THE PLANT ESTABLISHMENT PERIOD. TREES DELIVERED TO THE PROJECT WITHOUT ENGINEERS SEAL WILL BE REJECTED.
7. PLANTS SHALL MEET SIZE INDICATED BY MINIMUM HEIGHT AND SPREAD. PLANTS SHALL BE STRAIGHT AND UNIFORMLY SHAPED, UNLESS UNIQUE OR SPECIAL CHARACTERISTICS ARE SPECIFIED, AND SHALL BE UNDAMAGED, SOUND, HEALTHY, VIGOROUS AND FREE OF DISEASE AND INSECT INFESTATION. PLANTS NOT CONFORMING TO THESE REQUIREMENTS ON DELIVERY TO THE PROJECT AND AT THE END OF THE PLANT ESTABLISHMENT PERIOD WILL BE REJECTED.
8. CONTRACTOR SHALL BE SOLELY RESPONSIBLE FOR THE COMPLETE REMOVAL AND DAMAGES RESULTING FROM PLANTING ANY PLANT SPECIES LISTED ON THE HAWAII DEPARTMENT OF AGRICULTURE 'NOXIOUS WEED RULES' AS DEFINED IN THE STATUTE, HAWAII ADMINISTRATIVE RULES 4:68:1 OR THE 'FEDERAL NOXIOUS WEED LIST' AS DEFINED IN TITLE 7 OF THE CODE OF FEDERAL REGULATIONS (CFR), PARTS 360 AND 361
9. ALL TREE WORK MUST ADHERE TO AMERICAN NATIONAL STANDARD INSTITUTE (ORANS) - A300 TREE CARE STANDARDS AND ANSI-Z133 SAFETY STANDARDS FOR TREE WORK. WORK SHALL BE CONTRACTED TO ARBORISTS THAT HAVE BEEN CERTIFIED IN GOOD STANDINGS AS AN ISA CERTIFIED ARBORIST FOR AT LEAST 5 YEARS TO ASSURE THAT TRE WORK IS PERFORMED PROPERLY AND TREES ARE NOT DAMAGED BY PRACTICES SUCH AS TOPPING, FLUSH CUTS, OVER-THINNING, OR CLIMBING WITH SPIKES. CONTRACTOR SHALL SUBMIT A COPY OF THE ISA ARBORIST CERTIFICATION OF GOOD STANDING OF 5 YEARS TO THE ENGINEER MINIMUM 7 DAYS PRIOR TO TREE PRUNING.
10. FOR THE DURATION OF CONSTRUCTION WITHIN THE DRIP LINE OF TREES TO REMAIN THERE MUST BE: NO CHANGES, ALTERATIONS OR DISTURBANCE TO THE GRADE BY ADDING FILL, EXCAVATING OR SCRAPING EXCEPT AS NOTED ON PLANS; NO STORAGE OF CONSTRUCTION MATERIAL OR MATERIAL; NO DISPOSAL OF ANY LIQUIDS (E.G. CONCRETE SLEUTH, GAS, OIL PAINT); NO VEHICULAR TRAFFIC, EQUIPMENT OR EXCESSIVE PEDESTRIAN TRAFFIC; NO ATTACHMENT OF ANY WIRES, ROPES, LIGHTS; OR ANY SUCH ATTACHMENT OTHER THAN THOSE OF PROTECTIVE NATURE TO ANY TREE TO BE PRESERVED; AND NO CLEANING OF EQUIPMENT OR MATERIAL UNDER THE CANOPY OF ANY TREE OR GROUP OF TREES TO REMAIN.
11. PROTECTIVE FENCE SHALL BE ERECTED AROUND TREES IDENTIFIED ON PLAN OR TREES WITH TRUNK DIAMETER GREATER THAN 8 INCHES AS MEASURED AT HEIGHT OF 4 1/2 FEET. PROTECTIVE FENCE SHALL BE 4 FEET HIGH ORANGE PLASTIC MESH OR APPROVED EQUIVALENT SUPPORTED ON STEEL T-POST A MINIMUM OF 6 FEET LONG. PROTECTIVE FENCE SHALL SURROUND TREE AT MINIMUM OF 10 FEET FROM TREE TRUNK WITH STEEL T-POST AT A MINIMUM OF 5 FEET ON CENTER.
12. IF TREES OTHER THAN THOSE SPECIFICALLY DESIGNATED FOR REMOVAL ARE DAMAGED BEYOND SURVIVAL CONDITIONS AS DETERMINED BY ENGINEER. THE CONTRACTOR SHALL REMOVE SUCH TREES AND REPLACE THE TREE WITH A SAME SPECIE AND SIZE AND MAINTAIN FOR THE DURATION OF CONSTRUCTION OR 12 MONTHS WHICHEVER IS GREATER AT NO COST TO THE STATE.
13. PROVIDE EVEN FOUR INCH LAYER OF PLANTING SOIL OVER ALL PLANTING AREAS. REPRESENTATIVE SAMPLES OF SOIL FROM PROJECT SITE SHALL BE SUBMITTED TO THE UNIVERSITY OF HAWAII AGRICULTURAL EXTENSION SERVICE OR LABORATORY ACCEPTABLE TO THE ENGINEER FOR ANALYSIS OF REQUIRED SOIL AMENDMENTS. TEST RESULTS AND FERTILIZATION SCHEDULE SHALL BE PRESENTED TO THE ENGINEER FOR REVIEW AND ACCEPTANCE BEFORE PLACING PLANTING SOIL. UNIFORMLY DISTRIBUTE FERTILIZER AND AMENDMENTS OVER PLANTING AREAS AS RECOMMENDED BY THE SOIL ANANLYSIS REPORT. ROTOTIL TOP FOUR INCHES OF SOIL TO EVENLY INCORPORATE FERTILIZER AND AMENDMENTS.
14. GUY WIRES, FLAGGING, STAKES, WINDBREAKS, ETC. SHALL BE MAINTAINED AND REPLACED IF NECESSARY BY THE CONTRACOTR UNTIL THE TREE OR SHRUB IS ABLE TO STAND BY ITSELF. THE CONTRACTOR SHALL REMOVE AND DISPOSE AT THE END OF THE PLANT ESTABLISHMENT PERIOD.
15. ANY PLANTING THAT OBSTRUCTS SIGHT DISTANCE, SIGNS OR TRAFFIC LIGHTS SHALL BE FELOCATED OR REMOVED AS DETERMINED BY THE ENGINEER.

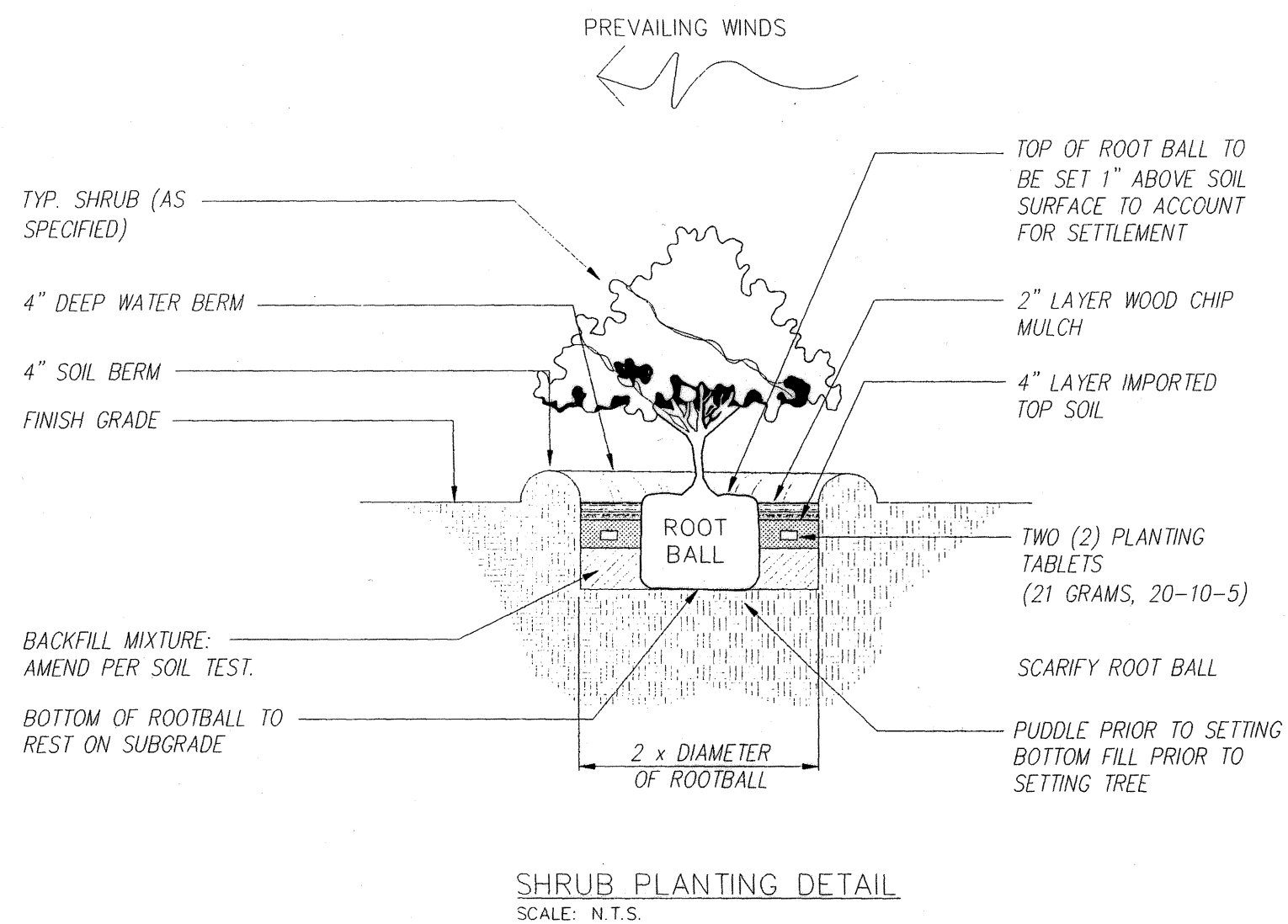
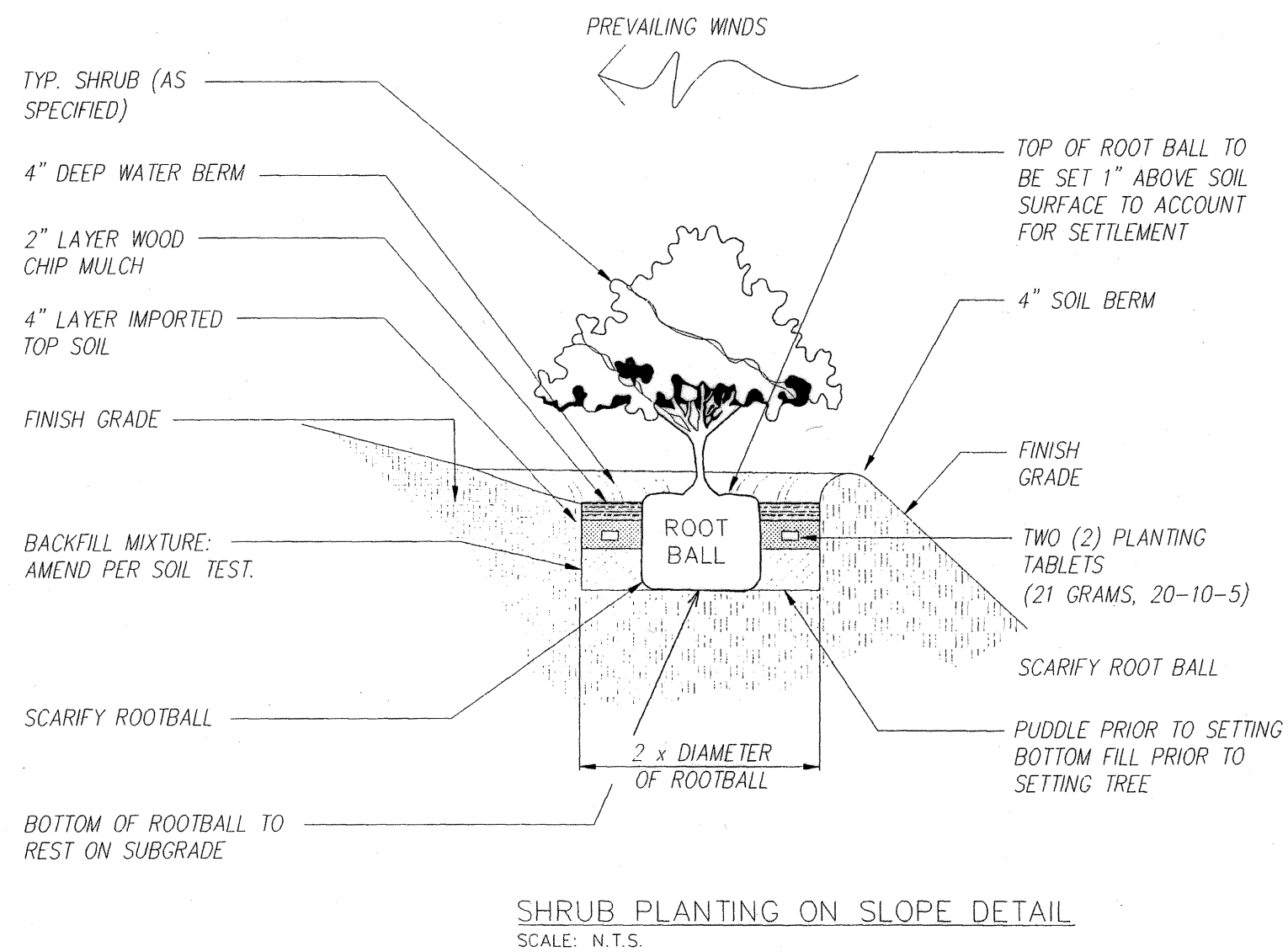

IRRIGATION NOTES:

1. IRRIGATION SHALL BE RAINBIRD LANDSCAPE DRIPLINE (RAINBIRD LD-06-18-xxx), OR APPROVED EQUAL.
2. IRRIGATION LINE WILL TIE INTO EXISTING DRIP LINE THAT ENDS AT BIKE PATH ROUNDABOUT
3. CONTRACTOR WILL VERIFY THE CONDITION OF THE EXISTING DRIP LINE AND MAKE ANY REPAIRS AS NEEDED.
4. CONTRACTOR SHALL CONFIRM, BY FIELD INSPECTION, THAT THE EXISTING IRRIGATION SYSTEM SHALL SUPPORT THE ADDITIONAL WATER REQUIREMENTS OF THE NEW PLANTING.
5. IF NECESSARY, COORDINATE WITH THE GENERAL MANAGER OF ALOHA BEACH RESORT TO INSTALL AN ADDITIONAL DRIP VALVE ASSEMBLY, WHICH SHALL BE A RAINBIRD XCZ-100-B-COM.
6. FOR ESTABLISHMENT OF COMMON BERMUDA GRASS, COORDINATE WITH THE GENERAL MANAGER OF ALOHA BEACH RESORT TO INSTALL A BATTERY-POWERED IRRIGATION CONTROL VALVE TO PROVIDE TEMPORARY ABOVE-GROUND IRRIGATION FOR THE NEW GRASS.
7. ONCE THE GRASS ESTABLISHMENT MAINTENANCE PERIOD IS COMPLETED, THE CONTRACTOR SHALL REMOVE THE CONTROL VALVE AND ANY INCIDENTAL IRRIGATION MATERIALS.
8. THE CONTRACTOR SHALL ENSURE THAT THE TEMPORARY POINT OF CONNECTION AT ALOHA BEACH RESORT IS PROPERLY SEALED TO THE SATISFACTION OF THE GENERAL MANAGER.

| FED. ROAD DIST. NO. | STATE | FED. AID PROJ. NO. | FISCAL YEAR | SHEET NO. | TOTAL SHEETS |
|---------------------|-------|--------------------|-------------|-----------|--------------|
| HAWAII | HAW. | BR-056-1(51) | 2008 | 270 | 284 |

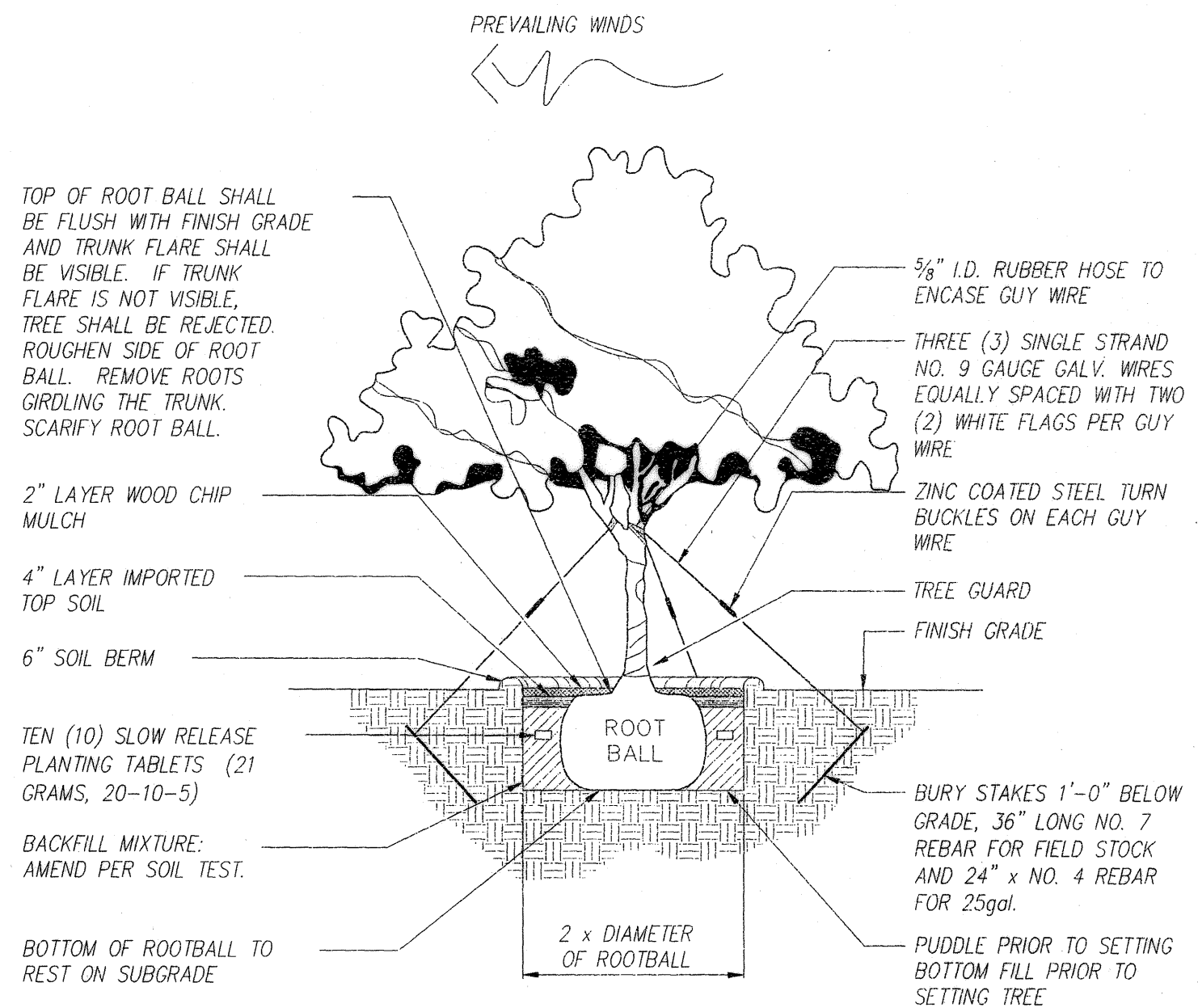

NOTE:
TRUNK MUST BE PROTECTED FROM ROPE SLING BURNS AND ABRASIONS DURING MOVING, TREE SHALL BE PLUMB. IF TREE IS LEANING AT THE END OF THE PLANT ESTABLISHMENT PERIOD, THE TREE SHALL BE REJECTED.

CONTAINER TREE PLANTING DETAIL
SCALE: N.T.S.

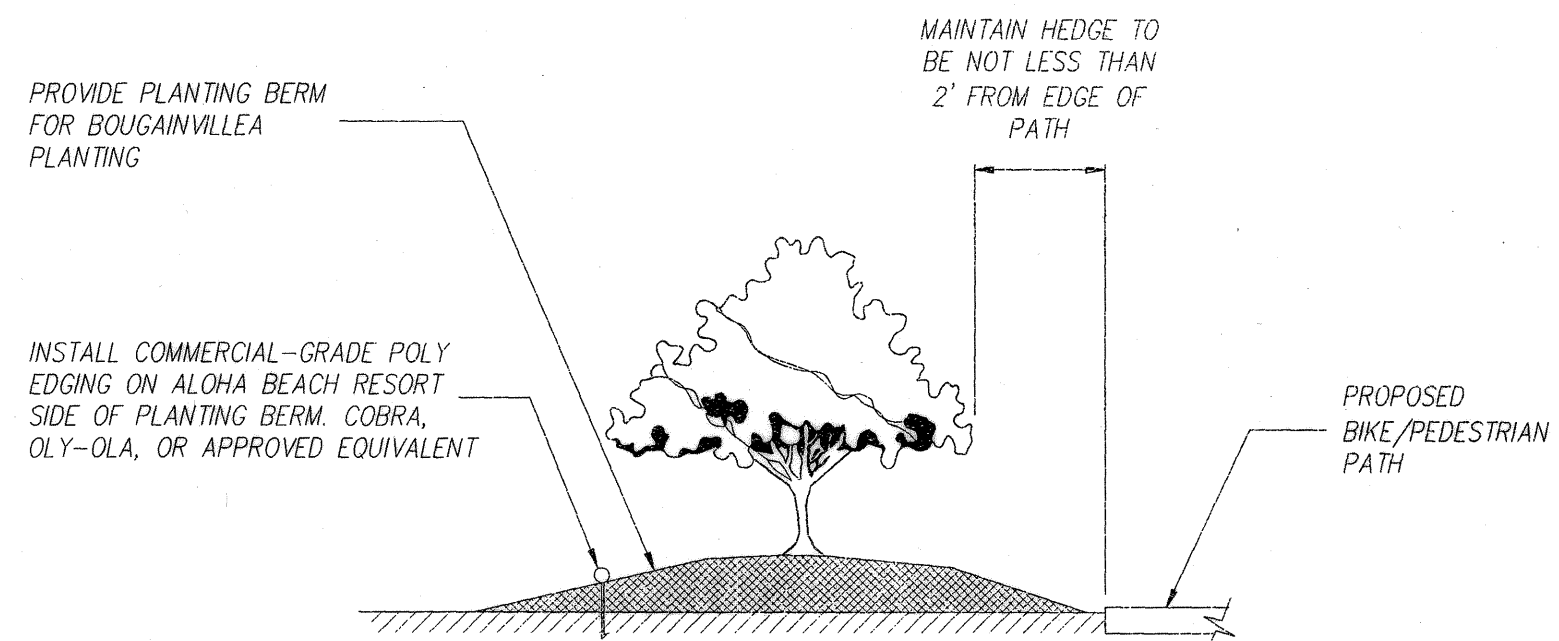

CROSS-SECTION OF BOUGAINVILLEA PLANTING ALONG ALOHA BEACH RESORT FRONTAGE
SCALE: N.T.S.

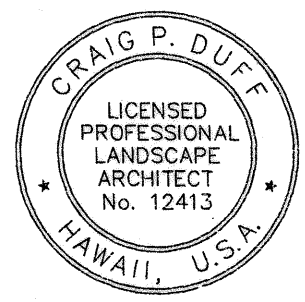

THIS WORK WAS PREPARED BY ME OR UNDER MY SUPERVISION
Craig P. Duff
06/30/2010
Expiration Date of the License
Kauai Nursery & Landscaping, Inc.

| |
|--|
| STATE OF HAWAII DEPARTMENT OF TRANSPORTATION HIGHWAYS DIVISION LANDSCAPE NOTES AND DETAILS KUHIO HIGHWAY, SHORT TERM IMPROVEMENTS Wailua Cone Haul Bridge Widening Fed. Aid Project No. BR-056-1(51) Scale: As Noted Date: MAY 2008 |
| SHEET No. L1.3 OF 3 SHEETS |