

WATER NOTES FOR EXISTING WATER FACILITIES

2. When adjustment of valve boxes and manhole frame/covers are required, it shall be the Contractor's responsibility to offset and record the location of the valve boxes and manhole frame/covers as marked by the Department of Water for the purposes of adjusting to the new finish grade. The Contractor shall preserve all of their offset stakes marking locations of the valve boxes and manhole frame/covers. If offset stakes are damaged or lost, it shall be the Contractor's sole responsibility to survey and re-stake the locations of the valve boxes and manhole frame/covers at their expense.

3. *Adjusting Water Meter Boxes - If necessary, existing service lateral piping shall be adjusted to maintain a spacing of 10" from the centerline of the piping in the meter box to the bottom of the meter box cover. In new sidewalk areas, replace the Type "B" meter box and cover with Type "X" meter box and cover. The top of all water meter boxes shall be flush with the new sidewalk surface.*

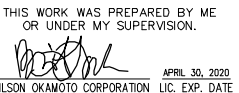

Note:
See "Traffic Signal Plans" for Adjustments/Relocation of Traffic Signal System

Manager and Chief Engineer
Department of Water,
County of Kauai

Date _____

STATE OF HAWAII
DEPARTMENT OF TRANSPORTATION
HIGHWAYS DIVISION

ROADWAY PAVING PLAN

*KUHIO HIGHWAY SHORT-TERM
IMPROVEMENTS KUAMOO ROAD
TO TEMPORARY KAPAA BYPASS ROAD*

Fed. Aid Proj. No. NH-056-I(50)

Scale: 1" = 20' Date: April 2019

SHEET No. *RP9* OF *16* SHEETS

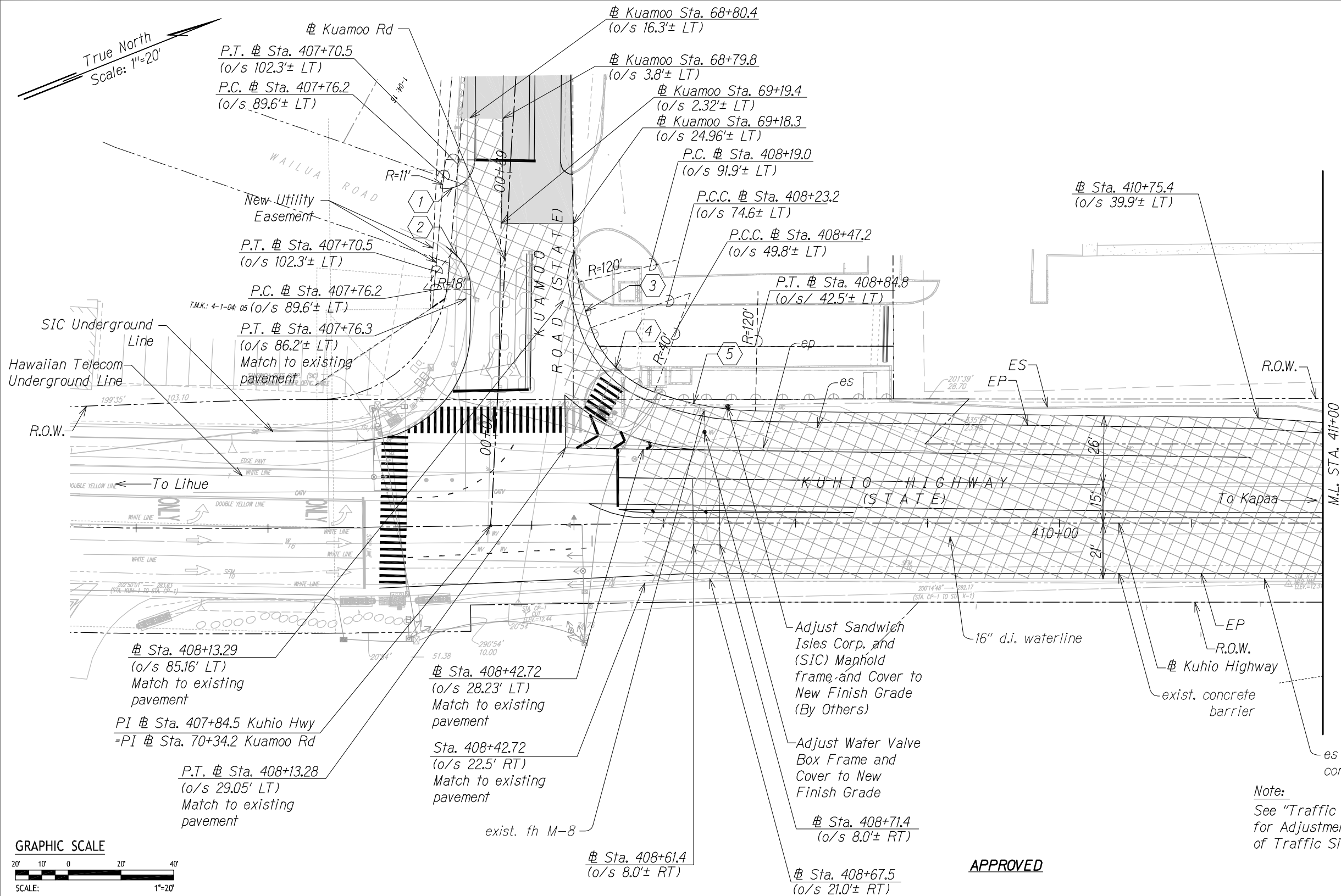

20' 10' 0 20' 40'

SCALE: 1"=20'

Legend:

 *New Pavement Structure*

 *2" Cold Plane Repave with 2" HMA, Mix IV*

CURVE DATA

	1	2	3	4	5
Δ	63° 1' 9"	51° 40' 11"	8° 34' 20"	50° 49' 52"	18° 41' 2"
$\Delta/2$	31° 30' 34"	25° 50' 5"	4° 17' 10"	25° 24' 56"	9° 20' 31"
R	11.00'	18.00'	120.00'	40.00'	120.00'
T	5.52'	7.75'	8.99'	19.01'	19.74'
Ch	9.41'	13.94'	17.94'	34.33'	38.96'
Lc	9.9'	14.43'	7.95'	35.49'	39.13'

ORIGINAL PLAN	SURVEY PLOTTED BY _____	DATE _____
NOTE BOOK	DRAWN BY _____	" _____
	TRACED BY _____	" _____
	DESIGNED BY _____	" _____
	QUANTITIES BY _____	" _____
	CHECKED BY _____	" _____
No. _____		

FED. ROAD DIST. NO.	STATE	FED. AID PROJ. NO.	FISCAL YEAR	SHEET NO.	TOTAL SHEETS
KAUAI	HAW.	NH-056-1(50)	2019	35	242

WATER NOTES FOR
EXISTING WATER FACILITIES

1. Prior to commencing his operations, the Contractor shall contact the County of Kaua'i, Department of Water Operations Division (phone no. 245-5444) and make arrangements for the Department to "tone" and mark the existing water facilities located within the project limits, such as waterlines, valve boxes, water meter boxes, and manhole frame/covers, etc., shall be adjusted to match the new finished grades noted on the construction plans.
2. When adjustment of valve boxes and manhole frame/covers are required, it shall be the Contractor's responsibility to offset and record the location of the valve boxes and manhole frame/covers as marked by the Department of Water for the purposes of adjusting to the new finish grade. The Contractor shall preserve all of their offset stakes marking locations of the valve boxes and manhole frame/covers. If offset stakes are damaged or lost, it shall be the Contractor's sole responsibility to survey and re-stake the locations of the valve boxes and manhole frame/covers at their expense.
3. Adjusting Water Meter Boxes - If necessary, existing service lateral piping shall be adjusted to maintain a spacing of 10" from the centerline of the piping in the meter box to the bottom of the meter box cover. In new sidewalk areas, replace the Type "B" meter box and cover with Type "X" meter box and cover. The top of all water meter boxes shall be flush with the new sidewalk surface.



THIS WORK WAS PREPARED BY ME
OR UNDER MY SUPERVISION.
Wilson Okamoto
WILSON OKAMOTO CORPORATION L.C. EXP. DATE
APRIL 30, 2020

STATE OF HAWAII
DEPARTMENT OF TRANSPORTATION
HIGHWAYS DIVISION

ROADWAY PAVING PLAN

**KUHIO HIGHWAY SHORT-TERM
IMPROVEMENTS KUAMOO ROAD
TO TEMPORARY KAPAA BYPASS ROAD**

Fed. Aid Proj. No. NH-056-1(50)

Scale: 1" = 20' Date: April 2019

SHEET No. RP10 OF 16 SHEETS

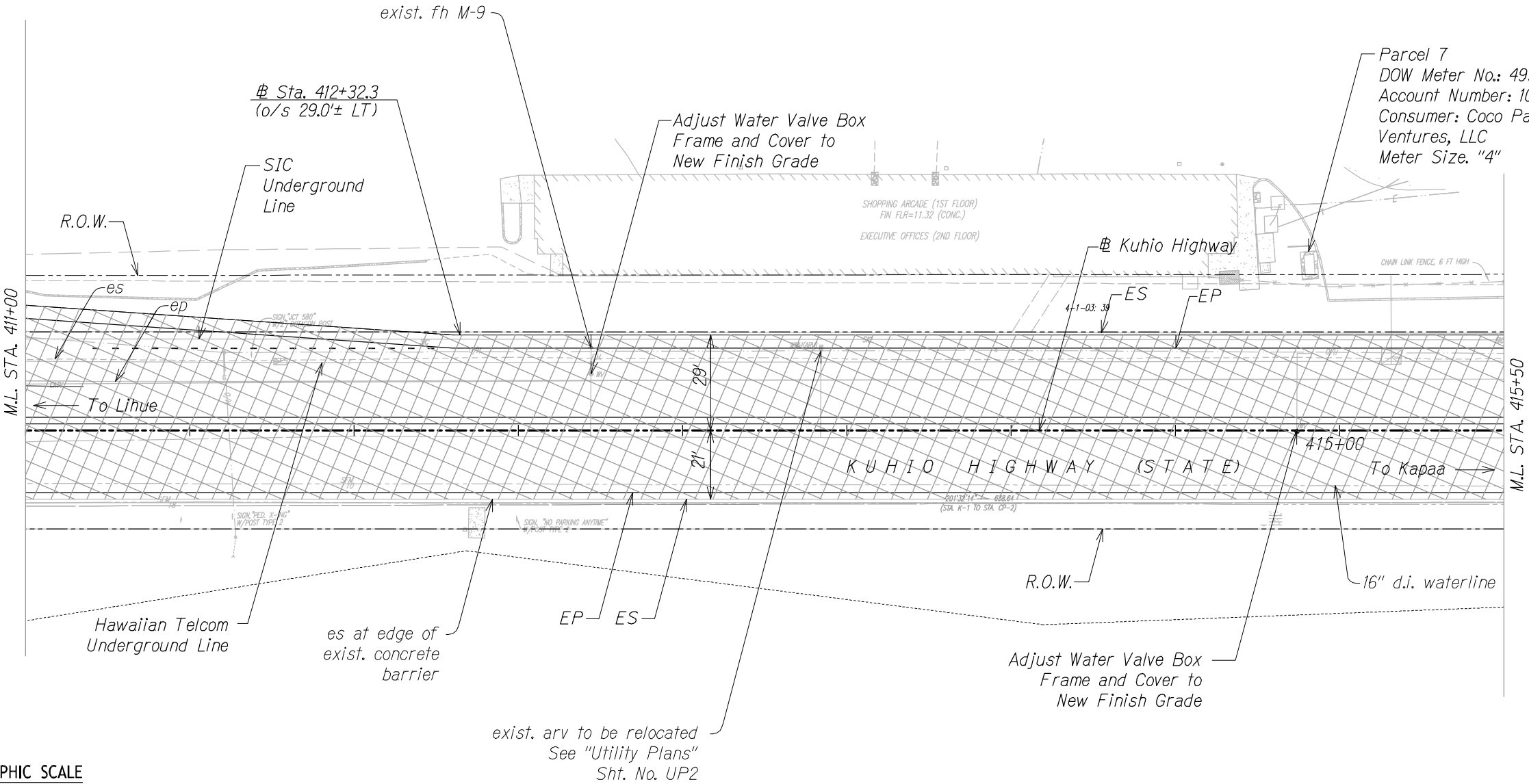
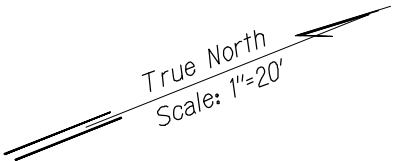

GRAPHIC SCALE



Legend:

- New Pavement Structure
- 2" Cold Plane Repave with 2" HMA, Mix IV

APPROVED

Manager and Chief Engineer
Department of Water,
County of Kauai

Date

FED. ROAD DIST. NO.	STATE	FED. AID PROJ. NO.	FISCAL YEAR	SHEET NO.	TOTAL SHEETS
KAUAI	HAW.	NH-056-1(50)	2019	36	242

True North
Scale: 1"=20'

WATER NOTES FOR EXISTING WATER FACILITIES

1. Prior to commencing his operations, the Contractor shall contact the County of Kaua'i, Department of Water Operations Division (phone no. 245-5444) and make arrangements for the Department to "tone" and mark the existing water facilities located within the project limits, such as waterlines, valve boxes, water meter boxes, and manhole frame/covers, etc., shall be adjusted to match the new finished grades noted on the construction plans.
2. When adjustment of valve boxes and manhole frame/covers are required, it shall be the Contractor's responsibility to offset and record the location of the valve boxes and manhole frame/covers as marked by the Department of Water for the purposes of adjusting to the new finish grade. The Contractor shall preserve all of their offset stakes marking locations of the valve boxes and manhole frame/covers. If offset stakes are damaged or lost, it shall be the Contractor's sole responsibility to survey and re-stake the locations of the valve boxes and manhole frame/covers at their expense.
3. Adjusting Water Meter Boxes - If necessary, existing service lateral piping shall be adjusted to maintain a spacing of 10" from the centerline of the piping in the meter box to the bottom of the meter box cover. In new sidewalk areas, replace the Type "B" meter box and cover with Type "X" meter box and cover. The top of all water meter boxes shall be flush with the new sidewalk surface.

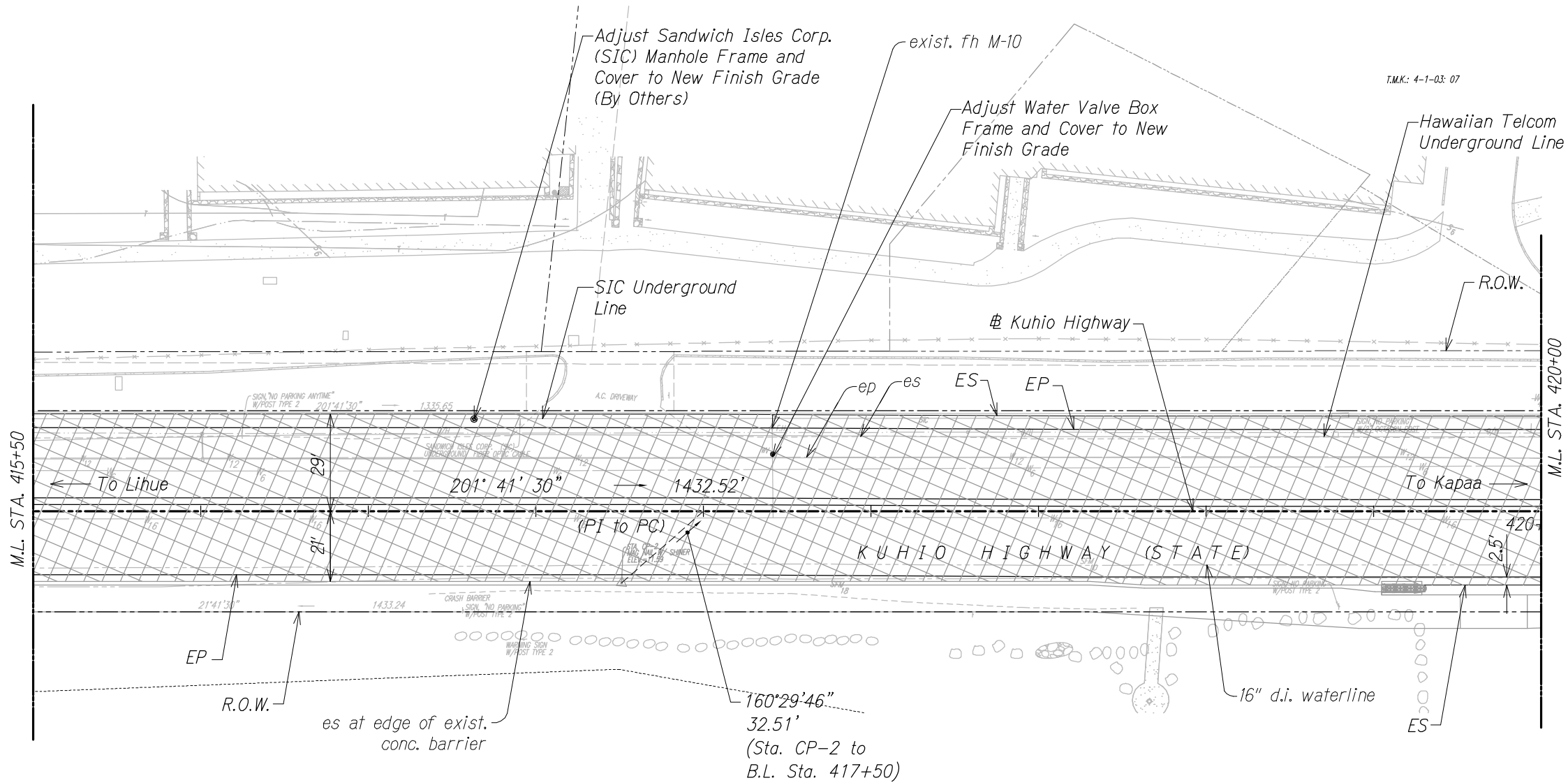

GRAPHIC SCALE



Legend:

- New Pavement Structure
- 2" Cold Plane Repave with 2" HMA, Mix IV

APPROVED

Manager and Chief Engineer
Department of Water,
County of Kauai
Date



THIS WORK WAS PREPARED BY ME
OR UNDER MY SUPERVISION.
[Signature]
WILSON OKAMOTO CORPORATION LIC. EXP. DATE
APRIL 30, 2020

STATE OF HAWAII
DEPARTMENT OF TRANSPORTATION
HIGHWAYS DIVISION
ROADWAY PAVING PLAN
KUHIO HIGHWAY SHORT-TERM IMPROVEMENTS KUAMOO ROAD TO TEMPORARY KAPAA BYPASS ROAD
Fed. Aid Proj. No. NH-056-1(50)
Scale: 1" = 20' Date: April 2019
SHEET No. RP11 OF 16 SHEETS

FED. ROAD DIST. NO.	STATE	FED. AID PROJ. NO.	FISCAL YEAR	SHEET NO.	TOTAL SHEETS
KAUAI	HAW.	NH-056-1(50)	2019	38	242

CURVE DATA

	7	8	12	13	14	15	16
Δ	66° 56' 20"	67° 57' 1"	20° 31' 11"	11° 57' 4"	26° 46' 40"	49° 15' 47"	14° 55' 16"
$\Delta/2$	33° 28' 10"	33° 58' 30"	10° 15' 35"	5° 58' 32"	13° 23' 20"	24° 37' 53"	7° 27' 38"
R	30.00'	41.94'	200.50'	149.00'	99.00'	49.00'	99.00'
T	19.83'	28.26'	36.29'	15.60'	23.56'	22.47'	12.96'
Ch	33.09'	46.88'	71.42'	31.02'	45.85'	40.84'	25.71'
Lc	35.05'	49.74'	71.81'	31.08'	46.27'	42.13'	25.78'

WATER NOTES FOR EXISTING WATER FACILITIES

1. Prior to commencing his operations, the Contractor shall contact the County of Kauai, Department of Water Operations Division (phone no. 245-5444) and make arrangements for the Department to "tone" and mark the existing water facilities located within the project limits, such as waterlines, valve boxes, water meter boxes, and manhole frame/covers, etc., shall be adjusted to match the new finished grades noted on the construction plans.
2. When adjustment of valve boxes and manhole frame/covers are required, it shall be the Contractor's responsibility to offset and record the location of the valve boxes and manhole frame/covers as marked by the Department of Water for the purposes of adjusting to the new finish grade. The Contractor shall preserve all of their offset stakes marking locations of the valve boxes and manhole frame/covers. If offset stakes are damaged or lost, it shall be the Contractor's sole responsibility to survey and re-stake the locations of the valve boxes and manhole frame/covers at their expense.
3. Adjusting Water Meter Boxes - If necessary, existing service lateral piping shall be adjusted to maintain a spacing of 10" from the centerline of the piping in the meter box to the bottom of the meter box cover. In new sidewalk areas, replace the Type "B" meter box and cover with Type "X" meter box and cover. The top of all water meter boxes shall be flush with the new sidewalk surface.

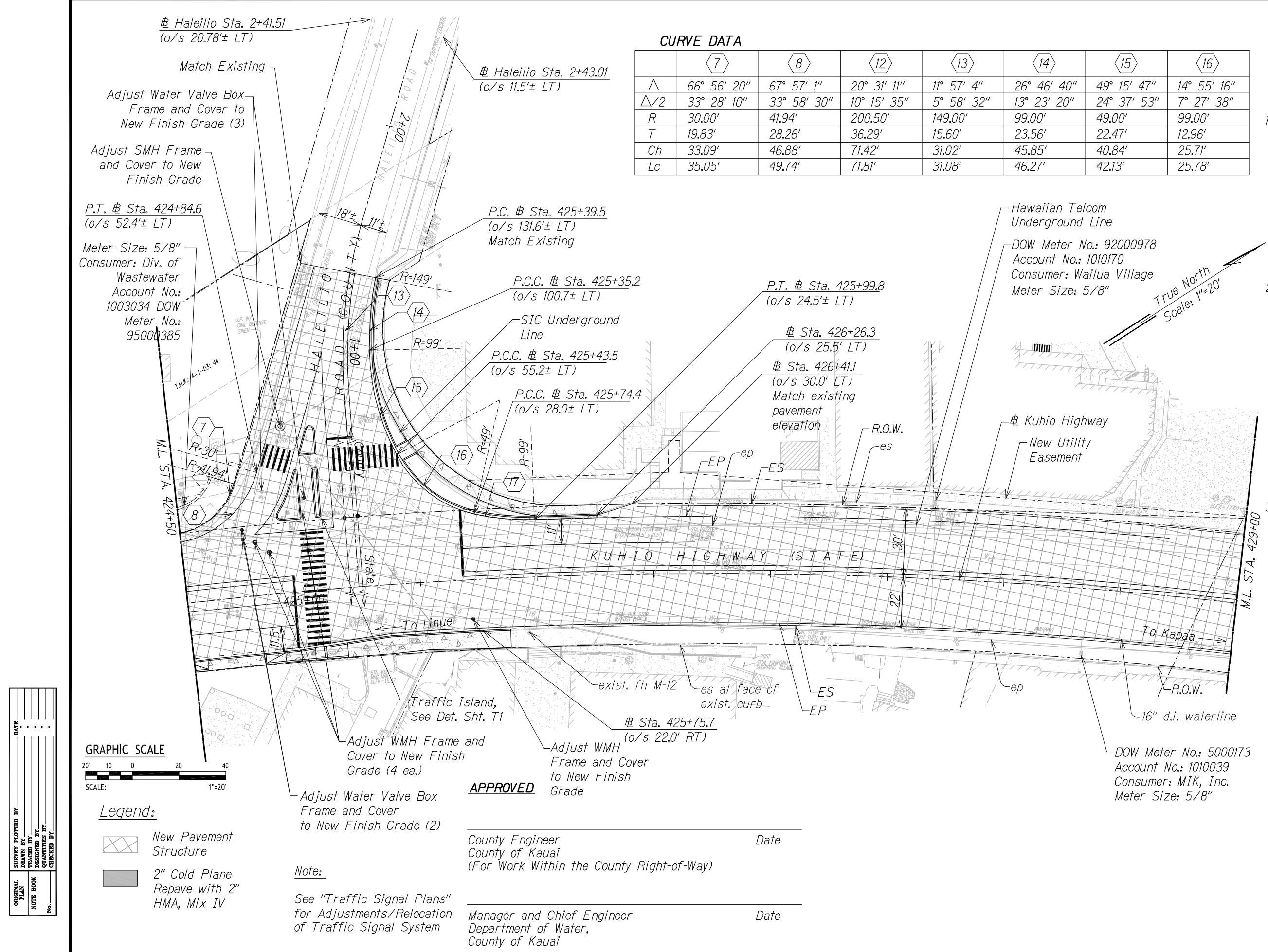

SURVEY PLOTTED BY	DATE
DRAWN BY	
DESIGNED BY	
QUANTITIES BY	
CHECKED BY	
ORIGINAL PLAN	
NOTE BOOK	
No.	



THIS WORK WAS PREPARED BY ME OR UNDER MY SUPERVISION.
APRIL 30, 2020
WILSON OKAMOTO CORPORATION L.C. EXP. DATE

STATE OF HAWAII
DEPARTMENT OF TRANSPORTATION
HIGHWAYS DIVISION

ROADWAY PAVING PLAN



KUHIO HIGHWAY SHORT-TERM
IMPROVEMENTS KUAMOO ROAD
TO TEMPORARY KAPAA BYPASS ROAD

Fed. Aid Proj. No. NH-056-1(50)

Scale: 1" = 20' Date: April 2019

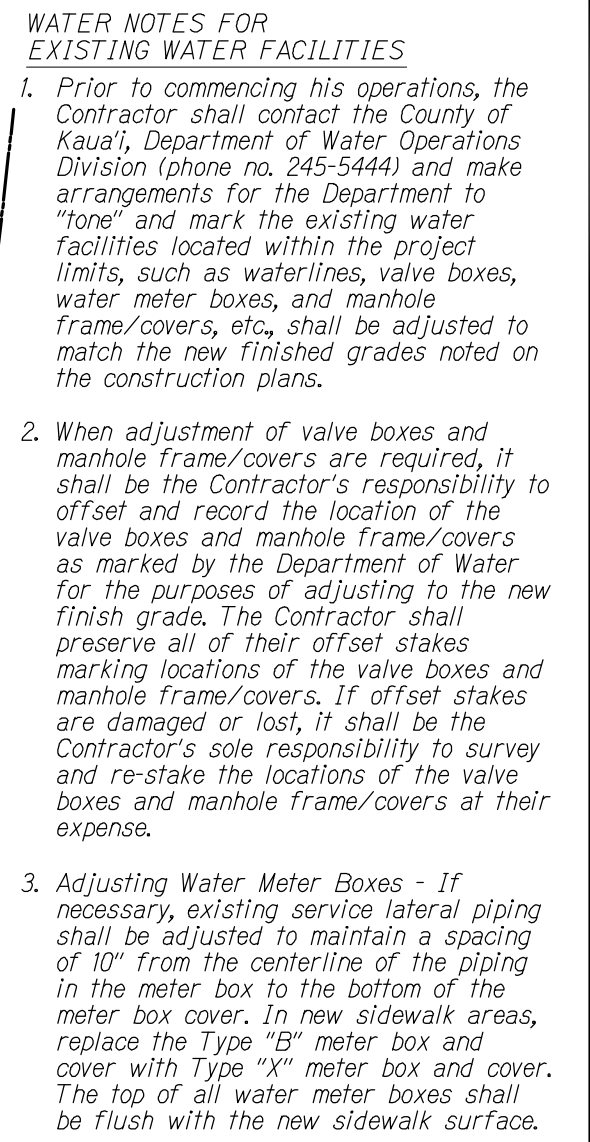
SHEET No. RP13 OF 16 SHEETS



			
Δ	16° 36' 9"	75° 54' 38"	59° 52' 54"
$\Delta/2$	8° 18' 5"	37° 27' 19"	29° 56' 27"
R	29.00'	39.73'	30.29'
T	4.23'	30.44'	17.45
Ch	8.37'	48.32'	30.24'
Lc	8.40'	51.94'	31.66'

APPROVED

Manager and Chief Engineer
Department of Water,
County of Kauai

Date



THIS WORK WAS PREPARED BY ME
OR UNDER MY SUPERVISION.



WILSON OKAMOTO CORPORATION

APRIL 30, 2020

LIC. EXP. DATE

STATE OF HAWAII
DEPARTMENT OF TRANSPORTATION
HIGHWAYS DIVISION

ROADWAY PAVING PLAN

KUHIO HIGHWAY SHORT-TERM
IMPROVEMENTS KUAMOO ROAD
TO TEMPORARY KAPAA BYPASS ROAD
Fed. Aid Proj. No. NH-056-1(K50)

Scale: 1" = 20' Date: April 1959

SHEET No. *RP14* OF 16 SHEETS

FED. ROAD DIST. NO.	STATE	FED. AID PROJ. NO.	FISCAL YEAR	SHEET NO.	TOTAL SHEETS
KAUAI	HAW.	NH-056-1(50)	2019	40	242

WATER NOTES FOR
EXISTING WATER FACILITIES

1. Prior to commencing his operations, the Contractor shall contact the County of Kaua'i, Department of Water Operations Division (phone no. 245-5444) and make arrangements for the Department to "tone" and mark the existing water facilities located within the project limits, such as waterlines, valve boxes, water meter boxes, and manhole frame/covers, etc., shall be adjusted to match the new finished grades noted on the construction plans.
2. When adjustment of valve boxes and manhole frame/covers are required, it shall be the Contractor's responsibility to offset and record the location of the valve boxes and manhole frame/covers as marked by the Department of Water for the purposes of adjusting to the new finish grade. The Contractor shall preserve all of their offset stakes marking locations of the valve boxes and manhole frame/covers. If offset stakes are damaged or lost, it shall be the Contractor's sole responsibility to survey and re-stake the locations of the valve boxes and manhole frame/covers at their expense.
3. Adjusting Water Meter Boxes - If necessary, existing service lateral piping shall be adjusted to maintain a spacing of 10" from the centerline of the piping in the meter box to the bottom of the meter box cover. In new sidewalk areas, replace the Type "B" meter box and cover with Type "X" meter box and cover. The top of all water meter boxes shall be flush with the new sidewalk surface.



THIS WORK WAS PREPARED BY ME
OR UNDER MY SUPERVISION.

[Signature]
WILSON OKAMOTO CORPORATION LIC. EXP. DATE

STATE OF HAWAII
DEPARTMENT OF TRANSPORTATION
HIGHWAYS DIVISION

ROADWAY PAVING PLAN

KUHIO HIGHWAY SHORT-TERM
IMPROVEMENTS KUAMOO ROAD
TO TEMPORARY KAPAA BYPASS ROAD

Fed. Aid Proj. No. NH-056-1(50)

Scale: 20' Date: April 2019

SHEET 40 OF 15 SHEETS

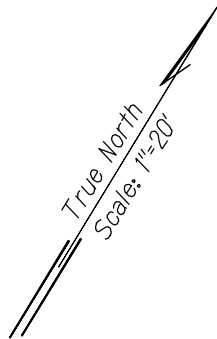

15' Wide Proposed Easement
for Utility Purposes in Favor
of Various Utility Companies

New Utility Easement

FH Removed
(By Others)

Adjust TEL. MH Frame and
Cover to New Finish Grade

SIC Underground
Line

Hawaiian Telcom
Underground Line

Construction
Parcel

Sta. 436+26.0
(o/s 24.5' LT)
Begin 290' Taper

R.O.W.

R.O.W.

ES

EP

M.L. STA. 433+50

To Lihue

435+00

KUHIO HIGHWAY (STATE)

To Kapaa

Sta. 435+75.7

R.O.W.

ES

EP

exist. fh M-14

Water Valve Box
Removed (By Others)

Adjust Water Valve Box
Frame and Cover to New
Finish Grade

P.T. Sta. 435+75.77

Sta. 435+75.7
(o/s 22.7' RT)

ES at Edge of
Concrete Gutter

GRAPHIC SCALE



Legend:



New Pavement
Structure



2" Cold Plane
Repave with 2"
HMA, Mix IV

APPROVED

Manager and Chief Engineer
Department of Water,
County of Kauai

Date

SURVEY PLOTTED BY	DATE
DRAWN BY	
DESIGNED BY	
QUANTITIES BY	
CHECKED BY	
ORIGINAL PLAN	
NOTE BOOK	
No.	

FED. ROAD DIST. NO.	STATE	FED. AID PROJ. NO.	FISCAL YEAR	SHEET NO.	TOTAL SHEETS
KAUAI	HAW.	NH-056-1(150)	2019	41	242

- WATER NOTES FOR EXISTING WATER FACILITIES**
1. Prior to commencing his operations, the Contractor shall contact the County of Kauai, Department of Water Operations Division (phone no. 245-5444) and make arrangements for the Department to "tone" and mark the existing water facilities located within the project limits, such as waterlines, valve boxes, water meter boxes, and manhole frame/covers, etc., shall be adjusted to match the new finished grades noted on the construction plans.
 2. When adjustment of valve boxes and manhole frame/covers are required, it shall be the Contractor's responsibility to offset and record the location of the valve boxes and manhole frame/covers as marked by the Department of Water for the purposes of adjusting to the new finish grade. The Contractor shall preserve all of their offset stakes marking locations of the valve boxes and manhole frame/covers. If offset stakes are damaged or lost, it shall be the Contractor's sole responsibility to survey and re-stake the locations of the valve boxes and manhole frame/covers at their expense.
 3. Adjusting Water Meter Boxes - If necessary, existing service lateral piping shall be adjusted to maintain a spacing of 10" from the centerline of the piping in the meter box to the bottom of the meter box cover. In new sidewalk areas, replace the Type "B" meter box and cover with Type "X" meter box and cover. The top of all water meter boxes shall be flush with the new sidewalk surface.



THIS WORK WAS PREPARED BY ME OR UNDER MY SUPERVISION.
[Signature]
WILSON OKAMOTO CORPORATION LIC. EXP. DATE APRIL 30, 2020

STATE OF HAWAII
DEPARTMENT OF TRANSPORTATION
HIGHWAYS DIVISION

ROADWAY PAVING PLAN

KUHIO HIGHWAY SHORT-TERM
IMPROVEMENTS KUAMOO ROAD
TO TEMPORARY KAPAA BYPASS ROAD

Fed. Aid Proj. No. NH-056-1(150)

Scale: 1" = 20' Date: April 2019

SHEET No. RP16 OF 16 SHEETS

CURVE DATA						
	20	21	22	23	24	25
Δ	29° 24' 38"	34° 12' 40"	26° 4' 49"	13° 7' 5"	62° 58' 55"	13° 55' 35"
Δ/2	14° 42' 19"	17° 6' 20"	13° 2' 24"	6° 33' 32"	31° 29' 27"	6° 57' 47"
R	78.00'	48.00'	77.97'	80.00'	50.00'	80.00'
T	20.47'	14.77'	18.06'	9.20'	30.63'	9.77'
Ch	39.60'	28.24'	35.18'	18.28'	52.24'	19.40'
Lc	40.04'	28.66'	35.49'	18.32'	54.96'	19.44'

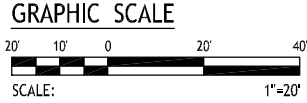
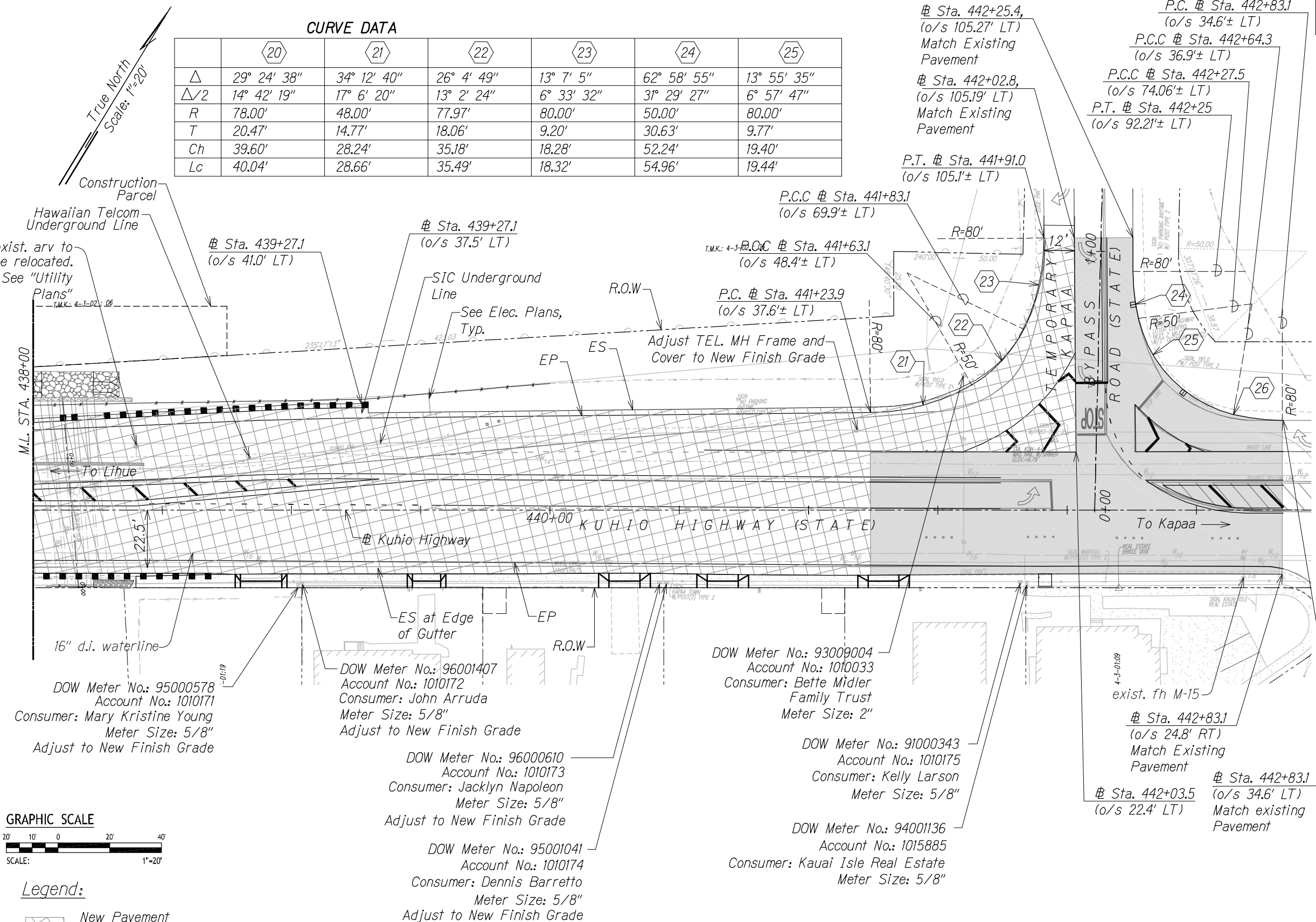

- Legend:**
- New Pavement Structure
 - 2" Cold Plane Repave with 2" HMA, Mix IV

APPROVED

Manager and Chief Engineer
Department of Water,
County of Kauai

Date

DATE	_____
SURVEY PLOTTED BY	_____
DRAWN BY	_____
DESIGNED BY	_____
QUANTITIES BY	_____
CHECKED BY	_____
ORIGINAL PLAN	_____
NOTE BOOK	_____
No.	_____