

FED. ROAD DIST. NO.	STATE	FED. AID PROJ. NO.	FISCAL YEAR	SHEET NO.	TOTAL SHEETS
KAUAI	HAW.	NH-056-1(50)	2019	C.O.ADD.75	244

Legend:

- Remove exist. concrete and/or exist. a.c.. pavement including asphalt base and aggregate subbase
- 2" Cold Plane Repave with 2" HMA, Mix IV

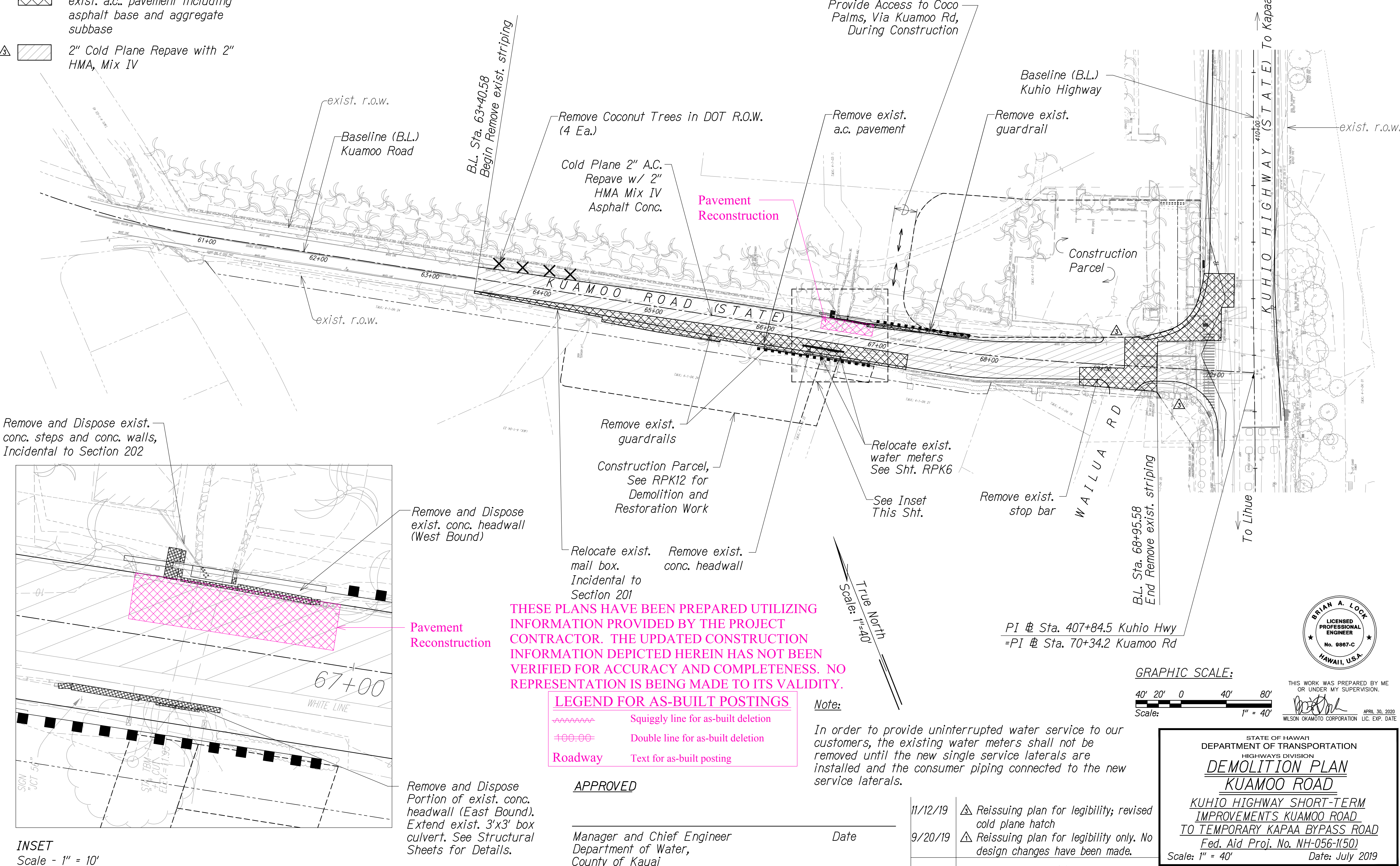

THESE PLANS HAVE BEEN PREPARED UTILIZING INFORMATION PROVIDED BY THE PROJECT CONTRACTOR. THE UPDATED CONSTRUCTION INFORMATION DEPICTED HEREIN HAS NOT BEEN VERIFIED FOR ACCURACY AND COMPLETENESS. NO REPRESENTATION IS BEING MADE TO ITS VALIDITY.

LEGEND FOR AS-BUILT POSTINGS	
	Squiggly line for as-built deletion
	Double line for as-built deletion
Roadway	Text for as-built posting

Note:
In order to provide uninterrupted water service to our customers, the existing water meters shall not be removed until the new single service laterals are installed and the consumer piping connected to the new service laterals.

APPROVED

Manager and Chief Engineer
Department of Water,
County of Kauai

Date

DATE	REVISION
11/12/19	△ Reissuing plan for legibility; revised cold plane hatch
9/20/19	△ Reissuing plan for legibility only. No design changes have been made.

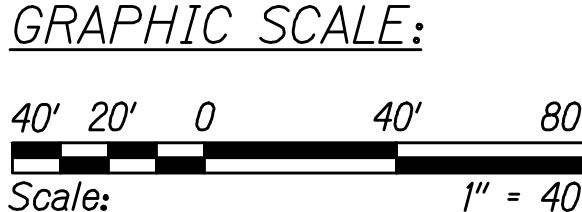
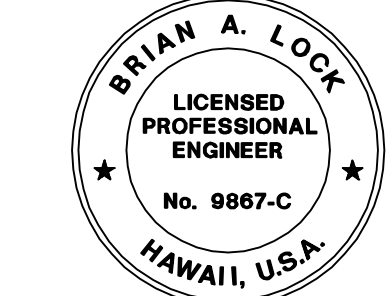

THIS WORK WAS PREPARED BY ME OR UNDER MY SUPERVISION.
WILSON OKAMOTO CORPORATION LIC. EXP. DATE

STATE OF HAWAII
DEPARTMENT OF TRANSPORTATION
HIGHWAYS DIVISION
DEMOLITION PLAN
KUAMOO ROAD
KUHIO HIGHWAY SHORT-TERM
IMPROVEMENTS KUAMOO ROAD
TO TEMPORARY KAPAA BYPASS ROAD
Fed. Aid Proj. No. NH-056-1(50)
Scale: 1" = 40'
Date: July 2019
SHEET No. RPK1 OF 13 SHEETS

SURVEY PLOTTED BY	DATE
DRAWN BY	
TRACED BY	
CHECKED BY	
ORIGINAL PLAN	
NOTE BOOK	
No.	

INSET
Scale - 1" = 10'

"AS-BUILT"

C.O.ADD.75

FED. ROAD DIST. NO.	STATE	FED. AID PROJ. NO.	FISCAL YEAR	SHEET NO.	TOTAL SHEETS
KAUAI	HAW.	NH-056-1(50)	2019	C.O.ADD.76	244

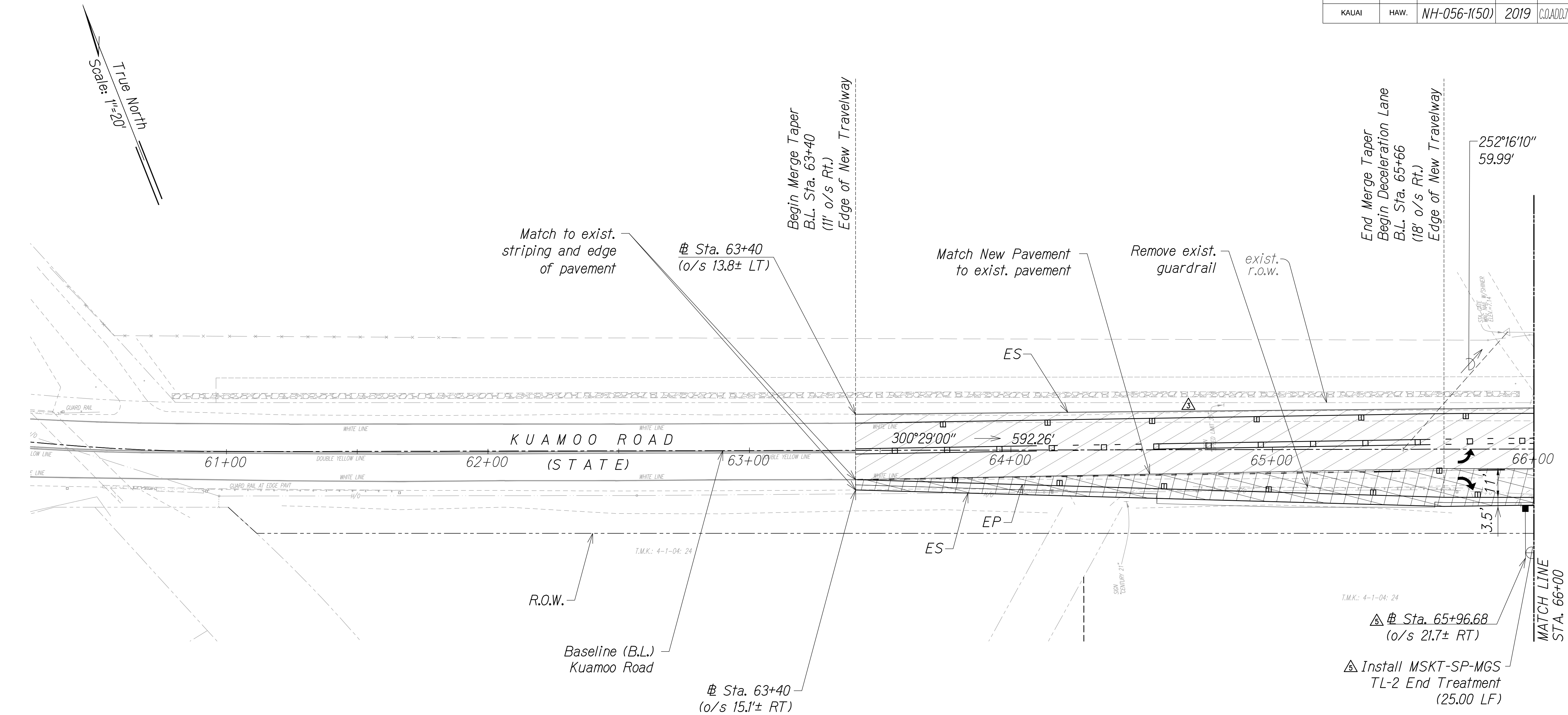

Legend:

- New Pavement Structure
- Cold Plane

GRAPHIC SCALE:

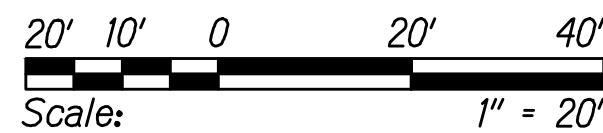

THESE PLANS HAVE BEEN PREPARED UTILIZING INFORMATION PROVIDED BY THE PROJECT CONTRACTOR. THE UPDATED CONSTRUCTION INFORMATION DEPICTED HEREIN HAS NOT BEEN VERIFIED FOR ACCURACY AND COMPLETENESS. NO REPRESENTATION IS BEING MADE TO ITS VALIDITY.

6/2/21	△ Replacing attenuator with guardrail and end treatment
11/12/19	△ Reissuing plan for legibility; revised cold plane hatch
9/20/19	△ Reissuing plan for legibility only. No design changes have been made.

DATE REVISION

"AS-BUILT"

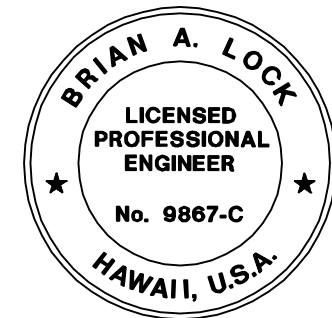

THIS WORK WAS PREPARED BY ME OR UNDER MY SUPERVISION.
[Signature]
WILSON OKAMOTO CORPORATION LIC. EXP. DATE

STATE OF HAWAII
DEPARTMENT OF TRANSPORTATION
HIGHWAYS DIVISION
ROADWAY PLAN
KUAMOO ROAD
KUHO HIGHWAY SHORT-TERM
IMPROVEMENTS KUAMOO ROAD
TO TEMPORARY KAPAA BYPASS ROAD
Fed. Aid Proj. No. NH-056-1(50)
Scale: 1" = 20' Date: July 2019

SHEET No. RPK2 OF 13 SHEETS

C.O.ADD.76

FED. ROAD DIST. NO.	STATE	FED. AID PROJ. NO.	FISCAL YEAR	SHEET NO.	TOTAL SHEETS
KAUAI	HAW.	NH-056-1(50)	2019	ADD.78	244

True North
Scale: 1"=20'

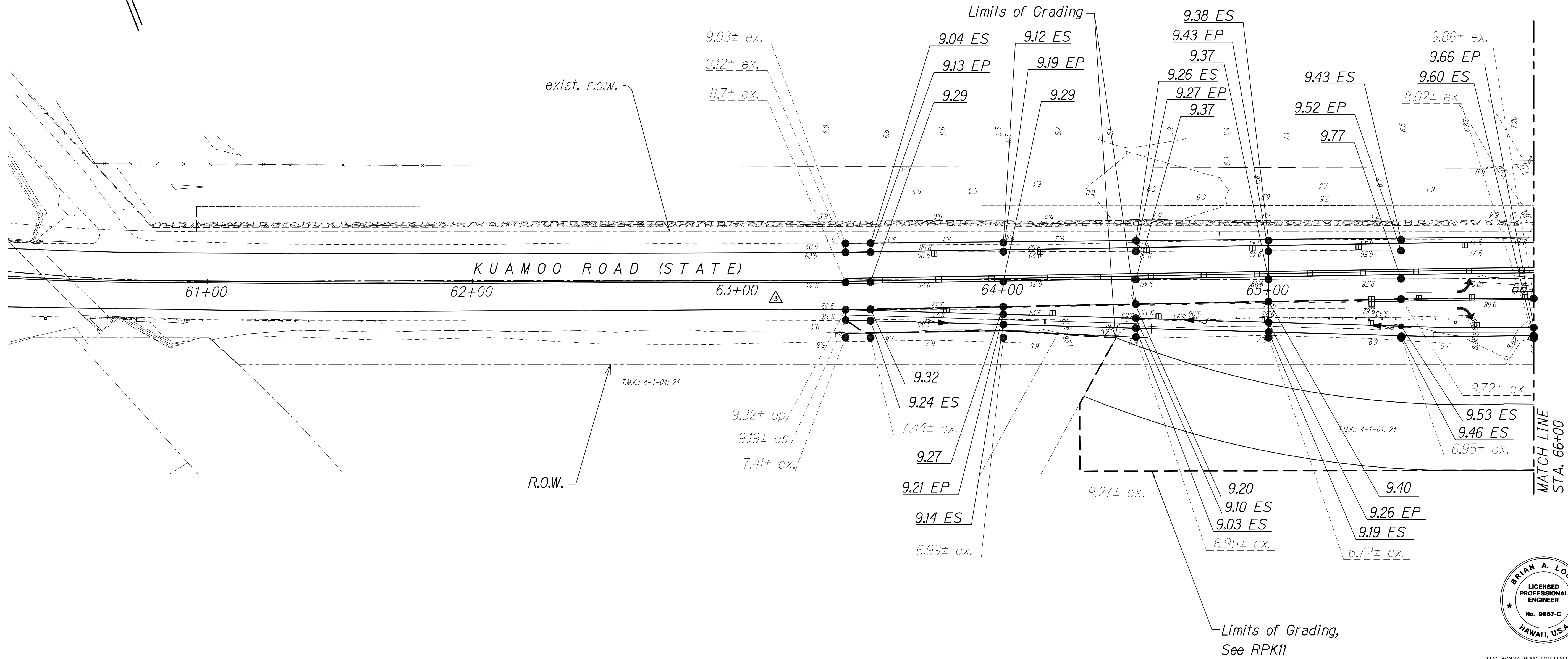

DATE	SURVEY PLOTTED BY
DATE	DRAWN BY
DATE	TRACED BY
DATE	CHECKED BY
DATE	REVIEWED BY
DATE	APPROVED BY

GRAPHIC SCALE:

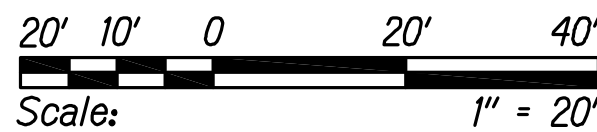

11/12/19	△ Reissuing plan for legibility; deleted elevation labels
9/20/19	△ Reissuing plan for legibility only. No design changes have been made.

DATE	REVISION
------	----------

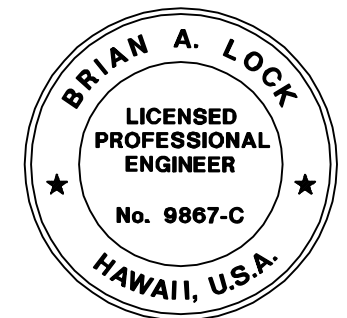

THIS WORK WAS PREPARED BY ME
OR UNDER MY SUPERVISION.
[Signature]
WILSON OKAMOTO CORPORATION LIC. EXP. DATE

STATE OF HAWAII
DEPARTMENT OF TRANSPORTATION
HIGHWAYS DIVISION
GRADING PLAN
KUAMOO ROAD
KUHIO HIGHWAY SHORT-TERM
IMPROVEMENTS KUAMOO ROAD
TO TEMPORARY KAPAA BYPASS ROAD
Fed. Aid Proj. No. NH-056-1(50)
Scale: 1" = 20' Date: July 2019
SHEET No. RPK4 OF 13 SHEETS

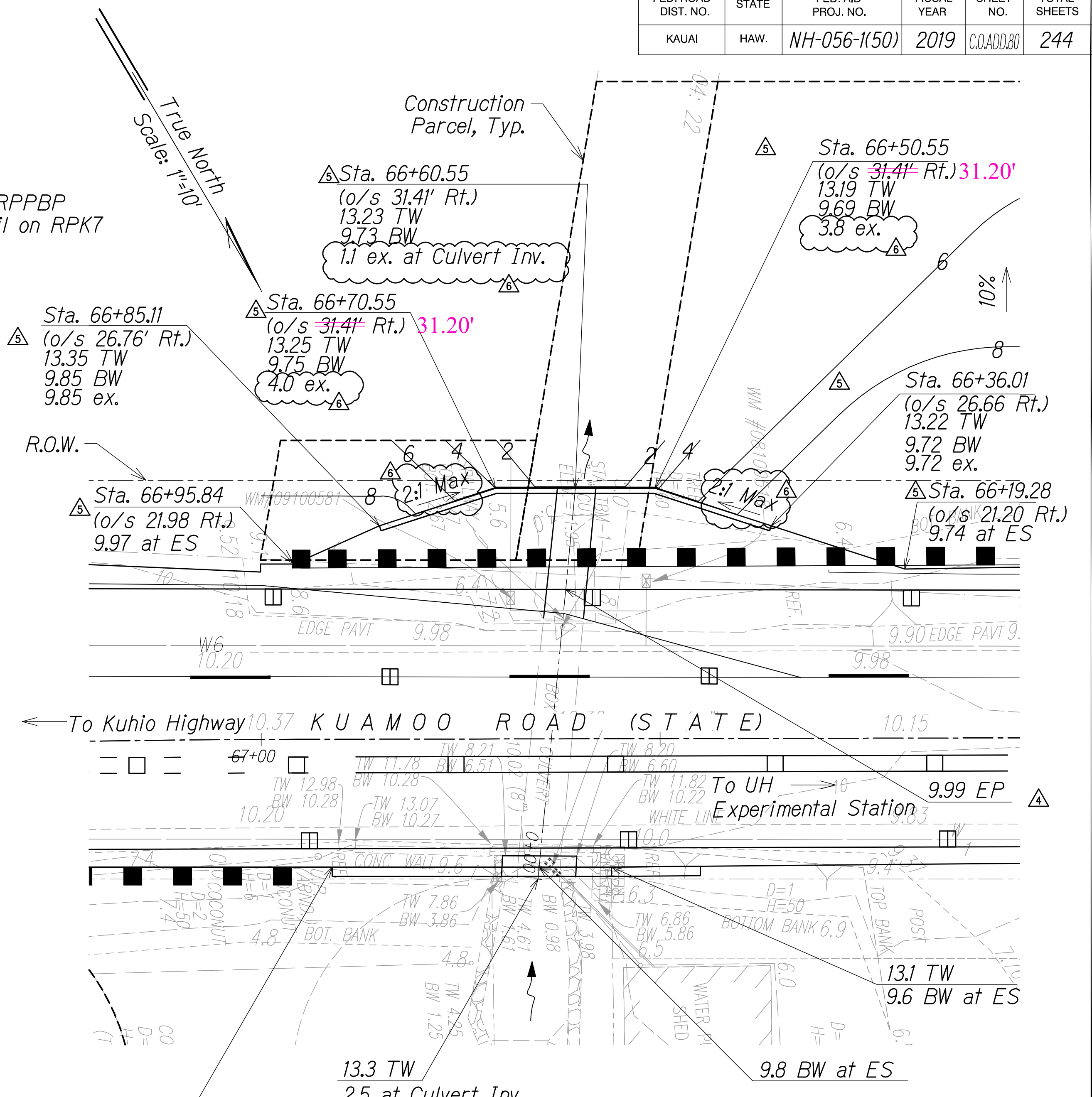
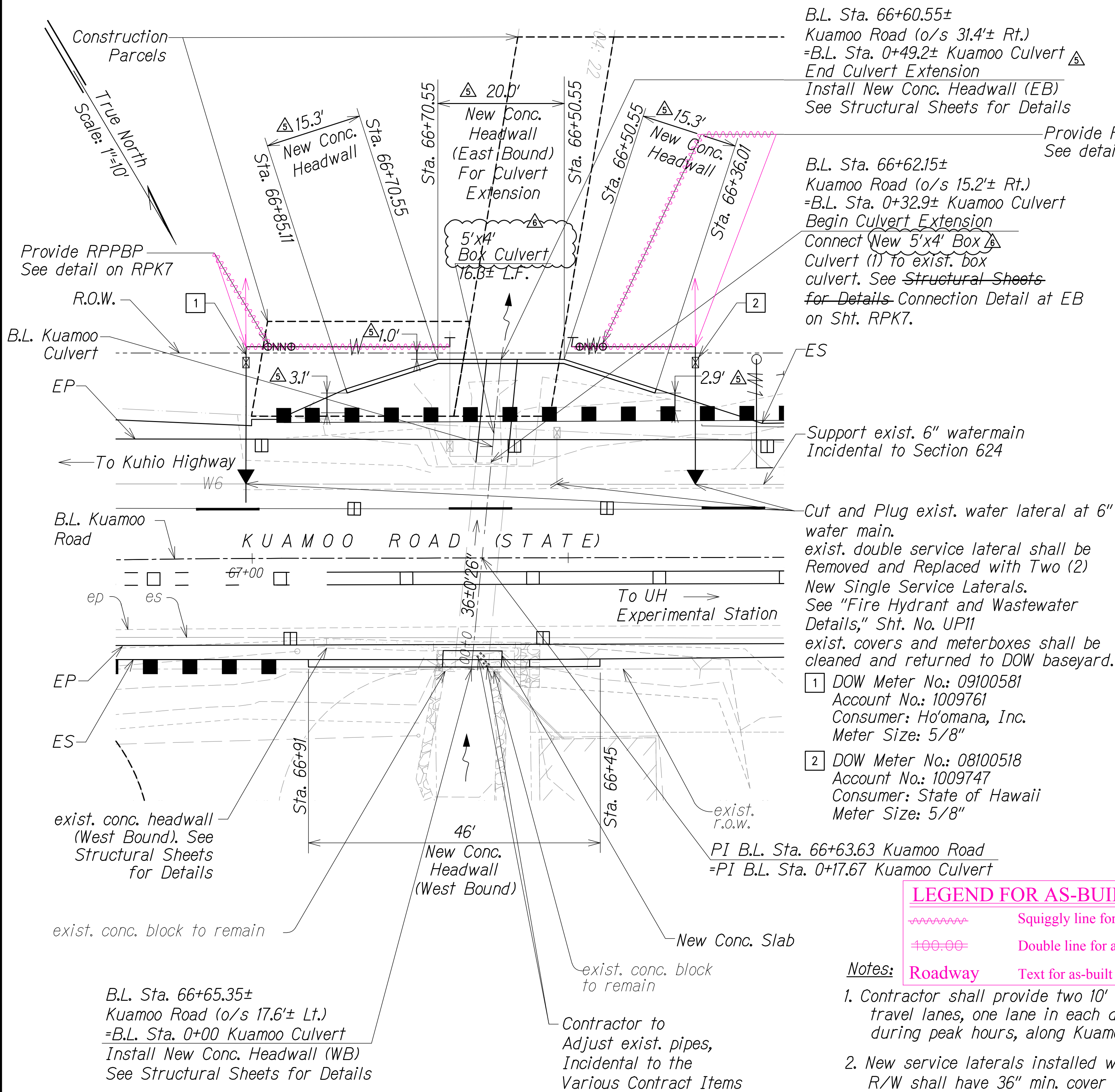

THESE PLANS HAVE BEEN PREPARED UTILIZING INFORMATION PROVIDED BY THE PROJECT CONTRACTOR. THE UPDATED CONSTRUCTION INFORMATION DEPICTED HEREIN HAS NOT BEEN VERIFIED FOR ACCURACY AND COMPLETENESS. NO REPRESENTATION IS BEING MADE TO ITS VALIDITY.

GRADING PLAN
EXTENSION OF EXISTING BOX CULVERT
AT STA. 66+64
Scale: 1" = 10'

DATE	REVISION
7/13/21	Revised grading at culvert headwall and updated culvert dimensions.
6/2/21	Extend shoulder and culvert headwall to 1 foot from R.O.W.
10/22/20	Revised headwall 4 feet to the south and grades accordingly.
11/12/19	Reissuing plan for legibility only. No design changes have been made.
9/20/19	Reissuing plan for legibility only. No design changes have been made.

APPROVED

Manager and Chief Engineer
Department of Water,
County of Kauai

Date



THIS WORK WAS PREPARED BY ME OR UNDER MY SUPERVISION.
WILSON OKAMOTO CORPORATION
APRIL 30, 2020
LIC. EXP. DATE

STATE OF HAWAII
DEPARTMENT OF TRANSPORTATION
HIGHWAYS DIVISION
KUAMOO ROAD
CULVERT EXTENSION
KUHIO HIGHWAY SHORT-TERM
IMPROVEMENTS KUAMOO ROAD
TO TEMPORARY KAPAA BYPASS ROAD
Fed. Aid Proj. No. NH-056-1(50)
Scale: 1" = 10' Date: July 2019
SHEET No. RPK6OF 13 SHEETS

"AS-BUILT"

C.O.ADD.80

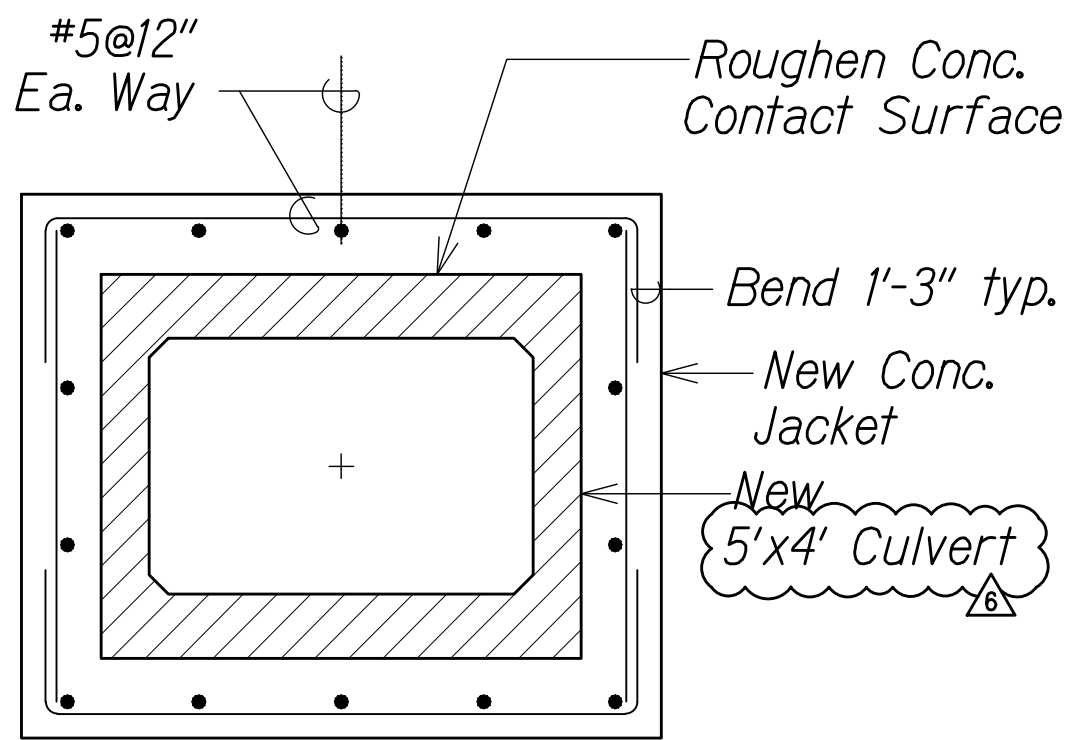
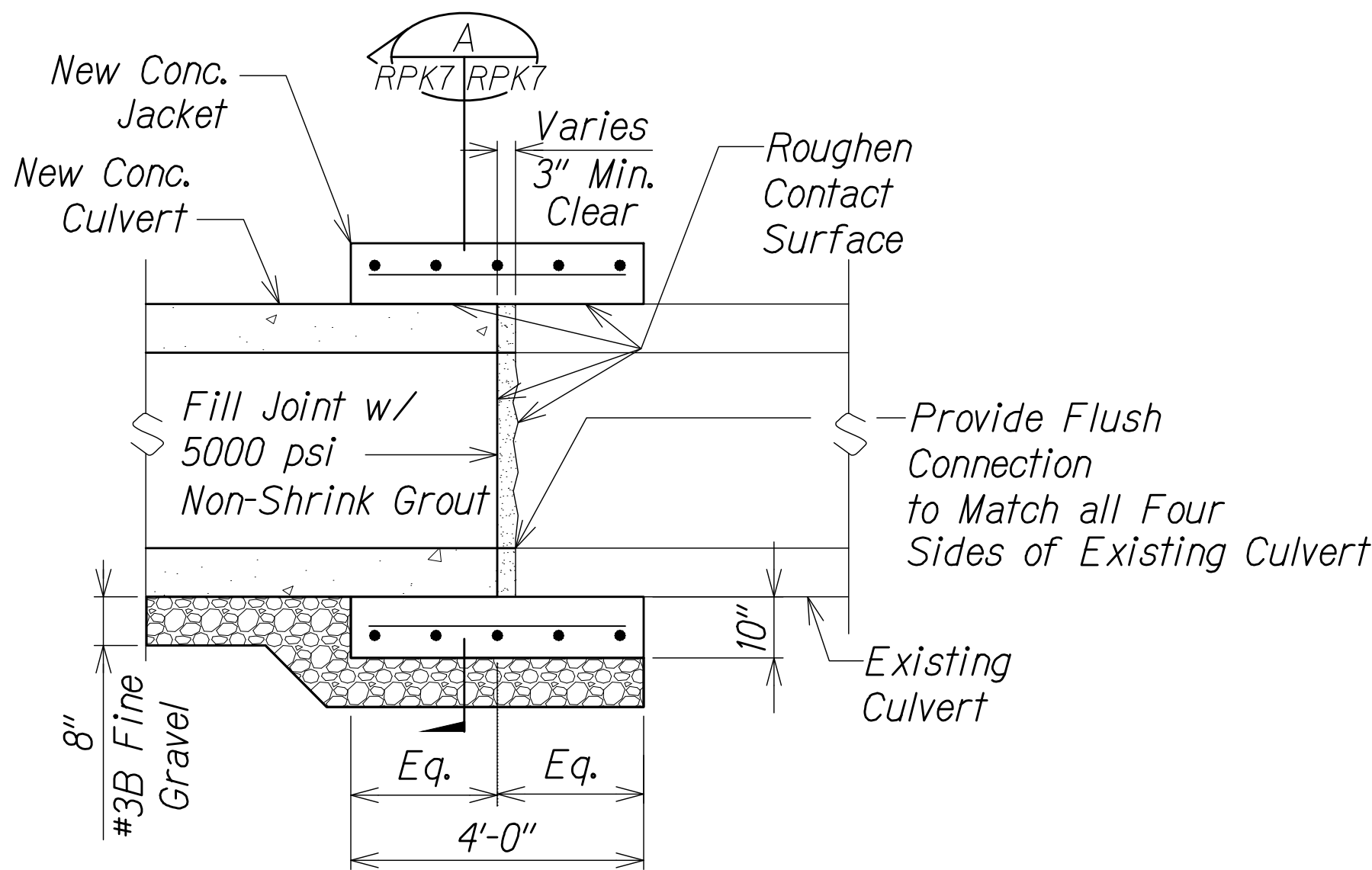

SECTION
Scale: 1/2"=1'-0"

CONNECTION DETAIL AT EB
Scale: 1/2"=1'-0"

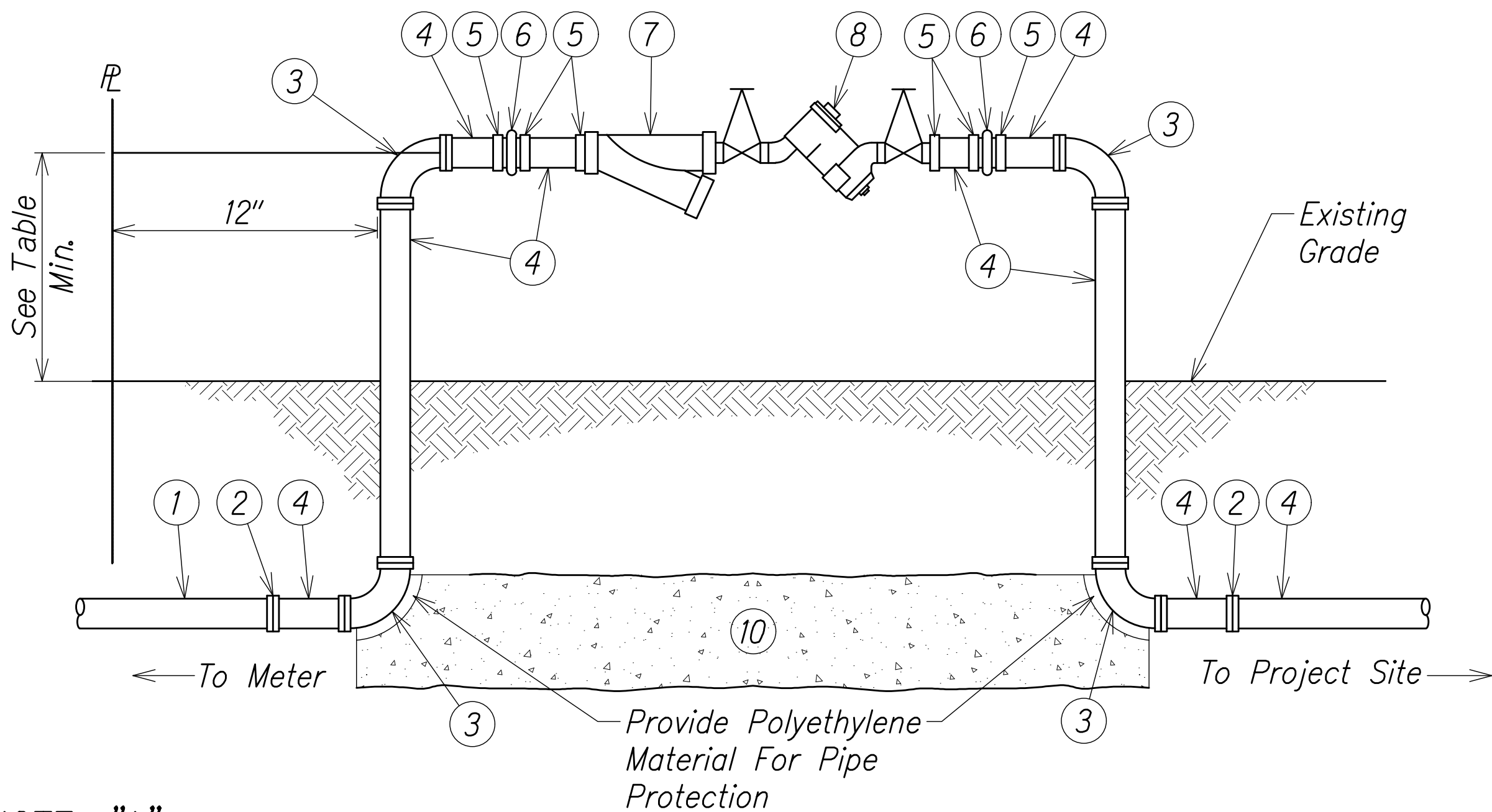

NOTE: "A"

- Contractor shall submit shop drawings to the Department of Water for approval prior to ordering device.
- The backflow device shall be installed on the property and as close to the water meter as physically possible.
- Delete the strainer for seldom-used emergency waterlines if recommended by the manufacturer of the backflow preventer.
- Strainer is required on all backflow preventers on domestic waterline.
- Whenever backflow prevention assembly is located 5' or more from the water meter, install a concrete jacket between water meter and backflow prevention assembly to avoid potential cross connection.
- At no time shall the bottom of the backflow prevention assembly be less than 12" above ground, floor, or flood level nor more than 48" above aforementioned grades.
- The backflow prevention assembly shall be installed after the water meter prior to any tees and branches.
- Refer to Division 100, Section 107.01 for additional requirements and type of backflow prevention needed.

REDUCED PRESSURE PRINCIPLE 1"
BACKFLOW PREVENTION DEVICE

Not to Scale

MATERIALS LIST 1" BFP

- New 1" Waterline
- Adapters and Bushings as necessary
- 1" 90° Copper Elbow
- 1" Copper Nipple, Type K
- 1" Copper Male Adapter
- 1" Bronze Union, F.P.T.
- 1" Bronze Strainer
- 1" Reduce Pressure Principle Backflow Prevention Device (See NOTE: "A")
- New 1" Waterline
- Concrete Reaction Block 1' Thick and 1' Wide

Size (inches)	H (inches)
3/4 to 1-1/2	18
2 to 3	24
4 to 6	30
8 to 10	36

APPROVED

Manager and Chief Engineer
Department of Water,
County of Kauai

Date

7/13/21	Revised culvert dimensions.
11/12/19	Reissuing plan for legibility only. No design changes have been made.
9/20/19	Reissuing plan for legibility only. No design changes have been made.

DATE

REVISION

THESE PLANS HAVE BEEN PREPARED UTILIZING INFORMATION PROVIDED BY THE PROJECT CONTRACTOR. THE UPDATED CONSTRUCTION INFORMATION DEPICTED HEREIN HAS NOT BEEN VERIFIED FOR ACCURACY AND COMPLETENESS. NO REPRESENTATION IS BEING MADE TO ITS VALIDITY.

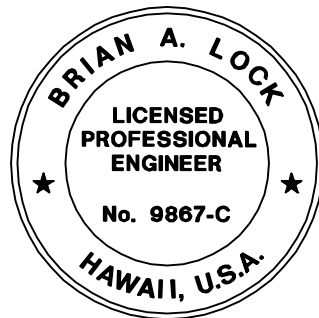

THIS WORK WAS PREPARED BY ME OR UNDER MY SUPERVISION.
WILSON OKAMOTO CORPORATION
APRIL 30, 2020
LIC. EXP. DATE

STATE OF HAWAII
DEPARTMENT OF TRANSPORTATION
HIGHWAYS DIVISION
**KUAMOO ROAD CULVERT
EXTENSION DETAILS**
KUHIU HIGHWAY SHORT-TERM
IMPROVEMENTS KUAMOO ROAD
TO TEMPORARY KAPAA BYPASS ROAD
Fed. Aid Proj. No. NH-056-1(50)
Scale: As Noted Date: July 2019
SHEET No. RPK7 OF 13 SHEETS

"AS-BUILT"

C.O.ADD.81

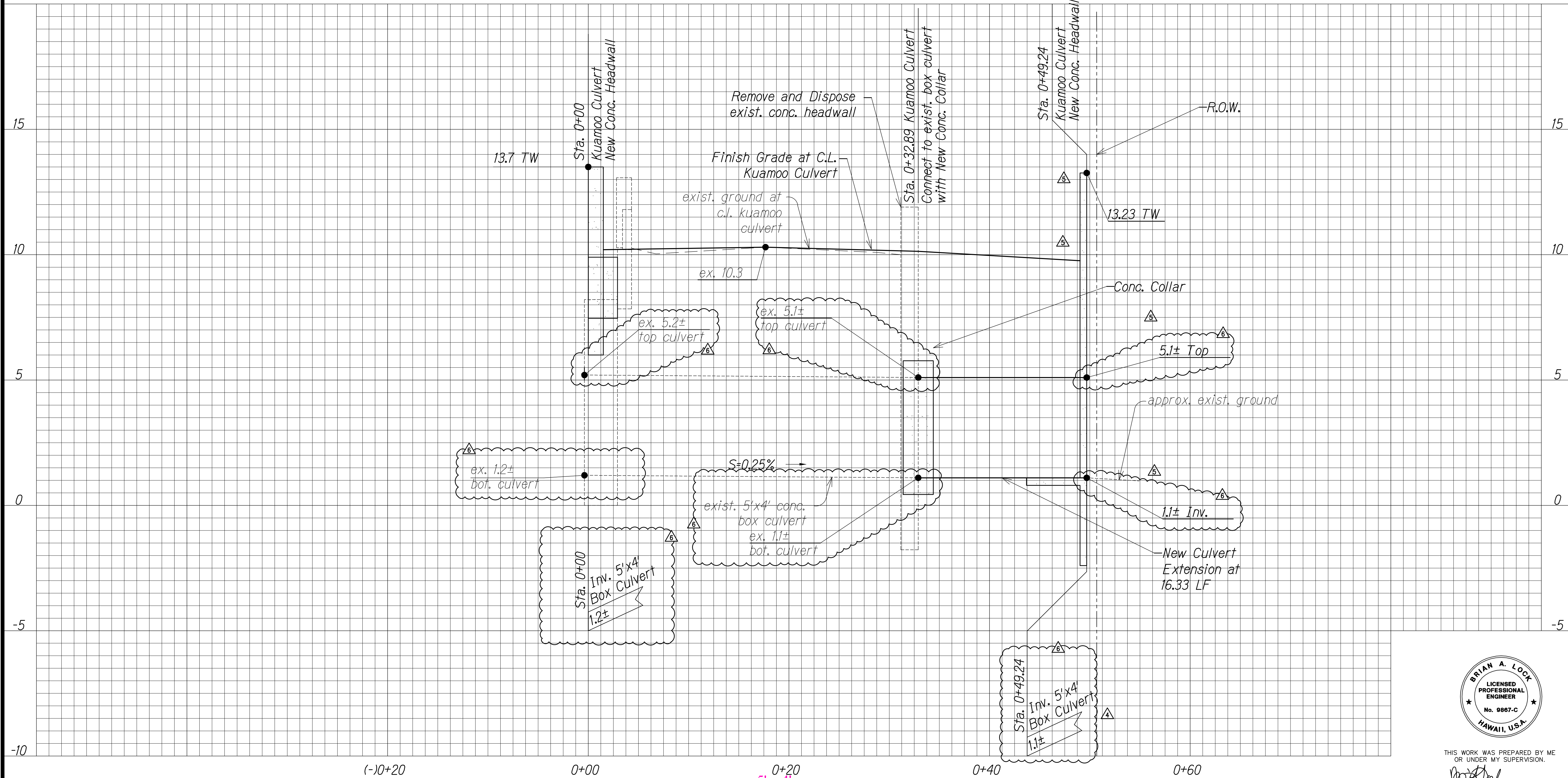

PROFILE - 5'x3' BOX CULVERT

Scale : Horiz. 1" = 5'
Vert. 1" = 2'

THESE PLANS HAVE BEEN PREPARED UTILIZING INFORMATION PROVIDED BY THE PROJECT CONTRACTOR. THE UPDATED CONSTRUCTION INFORMATION DEPICTED HEREIN HAS NOT BEEN VERIFIED FOR ACCURACY AND COMPLETENESS. NO REPRESENTATION IS BEING MADE TO ITS VALIDITY.

LEGEND FOR AS-BUILT POSTINGS

- Squiggly line for as-built deletion
- Double line for as-built deletion
- Roadway Text for as-built posting

- 7/13/21 Revised culvert dimensions and invert elevations.
- 6/2/21 Revised culvert headwall to 1 foot from R.O.W.
- 10/22/20 Revised profile headwall location 4 feet to the right and grade accordingly.
- 11/12/19 Reissuing plan for legibility only. No design changes have been made.
- 9/20/19 Reissuing plan for legibility only. No design changes have been made.

DATE REVISION

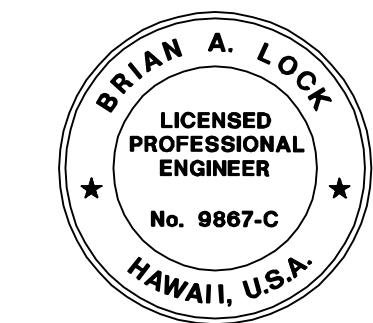

THIS WORK WAS PREPARED BY ME OR UNDER MY SUPERVISION.
WILSON OKAMOTO CORPORATION APRIL 30, 2020 LIC. EXP. DATE

STATE OF HAWAII
DEPARTMENT OF TRANSPORTATION
HIGHWAYS DIVISION
PROFILE - KUAMOO ROAD
CULVERT EXTENSION
KUHIO HIGHWAY SHORT-TERM
IMPROVEMENTS KUAMOO ROAD
TO TEMPORARY KAPAA BYPASS ROAD
Fed. Aid Proj. No. NH-056-1(50)
Scale: As Noted Date: July 2019

SHEET No. RPK8 OF 13 SHEETS

C.O.ADD.82

"AS-BUILT"

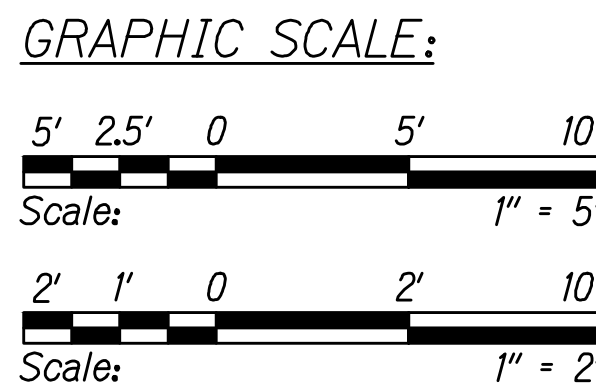

SURVEY PLOTTED BY	DATE
DRAWN BY	
TRACED BY	
CHECKED BY	
ORIGINAL PLAN	
NOTE BOOK	
No.	

FED. ROAD DIST. NO.	STATE	FED. AID PROJ. NO.	FISCAL YEAR	SHEET NO.	TOTAL SHEETS
KAUAI	HAW.	NH-056-1(50)	2019	C.O.ADD.83	244

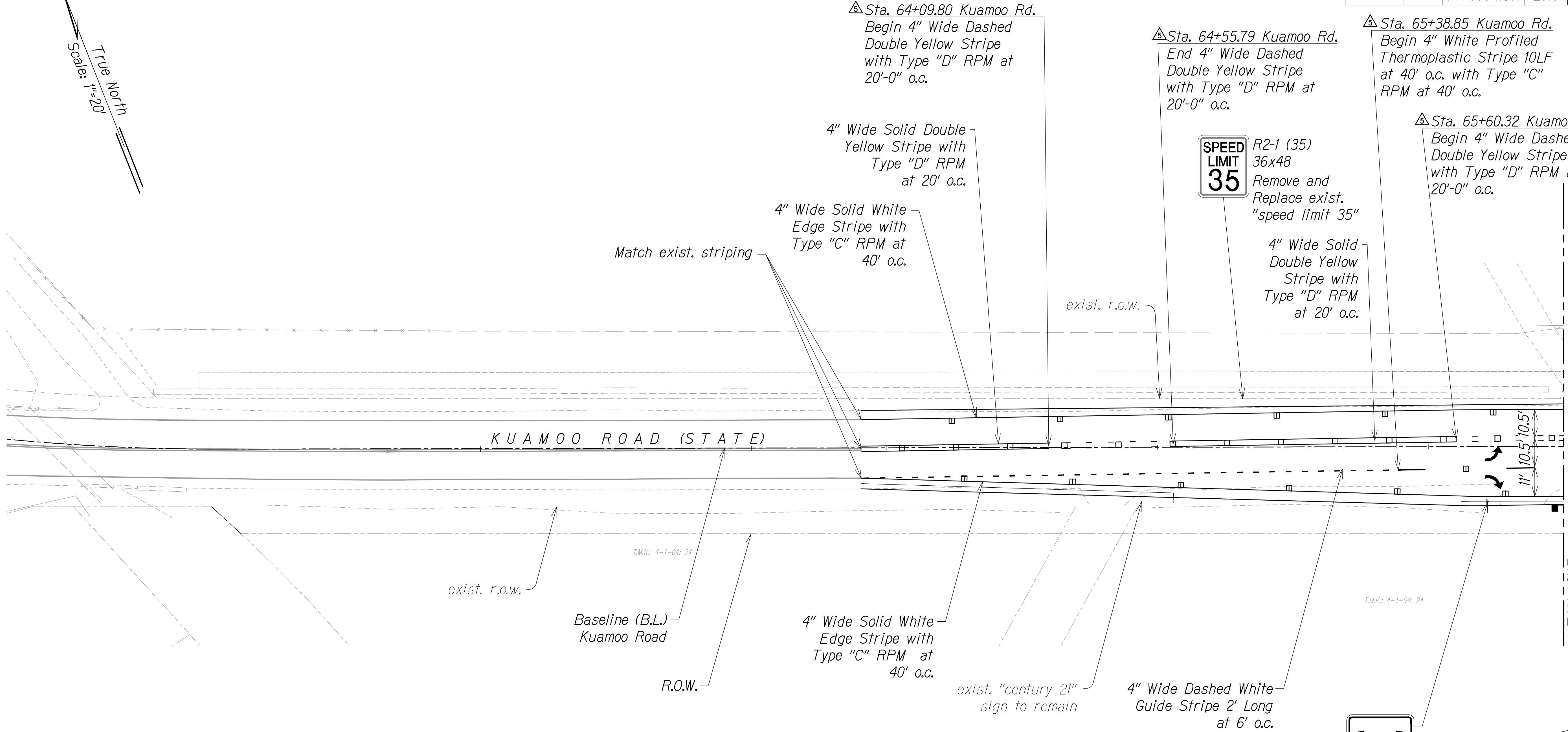
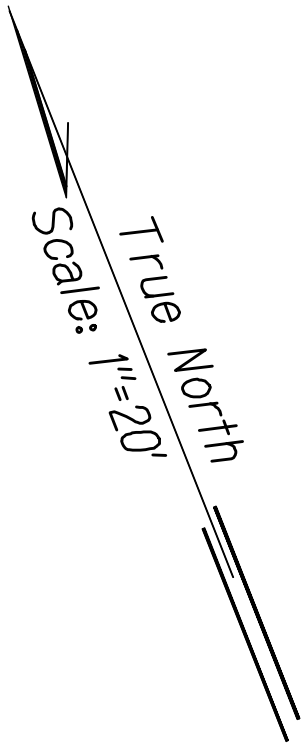

R2-1 (35)
36x48
Remove and
Replace exist.
"speed limit 35"

4" Wide Solid
Double Yellow
Stripe with
Type "D" RPM
at 20' o.c.



R3-8
30x30

Install New Directional
Sign and Post

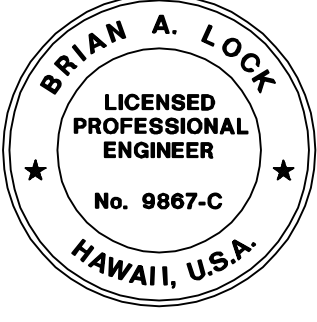

THIS WORK WAS PREPARED BY ME
OR UNDER MY SUPERVISION.
[Signature]
WILSON OKAMOTO CORPORATION LIC. EXP. DATE

Note:
All pavement markings shall be
thermoplastic extrusion/markings
or pavement marking tape.
Painting is not acceptable.

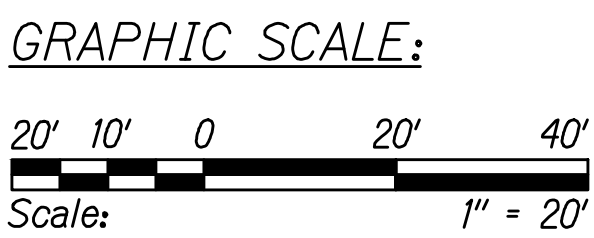

THESE PLANS HAVE BEEN PREPARED
UTILIZING INFORMATION PROVIDED
BY THE PROJECT CONTRACTOR. THE
UPDATED CONSTRUCTION
INFORMATION DEPICTED HEREIN
HAS NOT BEEN VERIFIED FOR
ACCURACY AND COMPLETENESS.
NO REPRESENTATION IS BEING
MADE TO ITS VALIDITY.

6/2/21	△ Revised lane striping.
11/12/19	△ Reissuing plan for legibility only. No design changes have been made.
9/20/19	△ Reissuing plan for legibility only. No design changes have been made.

DATE	REVISION
------	----------

STATE OF HAWAII
DEPARTMENT OF TRANSPORTATION
HIGHWAYS DIVISION
**PAVEMENT MARKING
AND SIGNING PLAN**
KUHIU HIGHWAY SHORT-TERM
IMPROVEMENTS KUAMOO ROAD
TO TEMPORARY KAPAA BYPASS ROAD
Fed. Aid Proj. No. NH-056-1(50)
Scale: 1" = 20' Date: July 2019

SHEET No. RPK9 OF 13 SHEETS

"AS-BUILT"

C.O.ADD.83

SURVEY PLOTTED BY	DATE
DRAWN BY	
TRACED BY	
CHECKED BY	
ORIGINAL PLAN	
NOTE BOOK	
No.	

FED. ROAD DIST. NO.	STATE	FED. AID PROJ. NO.	FISCAL YEAR	SHEET NO.	TOTAL SHEETS
KAUAI	HAW.	NH-056-1(50)	2019	C.O.ADD.84	244

Scale: 1"=20'
True North

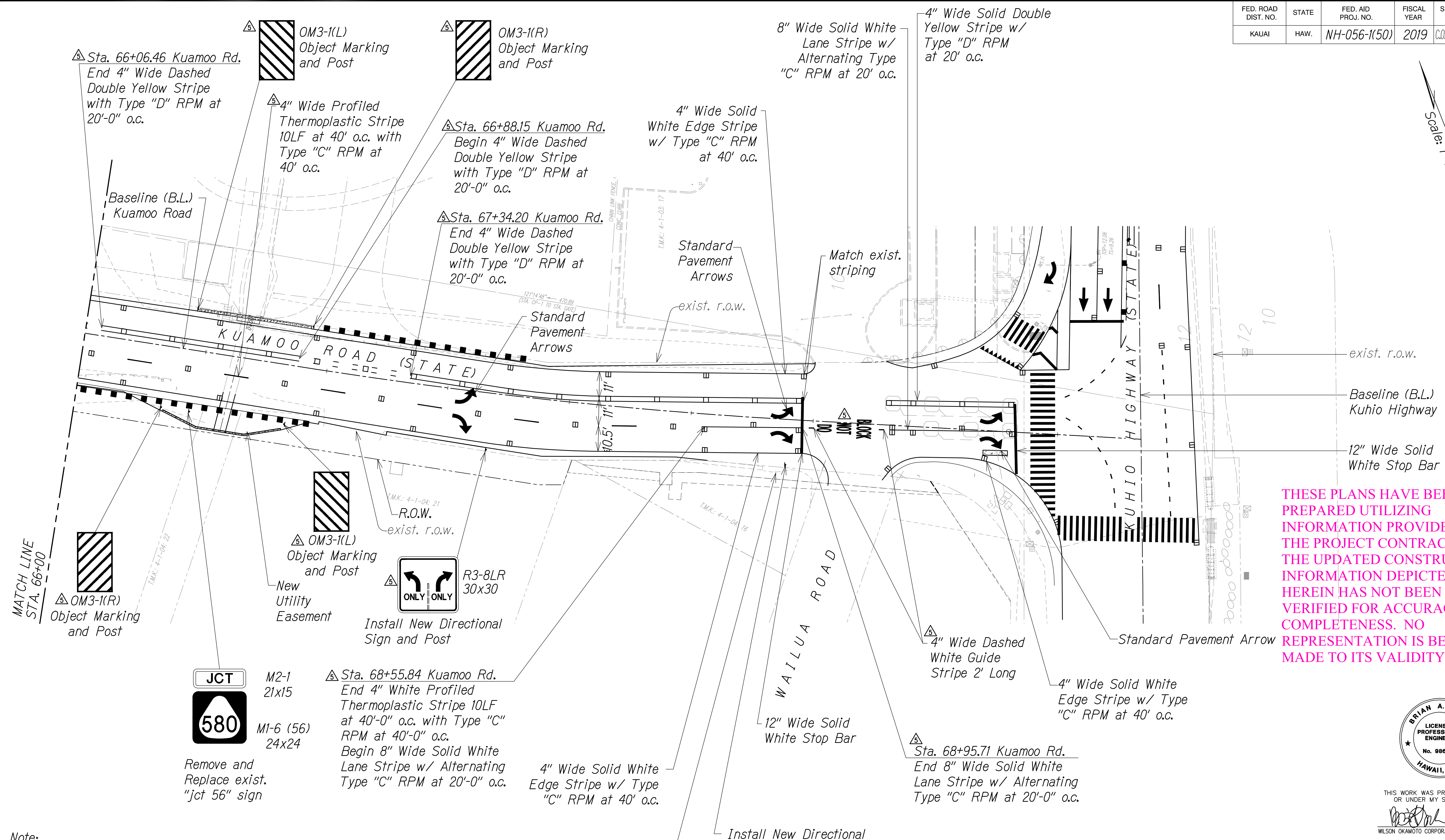

THESE PLANS HAVE BEEN PREPARED UTILIZING INFORMATION PROVIDED BY THE PROJECT CONTRACTOR. THE UPDATED CONSTRUCTION INFORMATION DEPICTED HEREIN HAS NOT BEEN VERIFIED FOR ACCURACY AND COMPLETENESS. NO REPRESENTATION IS BEING MADE TO ITS VALIDITY.



THIS WORK WAS PREPARED BY ME OR UNDER MY SUPERVISION.
WILSON OKAMOTO CORPORATION
APRIL 30, 2020
LIC. EXP. DATE

Note:
All pavement markings shall be thermoplastic extrusion/markings or pavement marking tape. Painting is not acceptable.

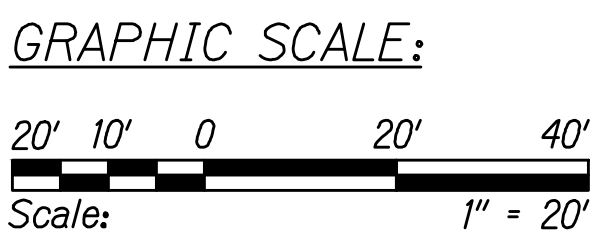

DATE	REVISION
6/2/21	Revised sign callouts, relocated OM3-1 signs closer to new culvert wall, and updated the lane striping.
10/22/20	Relocated the OM3-1 signs 4 ft to the south
11/12/19	Reissuing plan for legibility only. No design changes have been made.
9/20/19	Reissuing plan for legibility only. No design changes have been made.

STATE OF HAWAII
DEPARTMENT OF TRANSPORTATION
HIGHWAYS DIVISION
PAVEMENT MARKING AND SIGNING PLAN
KUHIO HIGHWAY SHORT-TERM IMPROVEMENTS KUAMOO ROAD TO TEMPORARY KAPAA BYPASS ROAD
Fed. Aid Proj. No. NH-056-1(50)
Scale: 1" = 20' Date: July 2019
SHEET No. RPK10 of 13 SHEETS

"AS-BUILT"

C.O.ADD.84

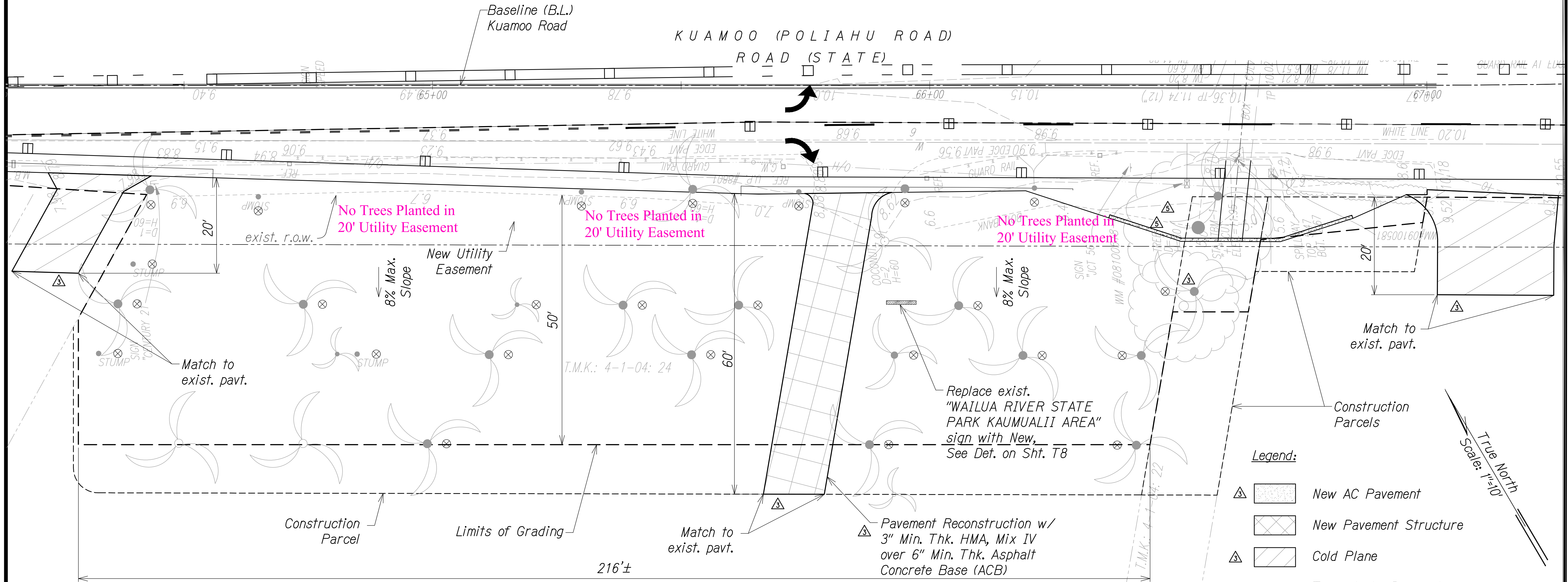

- Legend:
- New AC Pavement
 - New Pavement Structure
 - Cold Plane
 - Trees to be Removed
 - Trees to Remain
 - New Tree Location

Notes:

- Trees to be removed within Wailua River State Park or along Kumao Road right-of-way shall be cut at the base and ground down flush to surface level to minimize soil disturbance. Removed trees shall be replaced near the same location.
- Use of the Wailua River State Park cannot exceed 180 days. The Contractor shall notify State Parks at (808) 587-0287, at least seven day prior to start of work in the State Park. The Contractor shall provide the start and end dates of the 180 day period prior to start of work in the State Park. Any use of the park property for construction beyond 180 days will be considered a conversion of that property and will be subject to appropriate actions by the state.

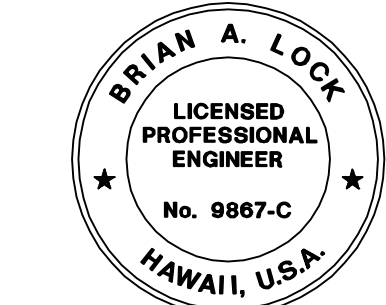

THIS WORK WAS PREPARED BY ME OR UNDER MY SUPERVISION.
WILSON OKAMOTO CORPORATION
APRIL 30, 2020
LIC. EXP. DATE

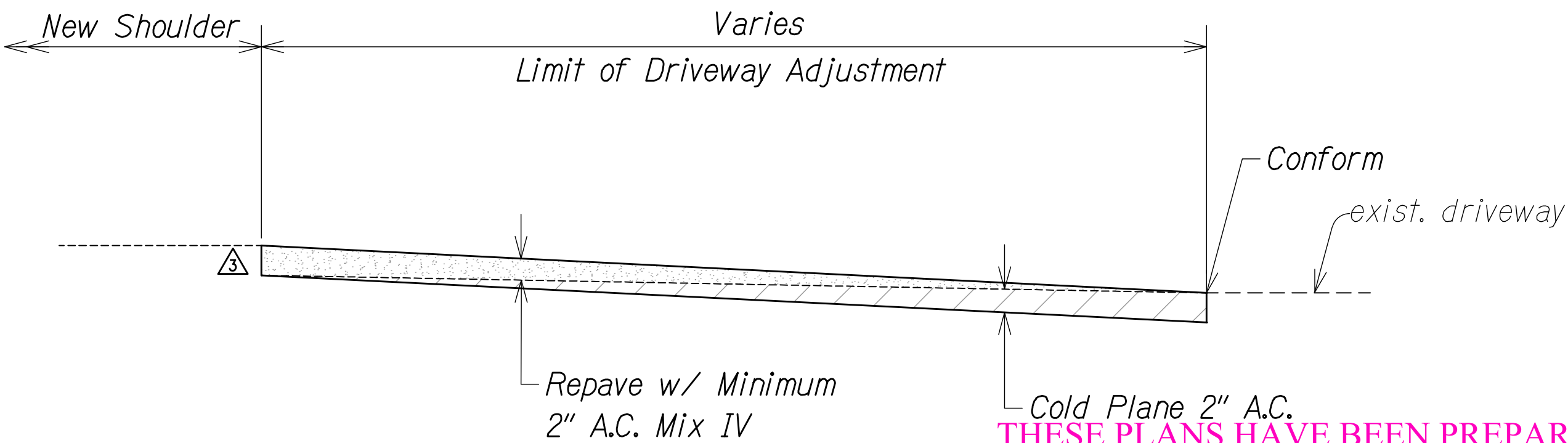

LONGITUDINAL CONFORM TAPER
Not to Scale

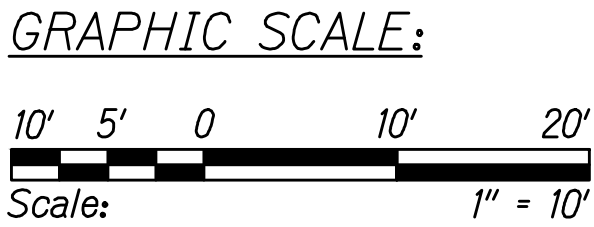

THESE PLANS HAVE BEEN PREPARED UTILIZING INFORMATION PROVIDED BY THE PROJECT CONTRACTOR. THE UPDATED CONSTRUCTION INFORMATION DEPICTED HEREIN HAS NOT BEEN VERIFIED FOR ACCURACY AND COMPLETENESS. NO REPRESENTATION IS BEING MADE TO ITS VALIDITY.

LEGEND FOR AS-BUILT POSTINGS	
	Squiggly line for as-built deletion
	Double line for as-built deletion
Roadway	Text for as-built posting

6/2/21	Removed new trees.
10/22/20	Revised dimension callout from headwall to bottom of driveway
11/12/19	Reissuing plan for legibility; revised hatches, detail and tree markings
9/20/19	Reissuing plan for legibility only. No design changes have been made.

DATE REVISION

STATE OF HAWAII
DEPARTMENT OF TRANSPORTATION
HIGHWAYS DIVISION
KAUMUALII - WAILUA RIVER STATE PARK
KUHO HIGHWAY SHORT-TERM IMPROVEMENTS KUAMOO ROAD
TO TEMPORARY KAPAA BYPASS ROAD
Fed. Aid Proj. No. NH-056-1(50)
Scale: As Noted Date: July 2019
SHEET No. RPK11 OF 13 SHEETS

SURVEY PLOTTED BY	DATE
DRAWN BY	
TRACED BY	
CHECKED BY	
ORIGINAL PLAN	
NOTE BOOK	
No.	

"AS-BUILT"

ADD.85

FED. ROAD DIST. NO.	STATE	FED. AID PROJ. NO.	FISCAL YEAR	SHEET NO.	TOTAL SHEETS
KAUAI	HAW.	NH-056-1(50)	2019	C.O.ADD.86	244

Sheet Total
Exc. = 157.22 C.Y.
Emb. = 412.18 C.Y.

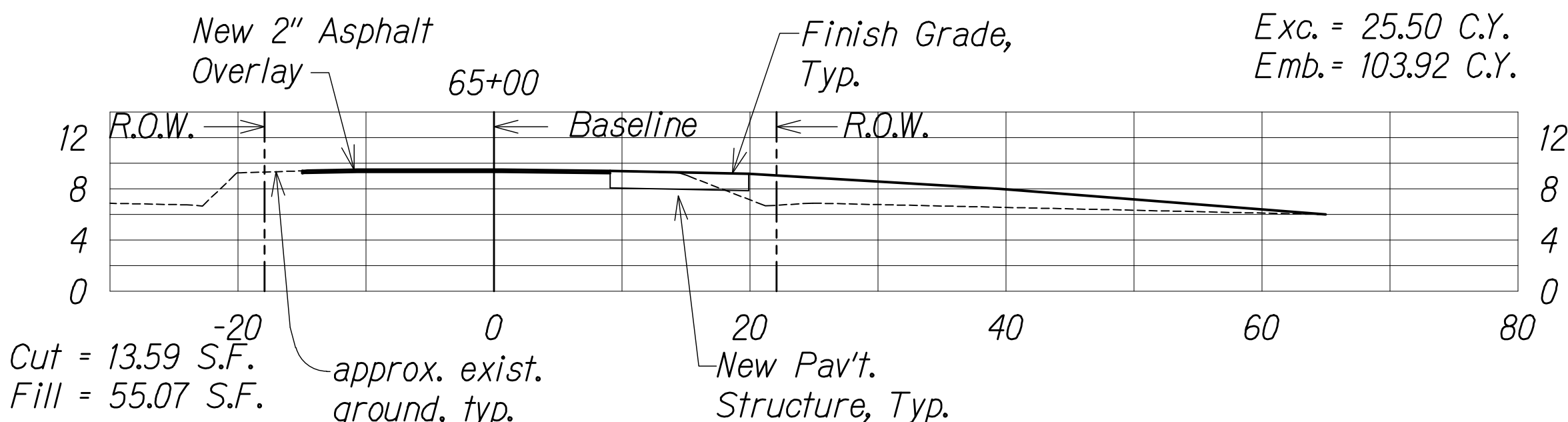
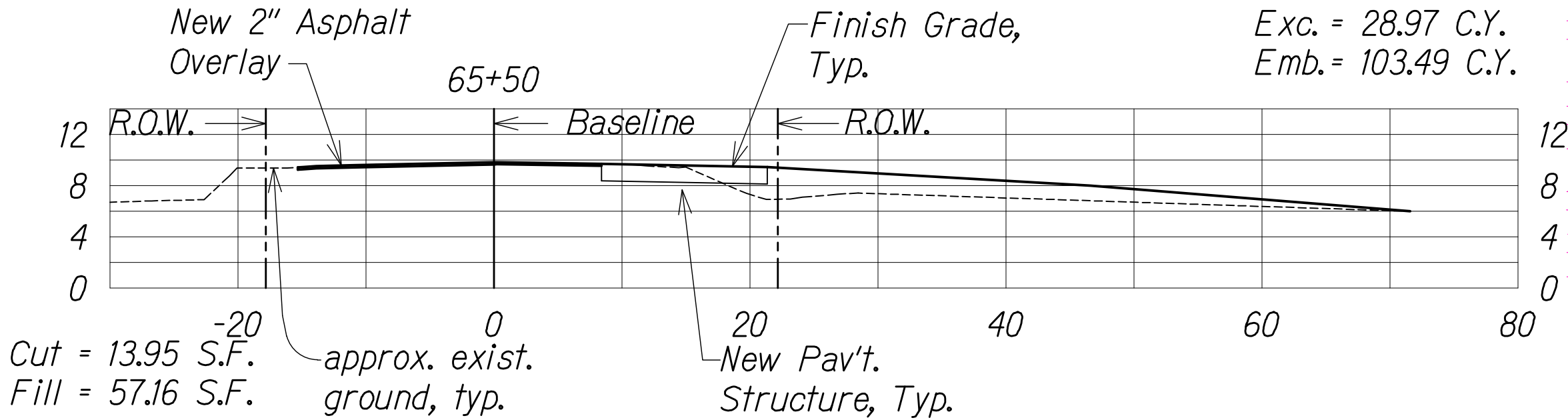
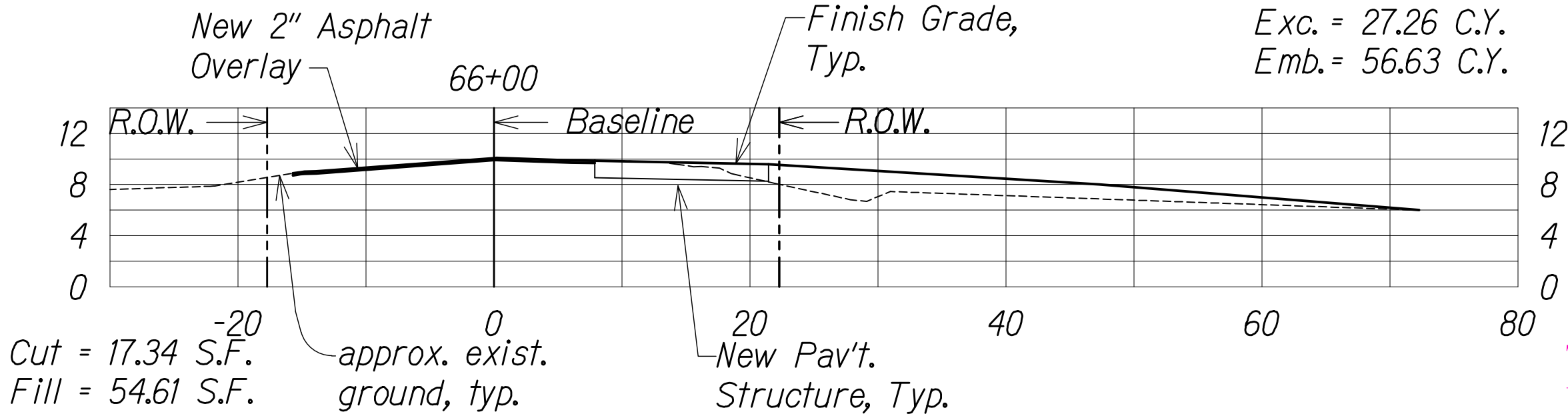
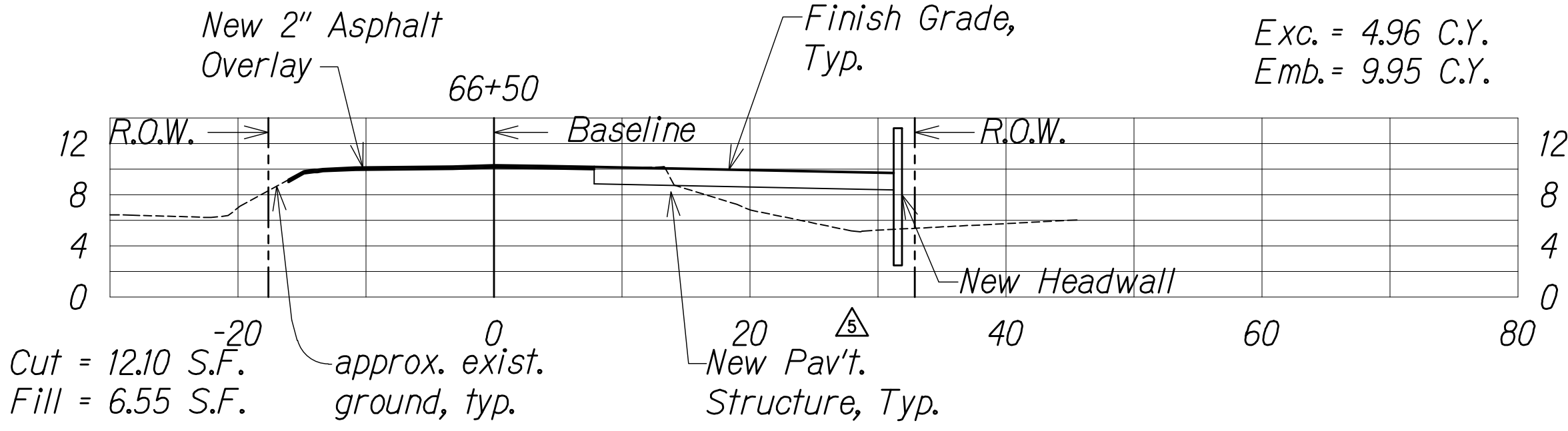
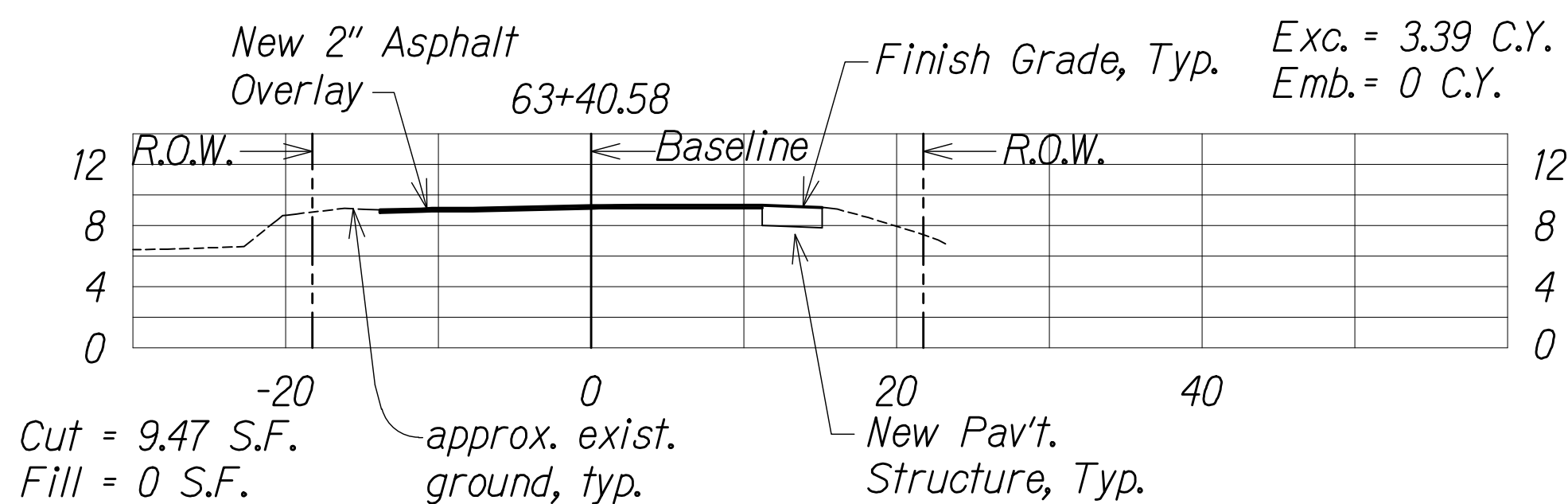
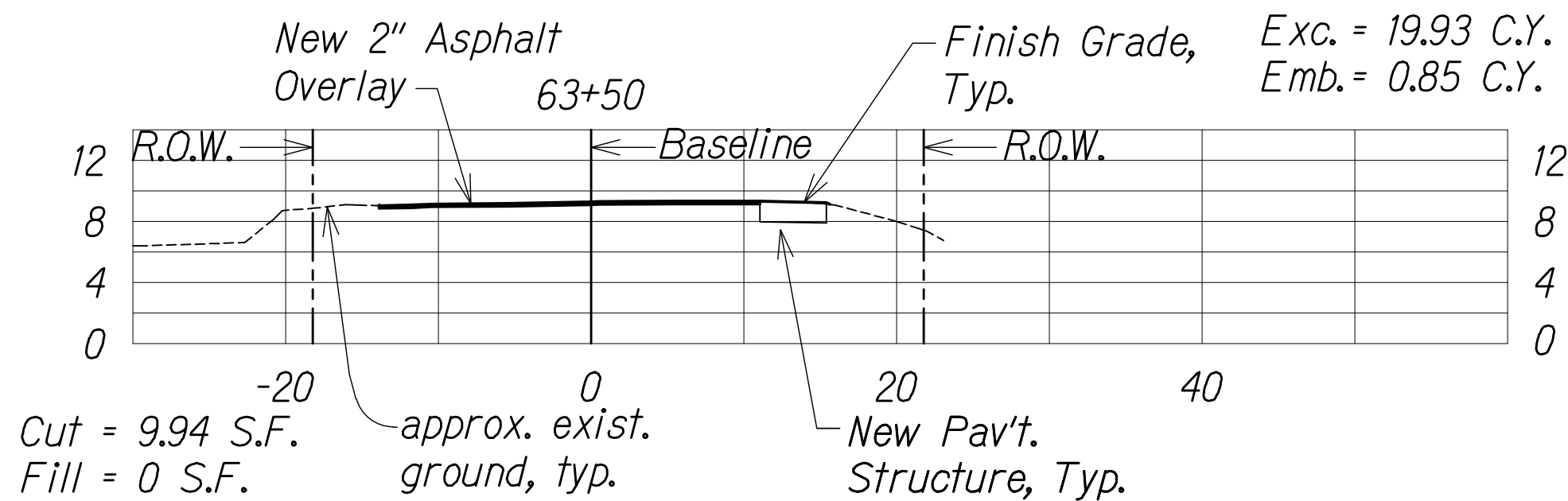
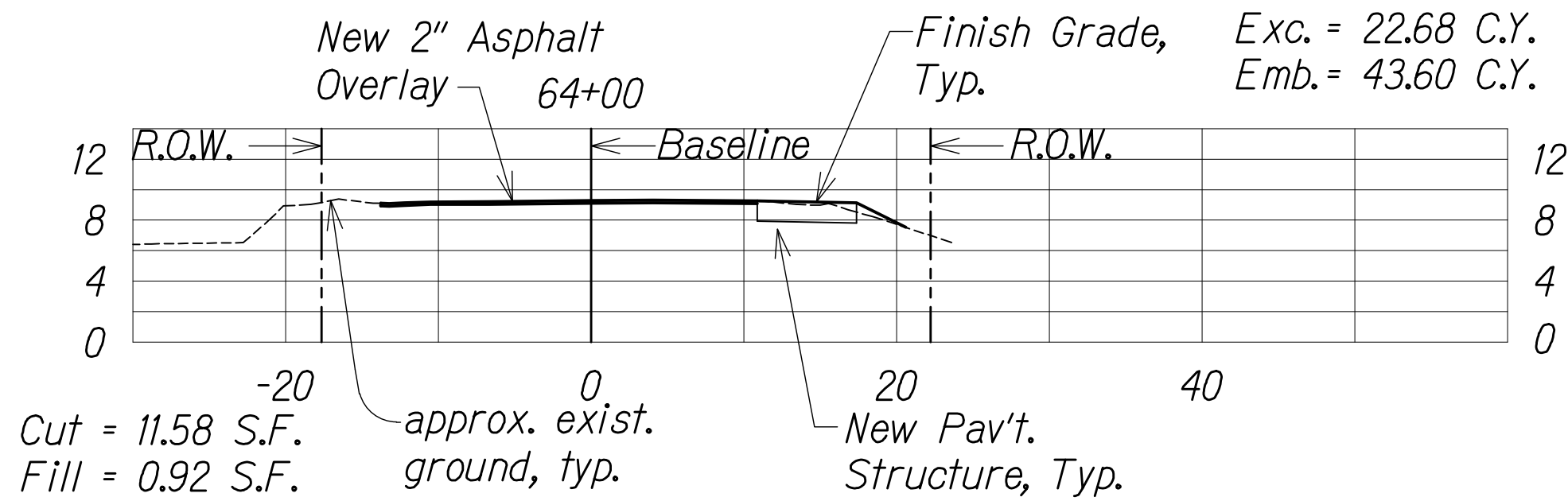
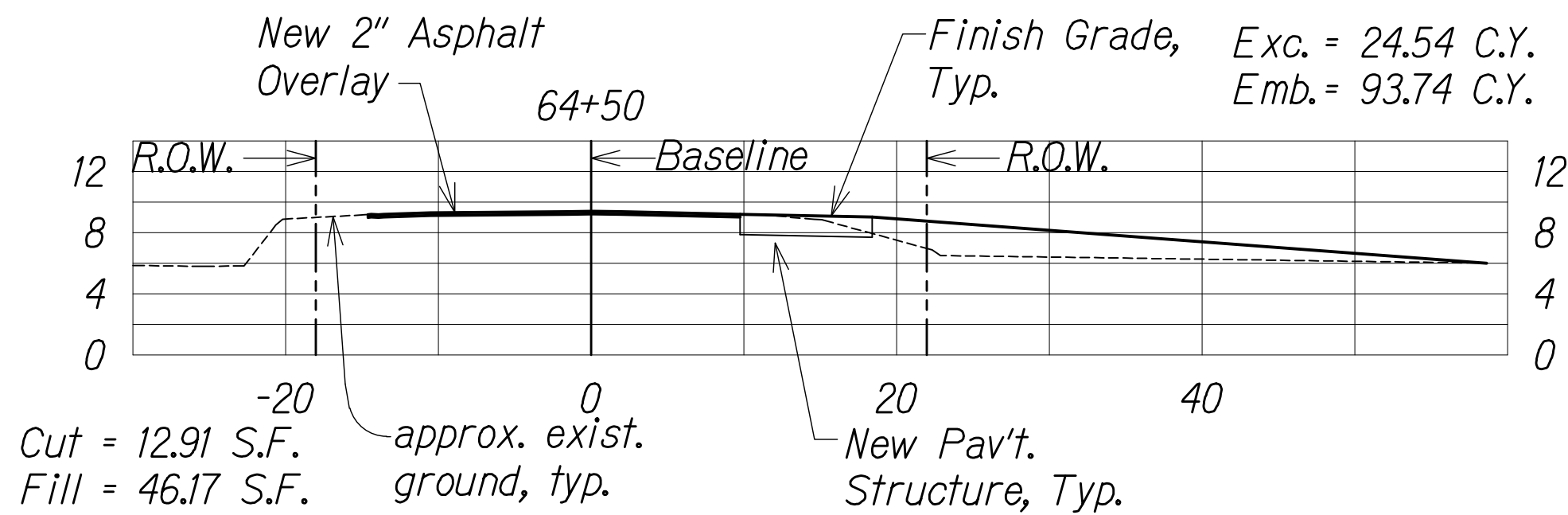

THESE PLANS HAVE BEEN PREPARED UTILIZING INFORMATION PROVIDED BY THE PROJECT CONTRACTOR. THE UPDATED CONSTRUCTION INFORMATION DEPICTED HEREIN HAS NOT BEEN VERIFIED FOR ACCURACY AND COMPLETENESS. NO REPRESENTATION IS BEING MADE TO ITS VALIDITY.

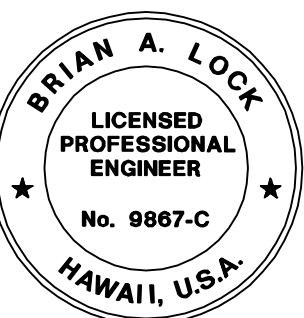
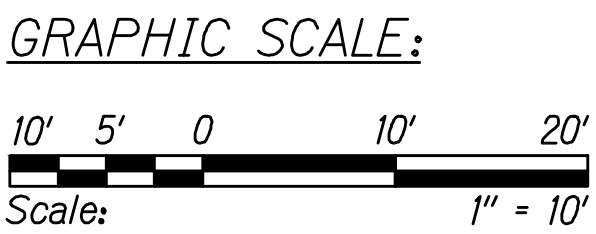

THIS WORK WAS PREPARED BY ME OR UNDER MY SUPERVISION.
WILSON OKAMOTO CORPORATION
APRIL 30, 2020
LIC. EXP. DATE

6/2/21	△ Revised section 66+50 headwall to 1 foot from R.O.W.
10/22/20	△ Revised section 66+50 headwall location 4 feet to the right.
11/12/19	△ Reissuing plan for legibility only. No design changes have been made.
9/20/19	△ Reissuing plan for legibility only. No design changes have been made.

DATE	REVISION
------	----------

STATE OF HAWAII
DEPARTMENT OF TRANSPORTATION
HIGHWAYS DIVISION

ROADWAY CROSS SECTIONS

KUHIO HIGHWAY SHORT-TERM
IMPROVEMENTS KUAMOO ROAD
TO TEMPORARY KAPAA BYPASS ROAD
Fed. Aid Proj. No. NH-056-1(50)
Scale: 1" = 10' Date: July 2019

SHEET No. RPK120F 13 SHEETS

Kuamoo Road Improvements
ROADWAY CROSS SECTIONS
Scale: 1" = 10'

FED. ROAD DIST. NO.	STATE	FED. AID PROJ. NO.	FISCAL YEAR	SHEET NO.	TOTAL SHEETS
KAUAI	HAW.	NH-056-1(50)	2019	ADD.87	244

Sheet Total Δ
Exc. = 183.93 C.Y.
Emb. = 28.32 C.Y.

Roadway Total Δ
Total Exc. = 341.14 C.Y.
Total Emb. = 440.51 C.Y.

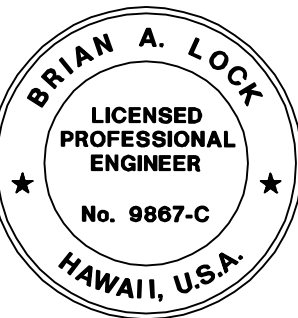
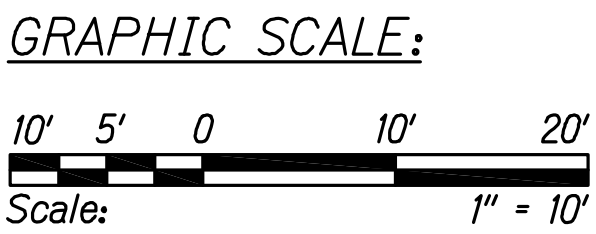
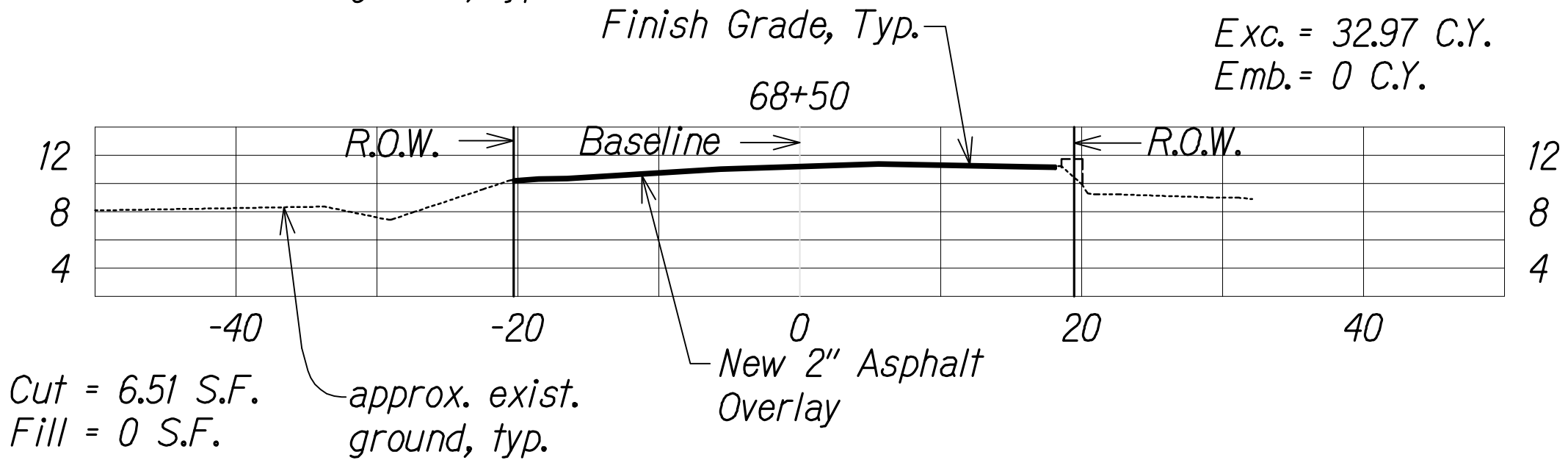
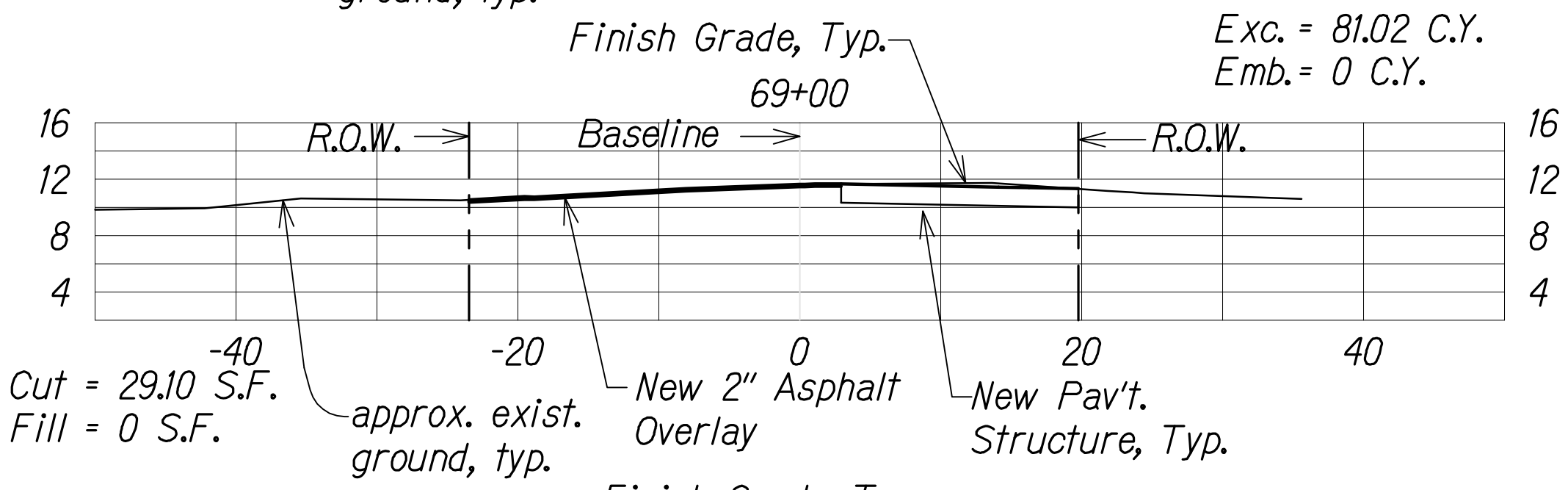
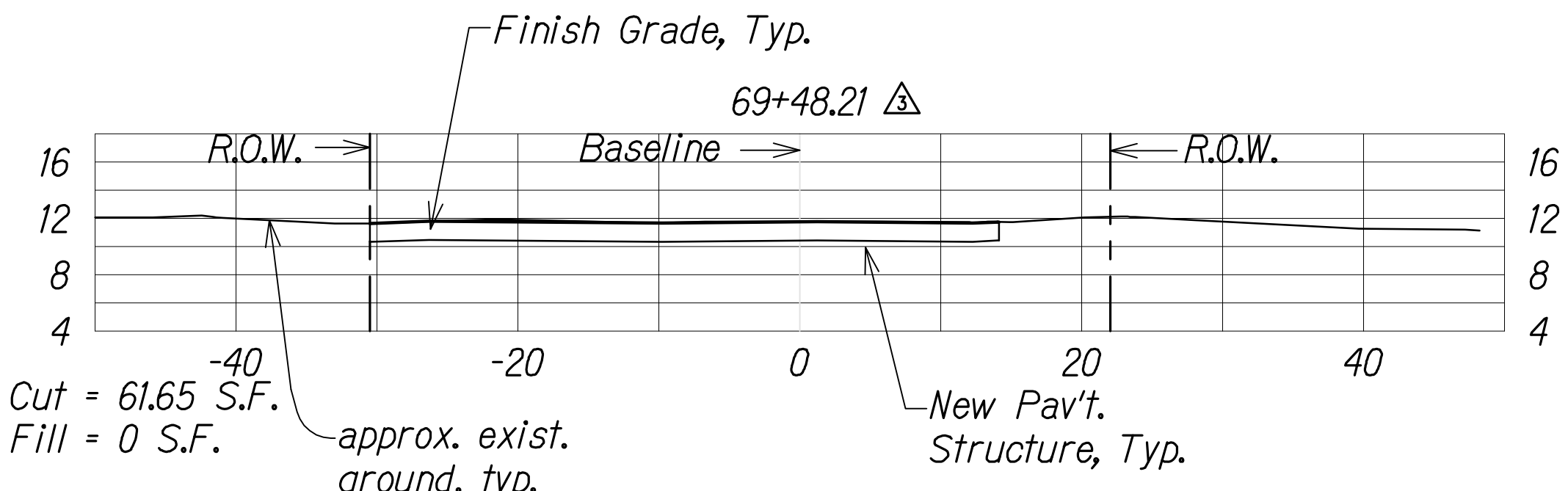
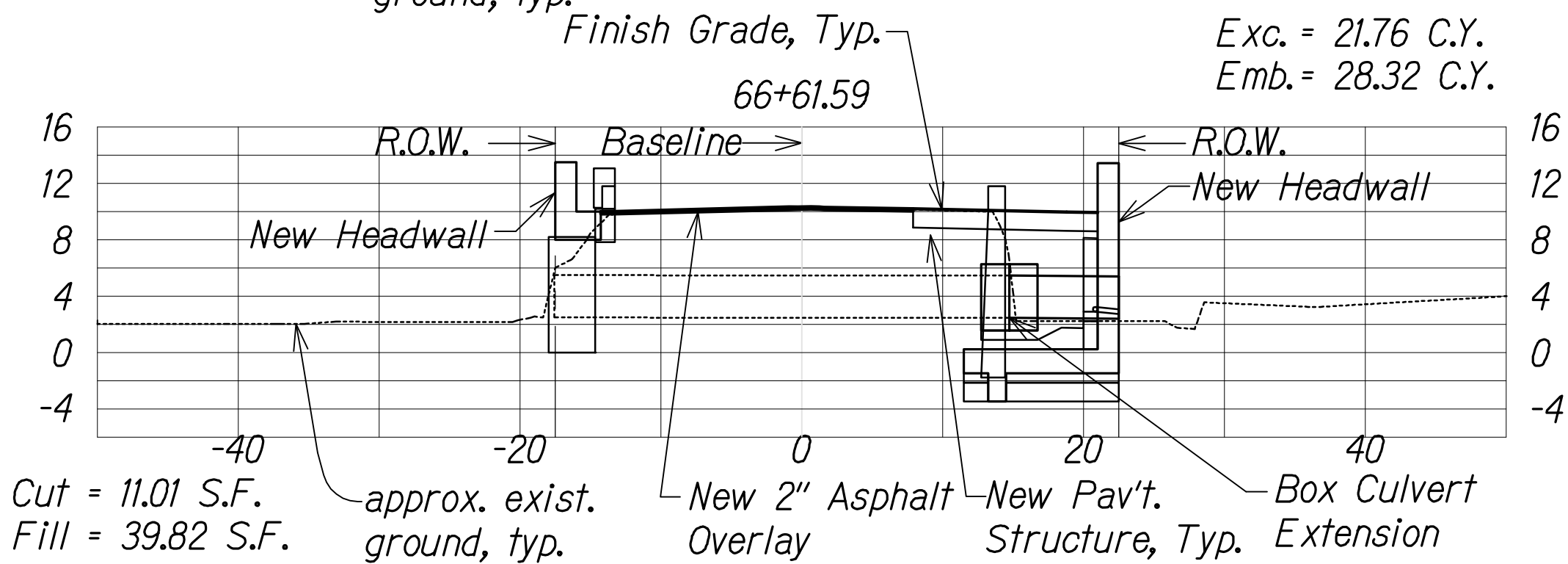
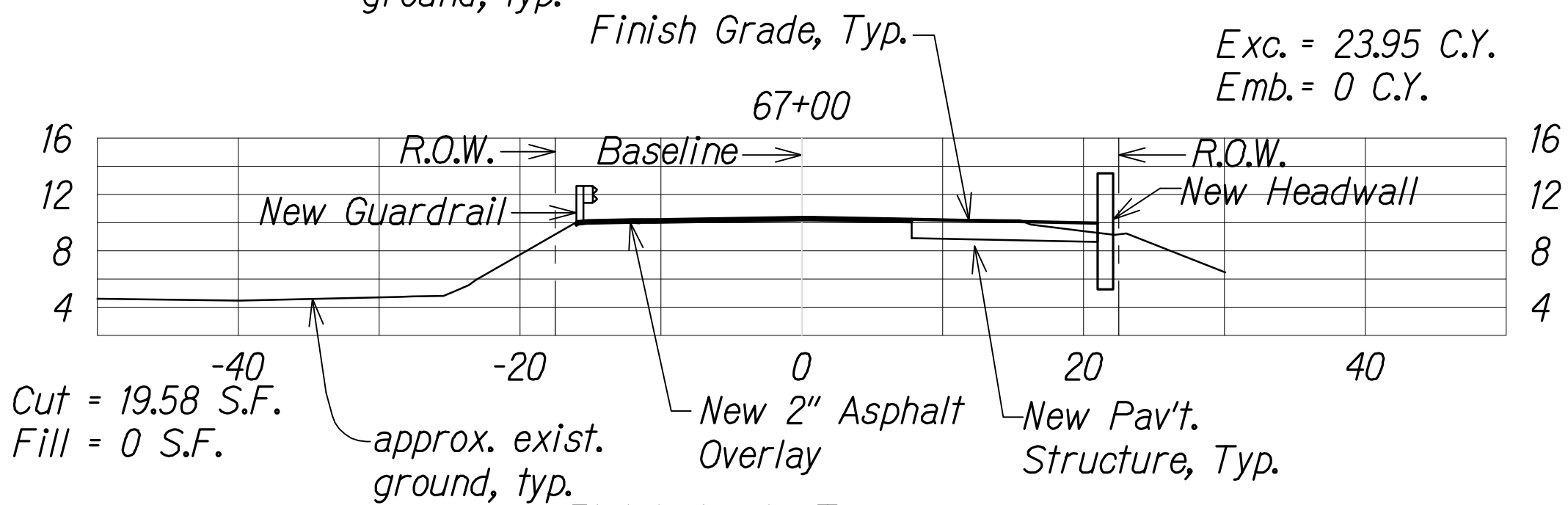
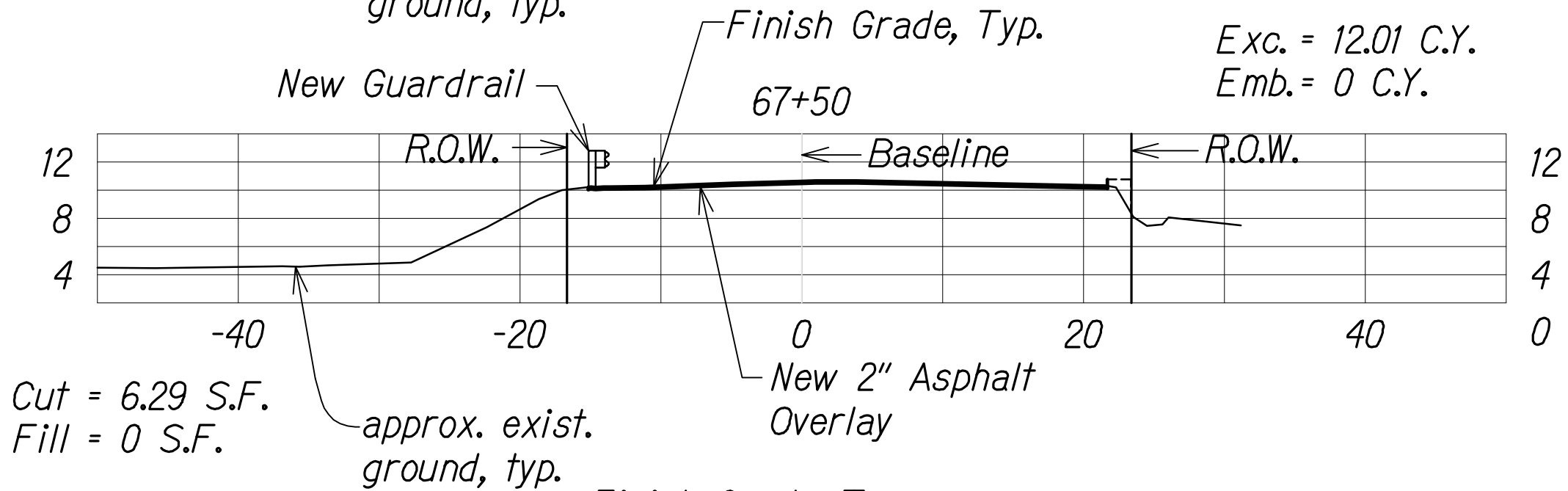
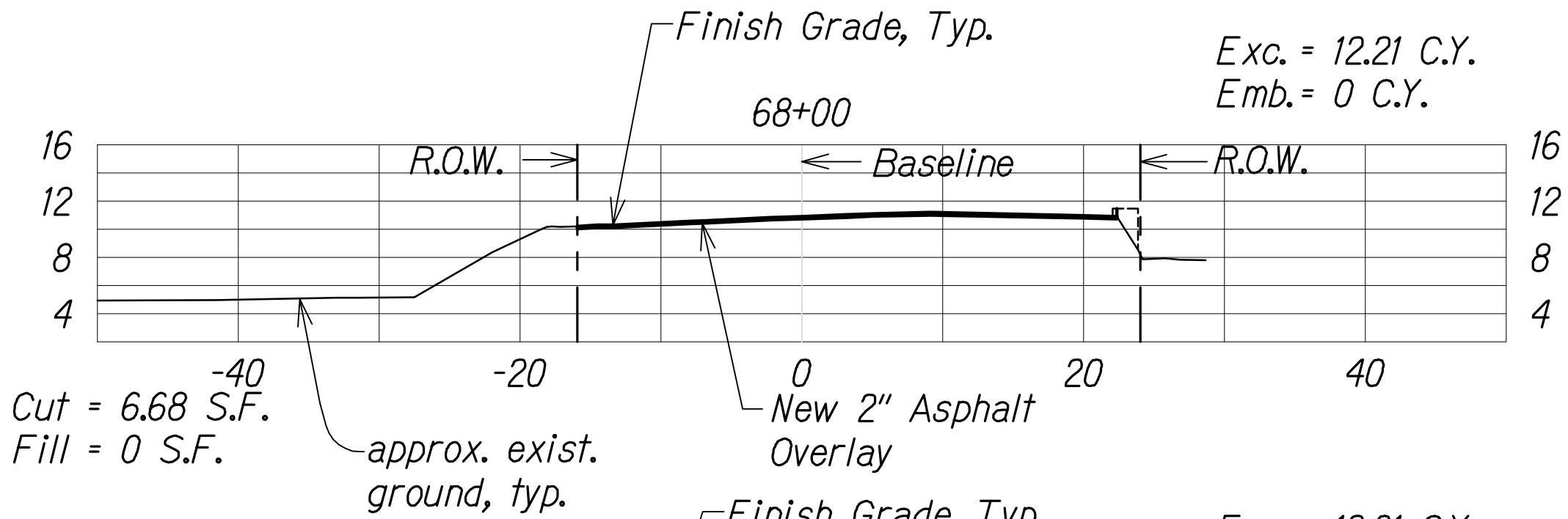

THIS WORK WAS PREPARED BY ME
OR UNDER MY SUPERVISION.
WILSON OKAMOTO CORPORATION LIC. EXP. DATE

STATE OF HAWAII
DEPARTMENT OF TRANSPORTATION
HIGHWAYS DIVISION

ROADWAY CROSS SECTIONS

KUHIO HIGHWAY SHORT-TERM
IMPROVEMENTS KUAMOO ROAD
TO TEMPORARY KAPAA BYPASS ROAD
Fed. Aid Proj. No. NH-056-1(50)
Scale: 1" = 10' Date: July 2019

SHEET No. RPK13 OF 13 SHEETS

Kuamoo Road Improvements
ROADWAY CROSS SECTIONS
Scale: 1" = 10'

11/12/19	Δ Reissuing plan for legibility; revised cross section and sheet totals
9/20/19	Δ Reissuing plan for legibility only. No design changes have been made.
DATE	REVISION