

1. *The Permittee Shall Make Minor Adjustments At Intersections, Driveways Bridges, Structures, Etc. To Fit Field Conditions.*
2. *Cones Or Delineators Shall Be Extended To A Point Where They Are Visible To Approaching Traffic.*
3. *Traffic Control Devices Shall Be Installed Such That The Sign Or Device Farthest From The Work Area Shall Be Placed First. The Others Shall Then Be Placed Progressively Toward The Work Area.*
4. *Regulatory And Warning Signs Within The Construction Zone That Are In Conflict With The Traffic Control Plans Shall Be Removed Or Covered. All Signs Shall Be Restored Upon The Completion Of The Work.*
5. *Flaggers And/or Police Officers Shall Be In Sight Of Each Other Or In Direct Communication At All Times.*
6. *When Required By The Issuing Office, The Permittee Shall Install A Flashing Arrow Signal As Shown On The Traffic Control Plans.*
7. *All Traffic Lanes Shall Be A Minimum Of 10 Feet Wide.*
8. *All Construction Warning Signs Shall Be Promptly Removed Or Covered Whenever The Message Is Not Applicable Or Not In Use.*
9. *The Backs Of All Signs Used For Traffic Control Shall Be Appropriately Covered To Preclude The Display Of Inapplicable Sign Messages (i.e. When The Signs Have Messages On Both Faces).*
10. *At The End Of Each Day's Work Or As Soon As The Work Is Completed, The Permittee Shall Remove All Traffic Control Devices No Longer Needed To Permit Free And Safe Passage Of Public Traffic. Removal Shall Be In The Reverse Order Of Installation.*
11. *Replace Permanent Pavement Markings And Traffic Signs Upon Completion Of Each Phase Of Work.*
12. *Police Officer/flagmen Shall Be Present At All Times.*

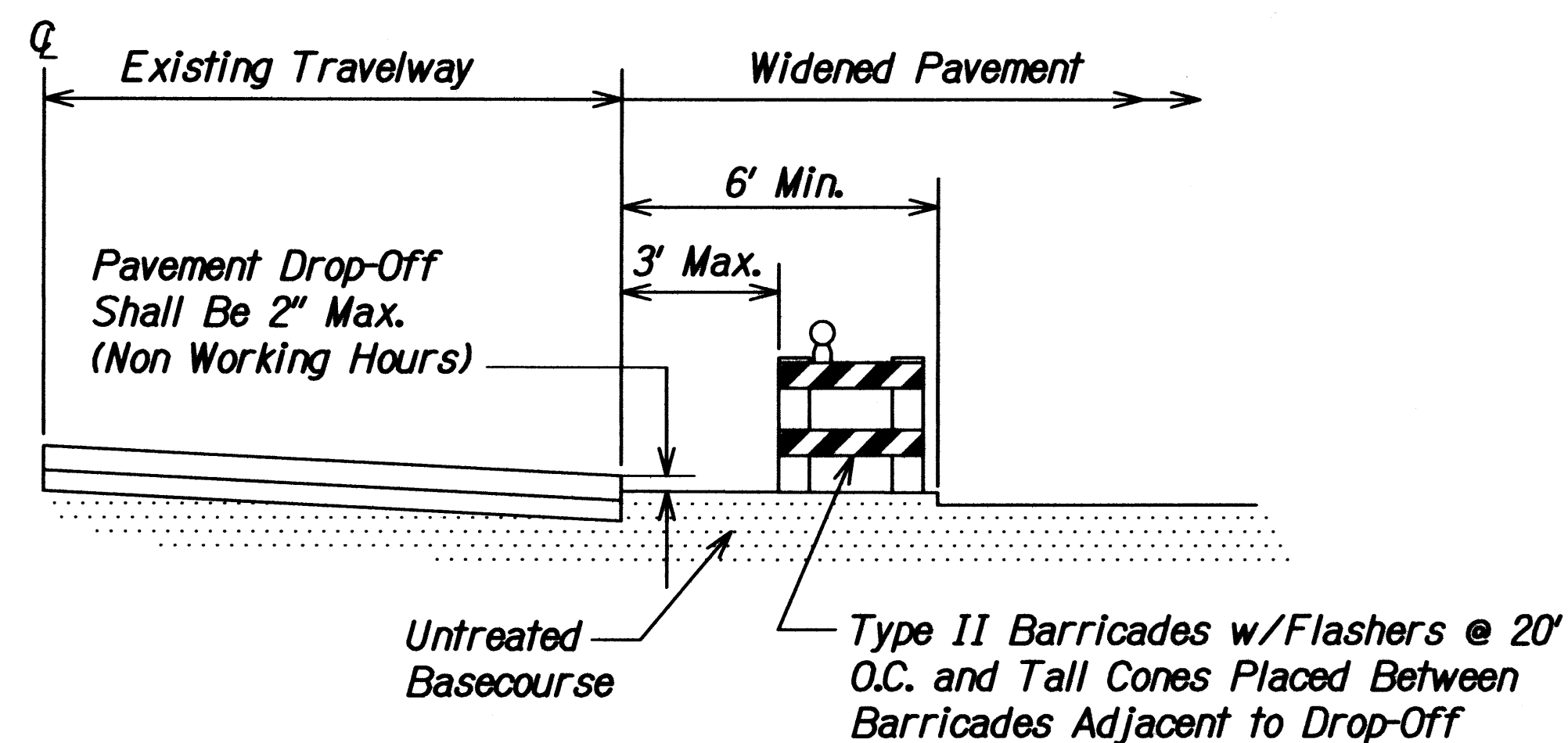

PAVEMENT DROP-OFF DETAIL  
PAVEMENT  
DROP LESS THAN 2"  
*Not To Scale*

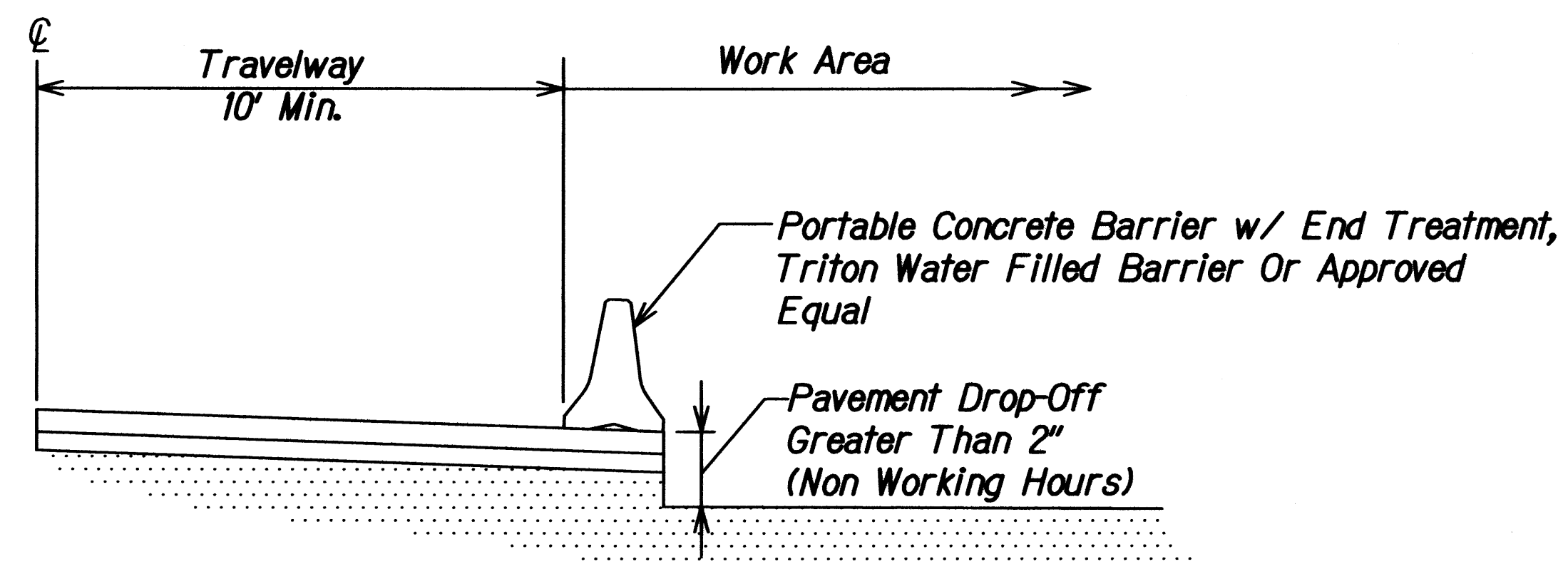

PAVEMENT DROP-OFF DETAIL  
PAVEMENT  
DROP GREATER THAN 2"  
Not To Scale

POSTED SPEED LIMIT (MPH)	SIGN SPACING (D) (FEET)	TAPER LENGTH (T) (FEET)		LONGIT- UDINAL BUFFER SPACE (BXFEET)	SPACING OF CONES OR DELINEATORS (FEET)		
		W=12' OR LESS	W= GREATER THAN 12'		TAPER	TANGENT	WORK AREA
20	250	200	W x 17	35	20	20	10
25	250	200	W x 17	55	25	25	10
30	250	250	W x 20	85	30	30	10
35	250	250	W x 20	120	35	35	10

$W$  = width of lane or shoulder

FED. ROAD DIST. NO.	STATE	FED. AID PROJ. NO.	FISCAL YEAR	SHEET NO.	TOTAL SHEETS
HAWAII	HAW.	HSIP-056-1(54)	2010	34	48

ORIGINAL PLAIN	SURVEY PLOTTED BY _____ DATE _____
NOTE BOOK	DRAWN BY <u>CAD</u>
	TRACED BY _____
	DESIGNED BY <u>KODANI &amp; ASSOCIATES</u>
	QUANTITIES BY <u>KODANI &amp; ASSOCIATES</u>
	CHECKED BY <u>HW-K</u>

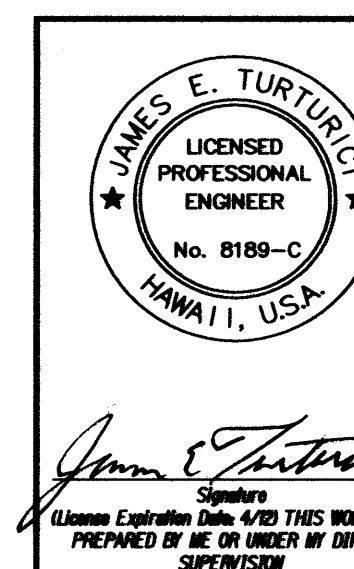

STATE OF HAWAII  
DEPARTMENT OF TRANSPORTATION  
HIGHWAYS DIVISION

**TRAFFIC CONTROL NOTES AND DETAILS**

**KUHIO HIGHWAY**  
**Intersection Improvements**  
**at Kapule Highway**  
**Federal Aid Project No. HSIP-056-1(54)**  
*Date: August 2010*