

FED. ROAD DIST. NO.	STATE	PROJ. NO.	FISCAL YEAR	SHEET NO.	TOTAL SHEETS
HAWAII	HAW.	51B-01-17M	2017	14	21

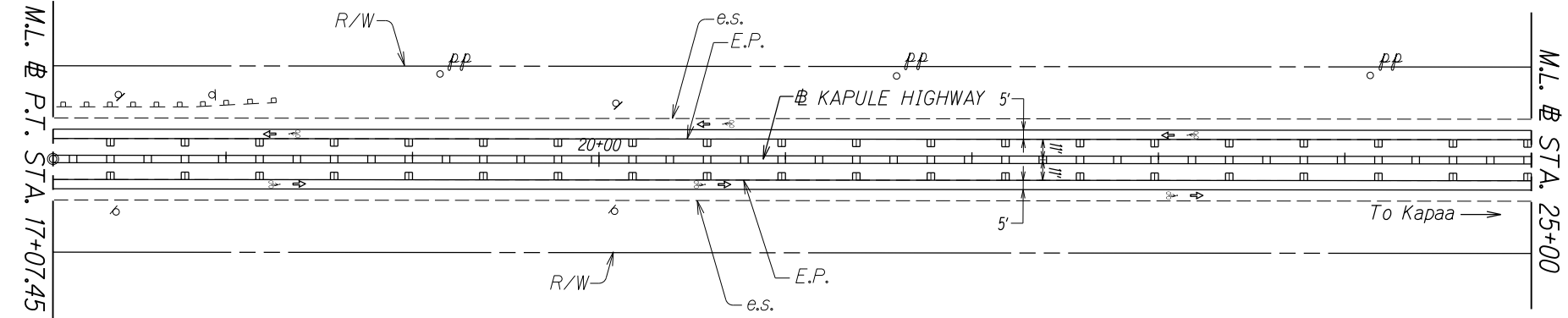
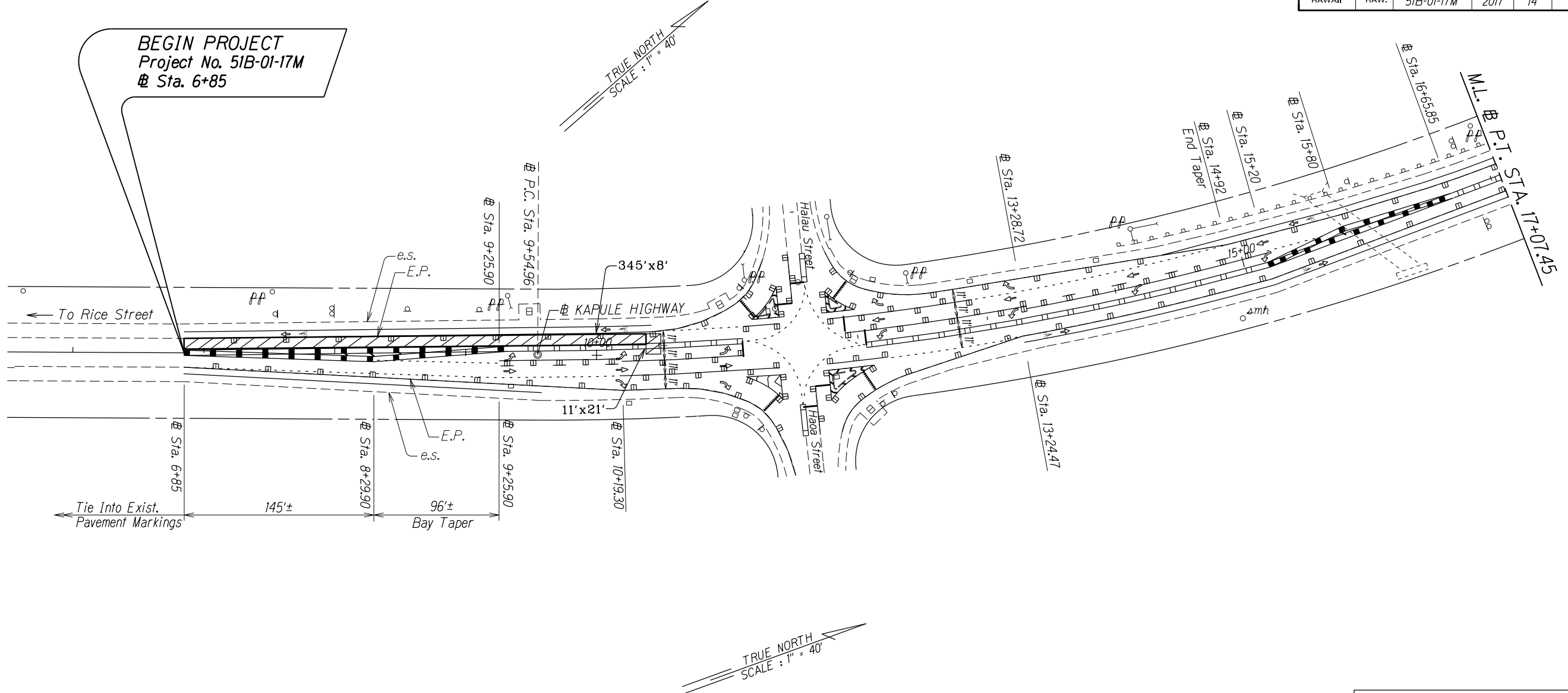

SURVEY PLOTTED BY	DATE
DESIGNED BY	
QUANTITIES BY	
CHECKED BY	
ORIGINAL PLAN	
NOTE: BOOK	
REVISIONS	

LEGEND FOR AS-BUILT POSTINGS	
	Squiggly line for as-built deletion
	Double line for as-built deletion
	Text for as-built posting

FIELD POSTED DRAWINGS

STATE OF HAWAII
DEPARTMENT OF TRANSPORTATION
HIGHWAYS DIVISION

**PAVEMENT MARKING
& TRAFFIC SIGNING PLAN**

KAPULE HIGHWAY PAVEMENT REPAIR
Halau Street to Ahukini Road
Project No. 51B-01-17M

Scale: 1" = 40' Date: Jan. 2017

SHEET No. T2 OF 4 SHEETS

"AS-BUILT"

FED. ROAD DIST. NO.	STATE	PROJ. NO.	FISCAL YEAR	SHEET NO.	TOTAL SHEETS
HAWAII	HAW.	51B-01-17M	2017	15	21

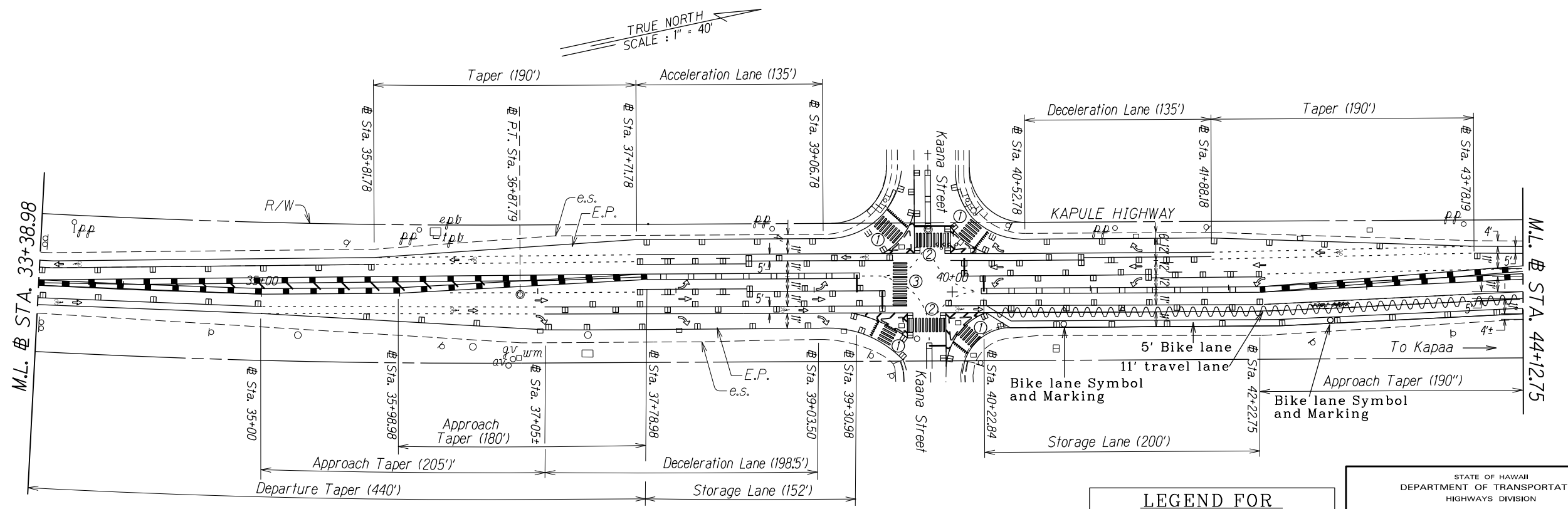
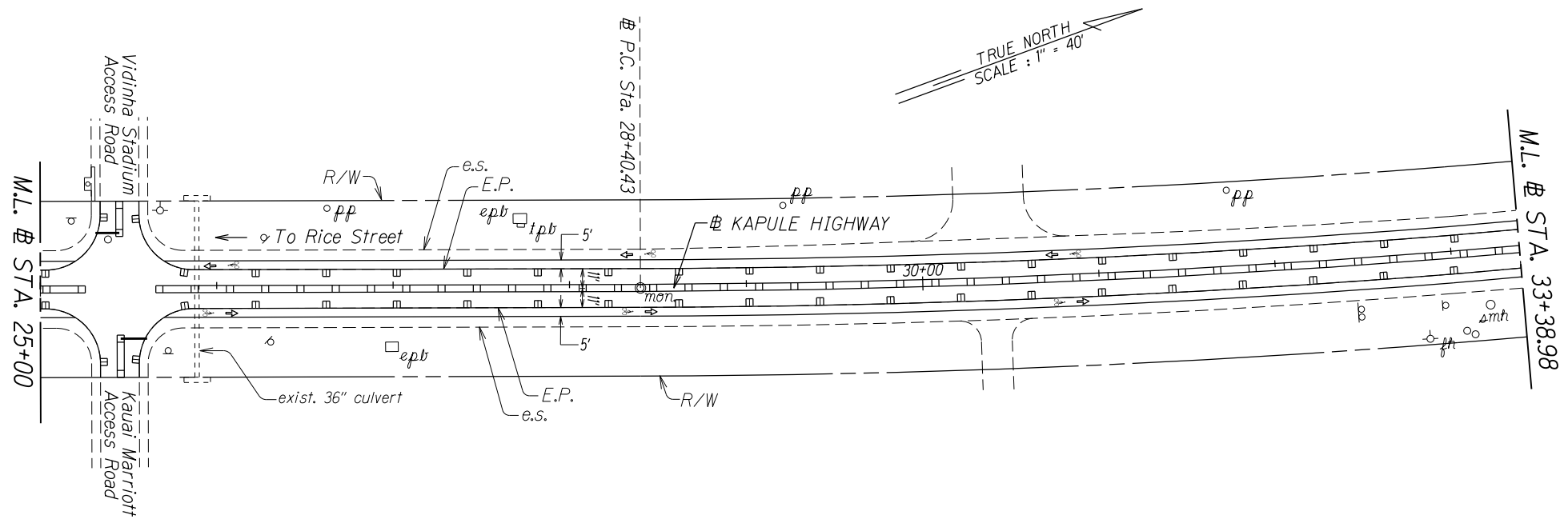

DATE	
DESIGNED BY	X
CHECKED BY	X
NOTED BY	X
QUANTITIES BY	X
REVISIONS	
BY	
DATE	

LEGEND FOR AS-BUILT POSTINGS	
	Squiggly line for as-built deletion
	Double line for as-built deletion
Roadway	Text for as-built posting

STATE OF HAWAII
DEPARTMENT OF TRANSPORTATION
HIGHWAYS DIVISION

PAVEMENT MARKING & TRAFFIC SIGNING PLAN
KAPULE HIGHWAY PAVEMENT REPAIR
Halau Street to Ahukini Road
Project No. 51B-01-17M

Scale: 1" = 40' Jan. 2017

SHEET No. T3 OF 4 SHEETS

"AS-BUILT"

FED. ROAD DIST. NO.	STATE	PROJ. NO.	FISCAL YEAR	SHEET NO.	TOTAL SHEETS
HAWAII	HAW.	51B-01-17M	2017	16	21

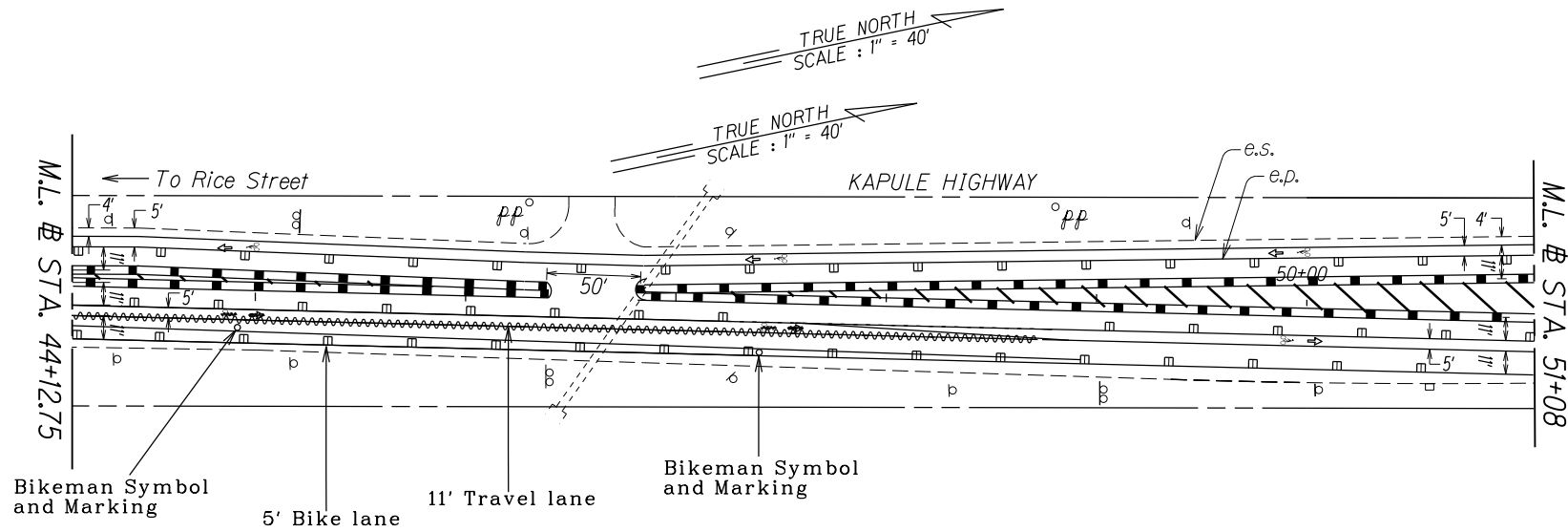

Bikeman Symbol and Marking
5' Bike lane
11' Travel lane
Bikeman Symbol and Marking

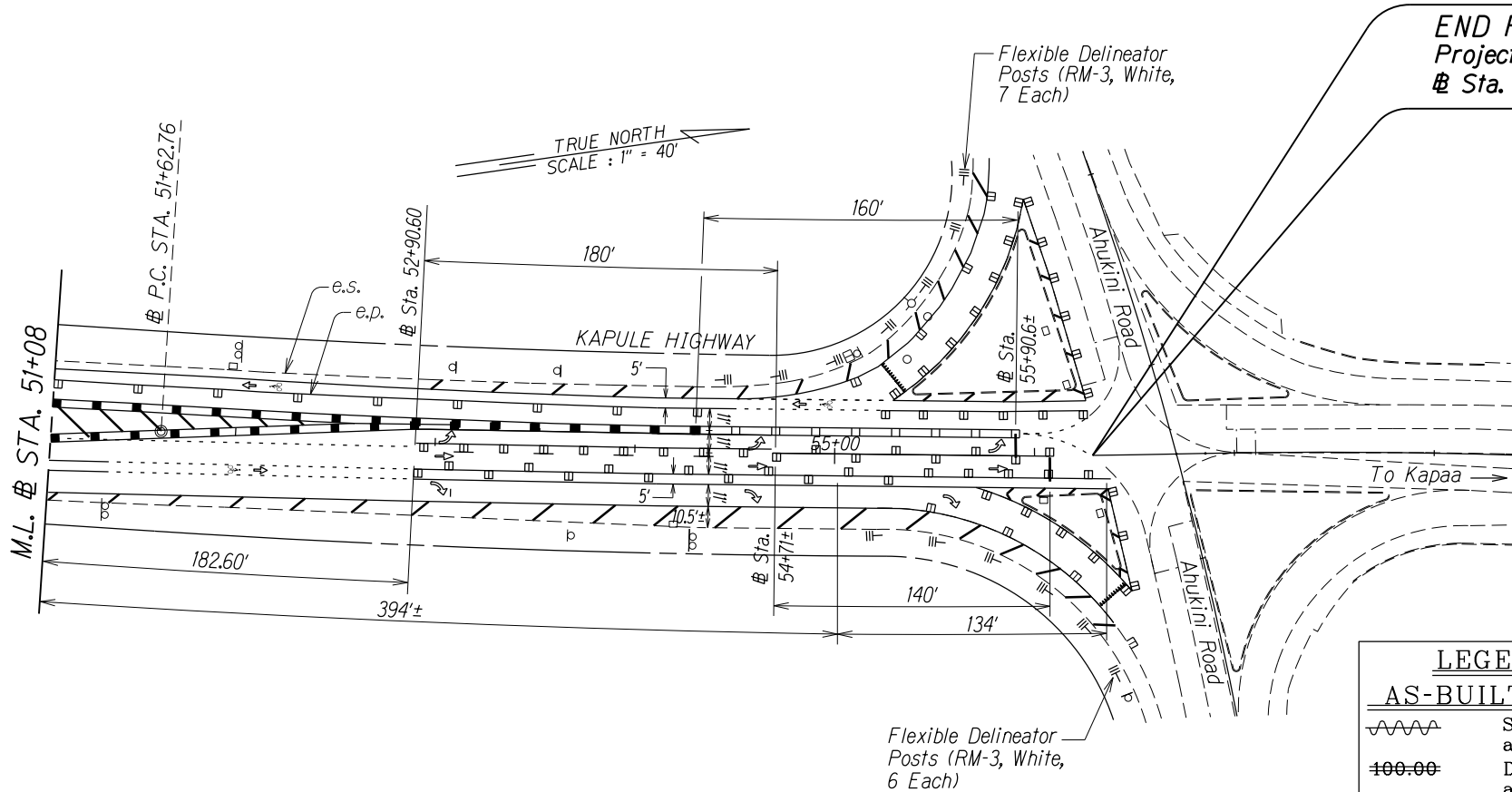

END PROJECT
Project No. 51B-01-17M
Sta. 56+29±

LEGEND FOR AS-BUILT POSTINGS

	Squiggly line for as-built deletion
	Double line for as-built deletion
Roadway	Text for as-built posting

STATE OF HAWAII
DEPARTMENT OF TRANSPORTATION
HIGHWAYS DIVISION

PAVEMENT MARKING & TRAFFIC SIGNING PLAN
KAPULE HIGHWAY PAVEMENT REPAIR
Halau Street to Ahukini Road
Project No. 51B-01-17M

Scale: 1" = 40' Date: Jan. 2017
SHEET No. T4 OF 4 SHEETS

SURVEY PLOTTED BY	DATE	X
DESIGNED BY		
NOTED BY		
QUANTITIES BY		
CHECKED BY		

"AS-BUILT"