

FED. ROAD DIST. NO.	STATE	PROJ. NO.	FISCAL YEAR	SHEET NO.	TOTAL SHEETS
HAWAII	HAW.	51B-01-17M	2017	17	21

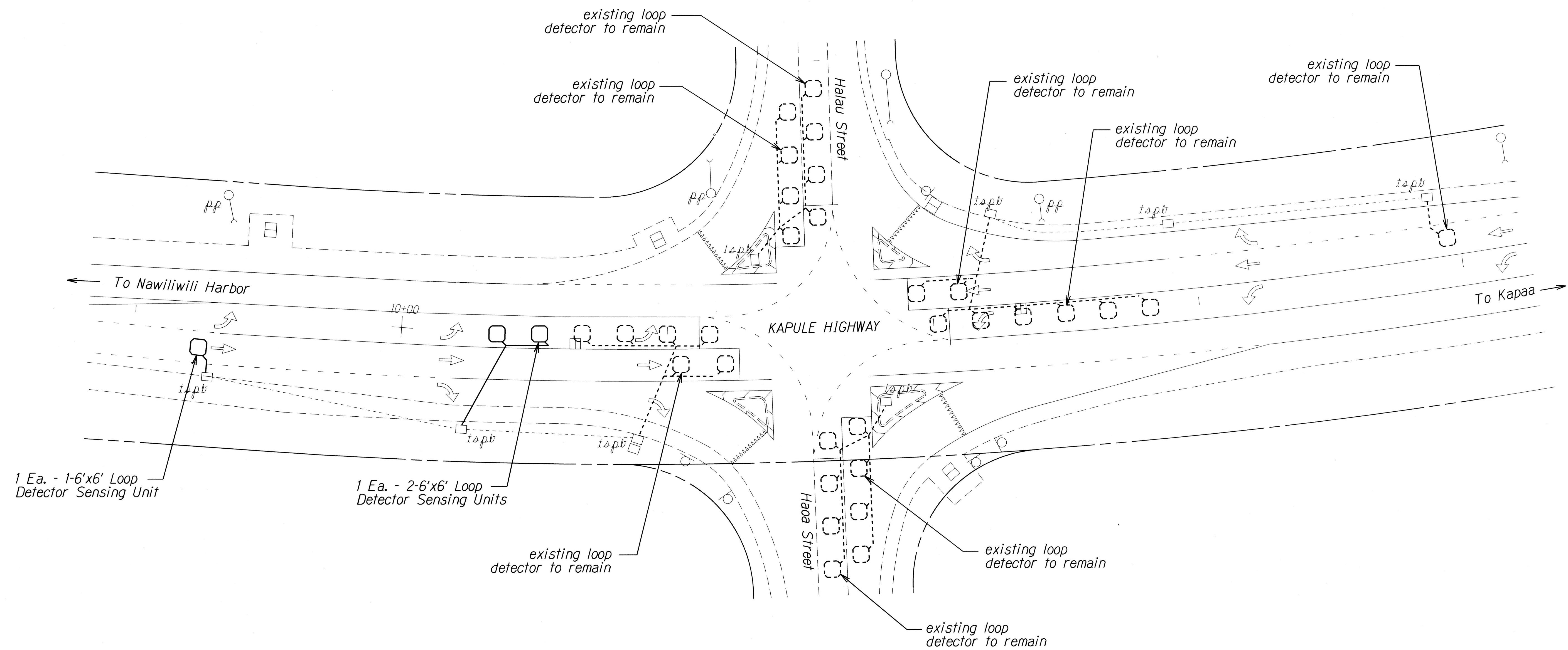

ORIGINAL PLAN	SURVEY PLOTTED BY	DATE
NOTE BOOK	DRAWN BY	
	TRACED BY	
	QUANTITIES BY	
	CHECKED BY	

STATE OF HAWAII  
DEPARTMENT OF TRANSPORTATION  
HIGHWAYS DIVISION

**LOOP DETECTOR PLAN**  
**AT HAA ST./HALAU ST. INTERSECTION**  
**KAPULE HIGHWAY PAVEMENT REPAIR**  
Halau Street to Ahukini Road  
Project No. 51B-01-17M

Scale: 1" = 40'  
Date: Jan. 2017

SHEET No. 1 OF 2 SHEETS

FED. ROAD DIST. NO.	STATE	PROJ. NO.	FISCAL YEAR	SHEET NO.	TOTAL SHEETS
HAWAII	HAW.	51B-01-17M	2017	18	21

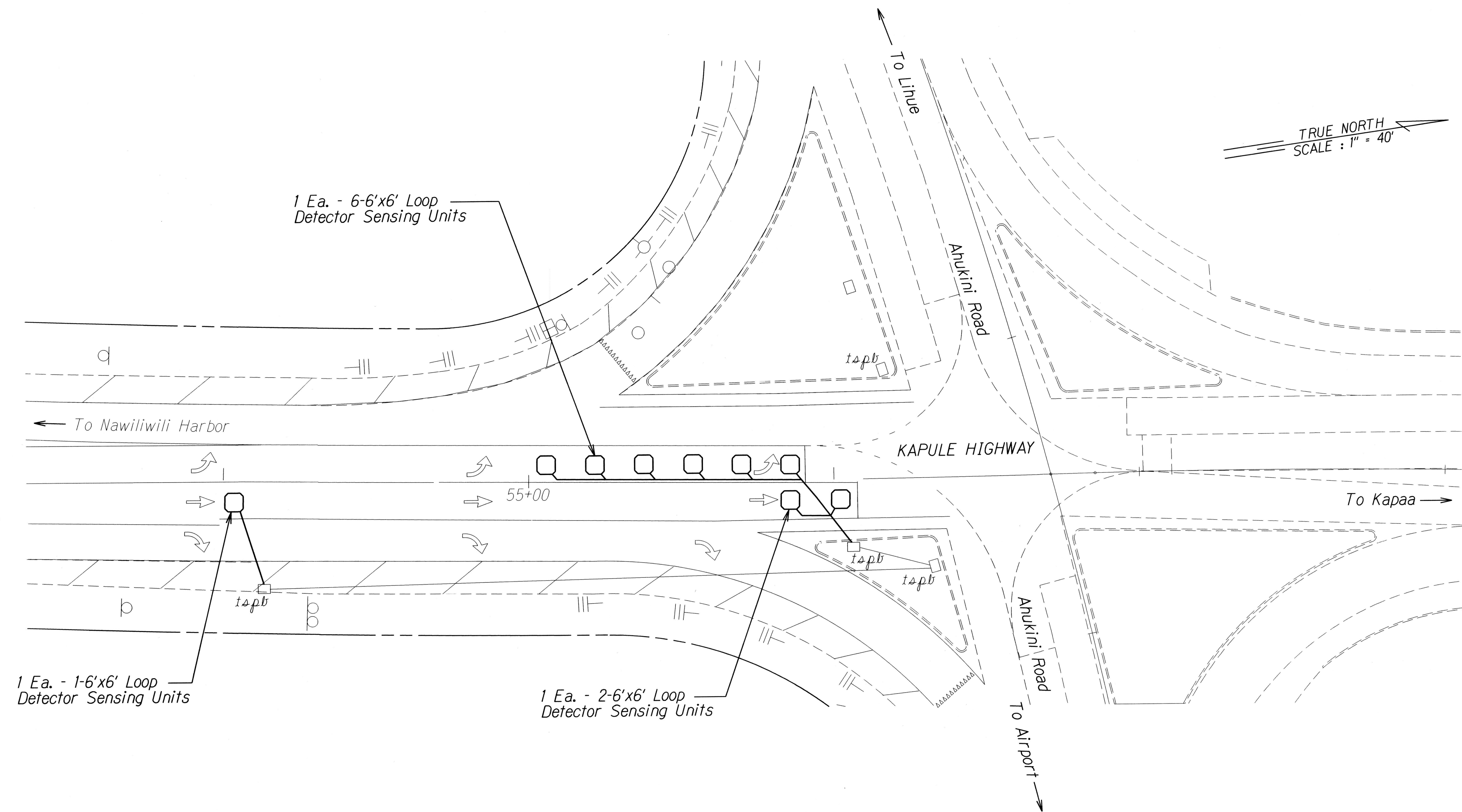

ORIGINAL PLAN	SURVEY PLOTTED BY	DATE
TRACED BY		
NOTED BY		
CHECKED BY		

STATE OF HAWAII  
DEPARTMENT OF TRANSPORTATION  
HIGHWAYS DIVISION

**LOOP DETECTOR PLAN**  
**AT AHUKINI ROAD INTERSECTION**  
**KAPULE HIGHWAY PAVEMENT REPAIR**  
**Halau Street to Ahukini Road**  
**Project No. 51B-01-17M**

Scale: 1" = 40' Date: Jan. 2017

SHEET No. 2 OF 2 SHEETS