

FED. ROAD DIST. NO.	STATE	PROJ. NO.	FISCAL YEAR	SHEET NO.	TOTAL SHEETS
HAWAII	HAW.	51B-01-00M	2000	6	23

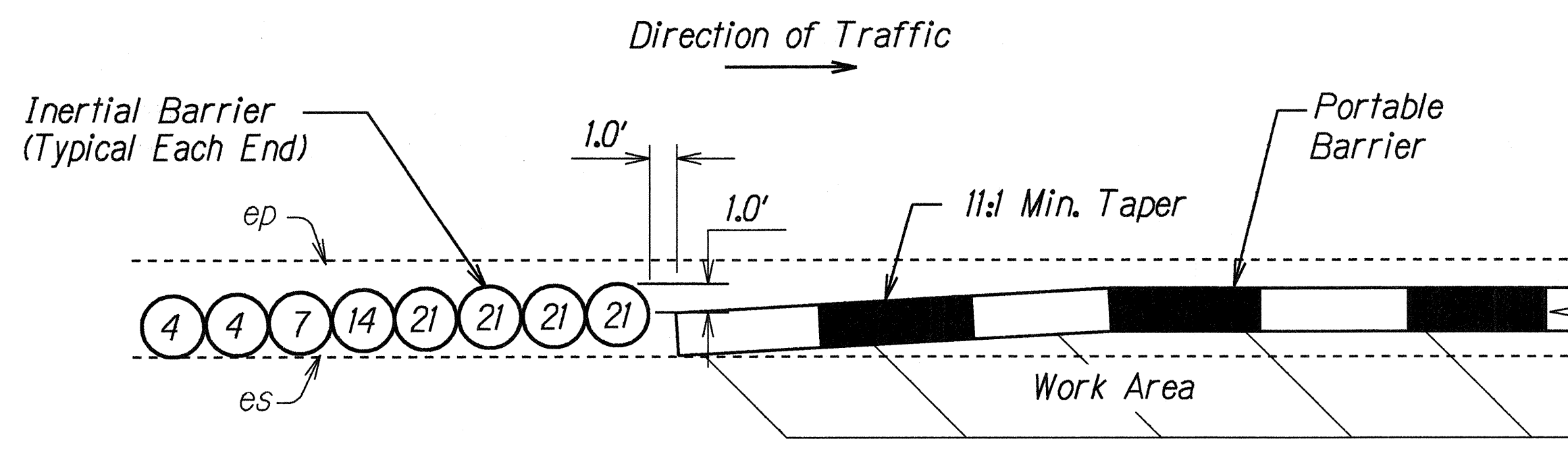

NOTE: The numbers inside the circle indicate weight of sand in 100 lb unit. Installation shall conform to Manufacturer's recommendations.

**TYPICAL DETAIL**  
**8-MODULE INERTIAL BARRIER**  
Not To Scale

**NOTES:**

1. Installation of portable physical barriers shall conform to Manufacturer's recommendations.
2. Physical barriers shall be required whenever guardrails have been removed and will not be reinstalled at the end of the work day. See General Note No. 14 on Plan Sht. No. 3.
3. Physical barriers shall be either portable concrete barriers or portable water-filled barriers. Installation of portable water-filled barriers shall conform to Manufacturer's recommendations as dictated by design speed and field conditions.
4. Providing, transporting, placing, maintaining, relocating and removing physical barriers shall be considered incidental to the various items of work. See Section 645, TRAFFIC CONTROL DEVICES of the Special Provisions.
5. Ends of portable barriers shall be protected with Inertial Barriers as shown hereon. Furnishing, installing and maintaining inertial barriers shall be considered incidental to the various contract items.
6. Furnishing, installing and maintaining reflector markers (RM-3) over the portable barriers shall be considered incidental to the various contract items.

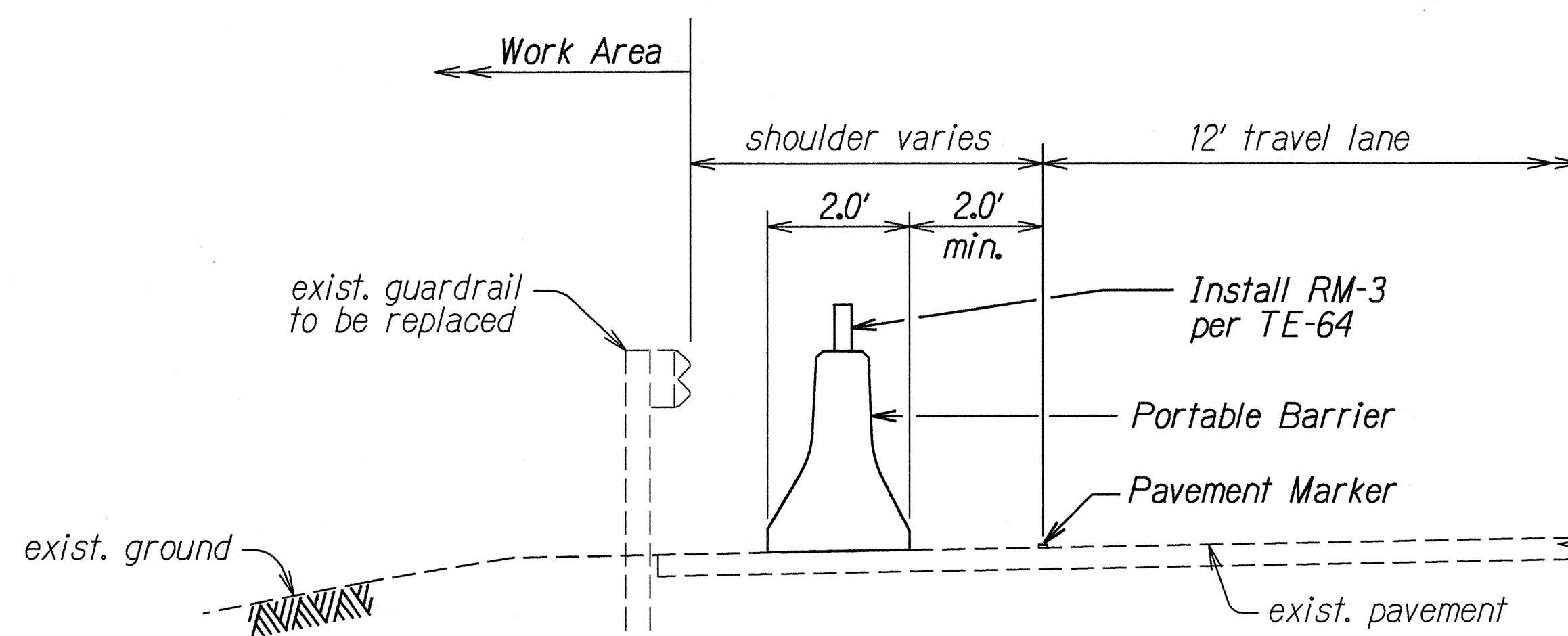

**TYPICAL DETAIL**  
**PORTABLE BARRIER**  
Not To Scale

SURVEY PLOTTED BY	DATE
DRAWN BY	12-15-99
TRACED BY	
CHECKED BY	
NOTED BY	
REVISIONS	
BY	
DATE	
REASON	
BY	
DATE	

STATE OF HAWAII  
DEPARTMENT OF TRANSPORTATION  
HIGHWAYS DIVISION

**PORTABLE PHYSICAL BARRIER**  
  
KAPULE HIGHWAY,  
MISCELLANEOUS IMPROVEMENTS  
Vicinity of Ahukini Road to Kuhio Highway  
Project No. 51B-01-00M  
Scale: As Shown      Date: December, 1999  
SHEET No. 1 OF 1 SHEETS