

FED. ROAD DIST. NO.	STATE	PROJ. NO.	FISCAL YEAR	SHEET NO.	TOTAL SHEETS
HAWAII	HAW.	51C-01-76	1981	2	2

BORING SCHEDULE			
STATION	IDENTIFICATION	BORING LOCATION	BORING DEPTH
100+60	HSB	A-1	50'
102+00	HSB	1	60'
103+80	HSB	2	80'
105+60	HSB	3	100'
107+40	HSB	4	125'
109+20	HSB	5	125'
111+00	HSB	6	60'
112+00	HSB	A-2	40'

GENERAL NOTES:

- The contractor shall be responsible for locating all existing underground utilities, pipes or other facilities, whether shown on the plans or not, prior to starting his operation. Any damage to these facilities will be borne by the contractor and shall be restored to the satisfaction of the owner.
- Areas Designated as Grave Sites Shall Not Be Disturbed By The Contractor's Drilling/Boring Operation And/Or Ingress/Egress From The Site.

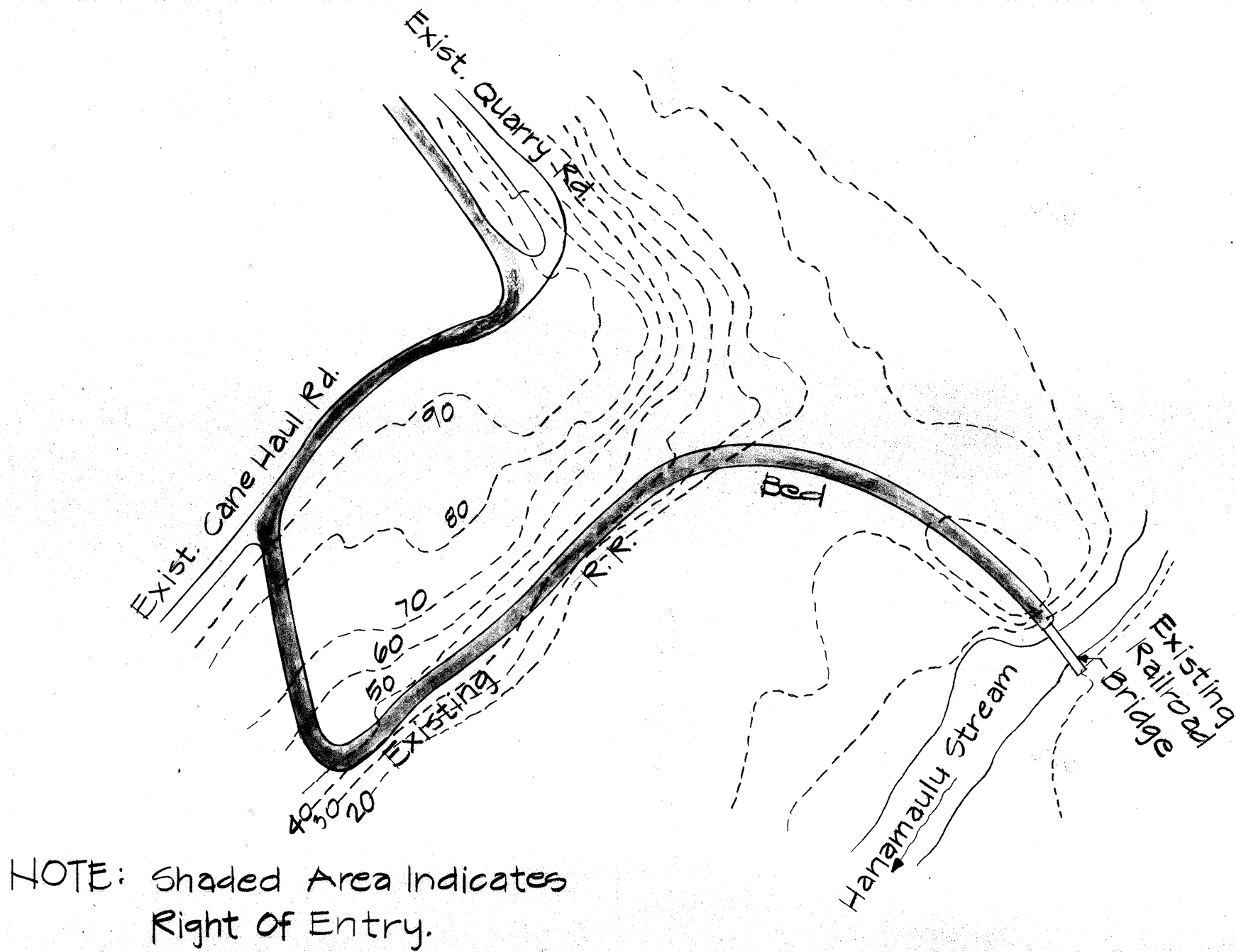

RIGHT OF ENTRY PLAN
Scale: 1" = 200'

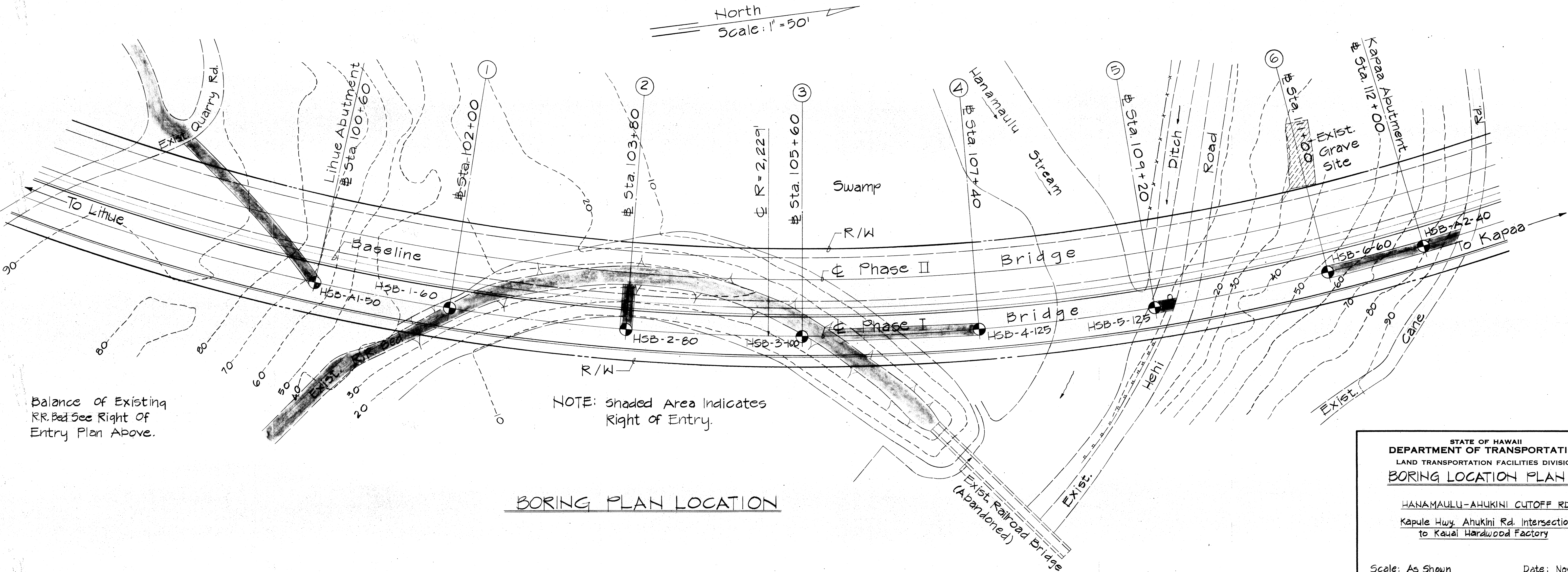

BORING PLAN LOCATION

STATE OF HAWAII
DEPARTMENT OF TRANSPORTATION
LAND TRANSPORTATION FACILITIES DIVISION
BORING LOCATION PLAN
HANAMAULU-AHUKINI CUTOFF RD.
Kapule Hwy. Ahukini Rd. Intersection
to Kauai Hardwood Factory

Scale: As Shown
Date: Nov., 1980
SHEET NO. 1 OF 1 SHEETS

ORIGINAL PLAN	DATE
DESIGNED BY	
DRAWN BY	
CHECKED BY	
NOTED BY	
QUANTITIES BY	
CHECKED BY	
NO.	

Balance of Existing
R.R. Bed See Right of
Entry Plan Above.