

FED. ROAD DIST. NO.	STATE	PROJ. NO.	FISCAL YEAR	SHEET NO.	TOTAL SHEETS
HAWAII	HAW.	50D-01-99M	1999	17	29

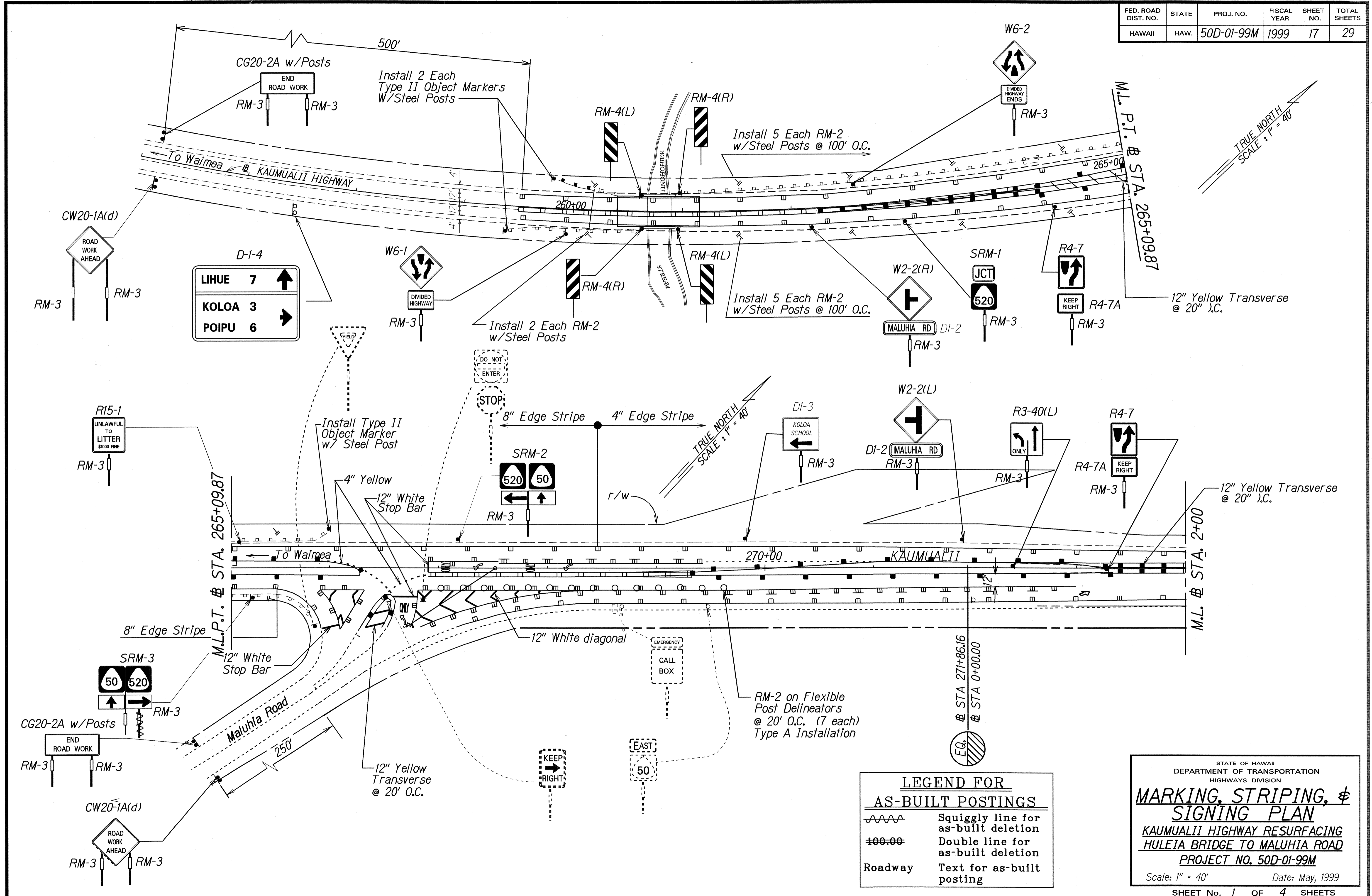

SURVEY PLOTTED BY: _____ DATE: _____
 DRAWN BY: _____
 CHECKED BY: _____
 ORIGINAL PLAN: _____
 NOTE BOOK: _____
 CHECKED BY: _____
 dkmutp01.dgn

LEGEND FOR AS-BUILT POSTINGS

	Squiggly line for as-built deletion
	Double line for as-built deletion
Roadway	Text for as-built posting

STATE OF HAWAII
 DEPARTMENT OF TRANSPORTATION
 HIGHWAYS DIVISION
MARKING, STRIPING, & SIGNING PLAN
 KAUMUALII HIGHWAY RESURFACING
 HULEIA BRIDGE TO MALUHIA ROAD
 PROJECT NO. 50D-01-99M
 Scale: 1" = 40' Date: May, 1999
 SHEET No. 1 OF 4 SHEETS

"AS-BUILT"

FED. ROAD DIST. NO.	STATE	PROJ. NO.	FISCAL YEAR	SHEET NO.	TOTAL SHEETS
HAWAII	HAW.	50D-01-99M	1999	18	29

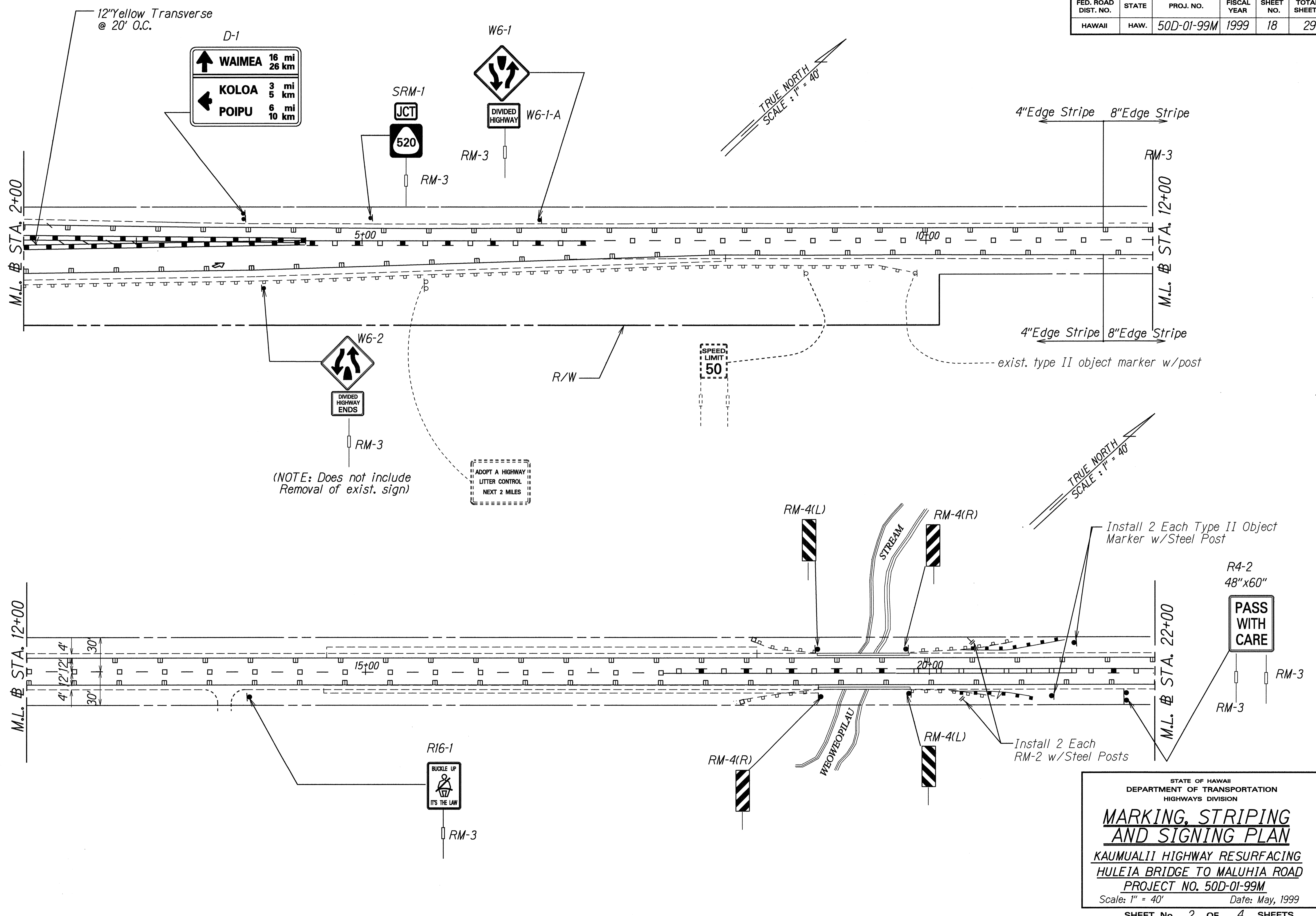

DESIGNED BY	DATE
DRAWN BY	
TRACED BY	
DESIGNED BY	
QUANTITIES BY	
CHECKED BY	
No. _____	
dkmukip02.dgn	

STATE OF HAWAII
DEPARTMENT OF TRANSPORTATION
HIGHWAYS DIVISION

MARKING, STRIPING AND SIGNING PLAN

KAUMUALII HIGHWAY RESURFACING
HULEIA BRIDGE TO MALUHIA ROAD
PROJECT NO. 50D-01-99M

Scale: 1" = 40' Date: May, 1999

FED. ROAD DIST. NO.	STATE	PROJ. NO.	FISCAL YEAR	SHEET NO.	TOTAL SHEETS
HAWAII	HAW.	50D-01-99M	1999	19	29

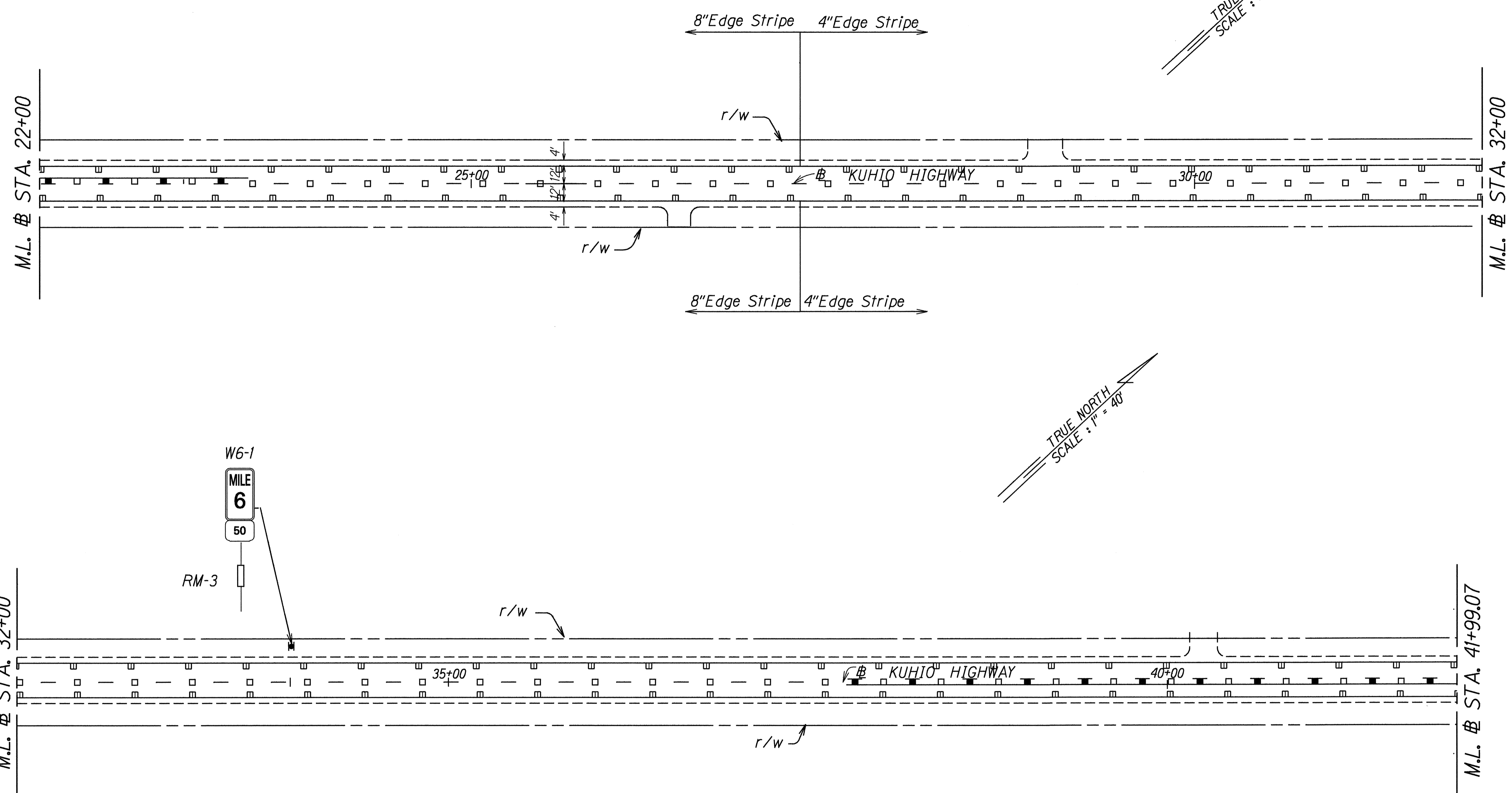

ORIGINAL SURVEY PLOTTED BY: DATE: 10/15/98
 PLAN: DRAWN BY: TRACED BY: DESIGNED BY: CHECKED BY: QUANTITIES BY: COUNTRYSIDE BY:
 USR2/HF/DDA/AMK
 dmmu/499903.000

STATE OF HAWAII
 DEPARTMENT OF TRANSPORTATION
 HIGHWAYS DIVISION

**MARKING, STRIPING
 & SIGNING PLAN**

KAUMUALII HIGHWAY RESURFACING
 HULEIA BRIDGE TO MALUHIA ROAD
 PROJECT NO. 50D-01-99M

Scale: 1"=40' Date: May, 1999

SHEET No. 3 OF 4 SHEETS

FED. ROAD DIST. NO.	STATE	PROJ. NO.	FISCAL YEAR	SHEET NO.	TOTAL SHEETS
HAWAII	HAW.	50D-01-99M	1999	20	29

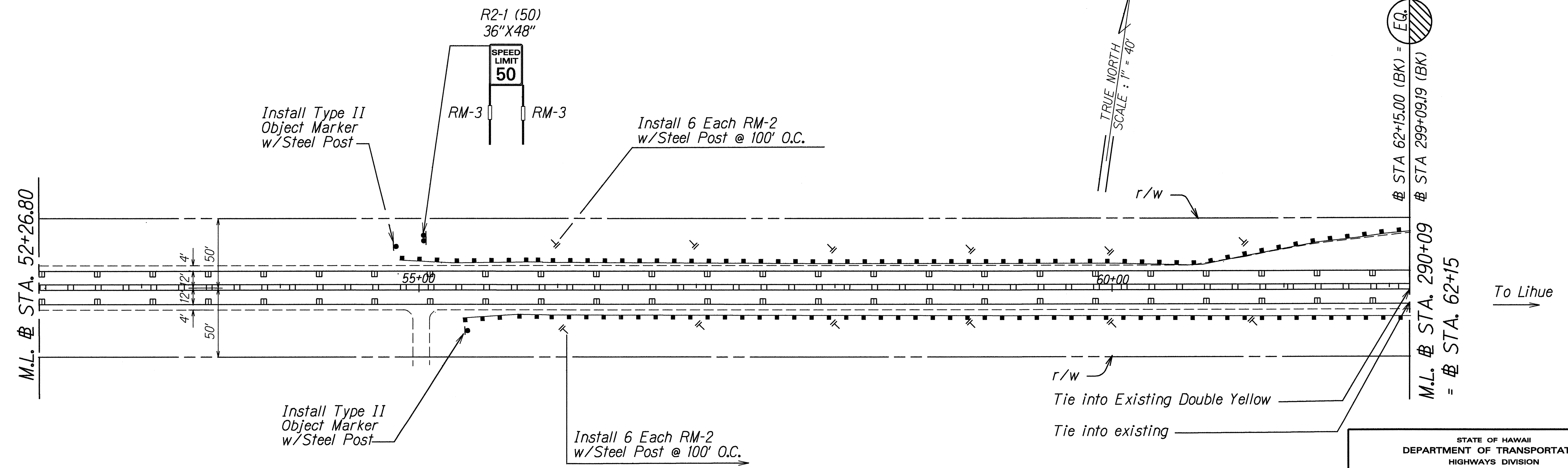
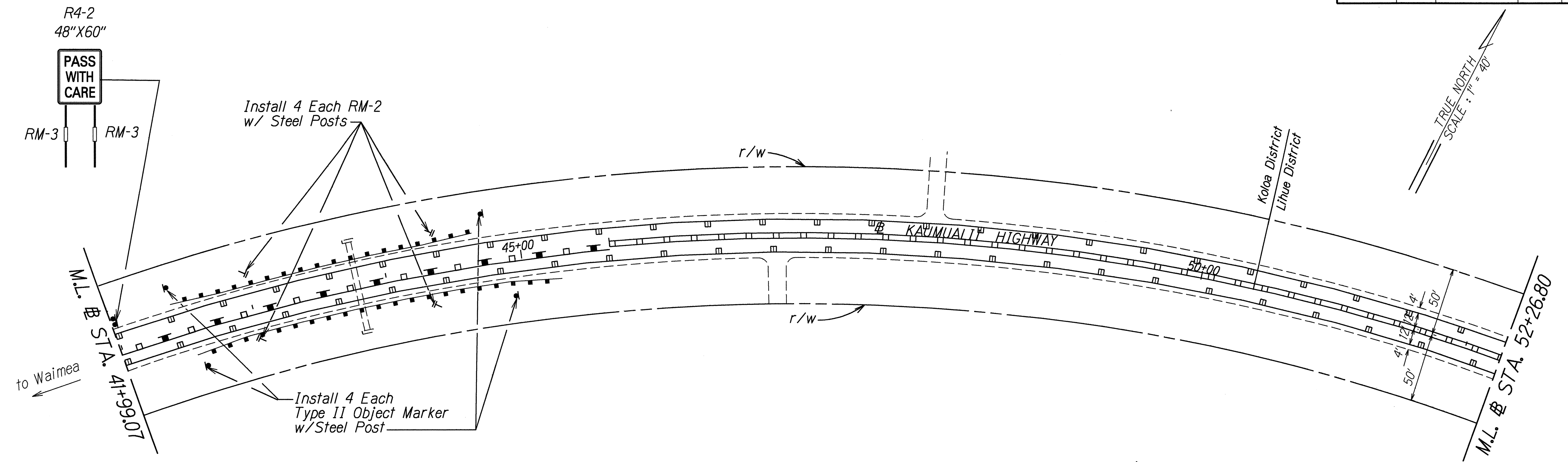

ORIGINAL PLAN
 SURVEY PLOTTED BY: DATE: 10/15/98
 DRAWN BY: JIM TUNNEY
 DESIGNED BY: JIM TUNNEY
 CHECKED BY: JIM TUNNEY
 USR2/H/ED/DA/HWK
 dlmw/cg/04/01/04/00

STATE OF HAWAII
 DEPARTMENT OF TRANSPORTATION
 HIGHWAYS DIVISION
**MARKING, STRIPING
 AND SIGNING PLAN**
 KAUMUALII HIGHWAY RESURFACING
 HULEIA BRIDGE TO MALUHIA ROAD
 PROJECT NO. 50D-01-99M
 Scale: 1"=40' Date: May, 1999
 SHEET No. 4 OF 4 SHEETS

FED. ROAD DIST. NO.	STATE	PROJ. NO.	FISCAL YEAR	SHEET NO.	TOTAL SHEETS
HAWAII	HAW.	50D-01-99M	1999	21	29

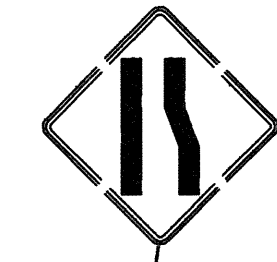
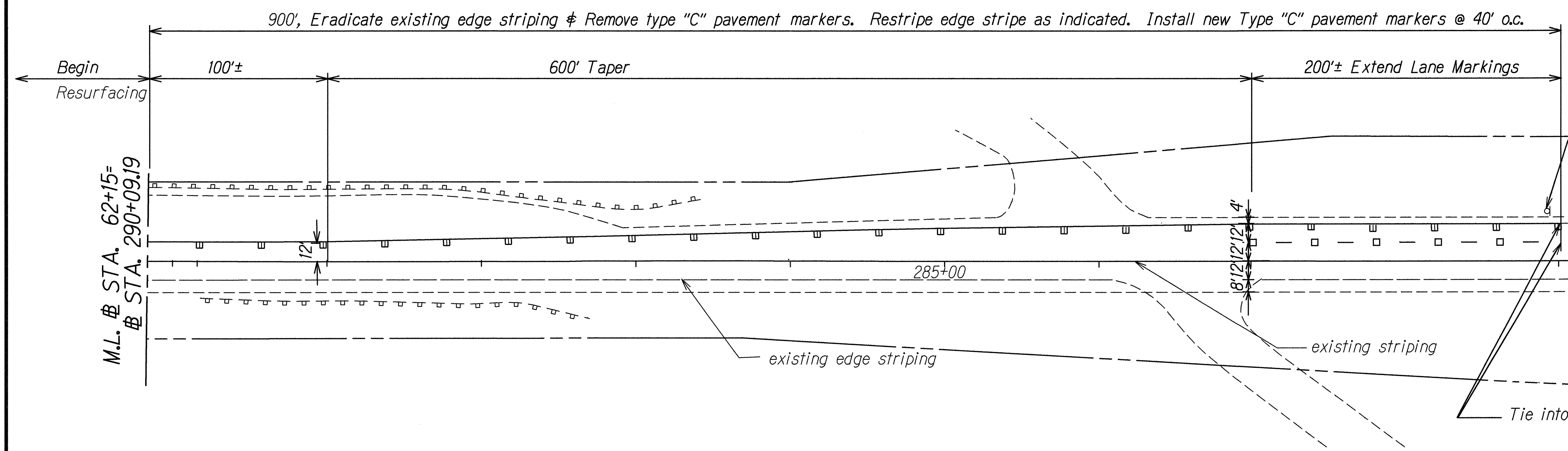

TRUE NORTH
SCALE: 1" = 40'

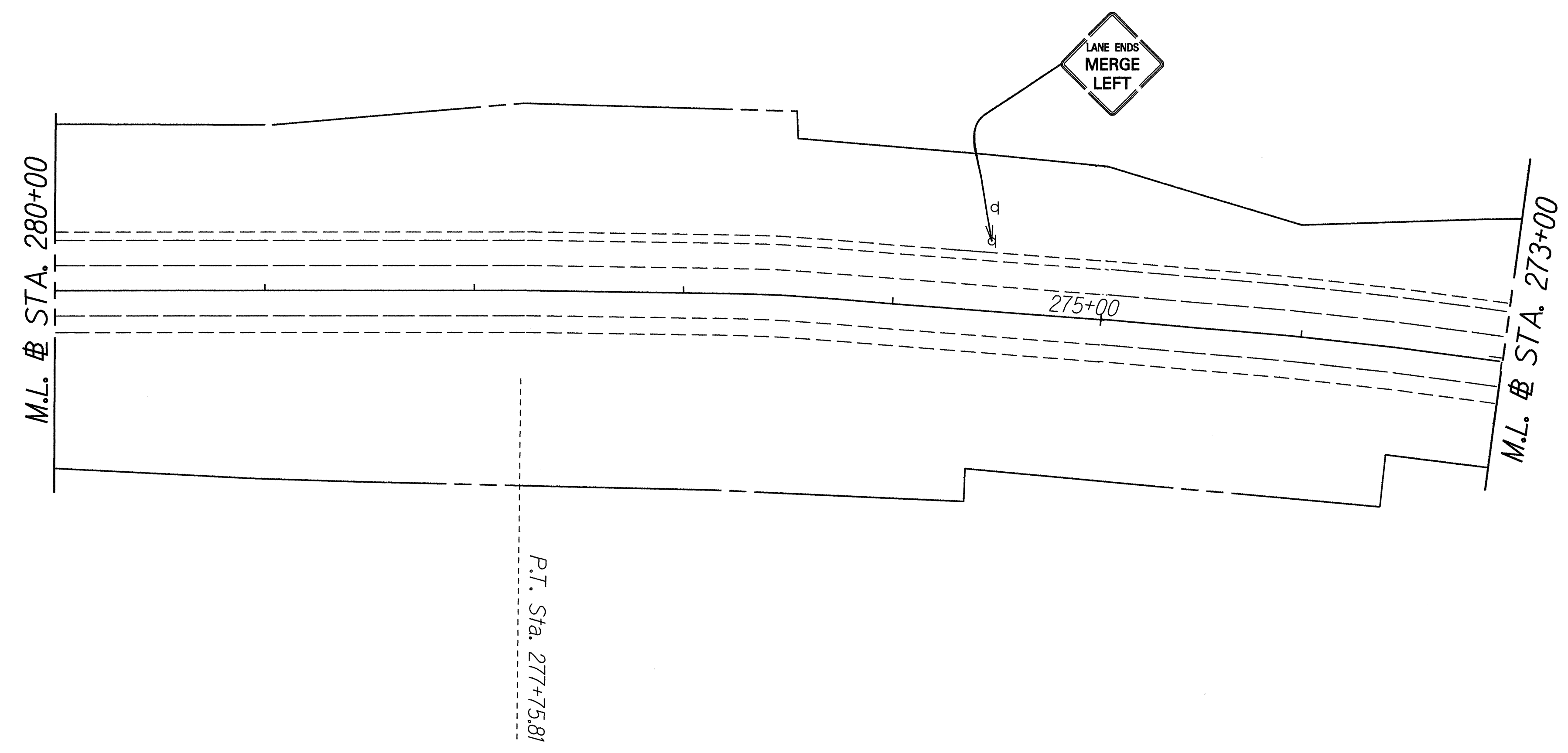

TRUE NORTH
SCALE: 1" = 40'

ORIGINAL PLAN
SURVEY PLOTTED BY: _____ DATE: 10/15/98
DRAWN BY: _____
TRACED BY: JIM TURBULEG
DESIGNED BY: _____
CHECKED BY: _____
USR2/HW/DIA/HW/K
dlmu/4/98/04.dgn

STATE OF HAWAII
DEPARTMENT OF TRANSPORTATION
HIGHWAYS DIVISION

**MARKING, STRIPING
AND SIGNING PLAN**

KAUMUALII HIGHWAY RESURFACING
HULEIA BRIDGE TO MALUHIA ROAD
PROJECT NO. 50D-01-99M

Scale: 1"=40' Date: May, 1999

SHEET No. 5 OF 6 SHEETS

