

FED. ROAD DIST. NO.	STATE	FED. AID PROJ. NO.	FISCAL YEAR	SHEET NO.	TOTAL SHEETS
HAWAII	HAW.	STP-050-1(18)	1996	20	33

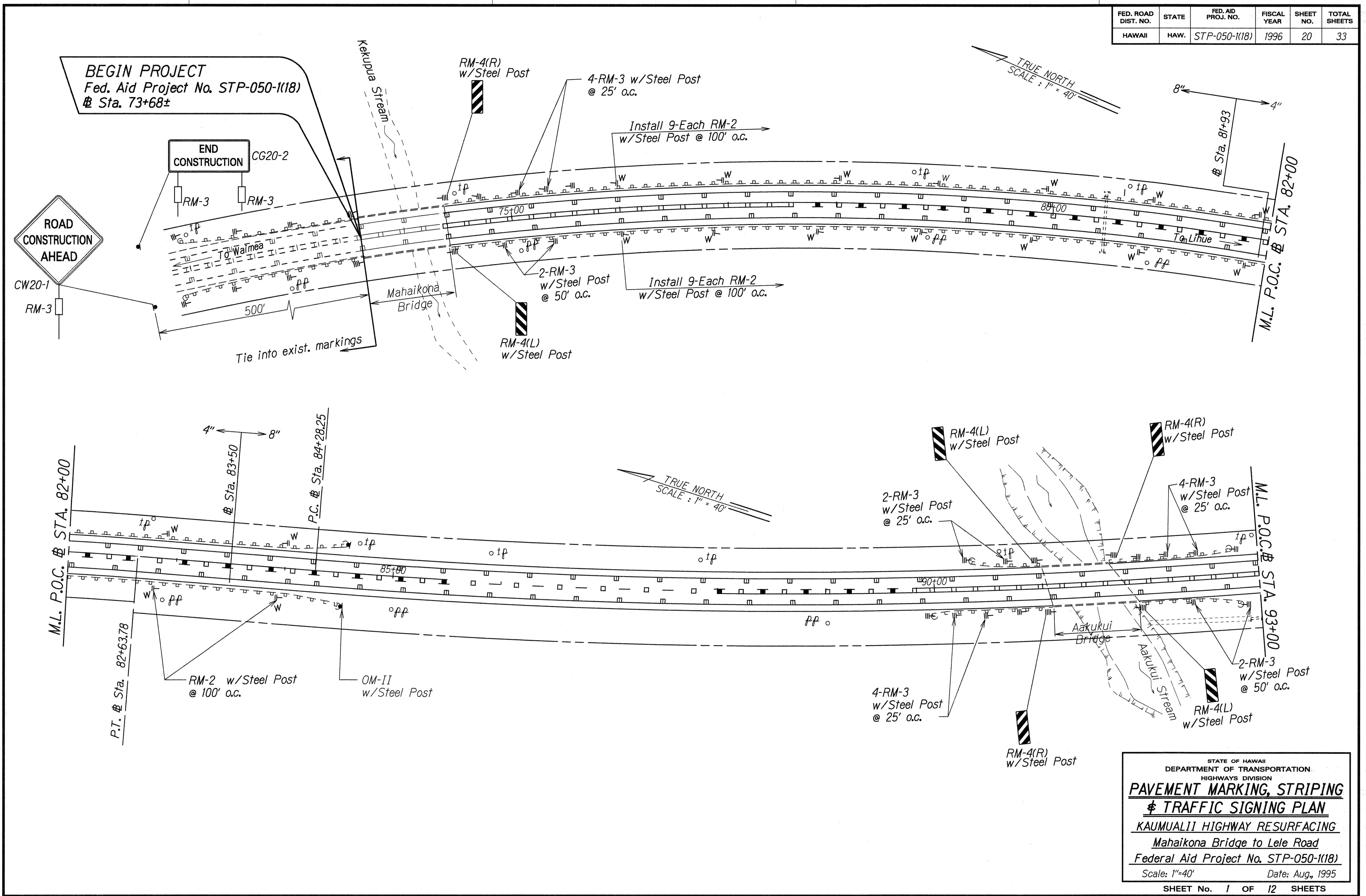

SURVEY PLOTTED BY	DATE
DRAWN BY	
DESIGNED BY	
QUANTITIES BY	
CHECKED BY	
ORIGINAL PLAN	
NOTE BOOK	
Kelesteve	
Kelesteve	

STATE OF HAWAII  
DEPARTMENT OF TRANSPORTATION  
HIGHWAYS DIVISION

**PAVEMENT MARKING, STRIPING  
& TRAFFIC SIGNING PLAN**

**KAUMUALII HIGHWAY RESURFACING**  
Mahaikona Bridge to Lele Road  
Federal Aid Project No. STP-050-1(18)

Scale: 1"=40'      Date: Aug, 1995

SHEET No. 1 OF 12 SHEETS

FED. ROAD DIST. NO.	STATE	FED. AID PROJ. NO.	FISCAL YEAR	SHEET NO.	TOTAL SHEETS
HAWAII	HAW.	STP-050-1(18)	1996	21	33

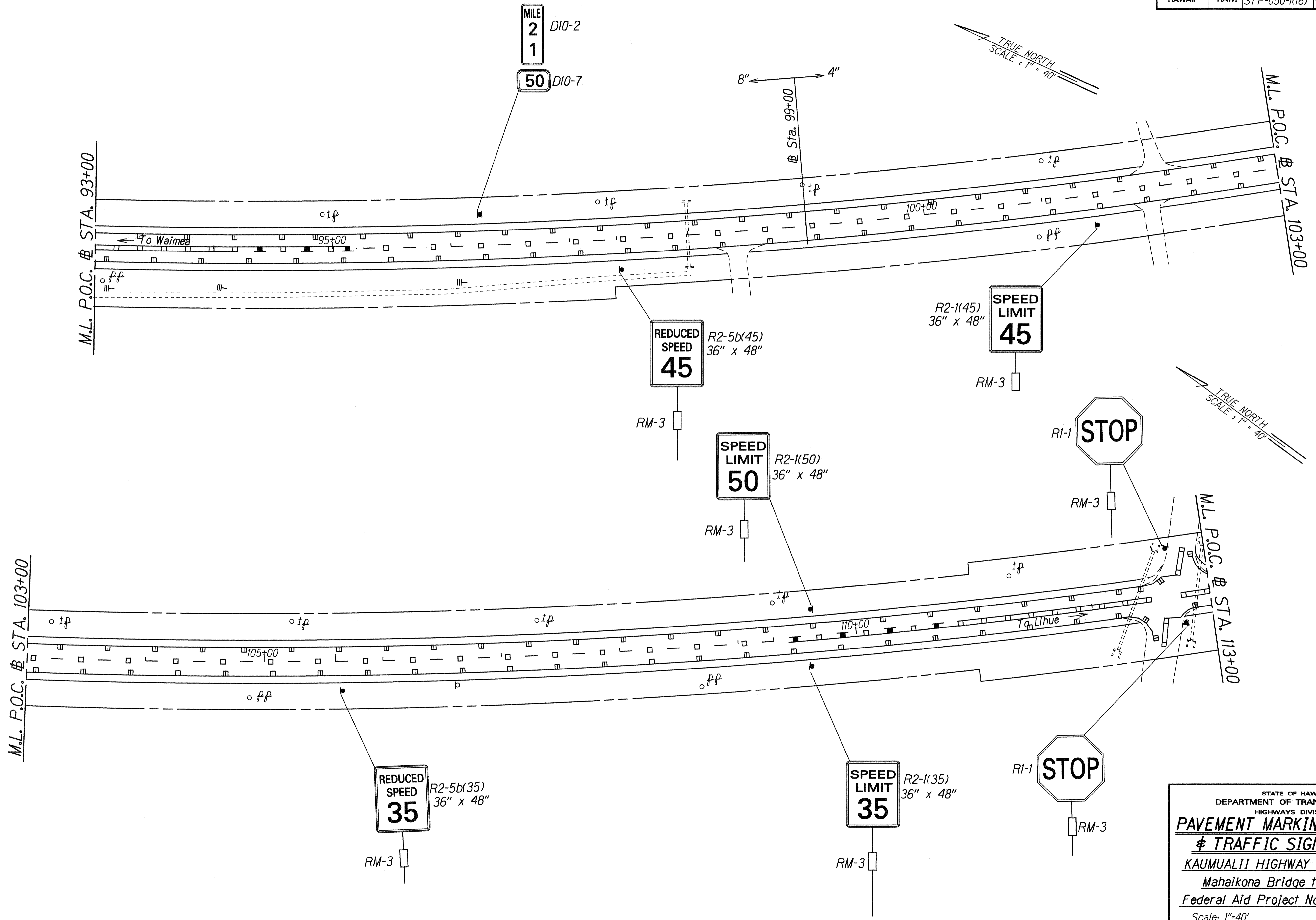

ORIGINAL PLAN	DATE	
SURVEY PLOTTED BY		
DRAWN BY		
TRACED BY		
DESIGNED BY		
CHECKED BY		

STATE OF HAWAII  
DEPARTMENT OF TRANSPORTATION  
HIGHWAYS DIVISION  
**PAVEMENT MARKING, STRIPING  
& TRAFFIC SIGNING PLAN**  
KAUMUALII HIGHWAY RESURFACING  
Mahaikona Bridge to Lele Road  
Federal Aid Project No. STP-050-1(18)  
Scale: 1"=40' Date: Aug., 1995  
SHEET No. 2 OF 12 SHEETS

FED. ROAD DIST. NO.	STATE	FED. AID PROJ. NO.	FISCAL YEAR	SHEET NO.	TOTAL SHEETS
HAWAII	HAW.	STP-050-1(18)	1996	22	33

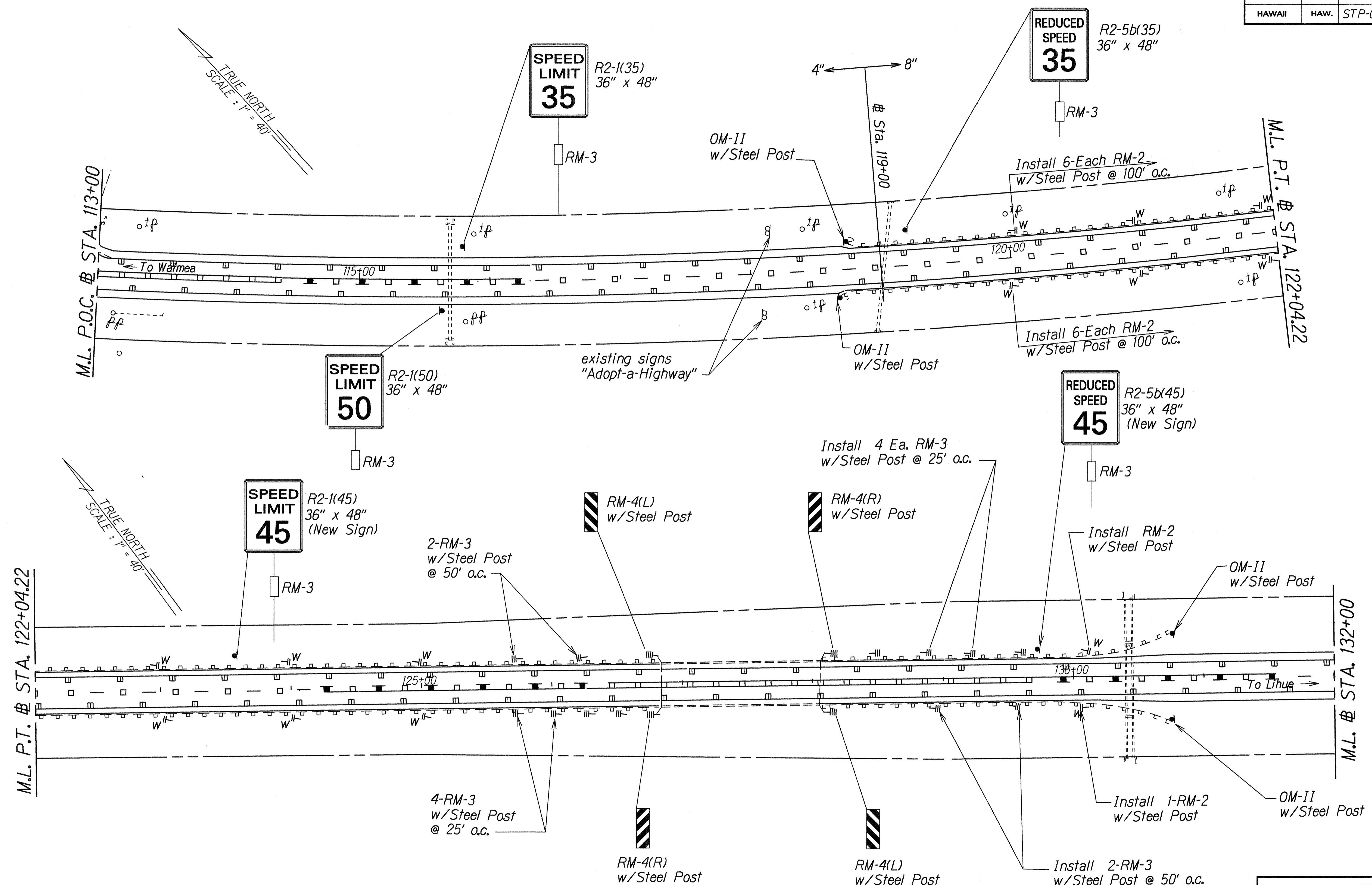

DATE	_____
SURVEY PLOTTED BY	_____
DRAWN BY	_____
TRACED BY	_____
NOTE BOOK	_____
RELIEVE	_____
QUANTITIES BY	_____
CHECKED BY	_____

STATE OF HAWAII  
DEPARTMENT OF TRANSPORTATION  
HIGHWAYS DIVISION

**PAVEMENT MARKING, STRIPING**  
**& TRAFFIC SIGNING PLAN**

KAUMUALII HIGHWAY RESURFACING  
Mahaikona Bridge to Lele Road  
Federal Aid Project No. STP-050-1(18)

Scale: 1"=40'      Date: Aug, 1995

SHEET No. 3 OF 12 SHEETS

FED. ROAD DIST. NO.	STATE	FED. AID PROJ. NO.	FISCAL YEAR	SHEET NO.	TOTAL SHEETS
HAWAII	HAW.	STP-050-1(18)	1996	23	33

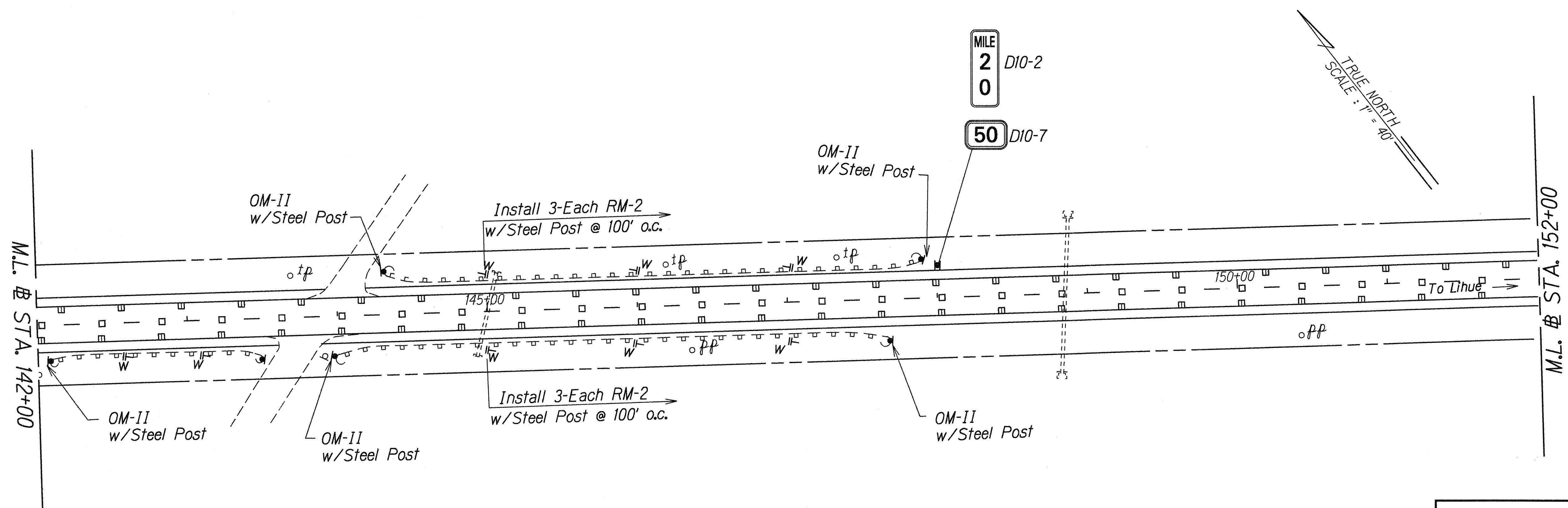
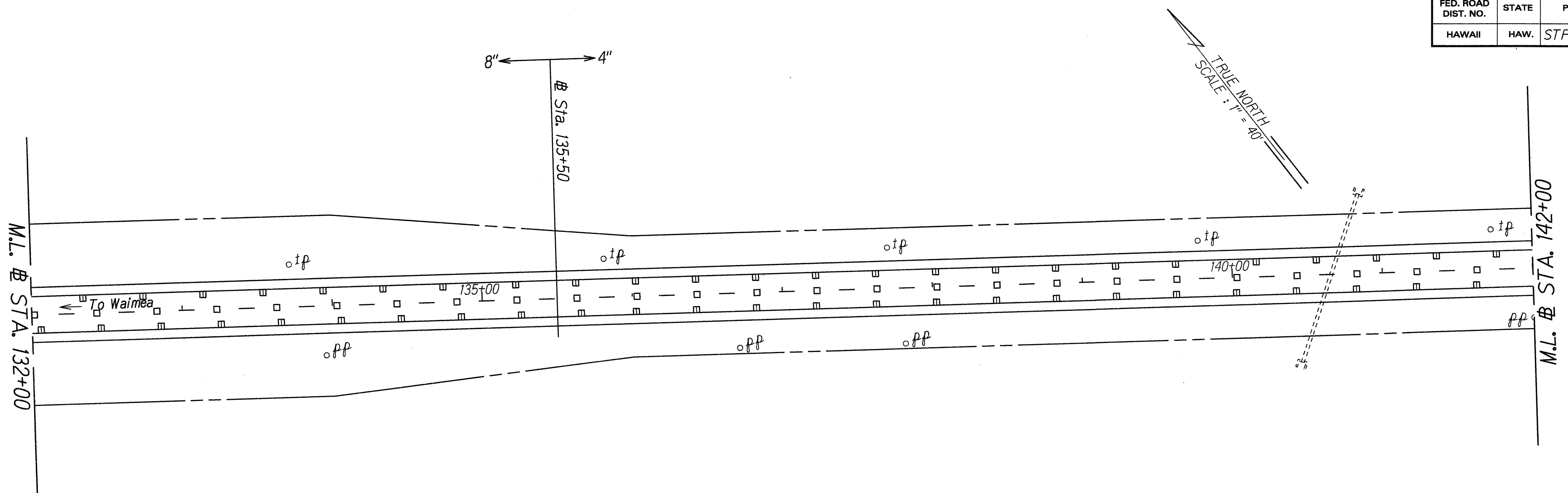

DATE	
SURVEY PLOTTED BY	
DRAWN BY	
TRACED BY	
QUANTITIES BY	
CHECKED BY	
ORIGINAL PLAN	
NOTE BOOK	
KEY	
CHECKED BY	

STATE OF HAWAII  
DEPARTMENT OF TRANSPORTATION  
HIGHWAYS DIVISION

**PAVEMENT MARKING, STRIPING  
& TRAFFIC SIGNING PLAN**

KAUMUALII HIGHWAY RESURFACING  
Mahaikona Bridge to Lele Road  
Federal Aid Project No. STP-050-1(18)

Scale: 1"=40' Date: Aug., 1995

SHEET No. 4 OF 12 SHEETS

FED. ROAD DIST. NO.	STATE	FED. AID PROJ. NO.	FISCAL YEAR	SHEET NO.	TOTAL SHEETS
HAWAII	HAW.	STP-050-1(18)	1996	24	33

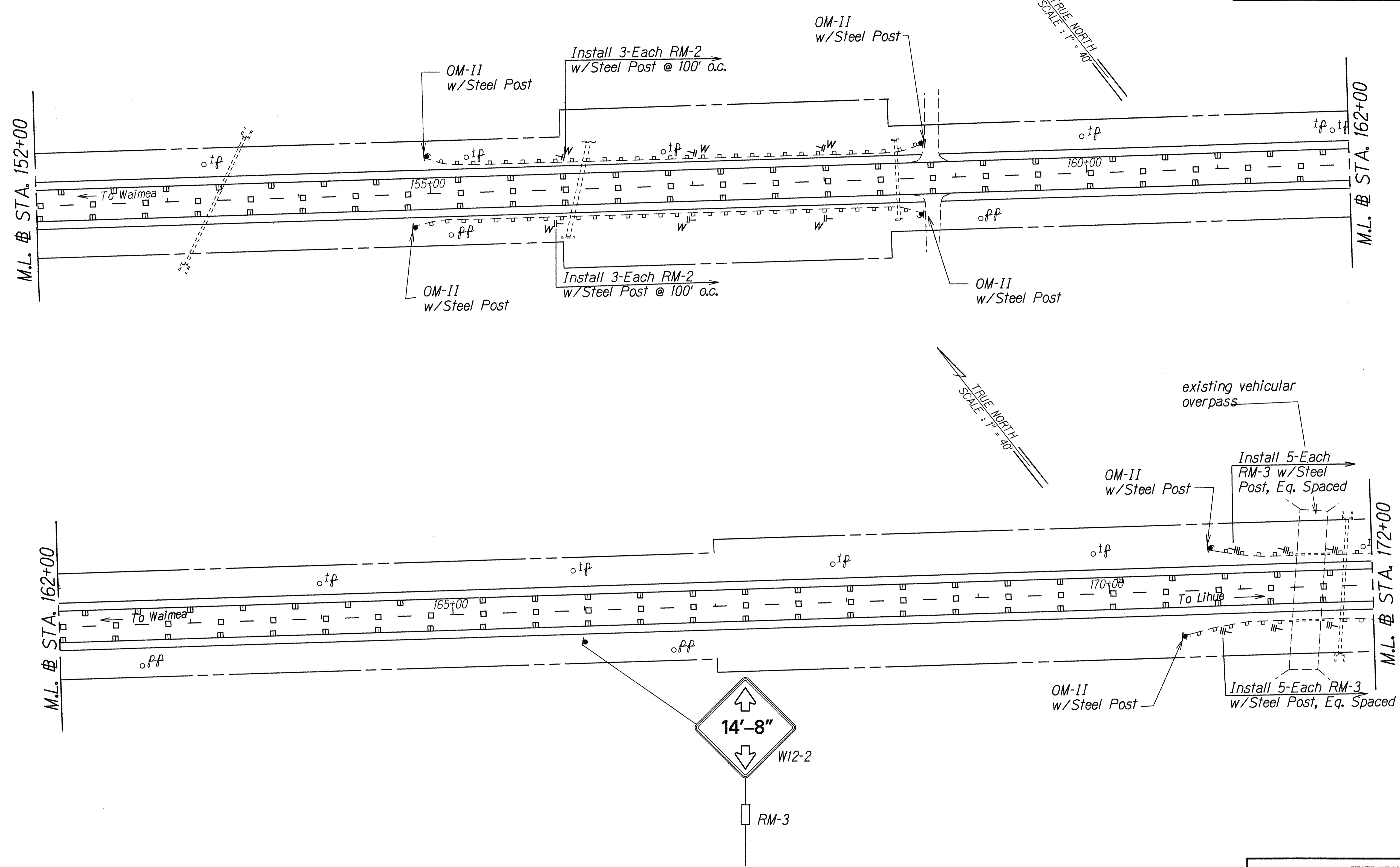

ORIGINAL PLAN  
 SURVEY PLOTTED BY \_\_\_\_\_ DATE \_\_\_\_\_  
 DRAWN BY *S.M. Williams*  
 TRACED BY *S.M. Williams*  
 NOTE BOOK *Kelstone*  
 QUANTITIES BY \_\_\_\_\_  
 CHECKED BY \_\_\_\_\_

STATE OF HAWAII  
 DEPARTMENT OF TRANSPORTATION  
 HIGHWAYS DIVISION  
**PAVEMENT MARKING, STRIPING**  
**TRAFFIC SIGNING PLAN**  
 KAUMUALII HIGHWAY RESURFACING  
 Mahaikona Bridge to Lele Road  
 Federal Aid Project No. STP-050-1(18)  
 Scale: 1"=40' Date: Aug, 1995  
 SHEET No. 5 OF 12 SHEETS

FED. ROAD DIST. NO.	STATE	FED. AID PROJ. NO.	FISCAL YEAR	SHEET NO.	TOTAL SHEETS
HAWAII	HAW.	STP-050-1(18)	1996	25	33

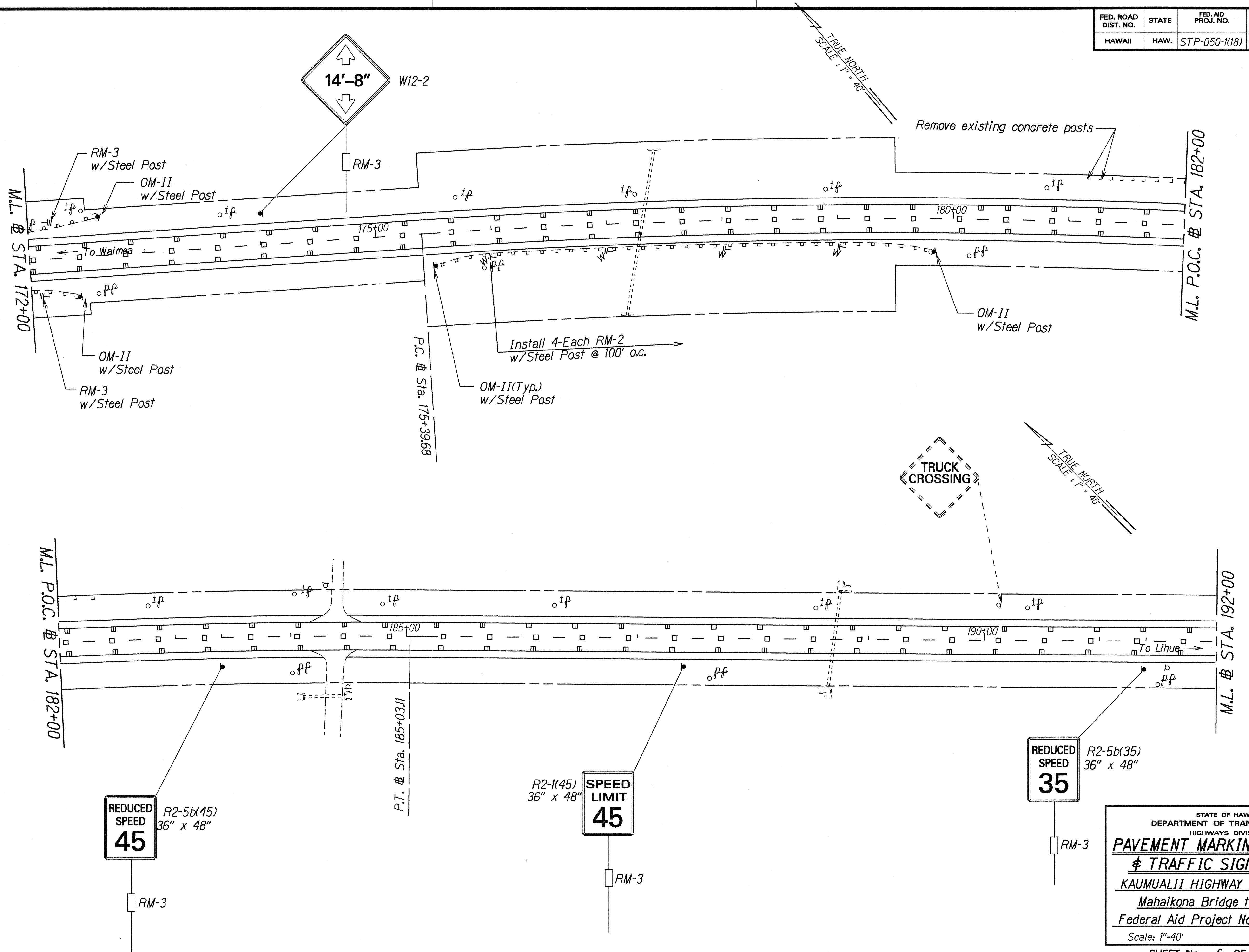

ORIGINAL PLAN	DATE
SURVEY PLOTTED BY	
DRAWN BY	
DESIGNED BY	
QUANTITIES BY	
CHECKED BY	

STATE OF HAWAII  
DEPARTMENT OF TRANSPORTATION  
HIGHWAYS DIVISION  
**PAVEMENT MARKING, STRIPING**  
**TRAFFIC SIGNING PLAN**  
KAUMUALII HIGHWAY RESURFACING  
Mahaikona Bridge to Lele Road  
Federal Aid Project No. STP-050-1(18)  
Scale: 1"=40' Date: Aug, 1995  
SHEET No. 6 OF 12 SHEETS

FED. ROAD DIST. NO.	STATE	FED. AID PROJ. NO.	FISCAL YEAR	SHEET NO.	TOTAL SHEETS
HAWAII	HAW.	STP-050-1(18)	1996	26	33

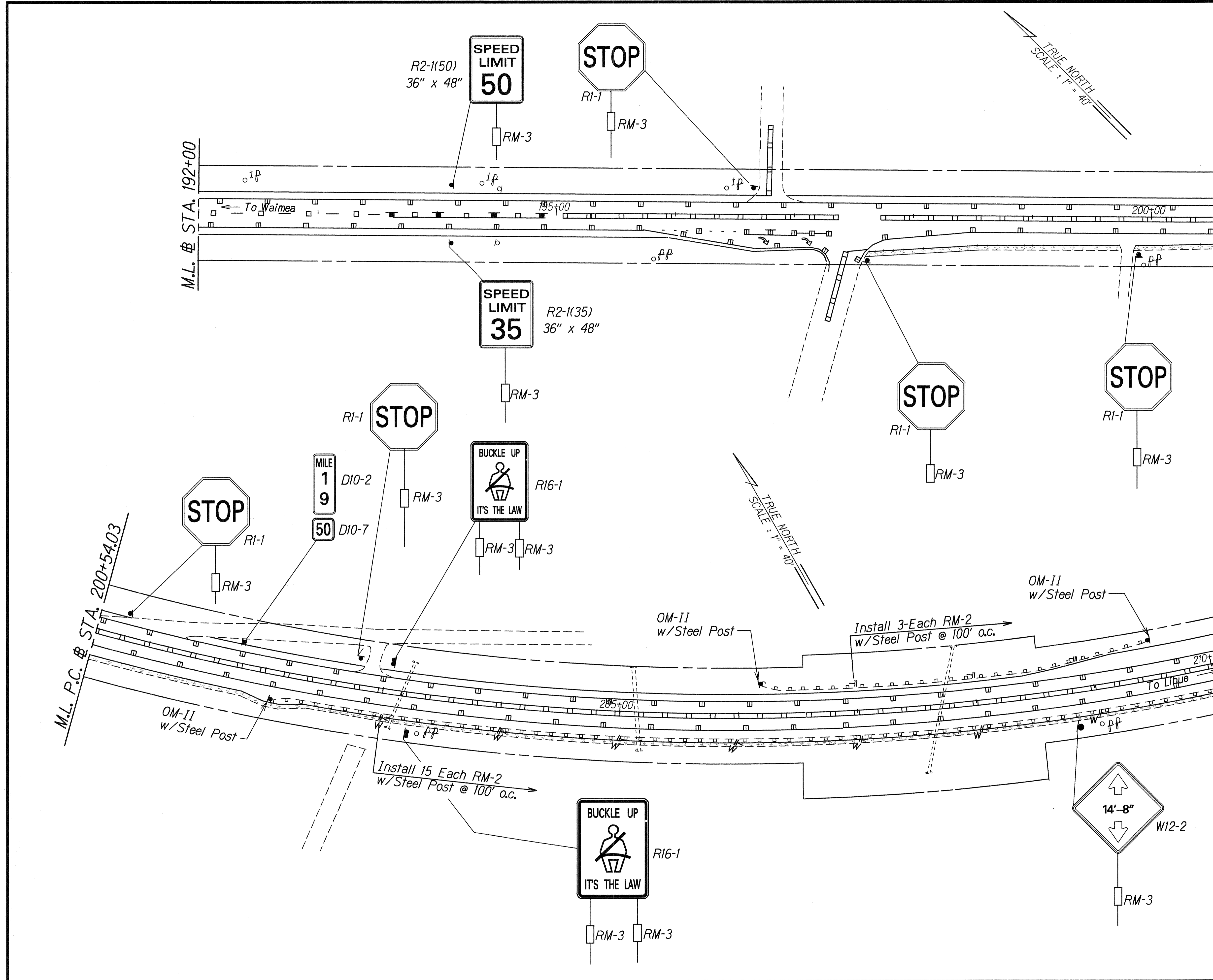

SURVEY PLOTTED BY	DATE
DRAWN BY	
TRACED BY	
NOTE BOOK	
QUANTITIES BY	
CHECKED BY	

STATE OF HAWAII  
DEPARTMENT OF TRANSPORTATION  
HIGHWAYS DIVISION  
**PAVEMENT MARKING, STRIPING**  
**TRAFFIC SIGNING PLAN**  
KAUMUALII HIGHWAY RESURFACING  
Mahaikona Bridge to Lele Road  
Federal Aid Project No. STP-050-1(18)  
Scale: 1"=40' Date: Aug., 1995  
SHEET No. 7 OF 12 SHEETS

FED. ROAD DIST. NO.	STATE	FED. AID PROJ. NO.	FISCAL YEAR	SHEET NO.	TOTAL SHEETS
HAWAII	HAW.	STP-050-1(18)	1996	27	33

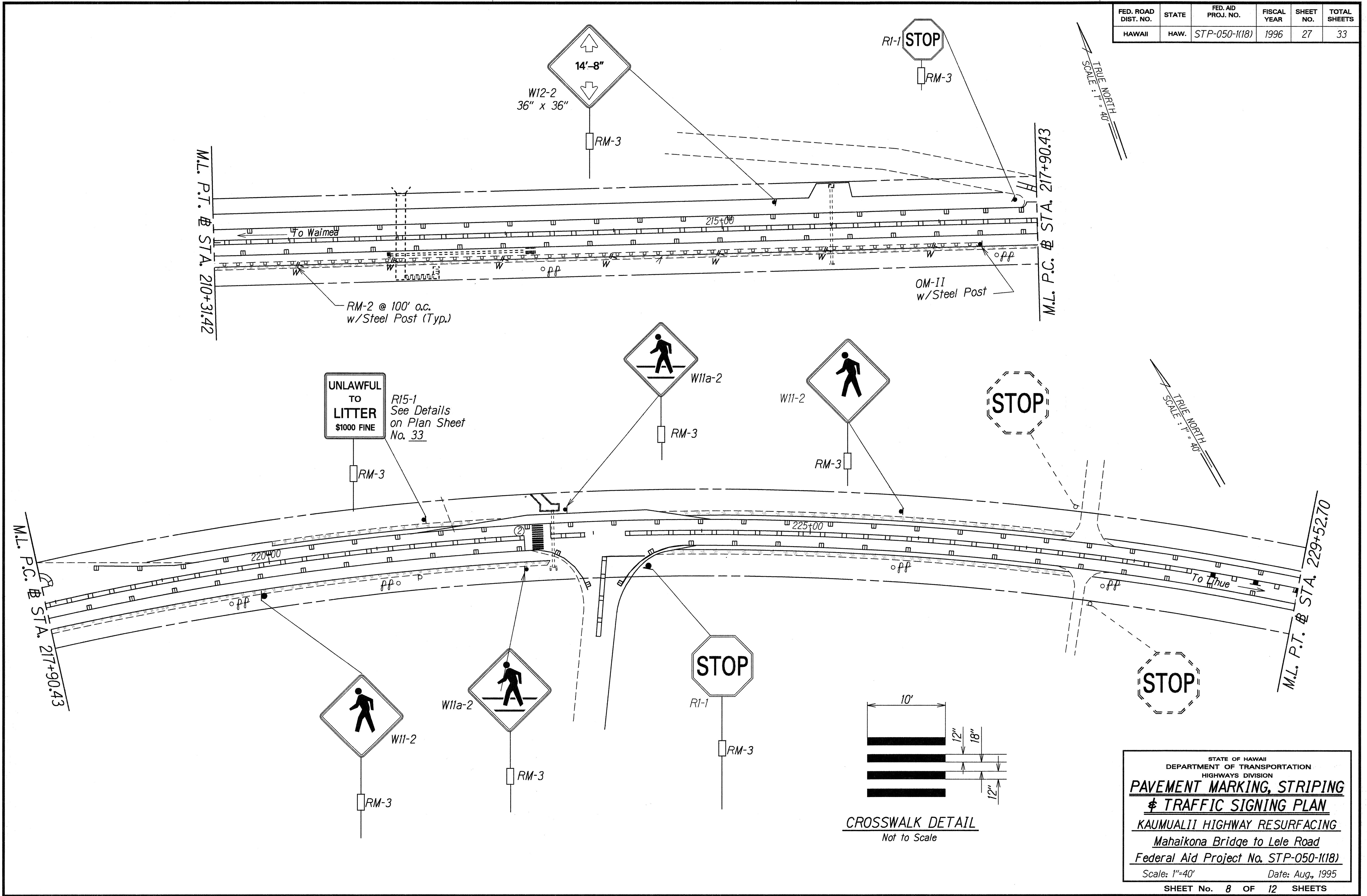

SURVEY PLOTTED BY	DATE
DRAWN BY	
DESIGNED BY	
QUANTITIES BY	
CHECKED BY	
ORIGINAL PLAN	
NOTE BOOK	
Keisuke	
Keisuke	

STATE OF HAWAII  
DEPARTMENT OF TRANSPORTATION  
HIGHWAYS DIVISION

**PAVEMENT MARKING, STRIPING**  
**TRAFFIC SIGNING PLAN**

KAUMUALII HIGHWAY RESURFACING  
Mahaikona Bridge to Lele Road  
Federal Aid Project No. STP-050-1(18)

Scale: 1"=40' Date: Aug, 1995

SHEET No. 8 OF 12 SHEETS

FED. ROAD DIST. NO.	STATE	FED. AID PROJ. NO.	FISCAL YEAR	SHEET NO.	TOTAL SHEETS
HAWAII	HAW.	STP-050-1(18)	1996	28	33

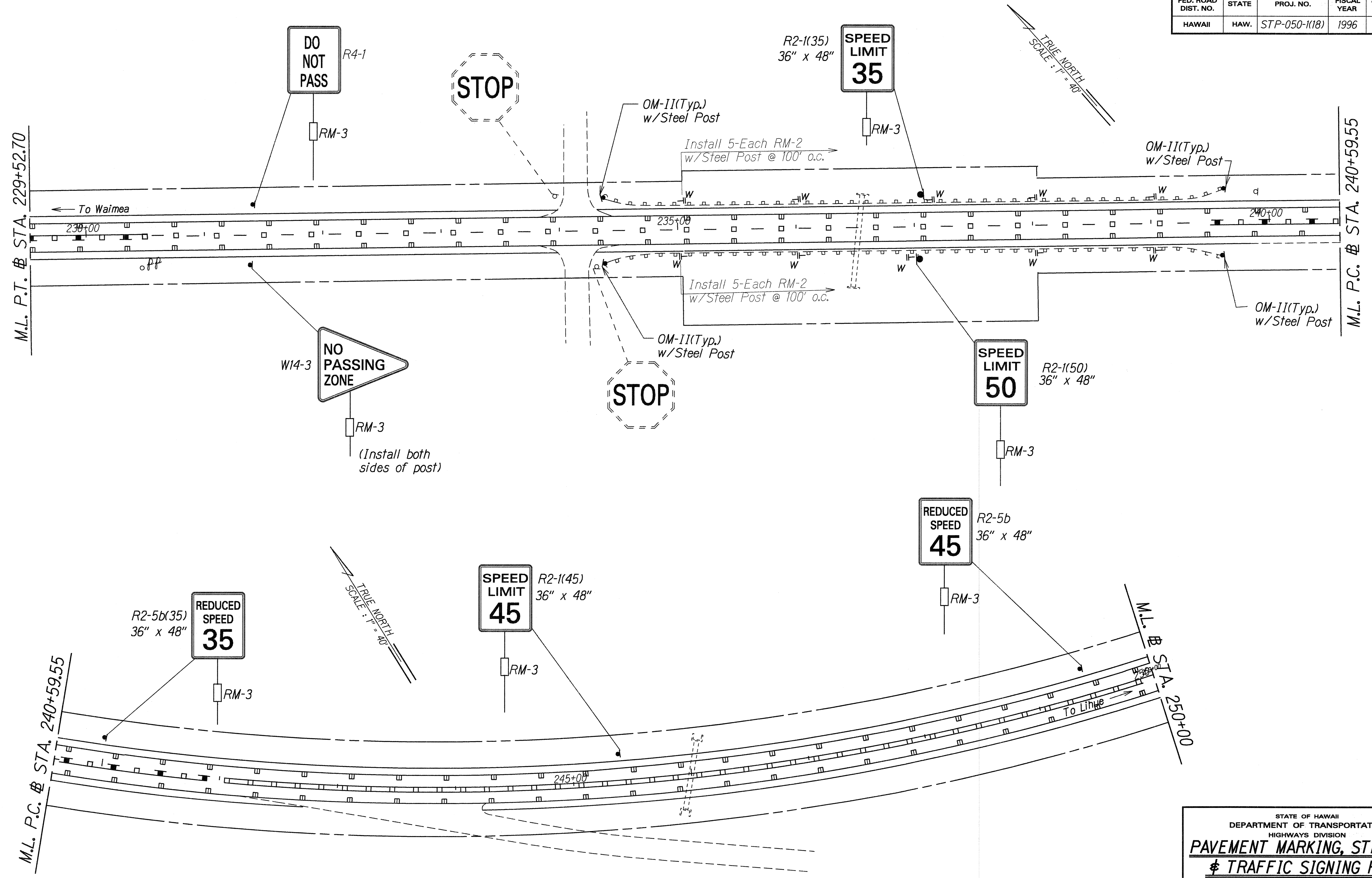

SURVEY PLOTTED BY	DATE
DRAWN BY <i>S. Ochiikawa</i>	X
TRACED BY <i>S. Ochiikawa</i>	
NOTE BOOK	
QUANTITIES BY <i>rel.steve</i>	
CHECKED BY <i>rel.steve</i>	

STATE OF HAWAII  
DEPARTMENT OF TRANSPORTATION  
HIGHWAYS DIVISION

**PAVEMENT MARKING, STRIPING  
& TRAFFIC SIGNING PLAN**

KAUMUALII HIGHWAY RESURFACING  
Mahaikona Bridge to Lele Road  
Federal Aid Project No. STP-050-1(18)

Scale: 1"=40' Date: Aug, 1995

FED. ROAD DIST. NO.	STATE	FED. AID PROJ. NO.	FISCAL YEAR	SHEET NO.	TOTAL SHEETS
HAWAII	HAW.	STP-050-1(18)	1996	29	33

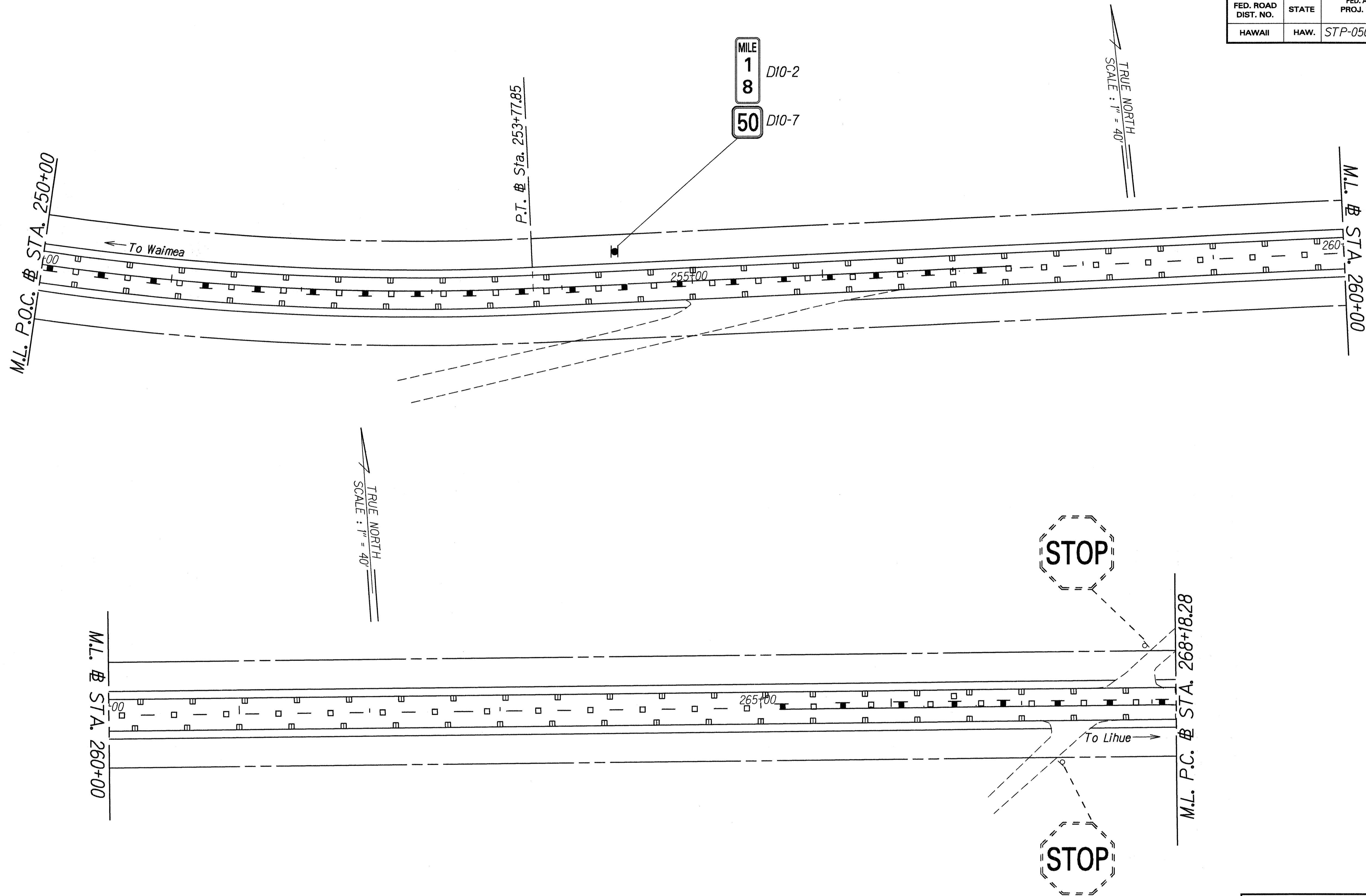

ORIGINAL PLAN	SURVEY PLOTTED BY	DATE
NOTE BOOK	DRAWN BY	
	DESIGNED BY	
	QUANTITIES BY	
	CHECKED BY	

STATE OF HAWAII  
DEPARTMENT OF TRANSPORTATION  
HIGHWAYS DIVISION  
**PAVEMENT MARKING, STRIPING**  
**TRAFFIC SIGNING PLAN**  
KAUMUALII HIGHWAY RESURFACING  
Mahaikona Bridge to Lele Road  
Federal Aid Project No. STP-050-1(18)  
Scale: 1"=40' Date: Aug., 1995

FED. ROAD DIST. NO.	STATE	FED. AID PROJ. NO.	FISCAL YEAR	SHEET NO.	TOTAL SHEETS
HAWAII	HAW.	STP-050-1(18)	1996	30	33

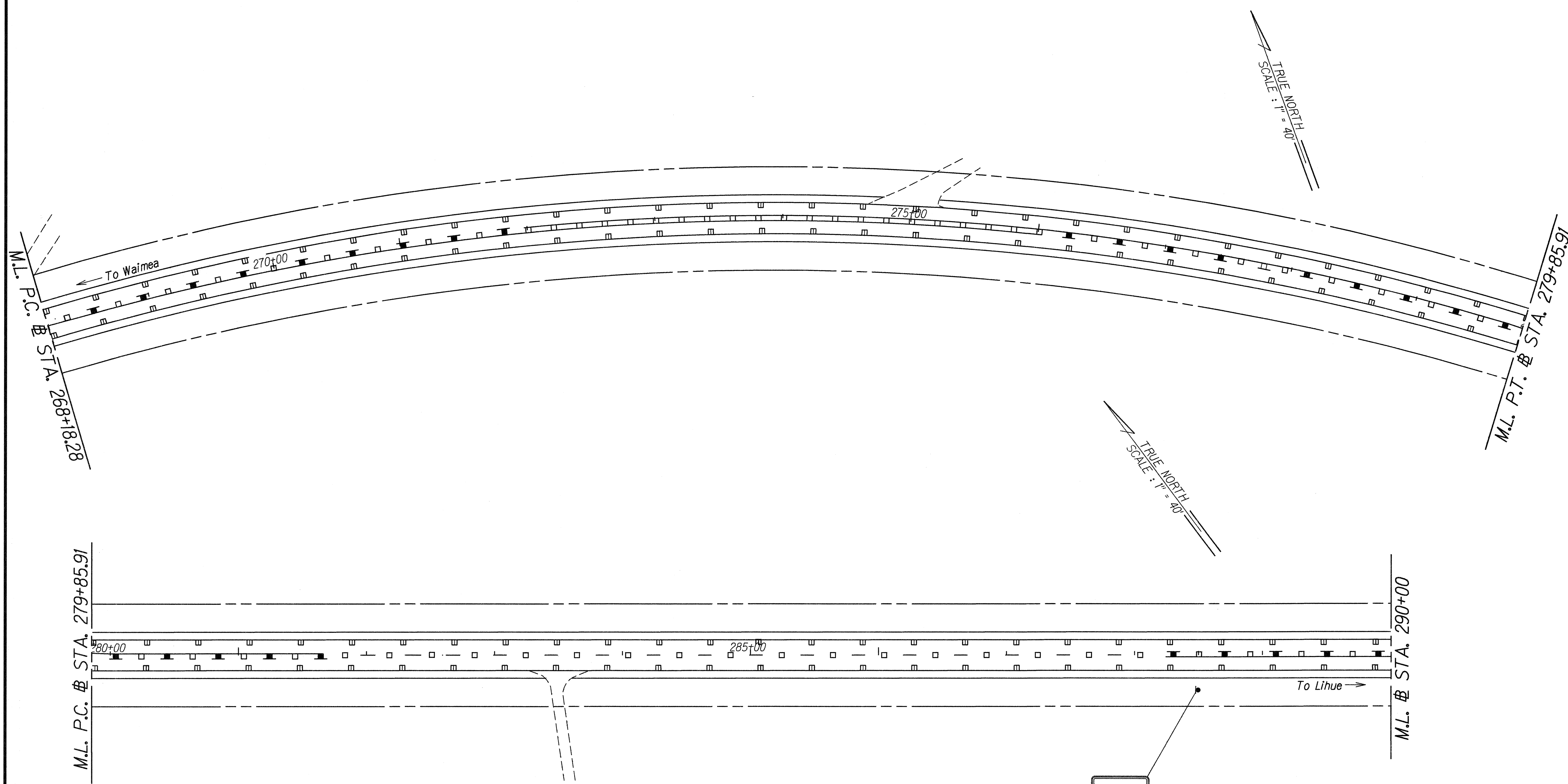

SURVEY PLOTTED BY	DATE
DRAWN BY	
TRACED BY	
NOTE BOOK	
QUANTITIES BY	
CHECKED BY	

REDUCED SPEED  
45  
R2-5b(45)  
36" x 48"

RM-3

STATE OF HAWAII  
DEPARTMENT OF TRANSPORTATION  
HIGHWAYS DIVISION  
**PAVEMENT MARKING, STRIPING  
& TRAFFIC SIGNING PLAN**  
KAUMUALII HIGHWAY RESURFACING  
Mahaikona Bridge to Lele Road  
Federal Aid Project No. STP-050-1(18)  
Scale: 1"=40' Date: Aug., 1995

FED. ROAD DIST. NO.	STATE	FED. AID PROJ. NO.	FISCAL YEAR	SHEET NO.	TOTAL SHEETS
HAWAII	HAW.	STP-050-1(18)	1996	31	33

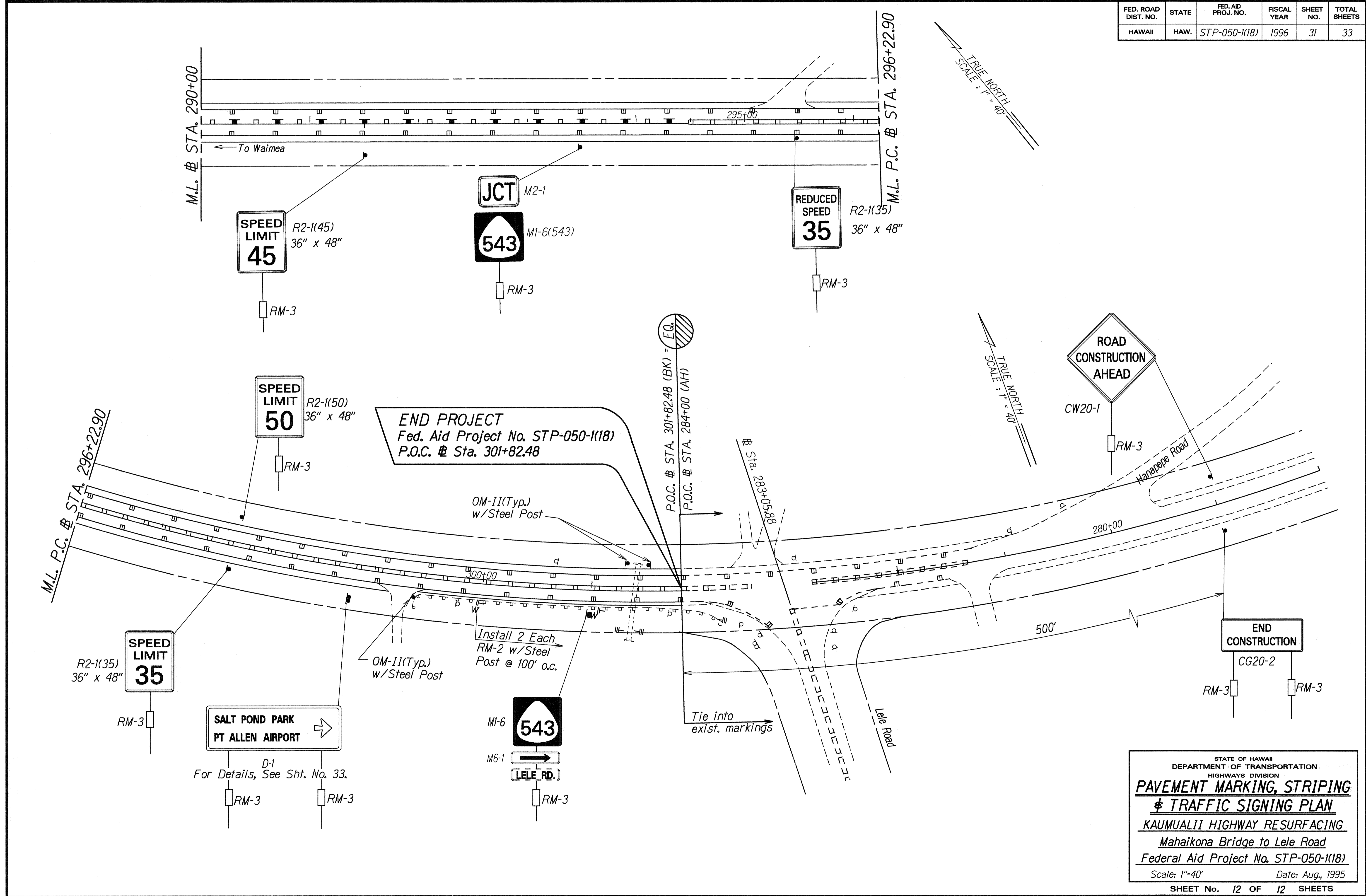

TRUE NORTH  
 SCALE: 1" = 40'

TRUE NORTH  
 SCALE: 1" = 40'

SURVEY PLOTTED BY	DATE
DRAWN BY	
TRACED BY	
NOTE BOOK	
QUANTITIES BY	
CHECKED BY	

STATE OF HAWAII  
 DEPARTMENT OF TRANSPORTATION  
 HIGHWAYS DIVISION

**PAVEMENT MARKING, STRIPING  
 & TRAFFIC SIGNING PLAN**

KAUMUALII HIGHWAY RESURFACING  
 Mahaikona Bridge to Lele Road  
 Federal Aid Project No. STP-050-1(18)

Scale: 1"=40' Date: Aug., 1995

SHEET No. 12 OF 12 SHEETS