

FED. ROAD DIST. NO.	STATE	FED. AID PROJ. NO.	FISCAL YEAR	SHEET NO.	TOTAL SHEETS
HAWAII	HAW.	ER-11(2)	1996	3	5

Curve Data

$\Delta = 41^\circ 51' 00''$
 $R = 1500.00'$
 $T = 573.54'$
 $C = 1071.44'$
 $L_c = 1095.63'$

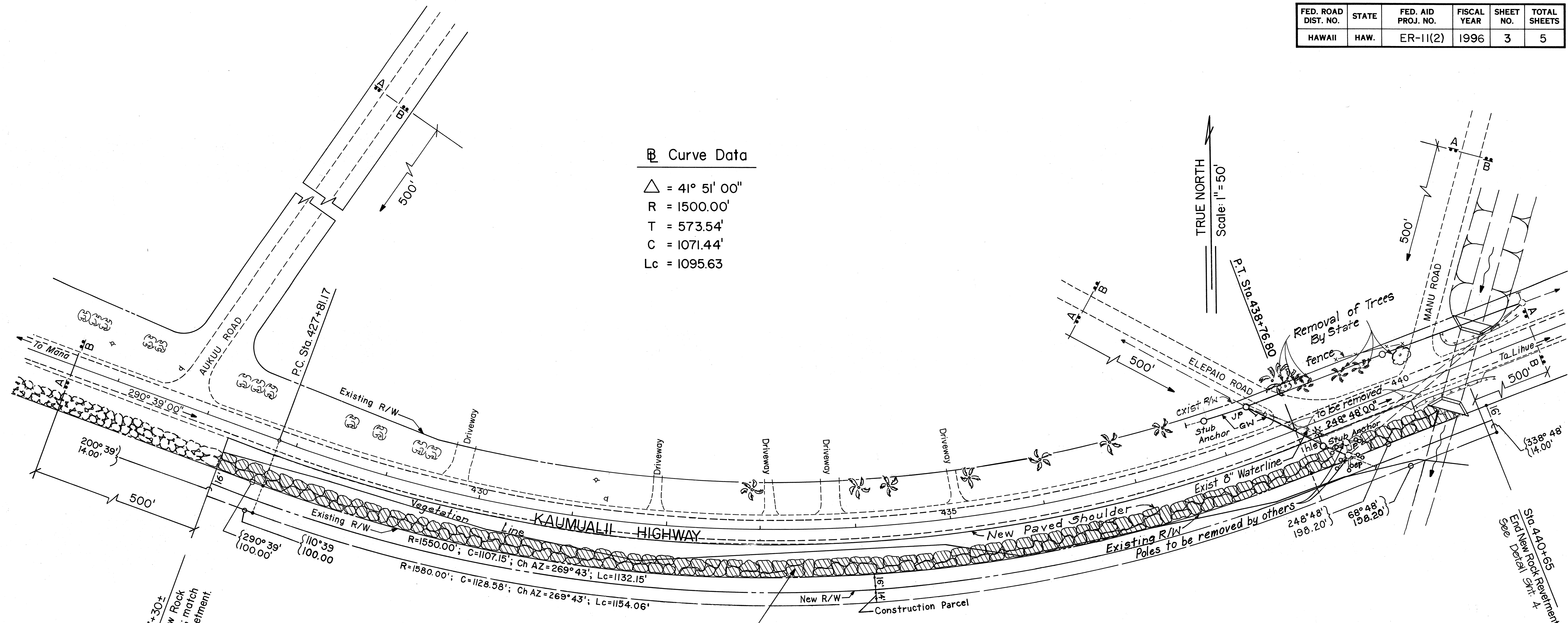

TRUE NORTH
Scale: 1" = 50'

LEGEND

- Coconut Tree
- Ironwood Tree
- New Guy Wire
- New Joint Pole (Hawaiian Telephone and Citizen Electric Company)
- Existing guy wire and anchor
- New 45' Stub Anchor Pole
- Existing joint pole (to be removed by others)
- Existing pole
- Highway Lighting Standard

SIGN LEGEND:

- A Install New Sign W/ Posts CW 20-1d
- B Install New Sign W/ Posts CG 20-2

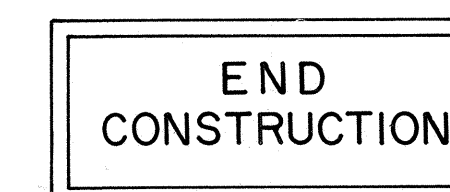

STATE OF HAWAII
DEPARTMENT OF TRANSPORTATION
HIGHWAYS DIVISION

PLAN

KAUMUALII HIGHWAY
ROCK REVETMENT AT KEKAHA

F.A. PROJECT NO. ER-11(2)

SCALE: 1" = 50' DATE: MAR. 1996

SHEET No. 1 OF 1 SHEETS

SURVEY PLOTTED BY	DATE
DRAWN BY	
DESIGNED BY	
QUANTITIES BY	
CHECKED BY	
ORIGINAL PLAN	
NOTE BOOK	
No.	