

FED. ROAD DIST. NO.	STATE	PROJ. NO.	FISCAL YEAR	SHEET NO.	TOTAL SHEETS
HAWAII	HAW.	HWY-K-01-91M	1991	7	11

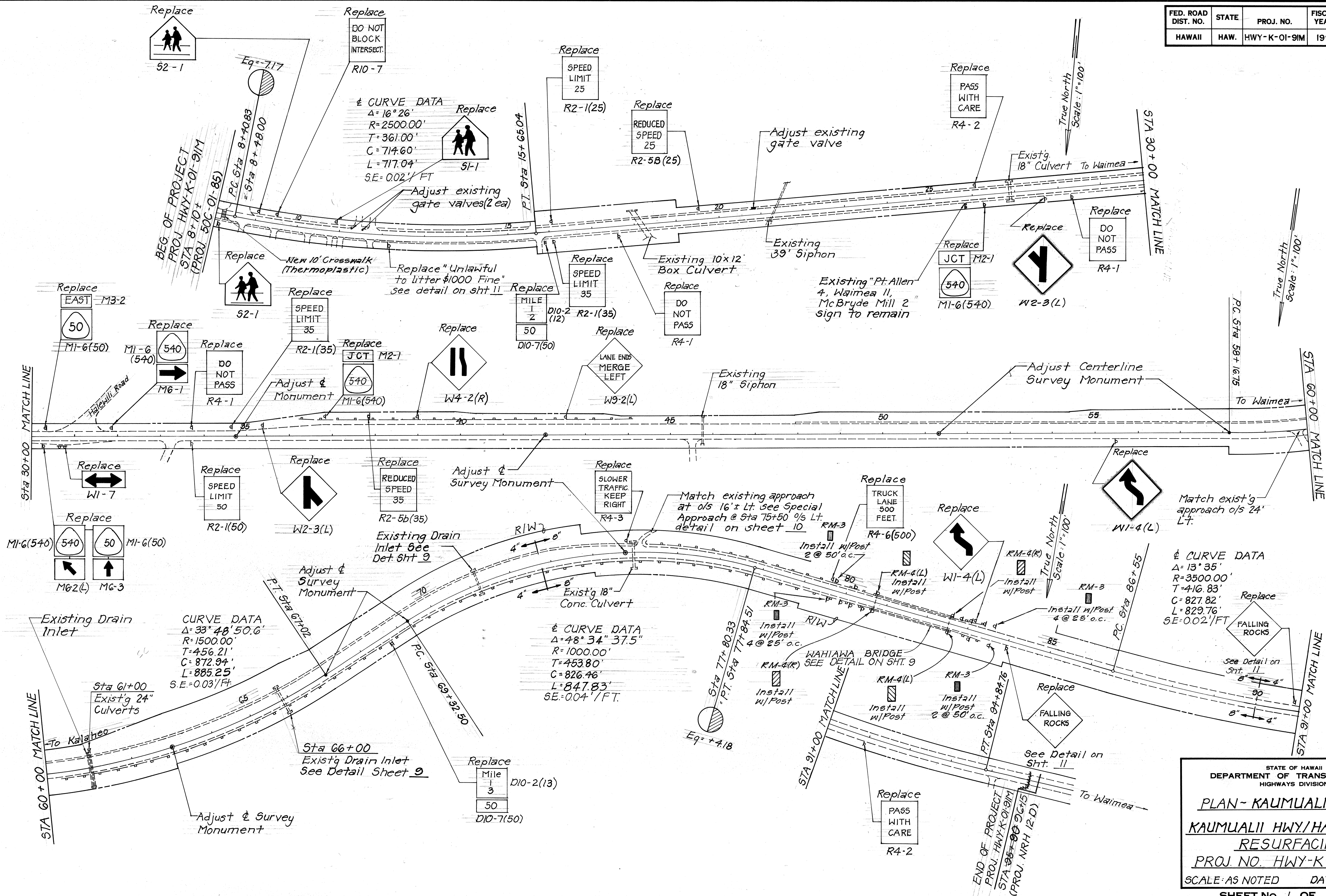

DATE	_____
DESIGNED BY	_____
CHECKED BY	_____
NO.	_____

STATE OF HAWAII
DEPARTMENT OF TRANSPORTATION
HIGHWAYS DIVISION

PLAN - KAUMUALII HWY.

KAUMUALII HWY./HALEWILI RD.

RESURFACING

PROJ. NO. HWY-K-01-91M

SCALE: AS NOTED DATE: SEP. 1990

SHEET No. 1 OF 2 SHEETS

FED. ROAD DIST. NO.	STATE	PROJ. NO.	FISCAL YEAR	SHEET NO.	TOTAL SHEETS
HAWAII	HAW.	HWY-K-01-91M	1991	8	11

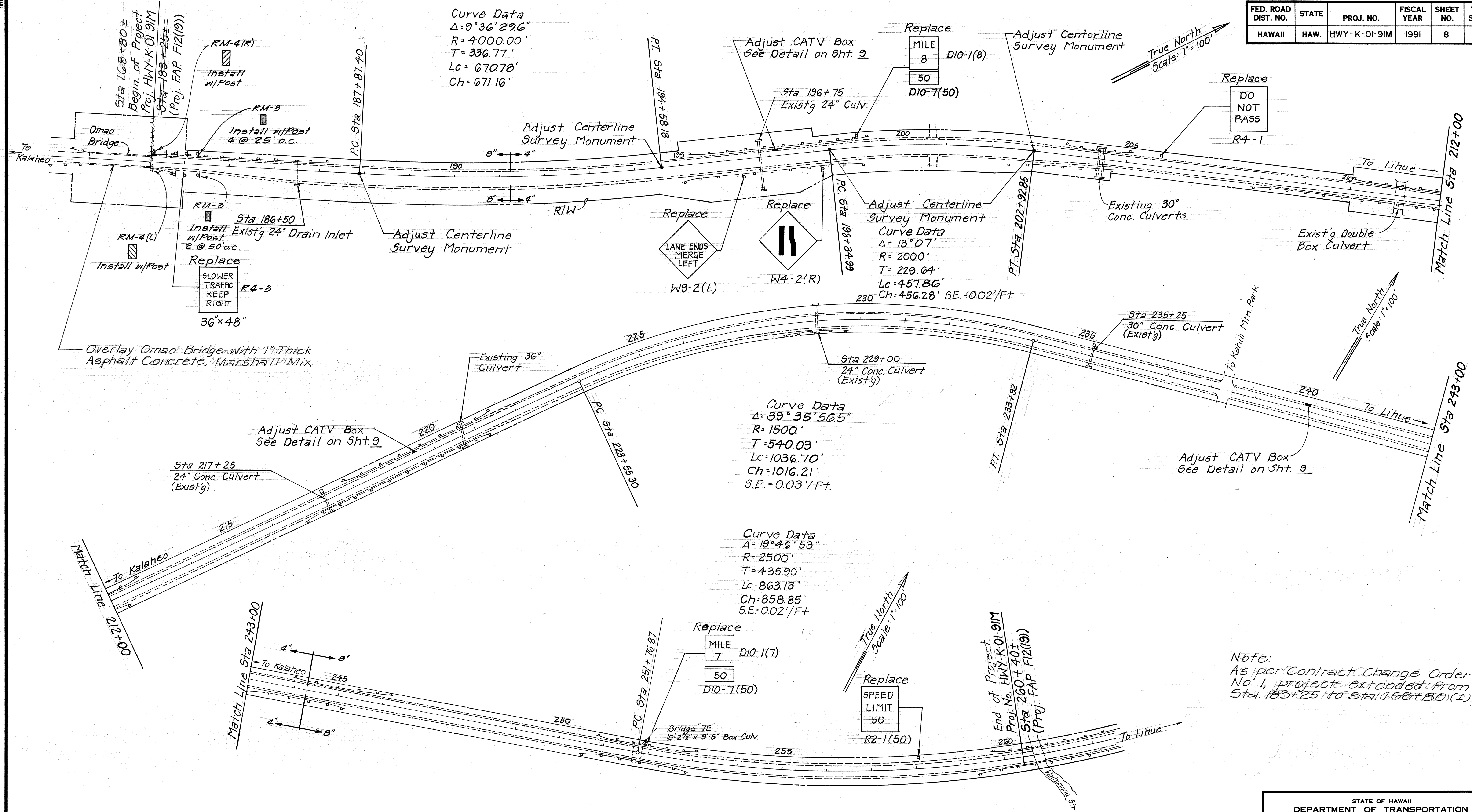

Note:
As per Contract Change Order
No. 1, project extended from
Sta. 163+25 to Sta. 168+80 (+)

ORIGINAL PLAN	DATE
DRAWN BY	
DESIGNED BY	
NOTED BY	
CHECKED BY	

STATE OF HAWAII
DEPARTMENT OF TRANSPORTATION
HIGHWAYS DIVISION

PLAN - KAUMUALII HWY.
KAUMUALII HWY/HALEWILI RD.
RESURFACING
PROJ. NO. HWY.-K-01-91M
SCALE: AS NOTED DATE: SEP. 1990
SHEET No. 2 OF 2 SHEETS