

FED. ROAD DIST. NO.	STATE	FED. AID PROJ. NO.	FISCAL YEAR	SHEET NO.	TOTAL SHEETS
HAWAII	HAW.	ARR-050-1(036)	FY13/14	Model	141

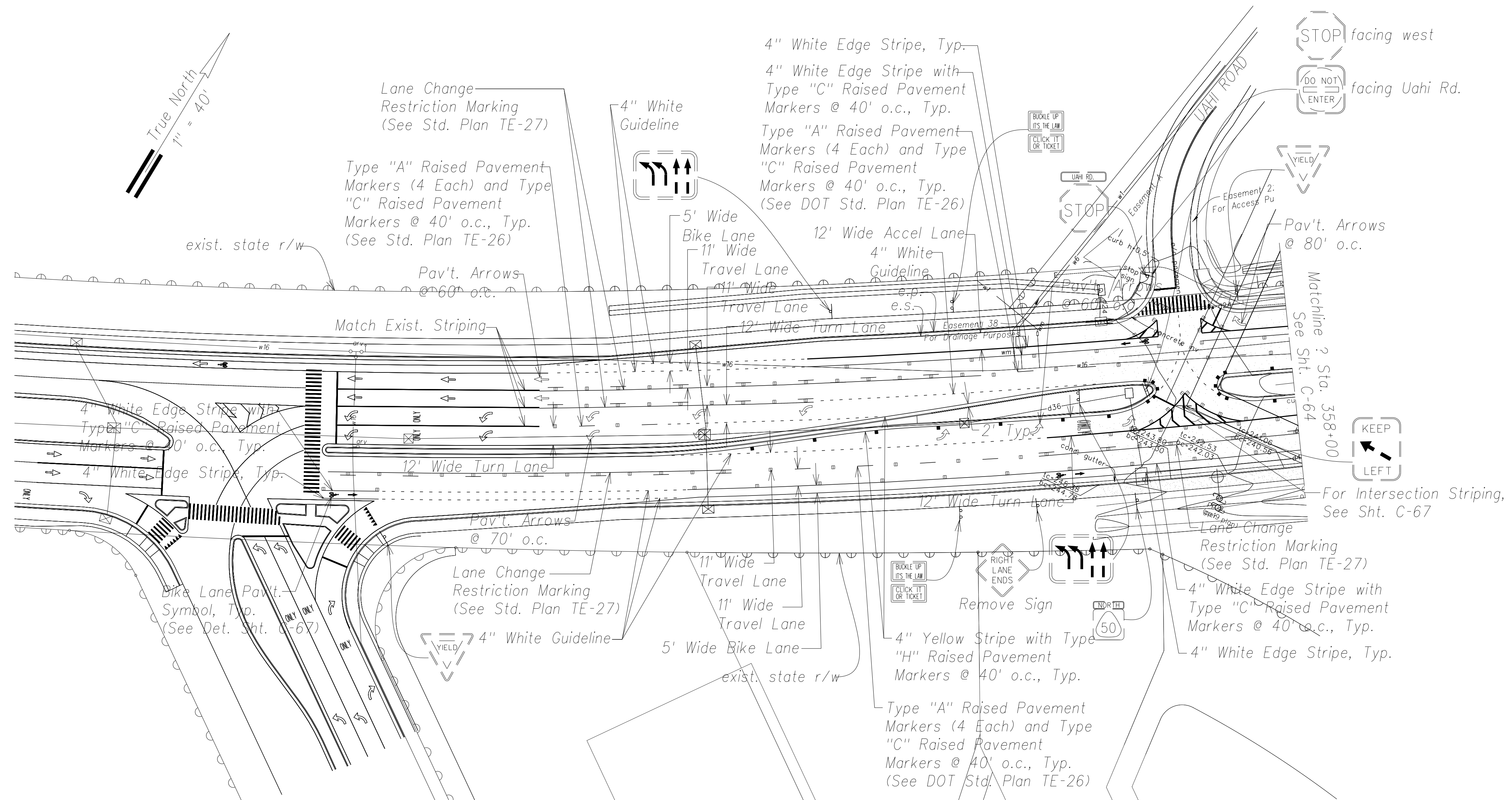

Signing and Pavement Marking Plan - (Nawiliwili Road To Sta. 358+00)  
Scale: 1" = 40'

SURVEY PLOTTED BY	DATE
DRAWN BY	
TRACED BY	
DESIGNED BY	
CHECKED BY	
ORIGINAL PLAN	No.
NOTE BOOK	



THIS WORK WAS PREPARED BY ME OR UNDER MY SUPERVISION AND CONSTRUCTION OF THIS PROJECT WILL BE UNDER MY OBSERVATION.

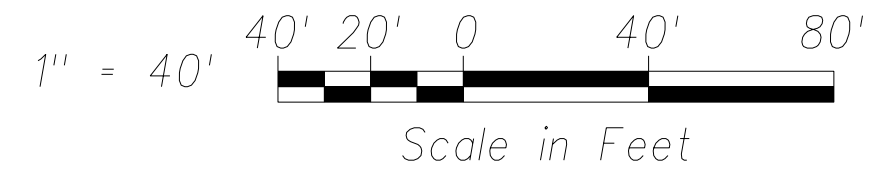

April 30, 2016  
EXPIRATION DATE OF THE LICENSE  
SIGNATURE

STATE OF HAWAII  
DEPARTMENT OF TRANSPORTATION  
HIGHWAYS DIVISION

**SIGNING AND PAVEMENT MARKING PLAN**  
(Nawiliwili Road To Sta. 358+00)

PHASE 1 - KAUMUALII HIGHWAY  
LIHUE MILL BRIDGE TO RICE STREET

PHASE 3 - REHABILITATION OF LIHUE MILL  
BRIDGE AND MAKAI WIDENING

Scale: As Shown Date: May 2, 2014  
SHEET No. C-63 OF 82 SHEETS

"AS-BUILT"

MODEL

FED. ROAD DIST. NO.	STATE	FED. AID PROJ. NO.	FISCAL YEAR	SHEET NO.	TOTAL SHEETS
HAWAII	HAW.	ARR-050-10036	FY13/14	Model	141

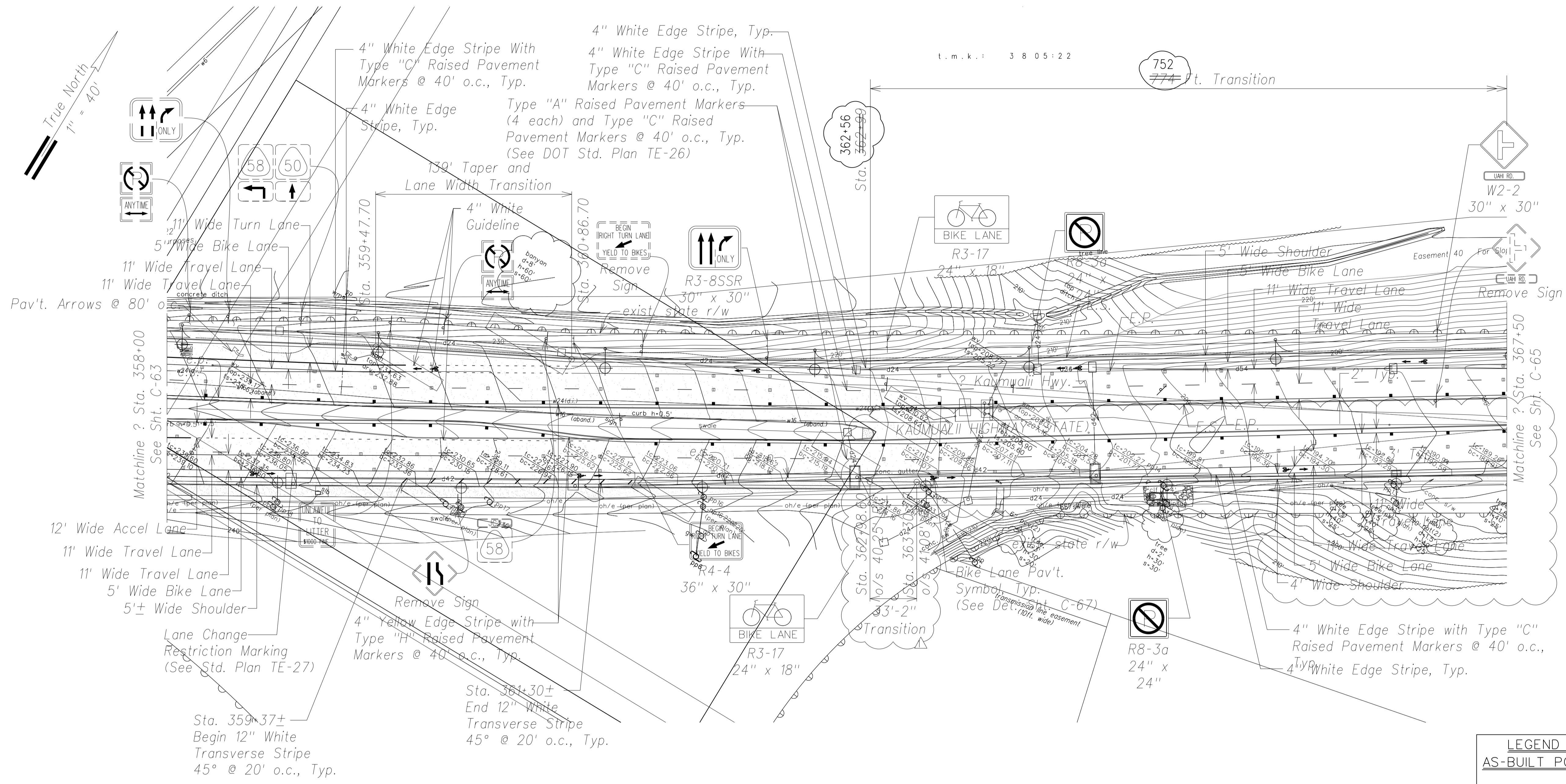

Signing and Pavement Marking Plan - (Sta. 358+00 To Sta. 367+50)  
Scale: 1" = 40'

SURVEY PLOTTED BY	DATE
DRAWN BY	
TRACED BY	
QUANTITIES BY	
CHECKED BY	
ORIGINAL PLAN	
NOTE BOOK	
No.	

LEGEND FOR AS-BUILT POSTINGS	
	Squiggly line for as-built deletion
	Double line for as-built deletion
	Text for as-built posting

Date	Revision
4/6/15	Revise pavement striping posting



THIS WORK WAS PREPARED BY ME OR UNDER MY SUPERVISION AND CONSTRUCTION OF THIS PROJECT WILL BE UNDER MY OBSERVATION.

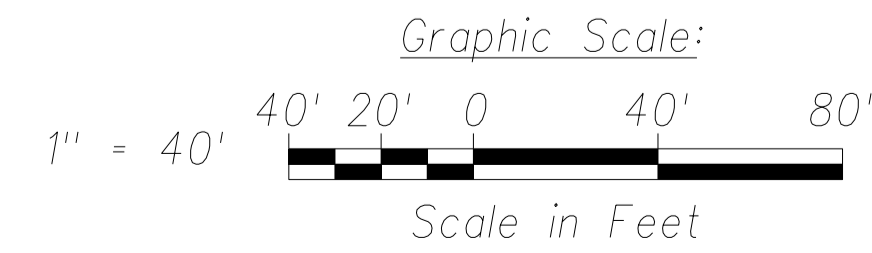

SIGNATURE \_\_\_\_\_  
EXPIRATION DATE OF THE LICENSE April 30, 2016

STATE OF HAWAII  
DEPARTMENT OF TRANSPORTATION  
HIGHWAYS DIVISION

PAVEMENT MARKING PLAN  
(Sta. 358+00 To Sta. 367+50)

PHASE 1 - KAUMUALII HIGHWAY  
LIHUE MILL BRIDGE TO RICE STREET

PHASE 3 - REHABILITATION OF LIHUE MILL  
BRIDGE AND MAKAI WIDENING

Scale: As Shown Date: May 2, 2014  
SHEET No. C-64 OF 82 SHEETS

"AS-BUILT"

CMODEL S1

FILE: C:\Users\leap\Desktop\0\mcp1.dwg saved April 7, 2016

FED. ROAD DIST. NO.	STATE	FED. AID PROJ. NO.	FISCAL YEAR	SHEET NO.	TOTAL SHEETS
HAWAII	HAW.	ARR-050-1(036)	FY13/14	Model	141

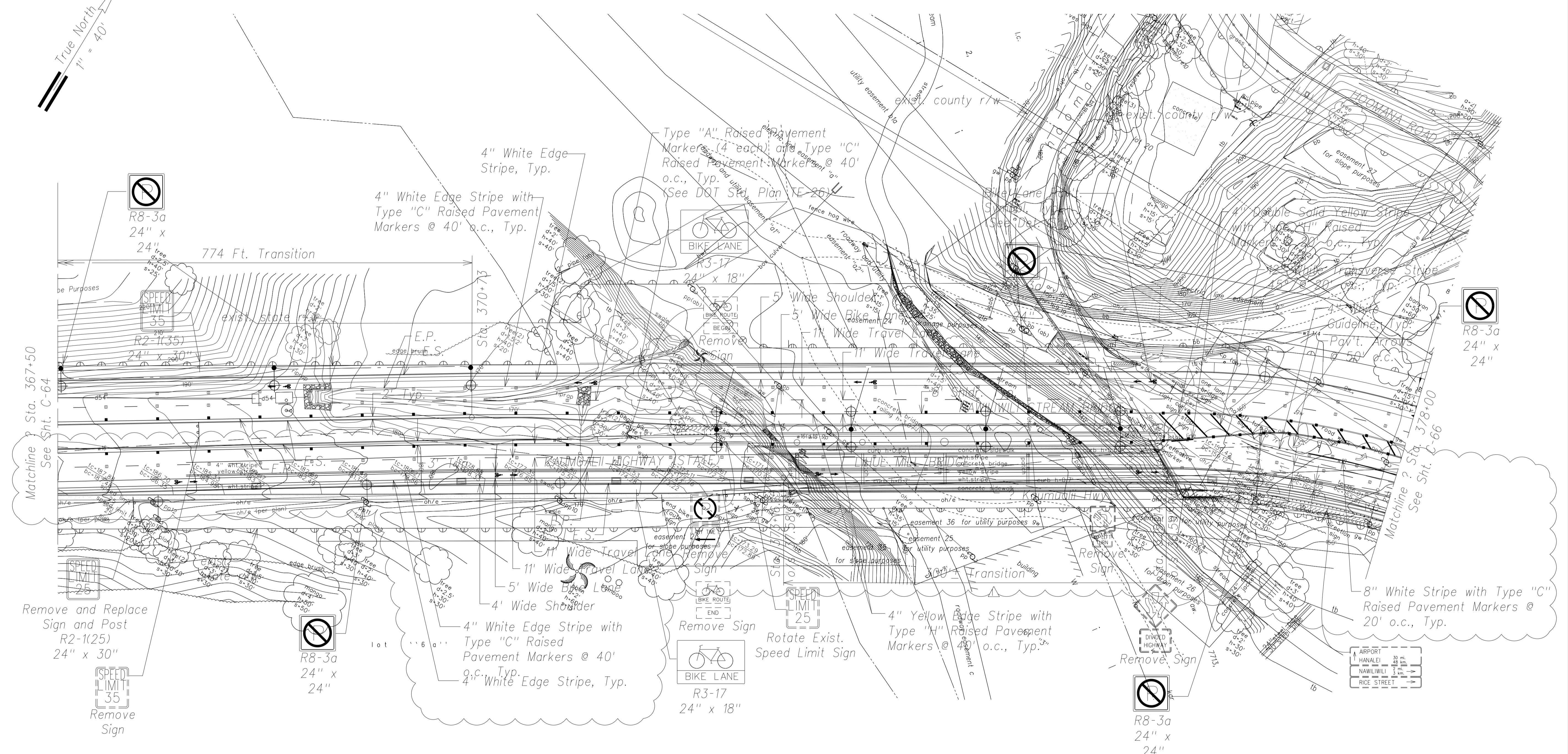
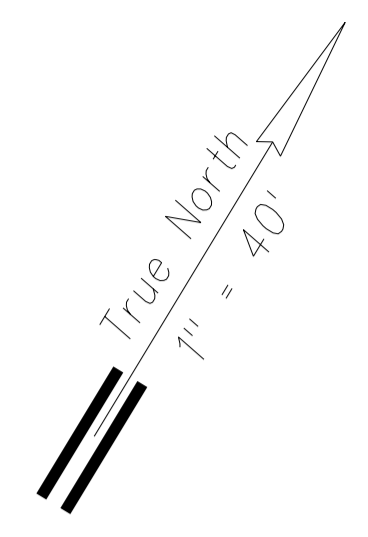

Signing and Paving Marking Plan - (Sta. 367+50 To Sta. 378+00)  
Scale: 1" = 40'

ORIGINAL PLAN	DATE
TRACED BY	
DESIGNED BY	
QUANTITIES BY	
CHECKED BY	

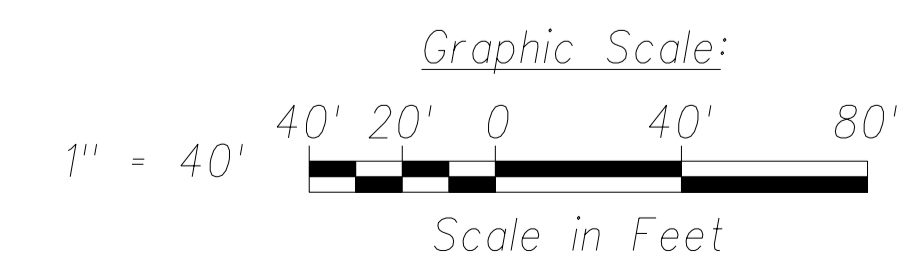

THIS WORK WAS PREPARED BY ME OR UNDER MY SUPERVISION AND CONSTRUCTION OF THIS PROJECT WILL BE UNDER MY OBSERVATION.  
SIGNATURE \_\_\_\_\_  
EXPIRATION DATE OF THE LICENSE April 30, 2016

4/6/15 Revise for additional PCC pav't. and revise striping  
Date Revision

STATE OF HAWAII  
DEPARTMENT OF TRANSPORTATION  
HIGHWAYS DIVISION

**SIGNING AND PAVEMENT MARKING PLAN**  
(Sta. 367+50 To Sta. 378+00)

PHASE 1 - KAUMUALII HIGHWAY  
LIHUE MILL BRIDGE TO RICE STREET

PHASE 3 - REHABILITATION OF LIHUE MILL  
BRIDGE AND MAKAI WIDENING

Scale: As Shown Date: May 2, 2014  
SHEET No. C-65 OF 82 SHEETS

"AS-BUILT"

MODEL S1

FED. ROAD DIST. NO.	STATE	FED. AID PROJ. NO.	FISCAL YEAR	SHEET NO.	TOTAL SHEETS
HAWAII	HAW.	ARR-050-1036	FY13/14	Model	141

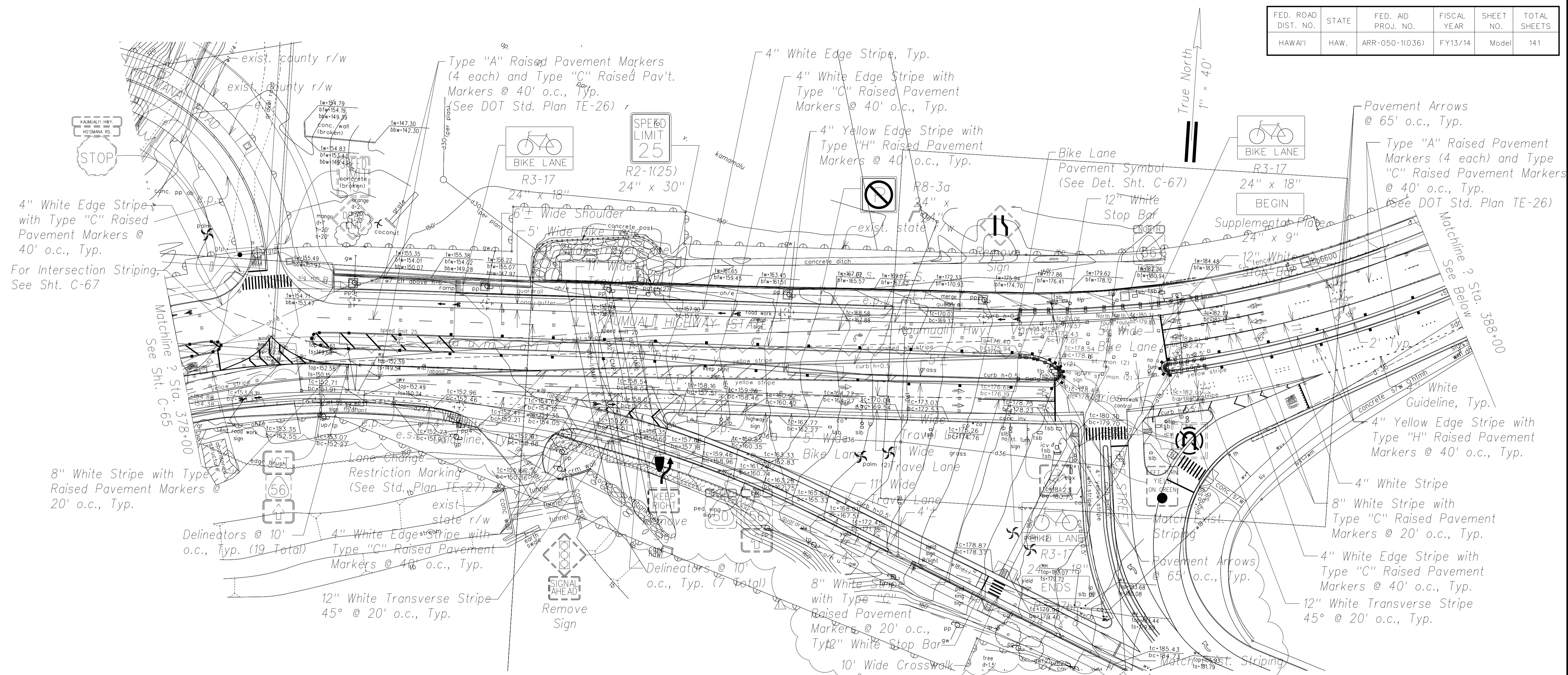

Signing and Pavement Marking Plan - (Sta. 378+00 To Sta. 388+00)  
Scale: 1" = 40'

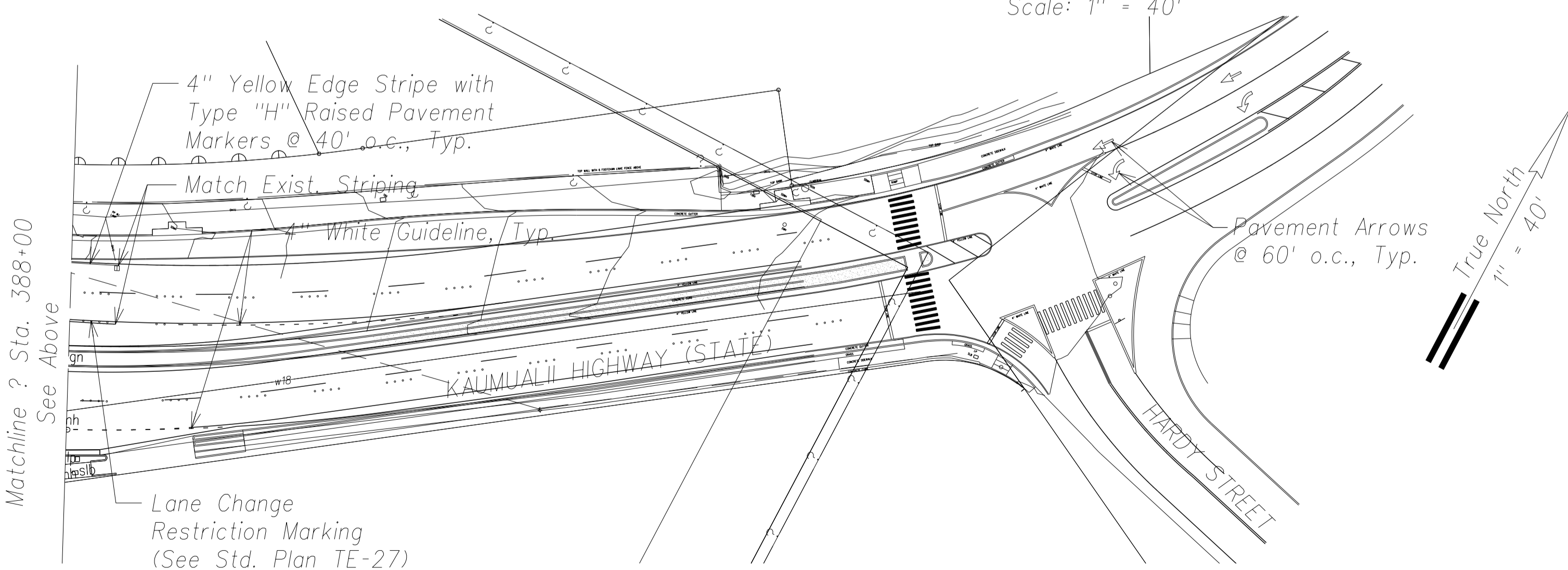

Signing and Pavement Marking Plan - (Sta. 388+00 To Hardy Street)  
Scale: 1" = 40'

SURVEY PLOTTED BY	DATE
DRAWN BY	
DESIGNED BY	
CHECKED BY	
NOTE BOOK	
No.	

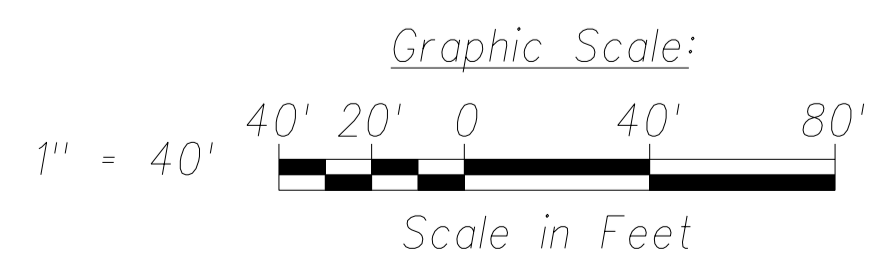

THIS WORK WAS PREPARED BY ME OR UNDER MY SUPERVISION AND CONSTRUCTION OF THIS PROJECT WILL BE UNDER MY OBSERVATION.

Signature: \_\_\_\_\_  
April 30, 2016  
EXPIRATION DATE OF THE LICENSE

4/6/15 Revise for additional PCC pavement and sidewalk work  
Date Revision

STATE OF HAWAII  
DEPARTMENT OF TRANSPORTATION  
HIGHWAYS DIVISION  
**SIGNING AND PAVEMENT MARKING PLAN**  
PHASE 1 - KAUMUALII HIGHWAY  
LIHUE MILL BRIDGE TO RICE STREET  
PHASE 3 - REHABILITATION OF LIHUE MILL BRIDGE AND MAKAI WIDENING

Scale: As Shown Date: May 2, 2014  
SHEET No. C-66 OF 82 SHEETS

"AS-BUILT"

CMODEL S1