

FED. ROAD DIST. NO.	STATE	FED. AID PROJ. NO.	FISCAL YEAR	SHEET NO.	TOTAL SHEETS
HAWAII	HAW.	ARR-050-1(036)	FY13/14	50	50

Notes:

1. A minimum of 3-feet of cover shall be maintained at all times.

2. Backfill material shall be sand only; water

jetted to within 12" of finished grade.

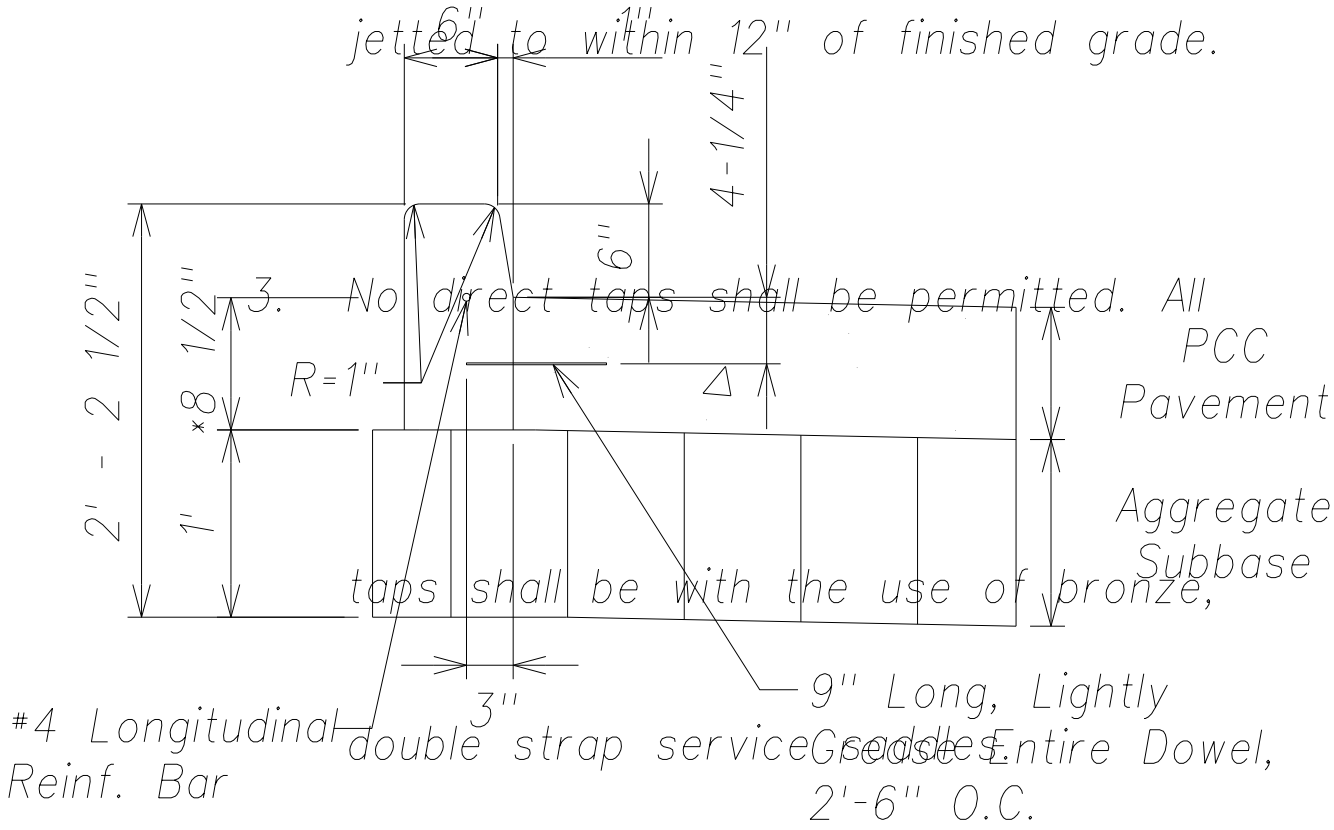

3. No direct taps shall be permitted. All PCC Pavement Aggregate Subbase tops shall be with the use of bronze, #4 Longitudinal Reinf. Bar double strap service grade. Entire Dowel, 2'-6" O.C.

Note:

*12" at Curb All other conditions for pipeline Cast-In-Place Concrete Curb to remain as specified.

APPROVED BY:

COUNTY ENGINEER, DEPARTMENT OF PUBLIC WORKS, COUNTY OF HAWAII, (FOR WORK IN THE COUNTY RIGHT-OF-WAY)

MANAGER AND CHIEF ENGINEER, DEPARTMENT OF WATER, COUNTY OF KAUAI, DATE

reducers, etc. with PVC ends or MJ ends.

Graphic Scale:

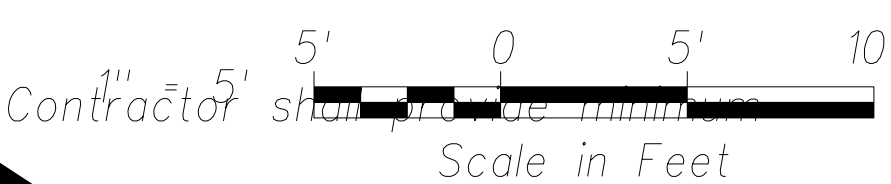

THIS WORK WAS PREPARED BY ME OR UNDER MY SUPERVISION AND CONSTRUCTION OF THIS PROJECT WILL BE UNDER MY OBSERVATION.

SIGNATURE: Michael H. Okamoto
EXPIRATION DATE OF THE LICENSE: April 30, 2014

STATE OF HAWAII
DEPARTMENT OF TRANSPORTATION
LIHU'E MILL BRIDGE TO THE STREET
PHASE 1 - HO'OMANA ROAD

MISCELLANEOUS DETAILS

the existing pavement structure for
PHASE 1 - KAUMOA HIGHWAY
LIHU'E MILL BRIDGE TO THE STREET
PHASE 1 - HO'OMANA ROAD
trench restoration of existing pavement in
Scale: As Shown
Date: December 12, 2013

SHEET No. C-32 OF 50 SHEETS

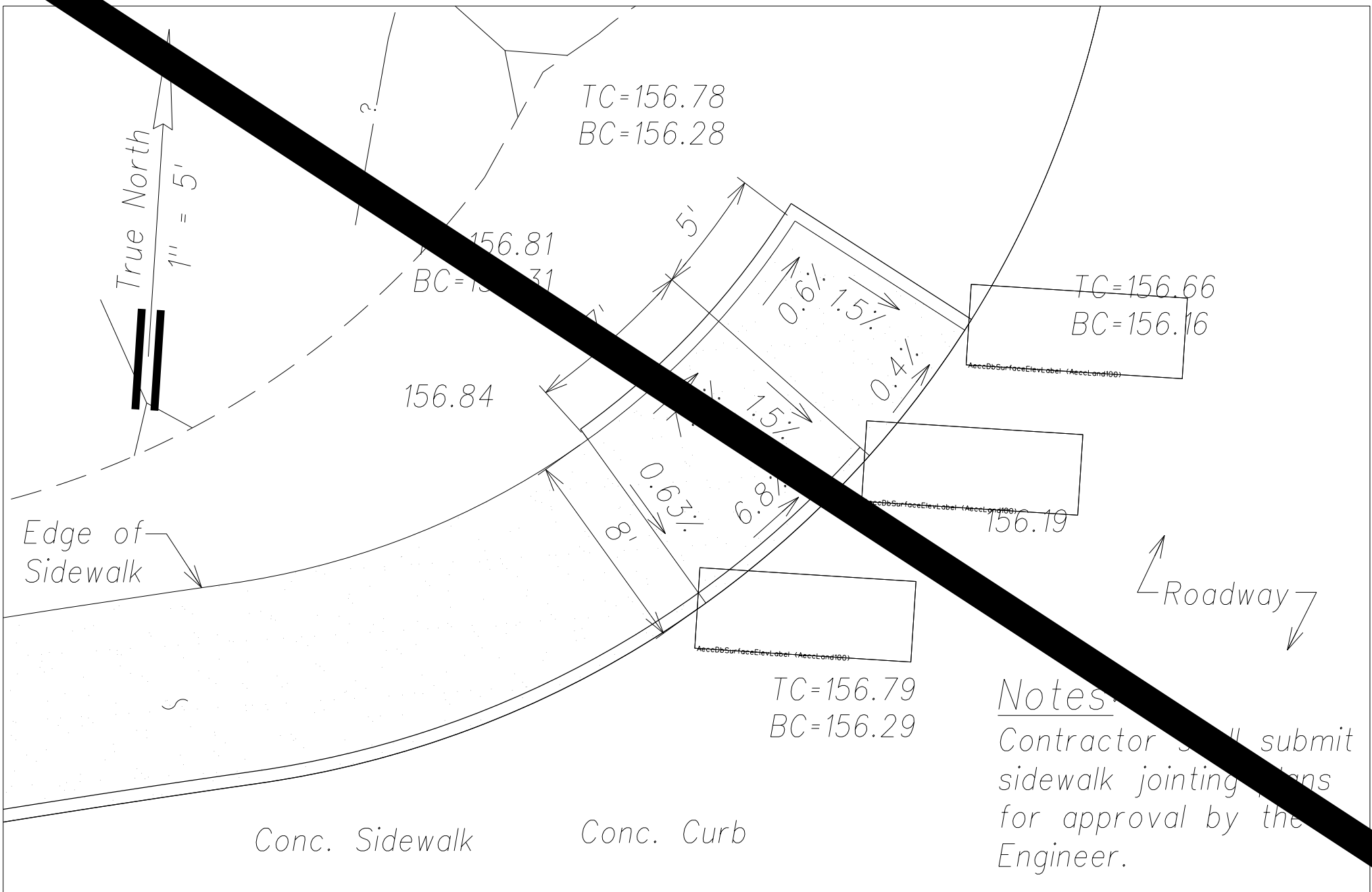

Notes:
Contractor shall submit sidewalk jointing plans for approval by the Engineer.

Type "B" Modified Curb Ramp
Scale: 1" = 5'

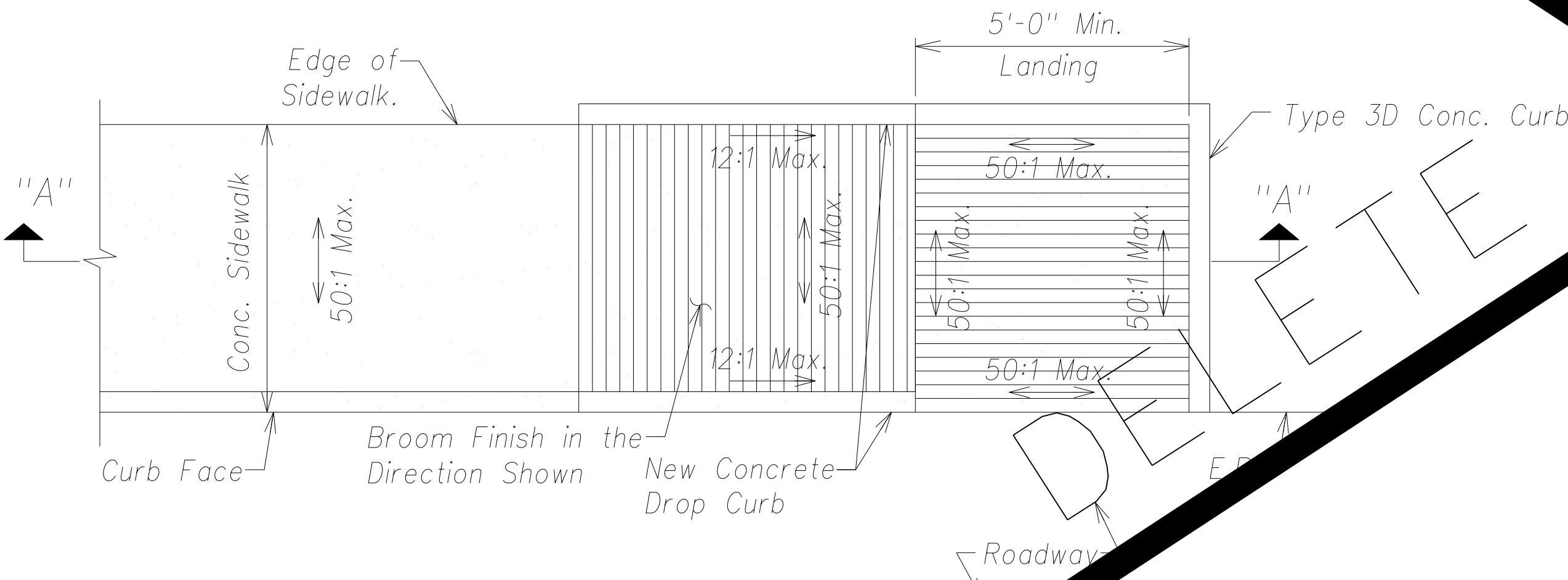

Modified Curb Ramp
Not to Scale

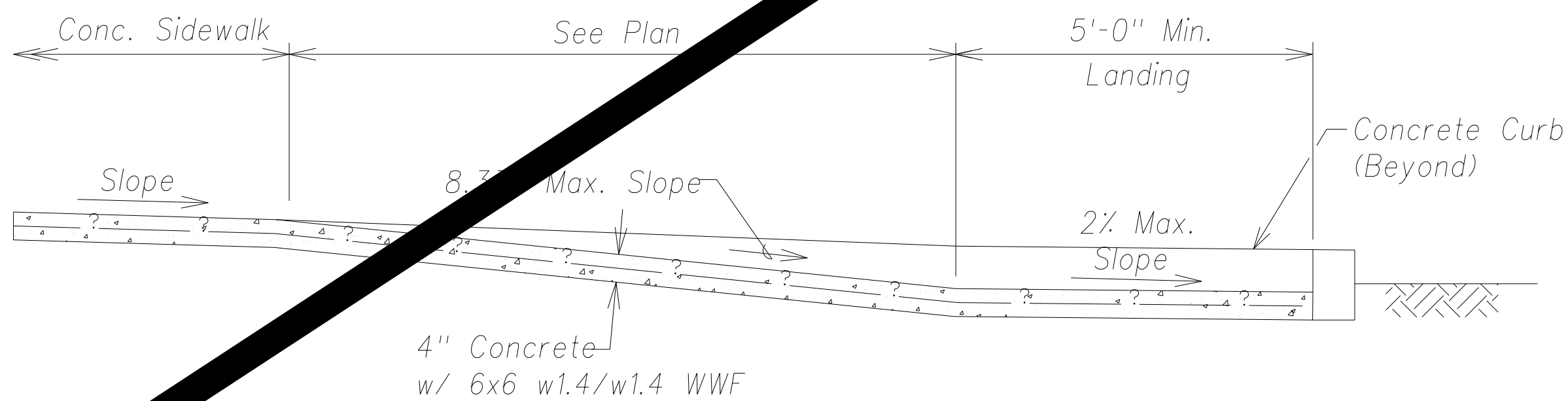

Section "A-A"
Not to Scale

4" Hot Mix A.C. Pav't.
(State Design Mix IV)
8" Asphalt Treated Base Course
6" Untreated Permeable Base

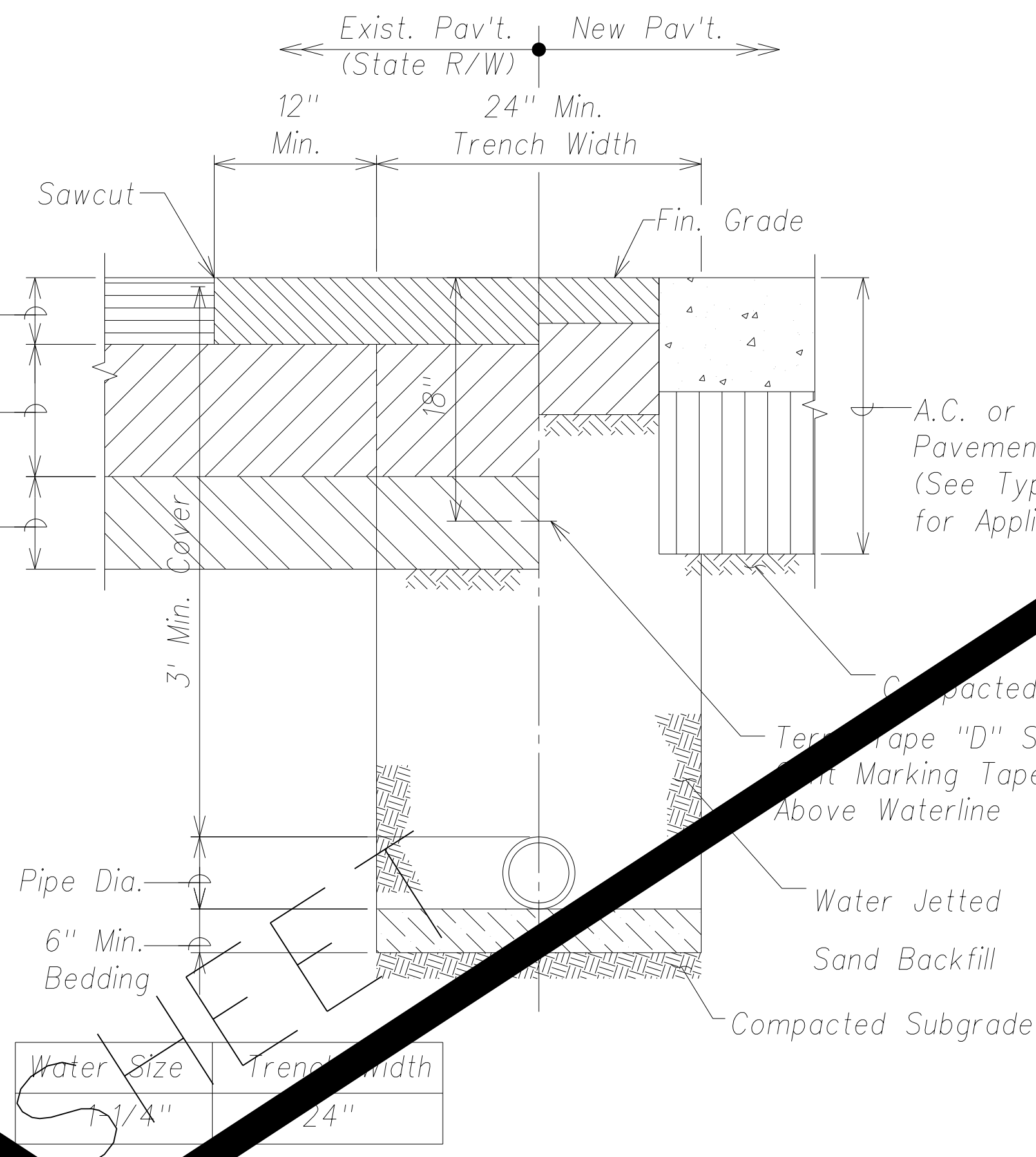

Waterline Trench Detail
Not to Scale

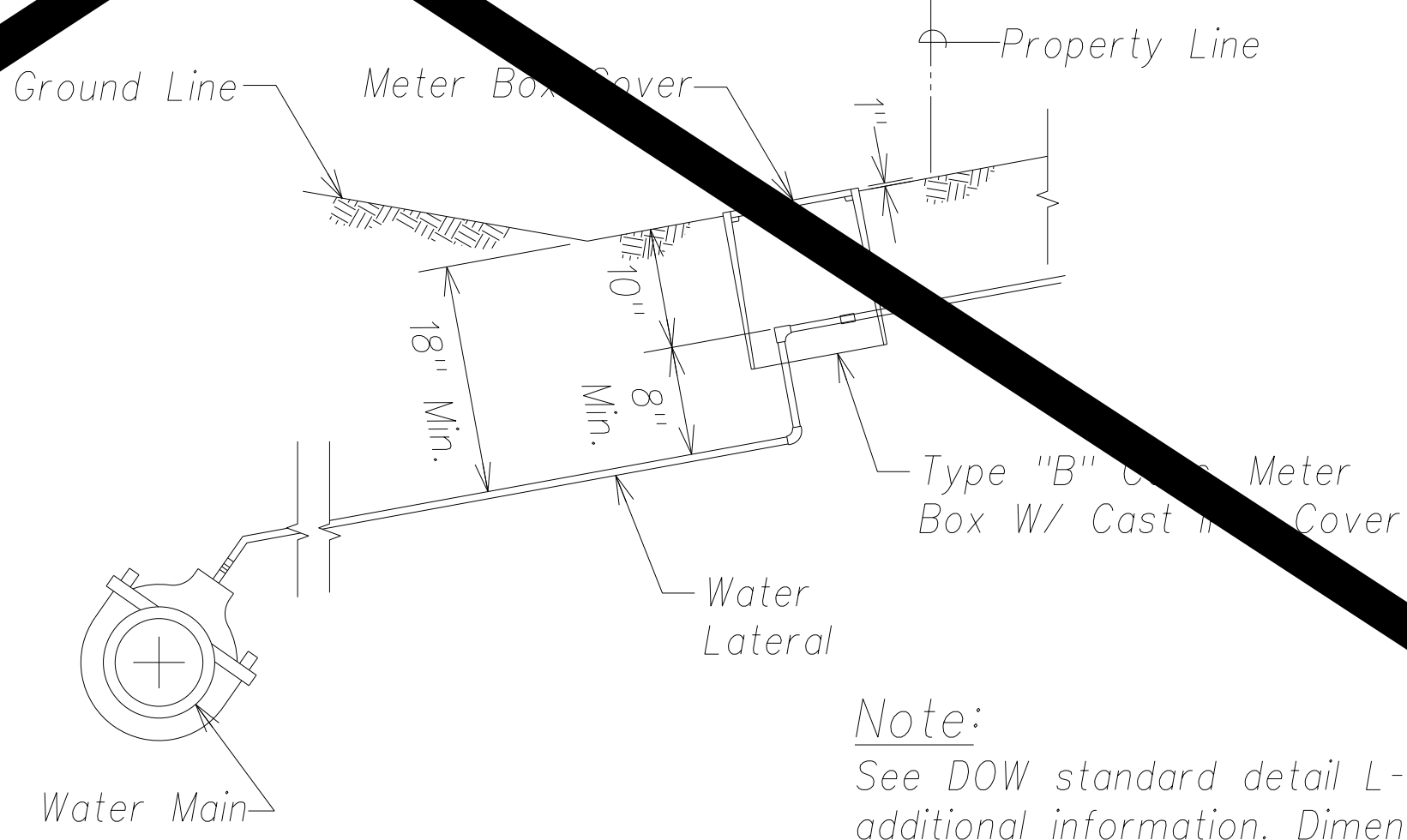

Profile View

Double Service Lateral
Not to Scale

Graphic Scale:

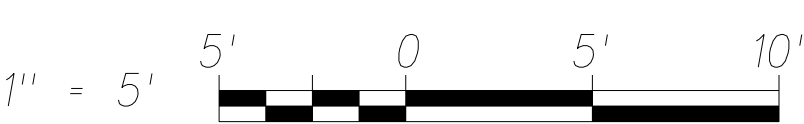

Scale in Feet

SURVEY PLOTTED BY	DATE
DRAWN BY	
DESIGNED BY	
QUANTITIES BY	
CHECKED BY	
ORIGINAL PLAN	
NOTE BOOK	
No.	

FED. ROAD DIST. NO.	STATE	FED. AID PROJ. NO.	FISCAL YEAR	SHEET NO.	TOTAL SHEETS
HAWAII	HAW.	ARR-050-1(036)	FY13/14	Model	50

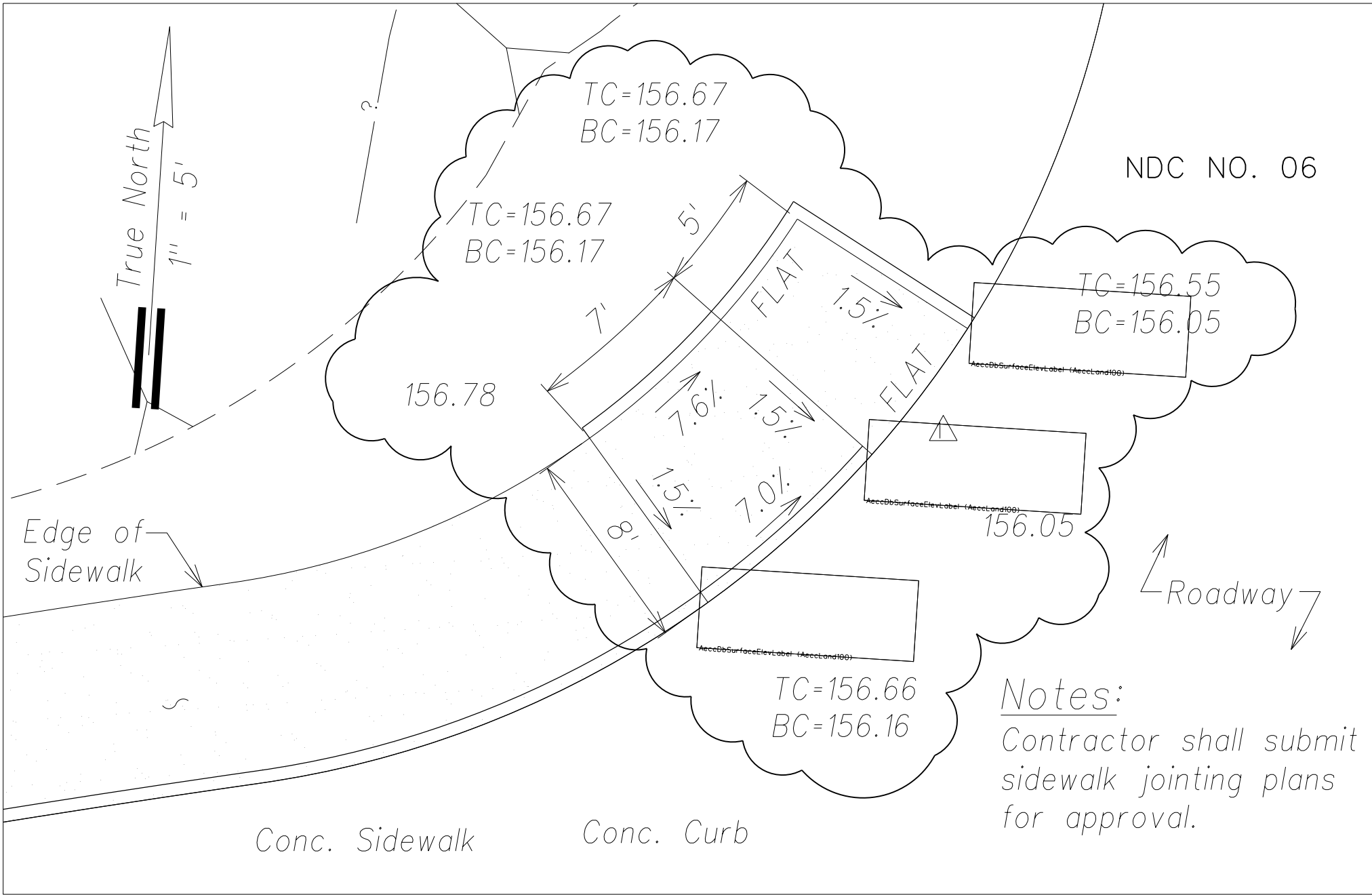

Type "B" Modified Curb Ramp
Scale: 1" = 5'

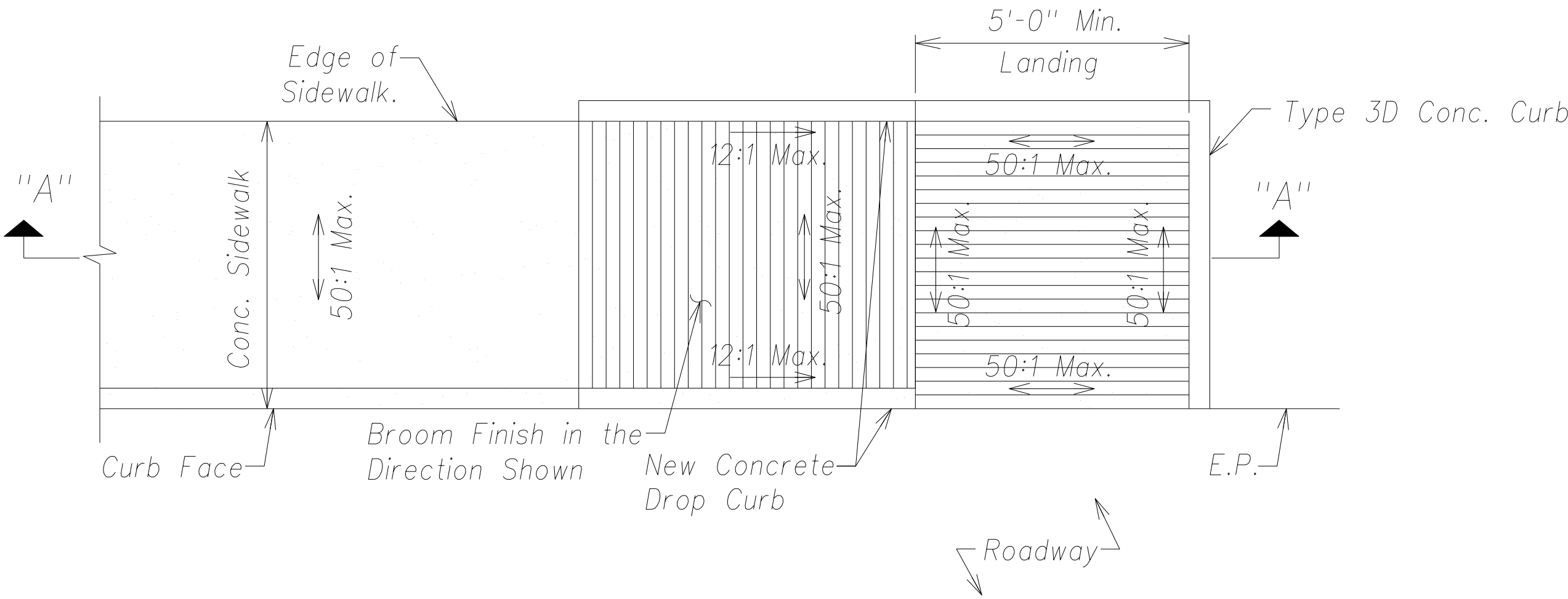

Modified Curb Ramp
Not to Scale

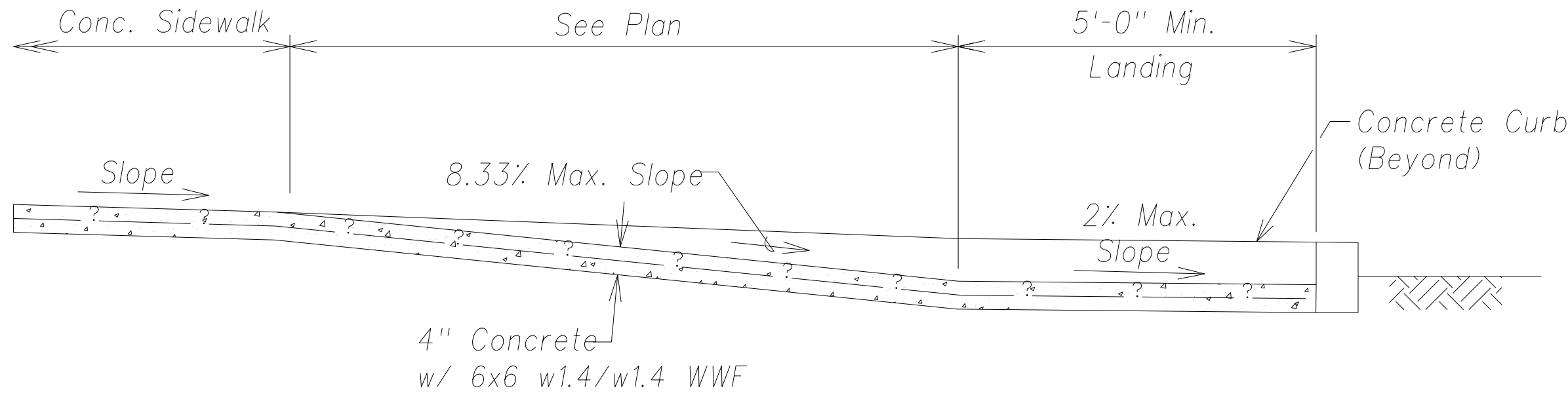

Section "A-A"
Not to Scale

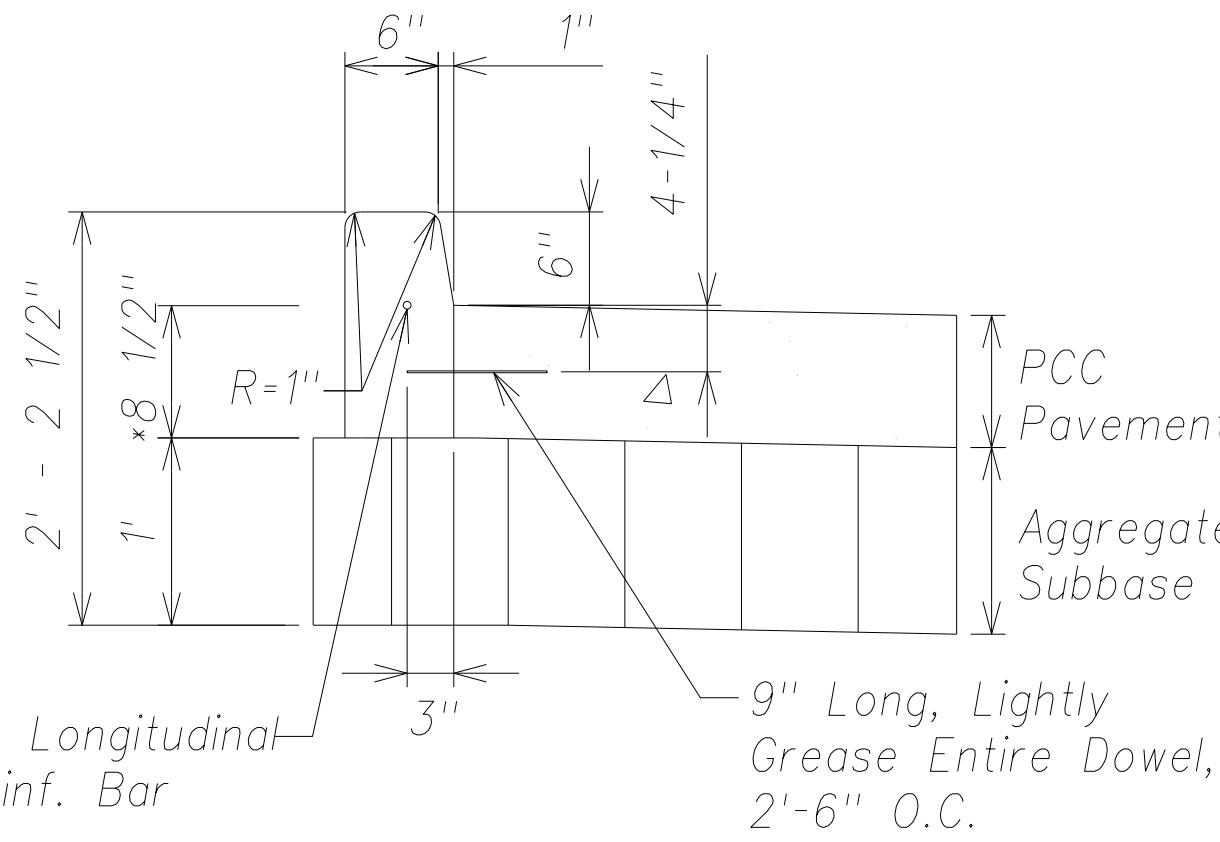

Note:
*12" at Curb Return
Cast-In-Place Concrete Curb
Not to Scale

SURVEY PLOTTED BY	DATE
DRAWN BY	
DESIGNED BY	
QUANTITIES BY	
CHECKED BY	

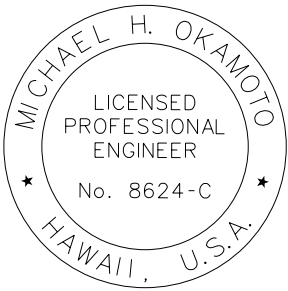

THIS WORK WAS PREPARED BY ME
OR UNDER MY SUPERVISION AND
CONSTRUCTION OF THIS PROJECT
WILL BE UNDER MY OBSERVATION.

SIGNATURE
April 30, 2014
EXPIRATION DATE
OF THE LICENSE

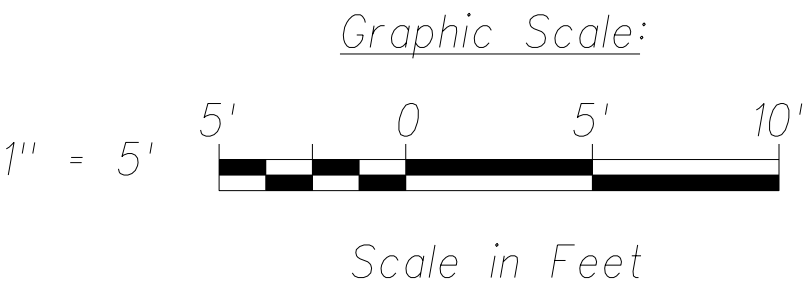

05/08/13	Revise Curb Ramp Elevations and Del. Water Details
Date	Revision
STATE OF HAWAII DEPARTMENT OF TRANSPORTATION HIGHWAYS DIVISION	
MISCELLANEOUS DETAILS	
PHASE 1 - KAUMUALI'I HIGHWAY LIHU'E MILL BRIDGE TO RICE STREET PHASE 1 - HO'OMANA ROAD	
Scale: As Shown	Date: December 4, 2012
SHEET No. C-32 OF 50 SHEETS	