

FED. ROAD DIST. NO.	STATE	FED. AID PROJ. NO.	FISCAL YEAR	SHEET NO.	TOTAL SHEETS
HAWAII	HAW.	NH-050-1(31)	2009	389	452

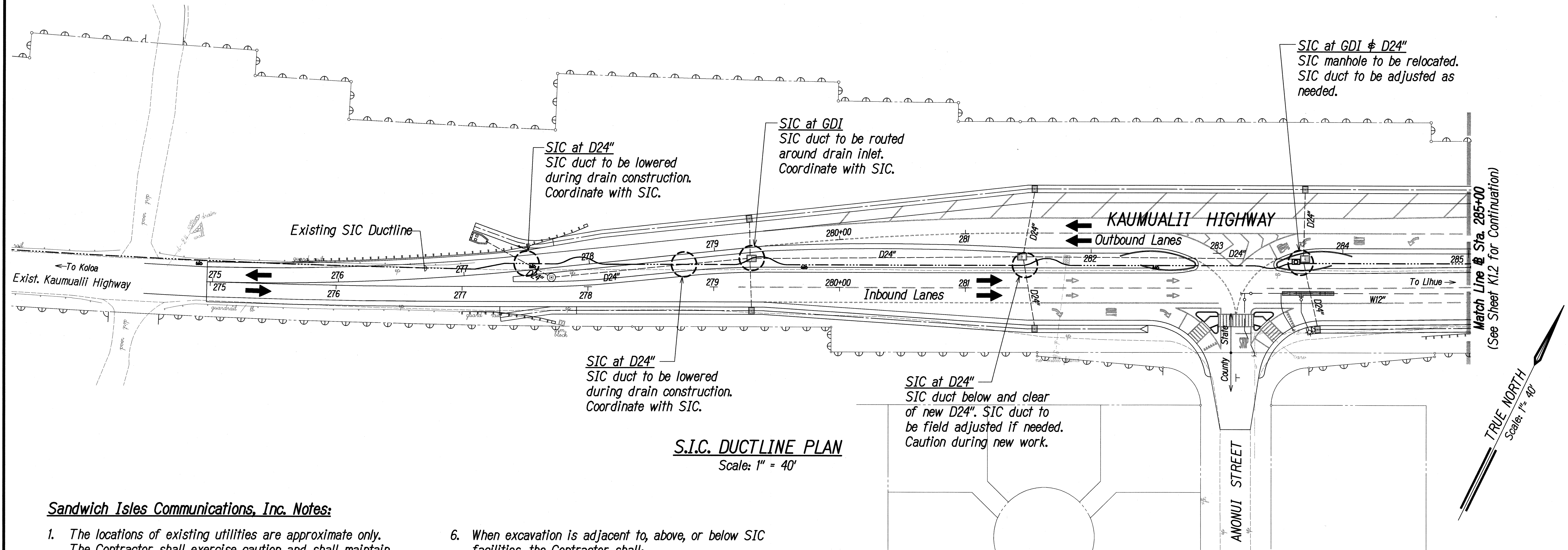

Sandwich Isles Communications, Inc. Notes:

1. The locations of existing utilities are approximate only. The Contractor shall exercise caution and shall maintain proper clearance whenever construction crosses or is in close proximity to Sandwich Isles Communications, Inc. (SIC) facilities.
2. Prior to excavating, the Contractor shall call into Hawaii's One Call Center and shall comply with Hawaii Revised Statutes Chapter 269E. Contact Hawaii One Call at 1-866-423-7287.
3. Where conflicts between new construction and SIC facilities are discovered, adjustments shall be made to SIC facilities to provide required clearances from the new work. Any such adjustment work shall be done by SIC, or by the Contractor with SIC approval and under the direction of an SIC inspector.
4. An SIC inspector or designated representative is required to be present during any work on SIC facilities. Provide temporary duct or cable support wherever necessary or required by the SIC inspector.
5. The Contractor shall notify SIC customer service at least 72 hours prior to excavation, bracing, or backfilling of SIC facilities. Contact SIC customer service at 1-888-995-7274.
6. When excavation is adjacent to, above, or below SIC facilities, the Contractor shall:
 - a. Sheet and/or brace the excavation to prevent slides, cave-ins, or settlements to ensure no movement or impact to SIC facilities.
 - b. Support existing structures and/or facilities with beams, struts, or underpinning while excavating around or beneath them to prevent any movement or impact to SIC facilities.
7. Unless otherwise indicated, the existing SIC ductline is to remain in-place.
8. Provisions have been by SIC to temporarily route service from the SIC ductline to temporary facilities for the duration of construction of the new work. The SIC facilities shown should be out of service. However, all SIC facilities shall be protected and preserved at all times.
9. Any damage to SIC facilities by the contractor as result of his activity shall be repaired by SIC. The cost for any repair shall be borne by the Contractor.

SURVEY PLOTTED BY	DATE
DRAWN BY	
DESIGNED BY	
QUANTITIES BY	
CHECKED BY	

1002 STATE DOT/KAUAI-1/PHASE 1A/REVISION PLAN/KAUAI-1-SIC01.dwg 5/08/09



5-11-09
THIS WORK WAS PREPARED BY
ME OR UNDER MY SUPERVISION
Glen K. Ikeda
PAREN, Inc.
dba PARK ENGINEERING
LICENSE EXPIRES 4-30-10

STATE OF HAWAII
DEPARTMENT OF TRANSPORTATION
HIGHWAYS DIVISION

S.I.C. DUCTLINE PLAN

KAUMUALII HIGHWAY WIDENING
Vicinity of Anonui Street to Vicinity of Lihue Mill Bridge
FEDERAL-AID PROJECT NO. NH-050-1(31)

Scale: 1" = 40' Date: MAY 2009

SHEET No. *K1.1* OF *K1.7* SHEETS

FED. ROAD DIST. NO.	STATE	FED. AID PROJ. NO.	FISCAL YEAR	SHEET NO.	TOTAL SHEETS
HAWAII	HAW.	NH-050-1(31)	2009	390	452

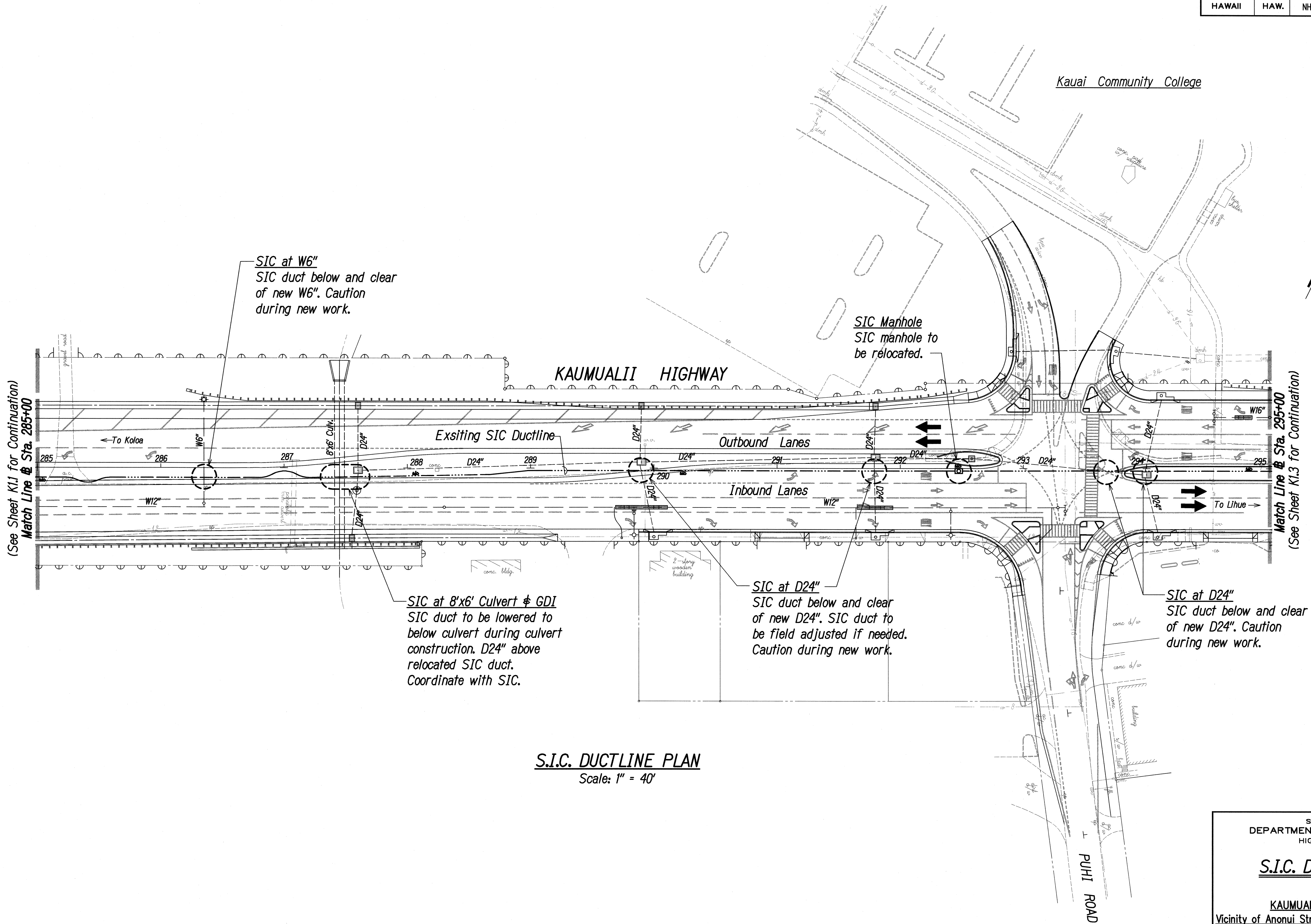

S.I.C. DUCTLINE PLAN
Scale: 1" = 40'



THIS WORK WAS PREPARED BY ME OR UNDER MY SUPERVISION

Glenn K. Ikeda
P.E., Inc.
dba PARK ENGINEERING
LICENSE EXPIRES 4-30-10

STATE OF HAWAII
DEPARTMENT OF TRANSPORTATION
HIGHWAYS DIVISION

S.I.C. DUCTLINE PLAN

KAUMUALII HIGHWAY WIDENING
Vicinity of Anonui Street to Vicinity of Lihue Mill Bridge
FEDERAL-AID PROJECT NO. NH-050-1(31)

Scale: 1" = 40' Date: MAY 2009

SHEET No. K1.2 OF K1.7 SHEETS

ORIGINAL PLAN	SURVEY PLOTTED BY	DATE
NOTE BOOK	DRAWN BY	
	TRACED BY	
	CHECKED BY	
	QUANTITIES BY	
	CHECKED BY	

U82 STATE DOT\KAUMUALII\PROJECTS\REVISION PLANS\K1.2-SICD.dwg 5/08/09

FED. ROAD DIST. NO.	STATE	FED. AID PROJ. NO.	FISCAL YEAR	SHEET NO.	TOTAL SHEETS
HAWAII	HAW.	NH-050-1(31)	2009	391	452

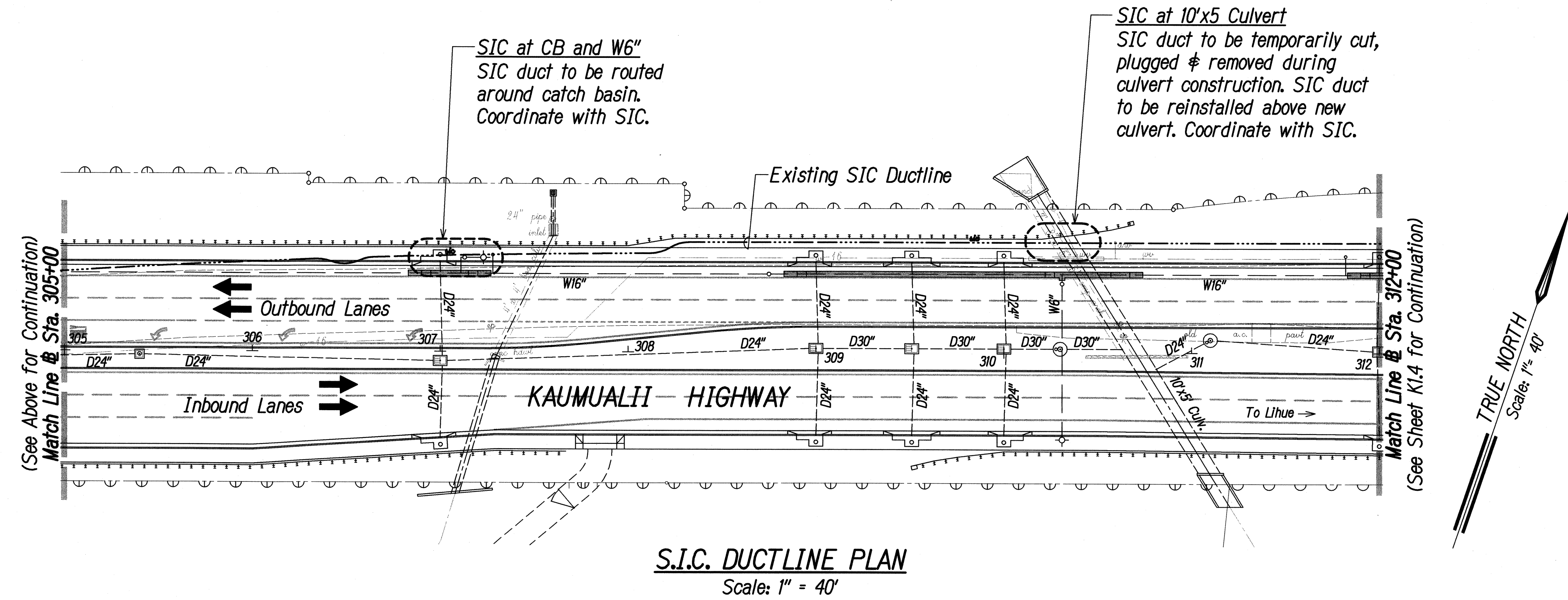
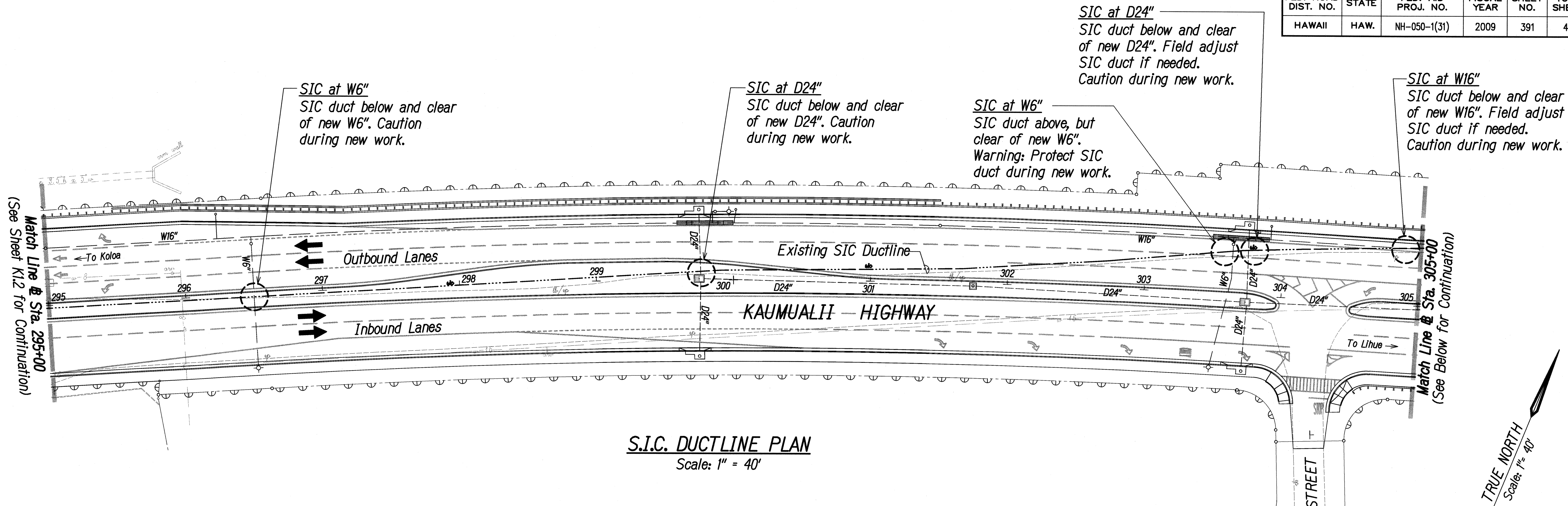

ORIGINAL PLAN	DATE
DESIGNED BY	
NOTED BY	
CHECKED BY	
NO.	

100% STATE DOT KAUMUALII - 1 PHASE 1A DESIGN PLAN (HAWAII) - K1.3-S001.dwg 5/08/09



5-11-09
THIS WORK WAS PREPARED BY ME OR UNDER MY SUPERVISION
Glenn K. Ikeda
P.E., INC.
dba PARK ENGINEERING
LICENSE EXPIRES 4-30-10

STATE OF HAWAII
DEPARTMENT OF TRANSPORTATION
HIGHWAYS DIVISION

S.I.C. DUCTLINE PLAN

KAUMUALII HIGHWAY WIDENING
Vicinity of Anonui Street to Vicinity of Lihue Mill Bridge
FEDERAL-AID PROJECT NO. NH-050-1(31)
Scale: 1" = 40' Date: MAY 2009

SHEET No. K1.3 OF K1.7 SHEETS

FED. ROAD DIST. NO.	STATE	FED. AID PROJ. NO.	FISCAL YEAR	SHEET NO.	TOTAL SHEETS
HAWAII	HAW.	NH-050-1(31)	2009	392	452

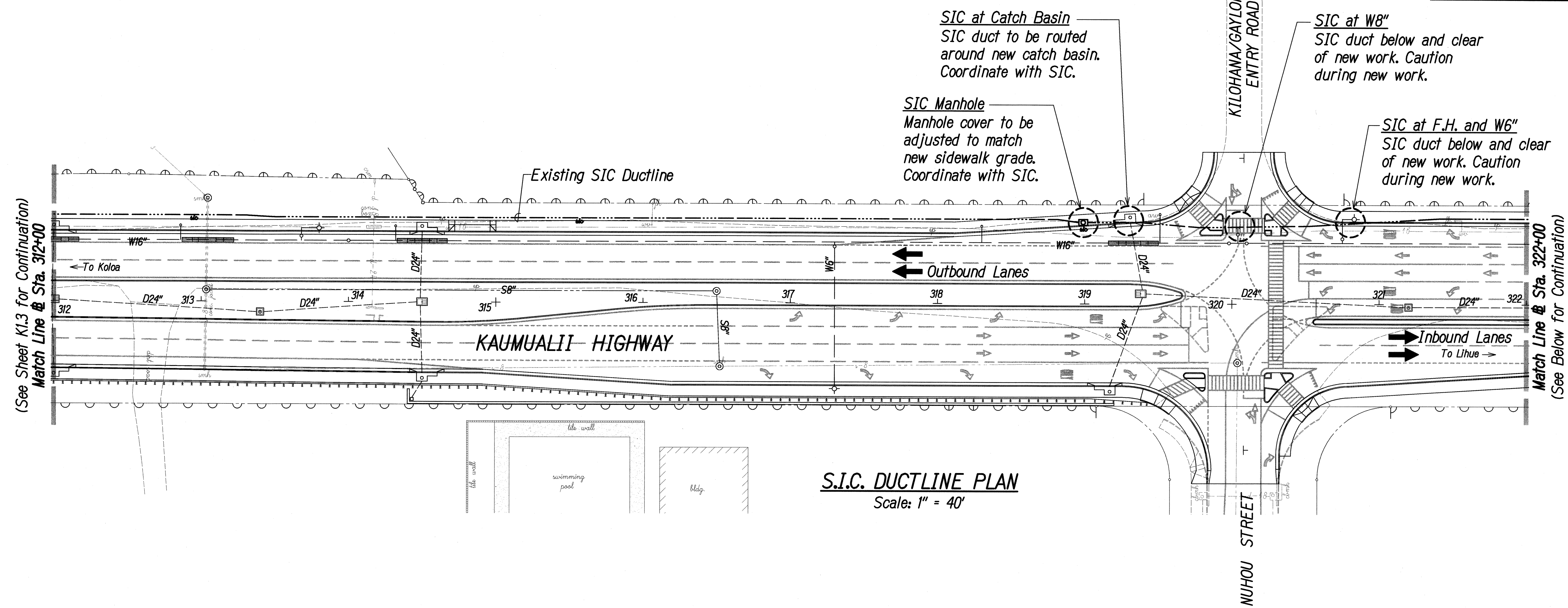

S.I.C. DUCTLINE PLAN
Scale: 1" = 40'

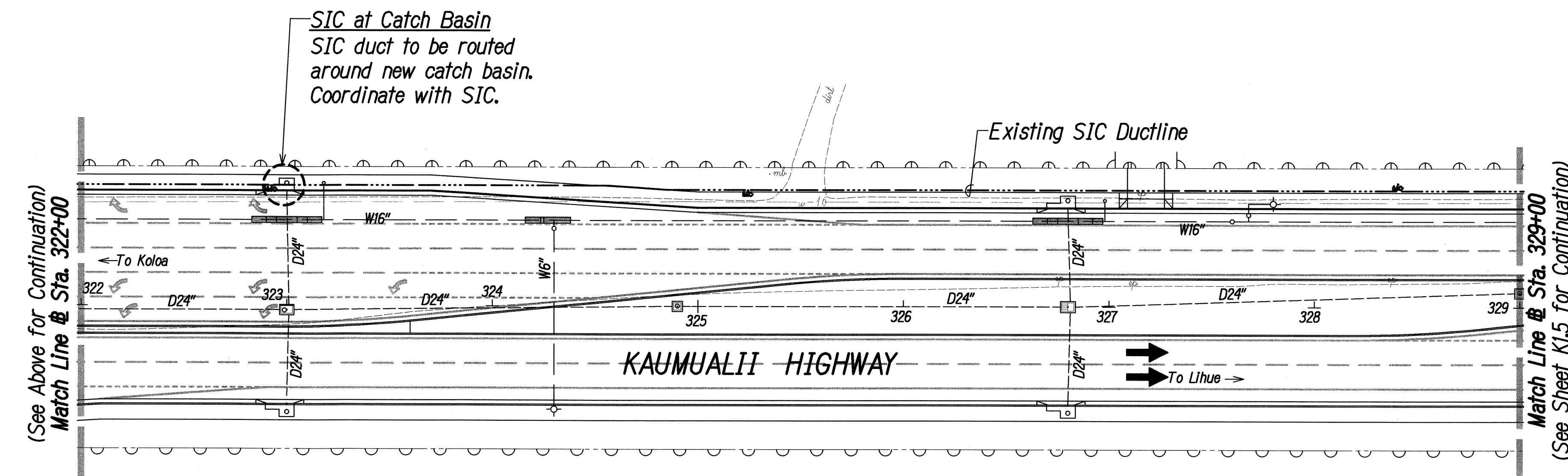

S.I.C. DUCTLINE PLAN
Scale: 1" = 40'

ORIGINAL PLAN	DATE
NOTE BOOK	DESIGNED BY
	QUANTITIES BY
	CHECKED BY

LIB2: STATE DOT\KAMUALII\PHASE1A\REVISION\PLAN\K1.4-SICD.dwg 5/07/09

GLENN K. IKEDA
LICENSED PROFESSIONAL ENGINEER
No. 8328-C
HAWAII, U.S.A.
5-11-09
THIS WORK WAS PREPARED BY ME OR UNDER MY SUPERVISION
Glenn K. Ikeda
PAREX, INC.
dba PARK ENGINEERING
LICENSE EXPIRES 4-30-10

STATE OF HAWAII
DEPARTMENT OF TRANSPORTATION
HIGHWAYS DIVISION

S.I.C. DUCTLINE PLAN

KAUMUALII HIGHWAY WIDENING
Vicinity of Anonui Street to Vicinity of Lihue Mill Bridge
FEDERAL-AID PROJECT NO. NH-050-1(31)

Scale: 1" = 40' Date: MAY 2009

SHEET No. K1.4 OF K1.7 SHEETS

FED. ROAD DIST. NO.	STATE	FED. AID PROJ. NO.	FISCAL YEAR	SHEET NO.	TOTAL SHEETS
HAWAII	HAW.	NH-050-1(31)	2009	393	452

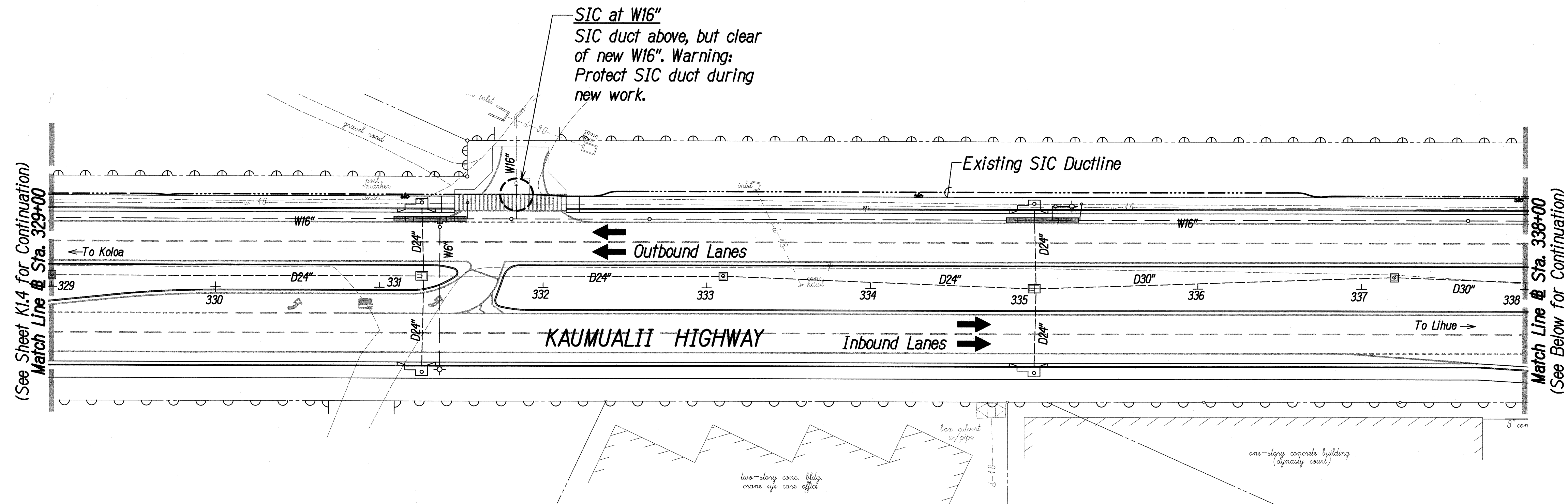

S.I.C. DUCTLINE PLAN
Scale: 1" = 40'

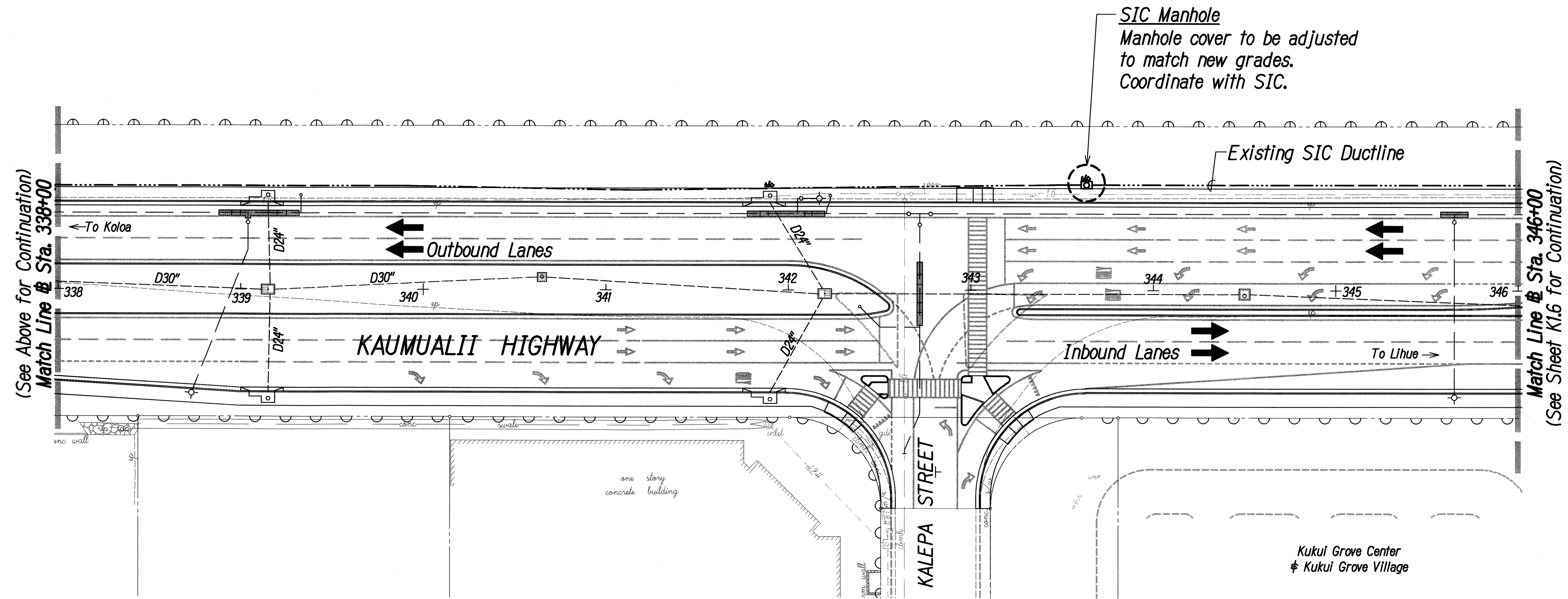
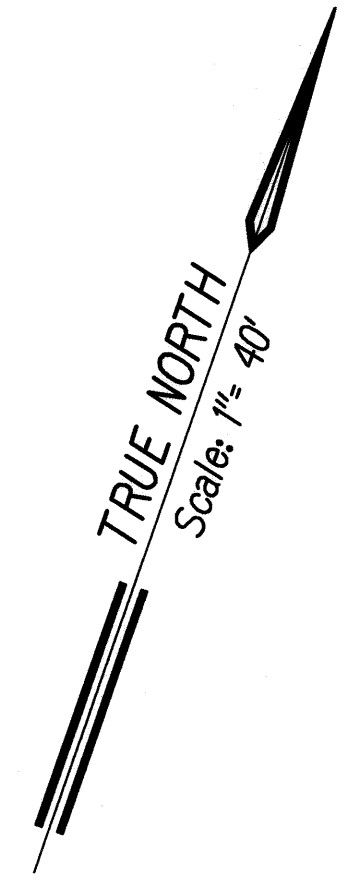

S.I.C. DUCTLINE PLAN
Scale: 1" = 40'

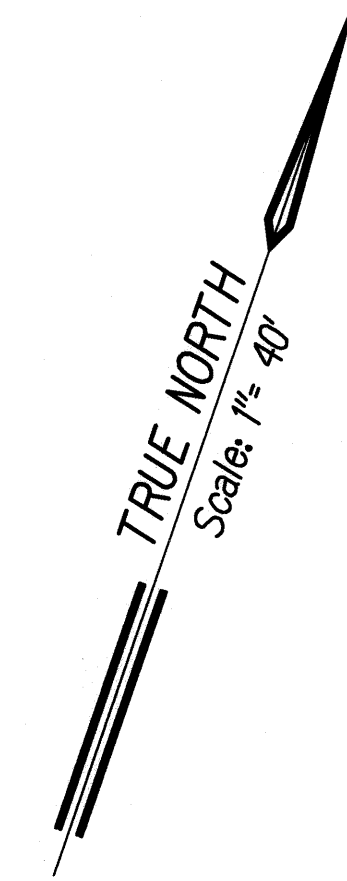

ORIGINAL PLAN NOTE BOOK No. _____	SURVEY PLOTTED BY _____	DATE _____
	DRAWN BY _____	DESIGNED BY _____
	QUANTITIES BY _____	CHECKED BY _____
	LIBRARY STATE OF HAWAII - PHASE II REVISION PLANS, KHW-05-0005.dwg, 5/07/09	

GLENN K. IKEDA
LICENSED PROFESSIONAL ENGINEER
No. 8328-C
HAWAII, U.S.A.

5-11-09
THIS WORK WAS PREPARED BY ME OR UNDER MY SUPERVISION
Glenn K. Ikeda
FORER, INC.
dba PARK ENGINEERING
LICENSE EXPIRES 4-30-10

STATE OF HAWAII
DEPARTMENT OF TRANSPORTATION
HIGHWAYS DIVISION

S.I.C. DUCTLINE PLAN

KAUMUALII HIGHWAY WIDENING
Vicinity of Anonui Street to Vicinity of Lihue Mill Bridge
FEDERAL-AID PROJECT NO. NH-050-1(31)

Scale: 1" = 40' Date: MAY 2009

SHEET No. K1.5 OF K1.7 SHEETS

FED. ROAD DIST. NO.	STATE	FED. AID PROJ. NO.	FISCAL YEAR	SHEET NO.	TOTAL SHEETS
HAWAII	HAW.	NH-050-1(31)	2009	394	452

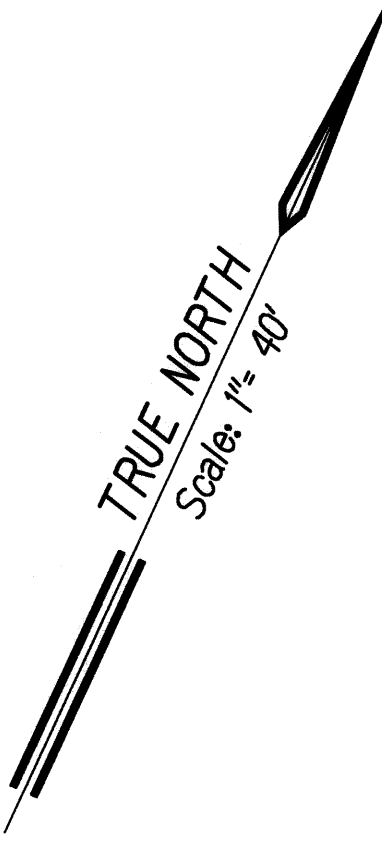
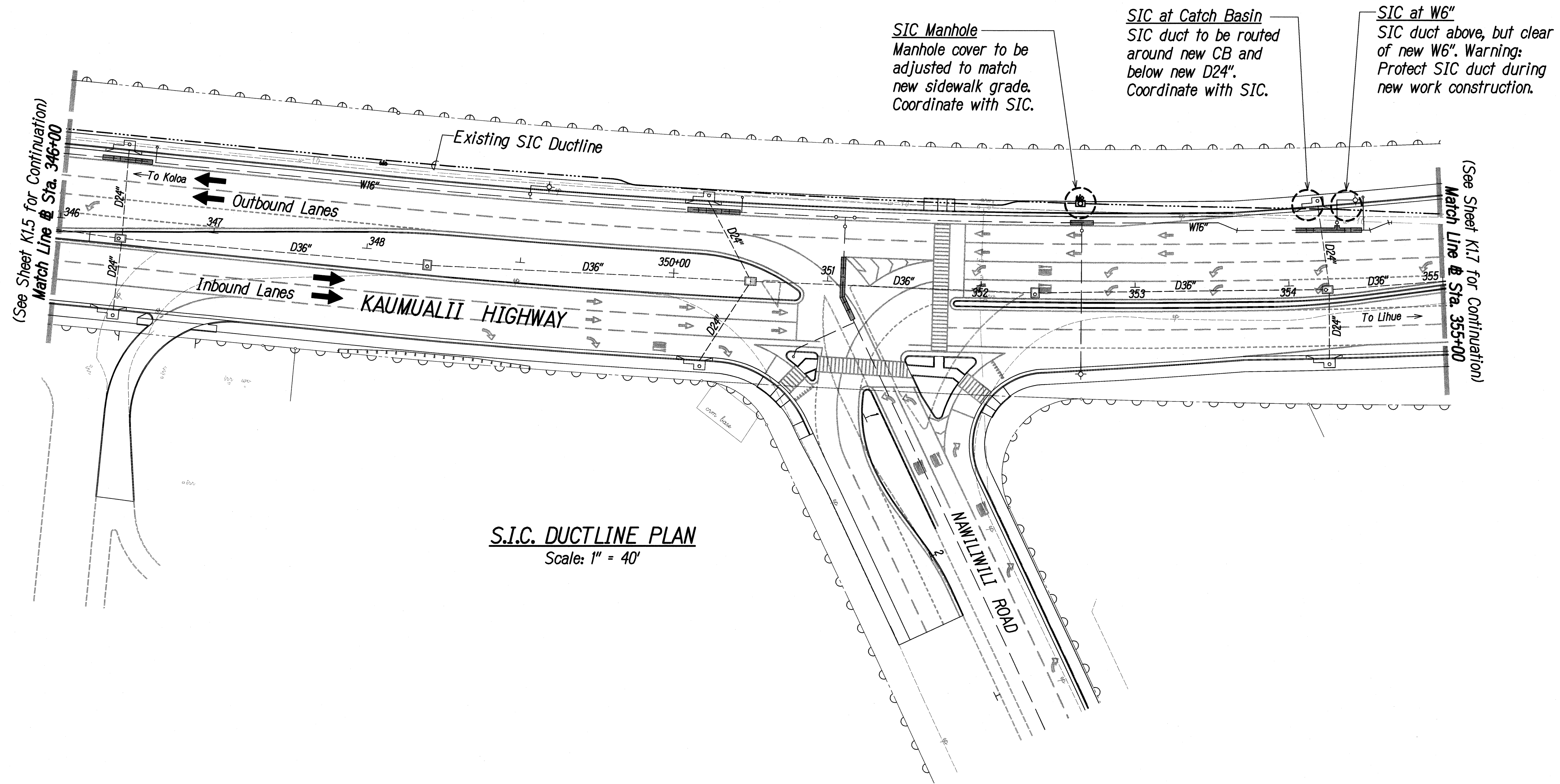

ORIGINAL PLAN	SURVEY PLOTTED BY	DATE
NOTE BOOK	DRAWN BY	
No.	DESIGNED BY	
	QUANTITIES BY	
	CHECKED BY	

LIB2 STATE DOT\KAMUALII-1\PHASE1A DESIGN\PLANS\K16-SIC.Dwg 5/07/09



5-11-09
THIS WORK WAS PREPARED BY
ME OR UNDER MY SUPERVISION
Glenn K. Ikeda
FOREN, INC.
880 PARK ENGINEERING
LICENSE EXPIRES 4-30-10

STATE OF HAWAII
DEPARTMENT OF TRANSPORTATION
HIGHWAYS DIVISION

S.I.C. DUCTLINE PLAN

KAUMUALII HIGHWAY WIDENING
Vicinity of Anonui Street to Vicinity of Lihue Mill Bridge
FEDERAL-AID PROJECT NO. NH-050-1(31)

Scale: 1" = 40' Date: MAY 2009

SHEET No. K1.6 OF K1.7 SHEETS

FED. ROAD DIST. NO.	STATE	FED. AID PROJ. NO.	FISCAL YEAR	SHEET NO.	TOTAL SHEETS
HAWAII	HAW.	NH-050-1(31)	2009	395	452

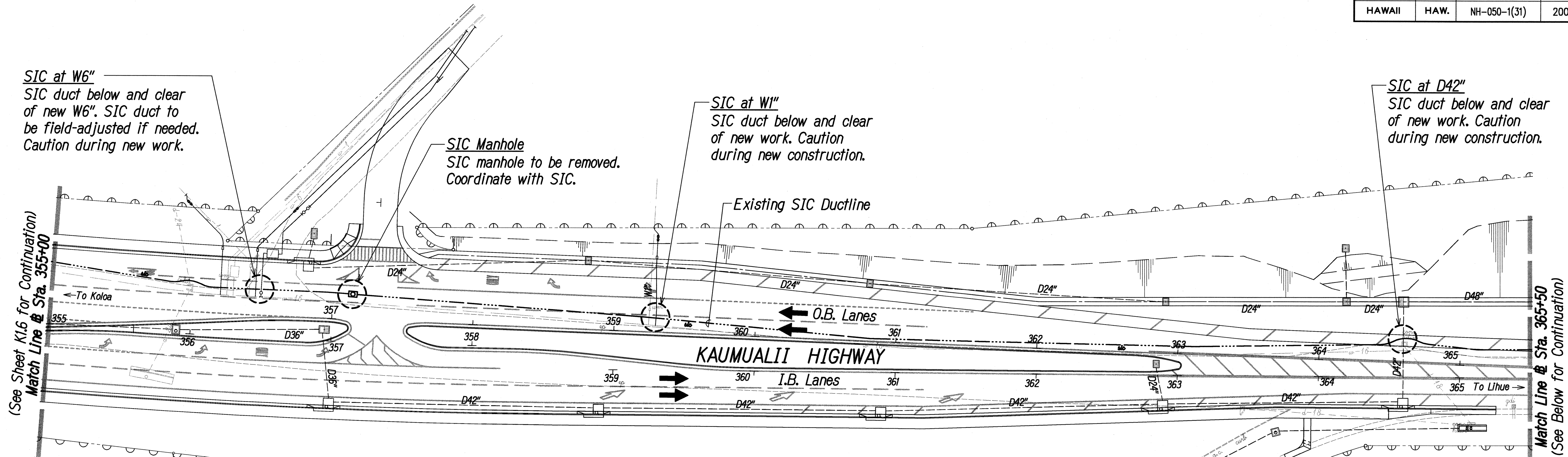

S.I.C. DUCTLINE PLAN
Scale: 1" = 40'

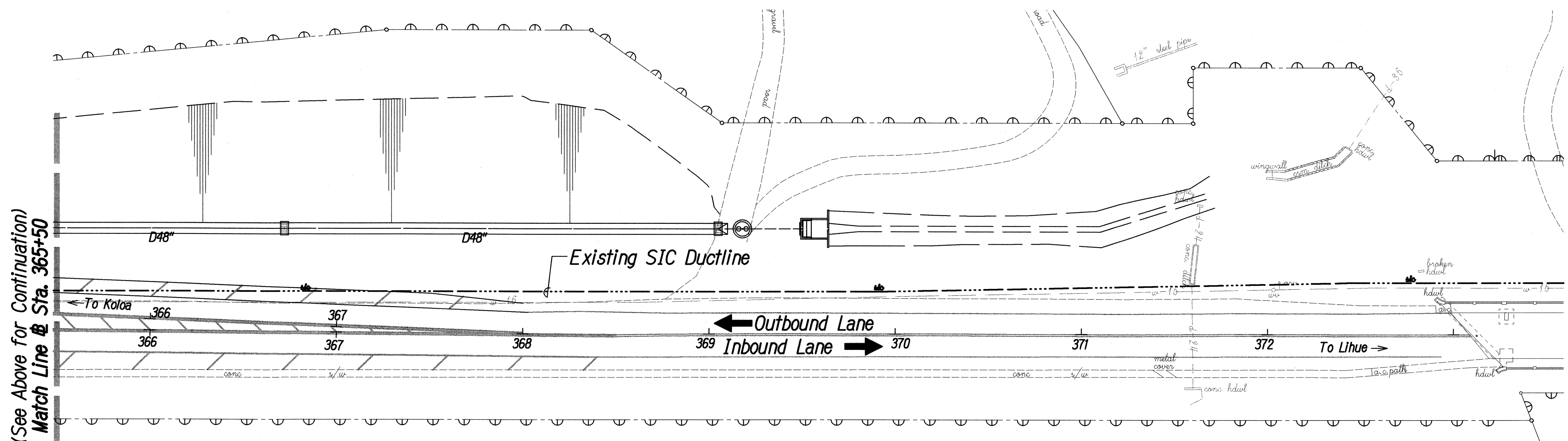

S.I.C. DUCTLINE PLAN
Scale: 1" = 40'

ORIGINAL PLAN	SURVEY PLOTTED BY	DATE
NOTE BOOK	DRAWN BY	
No.	DESIGNED BY	
	QUANTITIES BY	
	CHECKED BY	

LIB2: STATE DOT\HAWAII\1\PHASEA: REVISIONS\ANS\K1.7-2009.dwg 5/08/09



THIS WORK WAS PREPARED BY ME OR UNDER MY SUPERVISION

Glenn K. Ikeda
P.E., Inc.
dba PARK ENGINEERING
LICENSE EXPIRES 4-30-10

STATE OF HAWAII
DEPARTMENT OF TRANSPORTATION
HIGHWAYS DIVISION

S.I.C. DUCTLINE PLAN

KAUMUALII HIGHWAY WIDENING
Vicinity of Anonui Street to Vicinity of Lihue Mill Bridge
FEDERAL-AID PROJECT NO. NH-050-1(31)

Scale: 1" = 40' Date: MAY 2009

SHEET No. K1.7 OF K1.7 SHEETS