

FED. ROAD DIST. NO.	STATE	FED. AID PROJ. NO.	FISCAL YEAR	SHEET NO.	TOTAL SHEETS
HAWAII	HAW.	ER-II(1)	1993	3	5

CURVE DATA ① and ②

$\Delta = 20^\circ 55' 30''$
 $\frac{\Delta}{2} = 10^\circ 27' 45''$
 $R = 1500.00$
 $T = 286.77'$
 $C = 544.76'$
 $L_c = 547.82'$

TRUE NORTH
Scale: 1" = 50'

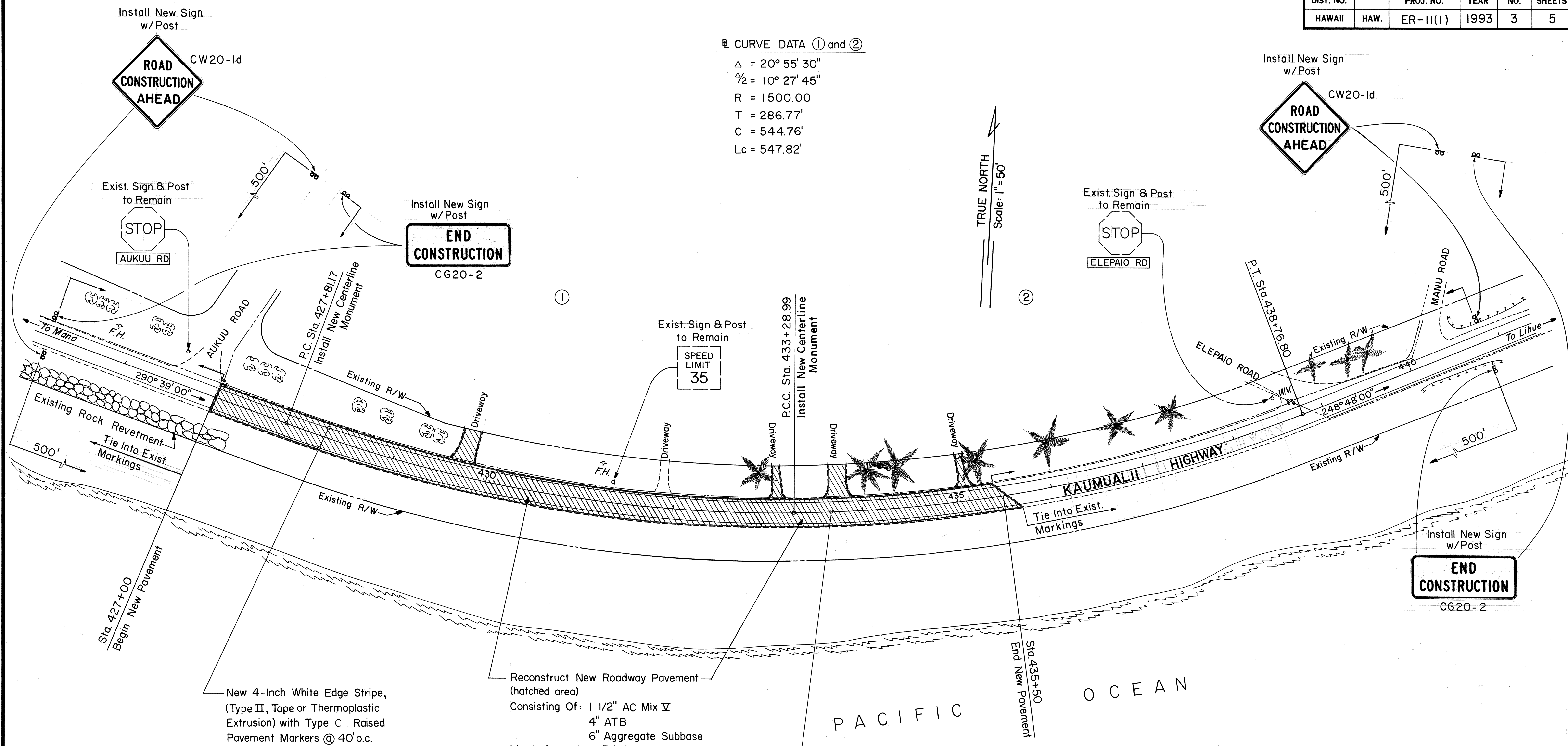

Install New Sign w/Post



CW20-1d

Exist. Sign & Post to Remain

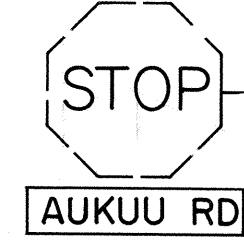

AUKUU RD

Install New Sign w/Post

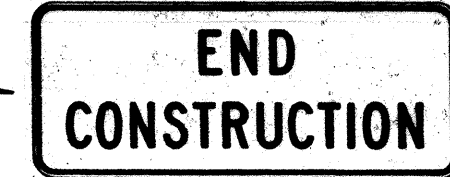

CG20-2

Install New Sign w/Post



CW20-1d

Exist. Sign & Post to Remain



ELEPAIO RD

Install New Sign w/Post

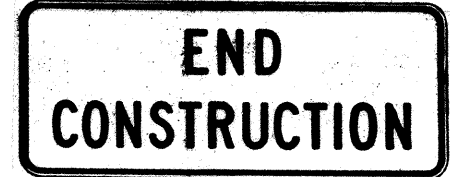

CG20-2

Exist. Sign & Post to Remain

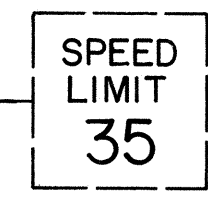

SPEED LIMIT 35

New 4-Inch White Edge Stripe, (Type II, Tape or Thermoplastic Extrusion) with Type C Raised Pavement Markers @ 40' o.c.

Reconstruct New Roadway Pavement (hatched area) Consisting Of: 1 1/2" AC Mix ∇ 4" ATB 6" Aggregate Subbase Match Smoothly to Existing Pavement.

Sta. 427+00 to 435+50 New Double 4-Inch Wide Yellow Pavement Striping. (Type I, Tape or Thermoplastic Extrusion) with Type D Raised Pavement Markers @ 20' o.c.

DATE	_____
SURVEY PLOTTED BY	_____
DRAWN BY	_____
TRACED BY	_____
CHECKED BY	_____
NO. _____	_____

STATE OF HAWAII
DEPARTMENT OF TRANSPORTATION
HIGHWAYS DIVISION
PLAN, SIGNING & PAVEMENT MARKING
KAUMUALII HIGHWAY RECONSTRUCTION
At Kekaha
F. A. PROJECT NO. ER-II(1)
SCALE: NOT TO SCALE DATE: OCT. 1992
SHEET NO. 1 OF 1 SHEETS