

GENERAL NOTES

- All Azimuths refer to Δ "Laaukahi" and the baseline stations refer to Proj. No. F-12(12).
- All elevations are referred to Mean Sea Level Datum.
- Baseline shown is not necessarily the centerline of existing road.
- The Contractor shall keep at least one lane open to traffic during working hours and both lanes open to traffic during non-working hours.
- The Contractor's attention is directed to Subsection E03.02(A)(G) "Surplus Material" of the Standard Specifications.
- The cost of demolishing existing conc. Inlet shall be considered incidental to Class "A" Concrete. Care must be taken to protect the Conc. pipe from damage.
- The Contractor's attention is directed to Section G42 "Reset Posts, Signs, Markers and Guard Rails" of the Standard Specifications.
- The exact locations of two Project Information Signs shall be determined in the field by the Engineer.
- Any damage to existing asphalt concrete pavement by the Contractor must be repaired by the Contractor to original condition at the Contractor's own expense.

Construct Reinforced Concrete Gutter, Type G1214. For Details, see Sheet No. 2
Sta. 57+67 to Sta. G3+25 Lt. 558 L.F.
Sta. G3+50 to Sta. G4+00 Lt. 50 L.F.

Construct Reinforced Concrete Gutter, Type G1117. For Details see Sheet No. 2
Sta. G0+00 to Sta. G3+10 Rt. 304.5 L.F.
Sta. G3+25 to Sta. G4+00 Rt. 75 L.F.

Note:
Install Project Information Sign at each end of Project.

Sta. 58+36 Lt.
Demolish existing Conc. Inlet and Construct 1-C.D.I. Install Grating Flush with Concrete. For Details, see Sheet No. 4
Est. Quant.
Struct. Exc. 15.4 = 8 C.Y.
Class "A" Conc. 1.07 = 2 C.Y.
Reinf. Steel 34 = 33 Lb
Type G1214 Frame & Grate = 1 Ea.

Construct Stabilized Shoulder: 212
Sta. 59+75 to Sta. G3+10 Rt. 223 S.Y.
Sta. G3+30 to Sta. G4+00 Rt. 47 S.Y.
Sta. 57+67 to Sta. G3+25 Lt. 372 S.Y.
Sta. G3+50 to Sta. G4+00 Lt. 34 S.Y.
For Details, see Sheet No. 2

CURVE DATA
Δ = 108° 27' 30"
4P = 54' 13' 45"
R = 800.00'
T = 1110.42'
C = 1228.18'
Lc = 1514.36'

DIST. NO.	STATE	PROJ. NO.	FISCAL YEAR	SHEET NO.	TOTAL SHEETS
HAWAII	HAW.	50C-02-71	1971	3	7

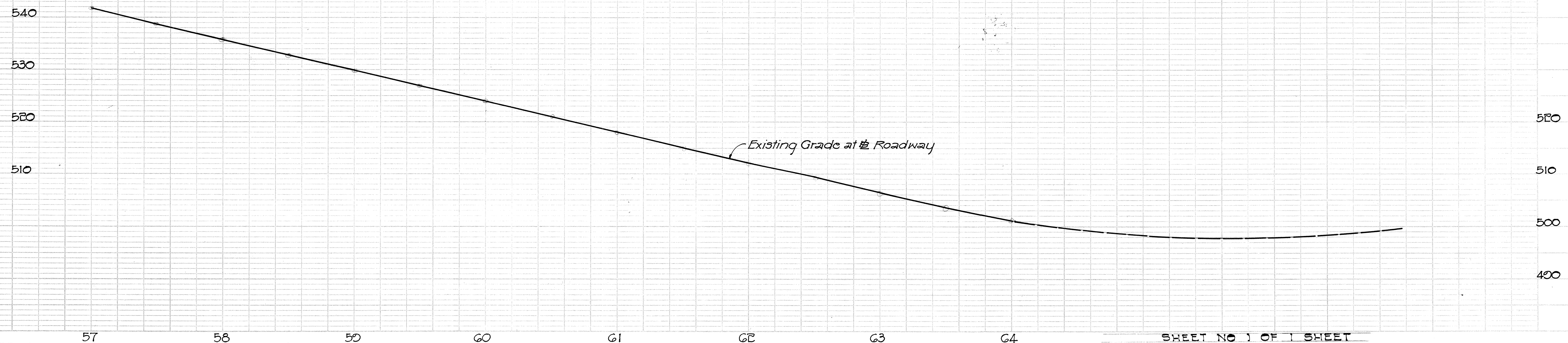
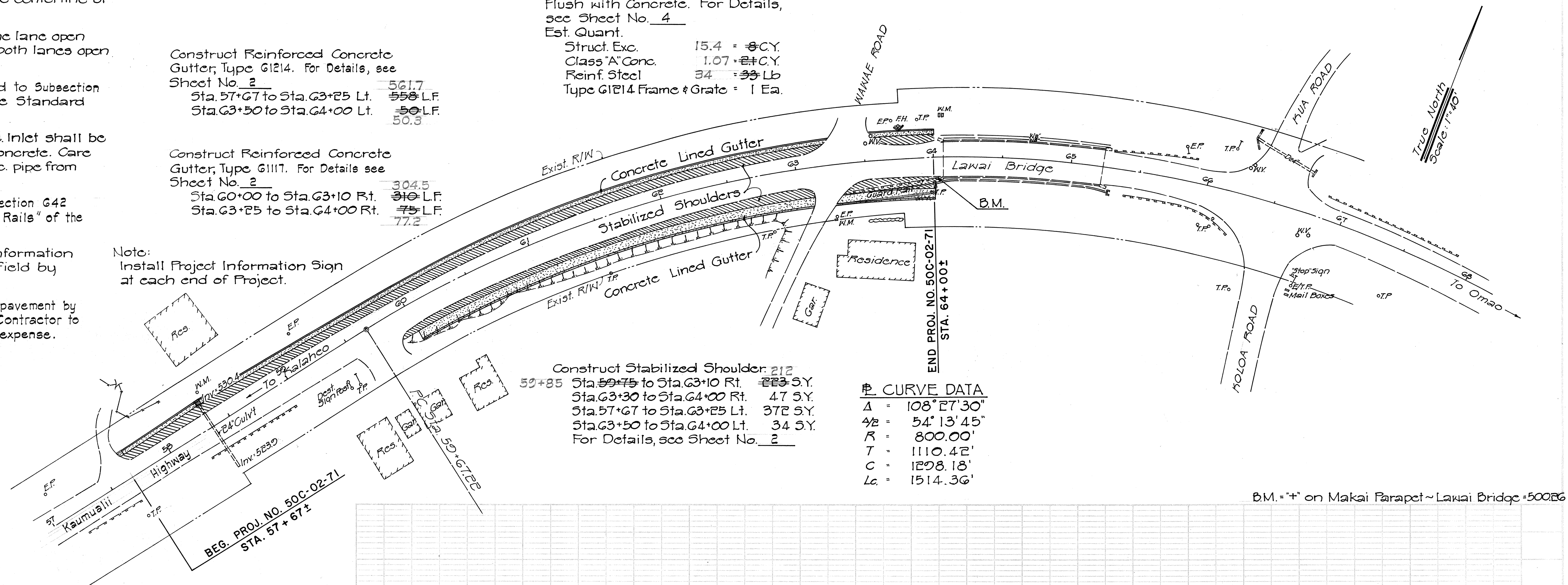

SHEET NO. 1 OF 1 SHEET