

REPAIR NOTES:

1. Remove loose or delaminated concrete above corroded reinforcing steel. Remove all loose corrosion buildup from exposed rebars.
2. Once initial removal are made, proceed with undercutting of all exposed corroded bars.
- 1 Provide 3/4 inch clearance between exposed rebars and surrounding concrete or 1/4 inch larger than the largest aggregate in repair material, whichever is greater.
3. Concrete removals shall extend along the bars to locations along the bar free of bond inhibiting corrosion, and where the bar is well bonded to surrounding concrete.
4. If non-corroded reinforcing steel is exposed during the undercutting process, care shall be taken not to damage the bar's bond to surrounding concrete. If bond between bar and concrete is broken, undercutting of the bar shall be required.
5. Any reinforcement which is loose shall be secured in place by tying to other secured bars or by other approved methods.
6. Repair spall using polymer modified concrete per manufacturer's recommendation. Finish should match pattern of existing concrete surface.

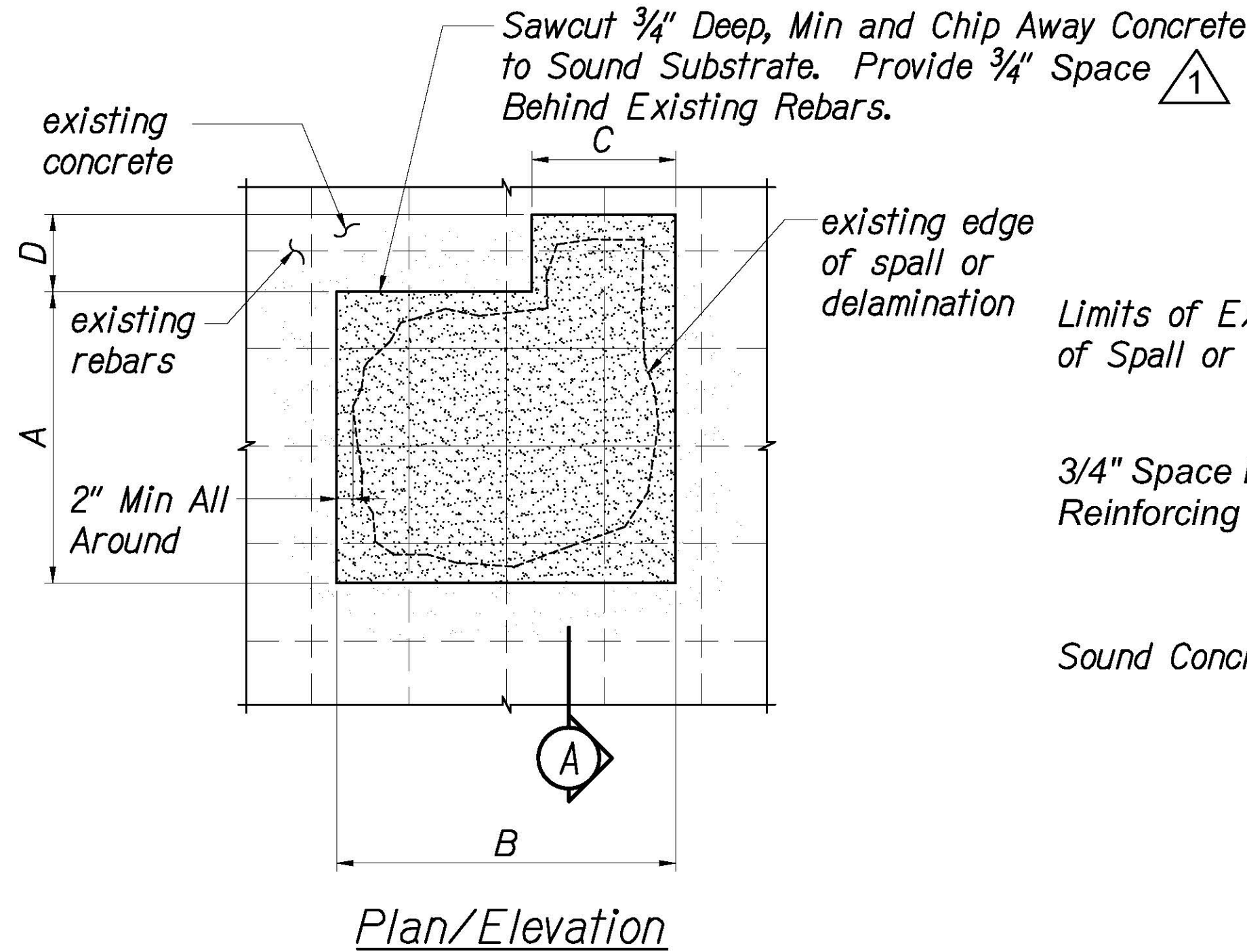

$$QTY. = (A+D) \times (B+C)$$

TYPE 1 SPALL REPAIR (S.F.) $\frac{1}{C-1b \mid C-1b}$
Not to Scale

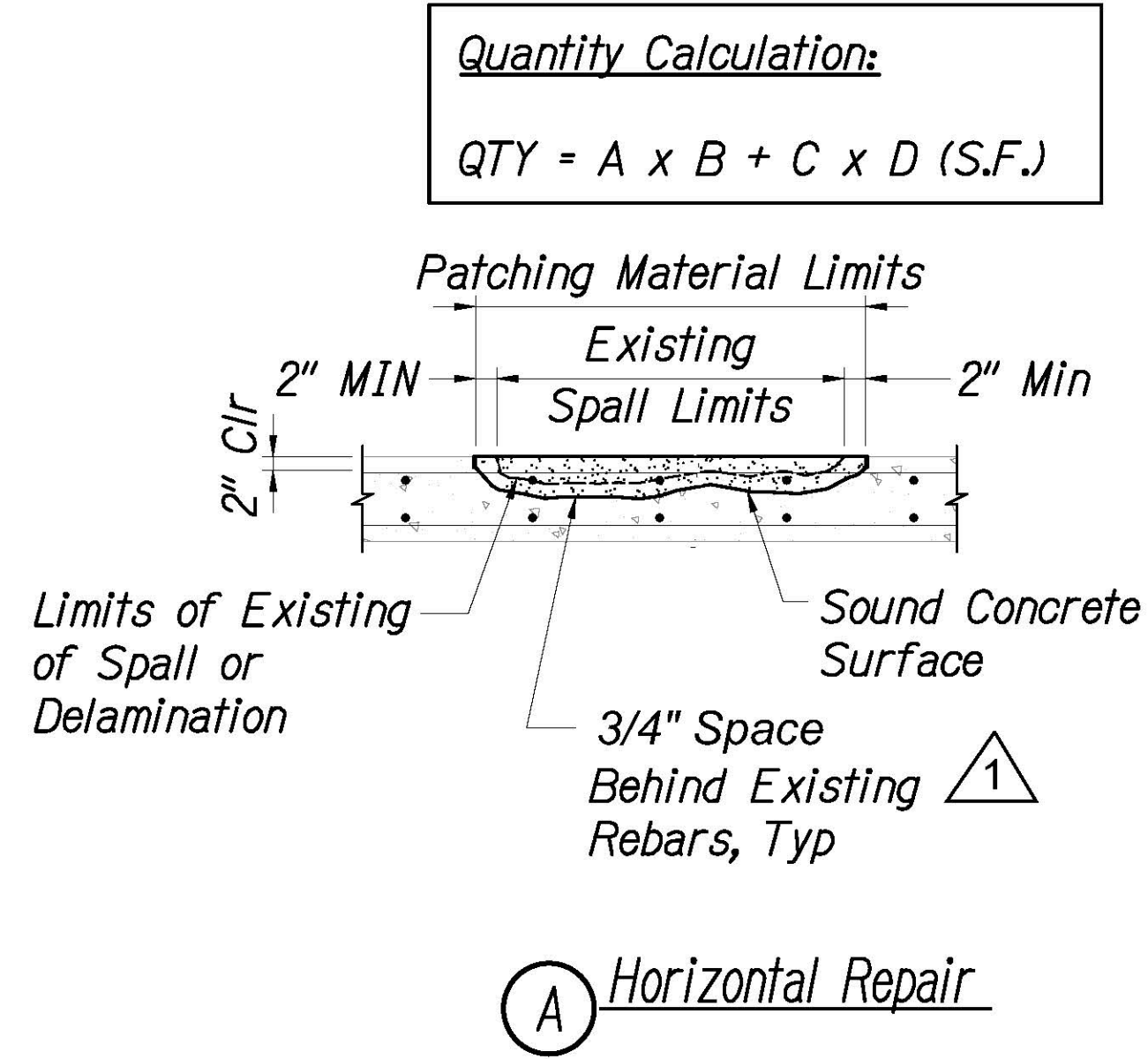
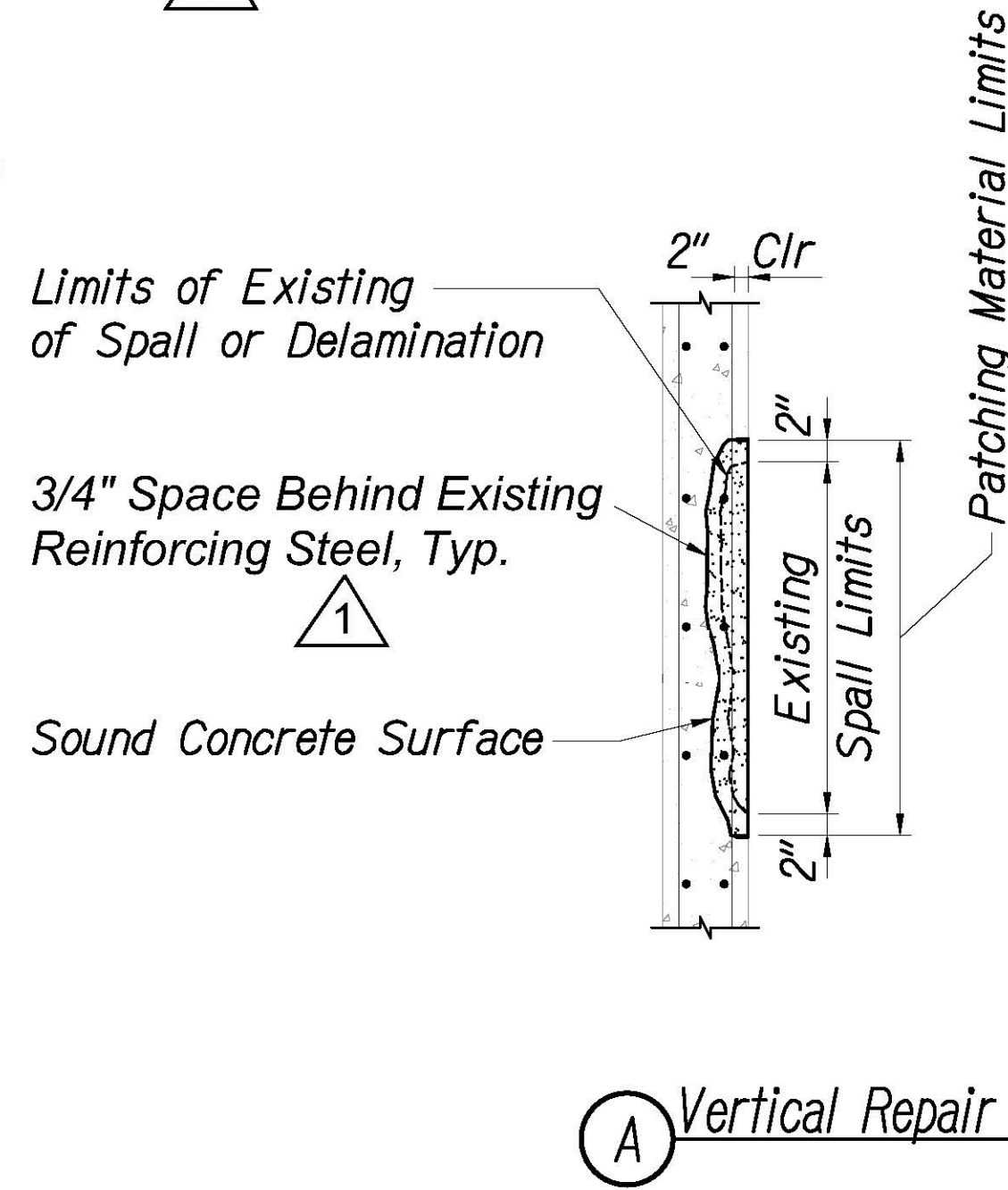

Quantity Calculation:
 $QTY = A \times B + C \times D$ (S.F.)

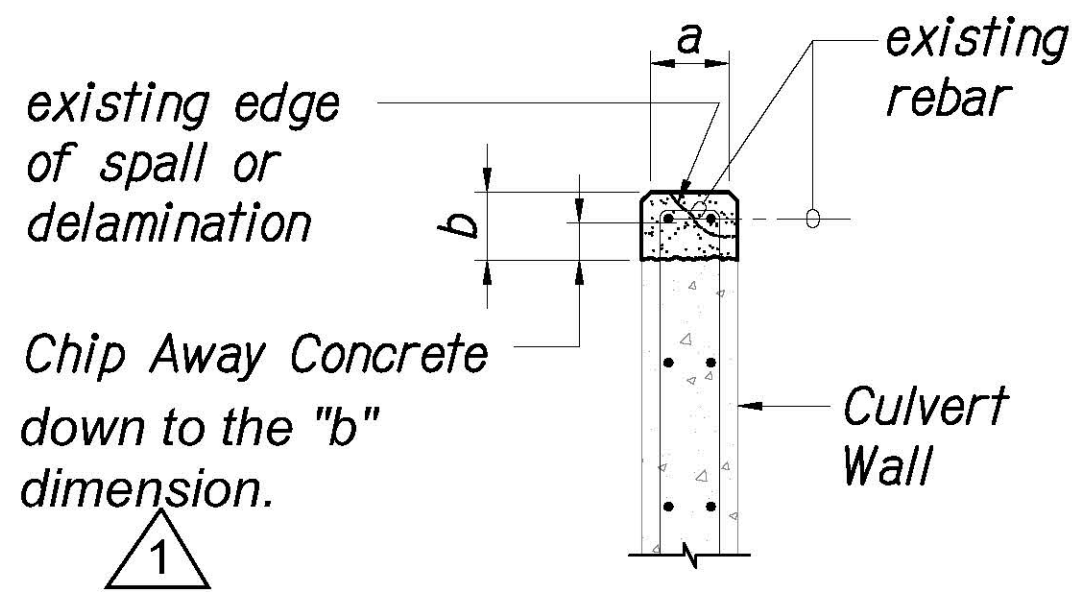

$$QTY. = (a+b) \times length$$

TYPE 2 SPALL REPAIR (S.F.) $\frac{2}{C-1b \mid C-1b}$
Not to Scale

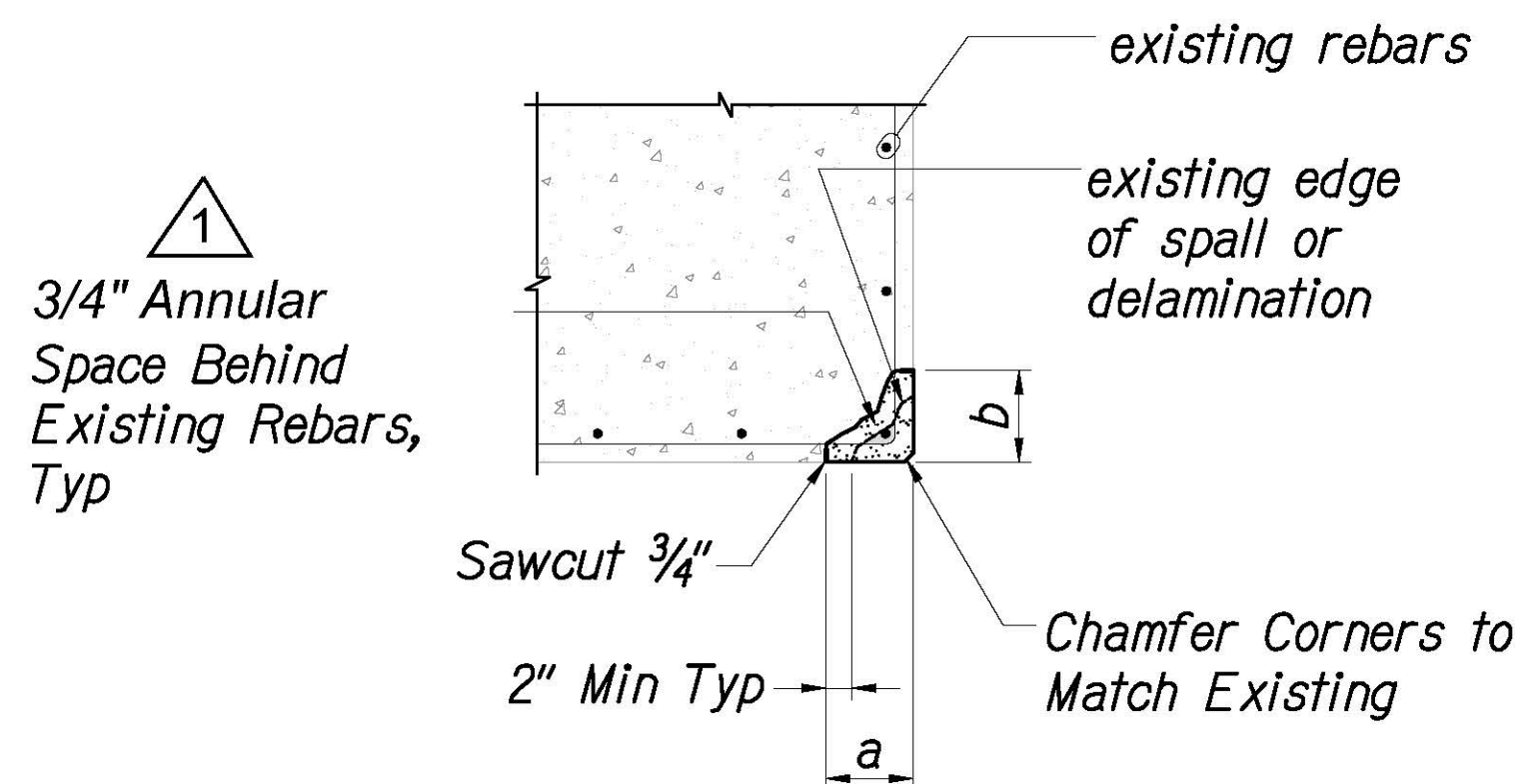

$$QTY. = (a+b) \times length$$

TYPE 3 SPALL REPAIR (S.F.) $\frac{3}{C-1b \mid C-1b}$
Not to Scale

| | | |
|---------------|-------------------|------|
| ORIGINAL PLAN | SURVEY PLOTTED BY | DATE |
| NOTE BOOK | DRAWN BY | |
| | DESIGNED BY | |
| | CHECKED BY | |

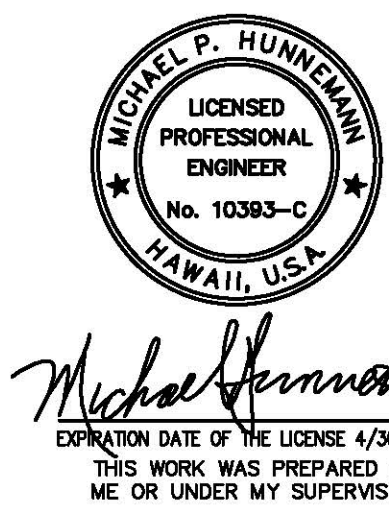

| | |
|--|---------------------------|
| 6/9/23 | 1 - Revised Notes |
| DATE | REVISION |
| STATE OF HAWAII DEPARTMENT OF TRANSPORTATION HIGHWAYS DIVISION TYPICAL SPALL REPAIR DETAILS MINOR BRIDGE REPAIRS AT VARIOUS LOCATIONS, PART 1 KAUAI, HAWAII PROJECT NO. HWY-K-02-23M Scale: As Shown Date: May 2023 | |
| C-1F | SHEET No. 10 OF 41 SHEETS |