

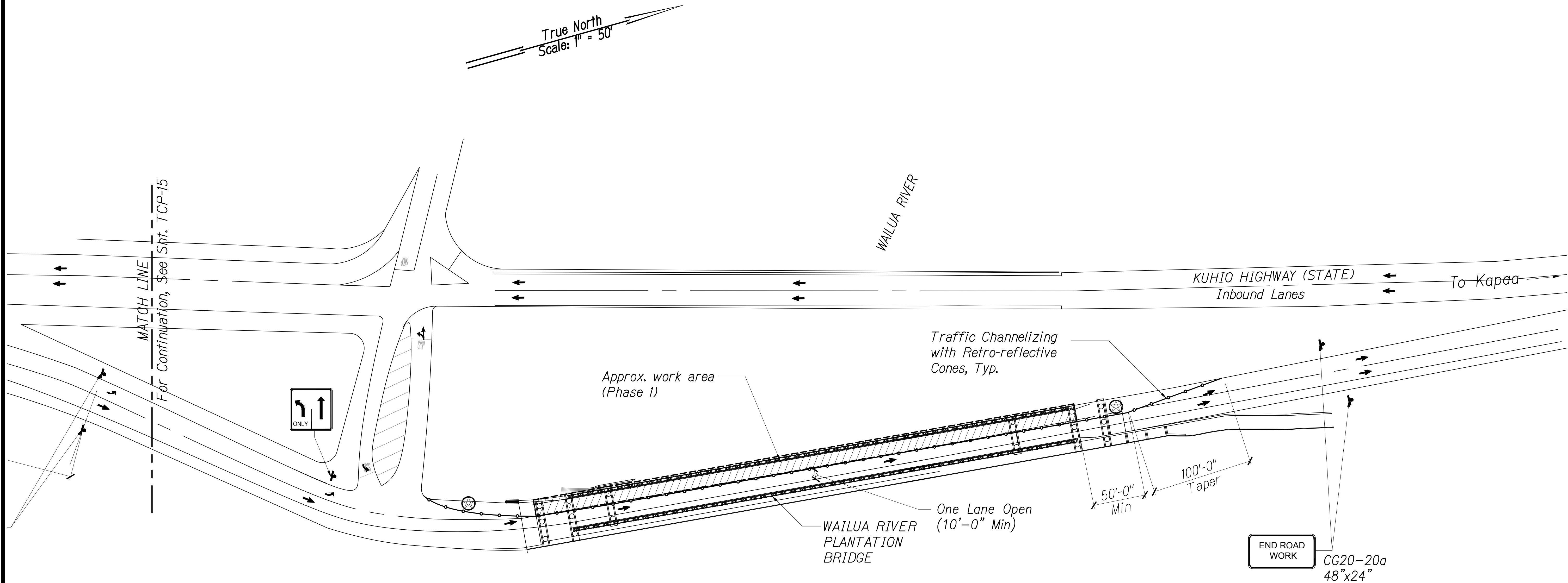

FED. ROAD DIST. NO.	STATE	FED. AID PROJ. NO.	FISCAL YEAR	SHEET NO.	TOTAL SHEETS
KAUAI	HAW.	HWY-K-02-23M	2023	39	41

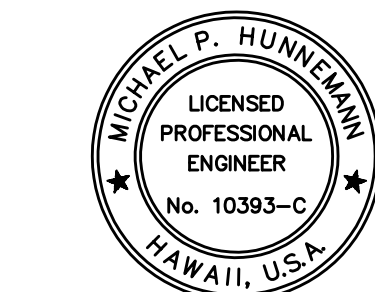

WAILUA RIVER PLANTATION BRIDGE  
PHASE 1 - TRAFFIC CONTROL PLAN 2  
Scale: 1"=50'



*Michael P. Hunneman*  
EXPIRATION DATE OF THE LICENSE 4/30/2024  
THIS WORK WAS PREPARED BY  
ME OR UNDER MY SUPERVISION

STATE OF HAWAII  
DEPARTMENT OF TRANSPORTATION  
HIGHWAYS DIVISION

**TRAFFIC CONTROL PLAN - 2**  
**WAILUA RIVER PLANTATION BRIDGE**

MINOR BRIDGE REPAIRS AT  
VARIOUS LOCATIONS, PART 1  
KAUAI, HAWAII  
PROJECT NO. HWY-K-02-23M

Scale: As Shown      Date: May 2023

ORIGINAL PLAN	SURVEY PLOTTED BY _____	DATE _____
NOTE BOOK	DRAWN BY _____	_____
No. _____	TRACED BY _____	_____
	DESIGNED BY _____	_____
	CHECKED BY _____	_____

FED. ROAD DIST. NO.	STATE	FED. AID PROJ. NO.	FISCAL YEAR	SHEET NO.	TOTAL SHEETS
KAUAI	HAW.	HWY-K-02-23M	2023	40	41

True North  
Scale: 1" = 50'

- NOTES:
- Contractor shall demolish and replace expansion joints in two phases to minimize impact to the traffic.
  - Lane closure will only be allowed at night. No daytime lane closures are allowed. See additional notes on C-1 and TCP-1.

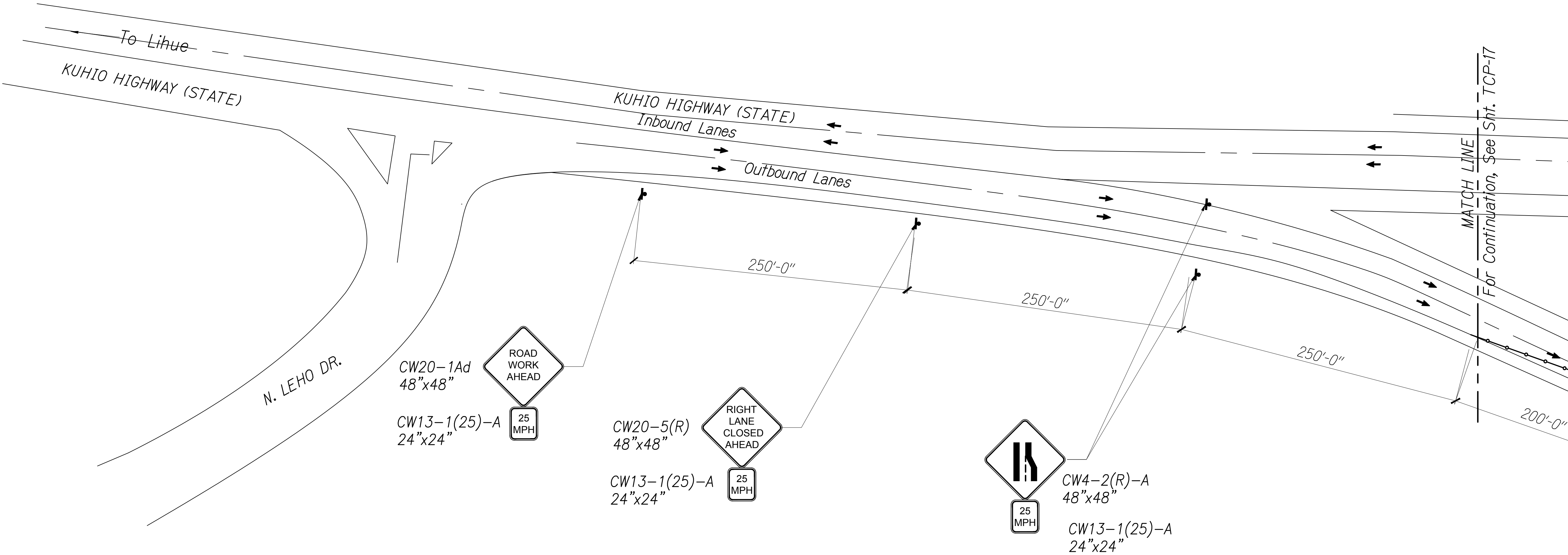

WAILUA RIVER PLANTATION BRIDGE  
PHASE 2 - TRAFFIC CONTROL PLAN 1  
Scale: 1"=50'

ORIGINAL PLAN	SURVEY PLOTTED BY	DATE
NOTE BOOK	DRAWN BY	
	TRACED BY	
	CHECKED BY	
	APPROVED BY	
	DESIGNED BY	
	CHECKED BY	
No.		

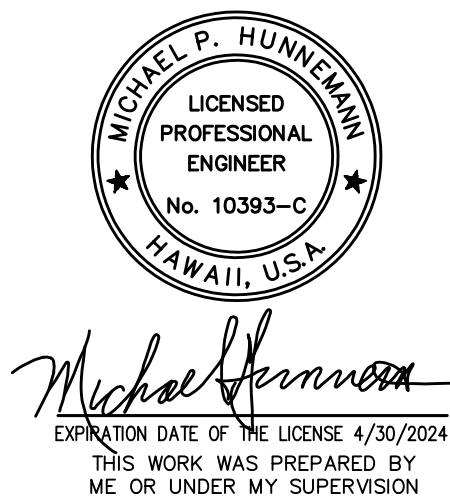

STATE OF HAWAII  
DEPARTMENT OF TRANSPORTATION  
HIGHWAYS DIVISION

**TRAFFIC CONTROL PLAN - 1**  
**WAILUA RIVER PLANTATION BRIDGE**

MINOR BRIDGE REPAIRS AT  
VARIOUS LOCATIONS, PART 1  
KAUAI, HAWAII  
PROJECT NO. HWY-K-02-23M

Scale: As Shown Date: May 2023

TCP 17 SHEET No. 40 OF 41 SHEETS

