

INDEX TO DRAWINGS	
SHEET NO.	DESCRIPTION
1	TITLE SHEET WITH GENERAL NOTES AND ESTIMATED QUANTITIES
2	WAILUA BRIDGE ; PART LAYOUT PLAN & SECTION
3	FRAMING PLAN & DETAILS
4 & 5	SECTIONS & DETAILS
6	WAINIHA BRIDGE NO. 2; PLAN & SECTIONS
7	TYPICAL DETAILS
8	STANDARD PLAN SUMMARY

STATE OF HAWAII
DEPARTMENT OF TRANSPORTATION
HIGHWAYS DIVISION
"AS-BUILT"
PLANS FOR
WAILUA BRIDGE, PREPARATION AND
PAINTING OF STEEL SUPPORTS
PROJECT NO. HWY-K-03-88M
DISTRICT OF LIHUE
AND
WAINIHA BRIDGE NO. 2 PREPARATION AND
PAINTING OF STEEL
SUPERSTRUCTURE
PROJECT NO. HWY-K-01-88M
DISTRICT OF HANAIEI
ISLAND OF KAUAI

GENERAL NOTES:

1. Scope of Work: cleaning and painting of steel supports of Wailua Bridge and steel superstructure of Wainiha Bridge No. 2.
2. All existing steel structures shall be painted with two prime coats and two finish coats. The prime coat shall be either Corrosal Rust converter and Primer on Steel Coat, Super Steel protection. The finish coat shall be Black Bridge Paint AASHTO M 88.
3. Application of anti-corrosive primer on metal surfaces prior to painting shall be in accordance to the manufacturer's recommendation subject to the approval of the Engineer.
4. Cleaning of metal surfaces by water blasting and wirebrushing, application of anti-corrosive primer and painting of all steel structures will not be measured separately, but all will be paid for on a lump sum basis under cleaning and painting of steel support of Wailua Bridge or steel superstructure of Wainiha Bridge No. 2.
5. All traveled lanes on the bridges shall be open to traffic at all times throughout the duration of the projects.
6. Plan sheet Nos. 2 to 7 are for information purposes only.
7. All dimensions of existing steel structures indicated on the plans shall be verified in the field by the Contractor.
8. Maximum gross vehicle loading on Wainiha Bridge No. 2 shall be limited to 8 tons.

ESTIMATED QUANTITIES

ITEM	METAL SURFACE	PRIME COAT	FINISH COAT
Cleaning and Painting of Steel supports of Wailua Bridge	2,150 S.F.	9 GAL.	7 GAL.
Cleaning and Painting of Steel Superstructure of Wainiha Bridge No. 2	4,072 S.F.	17 GAL.	12 GAL.

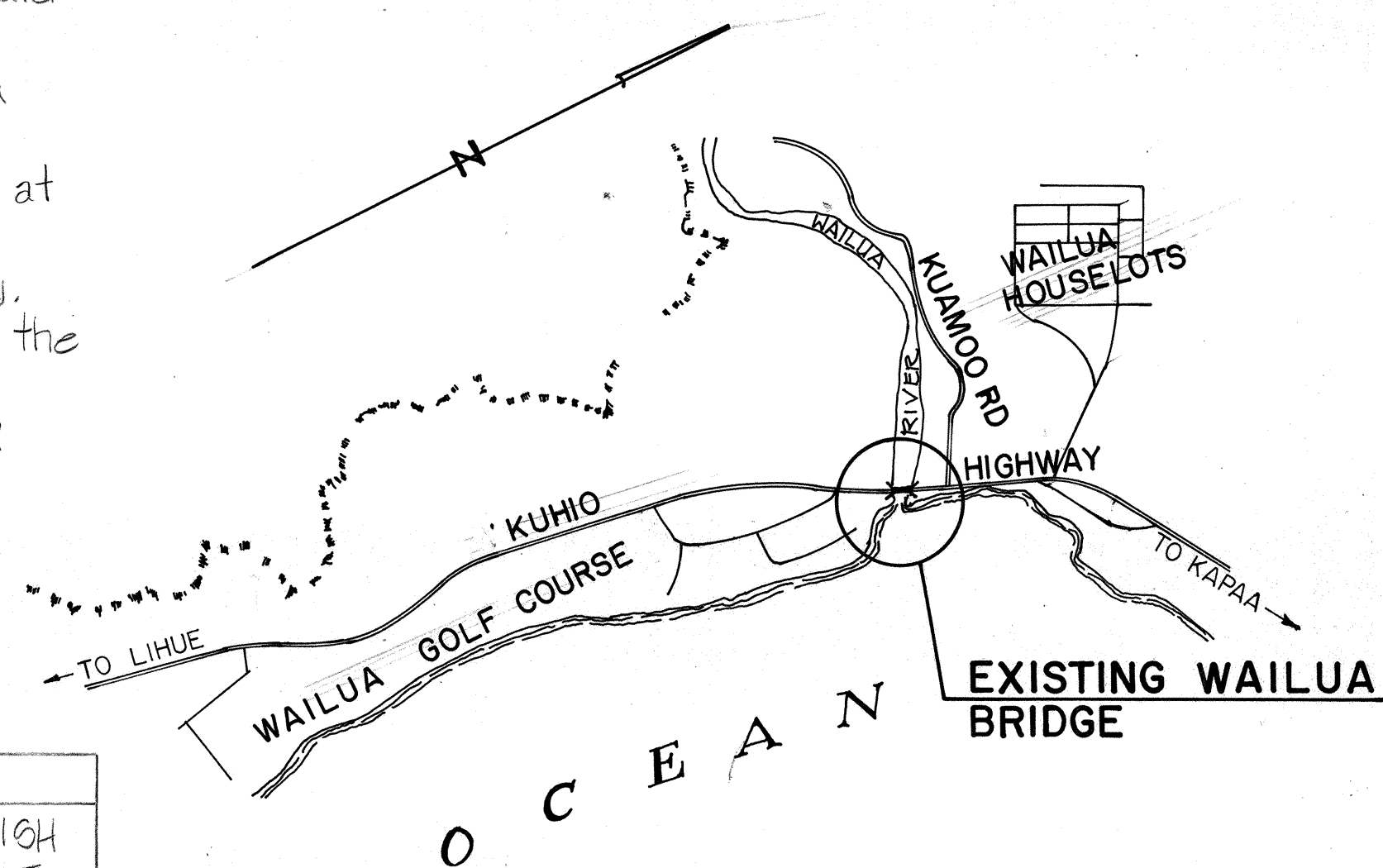

LAYOUT OF PROJECT
NOT TO SCALE

NO SIGNIFICANT CHANGES WERE MADE DURING CONSTRUCTION ON THESE PLANS EXCEPT CHANGES IN THE ORIGINAL THEORETICAL QUANTITIES. FOR ACTUAL QUANTITIES, REFER TO PROJECT LEDGER AND/OR COMPUTATION BOOK.

David H. Muehle
RESIDENT ENGINEER

4/21/89
DATE

PROJECT LOCATION
PROJ. NO. HWY-K-01-88M

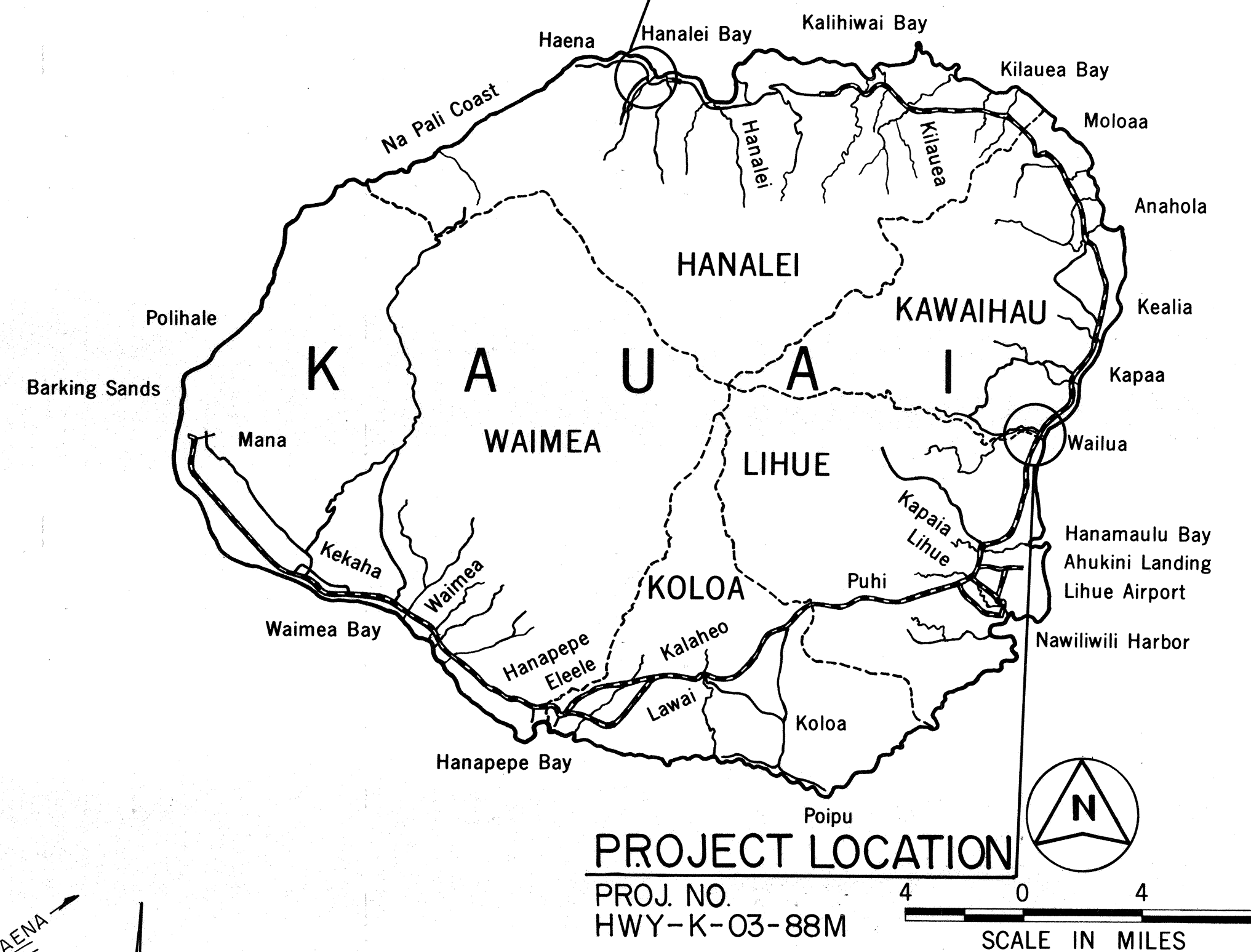

PROJECT LOCATION
PROJ. NO. HWY-K-03-88M
SCALE IN MILES

FEDERAL AID PROJECTS PREVIOUSLY CONSTRUCTED OR UNDER CONSTRUCTION

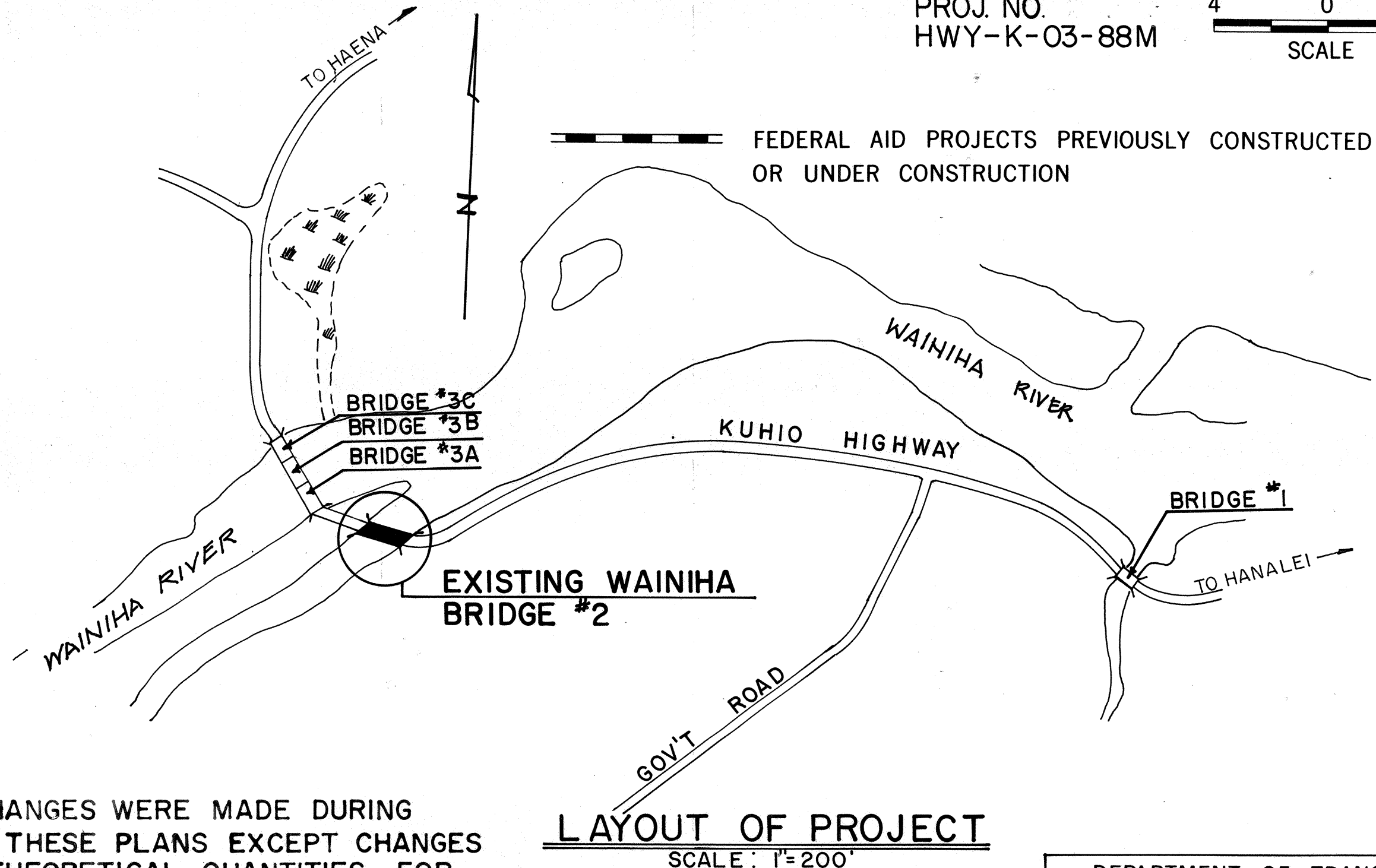

LAYOUT OF PROJECT
SCALE: 1"=200'

DEPARTMENT OF TRANSPORTATION
STATE OF HAWAII

APPROVED: *Edmund J. Davis* 5/20/89
DIR. OF TRANSPORTATION DATE

KAUAI DISTRICT R. TAKAESU 548-4125 MAY 1988
DESIGNED BY P. S. & E. BY DATE PHONE