

FED. ROAD DIST. NO.	STATE	FED. AID PROJ. NO.	FISCAL YEAR	SHEET NO.	TOTAL SHEETS
HAWAII	HAW.	STP-0700(38)	1998	28	29

LEGEND

- 4" or 8" White Edge Stripe with Type C Raised Pavement Markers @ 40'-0" o.c. (Tape, Type II or Thermoplastic Extrusion)
- 4" White Guide Lines (Tape, Type III or Thermoplastic Extrusion except for bus bays)
- Transverse Shoulder Marking (Tape, Type II or Thermoplastic Extrusion)

NOTES

- Layout of pavement markings and striping shall be done by the Contractor and approved by the Engineer prior to any installation work.
- Existing pavement markings not incorporated in the final traffic pattern shall be removed as directed by the Engineer. Costs shall be incidental to the various pavement marking items.
- Raised pavement markers shall not be installed within crosswalks.
- Final locations of all signs shall be approved by the Engineer prior to any installation work.
- Existing signs not shown on these plans shall remain as posted unless otherwise directed by the Engineer. Removal and disposal of existing signs and/or posts as designated on these plans or directed by the Engineer shall be incidental to the various signing items.
- All pavement striping shall be as noted on the legend or plans.
- All preformed pavement marking tapes over existing pavement shall be applied with an approved primer as recommended by the tape manufacturer and as approved by the Engineer. The primer shall be allowed to dry to the tacky stage prior to tape application.
- Removal of existing Delineators and Posts as directed by the Engineer shall be considered incidental to the various signing items.
- Existing signs that are to be replaced shall not be removed until new signs are installed as replacements, or the messages are no longer necessary.
- Backing for all new regulatory and warning signs shall not be spliced.
- All sign panels shall conform to Section 621 of Special Provisions and the latest editions and amendments of the following FHWA publications:
 - "Manual on Uniform Traffic Control Devices fro Street and Highweays"(MUTCD)
 - "Standard Highway Signs"
 - "Standard Allhabets for Highway Signs"
- The Contractor shall erect at the beginning of the project and at the end of the project advance construction warning signs placed as indicated hereon or as directed by the Engineer for the duration of the highway project and shall be maintained by the contractor. These signs shall be placed in addition to the required traffic control signs called for in Section 645-Traffic Control. The advance construction warning signs shall be new and become the property of the State. the Contractor shall remove, clean, and deliver the signs and posts to the Kauai District Baseyard , in Kapaa, upon completion of the project.

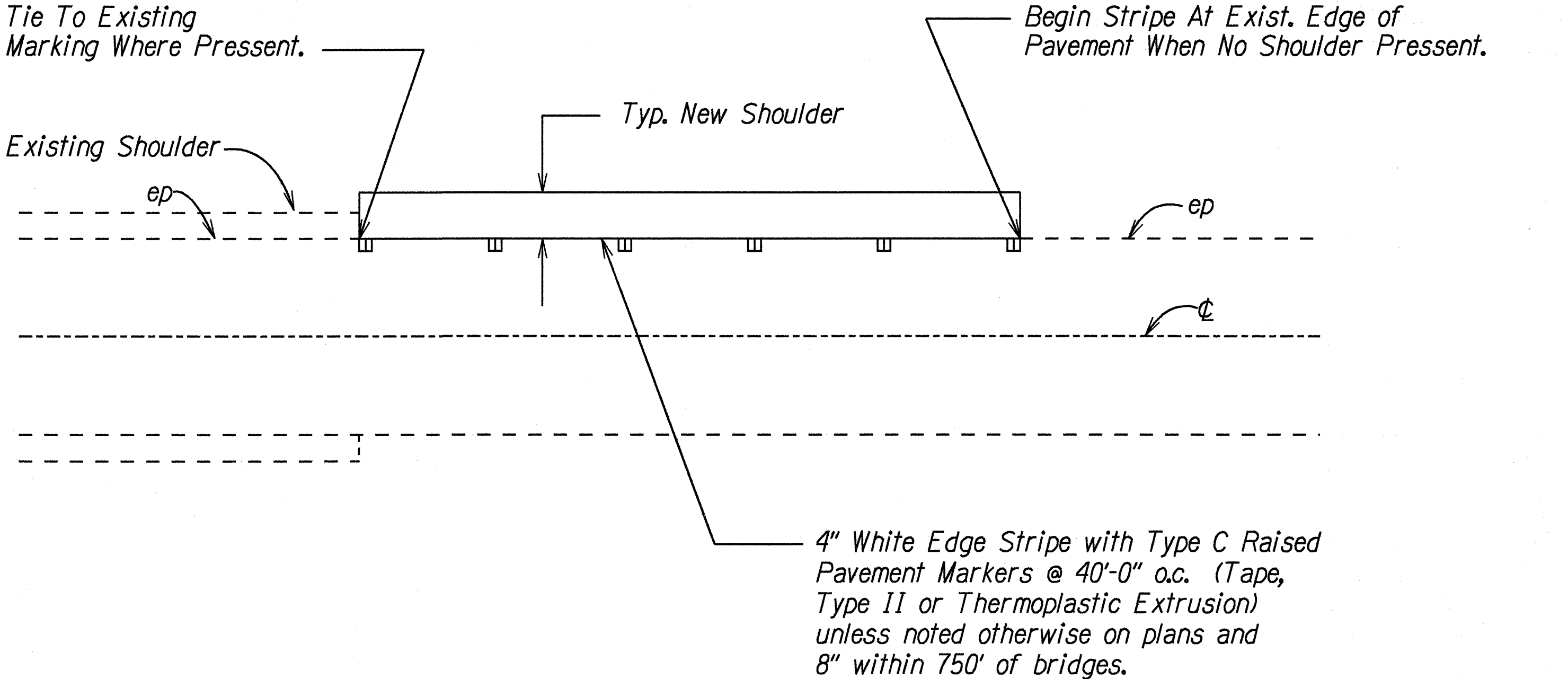
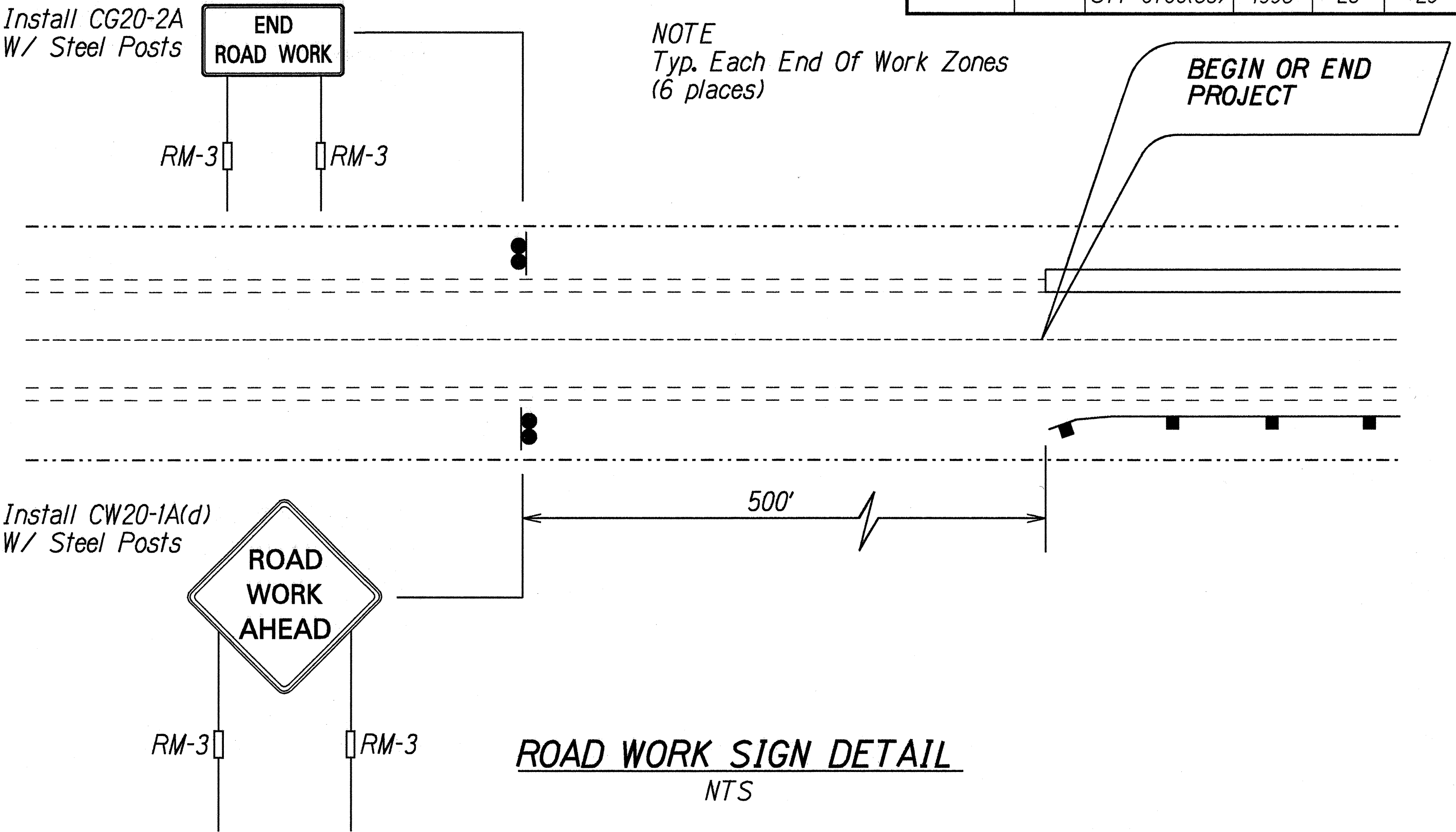

ORIGINAL PLAN	SURVEY PLOTTED BY	DATE
NOTED	DRAWN BY	
NOTED	TRACED BY	
NOTED	DESIGNED BY	
NOTED	CHECKED BY	
NOTED	CHECKED BY	

STATE OF HAWAII DEPARTMENT OF TRANSPORTATION HIGHWAYS DIVISION
TRAFFIC MARKING LEGEND, DETAILS & NOTES
RICE ST., KUHIO HWY. & KUAMOO RD GUARDRAIL AND SHOULDER IMPROVEMENTS AT VARIOUS LOCATIONS FEDERAL AID PROJECT NO. STP-0700(38)
Scale: None Date: Sept, 1996
SHEET No. 1 OF 1 SHEETS