

FED. ROAD DIST. NO.	STATE	PROJ. NO.	FISCAL YEAR	SHEET NO.	TOTAL SHEETS
HAWAII	HAW.	50E-01-90	1996	2	2

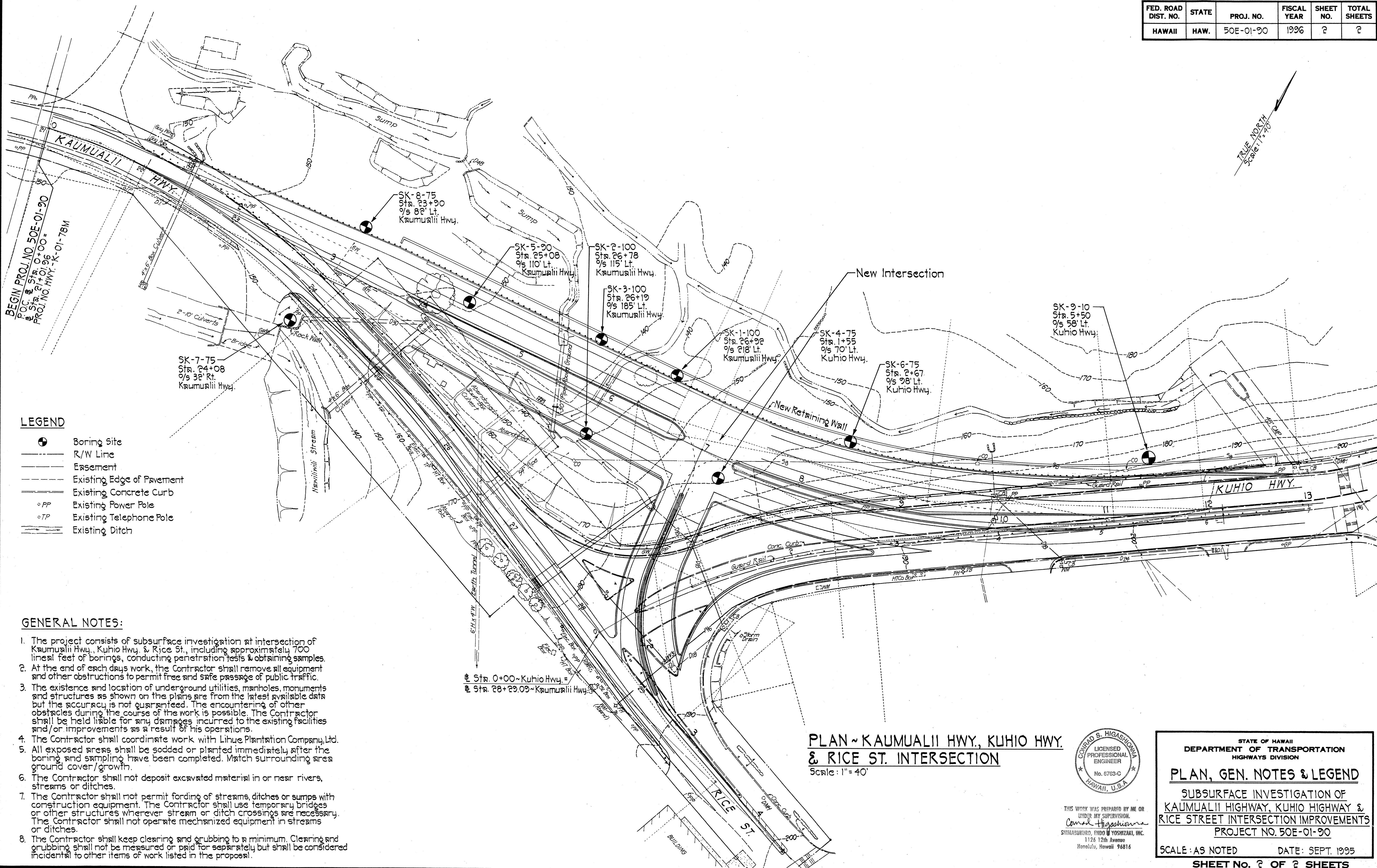

- LEGEND**
- Boring Site
 - R/W Line
 - Easement
 - Existing Edge of Pavement
 - Existing Concrete Curb
 - PP Existing Power Pole
 - TP Existing Telephone Pole
 - Existing Ditch

GENERAL NOTES:

1. The project consists of subsurface investigation at intersection of Kaumualii Hwy., Kuhio Hwy. & Rice St., including approximately 700 linear feet of borings, conducting penetration tests & obtaining samples.
2. At the end of each days work, the Contractor shall remove all equipment and other obstructions to permit free and safe passage of public traffic.
3. The existence and location of underground utilities, manholes, monuments and structures as shown on the plans are from the latest available data but the accuracy is not guaranteed. The encountering of other obstacles during the course of the work is possible. The Contractor shall be held liable for any damages incurred to the existing facilities and/or improvements as a result of his operations.
4. The Contractor shall coordinate work with Lihue Plantation Company, Ltd.
5. All exposed areas shall be sodded or planted immediately after the boring and sampling have been completed. Match surrounding area ground cover/growth.
6. The Contractor shall not deposit excavated material in or near rivers, streams or ditches.
7. The Contractor shall not permit fording of streams, ditches or sumps with construction equipment. The Contractor shall use temporary bridges or other structures wherever stream or ditch crossings are necessary. The Contractor shall not operate mechanized equipment in streams or ditches.
8. The Contractor shall keep clearing and grubbing to a minimum. Clearing and grubbing shall not be measured or paid for separately but shall be considered incidental to other items of work listed in the proposal.

**PLAN ~ KAUMUALII HWY., KUHIO HWY.
& RICE ST. INTERSECTION**
Scale: 1" = 40'

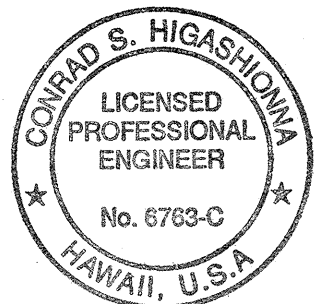

THIS WORK WAS PREPARED BY ME OR UNDER MY SUPERVISION.
Conrad S. Higashimura
SITILABUKIRO, ENDO & YOSHIZAKI, INC.
1126 12th Avenue
Honolulu, Hawaii 96816

STATE OF HAWAII
DEPARTMENT OF TRANSPORTATION
HIGHWAYS DIVISION

PLAN, GEN. NOTES & LEGEND

SUBSURFACE INVESTIGATION OF
KAUMUALII HIGHWAY, KUHIO HIGHWAY &
RICE STREET INTERSECTION IMPROVEMENTS
PROJECT NO. 50E-01-90

SCALE: AS NOTED DATE: SEPT. 1995
SHEET NO. 2 OF 2 SHEETS