

FED. ROAD DIST. NO.	STATE	FED. AID PROJ. NO.	FISCAL YEAR	SHEET NO.	TOTAL SHEETS
HAWAII	HAW.	F-058-1(1)	1990	11	29

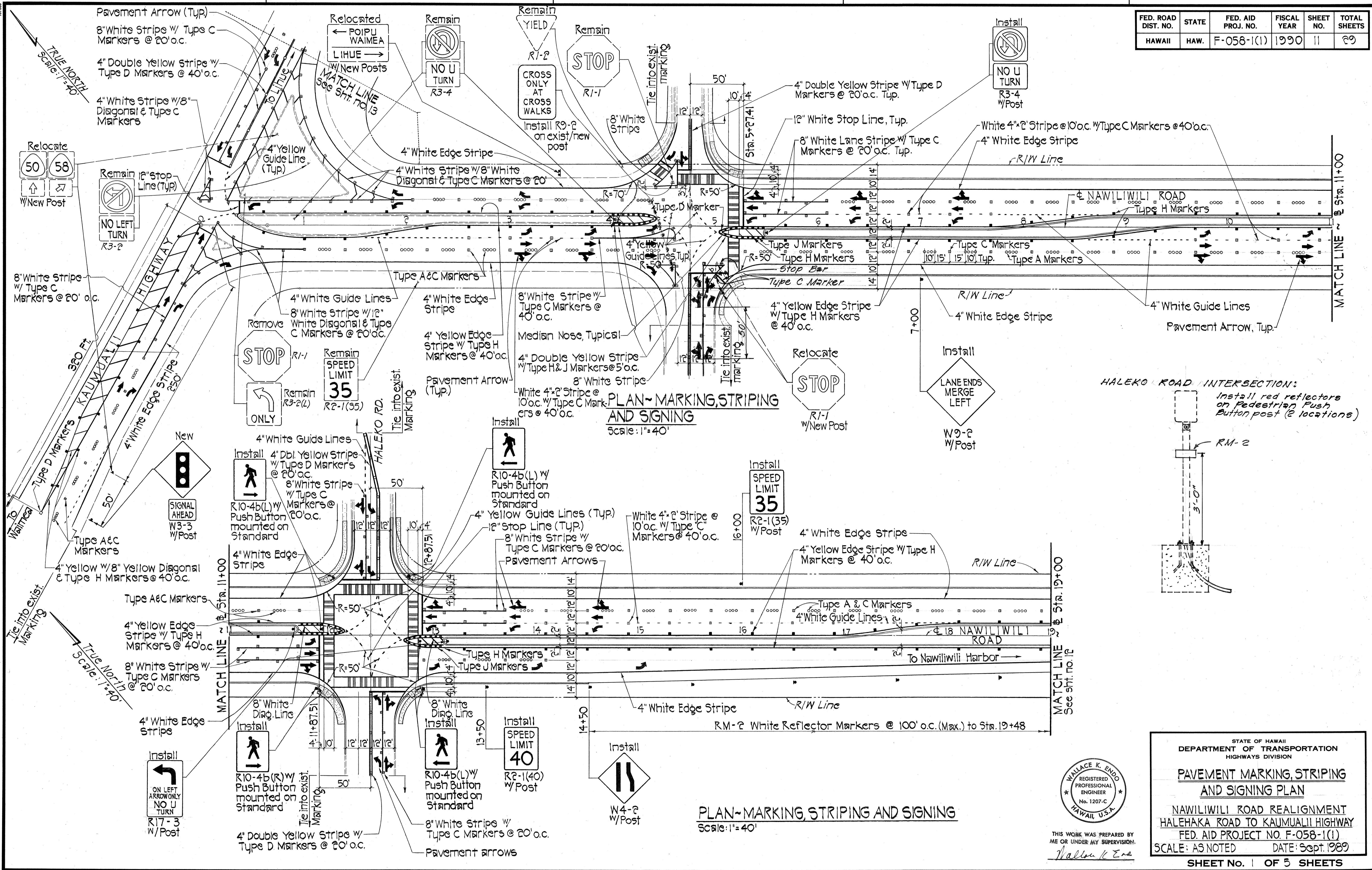

PLAN-MARKING, STRIPING AND SIGNING
Scale: 1"=40'

PLAN-MARKING, STRIPING AND SIGNING
Scale: 1"=40'

HALEKO ROAD INTERSECTION:
Install red reflectors on Pedestrian Push Button post (2 locations)
RM-2

DATE	_____
SURVEY PLOTTED BY	_____
DRAWN BY	_____
DESIGNED BY	_____
CHECKED BY	_____
ORIGINAL PLAN	_____
NOTE BOOK	_____
NO.	_____



THIS WORK WAS PREPARED BY ME OR UNDER MY SUPERVISION.
Wallace K. Endo

STATE OF HAWAII
DEPARTMENT OF TRANSPORTATION
HIGHWAYS DIVISION

PAVEMENT MARKING, STRIPING AND SIGNING PLAN

NAWILIWILI ROAD REALIGNMENT
HALEHAKA ROAD TO KAUMUALII HIGHWAY
FED. AID PROJECT NO. F-058-1(1)
SCALE: AS NOTED DATE: Sept. 1989

SHEET NO. 1 OF 5 SHEETS

FED. ROAD DIST. NO.	STATE	FED. AID PROJ. NO.	FISCAL YEAR	SHEET NO.	TOTAL SHEETS
HAWAII	HAW.	F-058-1(1)	1990	12	29

TRUE NORTH
Scale: 1" = 40'

True North
Scale: 1" = 40'

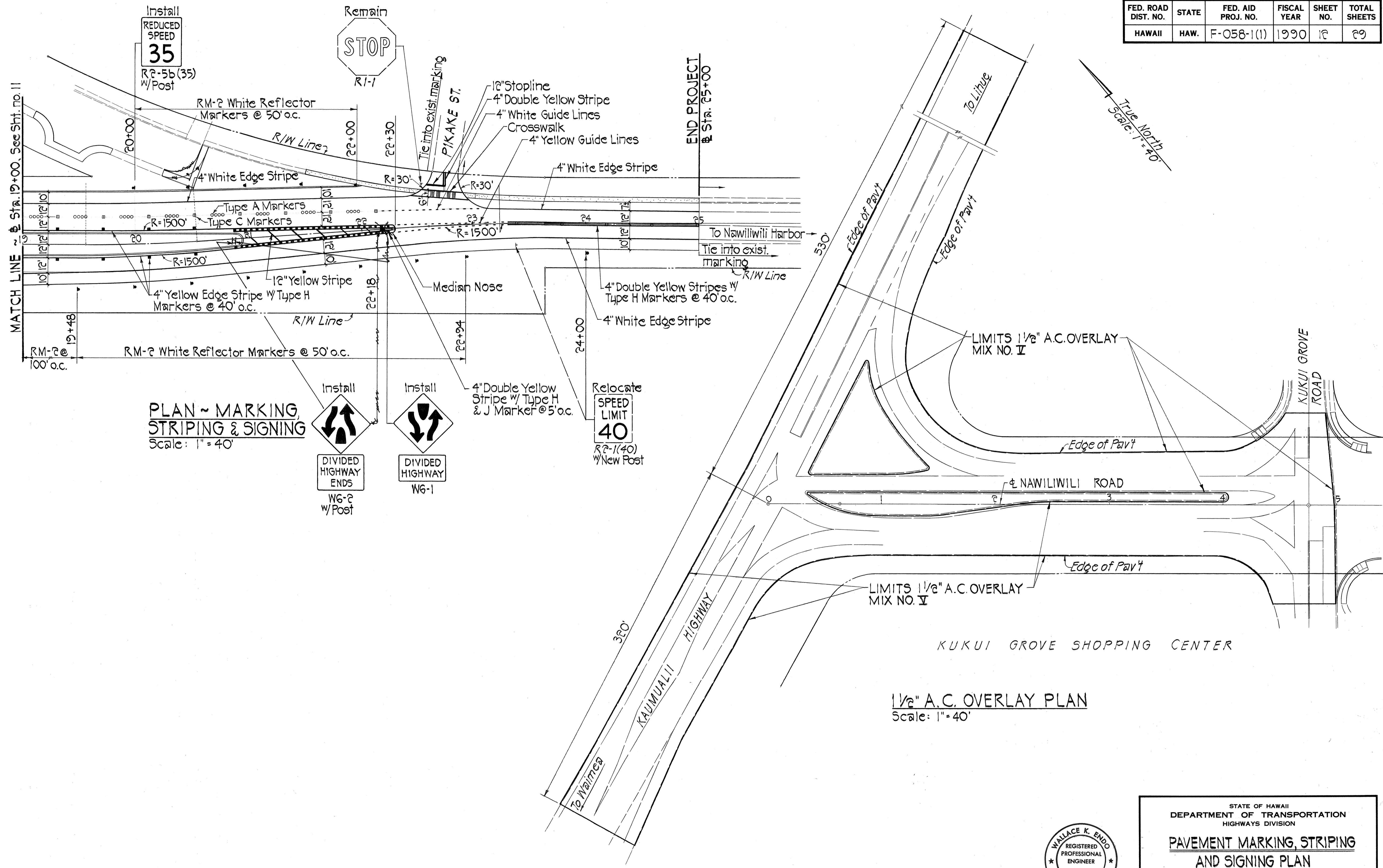

SURVEY PLOTTED BY	DATE
DRAWN BY	
TRACED BY	
DESIGNED BY	
CHECKED BY	
NO.	

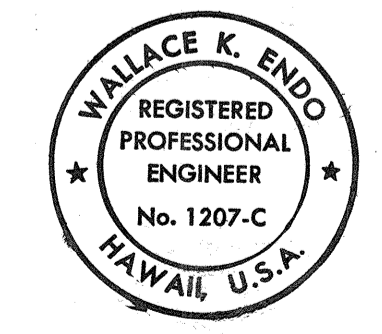

THIS WORK WAS PREPARED BY ME OR UNDER MY SUPERVISION.
Wallace K. Endo

STATE OF HAWAII
DEPARTMENT OF TRANSPORTATION
HIGHWAYS DIVISION

PAVEMENT MARKING, STRIPING AND SIGNING PLAN

NAWILIWILI ROAD REALIGNMENT
HALEHAKA ROAD TO KAUMUALII HIGHWAY
FED. AID PROJECT NO. F-058-1(1)
SCALE: AS NOTED DATE: Sept. 1989

SHEET No. 12 OF 5 SHEETS

FED. ROAD DIST. NO.	STATE	FED. AID PROJ. NO.	FISCAL YEAR	SHEET NO.	TOTAL SHEETS
HAWAII	HAW.	F-058-1(1)	1990	13	29

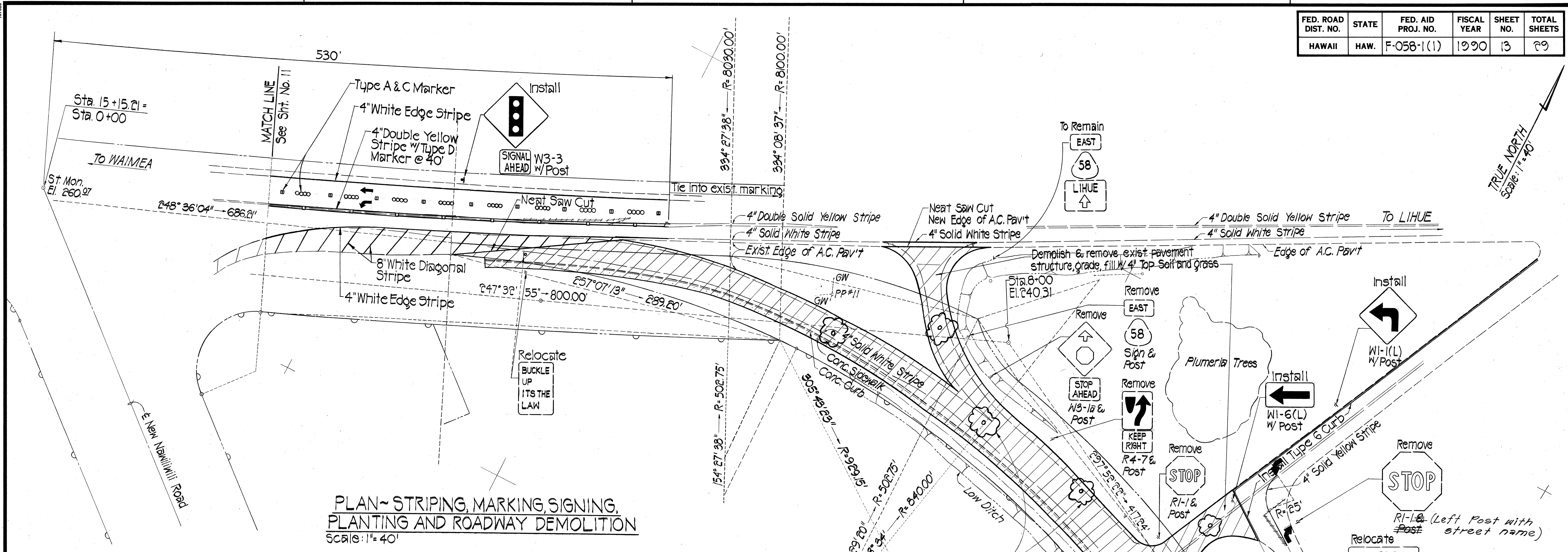

PLAN ~ STRIPING, MARKING, SIGNING, PLANTING AND ROADWAY DEMOLITION
Scale: 1" = 40'

PLANT LIST	
QUANTITY	COMMON AND BOTANICAL NAME
10 EA	KUKUI TREE - ALEURITES MOLUCCANA
58,000 SF	BURMUDA GRASS - CYNODON DACTYLON

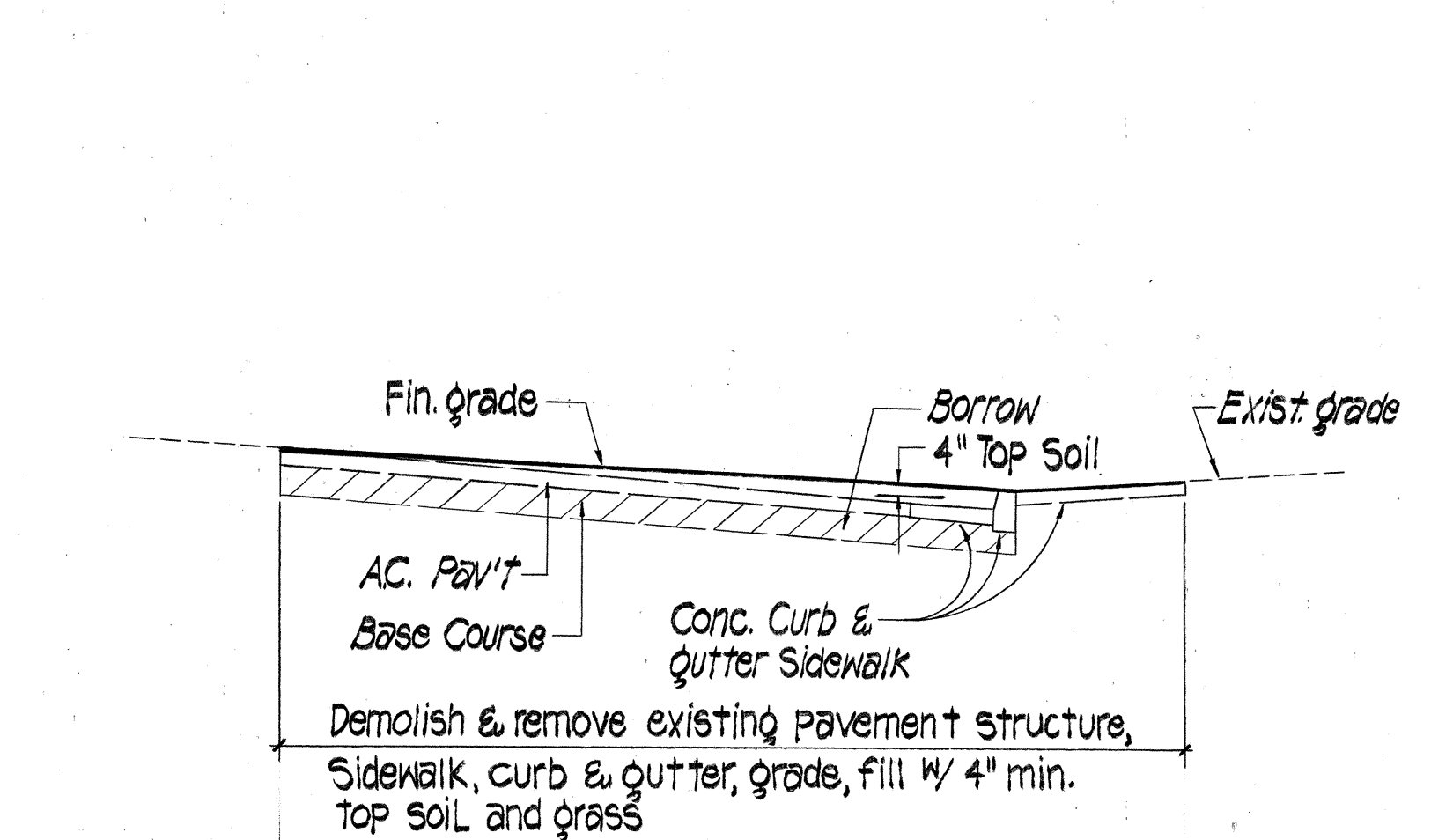

TYPICAL SECTION ~ ROADWAY DEMOLITION
Not to Scale

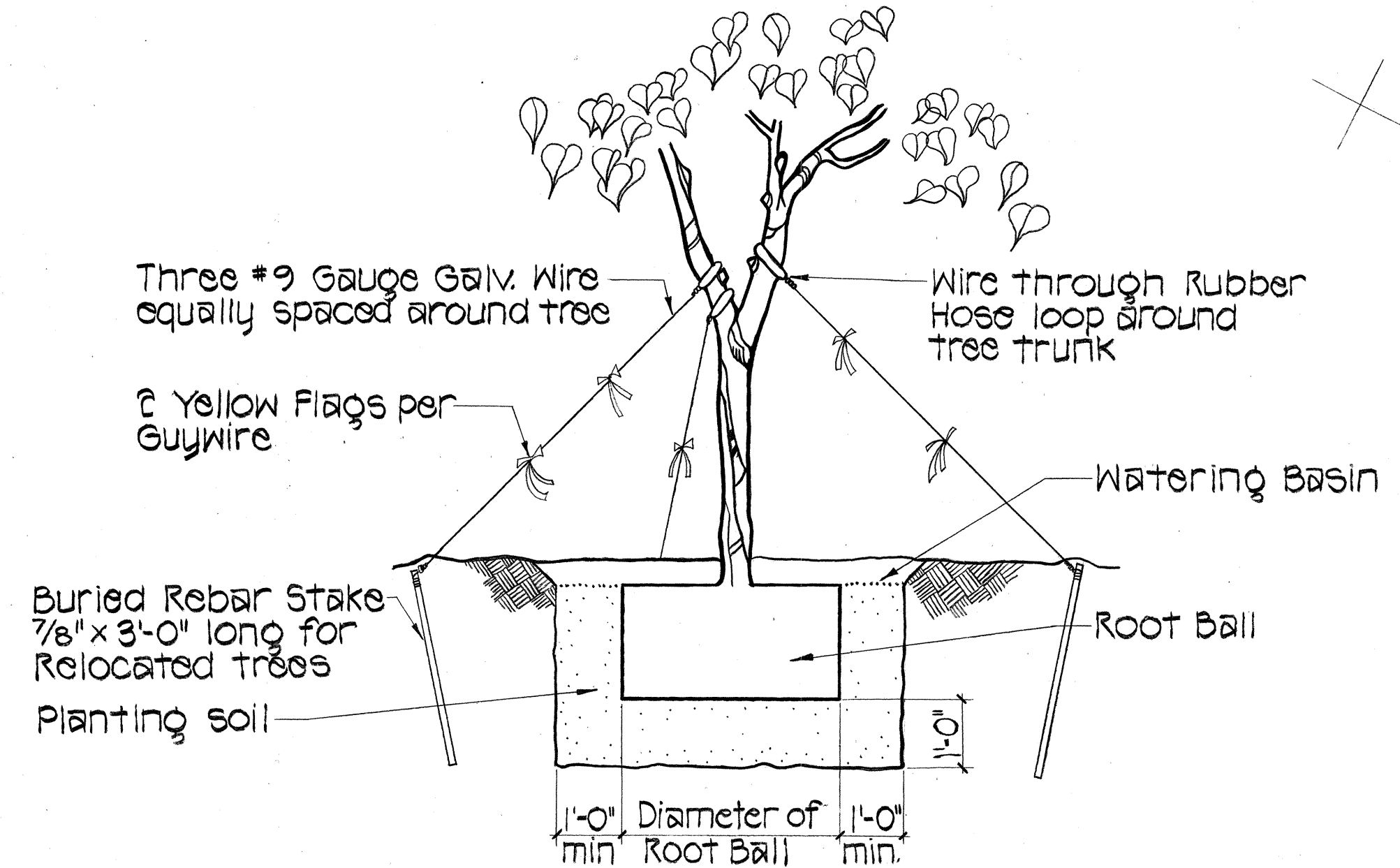

TRANSPLANTED TREE
Not to Scale

DATE	_____
SURVEY PLOTTED BY	_____
DRAWN BY	_____
DESIGNED BY	_____
CHECKED BY	_____
NO. _____	_____



THIS WORK WAS PREPARED BY ME OR UNDER MY SUPERVISION.
Harold I. Yoshizaki

STATE OF HAWAII
DEPARTMENT OF TRANSPORTATION
HIGHWAYS DIVISION

**PLAN ~ STRIPING, MARKING, SIGNING
PLANTING AND ROADWAY DEMOLITION**

NAWILIWILI ROAD REALIGNMENT
HALEHAKA ROAD TO KAUMUALII HIGHWAY
FED. AID PROJECT NO. F-058-1(1)
SCALE: AS NOTED DATE: Sept. 1989

SHEET No. 3 OF 5 SHEETS

FED. ROAD DIST. NO.	STATE	FED. AID PROJ. NO.	FISCAL YEAR	SHEET NO.	TOTAL SHEETS
HAWAII	HAW.	F-058-1(1)	1990	14	29

TRUE NORTH
Scale: 1"=40'

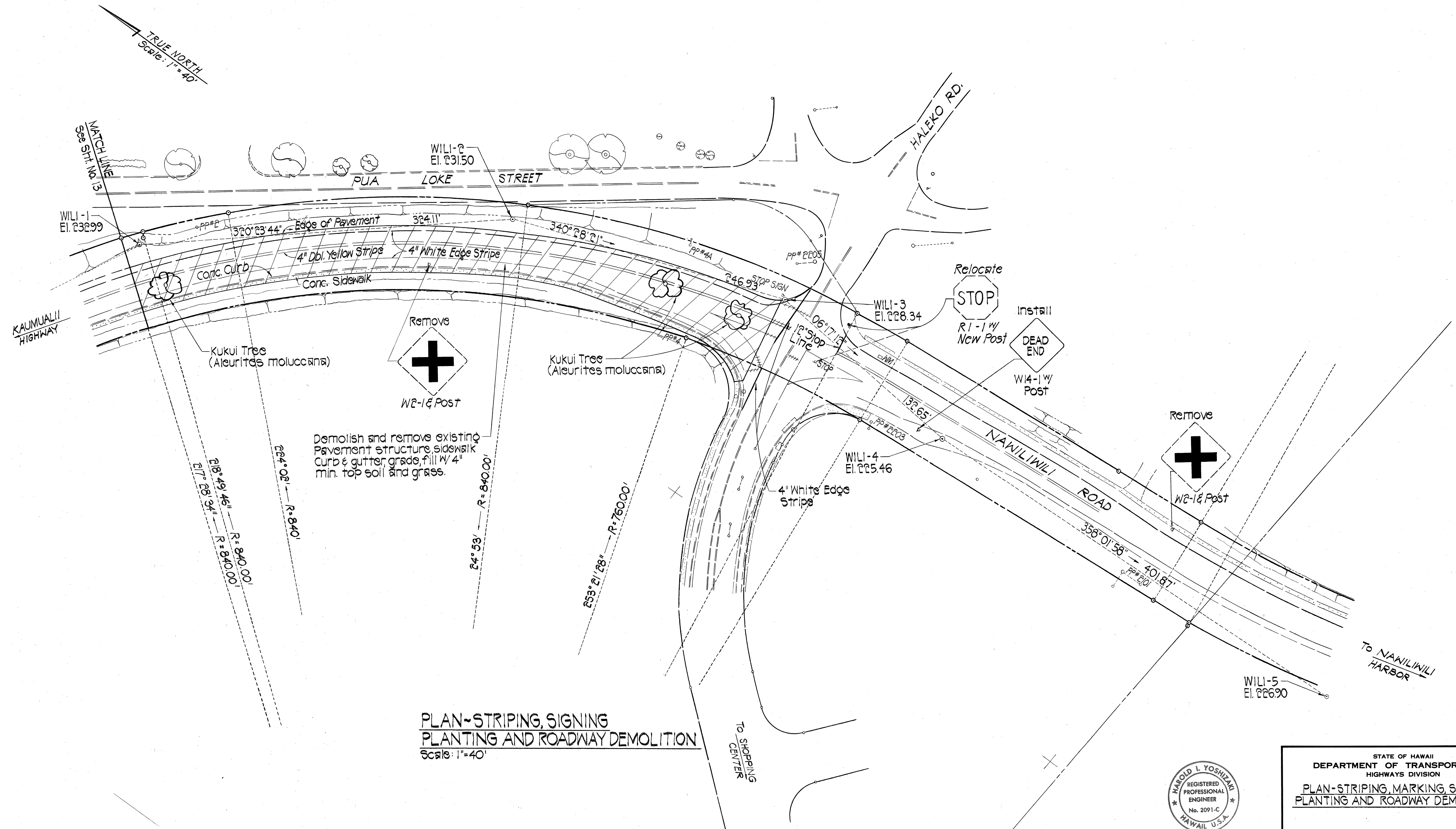

Demolish and remove existing
Pavement structure, sidewalk,
Curb & gutter, grade, fill w/ 4"
min. top soil and grass.

**PLAN-STRIPING, SIGNING
PLANTING AND ROADWAY DEMOLITION**
Scale: 1"=40'

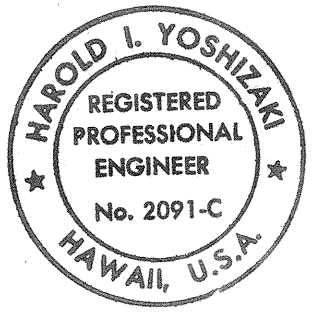

THIS WORK WAS PREPARED BY
ME OR UNDER MY SUPERVISION.
Harold I. Yoshizaki

STATE OF HAWAII
DEPARTMENT OF TRANSPORTATION
HIGHWAYS DIVISION

**PLAN-STRIPING, MARKING, SIGNING,
PLANTING AND ROADWAY DEMOLITION**

NAWILIWILI ROAD REALIGNMENT
HALEHAKA ROAD TO KAUMUALII HIGHWAY
FED. AID PROJECT NO. F-058-1(1)
SCALE: AS NOTED DATE: Sept. 1989

SHEET No. 4 OF 5 SHEETS

DATE	_____
SURVEY PLOTTED BY	_____
DRAWN BY	_____
TRACED BY	_____
DESIGNED BY	_____
CHECKED BY	_____
ORIGINAL PLAN No.	_____
NOTE BOOK No.	_____

FED. ROAD DIST. NO.	STATE	FED. AID PROJ. NO.	FISCAL YEAR	SHEET NO.	TOTAL SHEETS
HAWAII	HAW.	F-058-1(1)	1990	15	29

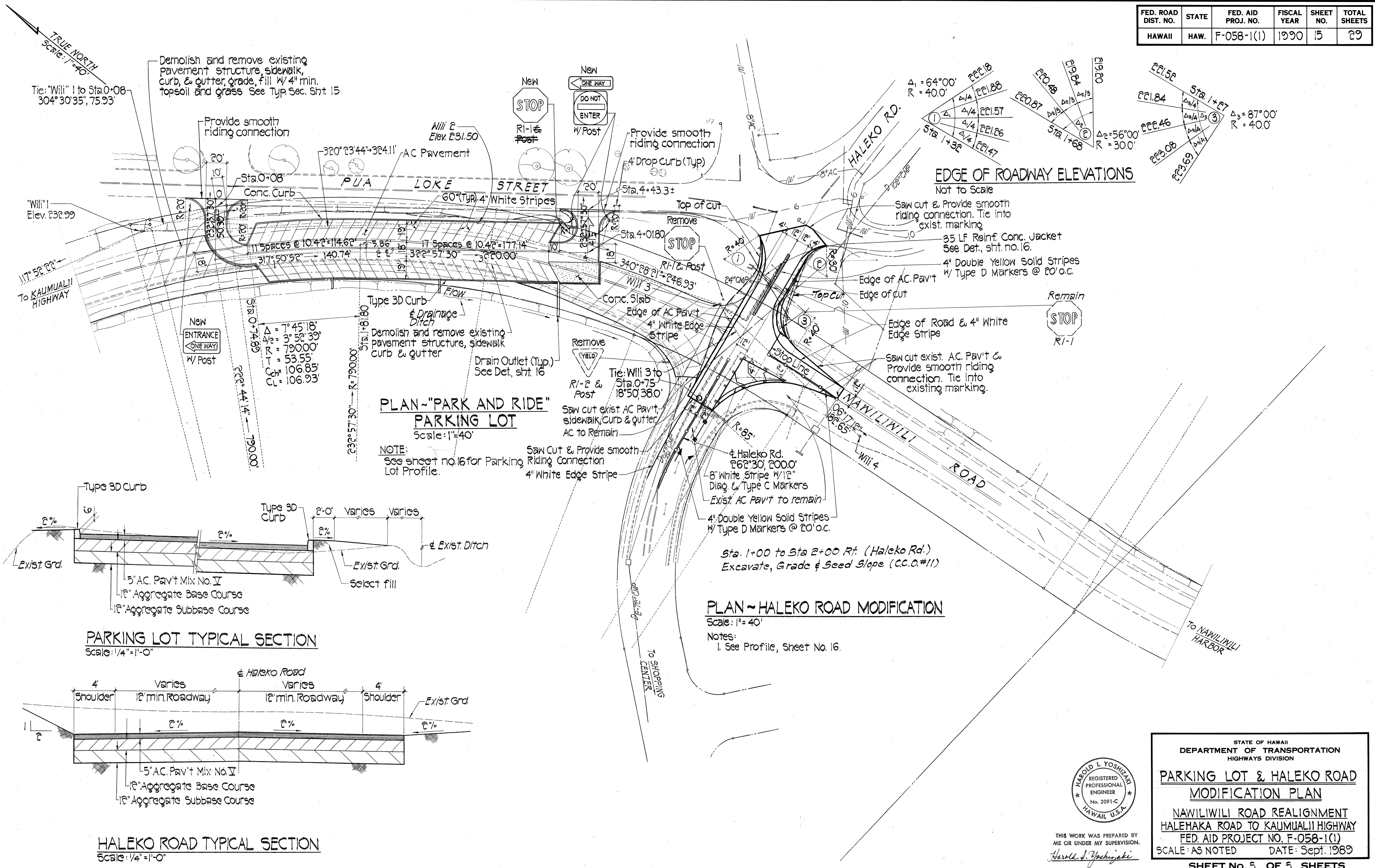

EDGE OF ROADWAY ELEVATIONS
Not to Scale

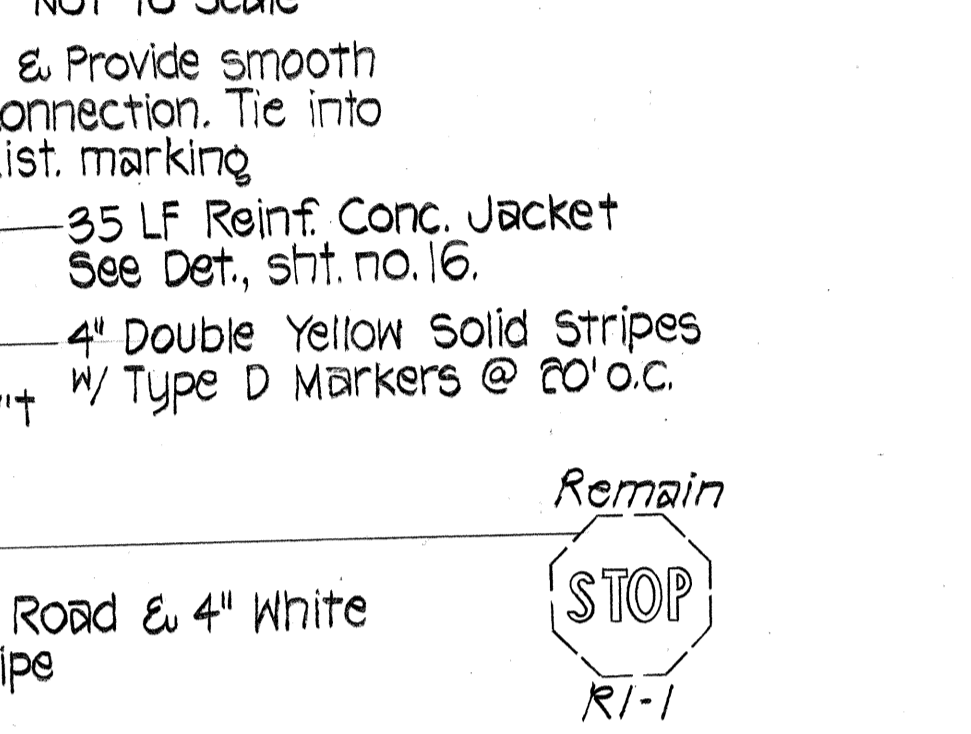

PLAN ~ "PARK AND RIDE" PARKING LOT
Scale: 1" = 40'

NOTE:
See sheet no. 16 for Parking Lot Profile.

PLAN ~ HALEKO ROAD MODIFICATION
Scale: 1" = 40'

Notes:
1. See Profile, Sheet No. 16.

PARKING LOT TYPICAL SECTION
Scale: 1/4" = 1'-0"

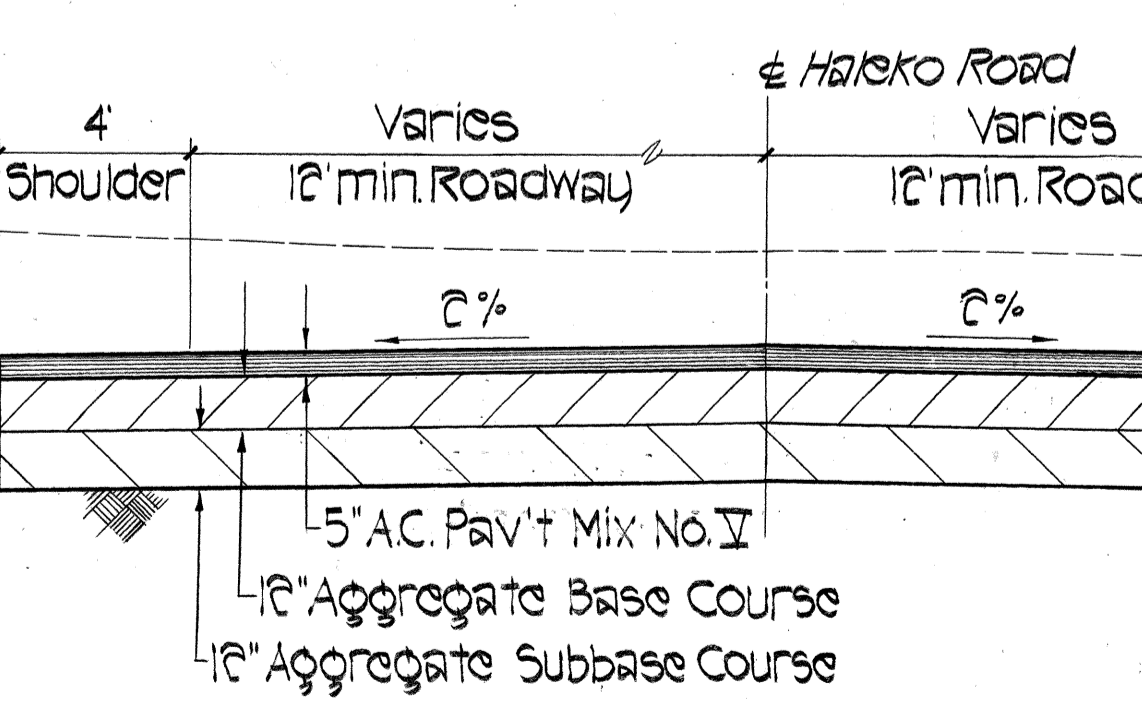

HALEKO ROAD TYPICAL SECTION
Scale: 1/4" = 1'-0"

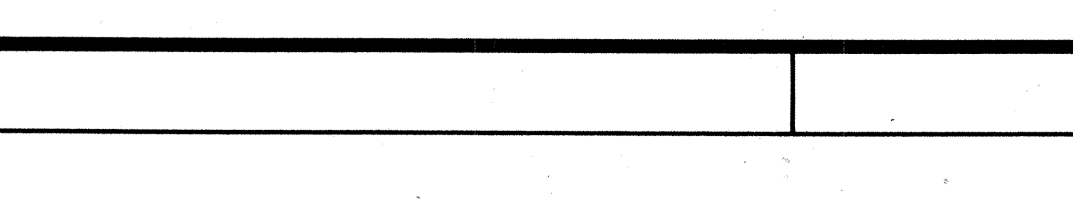

DATE	_____
SURVEY PLOTTED BY	_____
DRAWN BY	_____
TRACED BY	_____
DESIGNED BY	_____
CHECKED BY	_____
NO.	_____

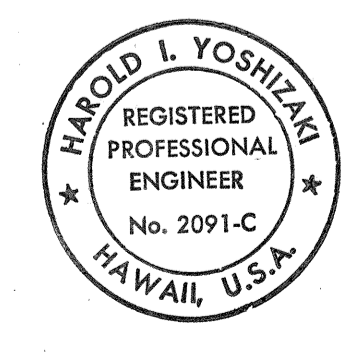

THIS WORK WAS PREPARED BY ME OR UNDER MY SUPERVISION.
Harold L. Yoshizaki

STATE OF HAWAII
DEPARTMENT OF TRANSPORTATION
HIGHWAYS DIVISION

PARKING LOT & HALEKO ROAD MODIFICATION PLAN

NAWILIWILI ROAD REALIGNMENT
HALEHAKA ROAD TO KAUMUALII HIGHWAY
FED. AID PROJECT NO. F-058-1(1)
SCALE: AS NOTED DATE: Sept. 1989

SHEET No. 5 OF 5 SHEETS