

LEGEND

- RSA — RUNWAY SAFETY AREA
- ACTIVE AIRCRAFT ROUTES
- TEMPORARY PORTABLE JETBLAST DEFLECTOR
- LOW PROFILE BARRICADE
- TRAFFIC CONES
- CONTRACTOR HAUL ROUTE
- RUNWAY CLOSURE 'X'
- FLAGGER - WITH ATCT RADIO COMMUNICATION
- CLOSED CONSTRUCTION AREA
- CONTRACTOR STAGING AREA
- TEMPORARY EARTHWORK STOCKPILE
- EARTHWORK BORROW SITE
- COVER AIRFIELD SIGN
- COVER AIRFIELD LIGHT
- FAA STAGING & WORK AREA

WORK TO BE PERFORMED:

1. PLACE LOW PROFILE BARRICADES, AIRFIELD SIGN & TAXIWAY EDGE LIGHT COVERS TO FACILITATE CLOSURE AREAS
2. NIGHT 1: OBLITERATE RWY CL PAVEMENT MARKINGS AT TWY D CROSSING
3. NIGHT 2: PLACE ASPHALT SEAL COAT
4. NIGHT 3: INSTALL PERMANENT RWY 3-21 PAVEMENT MARKINGS
5. ADJUST RUNWAY DISTANCE REMAINING SIGNS

PHASING NOTES:

1. CONTRACTOR SHALL BRING ADDITIONAL RESOURCES TO COMPLETE THE WORK WITHIN SPECIFIED DURATION FOR THE PHASE
2. WORK SHALL BE PERFORMED OUTSIDE OF TEMPORARY RWY 17-35 RSA

**SUB-PHASE 4B (NIGHTTIME) - TWY D CROSSING
RWY 3-21**

DURATION: 3 CALENDAR NIGHTS
CONCURRENT WITH PHASE 4 AND SUB-PHASE 4A
WORK SHIFT: 2300 TO 0800 HST

AIRFIELD OPERATIONS NOTAMS:

- REFER TO DWG G4.01 FOR PHASE 4 NOTAMS
- REFER TO DWG G4.02 FOR SUB-PHASE 4A NOTAMS
- TWY D CLOSED BETWEEN TWY A AND TWY B
- HIGH SPEED TWY D CLOSED BETWEEN RWY 17-35 AND TWY B

NAVAID SHUTDOWNS / NOTAMS:

- REFER TO DWG G4.01 FOR PHASE 4 NOTAMS
- REFER TO DWG G4.02 FOR SUB-PHASE 4A NOTAMS

SPECIAL INSTRUCTIONS FOR ATIS:

- DEPARTING IFR AIRCRAFT FOR RWY 17-35 MUST HOLD AT GATE FOR RELEASE FROM HCF ON 134.0/319.2, 126.5/269.4 OR CALL HCF AT 808-840-6201
- ARRIVING IFR AIRCRAFT SHALL CANCEL FLIGHT PLAN WHEN CLEAR OF LANDING RUNWAY AND ALL TAXIWAYS

AIRFIELD NON-STANDARD CONDITIONS:

- REFER TO DWG G4.01 FOR PHASE 4 CONDITIONS
- REFER TO DWG G4.02 FOR SUB-PHASE 4A CONDITIONS
- NON-STANDARD TAXIWAY CENTERLINE MARKING AT TWY D CROSSING RWY 3-21

DECLARED DISTANCES				
DISTANCE	RUNWAY 3	RUNWAY 21	RUNWAY 17	RUNWAY 35
ACCELERATED STOP DISTANCE AVAILABLE (ASDA)	0	0	6,500'	6,200' *
LANDING DISTANCE AVAILABLE (LDA)	0	0	6,500'	6,200' *
TAKEOFF RUN AVAILABLE (TORA)	0	0	6,500'	6,500'
TAKEOFF DISTANCE AVAILABLE (TODA)	0	0	6,500'	6,500'

* DECLARED DISTANCE REDUCED

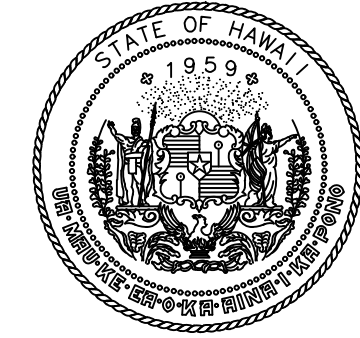

Airports Division
DEPARTMENT OF TRANSPORTATION
STATE OF HAWAII

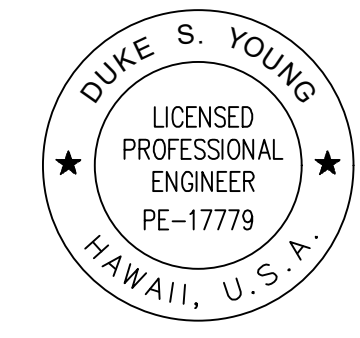

Duke Young 4/30/24
DUKE YOUNG, PE
CIVIL ENGINEER
Expiration Date

DSGN.	DRWN.	CHKD.	APPD.
HF	HT	JB	DY

KEY PLAN / NOTES:

NO.	DATE	REVISIONS
-----	------	-----------

CONSTRUCTION DOCUMENTS

JULY 2022
DATE

PROJECT TITLE :

**RELOCATE
RUNWAY 3-21**

AT
LIHUE AIRPORT
LIHUE, KAUAI, HAWAII

PROJECT NO.:

AK1031-14

SHEET TITLE:

**SUB-PHASE 4B
(NIGHTTIME)**

DATE :

07/2022

SHEET :

61 OF 376 SHEETS

DWG. NO.

G4.04

C:\USERS\GALLARDO\BBOX\LIHUE\RSA\900-CAD-GIS\900-CAD\20-SHEETS\G4.04-1.05.DWG

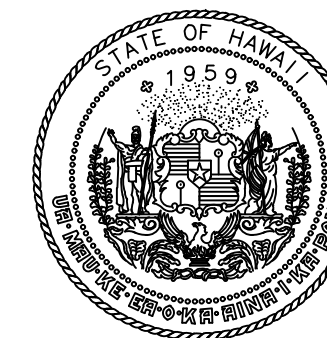
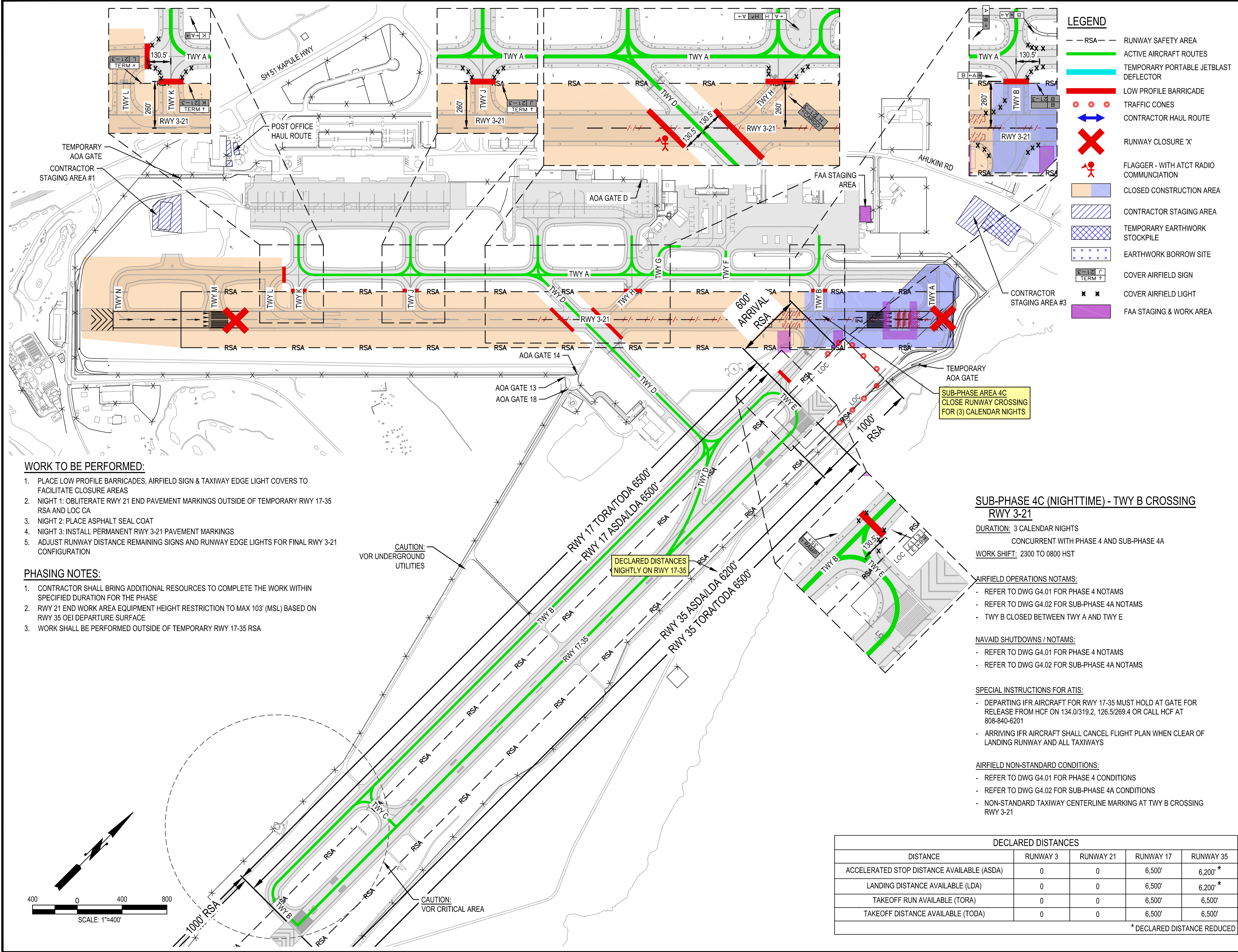

Airports Division
DEPARTMENT OF TRANSPORTATION
STATE OF HAWAII

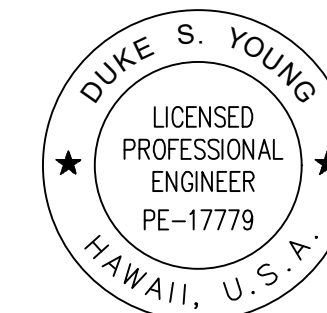

Duke S. Young
DUKE YOUNG, PE
CIVIL ENGINEER

4/30/24
Expiration Date

DSGN.	DRWN.	CHKD.	APPD.
HF	HT	JB	DY

KEY PLAN / NOTES:

NO.	DATE	REVISIONS
-----	------	-----------

CONSTRUCTION DOCUMENTS

JULY 2022
DATE

PROJECT TITLE :

RELOCATE RUNWAY 3-21

AT
LIHUE AIRPORT
LIHUE, KAUAI, HAWAII

PROJECT NO.:

AK1031-14

SHEET TITLE:

SUB-PHASE 4C (NIGHTTIME)

DATE :	DWG. NO.
07/2022	G4.05
SHEET :	
62 OF 376 SHEETS	